

W-E DRILL SECTIONS

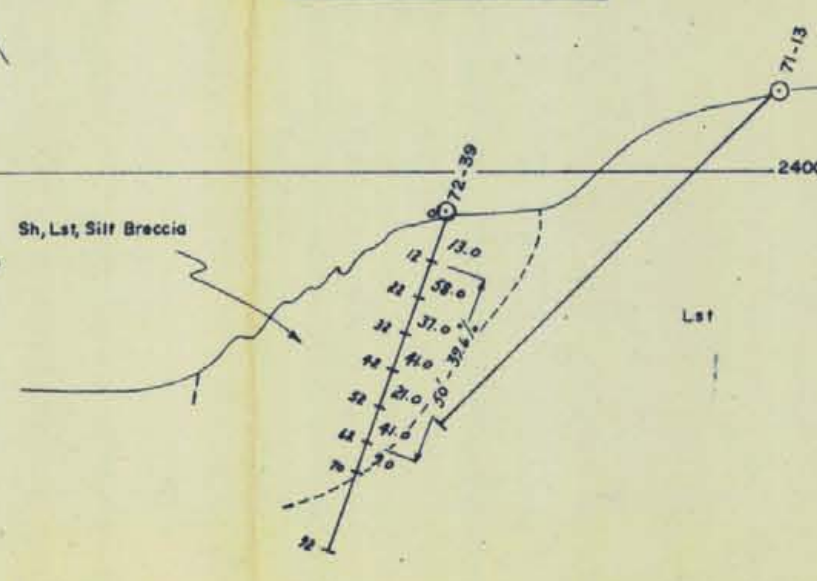

LEGEND

- Overburden
- Fluorite-Witherite, Baritocalcite (Fl Ba)
- Shale breccia (Sh Bx)
- Shale (Sh)
- Limestone breccia (Lst. Bx)
- Limestone (Lst)
- Bedding
- Mapped contact
- Assumed contact
- Fossils
- Survey station
- Stadia point
- Outline of trench or road
- Diamond drill hole

Sample No	Length	% Ca F ₂
17094	10'	70.0
17095	30'	49.0

Department of
Mines and Petroleum Resources
ASSESSMENT REPORT
NO. 3975 MAP #16

LIARD FLUORSPAR MINES LTD.

CLIFF PROSPECT
GEOLOGY

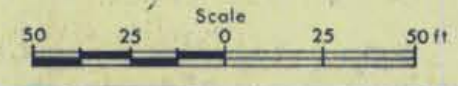

Survey by: A. Audet Map by: J. Brander & H. Meixner
Project No 1972 Figure No-16

To accompany Report
by
J. R. Woodcock
(November 1972)
on
Liard Fluorspar Project
Tee, Tam, Fire, West, Gem Mineral Claims
Liard Mining Division

J. R. Woodcock
PROFESSIONAL
ENGINEER

LIARD FLUORITE

SHOWS A, B, D, E, G

SCALE 1"=100'
CONTOUR INTERVAL 10 FT.

- LEGEND**
- C ■ ■ **ORE:** (a) in outcrop, (b) assumed
(ore has over 60% combined fluorite
with iron, and barite)
 - B ■ ■ **SLATE & ARGILLITE:**
(a) in outcrop, (b) assumed
 - A ■ ■ **LIMESTONE:**
(a) in outcrop, (b) assumed
- Limits of outcrop
 - Cliff edge
 - Rock contains small lenses
& stringers of ore
 - Float of ore
 - Fossil Locality
 - Attitude of Bedding
 - Stripped Area
 - Road
 - Claim Posts
 - Grid Line showing location
of labelled 2'-high posts
 - Diamond Drill Holes
 - Shale, Limestone Contact

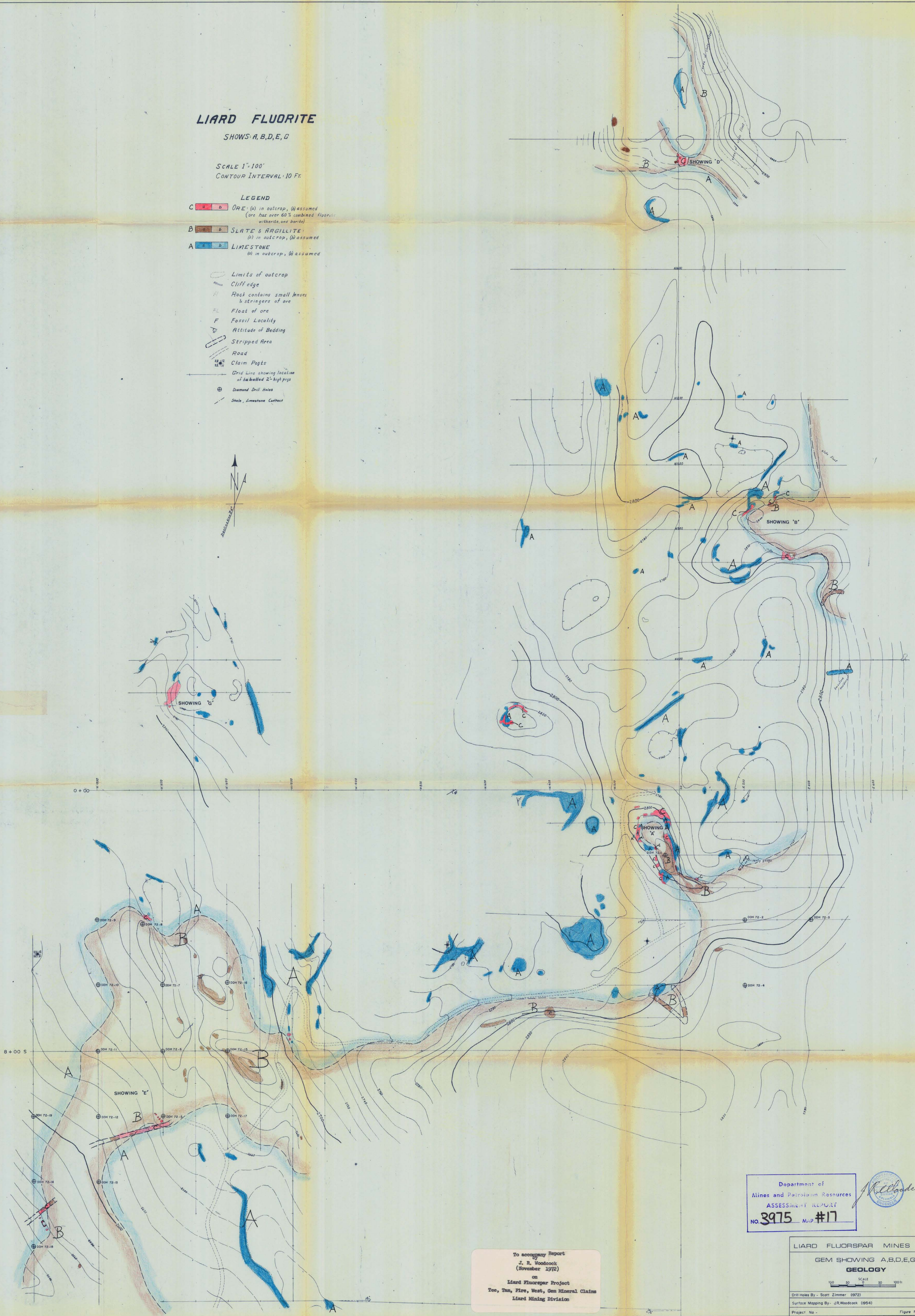
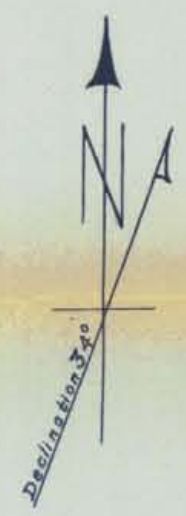

Department of
Mines and Petroleum Resources
ASSESSMENT REPORT
NO. 3975 MAP #17

To accompany Report
by
J. R. Woodcock
(November 1972)
on
Liard Fluorspar Project
Tee, Das, Fire, West, Gen Mineral Claims
Liard Mining Division

LIARD FLUORSPAR MINES LTD
GEM SHOWING A,B,D,E,G
GEOLOGY
SCALE 1"=100'
Drill Holes By - Scott Zimmer (1972)
Surface Mapping By - J.R. Woodcock (1954)
Project No. - Figure No. 17

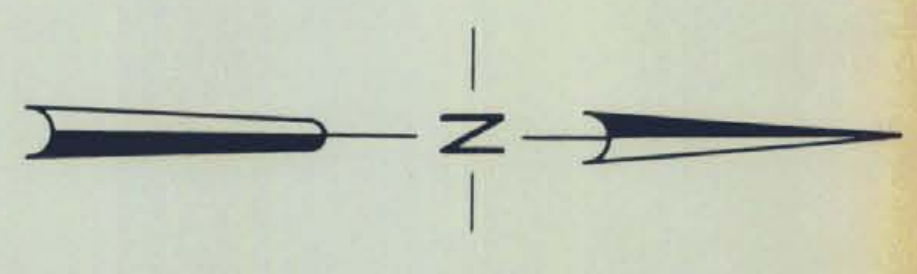


7500 NORTH
19,000 WEST
MAIN PROPERTY GRID

LEGEND

- Alluvial Fan and Bar
- New Fills and Bars
- Sand Bedrock
- Limestone Bedrock
- Stone
- Limestone
- Boundary
- Inferred contact
- Assumed contact
- Marginalized zone
- Dam
- Sandy stream
- Dam
- Spill point
- Outline of transmission

Department of
Mines and Petroleum Resources
ASSISTANT REGISTRAR
No. 39175 Map #18



Geological Report
2, 10, 100000
(November 1975)
Camp Prospect
200, 200, 200, 200, 200, 200, 200, 200
Zambian Mining Division

LIARD FLUORSPAR MINES LTD.
CAMP PROSPECT
GEOLOGY

Scale: 1:50,000

PROJECT No. _____

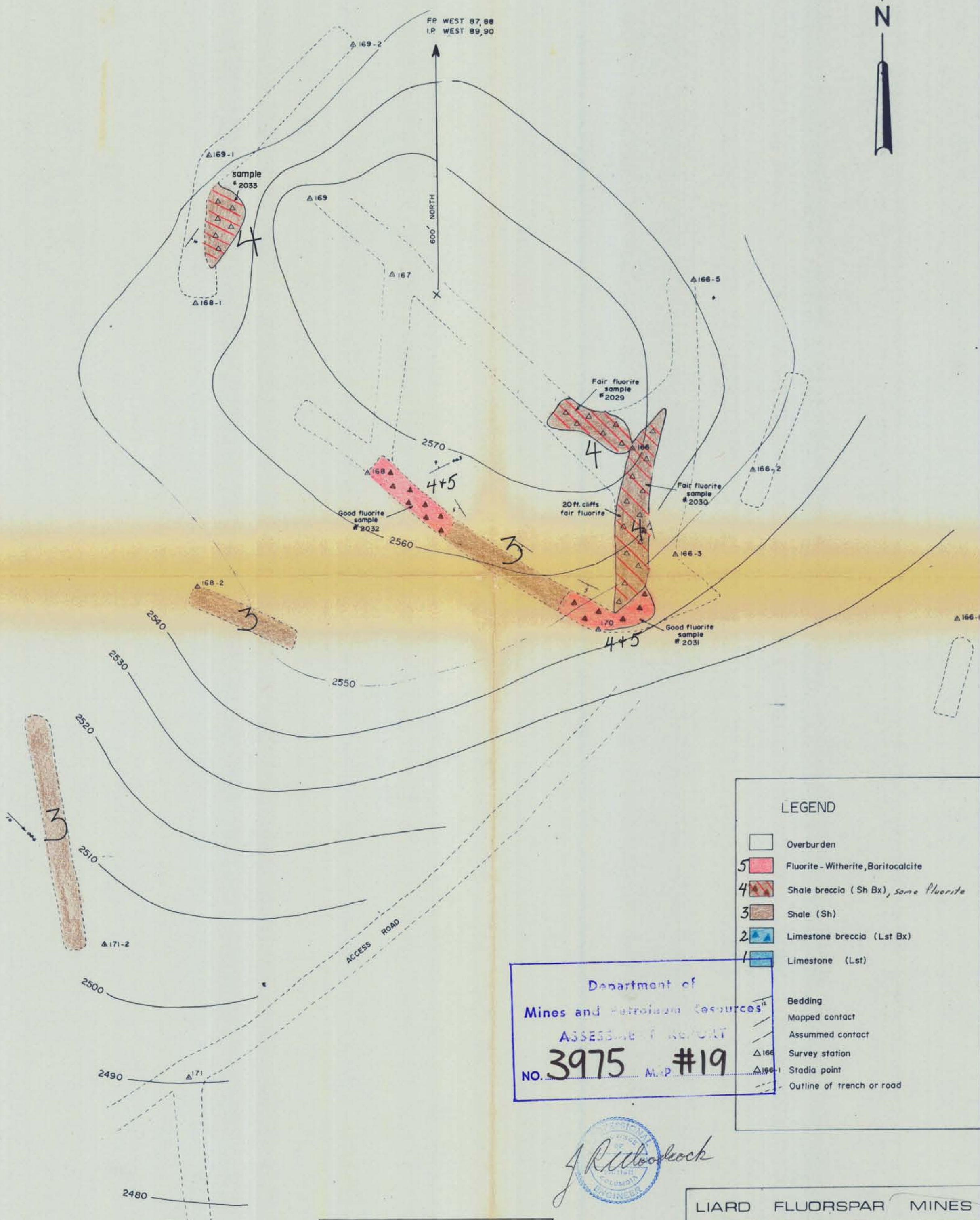
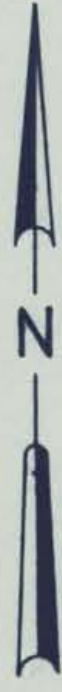

LEGEND

- Overburden
- 5 Fluorite - Witherite, Baritocalcite
- 4 Shale breccia (Sh Bx), some Fluorite
- 3 Shale (Sh)
- 2 Limestone breccia (Lst Bx)
- 1 Limestone (Lst)
- Bedding
- Mapped contact
- Assumed contact
- Survey station
- Stadia point
- Outline of trench or road

Department of
Mines and Petroleum Resources
ASSESSMENT REPORT
NO. 3975 M.P. #19

J. R. Woodcock

To accompany Report
by
J. R. Woodcock
(November 1972)
on
Liard Fluorspar Project
Tee, Tan, Fire, West, Gem Mineral Claims
Liard Mining Division

Sample No	% CaF ₂
2029	3.33
2030	2.51
2031	17.3
2032	8.09
2033	16.8

LIARD FLUORSPAR MINES LTD.

**NIK PROSPECT
GEOLOGY**

Scale
50 25 0 25 50 ft

Mapped by - A. Audet July 1972

PROJECT No. FIGURE No - 19



2 of Tam 45 & 46
41 of Gem 27 & 26

Sample No	Length	% Ca F ₂
2002	18'	52.4
2003	26'	32.1
2004	18'	41.2
2005	15'	28.4
2006	20'	44.9
2007	20'	28.6
2008	20'	13.7



LEGEND

- Overburden
- Fluorite-Witherite, Baritocalcite (Fl Ba)
- Limestone (Lst)
- Ca Calcite
-
-
-

Department of
Mines and Petroleum Resources
ASSESSMENT REPORT
NO. 3975 MAP #20



To Accompany Report
by
J. R. Woodcock
(November 1972)
on
Liard Fluorspar Project
Tee, Tam, Fire, West, Gem Mineral Claims
Liard Mining Division

LIARD FLUORSPAR MINES LTD.
**HENRY PROSPECT
GEOLOGY**

Scale 0 25 50 ft

Mapped by H Meixner & J Brander

Project No- 1972 Figure No -20

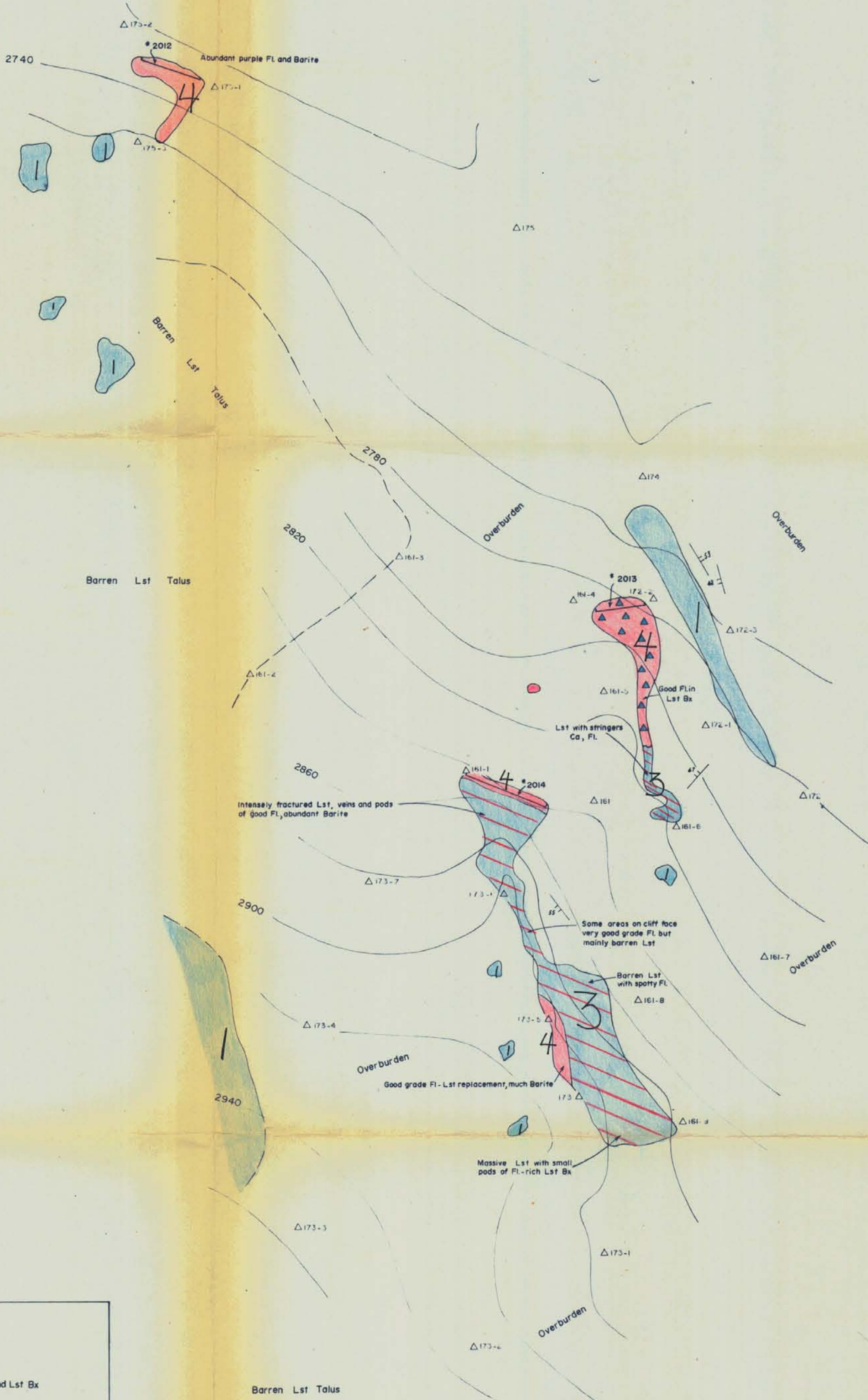
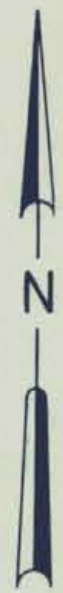

LEGEND

- Overburden
- 4 Mineralized Lst and Lst Bx
- 3 Lst with veins pods Fl and Barite
- 2 Limestone breccia
- 1 Limestone
- Bedding
- Mapped contact
- Assumed contact
- Lst Limestone
- Fl Fluorite
- Bx Breccia

Sample No	Length	% Ca F ₂
2012		35.0
2013		51.0
2014		31.0

Department of
 Mines and Petroleum Resources
 ASSESSMENT REPORT
 NO. 3975 M.P. #21

J. R. Woodcock

To accompany Report
 by
 J. R. Woodcock
 on
 Liard Fluorspar Project
 Tee, Tam, Fire, West, Gem Mineral Claims
 Liard Mining Division

LIARD FLUORSPAR MINES LTD.

BAR PROSPECT

GEOLOGY

Scale
 50 25 0 25 50 ft

Mapped by - A. Audet
 PROJECT No - 1972 FIGURE No - 21

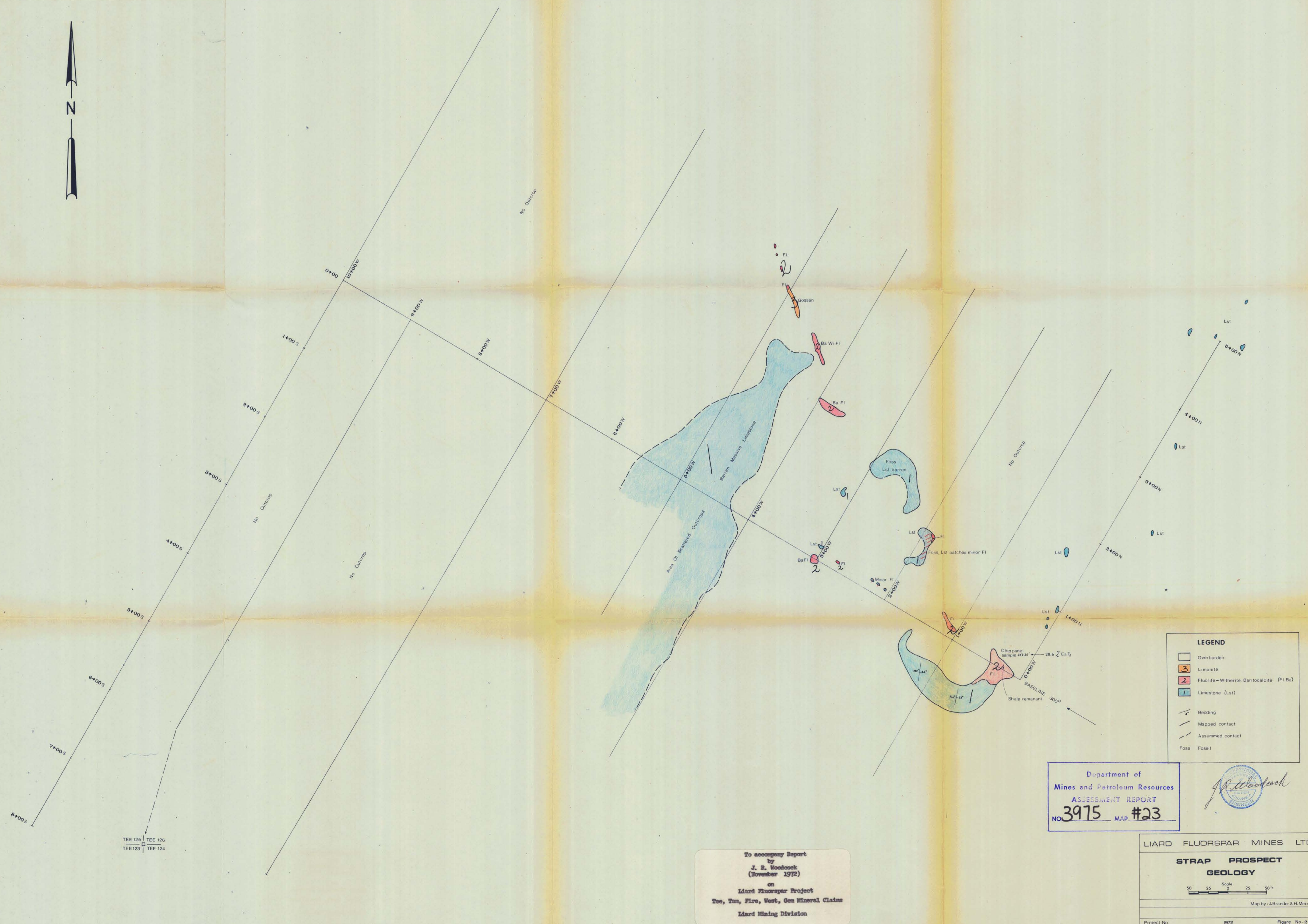
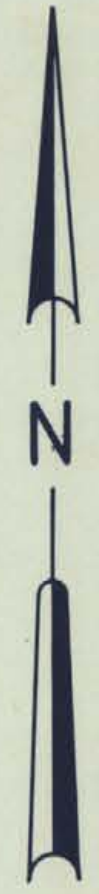

LEGEND

[White box]	Overburden
[Orange box]	Limonite
[Red box]	Fluorite-Witherite, Baritocalcite (Fl Ba)
[Blue box]	Limestone (Lst)
[Dashed line]	Bedding
[Solid line]	Mapped contact
[Dotted line]	Assumed contact
[Symbol]	Foss Fossil

Department of
Mines and Petroleum Resources
ASSESSMENT REPORT
NO. 3975 MAP #23



To accompany Report
by
J. R. Woodcock
(November 1972)
on
Liard Fluorspar Project
Tee, Tux, Fire, West, Gem Mineral Claims
Liard Mining Division

LIARD FLUORSPAR MINES LTD.
**STRAP PROSPECT
GEOLOGY**
Scale
50 25 0 25 50 ft
Map by: J. Brander & H. Meixner
Project No. 1972 Figure No. 23

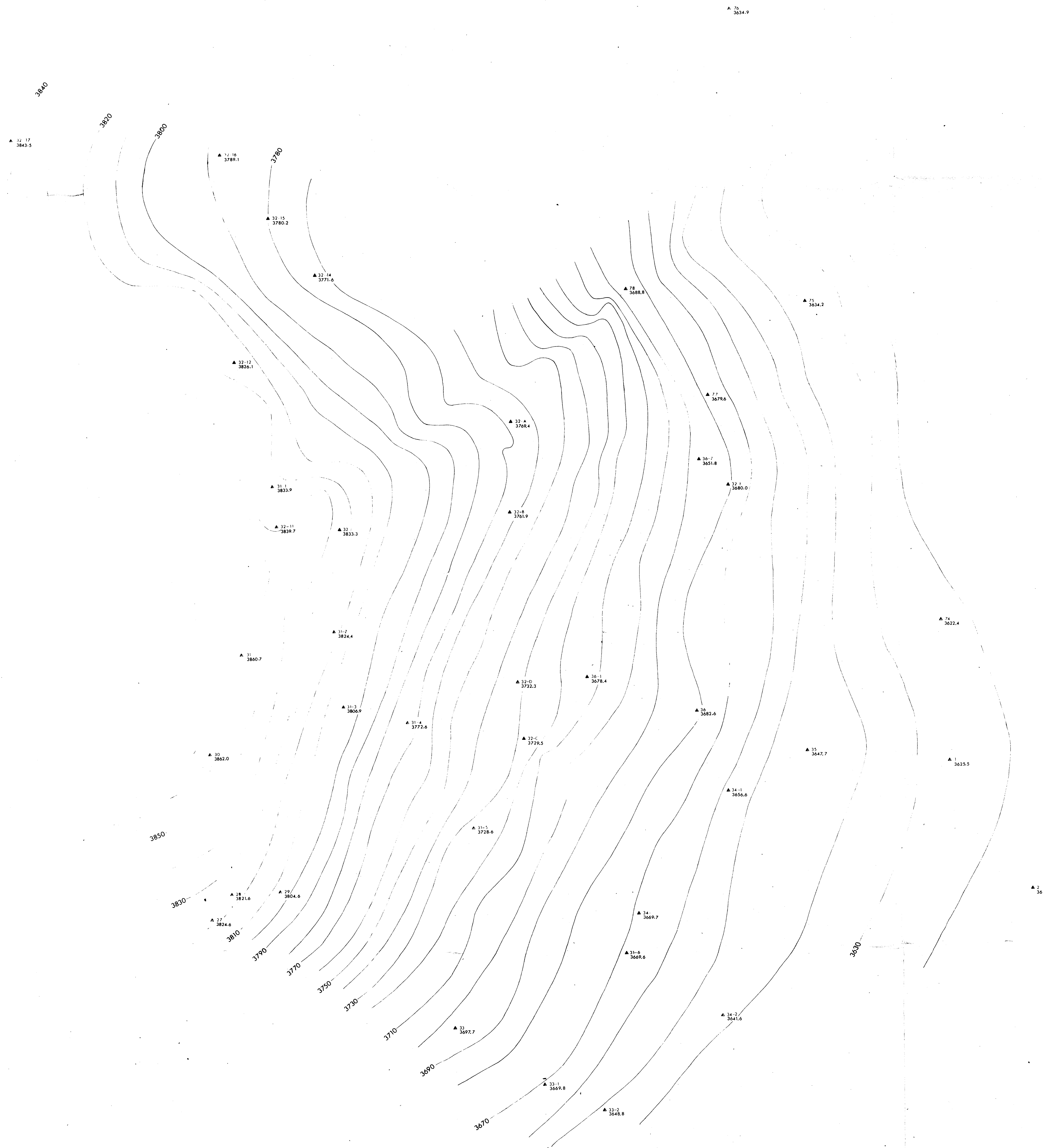
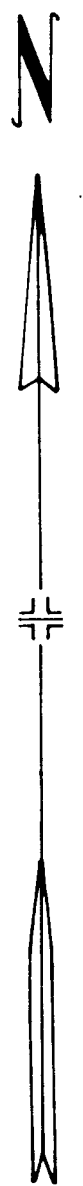

to accompany reports
by
J. R. Woodcock
(November 1972)
on
Liard Fluorspar Project
Tee, Ten, Fire, West, Gem Mineral Claims
Liard Mining Division

Department of
Mines and Petroleum Resources
ASSESSMENT REPORT
NO. 3975 MAP #9

LIARD FLUORSPAR
TAM DEPOSIT
TRANSIT SURVEY
Scale: 1" = 100'
Survey By: A.A.S.
Project No. 1972 Figure No. 9

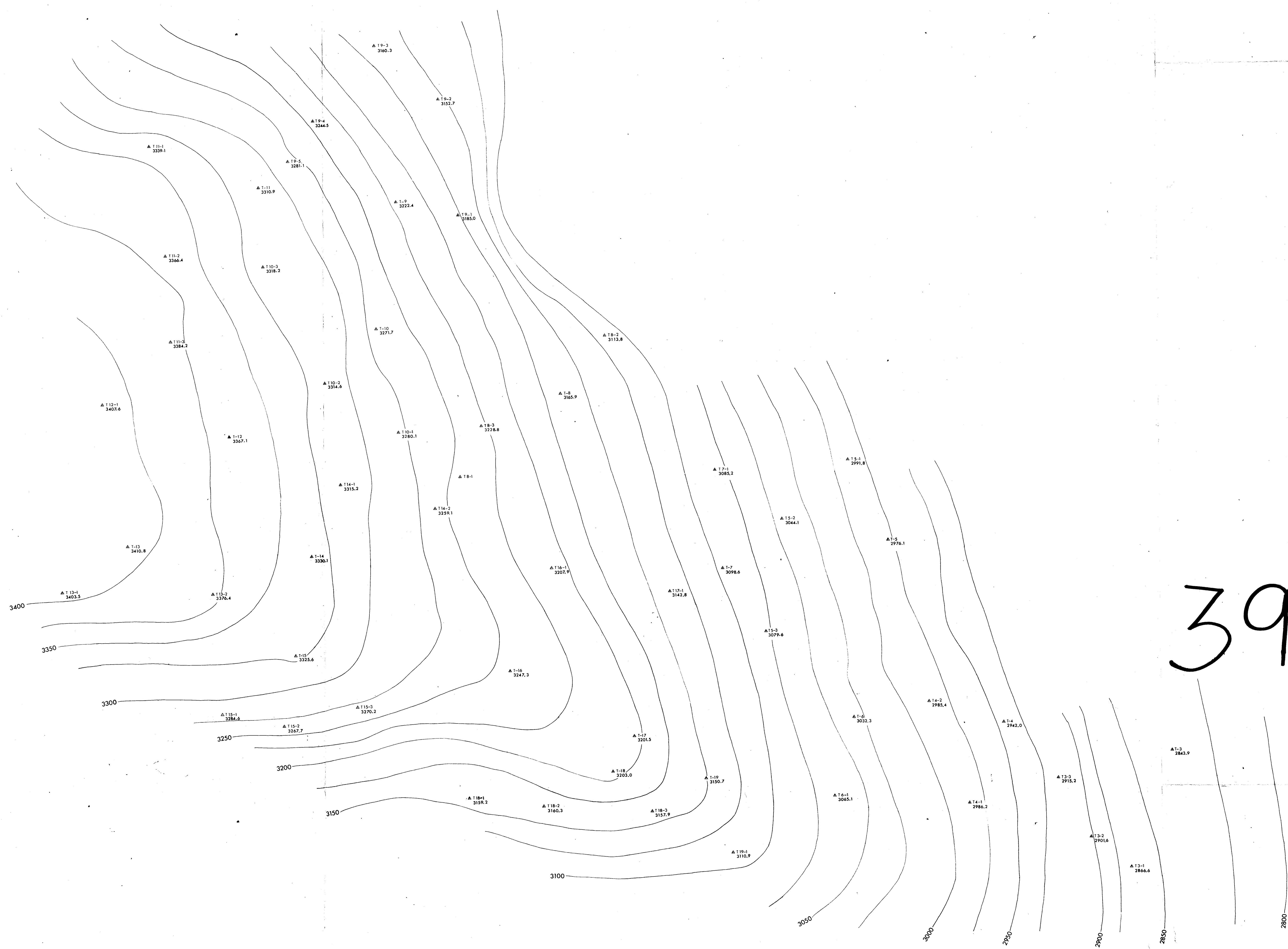

3975
M-11

Department of
Mines and Geotechnical Resources
ASSESSMENT REPORT
NO. 3975 MAP #11



To accompany Report
by
J. R. Woodcock
(November 1972)
on
Liard Fluorspar Project
Tee, Tan, Fire, West, Gem Mineral Claims
Liard Mining Division

LIARD FLUORSPAR	
TEE DEPOSIT	
TRANSIT SURVEY	
50 25 0 25 50m	
SCALE	
Survey By - A.Audet	
Project No - 1072	Figure No - 11

TEETER CREEK

TEETER CREEK

94 1/2 West Half 94 1/2 East Half

59° 40' 128° 30'

59° 40' 128° 30'

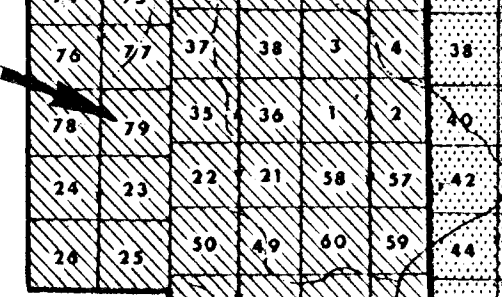
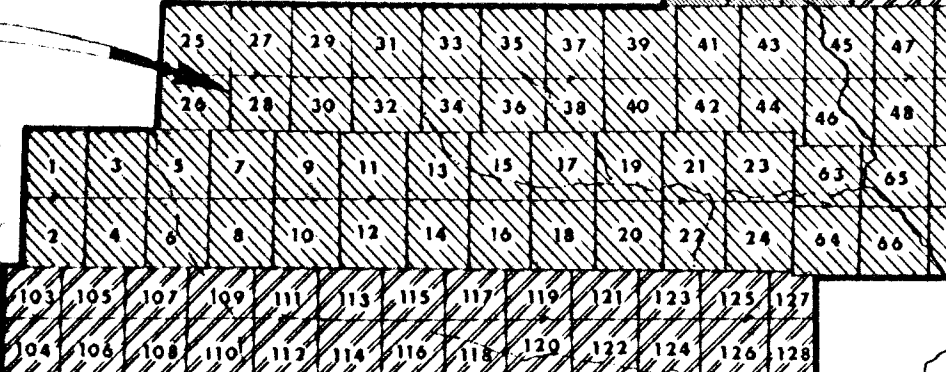
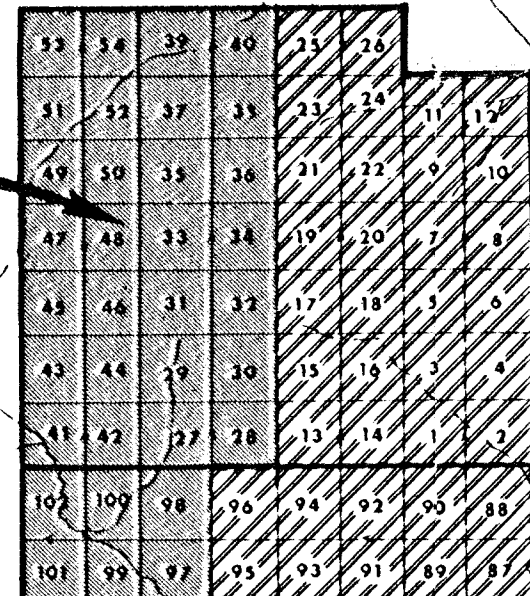
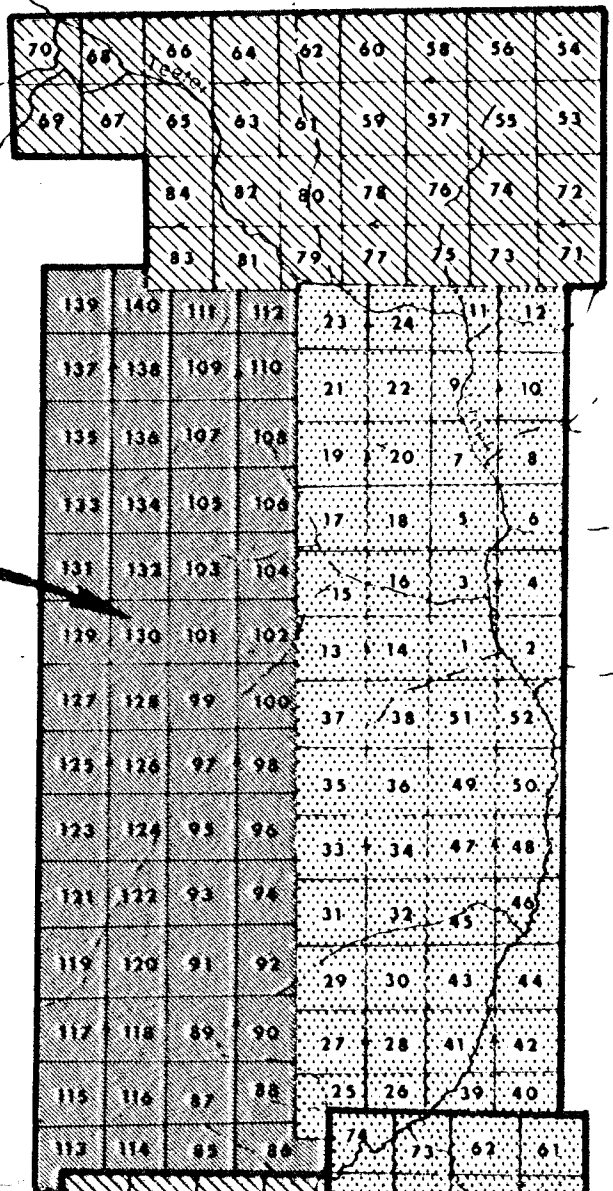
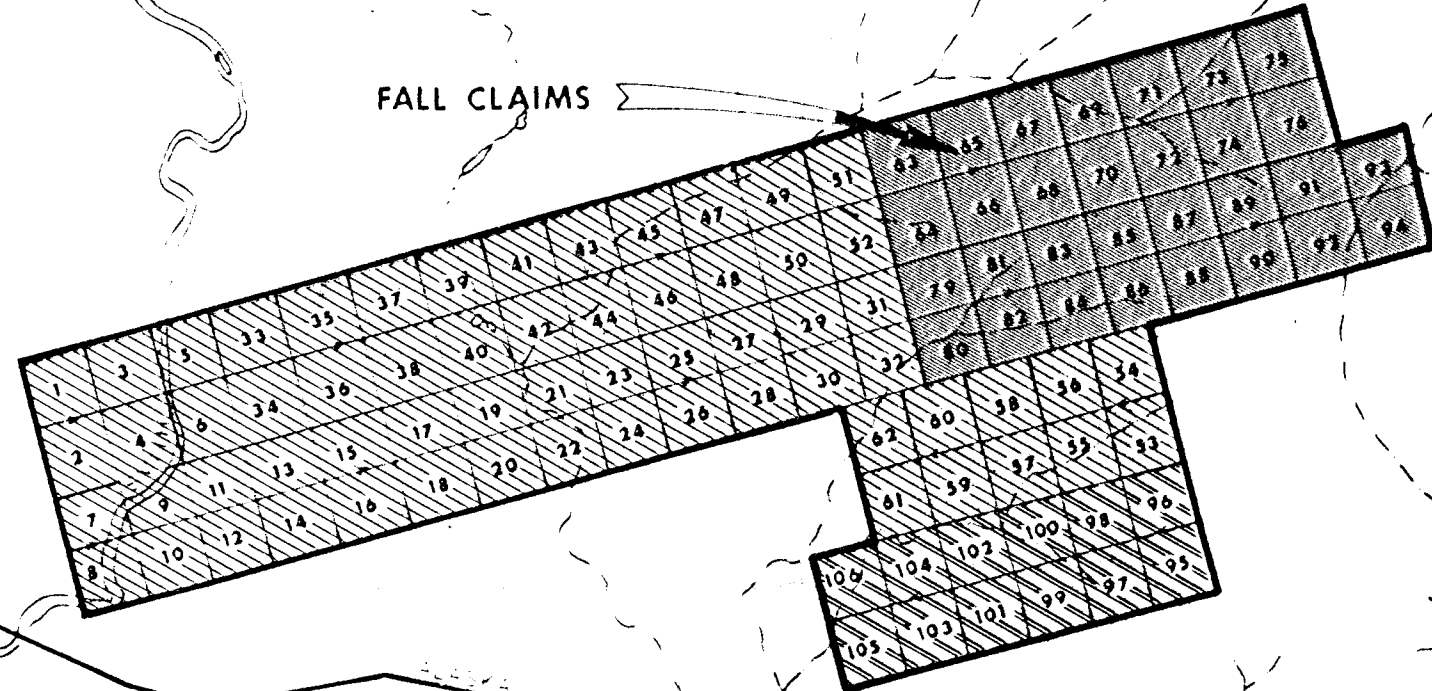

TAM CLAIMS







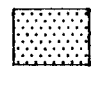

GEM CLAIMS

GEM C.G. 6700-26

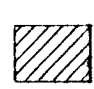
MEM CLAIMS

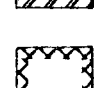
PET CLAIMS

CLAIM ANNIVERSARY DATES

-  JULY 23
-  JULY 26
-  SEPTEMBER 2
-  OCTOBER 7
-  OCTOBER 19
-  OCTOBER 20
-  OCTOBER 25
-  OCTOBER 28
-  DECEMBER 20
-  SEPTEMBER 15



59° 20' 128° 10'

59° 20' 128° 10'

VENTS RIVER

Department of
Mines and Petroleum Resources
ASSESSMENT REPORT
NO. 3975 MAP #2

To accompany Report
by
J. R. Woodcock
(November 1972)
on
Liard Fluorspar Project
Tee, Tam, Fire, West, Gem Mineral Claims
Liard Mining Division



JOEX-CONWEST
LIARD FLUORSPAR PROJECT
CLAIMS STATUS MAP
LIARD HOTSPRINGS AREA
SCALE - 1:50,000
J.R. WOODCOCK CONSULTANTS LTD.
Figure Number - 2 Date - 1972

13472
36r 36
36r 34
27/12/75
J.R.W.
2:15:27
4:25