

92J/7E

LINE CUTTING REPORT

HAPPY VALLEY MINERAL CLAIMS

LINE CUTTING REPORT

WORK DONE: JULY 1-5/72

LILLOOET MINING DIVISION

RETURN TO
DEPARTMENT OF MINES AND PETROLEUM RESOURCES
VICTORIA, BRITISH COLUMBIA

3988

ENLARGEMENT OF MAP 92-37 EAST
SHOWING HAPPY VALLEY CLAIMS
① & ② MADE BY P.S. RANDRY

Happy Valley 2
34159 N

29923 AX 14

29925 AX 16

LINE CUTTING REPORT
HAPPY VALLEY MINERAL CLAIMS

JULY 1-5 /72

LILLOOET MINING DIV.

29922 AX 13

29926 AX 15

39888

M-1

A line cleared completely
of timber and underbrush
with high tripod type markers
spaced at 66' intervals
using compass to maintain
line S 45° W

Trail
camp

Happy Valley 1
34158 N

WIDE CREEK

Lillooet Lake

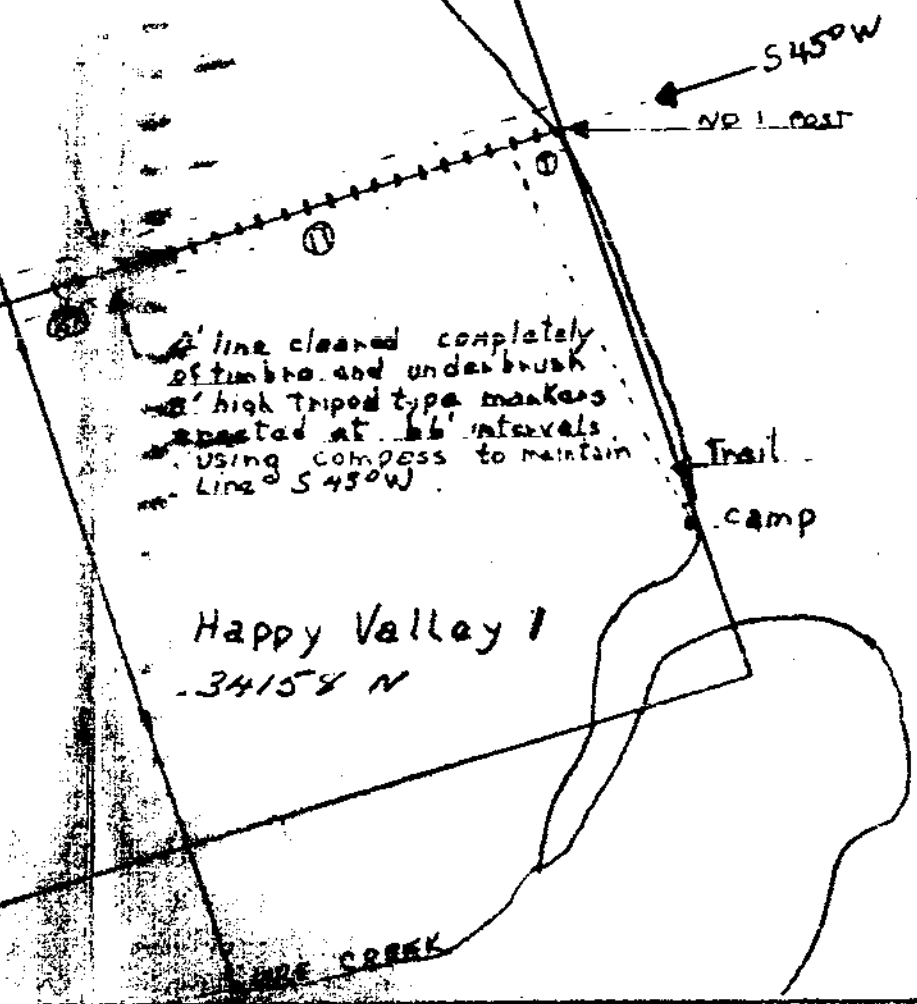
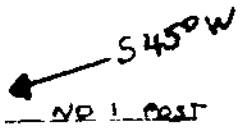

Department of
Mines and Geotechnical Resources
ASSESSMENT REPORT
NO. 3988 MAP #1