

RED RIVER MINES, LTD., (NPL)

HAWK MINERAL CLAIMS

Geochemical Survey

921/2W

4106

# 4106

REPORT ON THE  
GEOCHEMICAL SURVEY - SOIL SAMPLES

HAWK 1 - 35 MINERAL CLAIMS

NICOLA MINING DIVISION

MERRITT, B. C.

GOVERNMENT AGENT

RECEIVED

DEC 12 1973

MERRITT, B. C.

LOCATION DATA

The claim group is located on the south slope of Promentary Hill and approximately two and onehalf miles south-west of the Craigmont Mine, within the boundaries of the Nicola Mining Division. The average elevation of the locality of the claims is 4,200 ft.

The location is more precisely described as 50°10' North Latitude and 121°54' West Longitude, and consists of 35 contiguous claims staked in a northeasterly-southwesterly direction:

HAWK 1 - 35, Rec. Nos. 43843-43877  
December 5, 1970

MAPS

#1 Claim map

#2 Geochem. - Base map

Department of  
Mines and Petroleum Resources  
ASSESSMENT REPORT

NO. 4106 MAP

In October, 1972, a crew of men was employed to run base lines and to establish a grid on a portion of the "Hawk" block of mineral claims in the Nicola Mining Division, Province of B. C.

The base line was established from the final Claim Post tagged as Hawk #12 and #14, and Initial Post tagged as Hawk #14 and #15. A line was run 800' along the claim line. At this point a corner was turned at  $90^{\circ}$  - to Az.  $47.5^{\circ}$  - and this line was established as the Base Line. An additional control line was established by running a perpendicular line 2400' to the north, and Line "A" was run parallel to the base line.

A 200' grid was run and soil samples collected at 200' intervals on grid. Sampling was from the "B" soil zone using standard techniques and material sent to General Testing Labs for assay where AA analysis was used following decomposition with hot  $\text{HNO}_3$  and  $\text{HClO}_4$ .

## RESULTS

Soil sample analysis shows generally low values in copper, the only element for which tests were made. Two anomalous zones are indicated, with values above 100 parts per million considered as a base.

## RECOMMENDATION

Although the pattern is based on low values, it appears that there is positive indication that there is merit in further evaluation of the Hawk group. Further soil sampling and ground magnetometer survey is recommended on the group.

CERTIFICATE OF  
QUALIFICATIONS

I, Fred Kern, Jr., of 210 - 535 Howe Street, Vancouver, B. C., hereby certify:

1. I am a graduate Geologist with the B. Sc. in Geology from the University of Illinois, U. S. of A., 1948.
2. I have been employed as Geologist with major and minor petroleum and mining companies in North and South America.
3. During the past two years I have been active in Western Canada as consulting geologist.
4. The work outlined in this report was conducted directly under my supervision.

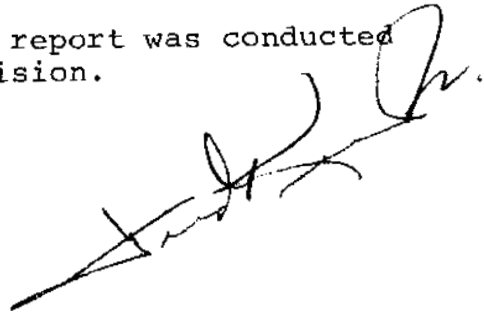
A handwritten signature in black ink, appearing to read "Fred Kern, Jr.", is written over the bottom right portion of the fourth list item. The signature is fluid and cursive, with a long horizontal stroke extending to the left.



# GENERAL TESTING LABORATORIES

DIVISION SUPERINTENDENCE COMPANY (CANADA) LTD

1001 EAST PENDER STREET VANCOUVER 6, B.C. CANADA  
 PHONE (604) 254-1647 TELEX 04-507514 CABLE SUPERVISE

TO:  
**RED RIVER MINES LTD.,**  
**4210-535 Howe Street,**  
**Vancouver, B.C.**

## CERTIFICATE OF ASSAY

No.: **7212-1951**

DATE: **22-12-72**

We hereby certify that the following are the results of assays on: **Geochemical Samples**

MARKED	COPPER (Cu) PPM							OZ/ST	OZ/ST
								GR/MT	GR/MT
0 0W-3	45								
0 200W	38								
0 200S	88								
0 400S	38								
0 600S	45								
0 800S	60								
0 1000S	28								
0 1200S	80								
0 400N	33								
0 600N	75								
0 800N	28								
0 1000N	40								
0 1200N	43								
0 1400N	45								
0 1600N	100								
0 1800N	40								
0 2000N	45								
0 2200N	28								
0 2400N	30								
25W 4S	43								
25W 4N	48								
25W 8N	45								
25W 12N	35								
25W 16N	35								
25W 20N	18								
25W 24N	15								
25W 28N	45								
25W 32N	95								
25W 36N	62								
200W 200W	43								
200W 400W	18								
200W 810	30								
200W 200S	43								
200W 400S	115								
200W 600S	45								

NOTE: REJECTS RETAINED ONE MONTH. PULPS RETAINED THREE MONTHS. ON REQUEST PULPS AND REJECTS WILL BE STORED FOR A MAXIMUM OF ONE YEAR.

ALL REPORTS ARE THE CONFIDENTIAL PROPERTY OF CLIENTS. PUBLICATION OF STATEMENTS, CONCLUSION OR EXTRACTS FROM OR REGARDING OUR REPORTS IS NOT PERMITTED WITHOUT OUR WRITTEN APPROVAL ANY LIABILITY ATTACHED THERETO IS LIMITED TO THE FEE CHARGED.

Cont'd ...

*H. Sharples*  
**H. Sharples**

PROVINCIAL ASSAYER

**COPY**

Analytical and Consulting Chemists, Bulk Cargo Specialists, Surveyors, Inspectors, Samplers, Weighers

MEMBER American Society For Testing Materials • The American Oil Chemists' Society • Canadian Testing Association  
 REFERENCE AND/OR OFFICIAL CHEMISTS FOR Vancouver Merchants Exchange • National Institute Of Oilseed Products • The American Oil Chemists' Society  
 OFFICIAL WEIGHMASTERS FOR Vancouver Board Of Trade • Vancouver Merchants Exchange



# GENERAL TESTING LABORATORIES

DIVISION: SUPERINTENDENCE COMPANY (CANADA) LTD

1001 EAST PENDER STREET, VANCOUVER 6, B.C. CANADA  
 PHONE (604) 254-1647 TELEX 04-507514 CABLE SUPERVISE

TO:  
  
**RED RIVER MINES LTD.**

## CERTIFICATE OF ASSAY

No.: **7212-1951**      DATE: **22-12-72**

We hereby certify that the following are the results of assays on: **Geochemical Samples**

Page **1**

MARKED	COPPER						SILVER	
	(%) PPM						OZ/ST GR/MT	OZ/ST GR/MT
200W 800E	35							
200W 1200E	38							
00 200E	28							
2007 400W	15							
6N 200E 600W	83							
8N 200E 800W	23							
1000W 200E 1000W	23							
1200W 200E 1200W	53							
1400W 200E	38							
1600W 200E	60							
18N 200E 1800W	33							
2000W 200E	30							
200E 2200W	70							
200E 2400W	28							
800W 00W	48							
800W 200W	30							
800W 200E	120							
800W 400W	58							
800W 400E	140							
800W 600W	43							
800W 600E	135							
800W 800W	53							
800W 1000W	95							
800W 1200W	60							
800W 1400W	68							
800W 1600W	45							
800W 1800W	33							
800W 2000W	58							
800W 2200W	33							
800W 2400W	45							
00 400W	40							
400W 200E	195							
200W 400W	30							
400W 400W	23							
400W 400E	60							

NOTE: REJECTS RETAINED ONE MONTH. PULPS RETAINED THREE MONTHS. ON REQUEST PULPS AND REJECTS WILL BE STORED FOR A MAXIMUM OF ONE YEAR.

ALL REPORTS ARE THE CONFIDENTIAL PROPERTY OF CLIENTS PUBLICATION OF STATEMENTS, CONCLUSION OR EXTRACTS FROM OR REGARDING OUR REPORTS IS NOT PERMITTED WITHOUT OUR WRITTEN APPROVAL. ANY LIABILITY ATTACHED THERETO IS LIMITED TO THE FEE CHARGED.

*H. Staples*  
**H. Staples**

Cont'd ...

PROVINCIAL ASSAYER

**COPY**

Analytical and Consulting Chemists, Bulk Cargo Specialists, Surveyors, Inspectors, Samplers, Weighers

MEMBER American Society For Testing Materials • The American Oil Chemists Society • Canadian Testing Association  
 REFEREE AND/OR OFFICIAL CHEMISTS FOR Vancouver Merchants Exchange • National Institute Of Oilseed Products • The American Oil Chemists' Society  
 OFFICIAL WEIGHMASTERS FOR Vancouver Board Of Trade • Vancouver Merchants Exchange



# GENERAL TESTING LABORATORIES

DIVISION: SUPERINTENDENCE COMPANY (CANADA) LTD.

1001 EAST PENDER STREET VANCOUVER 6, B.C., CANADA  
 PHONE (604) 254-1647 TELEX 04-507514 CABLE SUPERVISE

TO:  
  
**RED RIVER MINES LTD.**

## CERTIFICATE OF ASSAY

No.: **7212-1951** DATE: **22-12-72**

We hereby certify that the following are the results of assays on: **Geochemical Samples**

Page 3

MARKED	COPPER							
	(Cu) PPM						OZ/ST GR/MT	OZ/ST GR/MT
600N 400N	23							
400N 800N	39							
800N 400N	35							
1000N 400N	28							
1200N 400N	68							
1400N 400N	30							
1600N 400N	33							
1800N 400N	33							
2000N 400N	25							
2200N 400N	28							
2400N 400N	35							
1000N 800	55							
1000N 200N	30							
1000N 200N	33							
1000N 400N	40							
1000N 600N	55							
1000N 600N	38							
1000N 800N	60							
1000N 1000N	35							
1000N 1200N	83							
1000N 1400N	35							
1000N 1600N	103							
1800N 1800N	43							
100N 2000N	30							
1000N 2200N	15							
1000N 2400N	15							
600N 800	38							
600N 200N	48							
600N 400N	85							
600N 600N	40							
600N 800N	83							
600N 1000N	43							
600N 1200N	50							
600N 1400N	30							
600N 1600N	105							

NOTE: REJECTS RETAINED ONE MONTH, PULPS RETAINED THREE MONTHS. ON REQUEST PULPS AND REJECTS WILL BE STORED FOR A MAXIMUM OF ONE YEAR.

ALL REPORTS ARE THE CONFIDENTIAL PROPERTY OF CLIENTS. PUBLICATION OF STATEMENTS, CONCLUSION OR EXTRACTS FROM OR REGARDING OUR REPORTS IS NOT PERMITTED WITHOUT OUR WRITTEN APPROVAL. ANY LIABILITY ATTACHED THERETO IS LIMITED TO THE FEE CHARGED.

*H. Sharples*

**H. Sharples**

Cont'd ...

PROVINCIAL ASSAYER

**COPY**

Analytical and Consulting Chemists. Bulk Cargo Specialists, Surveyors, Inspectors, Samplers, Weighers

MEMBER: American Society For Testing Materials • The American Oil Chemists' Society • Canadian Testing Association  
 REFEREE AND/OR OFFICIAL CHEMISTS FOR: Vancouver Merchants Exchange • National Institute Of Oiled Products • The American Oil Chemists' Society  
 OFFICIAL WEIGHMASTERS FOR: Vancouver Board Of Trade • Vancouver Merchants Exchange





# GENERAL TESTING LABORATORIES

DIVISION: SUPERINTENDENCE COMPANY (CANADA) LTD.

1001 EAST PENDER STREET, VANCOUVER 6, B.C. CANADA  
 PHONE (604) 254-1647 TELEX 04-507514 CABLE SUPERVISE

TO:

**RED RIVER MINES LTD.**

## CERTIFICATE OF ASSAY

No.: **7212-1951**      DATE: **22-12-72**

We hereby certify that the following are the results of assays on: **Geochemical Samples**

Page 4

MARKED	COPPER						SILVER	
	(Cu) PPM						OZ/ST GR/MT	OZ/ST GR/MT
600W 1800W	38							
600W 2000W	23							
600W 2100W	28							
600W 2400W	20							
600W 200E	165							
600W 400E	93							
600W 600E	30							
1200W 0-3C	43							
1200W 200W	70							
1200W 200E	58							
1200W 400W	235							
1200W 400E	65							
1200W 600W	75							
1200W 600E	35							
1200W 800W	53							
1200W 1000W	25							
1200W 1200W	35							
1200W 1400W	135							
1200W 1600W	50							
1200W 1800W	58							
1200W 2000W	35							
1200W 2200W	30							
1200W 2400W	20							
1400W 00	35							
1400W 200W	38							
1400W 200E	53							
1400W 400W	45							
1400W 400E	33							
1400W 600W	73							
1400W 600E	40							
1400W 800W	30							
1400W 1000W	43							
1400W 1200W	93							
1400W 1400W	33							
1400W 1800W	43							

NOTE: REJECTS RETAINED ONE MONTH. PULPS RETAINED THREE MONTHS. ON REQUEST PULPS AND REJECTS WILL BE STORED FOR A MAXIMUM OF ONE YEAR.

ALL REPORTS ARE THE CONFIDENTIAL PROPERTY OF CLIENTS. PUBLICATION OF STATEMENTS, CONCLUSION OR EXTRACTS FROM OR REGARDING OUR REPORTS IS NOT PERMITTED WITHOUT OUR WRITTEN APPROVAL. ANY LIABILITY ATTACHED THERETO IS LIMITED TO THE FEE CHARGED.

*H. Staples*  
**H. Staples**

Cont'd ...

PROVINCIAL ASSAYER

**COPY**

Analytical and Consulting Chemists, Bulk Cargo Specialists, Surveyors, Inspectors, Samplers, Weighers

MEMBER American Society For Testing Materials • The American Oil Chemists' Society • Canadian Testing Association  
 REFEREE AND/OR OFFICIAL CHEMISTS FOR: Vancouver Merchants Exchange • National Institute Of Oilseed Products • The American Oil Chemists' Society  
 OFFICIAL WEIGHMASTERS FOR: Vancouver Board Of Trade • Vancouver Merchants Exchange



# GENERAL TESTING LABORATORIES

DIVISION: SUPERINTENDENCE COMPANY (CANADA) LTD.

1001 EAST PENDER STREET, VANCOUVER 6, B.C., CANADA  
 PHONE (604) 254-1647 TELEX 04-507514 CABLE SUPERVISE

TO:  
  
**RED RIVER MINES LTD.**

## CERTIFICATE OF ASSAY

No.: **7212-1951**      DATE: **22-12-72**

We hereby certify that the following are the results of assays on: **Geochemical Samples**

Page 5

MARKED	COPPER						SIGNATURE	
	(Cu) PPM						OZ/ST GR/MT	OZ/ST GR/MT
1400W 2000W	90							
1400W 2200W	43							
1400W 2400W	28							
1400W BLD	158							
1400W 200W	28							
1400W 280S	50							
1400W 400X	30							
1400W 400S	35							
1400W 600X	90							
1400W 600S	30							
1400W 800W	35							
1400W 1000W	30							
1400W 1200W	35							
1400W 1400W	33							
1400W 1600W	35							
1600W 2000W	30							
1600W 2200W	18							
1600W 2400W	15							
1800W BLD	73							
1800W 200X	33							
1800W 400X	45							
1800W 600X	55							
1800W 800X	38							
1800W 1000W (1)	25							
1800W 1000W (2)	33							
1800W 1200W	38							
1800W 1400W	23							
1800W 1800W	50							
1800W 2000W	48							
1800W 2200W	48							
1800W 2400W	25							
2000W 00W-V	35							
2000W 20W	43							
2000W 400X	45							
2000W 600X	50							

NOTE: REJECTS RETAINED ONE MONTH. PULPS RETAINED THREE MONTHS. ON REQUEST PULPS AND REJECTS WILL BE STORED FOR A MAXIMUM OF ONE YEAR.

ALL REPORTS ARE THE CONFIDENTIAL PROPERTY OF CLIENTS. PUBLICATION OF STATEMENTS, CONCLUSION OR EXTRACTS FROM OR REGARDING OUR REPORTS IS NOT PERMITTED WITHOUT OUR WRITTEN APPROVAL. ANY LIABILITY ATTACHED THERETO IS LIMITED TO THE FEE CHARGED.

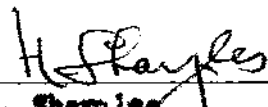
  
**H. Sharples**  
 PROVINCIAL ASSAYER

Cont'd ...

**COPY**

Analytical and Consulting Chemists, Bulk Cargo Specialists, Surveyors, Inspectors, Samplers, Weighers

MEMBER: American Society For Testing Materials • The American Oil Chemists' Society • Canadian Testing Association  
 REFEREE AND/OR OFFICIAL CHEMISTS FOR: Vancouver Merchants Exchange • National Institute Of Oilseed Products • The American Oil Chemists' Society  
 OFFICIAL WEIGHMASTERS FOR: Vancouver Board Of Trade • Vancouver Merchants Exchange



# GENERAL TESTING LABORATORIES

DIVISION: SUPERINTENDENCE COMPANY (CANADA) LTD.

1001 EAST PENDER STREET, VANCOUVER 6, B.C., CANADA  
 PHONE (604) 254-1647 TELEX 04-507514 CABLE SUPERVISE

TO:  
**RED RIVER MINES LTD.**

## CERTIFICATE OF ASSAY

No.: **7212-1951** DATE: **22-12-72**

We hereby certify that the following are the results of assays on: **Geochemical Samples**

Page 6

MARKED	COPPER							
	(%) PPM						OZ/ST GR/MT	OZ/ST GR/MT
1000W 800N1	43							
2000W 1000N	38							
2000W 1200N	23							
2000W 1400N	18							
1000W 1600N	30							
2000W 1800N	36							
1000W 2000N	35							
1000W 2400N	23							
<b>Decomposition:</b>		<b>HOT HNO<sub>3</sub>, HClO<sub>4</sub></b>						
<b>Procedure:</b>		<b>A.A.</b>						

NOTE: REJECTS RETAINED ONE MONTH. PULPS RETAINED THREE MONTHS. ON REQUEST PULPS AND REJECTS WILL BE STORED FOR A MAXIMUM OF ONE YEAR.

ALL REPORTS ARE THE CONFIDENTIAL PROPERTY OF CLIENTS. PUBLICATION OF STATEMENTS, CONCLUSION OR EXTRACTS FROM OR REGARDING OUR REPORTS IS NOT PERMITTED WITHOUT OUR WRITTEN APPROVAL. ANY LIABILITY ATTACHED THERETO IS LIMITED TO THE FEE CHARGED.

*H. Sharples*  
**H. Sharples** PROVINCIAL ASSAYER

**COPY** HS/ak

Analytical and Consulting Chemists, Bulk Cargo Specialists, Surveyors, Inspectors, Samplers, Weighers

MEMBER: American Society For Testing Materials • The American Oil Chemists' Society • Canadian Testing Association  
 REFEREE AND/OR OFFICIAL CHEMISTS FOR: Vancouver Merchants Exchange • National Institute Of Oilseed Products • The American Oil Chemists' Society  
 OFFICIAL WEIGHMASTERS FOR: Vancouver Board Of Trade • Vancouver Merchants Exchange

TO WEST 1/2 SEE MAP 92.1/3E

Waterfall Cr.

1 R 8

514750	514760	514650	514630
R12 13	R12	R12	R12
514730	514740	514630	514630
R12 11	R12 12	R12	R12
514710	514720	514610	514610
R12 9	R12 10	R12	R12 9
514690	514700		
R12 7	R12 8		

# 4106

# M-1

RED RIVER MINES LTD (NPL)

HAWK MINERAL CLAIMS

To accompany report of 12/72  
Soil Sample Program

2/73

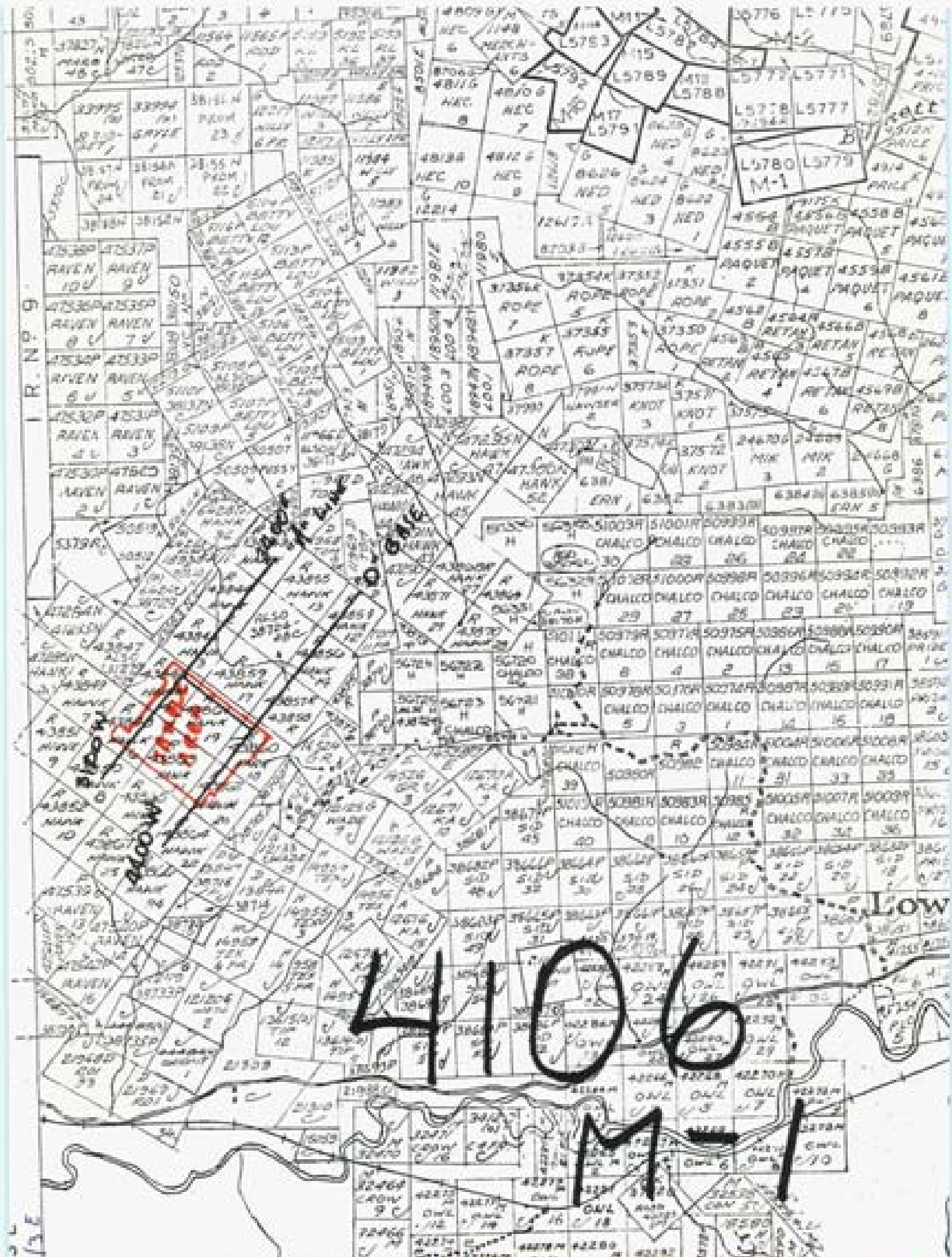
514750	514760	514650	514630
R12 13	R12	R12	R12
514730	514740	514630	514630
R12 11	R12 12	R12	R12
514710	514720	514610	514610
R12 9	R12 10	R12	R12 9
514690	514700		
R12 7	R12 8		

This map is prepared to serve as a guide only.  
Positions of unsurveyed claims and paper leases  
are plotted from locators' sketches  
and are not guaranteed.

Letters C.G. indicate claim is Crown-Granted.  
Symbol "C" indicates claim has forfeited.

**B. C. DEPARTMENT OF MINES AND  
PETROLEUM RESOURCES**

W-1  
4109

Department of  
Mines and Petroleum Resources  
ASSESSMENT REPORT  
NO. 4106 MAP #1

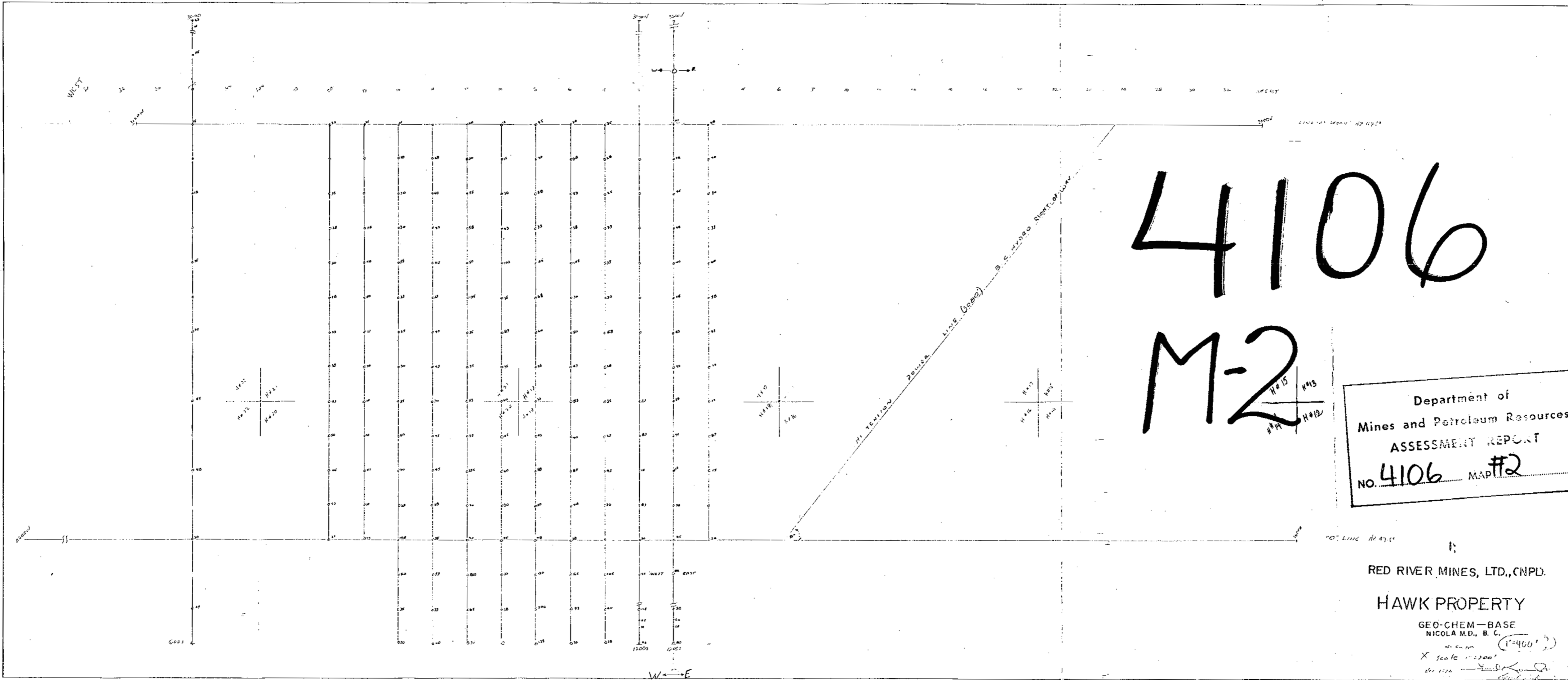

4106  
M-2

Department of  
Mines and Petroleum Resources  
ASSESSMENT REPORT  
NO. 4106 MAP #2

RED RIVER MINES, LTD., (CNPL)

HAWK PROPERTY

GEO-CHEM-BASE  
NICOLA M.D., B. C.

Scale 1:2500  
Date 1974  
Author [Signature]