

4153

GEOCHEMICAL REPORT
CAT CLAIMS, BRANDYWINE, B.C.
50°123°

FOR
NORTHAIR MINES LTD. (N.P.L.)
BY

J. W. HOGAN, B.A.Sc., P.Eng.
September 23-October 13, 1972.

92J/3E

Department of
Mines and Petroleum Resources
ASSESSMENT REPORT

NO. 4153 M.P. _____

L. J. Manning & Associates Ltd.
310 - 890 West Pender Street
Vancouver 1, B.C.

December 28, 1972.

TABLE OF CONTENTS

	<u>Page</u>
Introduction	1
General Geology & Topography	1
Sampled Soil Horizon	1
Sampling Procedure	1
Sample Preparation and Laboratory Analysis	1
Summary and Conclusions	1
#1 Drawing No. 1 - Location of Lines with respect to Claim Boundaries and Copper Geochemical Plan - Scale 1" = 400'	In Pocket
#2 Drawing No. 2 - Silver Geochemical Plan - Scale 1" = 400'	In Pocket
#3 Drawing No. 3 - Lead Geochemical Plan - Scale 1" = 400'	In Pocket
#4 Drawing No. 4 - Zinc Geochemical Plane - Scale 1" = 400'	In Pocket
#5 Location map	

L. J. MANNING & ASSOCIATES LTD.

CONSULTING MINING AND GEOLOGICAL ENGINEERS

610-890 WEST PENDER STREET VANCOUVER 1, B.C.

OFFICE PHONE:
683-5861

RESIDENTIAL PHONE:
L. J. MANNING - 985-5690

INTRODUCTION

The following report is on a geochemical soil survey over the Cat Claims, Brandywine, B.C.

GENERAL GEOLOGY AND TOPOGRAPHY

The area is not mapped but geological work immediately to the east shows andesitic rocks.

Steep slopes predominate.

SAMPLED SOIL HORIZON

Soils were taken from the "B" Horizon at depths of from 6" - 10" below surface.

SAMPLING PROCEDURE

Samples were taken on a line grid basis. This grid was at a 400' line interval on 200' stations. A shovel was used to reach the "B" Horizon where a 30-40 gram sample was placed in standard 4" x 9" soil sample envelopes. Samples were not taken where swampy ground was located, arising in excessive depth to the "B" Horizon.

Samples were partially air-dried and then shipped to Crest Laboratories, Vancouver, and Vancouver Geochemical Laboratories, North Vancouver.

SAMPLE PREPARATION AND LABORATORY ANALYSIS

Crest Laboratories and Vancouver Geochemical Laboratories treated the samples in the following manner:

- Drying
- Sieve to -80 mesh fraction
- Hot extraction by HClO_4 and HNO_3
- Atomic absorption analysis for copper, silver, lead and zinc in parts per million.

SUMMARY AND CONCLUSIONS

Crest Laboratories

Background for copper was determined to be 29 p.p.m. with threshold taken at 2 x B.G. or 56 p.p.m.

Background for silver was determined to be 1.9 p.p.m. with threshold taken as 2 x B.G. or 3.8 p.p.m.

Background for lead was determined to be 33 p.p.m. with threshold taken as 2 x B.G. or 66 p.p.m.

Background for zind was determined to be 43 p.p.m. with threshold taken as 2 x B.G. or 86 p.p.m.

Vancouver Geochemical Laboratories

Background for copper was determined to be 16 p.p.m. with threshold taken as 2 x B.G. or 32 p.p.m.

Background for silver was determined to be 1.0 p.p.m. with threshold taken as 2 x B.G. or 2.0 p.p.m.

Background for lead was determined to be 15 p.p.m. with threshold taken as 2 x B.G. or 30 p.p.m.

Background for zinc was determined to be 39 p.p.m. with threshold taken as 2 x B.G. or 78 p.p.m.

Anomalous Areas

Copper - a general anomalous 900' x 900' area is centered at 4E - 6W but contains several internal low values.

A weakly anomalous east-west trend occurs through 32E - 14S.

A weakly anomalous north-west trend occurs along Callaghan Creek Road from 28E - 36E (possible contamination).

Silver - Three anomalous silver values occur on line 4E from 12N - 16N.

Lead - No anomalous zones.

Zinc - No anomalous zones.

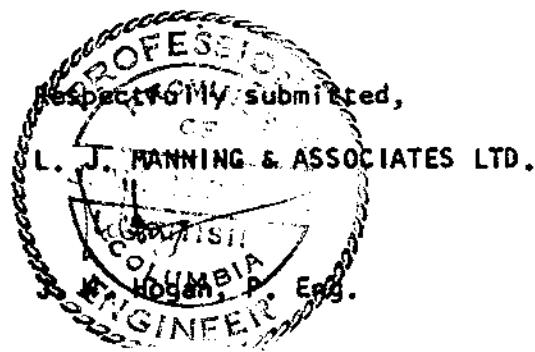

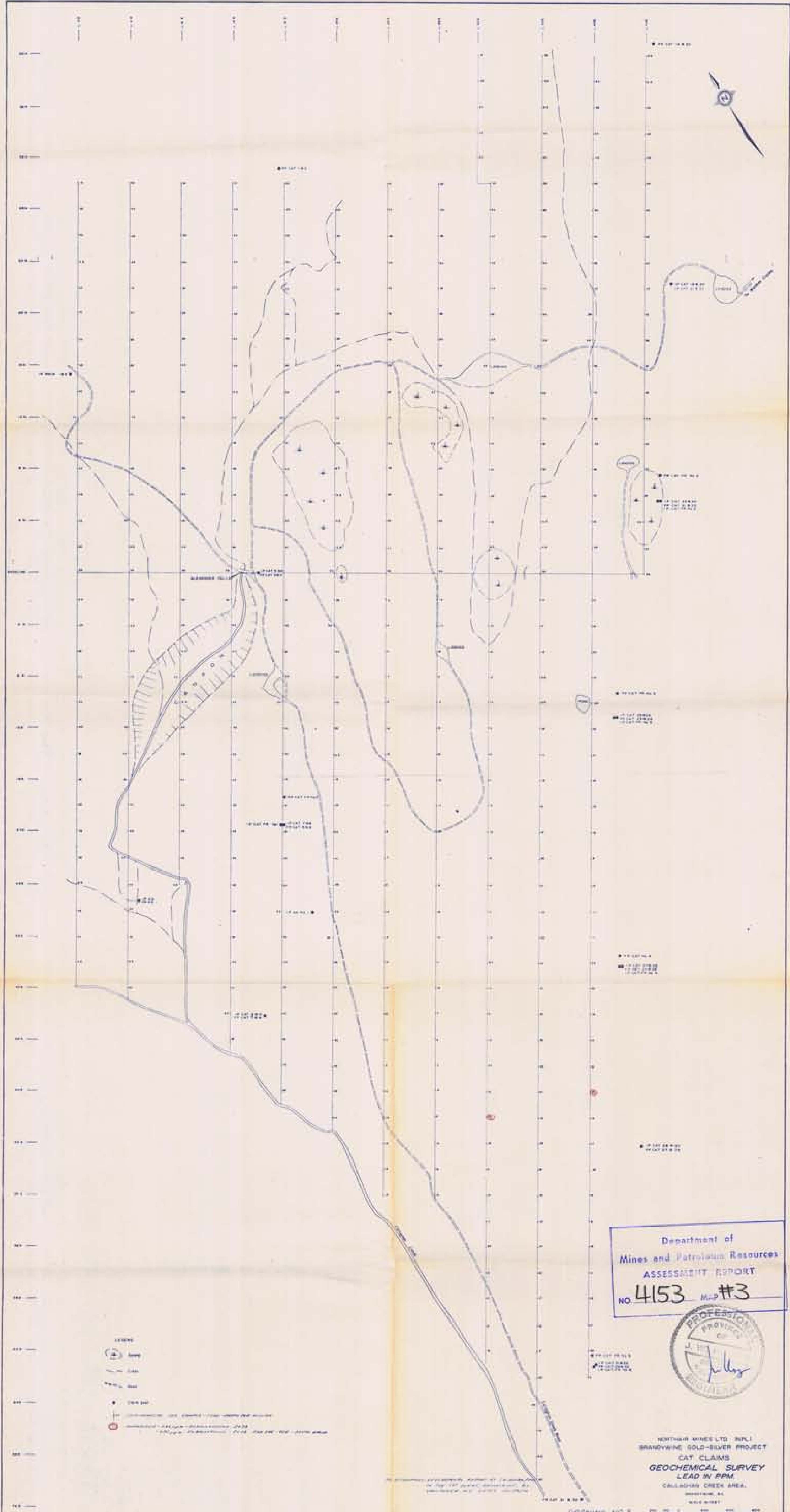

Department of
Mines and Petroleum Resources
ASSESSMENT REPORT
NO 4153 MAP #3



NORTHAM MINES LTD. NPL
BRANDYNE GOLD-SILVER PROJECT
CAT CLAIMS
GEOCHEMICAL SURVEY
LEAD IN PPM
CALLAGHAN CREEK AREA
ONTARIO, CAN.
SCALE 1:50,000

DRAWING NO. 3

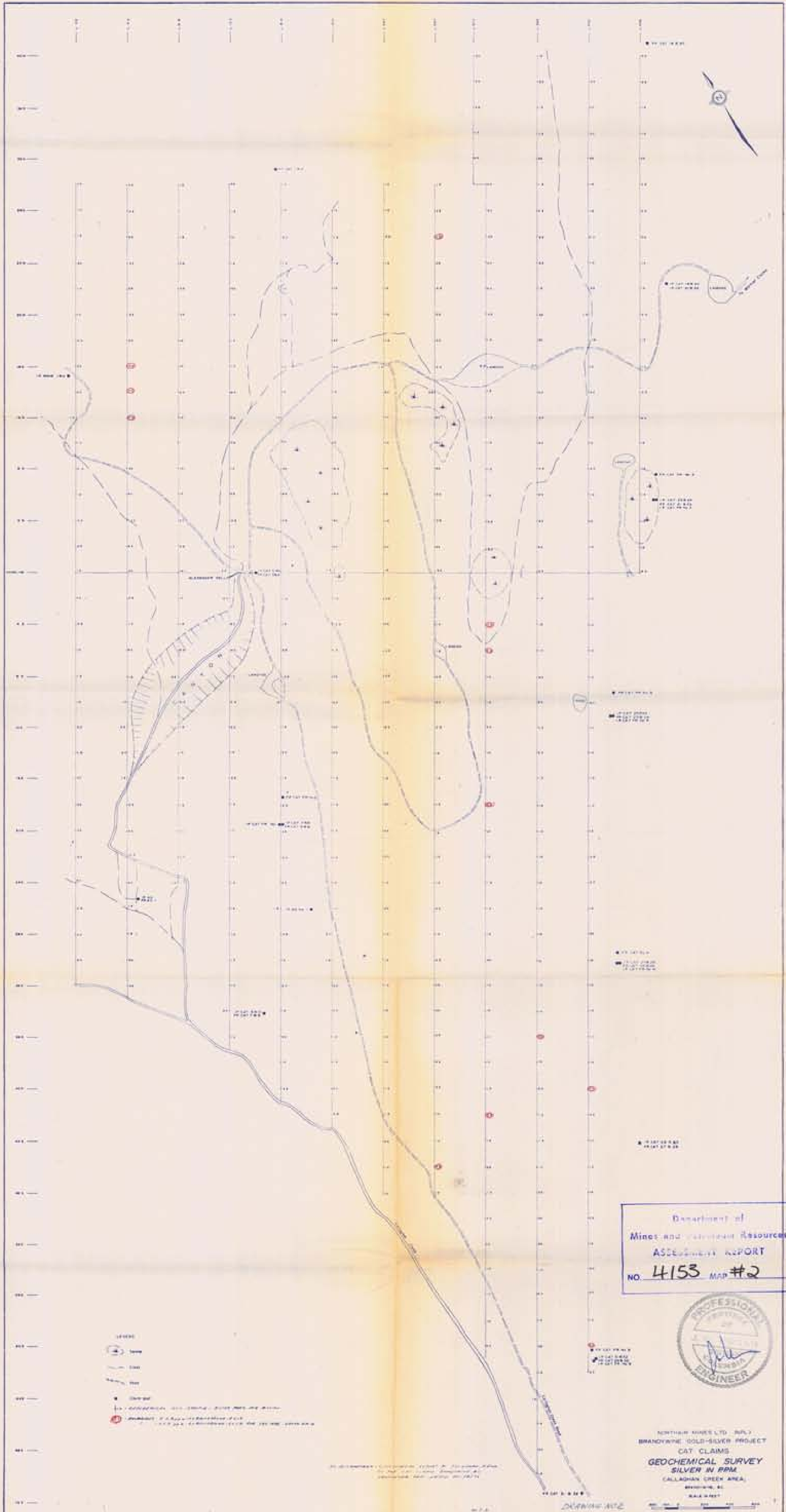

Department of
 Mines and Technical Resources
 ASSESSMENT REPORT
 NO. 4153 MAP #2

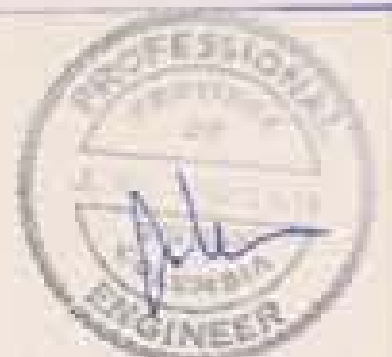

NORTHERN MINES LTD. - 50%
 BRANDYWINE GOLD-SILVER PROJECT
 CAT CLAIMS
GEOCHEMICAL SURVEY
 SILVER IN PPM
 CALLAGHAN CREEK AREA,
 BRANDYWINE, BC
 844-8887

- 10000
- 5000
- 1000
- 500
- 200
- 100
- 50
- 20
- 10
- 5
- 2
- 1
- 0.5
- 0.2
- 0.1
- 0.05
- 0.02
- 0.01
- 0.005
- 0.002
- 0.001
- 0.0005
- 0.0002
- 0.0001
- 0.00005
- 0.00002
- 0.00001
- 0.000005
- 0.000002
- 0.000001
- 0.0000005
- 0.0000002
- 0.0000001
- 0.00000005
- 0.00000002
- 0.00000001
- 0.000000005
- 0.000000002
- 0.000000001
- 0.0000000005
- 0.0000000002
- 0.0000000001

ASSESSMENT REPORT NO. 4153 MAP #2
 GEOCHEMICAL SURVEY
 SILVER IN PPM
 CALLAGHAN CREEK AREA,
 BRANDYWINE, BC
 844-8887

APPROXIMATE LOCATION OF "CAT"
CAMP

Department of
Mines and Geological Resources
ALICE SPRING DISTRICT
NO. 4153 #5

ALEXANDER FALLS

A I N S

