

# 4260

GEOLOGICAL REPORT

ON

SILVER MINERAL CLAIMS  
DEER LAKE AREA  
KAMLOOPS MINING DIVISION, B.C.

Latitude: 51° 32' 30" N

Longitude: 120° 22' 30" W

Map Sheet: 92P/9W

Department of  
Mines and Petroleum Resources  
ASSESSMENT REPORT  
NO. 4260 MAP \_\_\_\_\_ BY \_\_\_\_\_



JAMES S. DODGE, P.ENG.

OCTOBER 1, 1972 - APRIL 9, 1973

TABLE OF CONTENTS

	<u>Page No.</u>
LIST OF CLAIMS . . . . .	1
INTRODUCTION . . . . .	2
LOCATION AND ACCESS . . . . .	2
SURVEY TECHNIQUES . . . . .	3
GEOLOGY . . . . .	4
APPENDIX I - SUMMARY OF COSTS . . . . .	6
APPENDIX II - STATUTORY DECLARATION . . . . .	7
APPENDIX III - STATEMENT OF QUALIFICATIONS . . . . .	8

MAP

#1 GEOLOGIC RECONNAISSANCE MAP SILVER GROUP (Pocket)

LIST OF CLAIMS

<u>Claim Numbers</u>	<u>Grant Numbers</u>	<u>Mining Division</u>	<u>Date Recorded</u>
SILVER 18	54751	Kamloops	April 13, 1966
SILVER 19	54752	Kamloops	April 13, 1966
SILVER 21	54754	Kamloops	April 13, 1966
SILVER 24-26	54757 - 54759	Kamloops	April 13, 1966
SILVER 41-44	54774 - 54777	Kamloops	April 13, 1966

## INTRODUCTION

During October 1 - 7, 1972 and March 25 - April 9, 1973, James S. Dodge, Professional Engineer (B.C.) conducted a program of reconnaissance geological mapping for United Copper Corporation Limited on the Silver mineral claims Numbers 18, 19, 21, 24, 25, 26, 41, 42, 43, and 44 situated in the Deer Lake - Silver Lake area of the Kamloops Mining District.

The purpose of this investigation was (1) to determine if, in fact, sufficient outcrops were indicated in the area to justify a program of detailed grid geologic mapping, and (2) to evaluate critically the geochemical survey completed on the claims several years ago.

## LOCATION AND ACCESS

The Silver Claims are centered approximately at latitude  $51^{\circ} 32' 30''$  N and longitude  $120^{\circ} 22' 30''$  W in the Kamloops Mining District on the Clearwater Map Sheet 92P/9W. The claims lie north and northeast of Deer Lake at the headwaters of Nehalliston Creek at altitudes ranging 4,500 - 4,600 feet. The area is characterized by low rolling hills moderately to densely forested with fir.

Access to Deer Lake is by pickup truck on 9 1/2 miles of good gravel road branching from Mile 11 on the Little Fort - 100 Mile House road along Eakin Creek. This new gravel road climbs steeply up the north side of the valley from a point 1/10 mile beyond the old road, and is marked "Rock Island Lakes 13 Miles". The total distance to the claims from Kamloops is 70 miles. Between Deer Lake and Silver Lake, one mile to the north, the unimproved road crosses Silver Claims 18 and 19.

#### SURVEY TECHNIQUES

Two-man fly camp was established at the end of a drill access road 1/2-mile east of the south end of Deer Lake and a few thousand feet south of the claim group boundary. Access to the eastern claims was on foot from this camp, while those to the north were traversed from the road between Deer and Silver Lakes. Previously cut lines on 400-foot intervals, trending NE-SW parallel to claim end-lines, were used a locator reference in the geological reconnaissance of the areas of higher relief.

Although Bold cliff-forming outcrops were not observed in the rolling terrain, glacial till cover on many slopes was thin or virtually absent. Numerous sites comprise rough, fragmented material which was substantiated by shallow digging as being creep debris from sub-crops. This feature was further corroborated in

in detailed examinations of road excavations between Deer and Silver Lakes, and from bulldozer trenching west and southeast of Deer Lake. Nevertheless, rounded glacial till does cover certain areas with perhaps up to 15 feet of unsorted boulders, gravels, and silts, some with bedrock types unreported in the immediate area, e.g., monzonite porphyry and amygdaloidal basalt.

### GEOLOGY

The Silver Claims 18, 19, 21, 24, 25, 26, 41, 42, 43, and 44 are underlain by a pile of andesitic volcanics of apparent Nicola (Triassic) age which, in places, have been metasomatically monzonitized and syenitized with the development of hybrid rocks transitional between andesite and typical monzonite and syenite. No dike rocks or intrusive plutonic bodies were noted in this reconnaissance.

The volcanics comprise andesite flows, porphyritic augite andesite, andesite agglomerate with fragments of augite porphyry and non-porphyritic flows, hybrid andesite-monzonite and hybrid andesite-syenite. Owing to the scattered nature of outcrops revealed in the reconnaissance mapping and because of the common short-distance change in rock types, presentation of a lithologic section of structural interpretation of the volcanics is premature.

Of particular interest is the abundance of pyrite and pyrrhotite, especially in the hybrid monzonites which often assume a bleached appearance and are conspicuous by the development of magnetite and specularite. This pyritization appears to be secondary to a broad scale greenschist facies metamorphism of the andesites expressed in chloritization of biotite, augite, and feldspars.

On the accompanying geologic sketch map are shown the outcrop localities examined during this reconnaissance. Projecting these results, it is anticipated that detailed geologic mapping will provide substantially more information on lithology and possible hydrothermal alteration and pyritization halo definition. Sericitization was noted in one outcrop approximately 1/2 mile east of Deer Lake and it is recommended that in future detailed mapping that a petrographic study be made of a suite of samples to examine the hydrothermal alteration zoning characteristics of the area.

Although earlier workers have indicated a rather low reliability factor in geochemical soil sampling here, it is my observation from existing bulldozer cuts that in most areas on the claims the soils should reflect bedrock geochemical anomalies providing the proper sampling and analytical techniques are followed, as recommended in an orientation program by a consulting geochemist. It would appear that further, perhaps duplicatory, soil sampling is prudent.

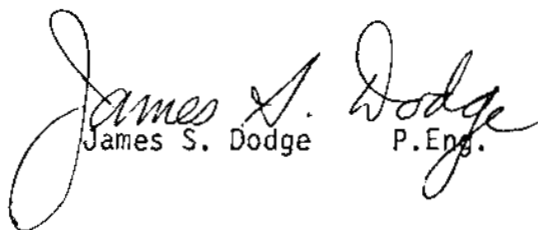
  
James S. Dodge P. Eng.

APPENDIX ISUMMARY OF COSTS

## Wages &amp; Fees (October 1, 1972 - April 9, 1973)

James S. Dodge, P.Eng.			
October 3 - 7, 1972	2 days @ \$150/day		\$300.00
April 6 - 9, 1973	2 1/4 days @ \$150/day		325.00
Arnold C. Racicot, Prospector			
April 6 - 9, 1973	4 days @ \$50/day		200.00

## Transportation and Subsistence

4-wheel drive Truck	620 miles @ 18¢/mile		111.00
Camp food	7 man-days @ \$7/each		49.00

Office - secretarial, report materials, photocopying			<u>35.00</u>
--	--	--	--------------

GRAND TOTAL . . . . .			<u><u>\$1,020.00</u></u>
-----------------------	--	--	--------------------------



APPENDIX II

DOMINION OF CANADA:  
PROVINCE OF BRITISH COLUMBIA.  
To Wit:

In the Matter of

costs incurred in carrying out geological mapping on the SILVER MINERAL CLAIMS,

I, James S. Dodge

of #304, 1035 West Pender Street, Vancouver 1, B.C.

in the Province of British Columbia, do solemnly declare that

to the best of my knowledge and belief the Summary of Costs as presented in Appendix I of this report, "Geological Report on the SILVER Mineral Claims", is both true and correct.

And I make this solemn declaration conscientiously believing it to be true, and knowing that it is of the same force and effect as if made under oath and by virtue of the "Canada Evidence Act."

Declared before me at the City  
Kamloops  
of ~~Vancouver~~ JSD, in the  
Province of British Columbia, this B.C.,  
day of June, A.D.

James S. Dodge

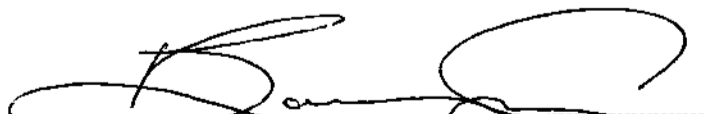
  
A Commissioner for taking Affidavits for British Columbia or  
A Notary Public in and for the Province of British Columbia.  
A Commissioner for taking affidavits  
within British Columbia.

APPENDIX III

STATEMENT OF QUALIFICATIONS

1. I am a minerals exploration consultant residing at 392 Royalmore Avenue, Richmond, British Columbia with offices at 1035 West Pender Street, Vancouver, British Columbia and Red Mountain, Aspen, Colorado, U.S.A.
2. I graduated as a mining engineer from Missouri School of Mines, B.S., 1941; received the degree of Master of Science in economic geology from Stanford University, 1951; and attended Albert-Ludwigs University, Freiburg, Germany during 1952.
3. I am a certified member of the Association of Professional Engineers of British Columbia, and am a registered professional engineer in the State of Colorado. I am a member of the Society of Economic Geologists.
4. I am the author of this entire report.
5. I carried out the geological mapping performed on the Silver Claims Nos. 18, 19, 21, 24, 25, 26, 41, 42, 43, and 44.

June 8, 1973.

Signed: \_\_\_\_\_

*James S. Dodge*

James S. Dodge

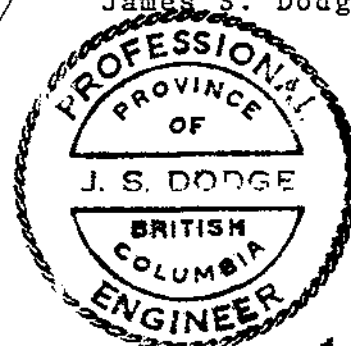

Expiry Date: August 4, 1978

4260 M-1

Department of  
Mines and Petroleum Resources  
ASSESSMENT REPORT  
NO. 4260 MAP #1

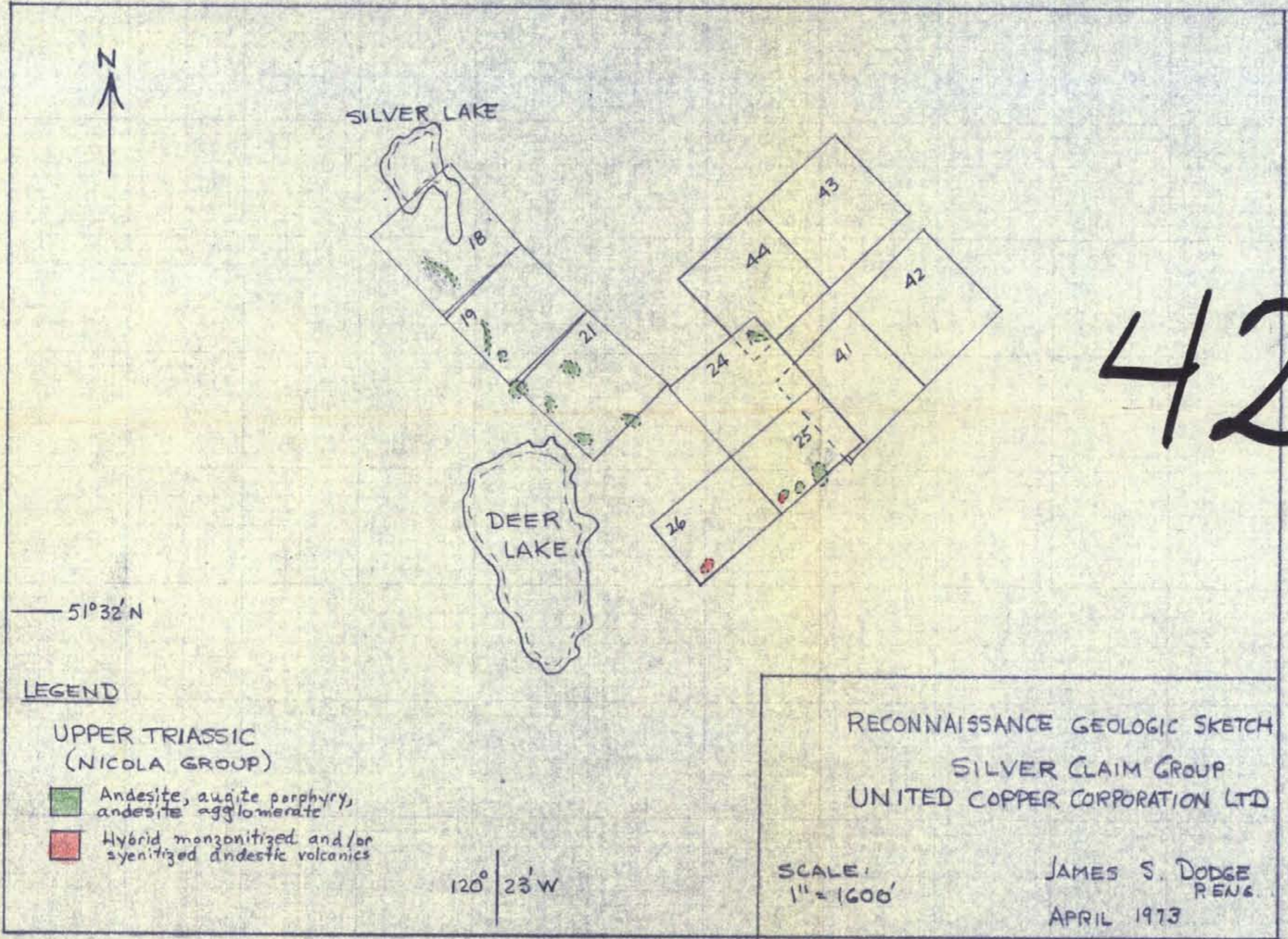

James S. Dodge