

92I/16E

LINE CUTTING REPORT

EVE, NAN MINERAL CLAIMS

WESTERN CANADA STEEL LTD.

KAMLOOPS MINING DIVISION

OWNER: WESTERN CANADA STEEL LTD.

WORK DONE: May 21-26/73

4418

Nan 2.

| | |
|-------------------------------|--------|
| Department of | |
| Mines and Petroleum Resources | |
| ASSESSMENT REPORT | |
| NO. 4418 | MAP #2 |

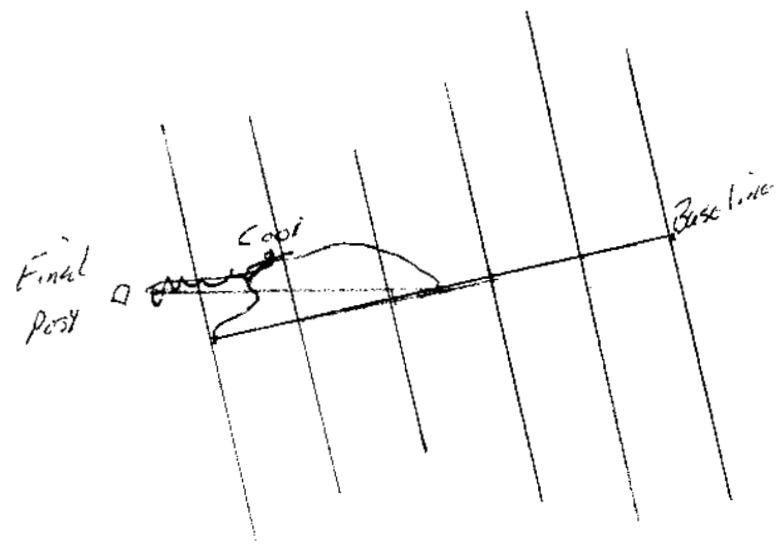

Initial Post r

May 25/73
G. B. Kelly

Nan 1.

[Handwritten signature]

EVC #5

EVC #3

Department of
Mines and Petroleum Resources
ASSESSMENT REPORT
NO. **4418** MAP **#3**

Baseline
Location here

EVC #6

EVC #9

Mar 28 / 73
J. G. Hur

~~Handwritten scribble~~

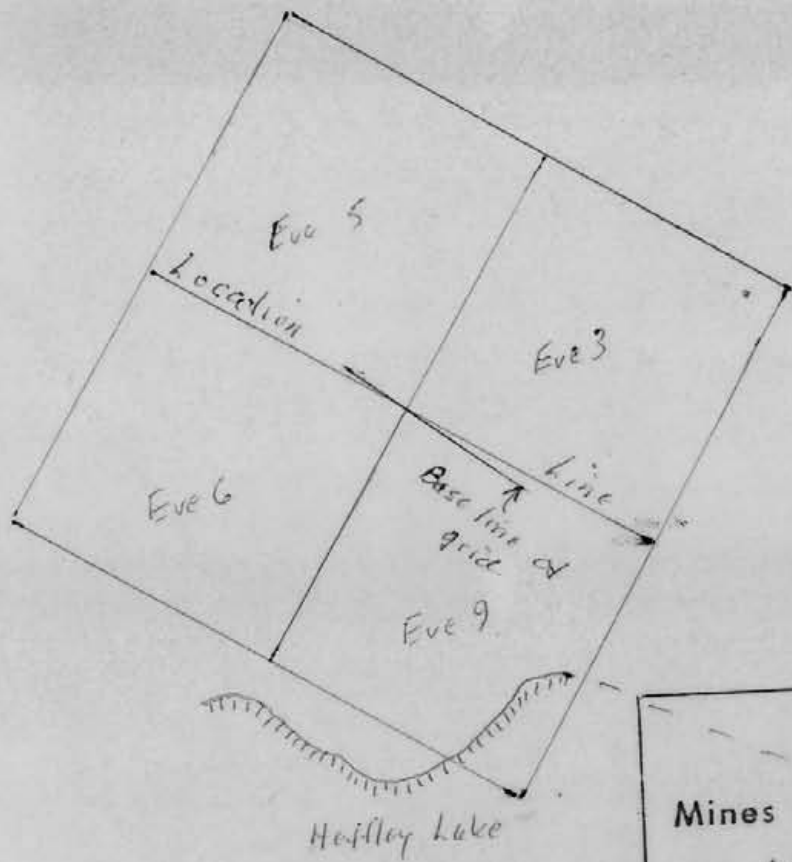

To accompany line cutting
report by J.M. Black P.Eng

1" = 1000 feet

Department of
Mines and Petroleum Resources
ASSESSMENT REPORT
NO. **4418** MAP **#1**

