

4434

92P/8E

LINE CUTTING REPORT

KAMLOOPS MINING DIVISION

BAR MINERAL CLAIMS

WORK DONE: April 4-21, 1973

PRINCIPAL: HIGHLAND LODE MINES LTD. (NPL)

Author: J.P. Elwell, P. Eng.

JAMES P. ELWELL, P.ENG.
CONSULTING MINING ENGINEER

PHONE: 682-2120
RES: 922-2551

222
X929 - 510 W. HASTINGS ST.
VANCOUVER 2, B.C.

Highland Lode Mines Ltd., N.P.L.
728 - 510 W. Hastings St.,
Vancouver 2, B.C.

Department of
Mines and Petroleum Resources
ASSESSMENT REPORT
NO. 4434 M.P.

April 24, 1973



Re: Line Cutting, BAR claims
Kamloops Min. Div. B.C.

Dear Sirs:

On April 21st 1973, in company with Mr. W. McLelland, I inspected the line cutting which had recently been completed on the BAR claim group in the Barriere area of the Kamloops Mining Division of B.C.

The base line has been run from the Initial Post of the BAR #35 and #36 south down the location line for a total distance of 9,600 feet. In the section of line inspected, it was found to run on a bearing of 180° (true). The line is well blazed and flagged with stations at 300 foot intervals. In order not to contravene Forestry Dept. regulations, the cutting of trees has been held to the bare minimum, also, as there was four to five feet of snow on the property at the time of the line cutting, there has been little slashing of underbrush to clear the line of sight. Once the snow has gone from the property, it may be necessary to slash the brush and lower tree limbs in order to provide a clear line of sight between stations.

The cross lines are cut at the 300 foot station intervals on the base line and are reported to run the width of the claim group, that is, 1,500 feet to the east and 4,500 feet to the west. Sections of eight different lines were checked. All were found to be run on a magnetic east-west bearing with stations marked at 100 foot intervals with flagging, and the station number inscribed on a picket or blaze. As with the base line, line cutting has been held to the minimum, but there should be no trouble following the blazes and flagging from station to station while carrying out the magnetometer and geochemical survey.

In general, I consider the lines inspected to be competently done considering the ground conditions at the time, and will be quite adequate for the purpose for which they are intended.

Yours very truly,

J.P. ELWELL, P. ENG.

C E R T I F I C A T E



I, JAMES PAUL ELWELL, of 4744 Caulfield Drive, WEST VANCOUVER, B.C., do hereby certify that:

1. I am a Consulting Mining Engineer residing at 4744 Caulfield Drive, West Vancouver, B.C., and with an office at 222-510 West Hastings Street, Vancouver 2, B.C.
2. I am a graduate in Mining Engineering from the University of Alberta in 1940, and am a Registered Professional Engineer in the Province of British Columbia.
3. I have no interest directly or indirectly in the property or securities of Highland Lode Mines Ltd., N.P.L., nor do I expect to receive directly or indirectly any interest in such property or securities.
4. The findings in the report are the result of personal examinations of the property made by me April 21st 1973.

DATED AT VANCOUVER, B.C. this 24th day of April 1973.

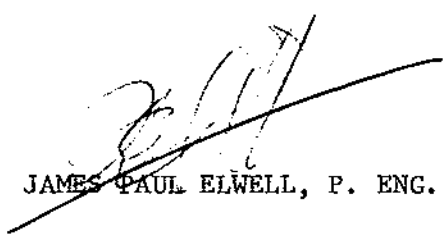
JAMES PAUL ELWELL, P. ENG.

Department of Mines and Petroleum Resources	
ASSESSMENT REPORT	
NO. 4434	M.P.

HIGHLAND LOBE MINES LTD. Mines and Petroleum Resources
DIAGRAM OF LINES CUT ON
BAR GROUP OF CLAIMS
KAMLOOPS MINING DIVISION
KAMLOOPS B.C.

ASSESSMENT REPORT

NO. 4434 MAP #1

TAC NO - 5-24-339105M - 339124M
TAC NO - 24-48-339129M - 339148M

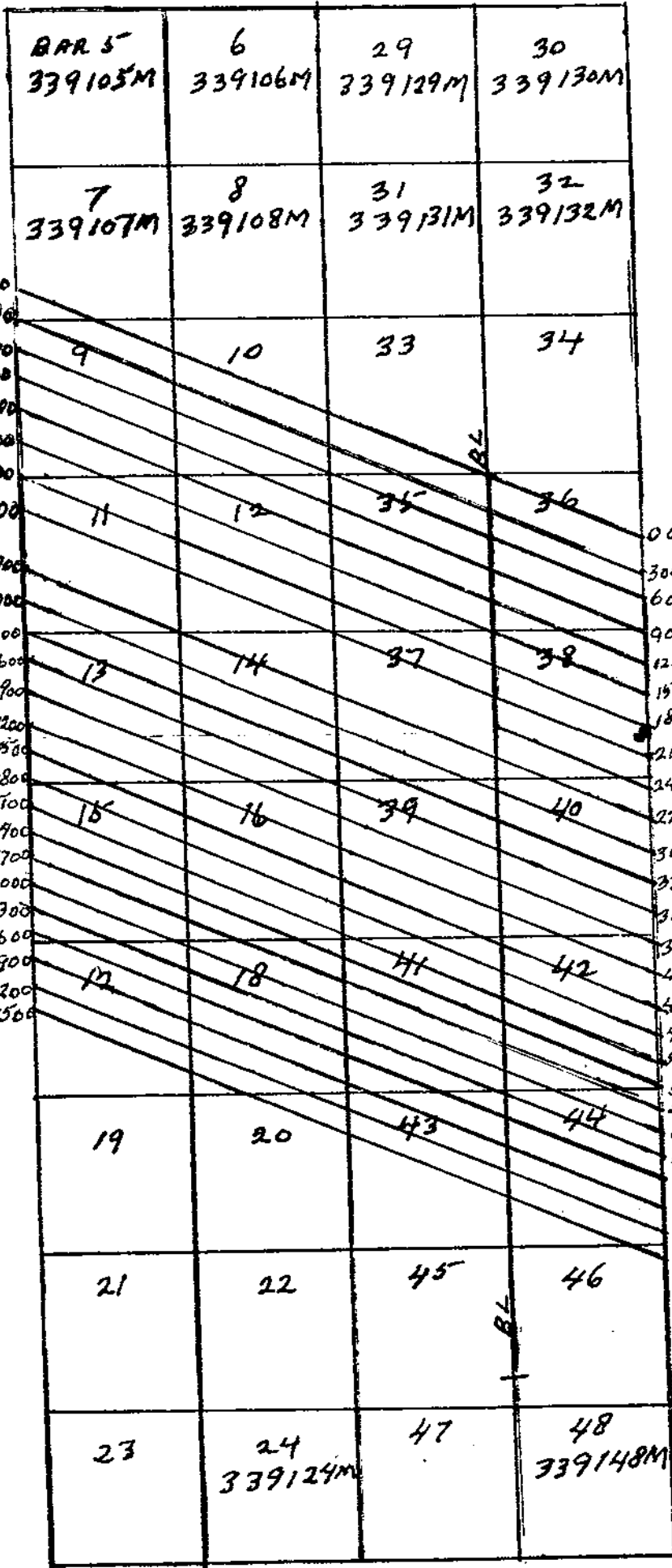

CROSS LINES CUT
APP 67° TO
BASE LINE
BASE LINE 180°
SCALE 1500 FT 1 INCH

00-E
300-E
600-E
900-E
1200-E
1500-E
1800-E
2100-E
2400-E
2700-E
3000-E
3300-E
3600-E
3900-E
4200-E
4500-E
4800-E
5100-E
5400-E
5700-E
6000-E
6300-E
6600-E
6900-E
7200-E
7500-E

4434

W.A.M.