

4470

92H/5W

LINE CUTTING REPORT

LUV MINERAL CLAIMS

NEW WEST. MINING DIVISION

WORK DONE: 1973

OWNER: AARON MINING LTD.

PARTIAL GRID MAP WEAVER LAKE PROPERTY

LLOYD STONEHOCKER	FEB 18TH	MARCH 3RD	15 DAYS
RODIE PICK	FEB 18TH - FEB 24TH		6 DAYS
DAVID TOMP	FEB 25TH	MARCH	6 DAYS
W.S. ASHE	FEB 25TH	MARCH 3RD	3 DAYS
W ASHE	FEB 25TH	MARCH 31	3 DAYS

Declared before me at the City of Victoria TOTAL number of days 30 DAYS

of Vancouver, in the City of Victoria
 Province of British Columbia, this 29
 day of June 1973, A.D.



John Turner
 A Commissioner for Taking Affidavits within British C.
 A Notary Public in and for the Province of British C.
 Submitting Recorder

SCALE 16" = 1 INCH

APPROX. GROUP 1500 W 112 W

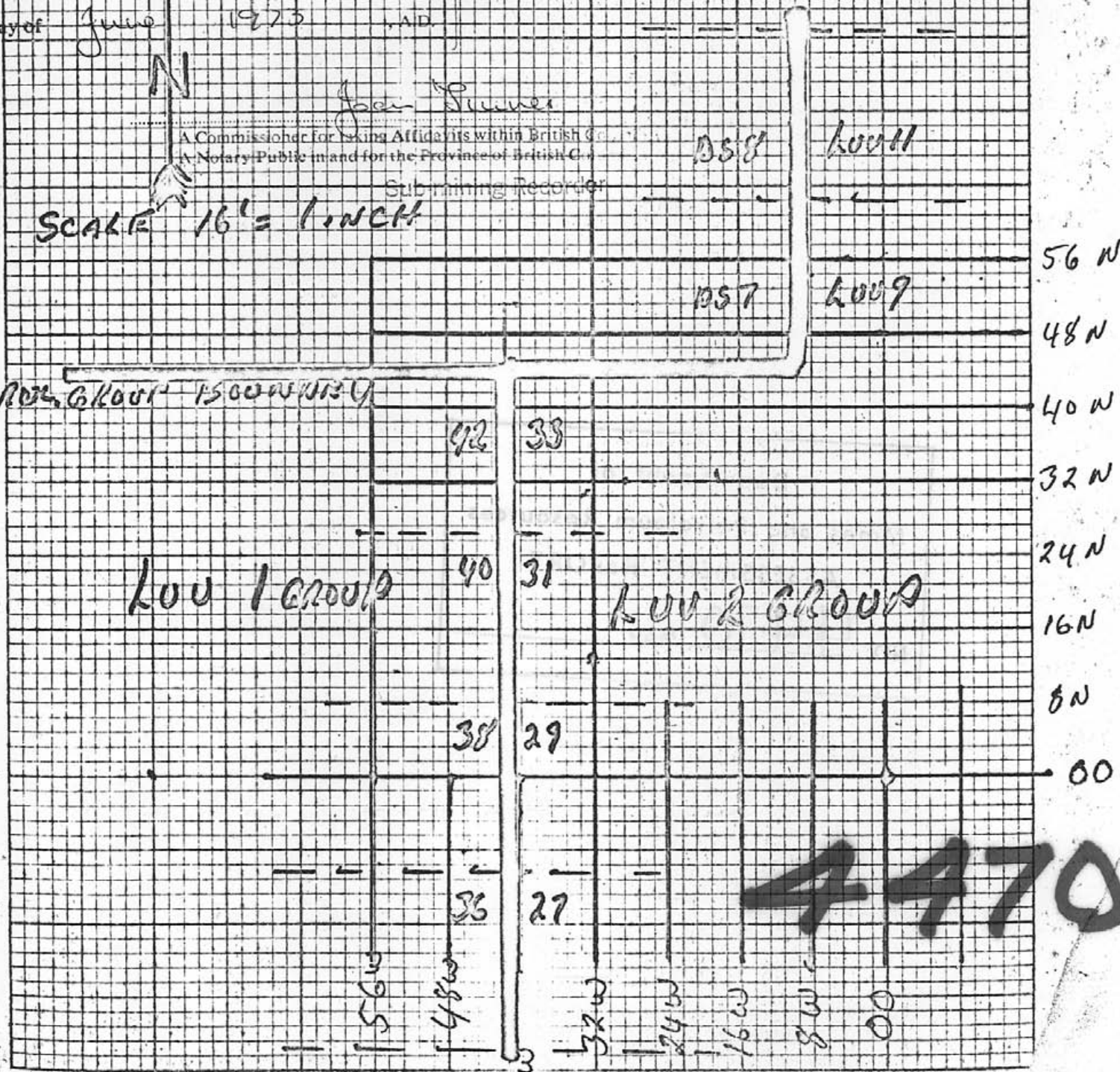

4470

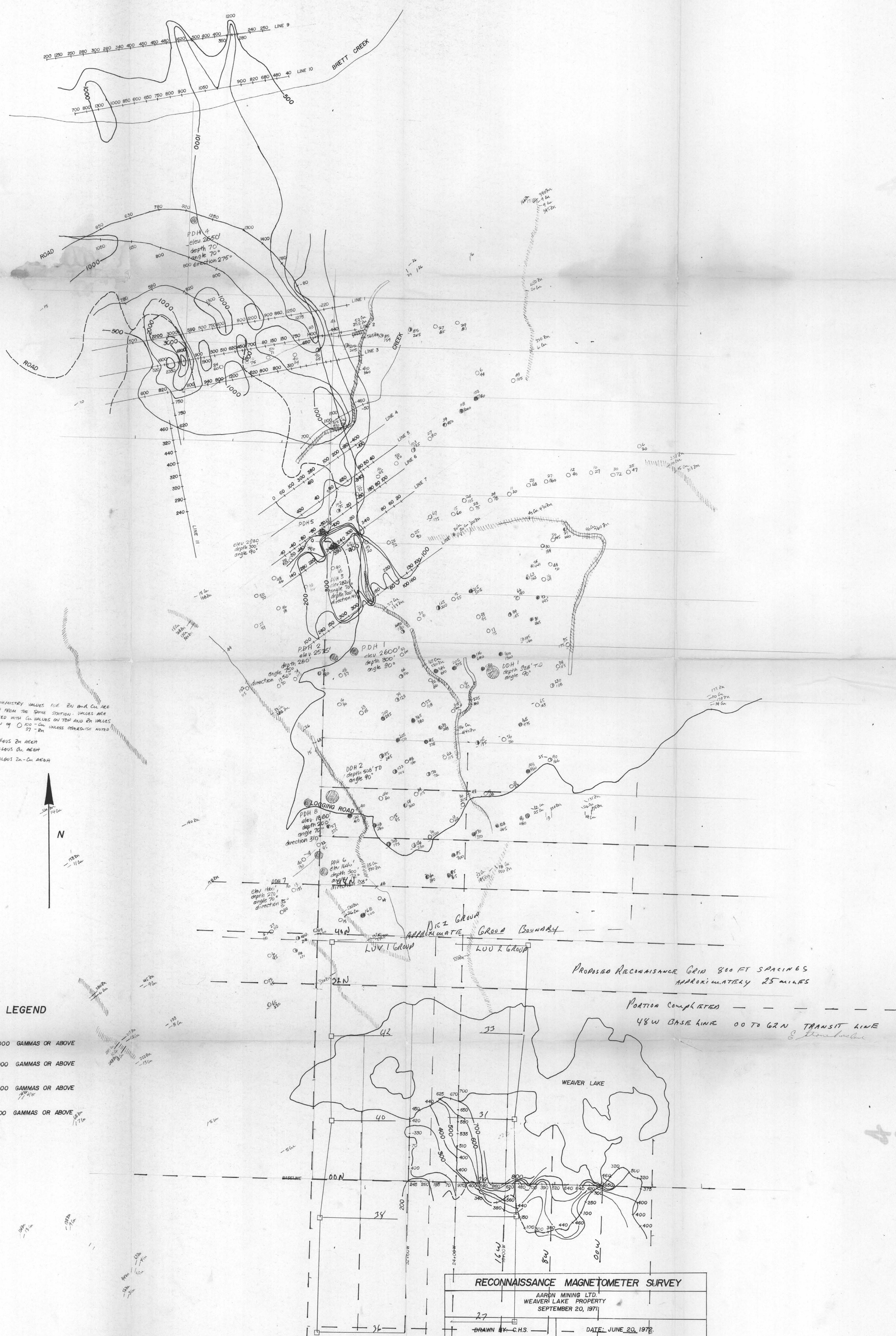

NOTE: GEOCHEMISTRY VALUES FOR ZN AND CU ARE TAKEN FROM THE SAME STATION. VALUES ARE PLOTTED WITH Cu VALUES ON TOP AND ZN VALUES BELOW BY O 37 - Zn UNLESS OTHERWISE NOTED

[Symbol] - ANOMALOUS Zn AREA
 [Symbol] - ANOMALOUS Cu AREA
 [Symbol] - ANOMALOUS Zn-Cu AREA

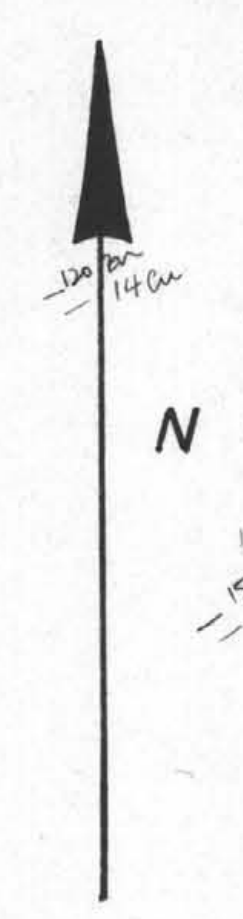

- LEGEND**
- [Symbol] 3000 GAMMAS OR ABOVE
 - [Symbol] 2000 GAMMAS OR ABOVE
 - [Symbol] 1000 GAMMAS OR ABOVE
 - [Symbol] 500 GAMMAS OR ABOVE

PROPOSED RECONNAISSANCE GRID 800 FT SPACINGS APPROXIMATELY 25 MILES

PORTION COMPLETED 48W BASELINE 00 TO 62N TRANSIT LINE

RECONNAISSANCE MAGNETOMETER SURVEY	
AARON MINING LTD. WEAVER LAKE PROPERTY SEPTEMBER 20, 1971	
27	DATE: JUNE 20, 1972
DRAWN BY: C.H.S.	

TO ACCOMPANY PLATE 3 AND REPORT ON THE WEAVER LAKE PROPERTY BY I.M. WATSON, BETHLEHEM COPPER CORP.

Department of Mines and Petroleum Resources
ASSESSMENT REPORT
NO. 4470 MAP #1

SCALE: 1" = 500'
MAP REFERENCE: 92H/5W

4470-M1
92H/5W