

92P/9W
LINE CUTTING REPORT

FL MINERAL CLAIMS
OWNER: VANGULF EXPLORATION CO.
WORK DONE: 1973
KAMLOOPS MINING DIVISION



MAP A 4702

1735 Grosvenor Street
376-2591 371-3713

Department of
Mines and Petroleum Resources
ASSESSMENT REPORT

No. **4702** MAP

August 23, 1973

Imperial Oil Limited
Minerals Section
500 - 6th Avenue S.W.
Calgary, Alberta
T2P 0J1

Attention: Mr. C.A. Aird

Invoice # 2

**SUB-MINING RECORDER
RECEIVED**
NOV 8 1973
M.R.# 85207E \$ 825.00
VANCOUVER, B. C.

Re: Friendly Lake property

Soil samples	500 samples @ \$1.00 each	\$400.00
Soil samples	60 samples @ \$3.60 each	\$216.00
Soil Samples	752 samples @ \$1.60 each	\$1203.20
117 samples	@ \$.60 each		\$70.20
28.2 miles of line cutting		@ \$75.00 per mile	\$2115.00
Total				\$4804.40
Received				\$1016.00
Balance due				\$3467.30

Declared before me at the
of
Province of British Columbia, in the
day of
NOV 9 1973, A.D.

C. A. Aird
James Explorations Ltd.
per:

[Signature]
Sub-Mining Recorder

A Commissioner for taking Affidavits within British Columbia
A Notary Public in and for the Province of British Columbia.

cc: E. Pokar
W. Hill
J. Cryderman

Jayne Tidale

*lines inspected and approved
received and approved by*
[Signature]

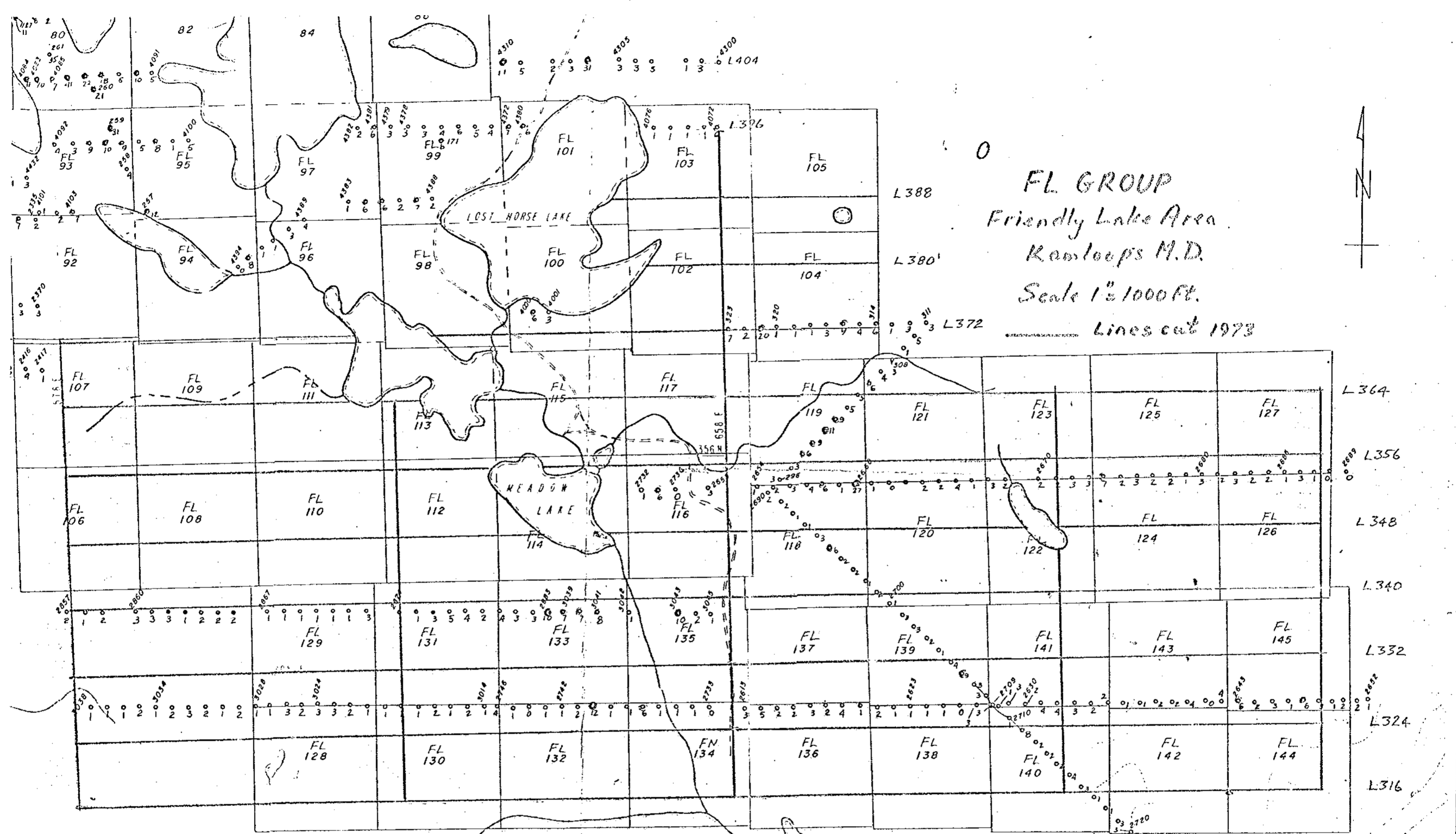

FL GROUP
 Friendly Lake Area
 Kamloops M.D.
 Scale 1" = 1000 ft.
 Lines cut 1973

SUB-MINING RECORDER
 RECEIVED
 NOV 8 1973
 M.R.# _____ \$ _____
 VANCOUVER, B.C.

Department of
 Mines and Petroleum Resources

ASSESSMENT REPORT FRIENDLY LAKE PROJECT 92 P/NE

NO. **4702** MAP #1

KAMLOOPS M.D.
 GEOCHEMICAL MAP
 MOLYBDENUM

1000 0 1000 2000
 SCALE - FEET

4702
MI

FL45	FL47	FL49	FL51	FL53	FL55	FL57	FL59	FL61
335205	335207	335209	335211	335213	335215	335217	335219	335221
FL44	FL46	FL48	FL50	FL52	FL54	FL56	FL58	FL60
335204	335206	335208	335210	335212	335214	335216	335218	335220

FL65	FL47	FL21	FL23	FL25	FL27	FL29	FL31	FL33
335223								
FL64	FL42	FL22	FL24	FL26	FL28	FL30	FL32	FL34
335224								

FL43	FL41	R015	R017	FL1	FL3	FL5	FL7	FL9
335223								
FL62	FL40	R016	R018	FL2	FL4	FL6	FL8	FL10
335222								

FL33	FL36	R029	R031	FL11	FL13	FL15	FL17	FL19	FL147	FL149
									133547	133549
FL39	FL37	FL35	R032	FL12	FL14	FL16	FL18	FL20	FL146	FL148
									133546	133548

FL67	FL69	FL71	FL73	FL75	FL77	FL79	FL81	FL83	FL85	FL87
335227	335229	335231	335233	335235	335237	335239	335241	335243	335245	335247
FL66	FL68	FL70	FL72	FL74	FL76	FL78	FL80	FL82	FL84	FL86
335226	335228	335230	335232	335234	335236	335238	335240	335242	335244	335246

FL89	FL91	FL93	FL95	FL97	FL99	FL101	FL103	FL105
335249	335251	335253	335255	335257	335259	335261	335263	335265
FL88	FL90	FL92	FL94	FL96	FL98	FL100	FL102	FL104
335248	335250	335252	335254	335256	335258	335260	335262	335264

FL107	FL109	FL111	FL113	FL115	FL117	FL119	FL121	FL123	FL125	FL127
335267	335269	335271	335273	335275	335277	335279	335281	335283	335285	335287
FL106	FL108	FL110	FL112	FL114	FL116	FL118	FL120	FL122	FL124	FL126
335266	335268	335270	335272	335274	335276	335278	335280	335282	335284	335286

FL129	FL131	FL133	FL135	FL137	FL139	FL141	FL143	FL145
335289	335291	335293	335295	335297	335299	335301	335303	335305
FL128	FL130	FL132	FL134	FL136	FL138	FL140	FL142	FL144
335288	335290	335292	335294	335296	335298	335300	335302	335304

Department of
Mines and Petroleum Resources
ASSESSMENT REPORT
NO 4702 MAP #2

THE FL GROUP
KAMLOOPS M.D.

- GREEN GROUP 1
- YELLOW GROUP 2
- BLUE GROUP 3
- RED GROUP 4

0 0.5
SCALE - MILES

Lost
Horse
L.

Friendly L.

12075E

51°35N

3N17 58V8 S-11

SUB-MINING RECORDER
 RECEIVED
 NOV 8 1973
 M.R.# 83207E S. 829100
 VANCOUVER, B.C.

To Accompany A Report By W.J. HILL
IMPERIAL OIL LIMITED Dated _____

4702
M2