

DIAMOND DRILLING REPORT

Jan. 9th, 1974

Property

92I/9 IM "D" Group  
Iron Mask area,  
KAMLOOPS, B.C.

Cost

DDH IM-31, 131'	-----	\$ 848.00
IM-33, 500'	-----	3164.00
IM-34, 312'	-----	2044.00
IM-35, 347'	-----	2368.00
IM-36, 241'	-----	1674.00
IM-37, 399'	-----	2888.00
Total		<u>\$11986.00</u>

see attached contractors invoices.

Core Storage

On property; see drill hole location map.

Qualifications

I, Nels B. Vollo, obtained a Batchelors degree in Geology from the University of Saskatchewan in 1950 and a Masters degree in Geology from McGill University in 1959. I have practised my profession as a geologist for 24 years and am a Fellow in good standing of the Geological Association of Canada and a Member of the Association of Professional Engineers of B.C.

Maps

- #1 Location map
- #2 Drill Hole location map

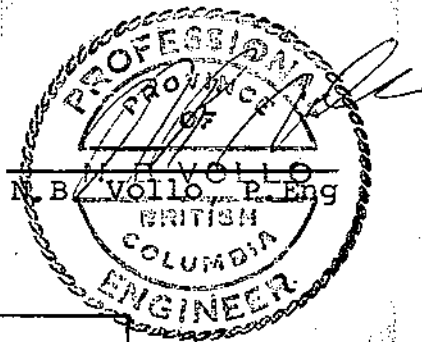

Department of  
Mines and Petroleum Resources  
ASSESSMENT REPORT

NO. **4844** MAP

H. ALLEN DIAMOND DRILLING LTD.

TELEPHONE 378-4494

P.O. BOX 1397  
MERRITT, B.C.

Invoice No. 107.

June 7, 1973.

TO: CRAIGMONT MINES LIMITED,  
Suite 270,  
180 Seymour Street,  
Kamloops, B.C.

In Account With:

H. ALLEN DIAMOND DRILLING LTD.,  
Box 1397,  
Merritt, B.C.

This invoice is for diamond drilling on your  
Iron Mask Area property.

Hole No. 29 overburden from 0 to 35 ft. ✓  
35 ft. @ \$8.00 per ft..... \$ 280.00

Hole No. 29 core drilling from 35 ft. to 140 ft. - 105 ft. @ \$6.00 per ft.... ✓ \$ 630.00

-----  
Hole No. 30 overburden from 0 to 32 ft. ✓  
32 ft. @ \$8.00 per ft..... \$ 256.00

Hole No. 30 core drilling from 32 ft. to 108 ft. - 76 ft. @ \$6.00 per ft..... ✓ \$ 456.00

-----  
Hole No. 31 overburden from 0 to 31 ft. ✓  
31 ft. @ \$8.00 per ft..... \$ 248.00

Hole No. 31 core drilling from 31 ft. to 131 ft. - 100 ft. @ \$6.00 per ft.... ✓ \$ 600.00

-----  
Hole No. 32 overburden from 0 to 37 ft. ✓  
37 ft. @ \$8.00 per ft..... \$ 296.00

Hole No. 32 core drilling from 37 ft. to 108 ft. - 71 ft. @ \$6.00 per ft..... ✓ \$ 426.00

-----  
Hole No. 33 overburden from 0 to 82 ft. ✓  
82 ft. @ \$8.00 per ft..... \$ 656.00

Hole No. 33 core drilling from 82 ft. to 500 ft. - 418 ft. @ \$6.00 per ft.... ✓ \$ 2,508.00

\$ 6,356.00

Contractor's Representative

Company's Representative

Herb Allen

[Signature]

921/4117

H. ALLEN DIAMOND DRILLING LTD.

TELEPHONE 378-4494

P.O. BOX 1397  
MERRITT, B.C.

Invoice No. 110.

June 30, 1973.

TO: CRAIGMONT MINES LIMITED,  
Suite 270,  
180 Seymour Street,  
Kamloops, B.C.

In Account With:

H. ALLEN DIAMOND DRILLING LTD.,  
Box 1397,  
Merritt, B.C.

This invoice is for diamond drilling on your  
Iron Mask Area property.

Hole No. 34 overburden from 0 to 86 ft. - 86 ft. @ \$8.00 per ft.....	\$ 688.00
Hole No. 34 core drilling from 86 ft. to 312 ft. - 226 ft. @ \$6.00 per ft....	\$ 1,356.00
-----	
Hole No. 35 overburden from 0 to 143 ft. - 143 ft. @ \$8.00 per ft.....	\$ 1,144.00
Hole No. 35 core drilling from 143 ft. to 347 ft. - 204 ft. @ \$6.00 per ft.....	\$ 1,224.00
-----	
Hole No. 36 overburden from 0 to 114 ft. - 114 ft. @ \$8.00 per ft.....	\$ 912.00
Hole No. 36 core drilling from 114 ft. to 241 ft. - 127 ft. @ \$6.00 per ft.....	\$ 762.00
-----	
Hole No. 37 overburden from 0 to 247 ft. - 247 ft. @ \$8.00 per ft.....	\$ 1,976.00
Hole No. 37 core drilling from 247 ft. to 399 ft. - 152 ft. @ \$6.00 per ft.....	\$ 912.00
	<u>\$ 8,974.00</u>

Contractor's Representative

Company's Representative

.....

*[Handwritten signature]*  
*[Handwritten signature]*  
92 1/9 119





CRAIGMONT MINES LIMITED

LOCATION MAP

921/9 IM GROUP

Department of	1" = 2 miles
Mines and Petroleum Resources	
ASSESSMENT REPORT	
NO. 4844	MAP #1

Jan. 9th, 1974

# DIAMOND DRILL CORE LOG - SAMPLE RECORD

DEPTH	DIP	BEARING AST.
COLLAR	-90°	

PROPERTY 92I/9 IM CLAIM IM-33  
 LATITUDE ..... STARTED June 21st, 1973.  
 DEPARTURE ..... FINISHED June 27th, 1973.  
 ELEVATION ..... TOTAL LENGTH 399'

LOGGED BY N.B. Vollo  
 CORE SIZE BQ  
 SECTION 56+00N  
43+25W  
 HOLE NO. IM-37

Footage	DESCRIPTION	MINERALIZATION	Sample	From	To	Length	Copper %	Mo %	Gold Oz.	Silver Oz.
0	Casing - overburden, boulders.									
251	Monzonite - grey green, medimm grained, intensely fractured. Core can be crumbled in the hand.									
267	- muddy gouge and breccia. Good core									
270	- more massive with about 30 fractures per foot, many chlorite healed.									
295	- becomes highly fract. with about 5/inch, chlorite carb. healed. moderate patchy K and epidote alt.									
338	- gouge, breccia. 35-45° slips. 50% lost core.									
352	- highly fractured, with patchy K and epidote alt. Brown staining on fractures.	1% patchy py								
367	- intensely fractured. Excellent core.									
375	- fault gouge - 40° slips. Exc. core.									
	A few larger pieces of monzonite.									

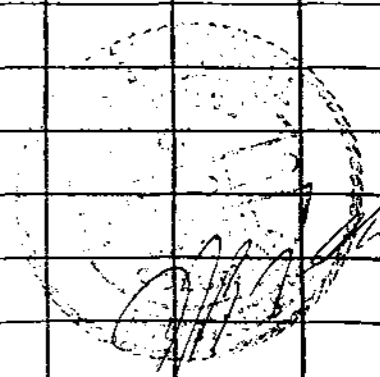



# DIAMOND DRILL CORE LOG - SAMPLE RECORD

DEPTH	DIP	BEARING AST.
COLLAR	-90°	

PROPERTY ..... 92I/9 IM ..... CLAIM IM-31  
 LATITUDE ..... STARTED June 18th, 1973  
 DEPARTURE ..... FINISHED June 21st, 1973  
 ELEVATION ..... TOTAL LENGTH 241'

LOGGED BY N.B. Vollo  
 CORE SIZE BQ  
 SECTION 64+00N  
 38+00W  
 HOLE NO. IM-36

Footage	DESCRIPTION	MINERALIZATION	Sample	From	To	Length	Copper %	Mo %	Gold Oz.	Silver Oz.
0	Casing - overburden.									
114	Fault zone - muddy breccia and gouge with slips 25-30° CA. Contains sections of pink, highly altered monzonite. 30% lost core. Sharp 45° gouge contact to									
124	Monzonite - pink, m.g., with strong K alteration. Mod. fract. with abundant calcite - chlorite veinlets. 6" gouge sections at 148', 152'.	1% py								
	164 - same but more grey, less altered, mod. fract. Occ. f.g dark inclusions.									
	187 - same, brecciated, somewhat muddy.									
	195 - relatively massive, but still with 15-20 chlorite or chlorite calcite healed fractures per foot.									
	238 - same, strong K alt. Numerous brown gypsum - hematite coated fractures.									
E-700 241	END OF HOLE									

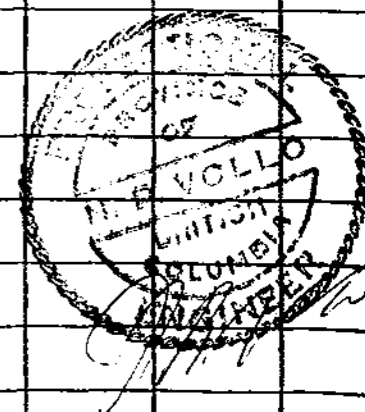

# DIAMOND DRILL CORE LOG - SAMPLE RECORD

DEPTH	DIP	BEARING AST.
COLLAR	-90°	

PROPERTY 921/9 IM CLAIM IM-31  
 LATITUDE ..... STARTED June 12th, 1973  
 DEPARTURE ..... FINISHED June 18th, 1973  
 ELEVATION ..... TOTAL LENGTH 347'

LOGGED BY N. B. Vollo  
 CORE SIZE BQ  
 SECTION 56+00N  
           34+00W  
 HOLE NO. IM-35

Footage	DESCRIPTION	MINERALIZATION	Sample	From	To	Length	Copper %	Mo %	Gold Oz.	Silver Oz.
0	Casing - overburden.									
143	Monzonite - pink, bleached, highly broken, with 25% core recovery.									
164	Fault zone - grey, crushed, muddy and kaolinized. good core.									
175	Monzonite - light brick coloured, leached, bleached and highly fractured, with sections of muddy breccia. Slips are mostly about 30° CA. Excellent core.									
225	Fault zone - brown to grey muddy gouge. Partly oxidized. 100% core recovery.									
231	Monzonite - pink, highly fractured, broken, with 50% lost core.	sparse py								
240	- same, brecciated and healed by calcite. A few muddy seams. 95% recovery.									
264	- light pinkish brown, moderately fractured, healed in part by calcite. 90% core recovery.									
E-7947	END OF HOLE									

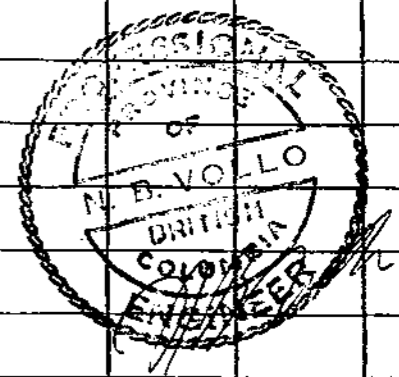



# DIAMOND DRILL CORE LOG - SAMPLE RECORD

DEPTH	DIP	BEARING AST.
COLLAR	-90°	

PROPERTY 921/9 IM CLAIM IM-33  
 LATTITUDE ..... STARTED June 5th, 1973  
 DEPARTURE ..... FINISHED June 12th, 1973  
 ELEVATION ..... TOTAL LENGTH 312'

LOGGED BY N.B. Vollo  
 CORE SIZE BQ  
 SECTION 40+00N  
38+00W  
 HOLE NO. IM-34

Footage	DESCRIPTION	MINERALIZATION	Sample	From	To	Length	Copper %	Mo %	Gold Oz.	Silver Oz.		
0	Casing - overburden.											
112	Monzonite - grey to pink with patches of K alteration. Moderately fractured, healed by calcite and chlorite.	1% py										
	172 - light coloured fault gouge, Slips at 45°											
	174 - pink, medium grained, with a few muddy breccia sections, minor faults, at about 20° CA.											
	200 - same, but with patches and blebs of epidote. A few brecciated sections around 20° CA slips.											
	275 - becomes grey, medium grained, relatively unaltered.											
312	END OF HOLE											

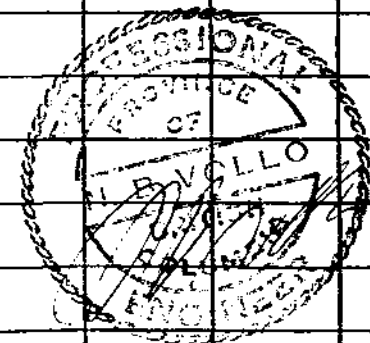

# DIAMOND DRILL CORE LOG - SAMPLE RECORD

DEPTH	DIP	BEARING AST.
COLLAR	-55°	N 50° E

PROPERTY 92I/9 IM CLAIM IM - 30  
 LATITUDE ..... STARTED May 22nd, 1973  
 DEPARTURE ..... FINISHED June 4th, 1973  
 ELEVATION ..... TOTAL LENGTH 500'

LOGGED BY N.B. Vollo  
 CORE SIZE BQ  
 SECTION 56+00N  
28+00W  
 HOLE NO. IM-33

Footage	DESCRIPTION	MINERALIZATION	Sample	From	To	Length	Copper %	Mo %	Gold Oz.	Silver Oz.
0	Casing - overburden.									
82	Monzonite - Pink, medium grained, mod. fractured, weathered.	minor mal. on fractures.								
87	Micromonzonite - dike, pink, very fine, moderately fractured. Minor epidote. 45° contact to	minor mal. on fractures,								
94	Monzonite - Pink, medium grained, mod. fractured. Sparse epidote.									
124	Dike - Very fine, pink, highly fractured, with badly broken core.									
127	lost core.									
128	Monzonite - pink, moderately fractured, with 5% irregular calcite veinlets. 25% lost core.									
130	- same - 10- 20%epidote - moderately fractured and healed by chlorite-calcite.	1-2% cp py blebs .1% py cp	3159	130	140	10	0.26			
	Bleaching and 1" 40° CA fault @155'	½% cp blebs	3161	150	160	10	0.21			

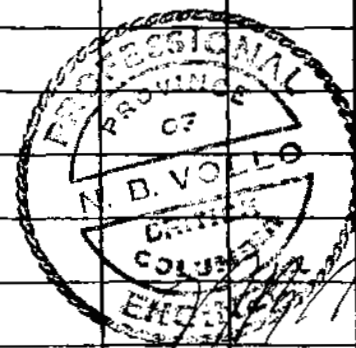

# DIAMOND DRILL CORE LOG - SAMPLE RECORD

PROPERTY 921/9 IM

IM-33  
HOLE No. .... Page No. 2

Depth	DESCRIPTION	MINERALIZATION	Sample	From	To	Length	Copper %	Mo %	Gold Oz.	Silver Oz.
	160 - becomes a breccia, with rounded fragments of pink monzonite in a darker matrix. 5% calcite stringers.	½% cp blebs	3162	160	170	10	0.22			
	170 - same - less calcite. Moderate brecciation, slips and fractures // core to	sparse cp py								
213	Micromonzonite - pale pinkish buff, fine, fairly massive. Contains scattered round ½" zoisite spots with dark cores. Appears to become finer grained, possibly chilled against	py along fractures								
239	Monzonite Breccia - coarse rounded and angular fragments of pink monzonite in a finer, darker matrix. Sharp 45° contact to	1-2% py								
291	Micromonzonite Dike - Dark, brownish, fine to medium grained, with zoisite blebs and stringers. Sharp 45° contact to	sparse py								
-701										

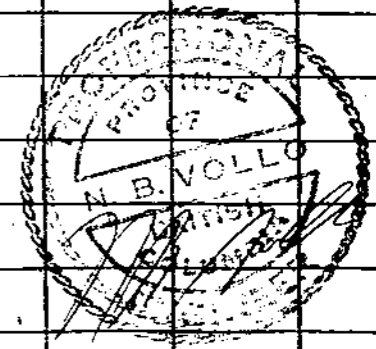

# DIAMOND DRILL CORE LOG -- SAMPLE RECORD

PROPERTY 92I/9 IM

HOLE No. IM-33 Page No. 3

Footage	DESCRIPTION	MINERALIZATION	Sample	From	To	Length	Copper %	Mo %	Gold Oz.	Silver Oz.		
295	Monzonite - pink, medium grained, brecciated and shattered, healed by 15% qtz. calcite stringers. Minor epidote. Minor faults at 296', 312'. 6" inclusion of coarse gabbro at 335'. 370 - becomes more massive, with less shattering and about 5% qtz. calcite stringers. Becomes bleached within 2' of contact to	1% py in qtz. strgrs.     sparse py, mostly along fractures.										
400	Fault - Breccia and gouge with slips at 40° to core axis.											
402	Monzonite - strongly bleached over first 2 feet, then becomes light brick coloured, medium grained, moderately fractured, with about 5% qtz. calcite stringers. 416 - becomes bleached.	2% py										
423	Fault zone - breccia and muddy gouge with slips and gouge seams 55-60° CA.											
701												

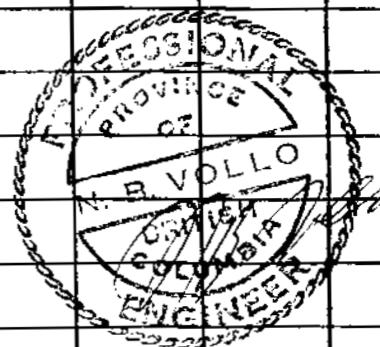





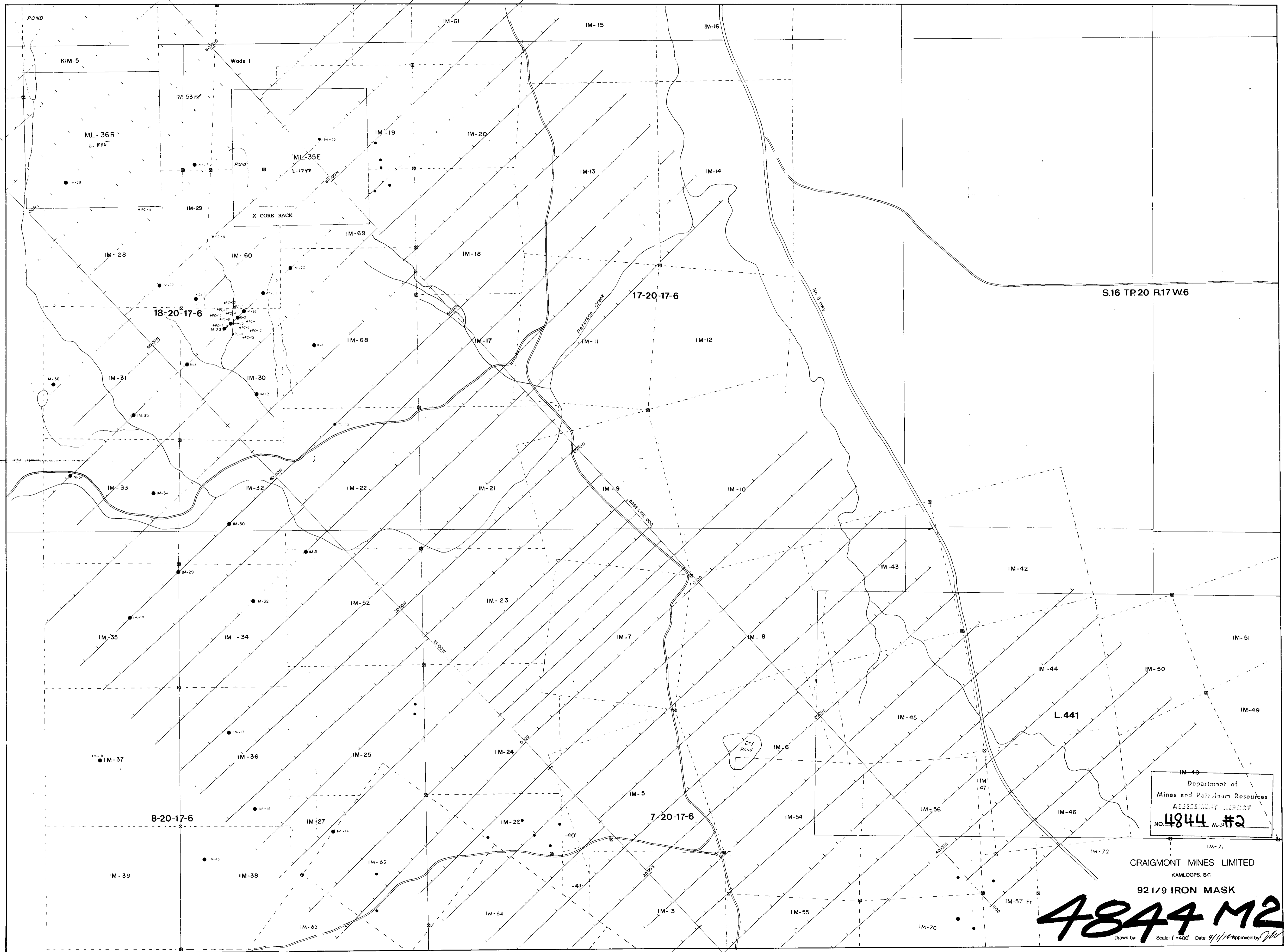

Department of  
Mines and Petroleum Resources  
ASSESSMENT REPORT  
NO. 4844 M2

CRAIGMONT MINES LIMITED  
KAMLOOPS, B.C.  
921/9 IRON MASK

**4844 M2**  
Scale: 1"=400' Date: 9/1/77 Approved by: [Signature]