

March 8, 1974

Mining Recorder
Nanaimo Mining Division
B.C. Dept. of Mines and Petroleum Resources

Dear Sir:

Re: Texada Lime Ltd.
1974 Diamond Drilling

Enclosed please find the following data:

- (a) vouchers to support cost of:
 - (i) Cameron McCutcheon Drilling\$7,503.86
 - (ii) W.G. Wahl Ltd. 720.00
 - (iii) Expenses - J. Inverarity..... 180.00
 - \$8,403.86
- (b) diamond drill log for holes 74-1 to 74-5 incl.
- (c) Plan showing location of drilling 1:50,000
Plan of drill holes 1" = 800'
- (d) Statement of location or core.

These data are presented to fulfill requirements of Part III of the regulations governing assessment work under the Mineral Act.

Respectfully submitted,

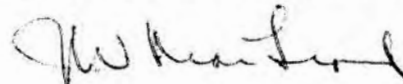

J.W. MacLeod, P.Eng.



Declared before me at the

Province of British Columbia, in the
City of VANCOUVER, B.C.

MAR 8 1974, A.D.

Sub - Mining Recorder

A Commissioner for taking Affidavits within British Columbia
A Notary Public in and for the Province of British Columbia

4903

CAMERON McCUTCHEON DRILLING LIMITED

DIAMOND DRILLING CONTRACTORS

Telephone: 685-2261
Telex: 04-54311

619-620-475 Howe Street
Vancouver 1, B.C.

March 1, 1974

Texada Lime Ltd.
309 - 193 W. Hastings St.,
Vancouver 3, B.C.

Invoice #2
Job 285

FEBRUARY 1974 BILLING

Mobilization to road site suitable for highway truck	\$250.00
---	----------

Footage Drilled:

Hole #74-1 - 0' - 2' = 2' Overburden @ \$6.50/ft	\$ 13.00	
- 2' - 205 = 203 BQ Drilling @ \$6.20/ft	1,258.60	
#74-2 - 100' - 203' = 103' BQ Drill- ing @ \$6.20/ft	638.60	
#74-3 - 0' - 10' = 10' Overburden @ \$6.50/ft	65.00	
- 10' - 201' = 191' BQ Drill- ing @ \$6.20/ft	1,184.20	
#74-4 - 0' - 2' = 2' Overburden @ \$6.50/ft	13.00	
- 2' - 247' = 245' BQ Drill- ing @ \$6.20/ft	1,519.00	
#74-5 - 0' - 250' = 250' BQ Drill- ing @ \$6.20/ft	<u>1,550.00</u>	6,241.40
Plus Schedule "A" - See Attached -		480.70

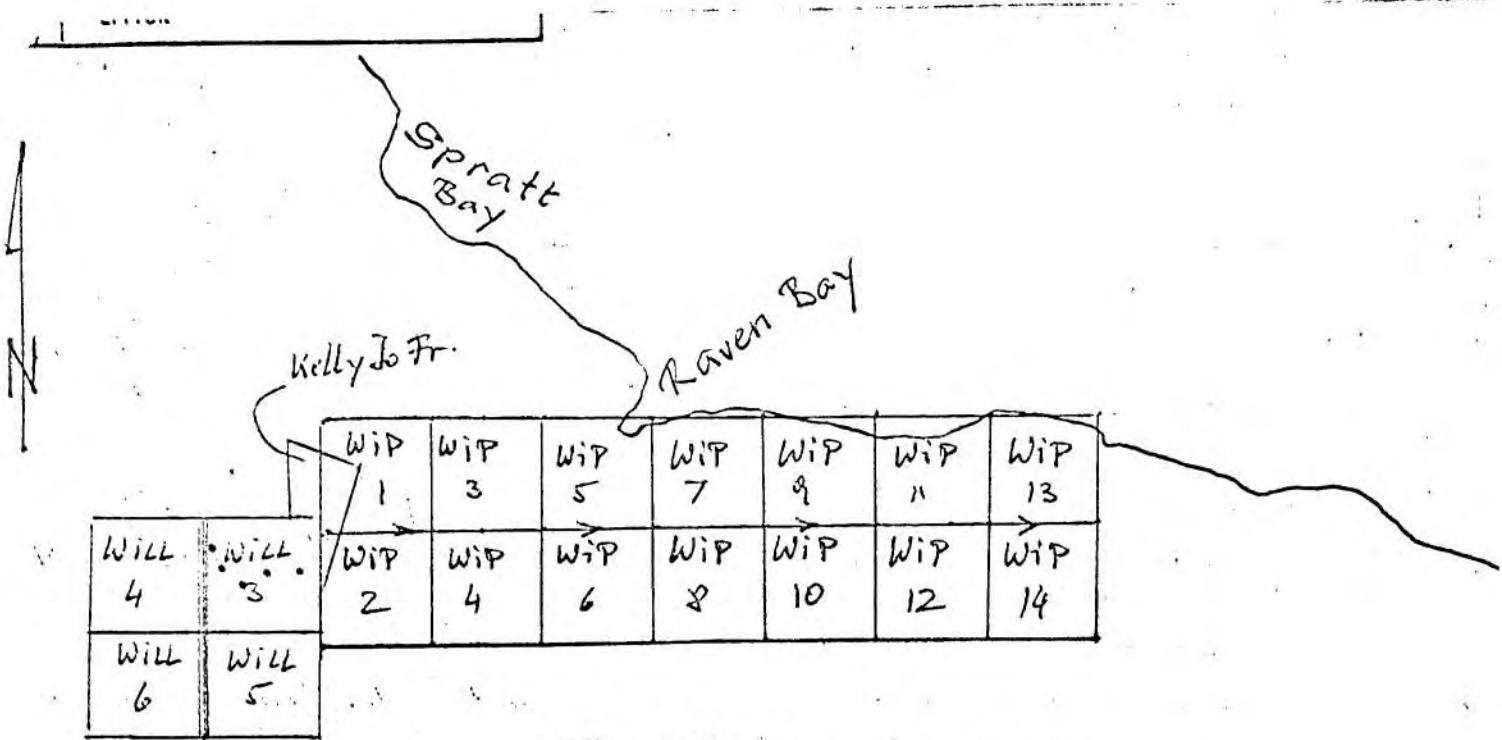

TEXADA ISLAND

QZF/10E.

SUB-MINING RECORDER
RECEIVED
MAR 15 1973
M.R.# 80937E (D.O.D.)
VANCOUVER, B. C.

4903

CERTIFICATE

I, James W. MacLeod, of 1220 Arbutus Street, in the City of Vancouver, in the Province of British Columbia, DO HEREBY CERTIFY:

1. That I am a Consulting Engineer, with a business address at 335-885 Dunsmuir Street, in the City of Vancouver, in the Province of British Columbia.
2. That I am a graduate of the University of Alberta with the degree of B.Sc. in Mining Engineering.
3. That I have actively practiced my profession in mineral exploration since graduation in 1946.
4. That I am a registered Professional Engineer in the Province of British Columbia.
5. That on March 6, 1974, I logged the five holes (74-1 to 5 incl.) drilled by Cameron McCutcheon between February 13th and February 22nd for the Texada Lime Co.



J.W. MacLeod, B.Sc., P.Eng.

Dated at the City of Vancouver, Province of British Columbia, this 18th day of February, 1974.

CLAIM NO. WILL 3

PROPERTY.....

HOLE NO. 74-1

LATITUDE.....

ELEVATION.....

BEARING.....

DEPTH 205STARTED Feb. 13/74COMPLETED Feb. 14/74

DEPARTURE.....

SECTION.....

DIP 90°DRILLED BY Cameron McCutcheonLOGGED BY J.W. MacLeod

DEPTH FEET	FORMATION	SAMPLE NO.	FROM	TO	WIDTH	ASSAYS		
							CaO	
0-2	Casing	701	0	10	10			
1-205	Limestone - grey*-massive	702	10	20	10			
	- apparent 100% recovery	703	20	30	10			
	- few hairline fractures with calcite	704	30	40	10			
		705	40	50	10			
		706	50	60	10			
	Note: core split by J. Inveriarity	707	60	70	10			
		708	70	80	10			
		709	80	90	10			
		710	90	100	10			
		711	100	110	10			
		712	110	120	10			
		713	120	130	10			
		714	130	140	10			
		715	140	150	10			
		716	150	160	10			
		717	160	170	10			
		718	170	180	10			
		719	180	190	10			
		720	190	200	10			
		721	200	205	5			

CLAIM NO. WILL 3

DIAMOND DRILL RECORD

PROPERTY.....

HOLE NO. 74-2

LATITUDE.....

ELEVATION.....

BEARING.....

DEPTH 203 (103)STARTED Feb. 14/74COMPLETED Feb. 16/74

DEPARTURE.....

SECTION.....

DIP.....

90°DRILLED BY Cameron McCutcheonLOGGED BY J.W. MacLeod

DEPTH FEET	FORMATION	SAMPLE NO.	FROM	TO	WIDTH	ASSAYS		
							CaO	
1	deepening of old hole 73-3	726	100	110	10			
100-139	LIMESTONE - grey, massive	727	110	120	10			
	107-115 4' lost	728	120	130	10			
		729	130	140	10			
		730	140	150	10			
139-141	LIMESTONE - white, 1" green schist with few crystals pyrite	731	150	160	10			
		732	160	170	10			
		733	170	180	10			
141-143	LIMESTONE - grey	734	180	190	10			
		735	190	200	10			
143-151	ANDESITE DIKE ? - 1.5' core recovered, mixed andesite	736	200	203	3			
	marble							
151-203	LIMESTONE - grey, massive, scattered calcite veinlets.							

CLAIM NO. WILL 3

DIAMOND DRILL RECORD

PROPERTY

HOLE NO. 74-3

LATITUDE ELEVATION BEARING DEPTH 201 STARTED Feb. 16/74 COMPLETED Feb. 18/74

DEPARTURE SECTION DIP 90° DRILLED BY Cameron McCutcheon LOGGED BY J.W. MacLeod

DEPTH FEET	FORMATION	SAMPLE NO.	FROM	TO	WIDTH	ASSAYS		
							CaO	
0-2	CASING	737	0	10	10			
		738	10	20	10			
2-201	LIMESTONE - grey, massive, calcite veinlets	739	20	30	10			
		740	30	40	10			
		741	40	50	10			
		742	50	60	10			
		743	60	70	10			
		744	70	80	10			
		745	80	90	10			
		746	90	100	10			
		747	100	110	10			
		748	110	120	10			
		749	120	130	10			
		750	130	140	10			
		751	140	150	10			
		752	150	160	10			
		753	160	170	10			
		754	170	180	10			
		755	180	190	10			
		756	190	200	10			

CLAIM NO. WILL 3

DIAMOND DRILL RECORD

PROPERTY.....

HOLE NO. 74-4

LATITUDE.....

ELEVATION.....

SEASIDE.....

DEPTH 247

STARTED Feb. 18/74

COMPLETED Feb. 20/74

DEPARTURE.....

SECTION.....

DIP 90°

DRILLED BY Cameron McCutcheon

LOGGED BY J.W. MacLeod

DEPTH FEET	FORMATION	SAMPLE NO.	FROM	TO	WIDTH	ASSAYS		
						CaO		
0-2	CASING	757	2	10	8			
		758	10	20	10			
5-8	LIMESTONE - grey, massive	759	20	30	10			
		760	30	40	10			
8-10	LIMESTONE - grey, 10% carb. stringers up to 1/2"	761	40	50	10			
		762	50	60	10			
10-12	LIMESTONE - grey, brecciated, crystals of pyrite	764	60	70	10			
		765	70	80	10			
12-58	LIMESTONE - grey, massive	766	80	90	10			
		767	90	100	10			
58-59	DIKE - grey, 10% pyrite	768	100	110	10			
		769	110	120	10			
59-115	LIMESTONE - grey, massive	770	120	130	10			
		771	130	140	10			
115-135	LIMESTONE - grey, few irregular chloritic seam with little pyrite, 1%	772	140	150	10			
		773	150	160	10			
		774	160	170	10			
135-227.5	LIMESTONE - grey, massive	775	170	180	10			
	179, crystals pyrite	776	180	190	10			
		777	190	200	10			

CLAIM NO. WILL 3

DIAMOND DRILL RECORD

PROPERTY

HOLE NO. 74-5

LATITUDE

ELEVATION

BEARING

DEPTH 250'

STARTED Feb. 20/74

COMPLETED Feb. 22/74

DEPARTURE

SECTION

DIP 90°

DRILLED BY Cameron McCutcheon

LOGGED BY J.W. MacLeod

DEPTH FEET	FORMATION	SAMPLE NO.	FROM	TO	WIDTH	ASSAYS			
0-4	CASING	783	0	10	10				
		784	10	20	10				
4-28	LIMESTONE - grey, massive	785	20	30	10				
		787	31	40	9				
28-31	PORPHYRY - 1.5' core, light green with greenish phenocrysts	788	40	50	10				
		789	50	60	10				
31-83	LIMESTONE - grey, massive - calcite veinlets	790	60	70	10				
		791	70	80	10				
83-91	SCHIST - light green, foliated with core	792	80	90	10				
	may be narrow fault zone	793	90	100	10				
		794	100	110	10				
91-103	LIMESTONE - 6" mud at 94'	795	110	120	10				
	96-98 chloritic shears	796	120	130	10				
	99- chloritic shears	797	130	140	10				
		798	140	150	10				
103-108	SILICIFIED ? - 10-15% pyrite	799	150	160	10				
		800	160	170	10				
108-118	LIMESTONE - grey, 15% qtz.-carb.?	801	170	180	10				
		802	180	190	10				
118-119	LIMESTONE - 20% pyrite	803	190	195	5				



Department of
 Mineral Resources
 No. **4903** #1

MERV ENGINEERING CORP.	
LOCATION OF TEXADA LIME DRILLING	
DRAWN BY: <i>Macdon</i>	SCALE: 1:50,000
DATE: <i>MARCH 8, 74</i>	N.T.S. : 92 F10

CG 196

CG 300A

TEXADA ISLAND

RAVEN BAY

WIP CLAIMS

WILL 3

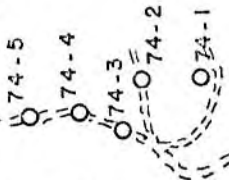

NO. **4903** #2

○ 74-2 LOCATION OF DRILL HOLE

MERV ENGINEERING CORP.

TEXADA LIME

1974 DRILLING

DRAWN BY: J.W.M.

SCALE: 1" = 800'

DATE: MARCH 8, 74

N.T.S. :

March 4/74

As Field Manager For Texada
Line Co. I hereby state that the
core acquired during assessment work
on Texada Island at Raven Bay during
February 1974. is stored at Texada Line
Plant in Langly B.C.

JW Bunnary.

CMI

CAMERON McCUTCHEON DRILLING LIMITED

DIAMOND DRILLING CONTRACTORS

Telephone: 685-2261
Telex: 04-54311

619-620-475 Howe Street
Vancouver 1, B.C.

- 2 -

Supplies & Services:

February 19

3 - 2" BW Casing @ \$14.17 ea.	\$ 42.51	
1 only BW Casing Shoe #102W289	<u>150.00</u>	
	192.51	
Plus 10%	<u>19.25</u>	\$ 211.76

February 22

44 BQ core Boxes @ \$5.00	220.00	220.00
Demobilization at job completion		100.00
		<hr/>
		<u>\$7,503.86</u>

A Notary Public in and for the Province of British Columbia or
Sub-Mining Recorder

E. & O.E.



Declared before me at the

 in the
 Province of British Columbia, this
 VANCOUVER, B.C.
 A.D. _____
 MAR 8 1974



W. G. WAHL LIMITED

CONSULTANTS: GEOLOGY - & PHYSICS

302 BAY ST. - SUITE 1101 - TORONTO, CANADA M5H 2P3
TELEPHONE 363-8761 - CABLE: WAHLCO - TORONTO

March 5th, 1974.

Texada Lime Limited,
198 West Hastings,
Vancouver, B. C.

Dear Mr. MacDonald:

Submitted is our statement of expenses incurred on behalf of the limestone drilling south Vanada, Texada Island.

To Expenses

Field Engineer	\$ 720.00
----------------	-----------

Sincerely yours,

W. G. WAHL LIMITED

W. G. Wahl

WGW:RS

March 3/74

Texada Lime Ltd
198 W Hastings

Dear Mr Mac Donald.

This is a statement
of my personal Expenses
while on Texada Island
During February of 1974.

This bill includes the
Cost of Food & Lodging at
The Texada Arms Hotel.
in Vancouver from the
8th to the 22nd of February

\$180.00

J. W. Lancaster.