

# 4915

## 92F/2E

PROSPECTING REPORT

On the

SAM GROUP

Alberni Mining Division

Vancouver Island, B. C.

James Szakacs  
James Szakacs  
Prospector

E. P. Sheppard  
E. Percy Sheppard, P. Eng.  
Consulting Geologist

Date: March 20, 1974  
Vancouver, B. C.

Department of	
Mines and Petroleum Resources	
ASSESSMENT REPORT	
NO. <b>4915</b>	MAP.....

C O N T E N T S

PROSPECTING REPORT:

INTRODUCTION  
PROPERTY  
OWNERSHIP  
WORK PERFORMED

RESUMÉ FOR James Szakacs  
and Supplement

CERTIFICATE (E. P. Sheppard, P. Eng.)

AFFIDAVIT ON EXPENDITURES

CERTIFICATE OF ANALYSIS (2)

INVOICES: Core Laboratories Ltd (2)

- - -

LIST OF MAPS

#1	Location Map	
#2	Claim Map	Scale: 1" = 400'
#3	Adit Plan	" 1" = 40'
#4	Geology map	1" = 400'

AMENDMENT TO:

File No. 166-Alberni

SAM Mineral Claim  
Prospecting Report #4915

A complete geologic report is not within the scope of the Prospecting Report dated March 20, 1974.

The rock formations observed were placed tentatively in the Mt. Sicker group on the map, although late Government mapping placed them in the Vancouver group of rocks.

The outcrops observed range from massive volcanic "greenstone" with no apparent dip and strike, to drag-folded and contorted tuffaceous beds. Occasional beds of chert were observed near the veins. Dips were seen to be 40° to 60° SW. Shearing exhibited strikes of North to N 20°E, with dips ranging from 60° to 75° E. In SAM 6, two exposures gave the impression of being the hanging wall of the shear zone.

Veins trend from North to N 40° E, and dip 40° to 47° E. The Upper and Lower Belcher drifts explore the vein for a distance of 380 ft. in the Upper and 235 ft. in the Lower. A raise connects these two levels. At present both portals are caved-in but an opening near the raise in the Upper drift gives access to the workings on both levels. It was observed that the vein pinches and swells both along strike and downdip. Dips at the Upper and Lower levels were 47° and 50° E, respectively.

Sampling was carried out on the Belcher and results are pending. Further work is to be performed by opening and sampling the various veins on the property. A better structural picture is necessary before the full potential of the veins can be assessed.

A complete compilation of the information available on the veins and gold content was made in the Geological Report dated November 23, 1973.

Two copies of the Geology Map are enclosed.

*E. P. Sheppard*

E. Percy Sheppard, P. Eng.  
Consulting Geologist

REFERRED TO	DATE	INITIAL
ADM		
ADM (P)		
C.G.C.	✓	
C.P.R.		
D.C.C.		
ACPR		
G.C.		
ACCTS.		
G.E.O.L.	✓	
INSP.		
M. REV.		
EC. & P.		
FILE NO.		

NOV 23 '74 AM

May

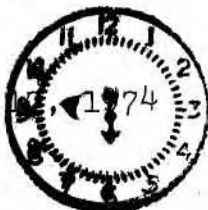

DEPT. OF MINES  
AND PETROLEUM RESOURCES

PROSPECTING REPORT  
SAM GROUP  
Alberni Mining Division  
Vancouver Island, B.C.

INTRODUCTION

The work was performed by J. Szakacs, Prospector, on the dates given below, and supervised by E. Percy Sheppard, P.Eng., Consulting Geologist.

This report is compiled from data as follows:

PROPERTY:

The SAM GROUP consists of 16 staked mineral claims, as follows:

<u>Name</u>	<u>Record No.</u>	<u>Expiry Date</u>
SAM 1-16 incl.	19946-19961	March 29, 1974

OWNERSHIP:

The claims are owned by Keywest Resources Ltd. (N.P.L.), by right of purchase from the owner.

WORK PERFORMED:

(See AFFIDAVIT ON EXPENDITURES)

Oct. 24-27, 1973

Left Vancouver 6:45 A.M. Took room at Redford Inn. Drove out to China Creek. Examined road conditions. Shopping.

Located and examined the following adits: Lower Mac, Upper Mac, Lower Belcher, Upper Belcher, Lower Shear, Upper Shear.

Condition of the adits is as follows:-

Lower Mac - Portal caved in. It appears that with 2 men it will take about 2-3 days to open this adit. Approximately 100 ft. northerly from the Lower Mac portal there is an opening; this is where the raise broke to the surface from the Lower Mac. There is a short drift and an ore shute at this point. The vein is about 6" wide and grayish in color. Some pyrite is visible. No samples were taken. The raise is in very good condition.

Upper Mac - This part of the adit is in bad shape, since the vein has been mined to the surface. About 80' of this adit is caved-in and it will take some time to clean and open it. Traced the vein right up to Williams Creek; in some places it is over 2' wide. Vein strikes N 42°E, and dips 55°SE.

Lower Belcher - The portal is caved-in; will take 2 men 4-5 days to open it.

Upper Belcher - Portal and about 50' section on surface is caved due to stope mining to surface.

Located Upper and Lower Shear adits. Upper Shear adit is open; 30' long. Took channel samples every 5 ft. Lower Shear adit is caved; worked on opening it.

Sampled and mapped Lower Shear adit. The underground workings are in good condition; no caved-in. Nothing left behind in this adit but the rail ties. The shearing could be seen on west side of Mineral Creek and also the first crosscut to the east; 60' long, and the face is still in shear. The shearing is a lot wider than 45' which is mentioned in the old report.

Prospected shear zone. The shearing was followed by outcrops for a length of approximately 2000' on strike. It varies in width from 57' on the extreme southerly part to 200' on the northern exposure. It is mineralized with pyrite which appears to be gold-bearing.

Nov. 13-16:

Traced shear zone across the property over the ridge to Yellow Creek.  
General reconnaissance of the claims and a review of work done.

March 1-10, 1974:

Surveyed proposed road from China Creek, including old mining road. The old logging road is in good shape; one day will be required for the Cat to clear it. The distance from China Creek road to the break in the logging road is 5414 feet. From the break to Station 4 is 3436 feet. Road should be widened to 20' and cleared. From Station 4 the new access road extending north through SAM 11, 4, 13 and 16, passes the adits and continues up the hill for a sufficient distance to allow prospecting of the north part of the property. Length of this new access road is 4276', with a width of 10 feet.



E. P. Sheppard  
E. Percy Sheppard, P. Eng.  
Consulting Geologist

James Szakacs  
James Szakacs  
Prospector

RESUME FOR:

James Szakacs  
275 Seymour River Place  
North Vancouver, B. C.

Date of Birth: May 12, 1935

Employment Record:

Present .....Development Miner for Canadian Mining Services  
620-475 Howe St.  
Vancouver

Sub-contractors for: Canadian Tungsten Ltd., N.W.T.

1972-74: Prospecting, sampling, line-outting, and  
general mechanical work for PAVAN EXPLORATIONS LTD  
818-510 W. Hastings St.  
Vancouver

1970-71: General prospecting in B.C. for: Bralorne Mines  
320-355 Burrard St.  
Vancouver

1964-70: Underground mining at Goldbridge for Bralorne-  
Pioneer Mines Ltd.

1961-64: Underground mining at Elliot Lake, Ontario

1958-61: General underground mining for various  
companies in Eastern Canada

- - - -

CERTIFICATE FROM: B.C.Dept. of Education, Secondary  
School Correspondence Division, Victoria

No. 2137-15 - June 20, 1967 - Geology 12 -  
Letter Grade: "A" (86-100%)

- - - -

SUPPLEMENT TO PROSPECTING REPORT - SAM GROUP

I have observed Jim Szakacs' field work over the years and wish to state that his knowledge of geology and requirements for prospecting are far beyond what would have been gained by any short academic course. As a prospector, his personal knowledge of mining is extremely valuable.

The work outlined in the accompanying Prospecting Report was carried out after consultations with Jim, and under my personal supervision. The final results were discussed with him and our future plans outlined.

SIGNED: E. P. Sheppard  
E. Percy Sheppard, P.Eng.  
Consulting Geologist



March 20, 1974  
Vancouver, B. C.

C E R T I F I C A T E

I, E. PERCY SHEPPARD, of the City of Vancouver, in the Province of British Columbia, hereby certify THAT:

I am a Consulting Geologist, with offices at 314-402 West Pender St., Vancouver 3, B.C.;

I am a graduate of Dalhousie University, with a B.Sc. in Geology, and have been active in mining exploration and geophysics for over 30 years

This report is compiled from observations and data obtained during my visits to the property during November 13-16, 1973 and March 8-10, 1974, and a study of pertinent Government reports and maps;

I have no direct or indirect interest in the property under discussion and do not expect to receive any such interest;

I am a member of the Professional Engineers Association of British Columbia, the American Institute of Mining Engineers, and a Fellow in the Geological Association of Canada.

DATED AT VANCOUVER, B.C., this 20th day of March 1974.

*E. P. Sheppard*

E. Percy Sheppard, P.Eng.





AFFIDAVIT ON EXPENDITURES

Keywest Resources Ltd  
SAM GROUP

PERSONNEL: E.Percy Sheppard, Consultant  
314-402 W. Pender St.  
Vancouver 3, B.C.

Jas. Szakacs, Prospector  
275 Seymour River Road  
North Vancouver

Gary Burnie, Field Assistant  
c/o 818-510 W. Hastings St.  
Vancouver

Jack McCann  
c/o 818-510 W. Hastings St.

----

Oct. 24-27: 1973		
Jas. Szakacs: 4 days @ \$60/day	.....	\$ 240.00
General Expenses (Food, lodging)	.....	113.00
Nov. 13-16:		
Jas. Szakacs: 4 days @ \$60/day	.....	240.00
Gary Burnie: 4 days @ \$50/day	.....	200.00
E.P. Sheppard: 4 days @ \$150/day	.....	600.00
General Expenses (Food, lodging)	.....	127.89
March 1-10, 1974:		
Jas. Szakacs: 10 days @ \$50/day	.....	500.00
Jack McCann " " @ \$35/day	.....	350.00
E.P. Sheppard: 3 " @ \$150 "	.....	450.00
General Expenses (Food, lodging)	.....	336.00
4-wheel drive hire	.....	173.00
ASSAYS: \$90.70, \$22.70	.....	113.40
DRAFTING:	.....	75.00
TOTAL	.....	<u>\$3,518.29</u>

I, E. PERCY SHEPPARD, of the city of Vancouver, in the Province of British Columbia, make the above declaration, conscientiously believing it to be true and knowing it is of the same force and effect as if made under oath and by virtue of the Canada Evidence Act.

E. P. Sheppard

Declared before me at the City of Vancouver in the Province of British Columbia, this 20 day of March 1974, A.D.

G. Phillips

~~Commissioner for taking affidavits for British Columbia.~~

Sub-mining Recorder



Appendix  
 ASSAYERS  
 CHEMISTS  
 GEOCHEMISTS

# CORE LABORATORIES LTD.

325 Howe Street Vancouver 1, B.C. Phone 688-3504

## Certificate of Analysis

REPORT NO.  
 1150-30-7031

SAMPLE(S) FROM: PAVAN EXPLORATION  
 818 - 510 West Hastings  
 Vancouver, B.C.

SAMPLE NO.	Au (oz/t)
Face of second x-cut 5'	<.003
2nd x cut 0-13'	<.003
2nd x-cut 13'-23'	<.003
2nd x-cut 23'-33'	.02
2nd x-cut 33-43'	.01
2nd x-cut 43-53'	.02
Upper Shear Adit 0'-5'	.08 ✓
Upper Shear Adit 10'-15'	.10 ✓
Upper Shear Adit 5'-10'	.05
Upper Shear Adit 15'-20'	.04
Upper Shear Adit 20'-25'	.04
Upper Shear Adit 25'-30'	.08 ✓
Lower Shear Adit 0'-5'	.04
Lower Shear Adit 5'-10'	.03
Lower Shear Adit 10'-15'	.01
Lower Shear Adit 15'-20'	.03 ✓
Lower Shear Adit 20'-25'	.02
Lower Shear Adit 25'-30'	.02 ✓
Lower Shear Adit 30'-35'	.02
Lower Shear Adit 35'-40'	.03
Lower Shear Adit 45'-50'	.03 ✓
Lower Shear Adit 40'-45'	.05 ✓
Lower Shear Adit 50'-55'	.02
Lower Shear Adit 60'-55'	.29 ✓



DATE 31 October 1973

SIGNED *[Signature]*

# CORE LABORATORIES LTD.

325 Howe Street Vancouver 1, B.C. Phone 688-3504

## Certificate of Analysis

REPORT NO.  
1174-30-7031

SAMPLE(S) FROM: PAVAN EXPLORATION  
818 - 510 West Hastin g  
Vancouver, B.C.

SAMPLE NO.	Ag (oz/t)
Upper Shear Adit 0'-5'	.06
Upper Shear Adit 10'-15'	.08
Upper Shear Adit 25'-30'	.07
Lower Shear Adit 15'-20'	.07
Lower Shear Adit 40'-45'	.08
Lower Shear Adit 55'-60'	.10



DATE 6 November 1973 SIGNED *E. P. Sheppard*

124°45' 73

74

75

Alberni 5 1/2 m

77

78

To Parksville Parksville 22m

40'

80

81

82

49°15'

56

55

54

53

52

51

50

49

48

47

46

45

44

55

55

54

53

52

51

50

49

48

47

46

45

44

Locharkaige & N. Ry

4

Rogers Creek

Bainbridge Lake

Pipe Line

Intake

China Creek

ROAD

Creek

Road

Department of  
Mines and Petroleum Resources

ASSESSMENT REPORT

NO. **4915** MAP # **151**

M C L A U G H L I

16	15	8	7
14	13	6	5
12	11	4	3
10	9	2	1

RIDGE

A L B E R N I

SAM GROUP

KEYWEST RESOURCES LTD. (NPL)

PATLICANT MTN.

4088

Sizard Lake

SCALE 1" = 1.25 mi



INVOICE

TELEPHONE 688-3504

# CORE LABORATORIES LTD.

325 HOWE STREET - VANCOUVER 1, B.C.

ASSAYERS  
CHEMISTS  
GEOCHEMISTS

CHARGE TO

PAVAN EXPDORATION  
818 - 510 West Hasting  
Vancouver, B.C.

INVOICE N<sup>o</sup> 1174

30-7031

SHIPPED TO:

DATE: 7/11/73	REFERENCE NO.:	YOUR ORDER NO.:
---------------	----------------	-----------------

SHIPPED:	VIA:	TERMS: NET 30 DAYS	UNIT PRICE	TOTAL
----------	------	-----------------------	------------	-------

6 6	Rock preparation Ag assay		0.70 3.50	4.20 <u>21.00</u>
	Less 10% discount			\$ 25.20 <u>2.50</u>
				<u>\$ 22.70</u>





INVOICE

TELEPHONE 688-3504

CORE LABORATORIES LTD.

325 HOWE STREET - VANCOUVER 1, B.C.

ASSAYERS  
CHEMISTS  
GEOCHEMISTS

CHARGE TO

PAVAN EXPLORATION  
818 - 510 West Hastings  
Vancouver, B.C.

INVOICE No 1150  
30-7031

SHIPPED TO:

DATE: 1/11/73	REFERENCE NO.:	YOUR ORDER NO.:
---------------	----------------	-----------------

SHIPPED:	VIA:	TERMS: NET 30 DAYS	UNIT PRICE	TOTAL
----------	------	-----------------------	------------	-------

24  
24

Rock preparation  
Au assay

*Re Sam Group*

0.70  
3.50

16.80  
84.00

Less 10% discount

\$ 100.80  
10.10  
\$ 90.70



UPPER SHEAR ADIT

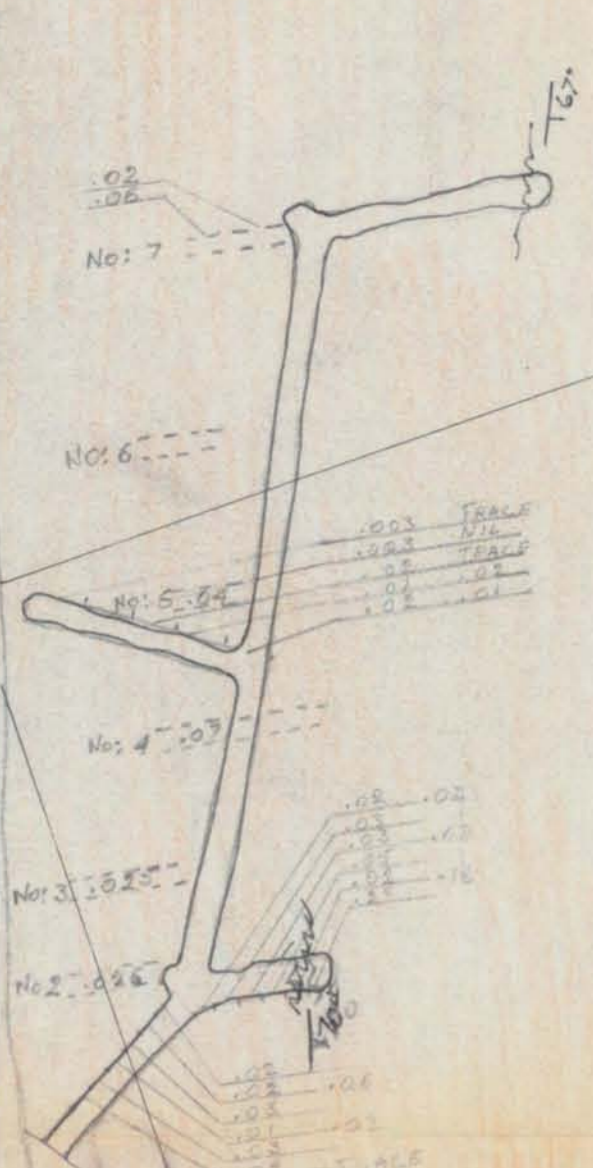

LOWER SHEAR ADIT

DUNSMUIR ADIT

SHAFT

STOPE

STOPE

UPPER BELCHER ADIT

RAISE

SEC 1

STOPE

UPPER MAC ADIT

SEC 2

LOWER BELCHER ADIT

LOWER MAC

270' EL

280' EL

2900' EL

Department of  
Mines and Petroleum Resources  
ASSESSMENT REPORT  
NO. 4915 MAP #3

SAM GROUP  
ADIT PLAN  
ALBERNI M.D.  
SCALE 1" = 40'



**4915 M3**

E. P. SHEPPARD & ASSOCIATES LTD NOV '77

COMPRESSOR HOUSE

ORE BIN

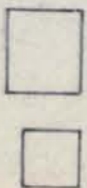

Eastern shear  
Hanging wall shear

2600' EL

175'

18,500' EL  
18,500' EL  
18,500' EL

9,800' EL

10,000' EL

3,100' EL

10,200' EL

3,000' EL

10,200' EL

10,200' EL

10,200' EL

10,200' EL

10,200' EL

10,200' EL



WATER  
FALL  
VENT



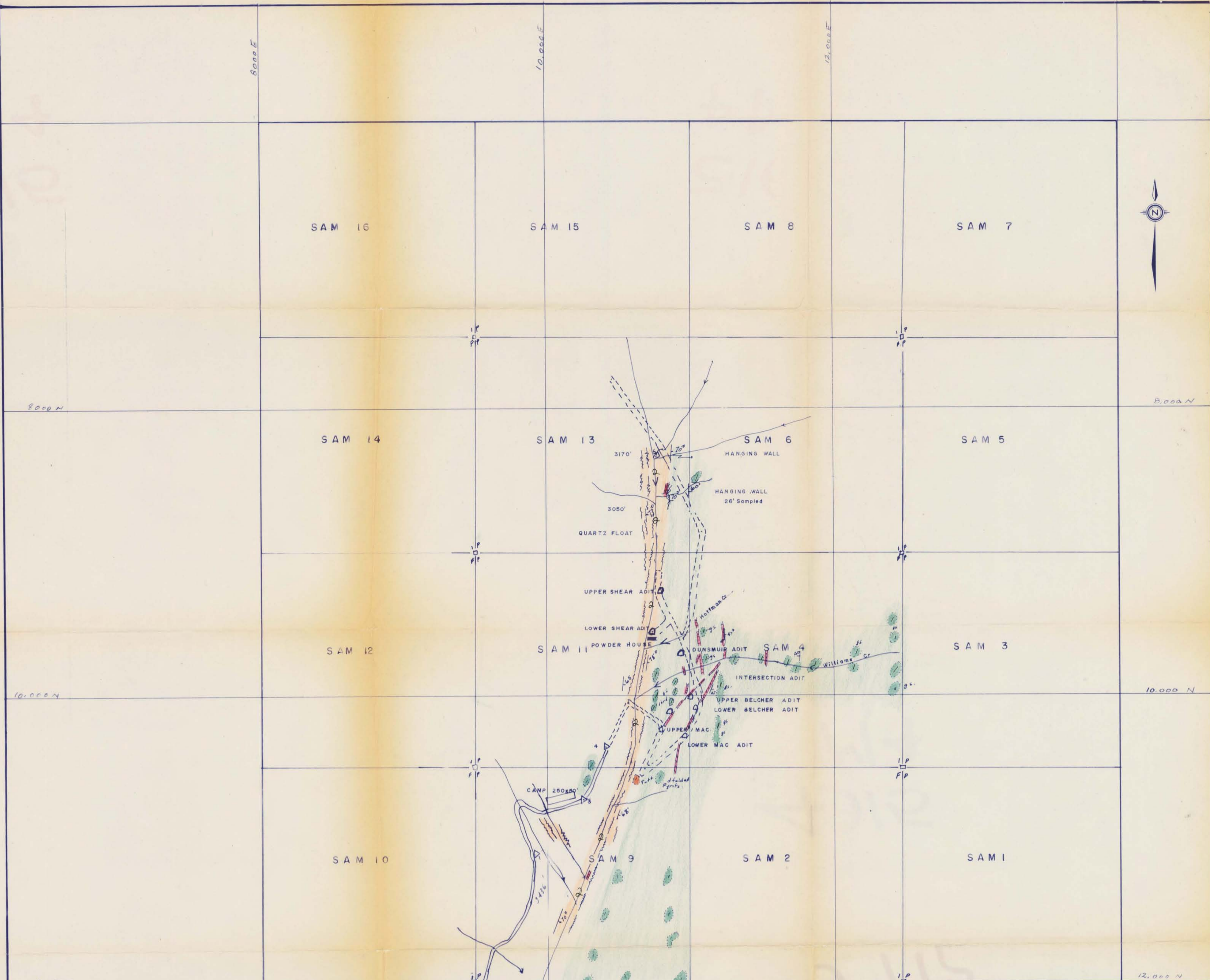

- LEGEND
- QUATERNARY  
PLEISTOCENE & RECENT  
Glacial and alluvial deposits
  - PERMIAN & EARLIER  
SICKER GROUP
  - 3 LIMESTONE, ARGILLITE
  - 2 Grey wacke, argillite, conglomerate  
banded tuff
  - 1 Volcanic breccia and tuff, altered to  
greenstone and greenschist; banded tuff, chert
  - QUARTZ VEIN
  - SHEAR
  - BEDDING DIP & STRIKE
  - OUTCROP
  - ROAD, BUILDING

**4915  
M4**



Department of  
Mines and Petroleum Resources  
ASSESSMENT REPORT  
NO. **4915** MAP **#4**

GEOLOGY MAP  
KEYWEST RESOURCES LTD (N-P-L)  
SAM GROUP  
ALBERNI M.D., B.C.  
SCALE 1" = 400'

MARCH 1974

FROM TO FEET  
BREAK 4 3436  
" N END 4278  
WIDTH 10'

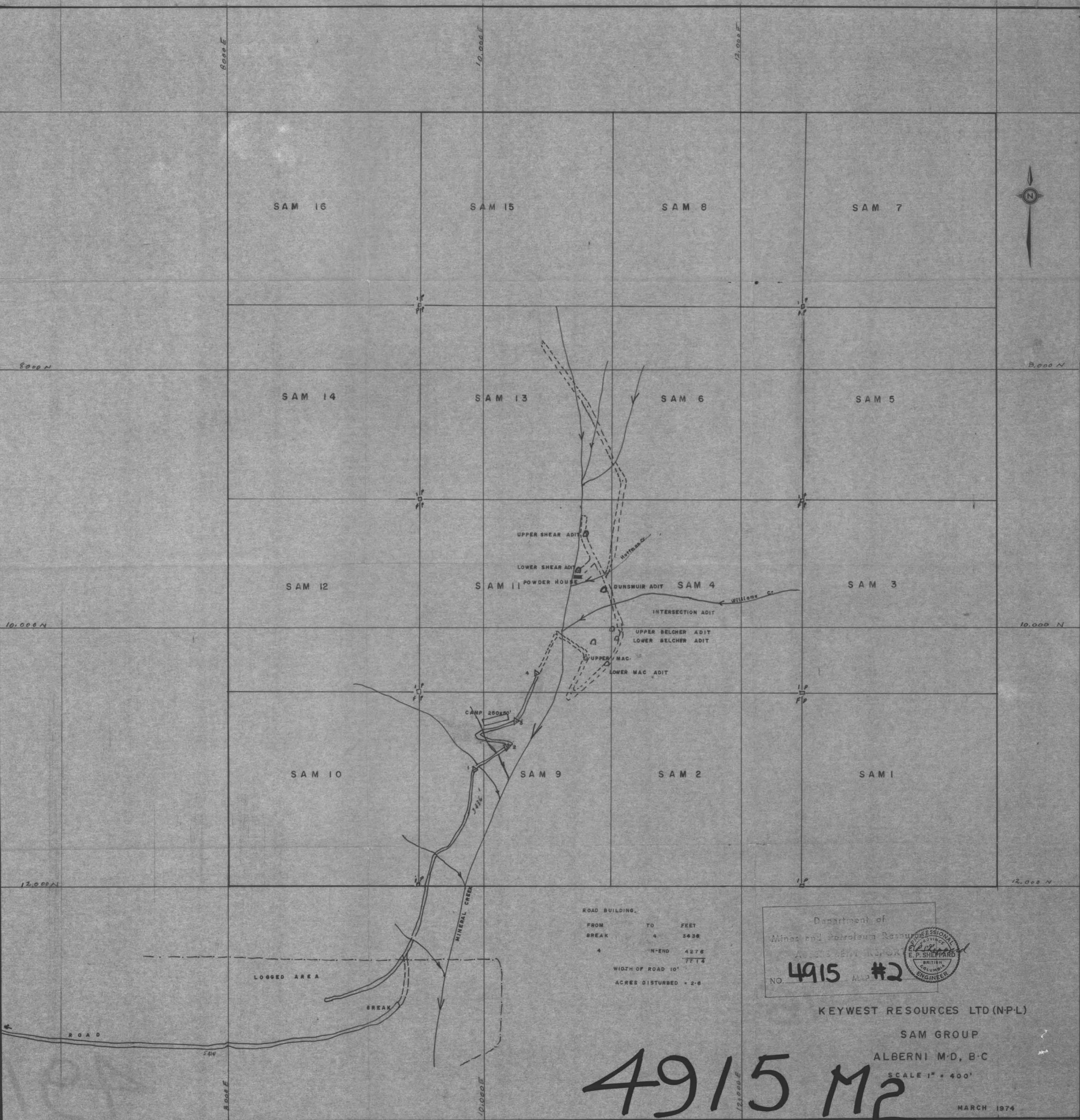

ROAD BUILDING.

FROM	TO	FEET
BREAK	4	3438
4	N-END	4276
		7714
WIDTH OF ROAD 10'		
ACRES DISTURBED = 2.8		

Department of  
 Mines and Petroleum Resources  
 PROVINCE OF BRITISH COLUMBIA  
 ASSISTANT ENGINEER  
 E. P. SHEPPARD  
 BRITISH COLUMBIA  
 ENGINEER

NO. **4915** M.P. #2

KEYWEST RESOURCES LTD (N-P-L)  
 SAM GROUP  
 ALBERNI M.D., B.C.  
 SCALE 1" = 400'

**4915 M2**

MARCH 1974