

4951

92F/5E

PROSPECTING REPORT

ON

MINERAL CLAIMS NUB 1-2, CUB 5-10

Record Numbers 18982-83, 17767-72
in the Alberni Mining Division
20 miles north of Tofino

49° 27' North Latitude
125° 45' West Longitude

APPENDICES

- | | | |
|------|-------------------------------------|----------------------|
| #1 A | Index Map | Scale 1" = 136 miles |
| #2 B | Claim Map | " 1" = 1500 Feet |
| C | Tabulation of Claim Data | |
| #3 D | Relationship to other properties | |
| #4 E | Noble Creek Section | 1" = 200 Feet |
| #5 F | Dry Creek Section | 1" = 100 Feet |
| G | Statement of costs | |
| H | Declaration of Competency, W. Guppy | |

May 1, 1974

Department of
Mines and Technical Resources
ASSESSMENT REPORT
NO. 4951

NOTES ON PROSPECTING REPORT - CUB GROUP MINERAL CLAIMS

During 1973 systematic prospecting was carried out on the Cub Mineral Claims. This program was conducted with the following objectives.

1. To relocate and examine known gold-bearing quartz veins in the area. (See under "History" below.)
2. To check anomalies found in a previous geochemical survey and look for mineralization in nearby outcrops that would account for these anomalies.
3. To further investigate the possibilities of a large, low-grade ore-body occurring in the area.

Claims and Title

Golden Hinde Mines Ltd. (N.P.L.) holds 14 contiguous mineral claims in the group. Attached is a tabulation marked Appendix "C" with data pertaining to these claims. Also attached is a photocopy of a section of Map 92F/5E (M) showing the claims in relation to other claims in the area, marked Appendix "D" and a map on the scale of 1" to 1500' marked Appendix "B" which shows an outline of the claim group and areas where work was carried out.

Location and Access

The claims cover the area drained by Dry Creek and the lower part of the valley of Noble Creek. Both these streams are tributaries on the northwest side of Bedwell River about 6 miles inland from tidewater at the head of Bedwell Sound. Access is by means of trails branching from the main Bedwell River road, which is an improved logging road located over the old Department of Mines access road originally constructed previous to 1914.

History

Bedwell River is among the oldest known mining areas in British Columbia. Placer gold was discovered here in the 1860's and Chinese placer miners were active in the area until around 1889 and were reported to have had a settlement consisting of several cabins near the mouth of Noble Creek. Lode gold and copper prospects were first located in the area around the turn of the century. Some of these are still held as Crown grants. The Cub claims represent a re-location of some of these old prospects. The most comprehensive report on the area is B. C. Department of Mines Bulletin #8 by H. Sargent, published in 1940. This report mentions narrow quartz veins on Noble Creek and disseminated

mineralization on Dry Creek. These are areas covered by the Cub claims.

Mineralization

Maps marked Appendix "E" and Appendix "F" outline the areas traversed. Appendix "E" covers the Noble Creek section on a scale of 1" to 100' and Appendix "F" the Dry Creek section on a scale of 1" to 200'. Some of the narrow quartz veins mentioned in Bullitin #8 are shown in the Noble Creek section. One other was found just north of the area mapped. It is proposed that this will be mapped in a supplementary report to follow at a later date. The stock-work of quartz veins and disseminated mineralization mentioned by Sargent is shown above the northerly fork of Dry Creek. Some indications of disseminated mineralization that could be tied in with geochemical anomalies in gold, silver, copper and molybdenum were also found south-west and north-east of Dry Creek indicating a large area of low-grade mineralization in this area.

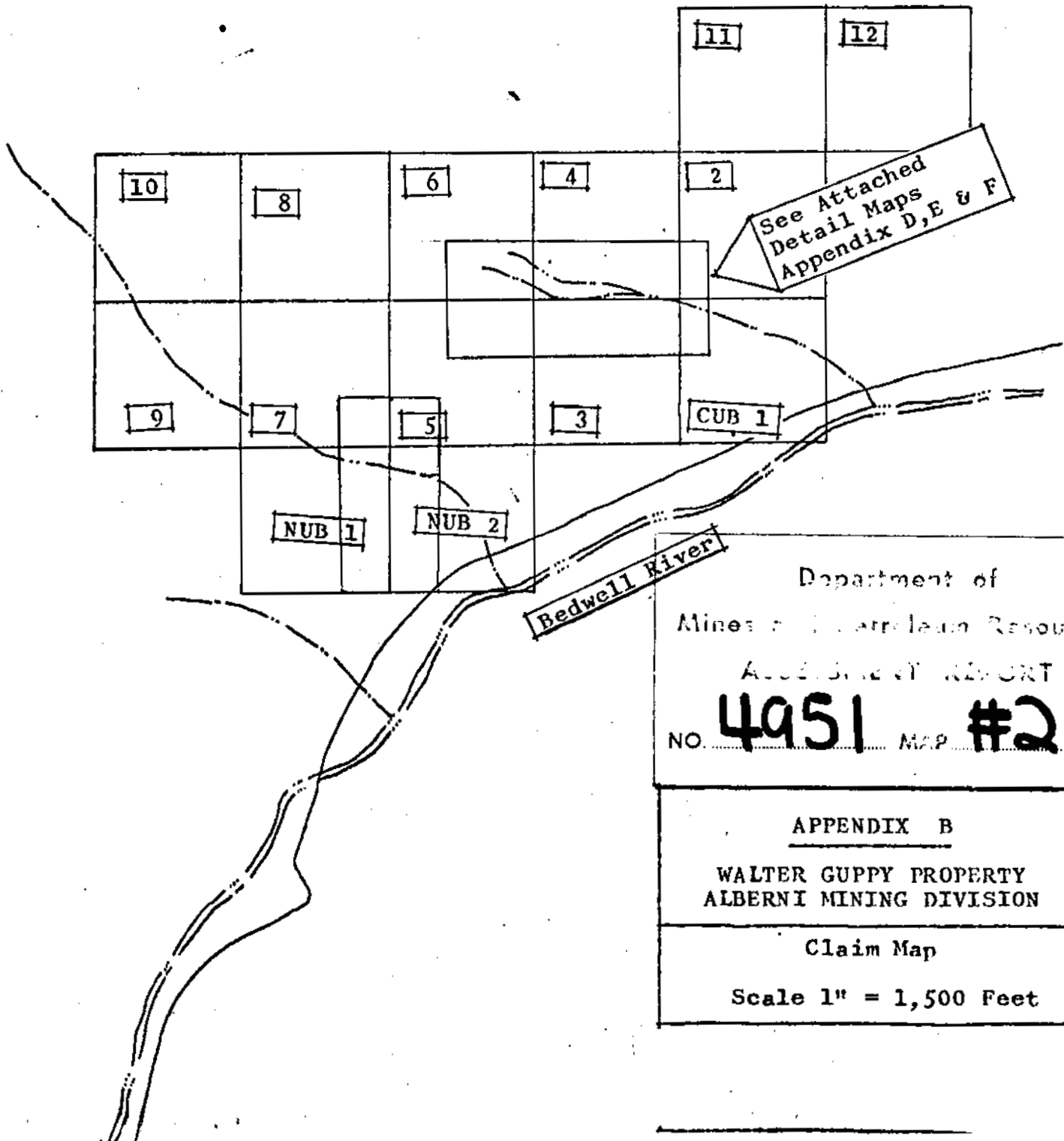

Department of
 Mines and Geotechnical Resources
 ASSESSMENT REPORT
 NO. **4951** MAP **#2**

APPENDIX B
 WALTER GUPPY PROPERTY
 ALBERNI MINING DIVISION
 Claim Map
 Scale 1" = 1,500 Feet

APPENDIX "C"
DATA PERTAINING TO THE CUB GROUP
ALBERNI MINING DIVISION

Claim name	Record number	Recording Date
Cub #1	19113	June 20, 1972
Cub #2	19114	June 20, 1972
Cub #3	19115	June 20, 1972
Cub #4	19116	June 20, 1972
Cub #5	17767	May 31, 1971
Cub #6	17768	May 31, 1971
Cub #7	17769	May 31, 1971
Cub #8	17770	May 31, 1971
Cub #9	17771	May 31, 1971
Cub #10	17772	May 31, 1971
Cub #11	19117	June 20, 1972
Cub #12	19118	June 20, 1972
Nub #1	18982	May 23, 1972
Nub #2	18983	May 23, 1972

CENTRAL STRATHCONA
NATURE CONSERVANCY AREA

MT. TOM TAYLOR

STRATHCONA PARK
CLASS "B"

River

Ashwood Cr.

Cr.

17700	17701	17702	17703	17704	17705
17706	17707	17708	17709	17710	17711
17712	17713	17714	17715	17716	17717
17718	17719	17720	17721	17722	17723
17724	17725	17726	17727	17728	17729
17730	17731	17732	17733	17734	17735
17736	17737	17738	17739	17740	17741
17742	17743	17744	17745	17746	17747
17748	17749	17750	17751	17752	17753
17754	17755	17756	17757	17758	17759
17760	17761	17762	17763	17764	17765
17766	17767	17768	17769	17770	17771
17772	17773	17774	17775	17776	17777
17778	17779	17780	17781	17782	17783
17784	17785	17786	17787	17788	17789
17790	17791	17792	17793	17794	17795
17796	17797	17798	17799	17800	17801
17802	17803	17804	17805	17806	17807
17808	17809	17810	17811	17812	17813
17814	17815	17816	17817	17818	17819
17820	17821	17822	17823	17824	17825
17826	17827	17828	17829	17830	17831
17832	17833	17834	17835	17836	17837
17838	17839	17840	17841	17842	17843
17844	17845	17846	17847	17848	17849
17850	17851	17852	17853	17854	17855
17856	17857	17858	17859	17860	17861
17862	17863	17864	17865	17866	17867
17868	17869	17870	17871	17872	17873
17874	17875	17876	17877	17878	17879
17880	17881	17882	17883	17884	17885
17886	17887	17888	17889	17890	17891
17892	17893	17894	17895	17896	17897
17898	17899	17900	17901	17902	17903
17904	17905	17906	17907	17908	17909
17910	17911	17912	17913	17914	17915
17916	17917	17918	17919	17920	17921
17922	17923	17924	17925	17926	17927
17928	17929	17930	17931	17932	17933
17934	17935	17936	17937	17938	17939
17940	17941	17942	17943	17944	17945
17946	17947	17948	17949	17950	17951
17952	17953	17954	17955	17956	17957
17958	17959	17960	17961	17962	17963
17964	17965	17966	17967	17968	17969
17970	17971	17972	17973	17974	17975
17976	17977	17978	17979	17980	17981
17982	17983	17984	17985	17986	17987
17988	17989	17990	17991	17992	17993
17994	17995	17996	17997	17998	17999

URSUS MTN.

URSUS

NO 4951 #3

APPENDIX "D"
TO ACCOMPANY ASSESSMENT
WORK REPORT
OUR MINERAL CLAIMS May/74

APPENDIX "G"

STATEMENT OF COSTS

ASSESSMENT WORK PROGRAM - Cub Mineral Claims

1973

Work was carried out from a base-camp nearer to the mouth of Bedwell River. Transportation was by means of a vehicle that was barged in for the purpose. A boat was also required for transportation out and for a standby in case of emergencies. The cost of the program is calculated as follows:-

Haul vehicle to Bedwell River	\$ 100.00
Hire of boat and truck	200.00
2 weeks field work for 1 man	700.00
Camp and miscellaneous expenses	100.00
Report preparation	<u>100.00</u>
	1200.00

APPENDIX "H"

Declaration of Competency, W. Guppy

I hereby certify as follows:-

1. That I am an experienced prospector and have done at least part-time field work every year since 1938 with the exception of three years spent in the Canadian Armed Services.
2. That in 1946 I took a correspondence course with the Canadian Legion Educational Services in mining. This course included geology and mineralogy. My instructor was Mr. W. M. Goodwin of the Department of Mines and Resources, Ottawa.
3. That I was employed full-time as a prospector by Nootka Explorations, 470 Granville Street, Vancouver for three years from 1967 to 1970 and by Hudson Bay Exploration & Development Co. during the 1970 season.
4. That I am well qualified to carry out the field work necessary to compile assessment work reports.

Walter Guppy

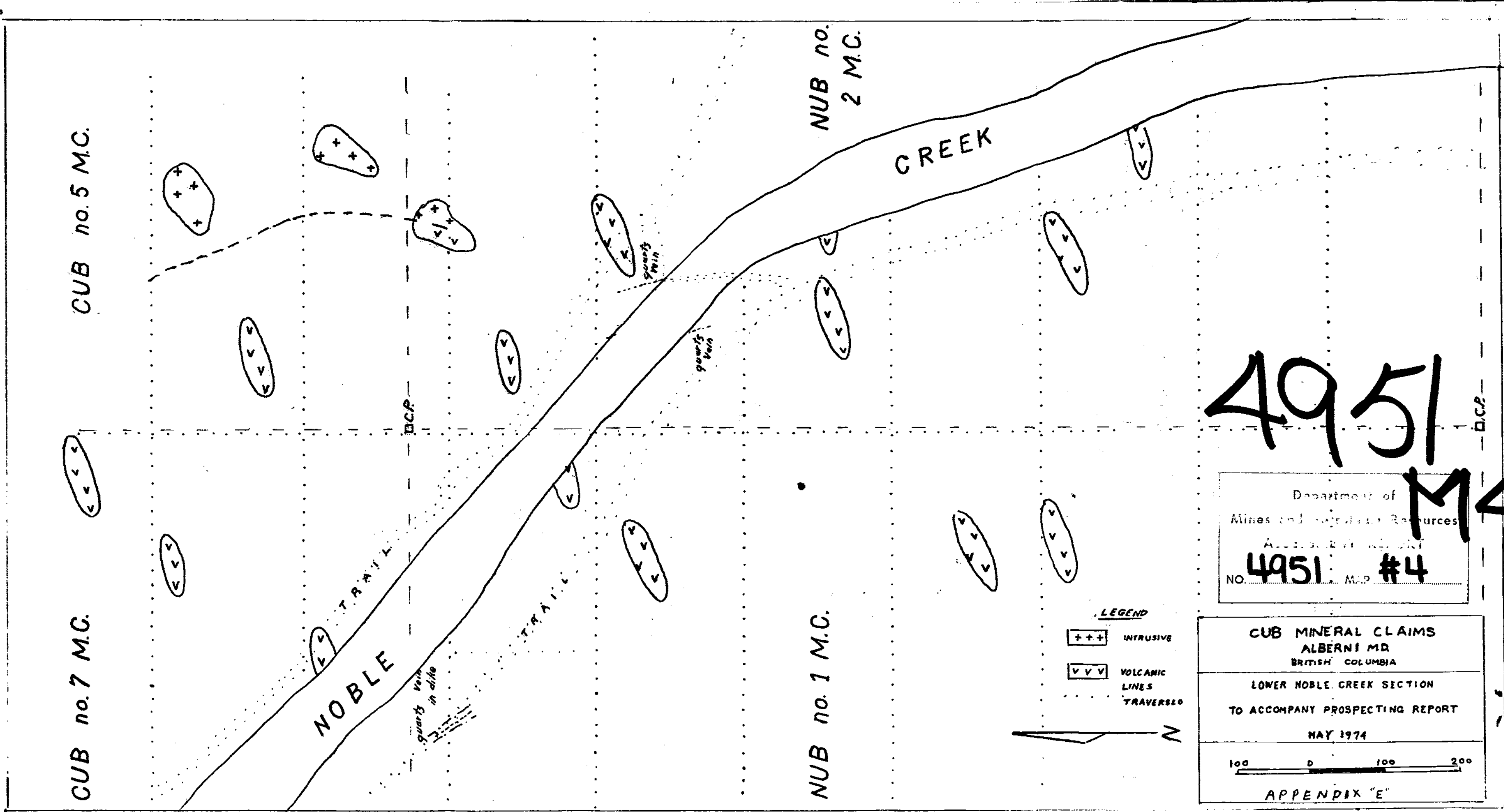

4951 M4

Department of
Mines and Geology Resources
ALBERTA
NO. 4951 MAP #4

CUB MINERAL CLAIMS
ALBERNI MD
BRITISH COLUMBIA
LOWER NOBLE CREEK SECTION
TO ACCOMPANY PROSPECTING REPORT
MAY 1974
100 0 100 200
APPENDIX "E"

Department of
 Mines and Geotechnical Resources
 ALBERTA DEPARTMENT OF
 NO. **4951** M.P. **#5**

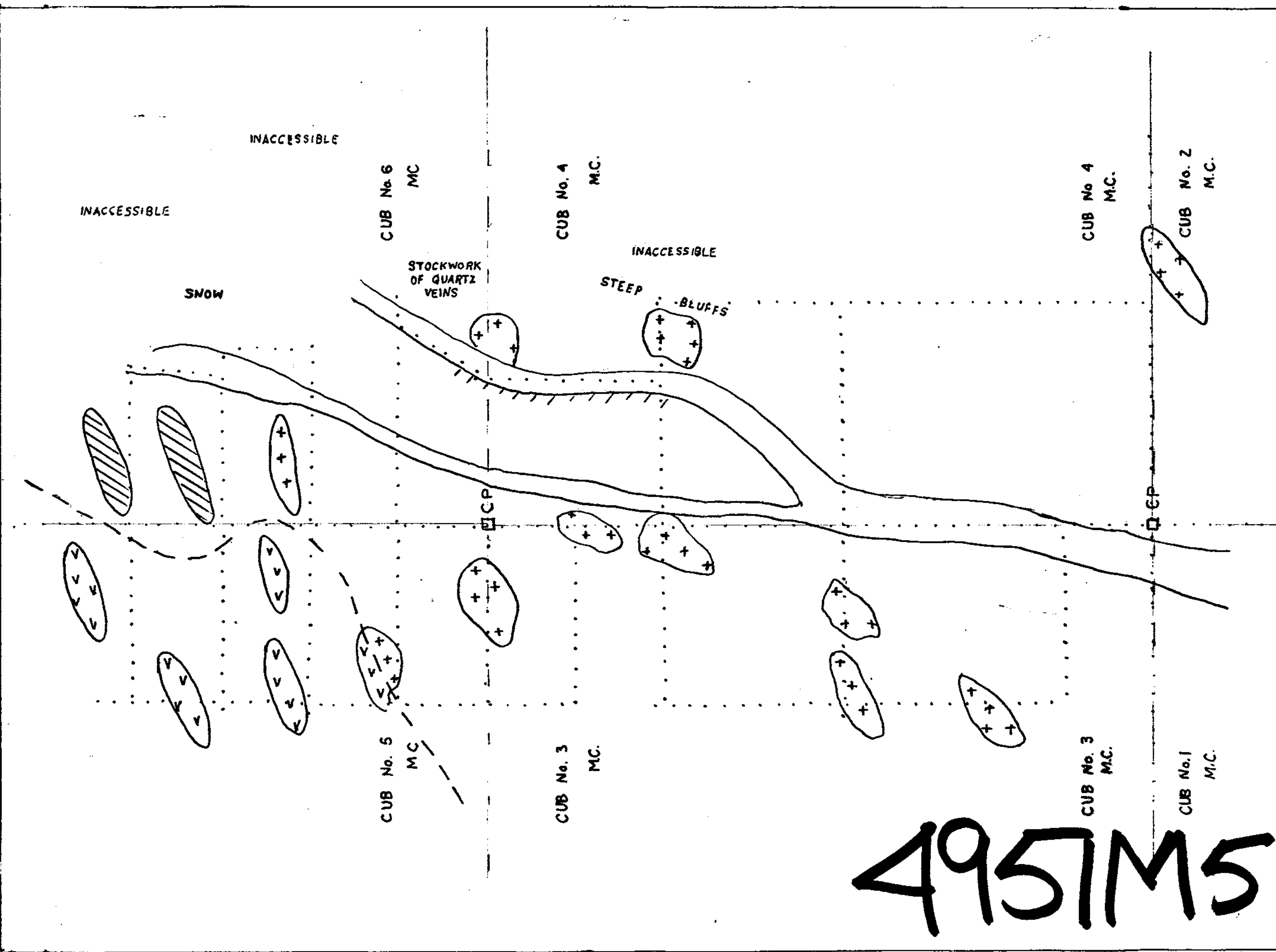

LEGEND

- +++ INTRUSIVE
- ▨ BRECCIA
- V V V VOLCANIC LINES
- LINES TRAVERSED

APPENDIX "F"

CUB MINERAL CLAIMS
ALBERNI M.D.
 BRITISH COLUMBIA

DRY CREEK SECTION

TO ACCOMPANY PROSPECTING REPORT

MAY 1974

SCALE IN FEET
 0 200 400

4951M5