

4994

MOB GROUP

92H/15E

PROSPECTOR'S REPORT

Evan Sleeman, Prospector

Vancouver, B.C.

June 11, 1974

Department of	
Mines and Petroleum Resources	
ASSESSMENT REPORT	
NO. 4994	MAP

OWNER: BRONSON MINES LTD.

Claims: Mob 1-20 inclusive

Location: Nicola Mining Division

Author: Evan Sleeman, Prospector

Dates of Work: Sept. 3-8, 1973

Prospectors: Evan Sleeman  
Jay Butterworth

Oct. 9 -12, 1973

Prospectors: Evan Sleeman  
Grant Sleeman

## Mob Group at Hornet Lakes

On Sept. 3 and Oct. 9, 1973, the writer traveled to Princeton via 4WD Ford 250 to prospect the Mob Claims.

We spent several days prospecting the various roads which make access easy with 4WD to almost all sections of the claim group, the notable exception being the S.W. corner on claims 7, 9, and 10.

On claim 11 just east of a small, rather stagnant lake on the main road is a large outcropping of granodiorite containing pyrite and a small amount of chalcopyrite. One quarter mile south on the same road, pyrite is found on an outcropping of dark diorite.

About one quarter mile farther down the road is an interesting area on the boundary of claims 8 and 14.

This area was trenched extensively a few years back by another mining company. The trenches are partially caved in now, but many copper showings are still in evidence.

The most spectacular is a small quartz shear containing high silver and copper. The copper is chalcopyrite and chalcocite with minor bornite. Though quite high grade, this vein is only inches thick and I doubt if it is important as a target by itself.

However, copper in a dark, fine grained diorite was found in trenches 300 feet to the west on the gas line. About 400 feet north of the high grade showing, chalcopyrite and bornite are found in epidote fracture fillings, and for about 200 feet to the south on the gas line.

About 75 feet west of the gas line, galena occurs in the seams of a dark brown volcanic breccia in the bottom of an old trench.

Four hundred feet to the east, several old trenches reached bed rock of the same dark, fine grained diorite containing pyrite and chalcopyrite.

Continuing on down the gas pipe line about 1500 feet for 200 feet north of the claim post containing initial tags for Mob 7 and 8 and final tags for 5 and 6, chalcopyrite is disseminated in the dark, very hard, fine grained diorite. Coarse grained light grey intrusive occurs here also, but no mineral was evident in it.

The same type dark, very hard diorite carries chalcopyrite for about 300 feet south of the claim post on the gas pipe line.

About 200 feet south of the claim post, hermatite is found in fractures of the diorite containing copper.

At 300 feet south of the claim post the rock contains no more copper with the exception of a small showing in granodiorite about 100 feet west of the pipe line and 1000 feet south of the claim post.

No commercial minerals were found on claims 9, 10 or 12. They contain many outcroppings--mostly granodiorite and coarser grained diorite.

On claim 6 just north of the road and opposite the lower Hornet Lake, a limonite stained gossan zone had been trenched. On close examination, minute disseminated chalcopyrite and pyrite were found.

Nothing of interest was found on claims 17, 18, 19, & 20. Outcrop was poor as overburden is deeper in this area.

On claim 4 east of the road and east of the upper Hornet Lake, chalcopyrite was found disseminated and in the fractures of the hard, fine grained diorite. There is also a little bornite here.

Some deep trenches in glacial till, about 1000 feet south of the last mentioned showing, did not reach bed rock but showed minor malachite staining.

This is a very interesting claim block--widespread copper mineralization could indicate areas of ore grade at depth, as some of the showings were not in evidence until the gas line uncovered them.

Respectfully submitted,

Evan Sleeman  
1561 W. 26th Ave.  
Vancouver, B.C.

DOMINION OF CANADA:  
PROVINCE OF BRITISH COLUMBIA.

In the Matter of

To Wit:

I, Evan Sleeman of 1561 West 26th Ave., Vancouver, B.C.

of

in the Province of British Columbia, do solemnly declare that the following is the true cost of work done on the Mob claims, 1-20, record nos.,

Name	DATE OF WORK	MAN DAYS	COST/DAY	TOTAL
E. Sleeman	Sept. 3-8/73	6	\$ 50.00	\$ 300.00
	Oct. 9-12/73	4	\$ 50.00	\$ 200.00
	May 25- Jun. 9/74	16	\$ 50.00	\$ 800.00
J. Butterworth	Sept. 3-8/73	6	\$ 50.00	\$ 300.00
D. Shwery	May 25-31/74	7	\$ 50.00	\$ 350.00
	Jun. 2-5	4	\$ 50.00	\$ 200.00
K. Sleeman	May 25 & 26/74	2	\$ 50.00	\$ 100.00
	June 1 & 2/74	2	\$ 50.00	\$ 100.00
	June 8/74	1	\$ 50.00	\$ 50.00
G. Sleeman	Oct. 9-12, 73	4	\$ 50.00	\$ 200.00
Geological supervision, D.C. Malcolm		3	\$125.00	\$ 375.00
Travel, 1800 miles, Ford 250 4WD @ 25¢ per mile				\$ 450.00
Camp costs @ \$10.00 per man day, 14days X 2				\$ 280.00
Magnetometer rental				\$ 150.00
Motel				\$ 138.60
Supplies, flagging tape, mosquito dope, maps, files propane gas, etc.				\$ 66.00
TOTAL				\$ 4059.60

And I make this solemn declaration conscientiously believing it to be true, and knowing that it is of the same force and effect as if made under oath and by virtue of the "Canada Evidence Act."

Declared before me at the *City*  
of *Nanaimo*, in the  
Province of British Columbia, this *12<sup>th</sup>*  
day of *June* — *1974*, A.D.

*Evan Sleeman*

*J.P. Phillips*  
A Commissioner for taking Affidavits for British Columbia or  
A Notary Public in and for the Province of British Columbia.

Sub-mining Recorder

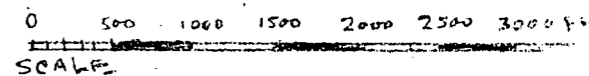

LEGEND

- ROAD
- PIPELINE
- U TRENCH
- O LAKES

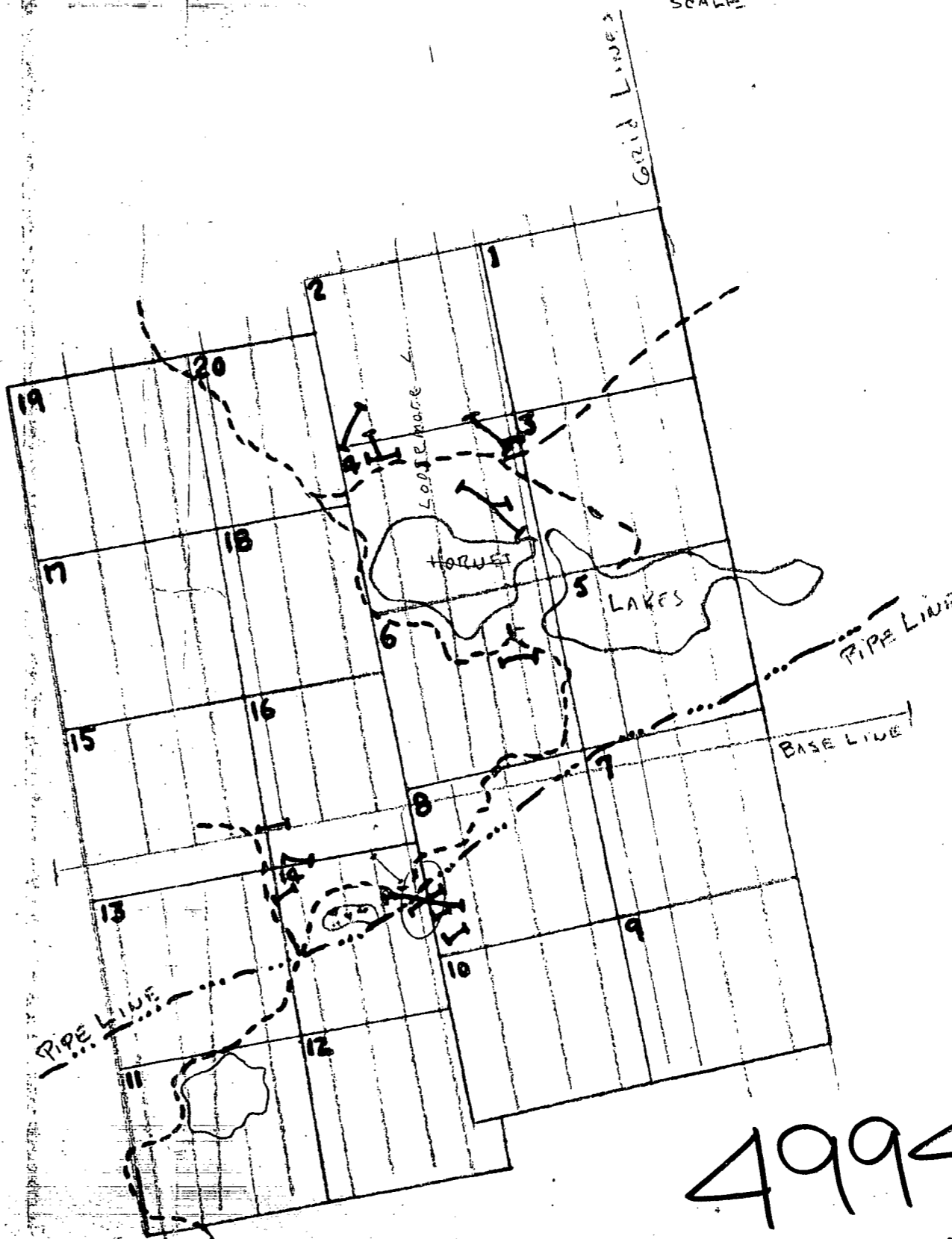

4999  
M1

HORNET LAKES PROPERTY  
BRONSON MINES

← TO MERRITT --- TO PRUCETON →  
GLADSTONE

Department of  
Mines and Petroleum Resources

ASSESSMENT REPORT

NO. **4994** MAP **#1**