

5014

92H/8W

PRELIMINARY

GEOLOGICAL REPORT

ON THE

BARB CLAIM GROUP

Similkameen M.D. $49^{\circ} 28' N$ $120^{\circ} 24' W$

92H/8W

N.T.S 92H/8W

Work done - June 19 and 20, 1973

Claims owned by G. Siemens

Vancouver B.C.
June 26, 1974

L. Sookochoff P. Eng.

Department of Mines and Petroleum Resources ASSESSMENT REPORT NO. 5014 MAP
--

CONTENTS

Introudction

Property Location and Access

Geology

Conclusions

Statement of Costs

Prospecting Report - V. Paulger

List of Illustrations

Scale

#1 Index Map

1" = 4 miles

#2 Claim Map

1" = 750 feet

INTRODUCTION

At the request on Mr. V. Paulger, a preliminary geological examination of the Barb 1-4 mineral claims was carried out. The examination was done on June 19 and 20, 1974, and the writer was accompanied by T. R. Tough, P. Eng. and also V. Paulger, who gave direction to the location of significant areas of interest which he had discovered from an earlier prospecting programme over the claim group.

PROPERTY, LOCATION AND ACCESS

The property consists of four contiguous located mineral claims located approximately four miles east of Princeton in the Similkameen Mining Division. The northern boundary of the claims is bounded by the southern trans-provincial Highway No. 3, by which access is provided.

<u>Claim Name</u>	<u>Record No.</u>	<u>Expiry Date</u>
Barb 1-4, incl.	40604-40607	June 11, 1974

GEOLOGY

The property covers andesitic and dioritic lavas of the Upper Triassic Nicola Group of rocks. Randomly oriented quartz porphyry dykes of uncertain age cut the flows. A contact between the Nicola Group and the Coast Intrusives is covered by the property.

Fault and shear zones on the property trend north-south and may be an expression of the contact zone. It is within one of these shear zones that three levels of underground development has been done. The workings follow a shear zone which is mineralized with lenses of chalcopyrite, tetrahedrite and bornite within a gangue of quartz-carbonate. The mineralization appears to be sporadic in degree but also appears to be confined to the shear zone. The porphyry dyke striking northwesterly and steeply dipping is not mineralized.

Other northerly trending but narrow (< one foot) shear zones in the vicinity of the old workings are lightly mineralized with chalcopyrite and pyrite.

Localized brownish discolorations of the soil observed on the property could reflect zones of significant copper mineralization.

CONCLUSIONS

The geological conditions found on the property are extremely encouraging for the location of economic zones of mineralization. The presence of significant structural breaks with incipient mineralization and the possibility of locating similar adjacent zones on the property warrants an active exploration programme. The programme should consist of detailed geological mapping, soil sampling and an E.M. survey. A diamond drill programme to test the prime targets would then follow.

Respectfully submitted,

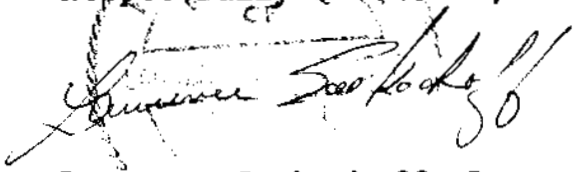

Laurence Sookochoff, P. Eng.

STATEMENT OF COSTS



L. Sookochoff, June 19 and 20, 1974

2 days @ \$150.00	\$300.00
Meals	23.00
Motel	10.00
Mileage - Vancouver to Princeton/return 390 miles @ 20¢ per mile	<u>78.00</u>
	<u>\$411.00</u>

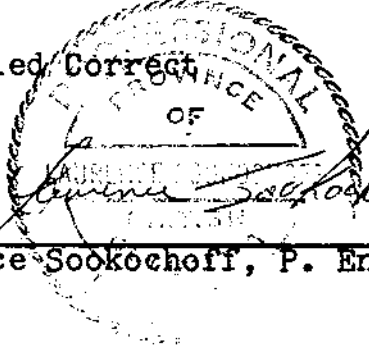
Certified Correct

Laurence Sookochoff, P. Eng.

Declared before me at the City
of Vancouver in the
Province of British Columbia, this 28th
day of June 1974, A.D.



A Commissioner for taking Affidavits within British Columbia or
A Notary Public in and for the Province of British Columbia.

SUB-MINING RECORDER

V.L. (VERN) PAULGER MINERAL EXPLORATION

897 Lethbridge Ave., Kamloops, B.C. Phone (604) 376-4265

June 15, 1973

T. R. Tough, P. Eng.
519 - 602 West Hastings Street
Vancouver, B.C.

Dear Mr. Tough:

Re: Barb Mineral Claims 1-6 inclusive
Princeton Mining Division

Following the staking of the six contiguous Barb mineral claims, Mr. G. Siemens, the owner of the claims, and I spent five days prospecting, sampling and mapping to the best of our ability the main area of known mineralization which is on the Barb 1, 2, 3 and 4 claims.

The claims are located approximately four miles east of Princeton, B.C. next to the highway.

We found what I would describe as a porphyry containing visual copper, also a high grade Cu vein in a shear zone which strikes north-south. Samples taken by myself retained assays of over 4% Cu across 8 ft. at the mouth of Adit #2 plus over 1% Cu across 6 ft. at Adit #1. I had only one sample of the (what I call) porphyry assayed which ran .95 Cu plus low silver values. I enclose a copy of my assay sheet for your records.

Following our sampling and examination of the old workings, we prospected and mapped at about 200 ft. intervals the Barb 1, 2, 3 and 4 claims. Numerous small mineralized zones were found in what I would describe as diorite and andesite shear zones from 1" to 10" wide. We followed what appears to be the contact of Granite and Nicola Group. This contact runs through the Barb 1-4 claims and, in my opinion, could well be of great importance. At the summit of the mountain we found a large gossan zone, which could also be of importance as copper can also be seen here. I would suggest that perhaps this zone should be diamond drilled to find out what, if anything, of economic importance may be found under this gossan zone.

Continued-

T. R. Tough, P. Emg.

June 15, 1973

- 2 -

It is my thought that this is one of the better copper showings I have seen since moving to British Columbia from Flin Flon, Manitoba, and although porphyry copper is something I have not been involed in very much in my 12 years of prospecting, I can honestly say this property would be one to check out carefully for such a deposit.

I would like to ask that you visit and examine these claims at your earliest convenience and perhaps make some recommendations as to a further work programme. I would, of course, pay you for your examination after which I would be willing to option this property to any of your clients, and would ask as a down payment my out-of-pocket expenses to date as follows. plus \$1,000.00 for a 1 -year option.

Expenses to date:

1. June 11-14, 1974 - Gord Siemens, 4 days @ \$40.00 per day	-	\$160.00
2. V. Paulger - 4 days @ \$60.00 per day	-	240.00
3. Meals for 2 men x 4 days @ \$12.00 per day	-	48.00
4. Room at Princeton, 4 days @ \$10.00/day	-	40.00
5. Car approx. 250 miles @ 20¢ per mile	-	50.00
6. Assays	-	30.00
7. Field equipment and supplies	-	<u>50.00</u>
	Total	<u>\$ 618.00</u>

I would hope that you could visit this property within the coming month or so, then perhaps the need of further exploration on these claims could start this summer.

May I look forward to hearing from you in this regard.

Yours very truly,

Vern L. Paulger.

c.c. G. Siemens

Declared before me at the City
of Vancouver in the
Province of British Columbia, this 28th
day of June 1974, A.D.

[Signature]

[Signature]
A Commissioner for taking Affidavits within British Columbia or
A Notary Public in and for the Province of British Columbia.

SUB-MINING RECORDER



Kamloops Research & Assay Laboratory Ltd.

WEST TRANS CANADA HIGHWAY - BOX 946 - KAMLOOPS, B.C.

B.C. LICENSED ASSAYERS
GEOCHEMICAL ANALYSTS

CERTIFICATE OF ASSAY

TO Mr. V. L. Paulger,
1355 Nanaimo St.,
Kamloops, B. C.

Certificate No. K-242

Date June 30, 1973.

I hereby certify that the following are the results of assays made by us upon the herein described Rock samples

Kral No.	Marked	GOLD	SILVER	COPPER						
		Ounces Per Ton	Ounces Per Ton	Percent	Percent	Percent	Percent	Percent	Percent	Percent
K-242-1	Barb Claim Adit #2	-	-	4.65	chip	30000'	8'			
2	Barb Claim Adit #1	.005	.305	1.45	-	"	6'			
3	EM Claim 1500' from S	Tr	.40	1.95						
4	EM Claim 3000' from S	-	-	3.30						
5	Osoyoos	.008	.322	.05						
6	Barb Claim Big Rock	Tr	.33	.95	- Bulder of Country rock by Adit #2.					

NOTE:

Rejects retained three weeks
Pulps retained three months
unless otherwise arranged.

R. S. Stender
Registered Assayer, Province of British Columbia



120° 30'

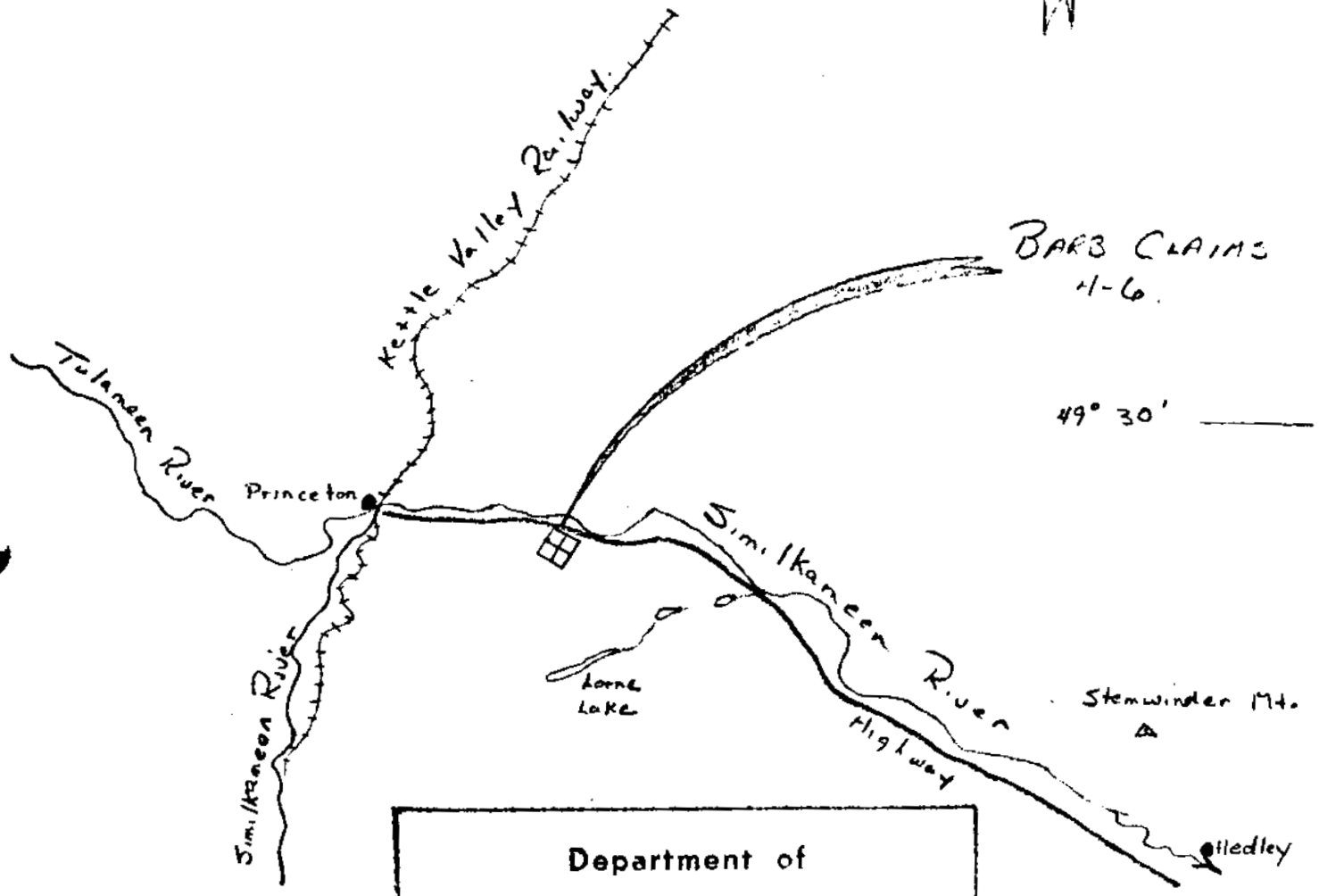

Department of
 Mines and Petroleum Resources
 ASSESSMENT REPORT
 NO. **5014** MAP **#1**

INDEX MAP.

BARB CLAIM GROUP

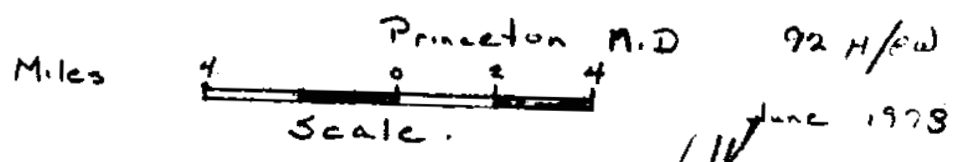

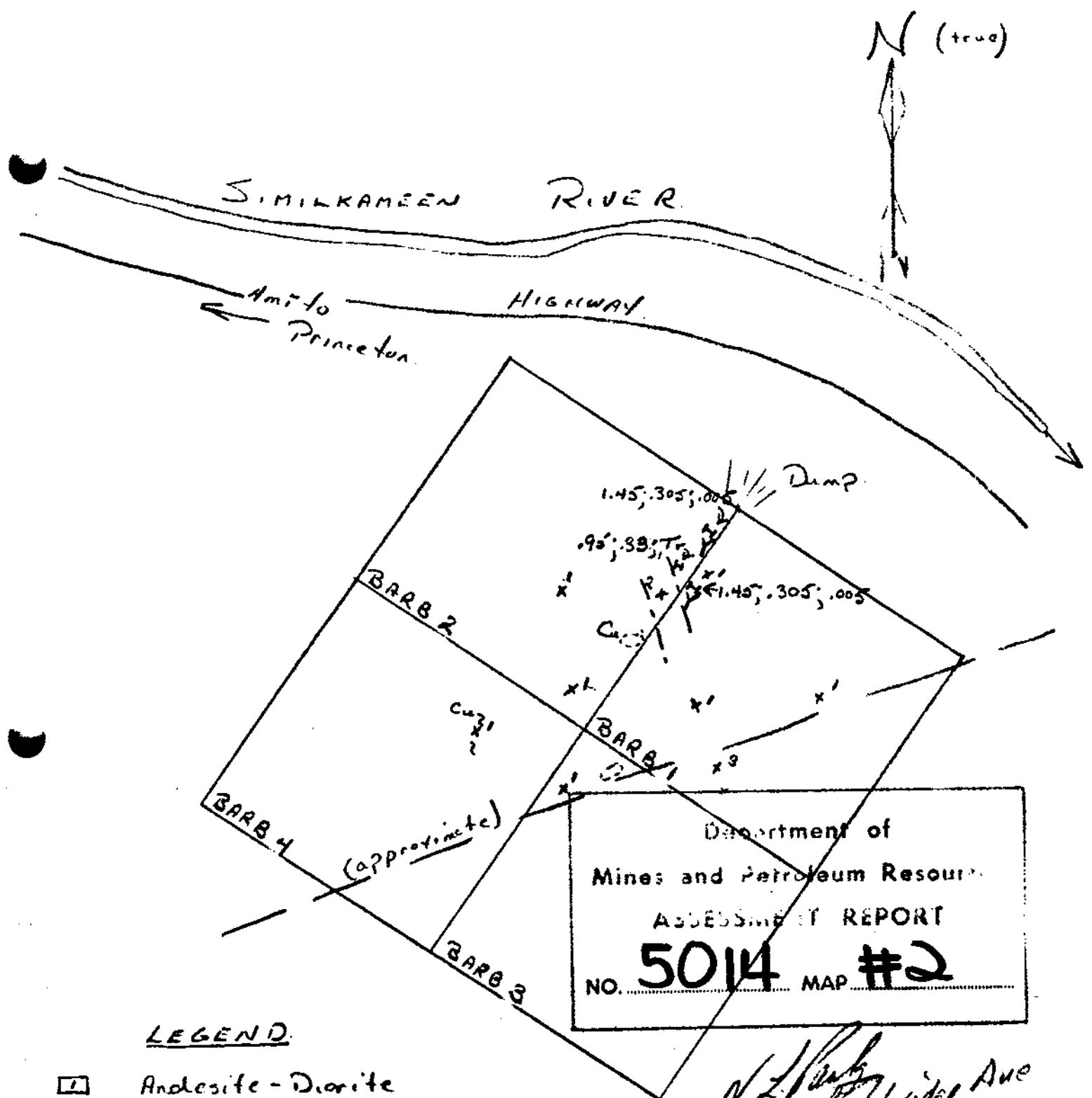

LEGEND.

- 1 Andesite - Diorite
- 2 Porphyry
- 3 Granite
- - - Shear Zone
- Contact
- x Outcrop
- o Gossan
- X Portal
- I Sample site - Cu; Ag; Au
- Cu. Copper Showing

Department of
Mines and Petroleum Resources
ASSESSMENT REPORT
NO. **5014** MAP **#2**

*N.Z. [unclear]
897 [unclear] Ave
Kamloops B.C.*

CLAIM MAP

Working's and Mineralized Outcrops
92 H/BW
June 1973

