

DIAMOND DRILLING PROJECT

ON THE OK CLAIM GROUP

LOCATION: Approximately 15 miles NNW of  
Powell River in the Bunster Hills  
Latitude 50° 03'N Longitude 124° 40'W

REPORT BY: A. W. Randall B.A. Sc.

SUPERVISED BY: B.E. Spencer, B.A. Sc. P.Eng.

WORK DONE BY: Western Mines Limited as agent for  
Granite Mountain Mines Ltd. (N.P.L.)

WORK PERIOD: January 20th to June 20th, 1974

5026 Part A

Campbell River, B.C.

July 1st, 1974

92K/2E

AWR/gk

Department of Mines and Geotechnical Resources ANNUAL REPORT 1974 No. 5026 M.P. ....
---

CONTENTS

	<u>PAGE</u>
<u>INTRODUCTION</u>	1
<u>LOCATION</u>	2
<u>DIAMOND DRILLING</u>	2
<u>DRILL LOGS AND ASSAYS</u>	2
<u>ASSESSMENT WORK</u>	2
 <u>TABLES</u>	
1. DDH LOCATIONS - 1974	5
2. DISTRIBUTION OF DIAMOND DRILLING BY CLAIMS	6
 <u>DECLARATION OF EXPENDITURES</u>	 8
<u>STATEMENT OF QUALIFICATIONS</u>	10
<u>REFERENCES</u>	11
 <u>MAPS</u>	
#1 1. GM 74-1 - DIAMOND DRILL LOCATIONS, SCALE 1"=800'	In Pocket
#2 2. GM 74-2 - LOCATION MAP SCALE 1"= 136 mi.	3
#3 3. GM 74-3 - LOCATION MAP SCALE 1" = 4 mi.	In Pocket

INTRODUCTION

In November 1973 Western Mines Limited optioned the OK property, located in the Powell River area (Vancouver Mining Division) from Granite Mountain Mines.

The OK property consists of 344 claims and fractions.

This property appears to be a fairly typical "porphyry copper" deposit with associated molybdenite. Details of the geology are given in several previous reports (noted in the references) and consequently will not be given here.

During the past 8 years various companies have optioned the property and have conducted geophysical, geological and geochemical investigations. From these studies a number of anomalous areas have been outlined. Many of these anomalies have been partly or completely drilled off. From the drilling to 1972 an estimate of reserves has been made, approximately 100,000,000 tons grading 0.32% Cu and 0.02% MoS<sub>2</sub> (Meyer, Boyle; February 1973).

The purpose of Western Mines work was to attempt to extend known mineralized zones, and to try to locate sufficient copper mineralization, grading 0.4% Cu or better, to bring this prospect up to an economic level.

### LOCATION

The OK property is located approximately 15 miles NNW of Powell River. (See map GM74-2). Access is by logging roads.

### DIAMOND DRILLING

The diamond drill hole locations are noted on Map GM74-1. Table 1 shows the drill hole locations and related information. All holes were drilled at  $-45^{\circ}$ . Inspiration Drilling of Vancouver was contracted to do the drilling. They supplied a Boyles Model 17A drill equipped to drill BQ size core. Drilling commenced on February 3rd and was terminated on June 16th. A total of 12,695 feet of drilling was done.

### DRILL LOGS AND ASSAYS

The drill logs are included under a separate cover. Samples were assayed for Cu and  $\text{MoS}_2$ . A few samples were assayed for selected other minerals. Assays are recorded on the drill logs.

### ASSESSMENT WORK

A detailed statement of expenditures is included at the end of this report. The method of distributing assessment work was as follows:

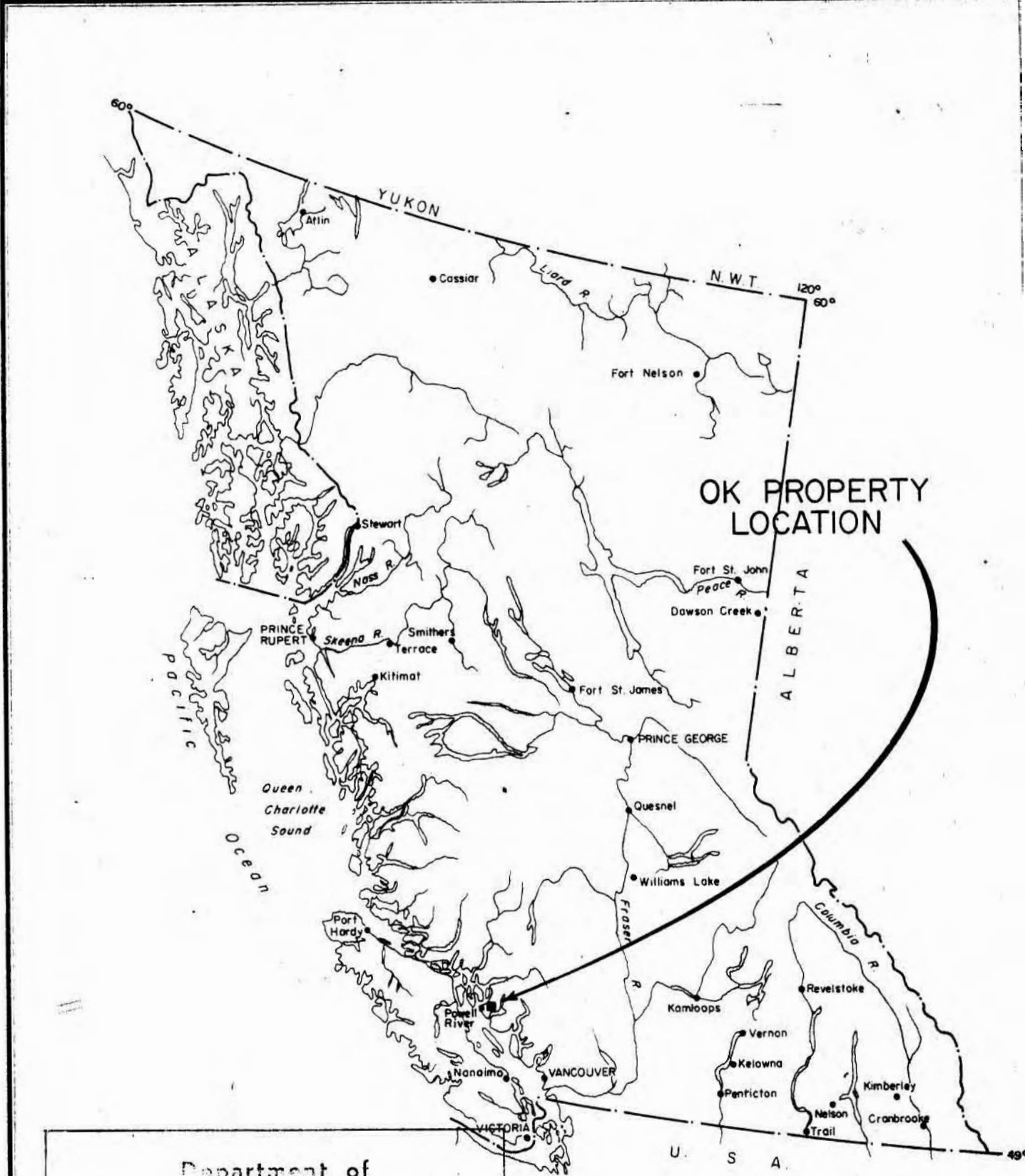

Department of  
 Mines and Petroleum Resources  
 ASSESSMENT REPORT  
 NO. **5026** MAP **#2**

WESTERN MINES LIMITED  
 LOCATION MAP

SCALE: 1" = 136 Miles  
 MAP No. 6M-2 JULY 1, 1974

- (1) The total costs were divided by the total footage drilled to determine a cost per foot of drilling.
  
- (2) This cost per foot was then multiplied by the number of feet of drilling per claim or group of claims to determine the amount of work to be applied to each group. This value was determined to be \$14.58 per foot. Table 2 shows the distribution of diamond drilling relative to the claims.

REPORT BY: A. W. Randall

SUPERVISED BY: B. E. Spencer  
P. Eng. Reg # 7876

TABLE I  
DDH LOCATION - 1974

<u>DDH NO.</u>	<u>LOCATION</u>		<u>EL. AT COLLAR</u>	<u>BEARING</u>	<u>TOTAL LENGTH</u>
	<u>N</u>	<u>E</u>			
74-1	63+30	53	2885	245	524'
2	68	50	2855	"	546'
3	76	51+45	2890	"	567'
4	76	54	2900	"	509'
5	76	56	2940	"	577'
6	84	54+50	2960	"	537'
7	84	50	2903	"	667'
8	95+64	55	2954	"	617'
9	95+64	55	2954	"	547'
10	96	58+80	2960	65°	547'
11	92	50+10	2951	245°	507'
12	99+90	56+20	3013	65	496'
13	99+60	59	3032	65	547'
14	104	55+75	3050	65	527'
15	102+60	69+40	3100	245	427'
16	104+70	72+75	3100	"	577'
17	108	72+70		"	557'
18	115+60	57		"	504'
19	164	69+20		"	697'
20	35+90	61+64	3051	"	767'
21	35+18N	65+20	3092	"	986'
22	39+90	65+33	3065	"	447'

TOTAL FOOTAGE - 1974 - 12,695'

TABLE II  
DISTRIBUTION OF DIAMOND DRILLING BY  
CLAIMS

<u>CLAIM</u>	<u>DDH</u>	<u>FOOTAGE ON CLAIM</u>
OK 1	74-1	524'
	74-2	546'
	TOTAL	<u>1088'</u>
OK 3	74-3	567'
	4	509'
	5	577'
	TOTAL	<u>1653'</u>
OK 14	74-6	537'
	7	667'
	8	617'
	9	425'
	11	507'
	TOTAL	<u>2573'</u>
OK 31	74-10	547'
	9	122'
	TOTAL	<u>669'</u>
OK 16	74-12	354'
	14	283'
	TOTAL	<u>637'</u>



TABLE II con't

OK 29	74-13	547'
	12	142'
	14	244'
	15	427'
	16	577'
	17	557'
	TOTAL	<u>2494'</u>
OK 37 & 38	74-19	697'
IN 150	74-18	504'
OK 45	74-20	536'
	21	986'
	TOTAL	<u>1522'</u>
OK 7	74-20	231'
OK 43	74-22	447'

DECLARATION OF EXPENDITURES

SUPERVISION:

A. Randall -	Jan. 15th to June 30th -	@\$1100/mo.	\$6500.00
R. Tschach	Jan. 1st to May 15th	@\$1600/mo.	\$7200.00

CORE SPLITTER:

B. Joneson -	Feb. 1st to Mar. 30th -	45 days	
		@ \$36.00/day	\$1620.00
S. Baal -	April 1st to April 30th -	25 days	
		@ \$36.00/day	\$ 900.00
S. Sandbach -	May 1st to June 10th	32 days	
		@ \$36.00/day	\$1152.00

DRILL SITE PREPARATION & DRILL MOVES:

Best Bulldozing; Powell River, hired on part time basis from January 15th to May 30th  
Cat & Swamper - 408.5 hours @ \$39.00/hour \$15,931.50

DIAMOND DRILLING

Contractor-Inspiration Drilling, Vancouver;  
12,695 ft. of BQ core \$133,219.50

BOARD & LODGING

1085 man days @ \$11.50/ man day \$12,477.50

TRANSPORT:

Company 4 x 4 (Land Rover) plus gasoline  
Jan. 15th to June 15th - 5 mo. @ \$300/mo. \$1500.00

ASSAYING

825 samples @ \$5.25/sample \$4331.25

SAMPLE SHIPPING

6880 lbs. of samples @ \$1.23/100 lbs. \$ 85.00

PREPARATION OF REPORT

A. Randall - June 24th to June 28th  
5 days @ \$55.00/day \$275.00

TOTAL \$185,191 .75

A.W. Randall

A.W. RANDALL B.A. Sc.

B. E. Spencer

B. E. SPENCER, BA. Sc. P.Eng.

Reg # 7876

STATEMENT OF QUALIFICATION

1. I, Alfred W. Randall, am a graduate of the University of British Columbia, Vancouver, B.C. B.A. Sc. (Geological Engineering) 1972.
  
2. I have practiced my profession for the past two years and for several summer seasons previous to obtaining my degree. I have been employed by the following companies: Gunnex Limited, Phelps Dodge Corp. American Smelting and Refining Company, Cordilleran Engineering, and Western Mines Limited.

A. W. Randall

A. W. RANDALL, B.A. Sc.

REFERENCES

WARES R., - REPORT ON OK PROPERTY  
BOYLAN\_MICKLE OPTION, APRIL 1971

ALLEN A.R., REPORT ON THE OK PROPERTY POWELL RIVER, B.C.  
AUGUST 1972

MEYER W., AND BOYLE P. SUMMARY REPORT 1972,  
OK PROPERTY POWELL RIVER, B.C.  
FEBRUARY 1973

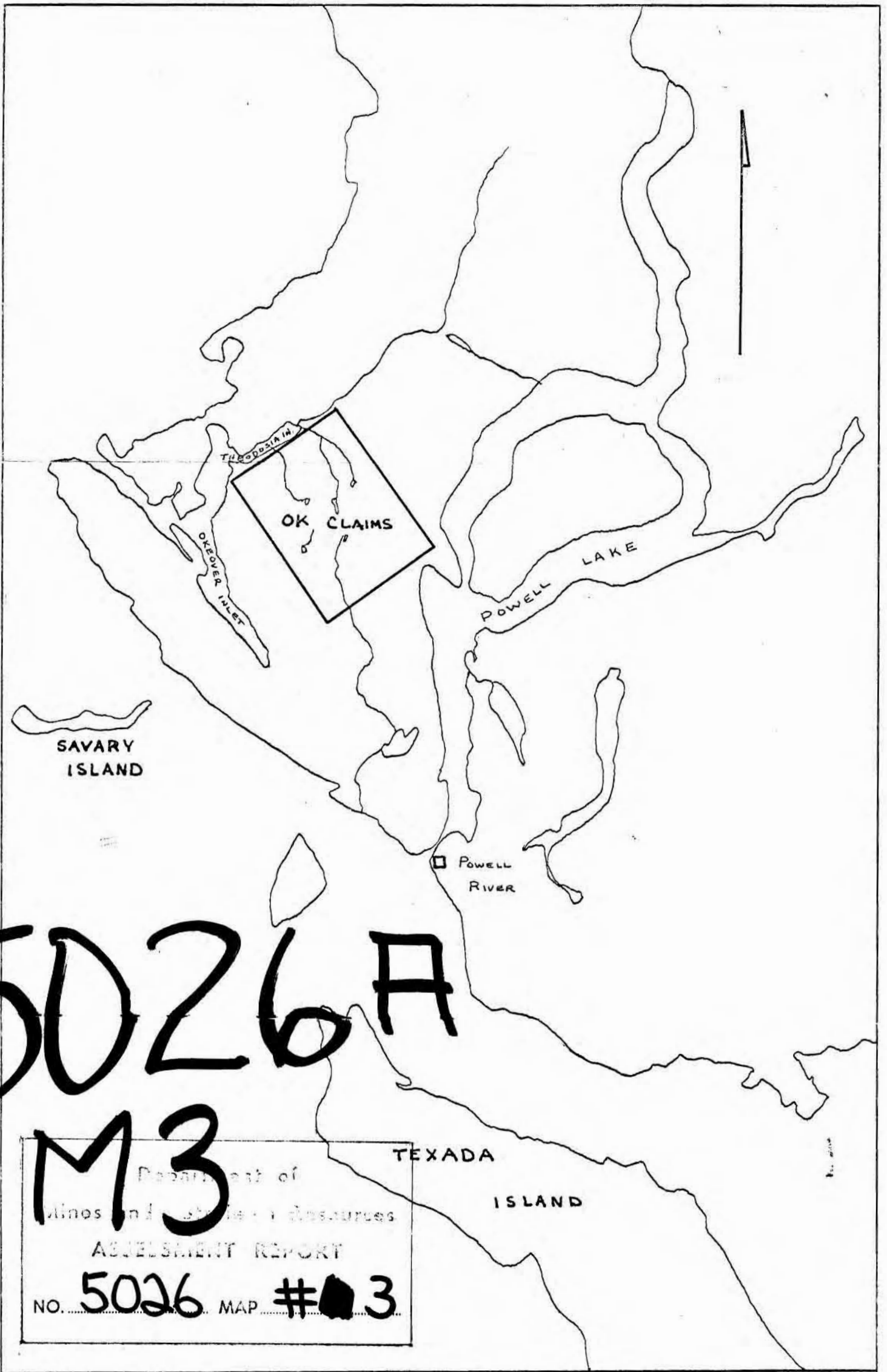

5026A

M3

Drawn by:		Traced by:	
Revised by	Date	Revised by	Date

**WESTERN MINES LIMITED**

**OK CLAIMS LOCATION**

Scale: 1" = 4mi      Date: JULY 1 1974      Plate: GM74-3

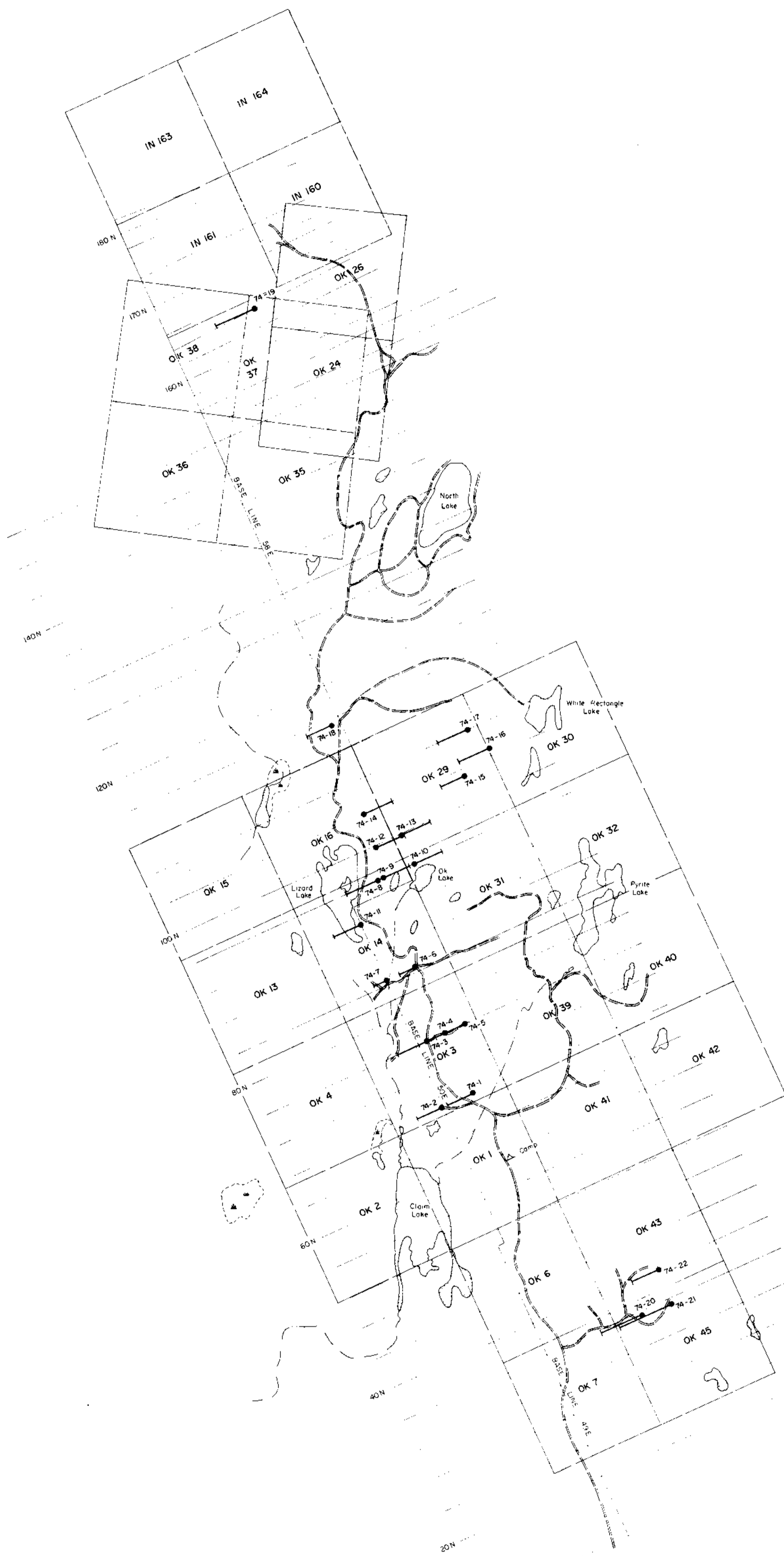

**LEGEND**

- ROAD
- DIAMOND DRILL HOLE
- CAMP

5026A

M1

NO. 5026 N.P. #1

WESTERN MINES LTD.	
GRANITE MOUNTAIN PROJECT	
DIAMOND DRILL HOLE LOCATIONS 1974	
SCALE IN FEET 0 400 800 1200 1600 2000 2400 2800	
DATE JULY 1, 1974	MAP No. GM-1