

5035

12H/10E

TOPOGRAPHIC MAPPING REPORT CLAIMS

REG 1-1, PINE 1-35,  
DY 1-8.

CLAIMS: PINE

OWNER: PACIFIC RESOURCES DEVELOPMENT LTD.

SIMILKAMEEN MINING DIVISION

Submitted April 30, 1975

92H/10E

DEPARTMENT OF MINES AND PETROLEUM RESOURCES  
VICTORIA, BRITISH COLUMBIA

RETURN TO

V8V 452



THIS REPORT GIVEN #5035 AS PREVIOUS REPORT  
#5035 NOT ACCEPTED AND RETURNED AND  
GEOL. GEOC. REPORT ON PINE CLAIMS IS NO. 5034

Department of  
Mines and Petroleum Resources  
ASSESSMENT REPORT  
NO. 5035 MAP

5035

5035

MINING CLAIM REPORT

CLAIMS: PINE

OWNER: PACIFIC RESOURCES DEVELOPMENT LTD.

SCHILLAGHEN MINING DIVISION

Submitted April 24, 1975

92H1

10E

RECEIVED BY THE MINING DIVISION  
VICTORIA, BRITISH COLUMBIA

VBV 452

THIS REPORT GIVEN #5035 AS PREVIOUS REPORT  
#5035 NOT ACCEPTED AND RETURNED AND  
GEOL. GEOC. REPORT ON PINE CLAIMS IS NO. 5034

# ALLWEST FORESTRY & RESOURCES SERVICES LTD.

5424 Imperial Ave., West Vancouver, B.C.

921 7256

FOREST MANAGEMENT  
LOGGING ENGINEERING  
FOREST INVENTORIES  
FEASIBILITY STUDIES

31 May. 1974

Project 73-010

Pacific Resources Development Ltd.  
#1700-777 Hornby Street  
Vancouver, B.C.

Dear Sir,

Herewith we submit a photogrammetric topographic map of the area east of Allison Lake covered by the Pine, Reg and Dy groups of claims. The claim locations are plotted according to the best information available, but during our field reconnaissance before mapping the area, we were not able to find the location line of the eastern row of claims (Pine 5/6 - Dy 1/2). We feel that it is advisable to survey the location lines of these claim groups and plot these on this map in order to have factual data to work with.

Part of the area is covered by merchantable timber stands and in order to facilitate exploration it may be desirable to have some of these stands logged by one of the established Quota holders in the Similkameen Public Sustained Yield Unit.

Part of the area is covered by Immature Lodgepole Pine stands or stands of low economic value and care should be taken not to damage these stands unnecessarily.

Road construction does not pose serious problems as many access roads exist. New roads should be located before construction starts and damage to timber and soils should be kept to a minimum.

Lack of time prevented us from completing more of the planned field work, but we hope to have the opportunity to do this next season.

Yours truly

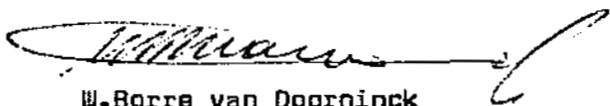

W. Borre van Doorninck  
President

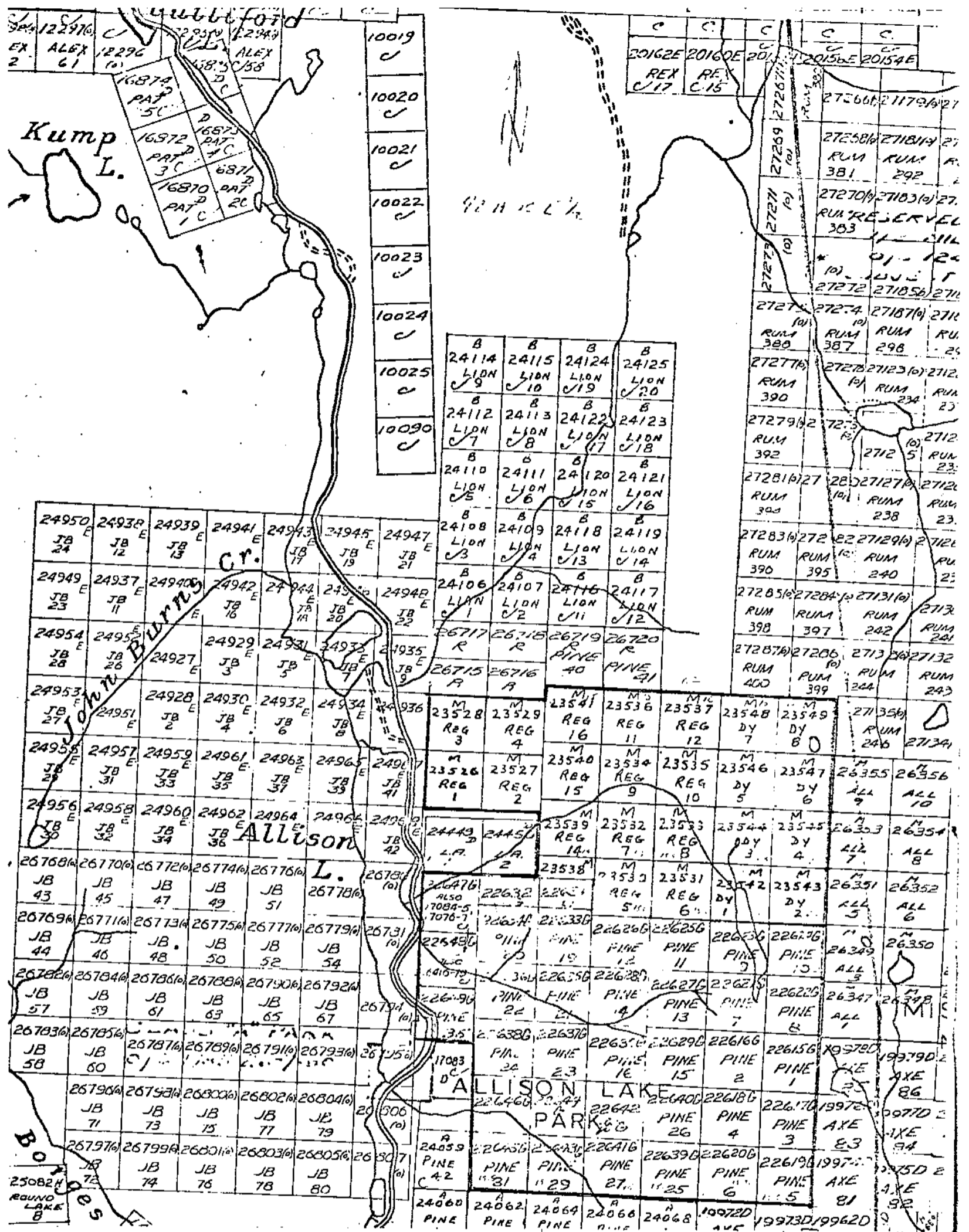

Department of  
 Mines and Petroleum Resources  
 ASSESSMENT REPORT  
 NO. 5035 MAP 1  
5035  
MI



Scale: 1" = 400'  
1:4800

Location Map of  
PINE, REG & DY Claims  
East Allison Lake

for

PACIFIC RESOURCES DEVELOPMENT LTD.

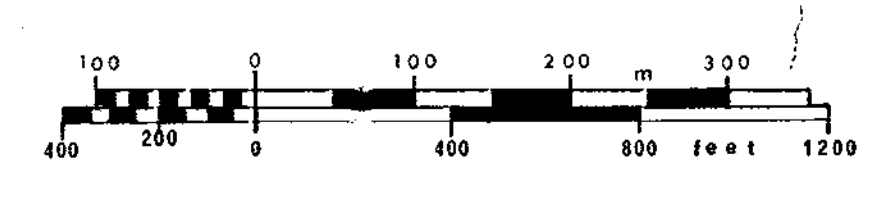

5035  
M2

Department of  
Mines and Petroleum Resources  
ASSESSMENT REPORT  
NO. 5035 MAP 2.

Legend

- |               |                  |   |
|---------------|------------------|---|
| ROADS         | TIMBER TYPE      | ⊙ |
| MAIN          | DENSE MATURE     | ⊙ |
| LOGGING       | SCATTERED MATURE | ⊙ |
| SKID          | IMMATURE         | ⊙ |
| BUILDINGS     | OPEN             | ⊙ |
| POWER LINE    | LOGGED 1967      | ⊙ |
| FENCE         | SWAMP            | ⊙ |
| TIMBER TYPE   | SLIDE            | ⊙ |
| BOUNDARY      | PHOTO CENTER     | ⊙ |
| GAS PIPE LINE |                  |   |
| CLAIM         |                  |   |
| BOUNDARY      |                  |   |
| INITIAL POST  |                  |   |