

5074 II

THE GRANBY MINING COMPANY LIMITED
PHOENIX COPPER DIVISION
Box 490 GRAND FORKS B.C.

82F/6W

PALMER OPTION PROJECT

Interim Report On D.D.H. No 1

by
James Paxton B.A.Sc. P.Eng.

August 20th 1974

Department of Mines and Petroleum Resources ASSESSMENT REPORT NO. 5074 MAP.....

James Paxton

TABLE OF CONTENTS

1. General Description
2. Cost Statement
3. Statement Of Qualifications
- #5 4. Index Map - Scale: 1:50,000
- #6 5. Surface Plan - Scale: 1" = 400'
6. Drill Core Logs - DDH N^o 1

GENERAL DESCRIPTION

The PAR claims are owned by Mr. Richard Palmer of Nelson B.C. In 1973 an options agreement was made between The Granby Mining Co. Ltd. and Mr. Palmer covering exploration work on the PAR and other claims in the area of Morning Mountain five miles south of Nelson B.C.

In July 1974 a D-6 Cat was moved to the property and Palmer's old trail running from the old logging road along the west side of Giveout Creek westward to the 5400 foot elevation on the east flank of Morning Mountain was made passable to 4WD vehicles.

At the end of July the decision was made to do a minimum of 600 feet of diamond drilling on the PAR claims

On August 1st 1974 an agreement was made between The Granby Mining Co., Ltd. and Connor's Drilling Ltd., 155 West 3rd Ave., Vancouver B.C. to do the drilling.

On August 8th a helicopter pad was cleared on the top of Morning Mountain ridge.

On August 13th drilling equipment and a two man camp were moved from the

Nelson airstrip to Morning Mountain by
Okanagan Helicopters Ltd.

Camp was set up on Morning Mountain.
A diesel pump was placed at the top of
Palmer's trail. Water was brought by gravity
to this pump from a small stream 500 feet
to the south and then pumped up to the
camp against a head of 700 feet.

Hole No 1 was collared on August 16
and was completed on August 19 at a
depth of 200 feet.

Hole size - A Q giving a 1 1/16" dia. core
Hole azimuth - 015°
Hole inclination - -45°
Hole elevation - Approx. 6100 feet
Overburden depth - 8 feet
Core recovery - 93%

The core is stored in a core rack near the
driller's camp and the helicopter pad and is
approximately 300 feet northwest of the
hole collar.

COST STATEMENT

At the time of writing this report billings and detailed cost statements from Connors Drilling Ltd., and Okanogan Helicopters Ltd. are not available and will be included in the final report on the project.

However, the basic cost of the drilling as per contract with Connors Drilling Ltd is:

Drilling in rock, 0-300 feet, \$10.85 a foot

Drilling in overburden, 0-50 feet, \$10.85 a foot

Therefore, costs incurred in drilling hole No 1 are:

0 to 8 feet in overburden at \$10.85 a foot = \$86.80

8 to 200 feet in rock at 10.85 a foot = 2083.20

\$ 2,170.00

STATEMENT OF QUALIFICATIONS

The undersigned graduated from the University of Saskatchewan with a B.A.Sc. degree, major in geological sciences, in 1953.

One year of honors geology was taken in 1954 at University of Manitoba

Since graduation the undersigned has been employed on various mining and exploration projects. Since 1964 the undersigned has been employed by The Granby Mining Co Ltd on both mine and exploration geology projects in B.C.

The undersigned is a member C.I.M., fellow of the G.A.C. and a member of the Association of Professional Engineers of B.C.

JAMES PAXTON P.Eng.
Senior Mine Geologist
The Granby Mining Co Ltd.,
Phoenix Copper Division

Signed:

James Paxton

To Creston Kaslo 45 m

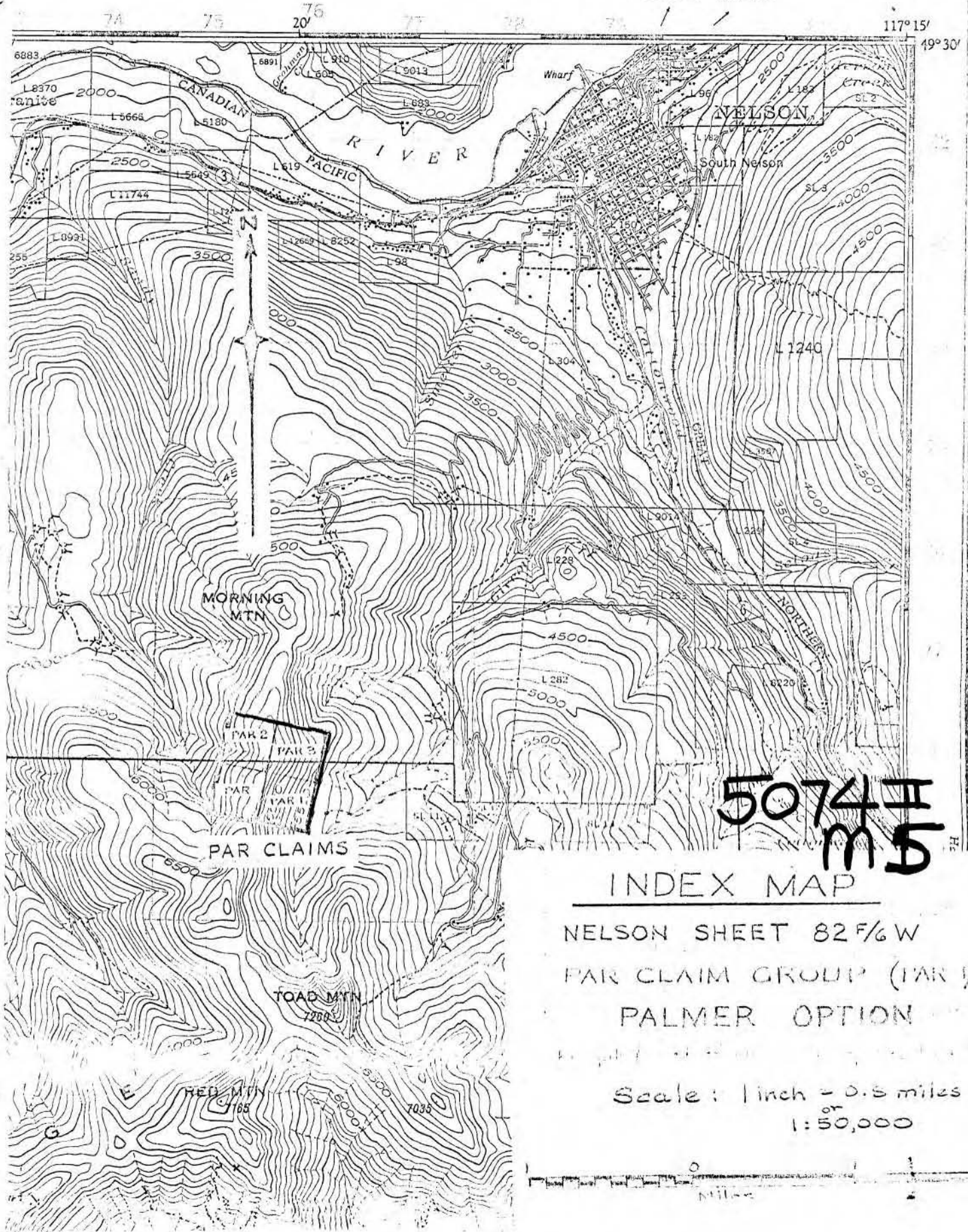

5074 II MS

INDEX MAP

NELSON SHEET 82 F/6 W
PAR CLAIM GROUP (PAR 1/4)
PALMER OPTION

Scale: 1 inch = 0.5 miles
or
1:50,000

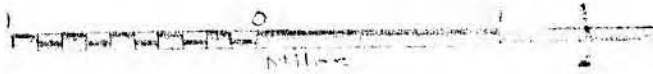

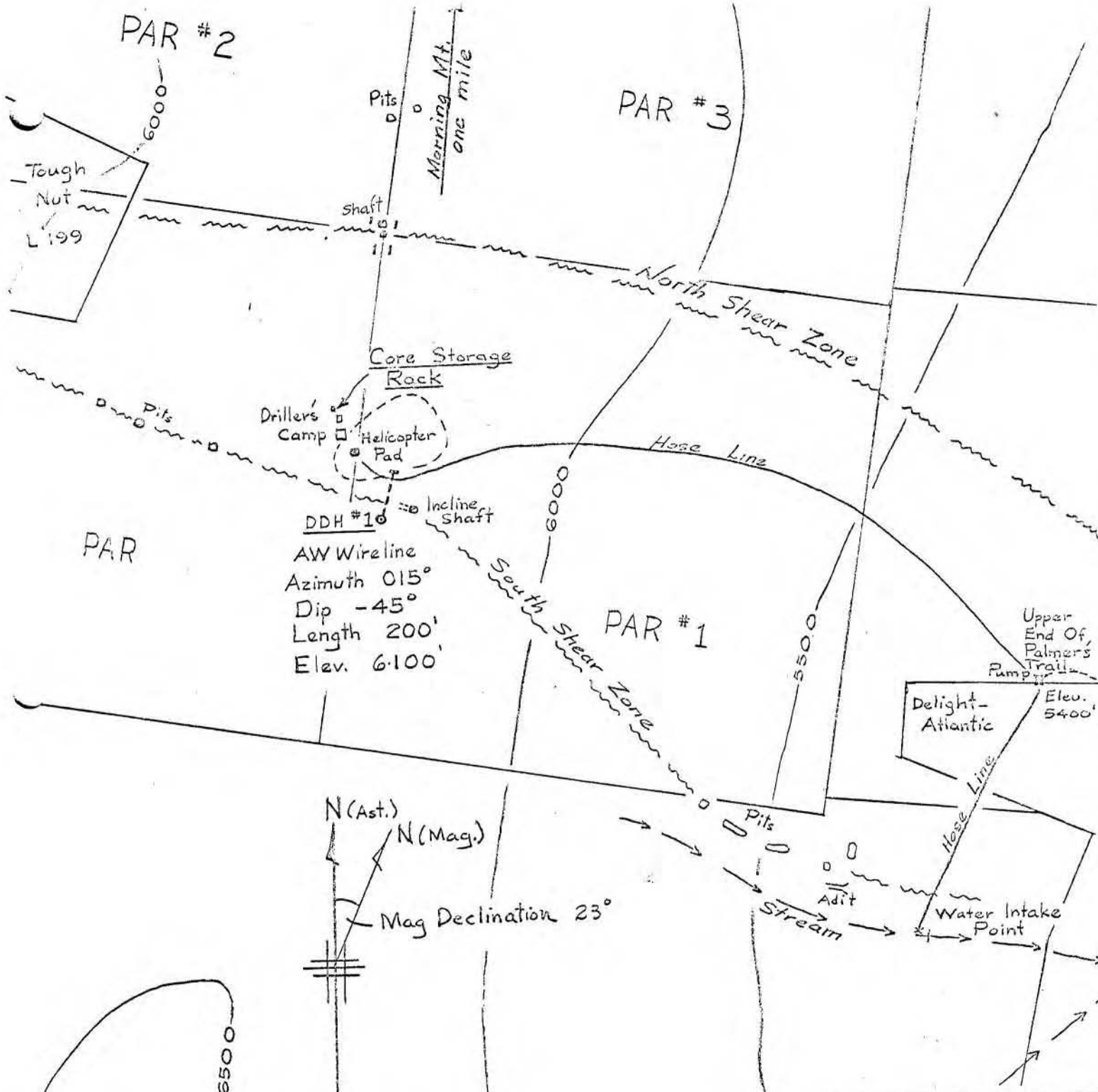

Department of
 Mines and Petroleum Resources
 ASSESSMENT REPORT
NO. 5074 II #6
 MAP

SURFACE PLAN	
PALMER OPTION	
DDH No 1	
Scale: 1"=400'	Aug. 1974
Drawn: James Poston 1974	

DIAMOND DRILL HOLE RECORD

THE GRANBY MINING COMPANY LIMITED
PHOENIX COPPER DIVISION, GRAND FORKS, B.C.

PROPERTY *Palmer Option, Nelson B.C.*

DIP TESTS			LEVEL		LAT.	HOLE NO.
FOOTAGE	ANGLE		LOCATION	ELEVATION	DEP.	SHEET NO.
	RECORDED	CORRECTED			BEARING	LOGGED
					LENGTH	TOTAL R

FOOTAGE		ROCK TYPE	MINERALIZATION	DESCRIPTION	CORE ASSAYS						SLUDGE ASSAYS					REC RUN		
FROM	TO				SAMPLE No.	FROM	TO	% CU.	OZ. AU.	OZ. AG.	AVERAGE	SAMPLE No.	FROM	TO	% CU.		OZ. AU.	OZ. AG.
107	103			<i>Lamprophyre Dyke</i> <i>Consists of med grained dark brown biotite. Contacts at 80° to core</i>														
103	156			<i>Chlorite Sericite Schist</i> <i>Similar to previous section but finer grained and slightly less schistose</i>														
156	158			<i>Talc Schist</i> <i>Grey to black color. Blocky core</i>														
158	200			<i>Chlorite - Sericite Schist</i> <i>Similar to section 103-156. Local short vuggy oxidized sections 185-188. S. Quartz veins, vuggy and limonite stained</i>														
	200			<i>End of hole.</i>														
				<u>Summary</u>														
				<i>0-200 Chlorite Sericite Schist</i>														
				<i>61-71 Oxidized zone with Pyrite + Mag</i>														
				<i>93-101 Oxidized schist with quartz veins, Malachite</i>														
				<i>107-123 Lamprophyre dyke</i>														
				<i>156-158 Talc Schist</i>														
				<i>signed James P. P. Aug 19, 1974</i>														

James P. P.

DIAMOND DRILL HOLE RECORD

THE GRANBY MINING COMPANY LIMITED
PHOENIX COPPER DIVISION, GRAND FORKS, B.C.

PROPERTY Palmer Option, Nelson, B.C.

DIP TESTS		LEVEL	LAT.	HOLE NO.
FOOTAGE	ANGLE		DEP.	SHEET NO.
	RECORDED	CORRECTED		
Cellar	-45°			
		LOCATION <u>PAR N° 1</u>		
		ELEVATION <u>6100, Approx.</u>	BEARING <u>N 015° E</u>	LOGGED
		FINISHED <u>Aug 19 1974</u>	LENGTH <u>200'</u>	TOTAL RE

FOOTAGE		ROCK TYPE	MINERALIZATION	DESCRIPTION	CORE ASSAYS						SLUDGE ASSAYS					RECC RUN
FROM	TO				SAMPLE NO.	FROM	TO	% CU.	OZ. AU.	OZ. AG.	AVERAGE	SAMPLE NO.	FROM	TO	% CU.	
0	10			Casing through overburden												
10	107			Chlorite - Sericite Schist												
				10-22 Brown stained. Iron minerals												8
				all oxidized to limonite												11
				22-26 Typical unaltered rock												15
				Grey-green color, Hardness 3-4												18
				Strongly schistose at 70° to core axis												22
				Aphanitic with 2-3mm lenticular grains												27
				of green chlorite comprising 20-30%												32
				of total rock. Numerous very fine (>1mm)												37
				subhedral grains of magnetite (9% of												42
				total rock) and pyrite (2% of total rock)												47
				Occasional specks of chalcopirite noted.												52
				26-28 Brown oxidized schist												57
				29-61 Similar to section 22-26												62
				49-51 Oxidized zone surrounding a												67
				small fault cutting foliation at 90°												72
				55-56 Oxidized zone at 80° to core												77
				filled with a network of irregular												82
				secondary white quartz veins												87
				61-71 Brown limonite stained, vuggy												92
				oxidized zone. Much pyrite												97
				leached fine magnetite and pyrite												102
				71-75 Similar to section 22-26												107
				75-76 Oxidized zone												112
				76-93 Grey-green schist similar to												117
				Section 22-26												122
				93-101 Numerous short sections of												126
				oxidized schist surrounding small												131.6
				irregular vuggy quartz veins. Specks												136
				of malachite noted at 102'												140
																145
																150.5

James [Signature]