

5082

MOB GROUP

GEOLOGICAL REPORT

92 H/15E

BY

D.C. MALCOLM, B.A.Sc., P. Eng., 2568

CONSULTING GEOLOGIST

Vancouver, B.C.

July 15, 1974

| | |
|-------------------------------|-----------|
| Department of | |
| Mines and Petroleum Resources | |
| ASSESSMENT REPORT | |
| NO. 5082 | MAP |

MOB GROUP

OWNER: BRONSON MINES LIMITED (N.P.L.)

Claims: Mob Mineral Claim Numbers 1 to 20, inclusive

Location: Princeton

Latitude: 49°

Longitude: 120° N.W.

Nicola Mining Division

Author: D.C. MALCOLM, B.A.Sc., P. Eng., 2568

Dates of Field Work: September 3, 1973 to June 8, 1974

C O N T E N T S

| | Page |
|--------------------------|------|
| SUMMARY. | 2 |
| LOCATION | 2 |
| CLAIMS | 2 |
| TOPOGRAPHY | 3 |
| HISTORY. | 3 |
| GENERAL GEOLOGY. | 3 |
| CLAIM GEOLOGY. | 4 |
| ROCK TYPES | 4 |
| DEPOSITS | 5 |
| CONCLUSION | 6 |
| REFERENCES | 6 |

MAP IN POCKET

- #1 General geology 1" = 4 mi.
- #2 Trenches
- #3 Geology 1" = 500'
- #4 Geochemical survey 1" = 500'

SUMMARY

The Mob Group covers the highly altered east contact of the Pike Mountain granodiorite batholyth. The Allison fault, and branching faults, have crushed the Nicola volcanics and diorite intrusions on the claims. Alteration is widespread with areas of disseminated pyrite and chalcopryrite on the property.

A high grade silver bearing shear zone contains quartz and galena.

The claims have a good chance of containing a disseminated copper deposit.

LOCATION

Latitude: 49°45' North
Longitude: 120°38' West
Elevation: 4,500 Feet

They are reached by the Princeton to Merritt No. 5 highway and by good dirt roads to Hornet Lakes and the gas pipe line.

CLAIMS

Twenty located claims: Mob Numbers 1 to 20, inclusive. Record Numbers 58,945 to 58,964, inclusive, recorded June 12, 1973 with assessment due June 12, 1975. The claims are in the Nicola Mining division of British Columbia.

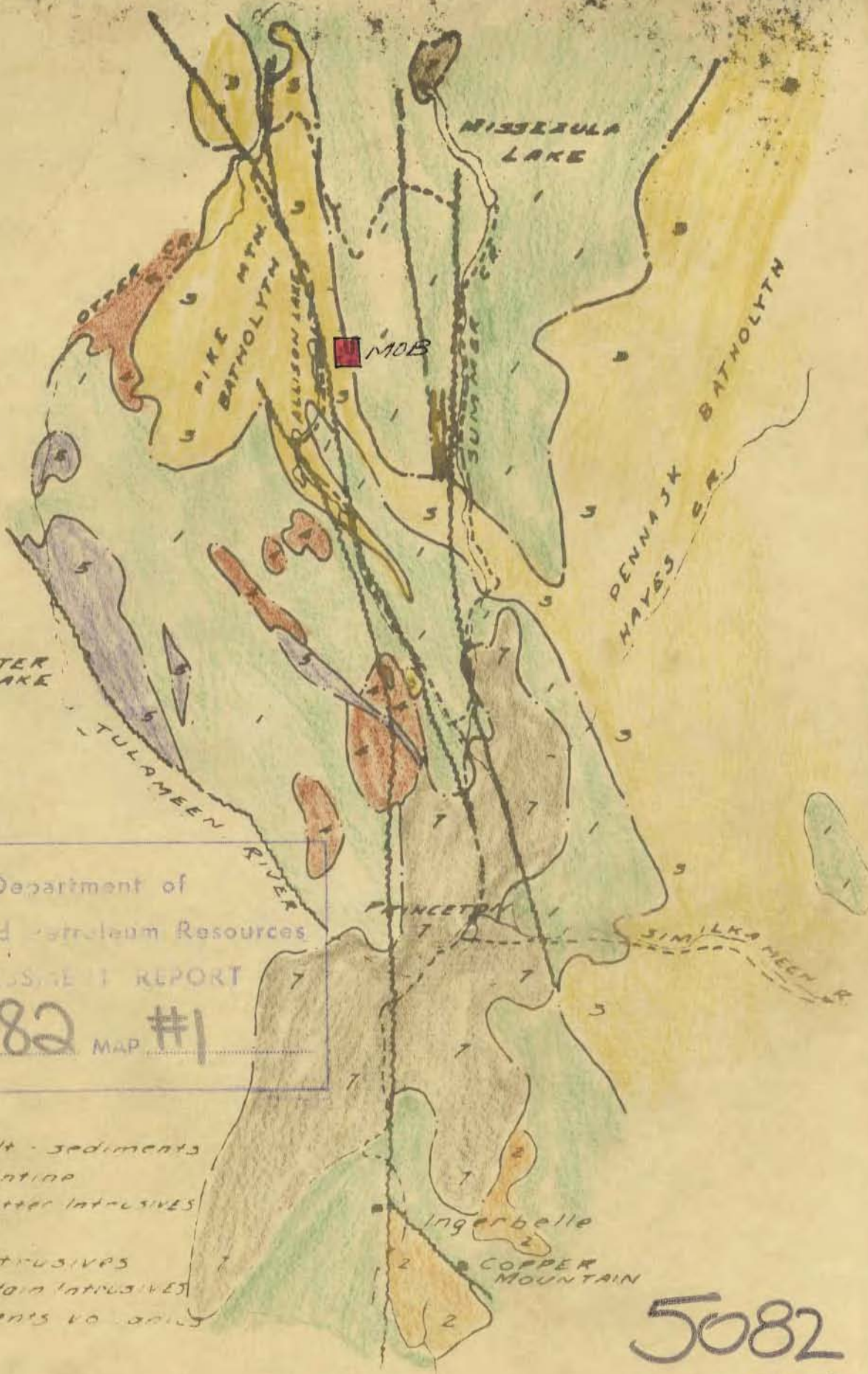

Department of
 Mines and Petroleum Resources
 ASSESSMENT REPORT
 NO. 5082 MAP #1

LEGEND

- Tertiary basalt - sediments
- Gabbro serpentine
- Cretaceous Otter Intrusives
- Cretaceous
- Jurassic Intrusives
- Copper Mountain Intrusives
- Nicola sediments & shales

5082
 m1

After Rice GSC Map 3844

GENERAL GEOLOGY
 Scale 1:24 Miles

TOPOGRAPHY

The claims cover the rocky summit between Allison Creek and Otter Creek.

The ground is relatively flat with a number of small lakes and open timbered grasslands.

HISTORY

The claims were formerly called the Red Group and were worked by Pageant Mines Limited.

GENERAL GEOLOGY

The Princeton to Merritt area is underlain by Nicola volcanics and sediments along the east side of the Coast Range Mountains.

The area is extensively faulted with the major north striking Allison fault striking north to slightly west of north through the area. It is between the Pennask batholyth and the Pike Mountain batholyth which are connected by irregular granodiorite intrusions and by at least two periods of younger diorite intrusives.

A number of large crushed zones in volcanics and diorites contain disseminated and fracture fillings of pyrite and chalcopyrite.

CLAIM GEOLOGY

The Mob claims cover the east contact between the Pike Mountain granodiorite batholyth and the Nicola volcanics. The latter rocks are intruded by fine grained diorites. The Allison Fault, a north striking major fault is immediately west of the claims and the Summers Creek Fault is to the east.

The rocks between these major breaks are crushed and faulted. One shear zone which strikes northeast contains a vuggy quartz filling, pyrite and galena with high silver values.

On Mob No. 2 claim trenches have exposed crushed altered diorite with disseminated pyrite and some chalcopyrite. A few specks of bornite were found.

ROCK TYPES

The granitic outcrops are confined to the south western and western Mob claims. The common type is a medium grained granodiorite with hornblende and some biotite. In places areas of orthoclase are common. A hornblendite with magnetite and few feldspars occur and fine grained granitic rocks are found. Sericitic alteration and some kaolin are in some outcrops.

The Nicola volcanics on the claims are black to very dark grey fine grained andesite. Hornblende crystals are common and magnetite is present in most outcrops. Some epidote and an occasional zeolite were seen.

The diorites are medium to fine grained rocks. Some are light colored with more feldspars than femics and some are dark with hornblende and magnetite.

DEPOSITS

Trenching on the pipe line uncovered a shear zone containing quartz, galena and some chalcopryrite. A picked sample assayed 754 oz. silver, per ton, Trace gold and 8.06% copper. A sample across 4 feet assayed 4.4 oz. silver, per ton, and Trace gold. Two diamond drill holes on this vein failed to obtain values in silver.

Trenching north east of the Hornet Lakes showed crushed diorite near a volcanic contact. The rock contained disseminated fine grained pyrite with chalcopryrite and a few specks of bornite.

Several outcrops both in diorite and altered volcanics show pyrite and traces of chalcopryrite.

CONCLUSION

The Mob claims are along the east contact of a granodiorite intrusive in Nicola volcanics and diorite intrusives. This contact is favorable for large copper pyrite deposits and the Mob claims contain indications of this type of mineralization.

Report by



Vancouver, B.C.
July 15, 1974

REFERENCES

Geology and Mineral Deposits of the
Princeton Map - Area, British Columbia

G.S.C. Memoir by H.M.A. Rice

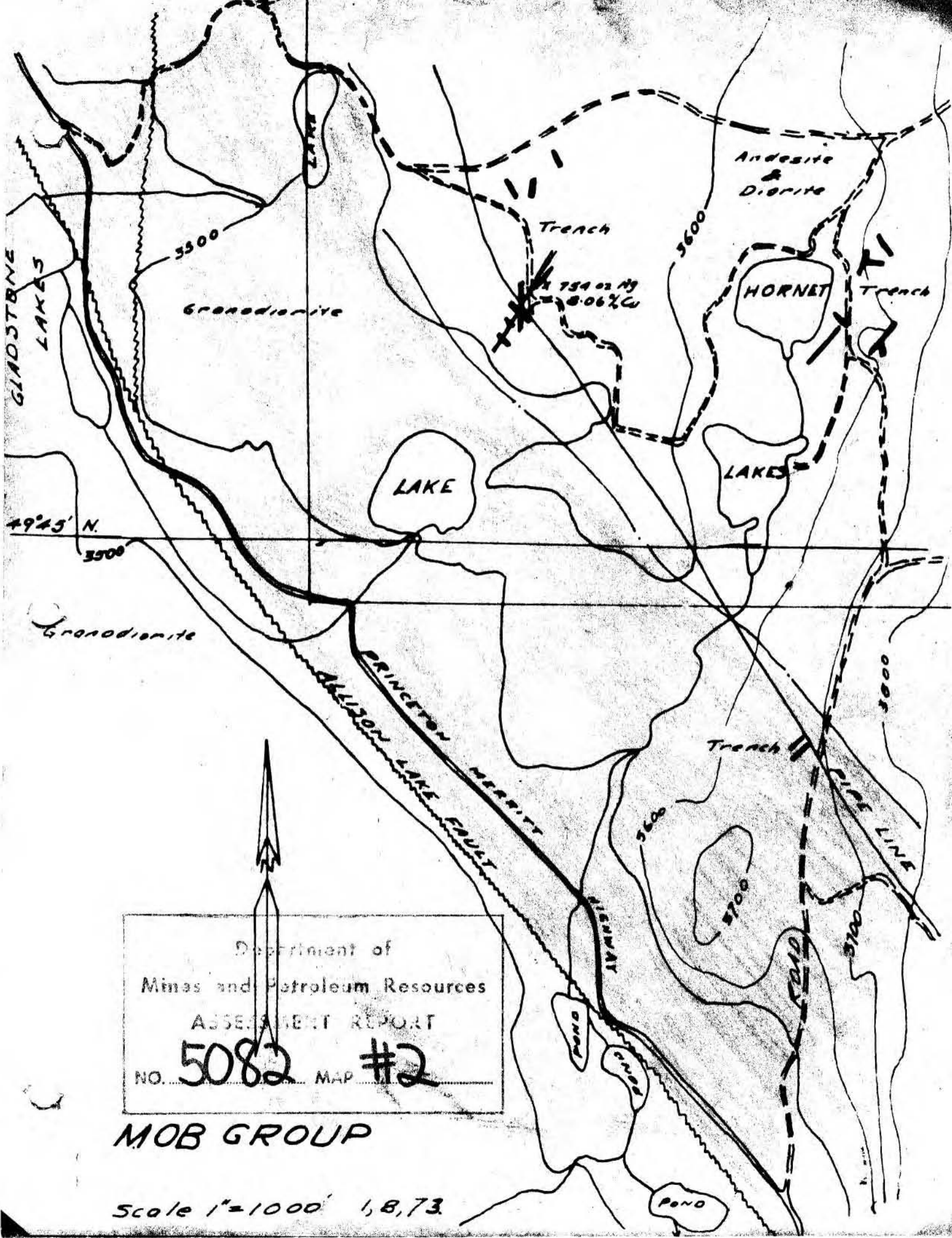

Department of
Minas and Petroleum Resources
ASSESSMENT REPORT
NO. **5082** MAP **#2**

MOB GROUP

Scale 1" = 1000' 1,8,73

BRONSON MINES LIMITED (N.P.L.)

GEOCHEMICAL SURVEY

SIMILKAMEEN MINING DIVISION

BRITISH COLUMBIA

SUMMARY

Geochemical sampling was done on lines spaced about 400 feet apart and 728 samples were taken at 100 foot spacing on the lines. Three samples in a granodiorite outcrop area showed 339,514 and 916 parts per million copper along a single line. One sample showed 230 parts per million copper in a covered area in an area of pyritized volcanics. A few soils assayed over 100 parts per million and they were scattered.

The geochemical program failed to outline attractive copper anomalous areas.

SAMPLING

Samples were taken at 100 foot intervals from the B soil layer along cut lines spaced at 400 foot intervals off a north base line. Seven hundred and twenty eight samples were taken with some gaps in the sampling in swampy and lake areas.

TESTING

The samples were tested by Atomic Absorption Assaying by General Testing Laboratories of Vancouver.

RESULTS

In general the soils were low in copper content averaging only 32 parts per million.

Seventeen samples were anomalous or above three times the average. They were scattered and did not reflect the copper content in the known deposits.

Three samples assaying 339,514 and 916 parts per million copper are in an area showing granodiorite outcrops with no copper. One sample on Mob 3 Claim is in a covered area of pyritized volcanics. It could be significant but in general the survey failed to show attractive anomalous areas.

Report by

DC Malcolm

D.C. MALCOLM P.P. ENG.
Consulting Geologist
D. C. MALCOLM



PROFESSIONAL
BRITISH COLUMBIA
ENGINEER

Vancouver, B.C.,
August 12, 1974

NOTE

To accompany the Geological Report on
the Mob Group, July, 1974.

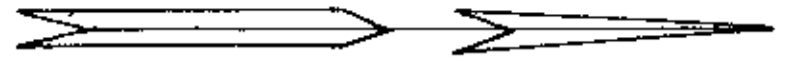

COPPER
 Parts per million
 ● plus 200
 ○ plus 100

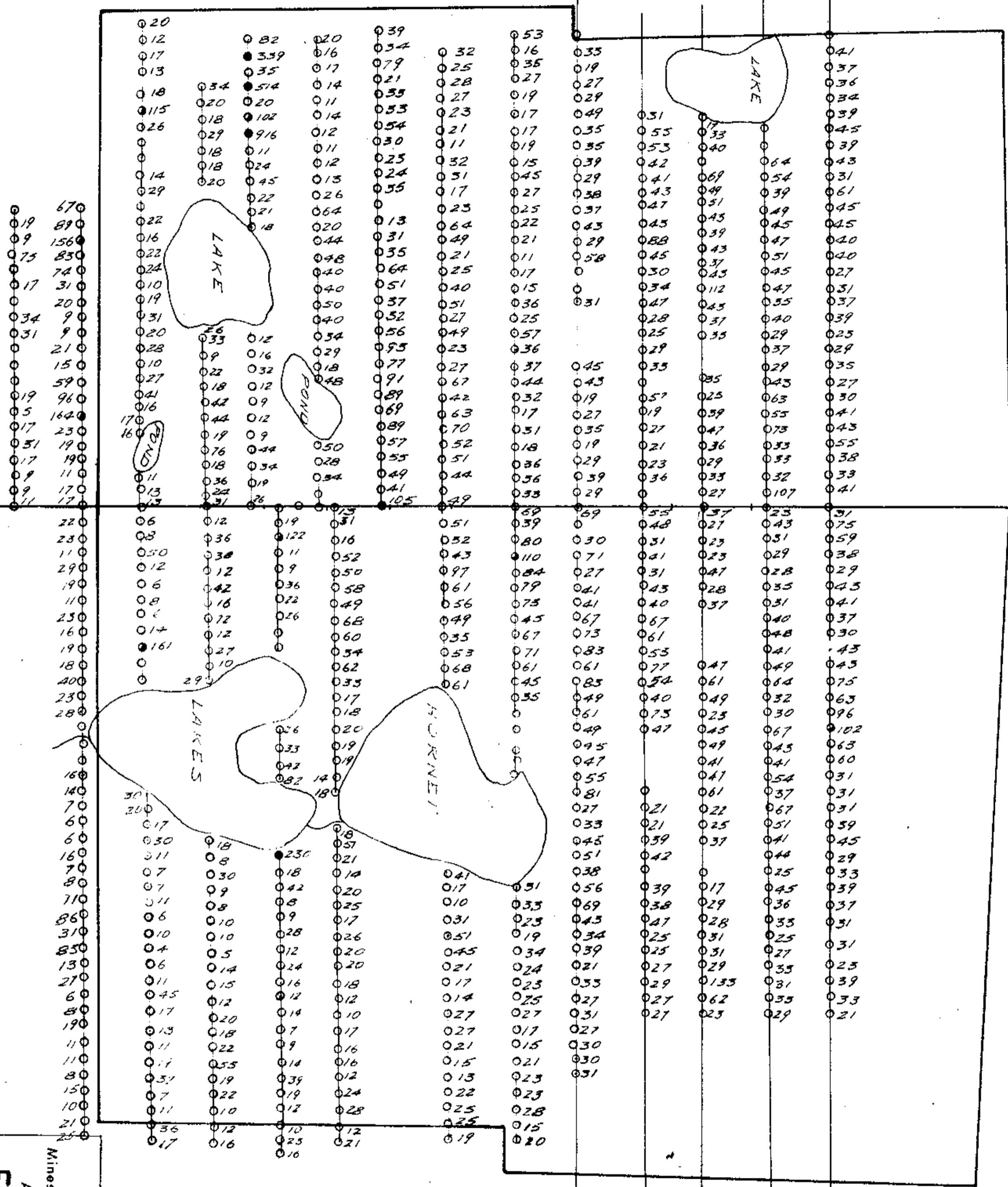

BRONSON MINES LTD

MOB GROUP

GEOCHEMICAL SURVEY

Scale 1"=500' Date 10/8/74

Department of
 Mines and Petroleum Resources
 ASSESSMENT REPORT
 No. 5082 MAP #11

5082
 M4

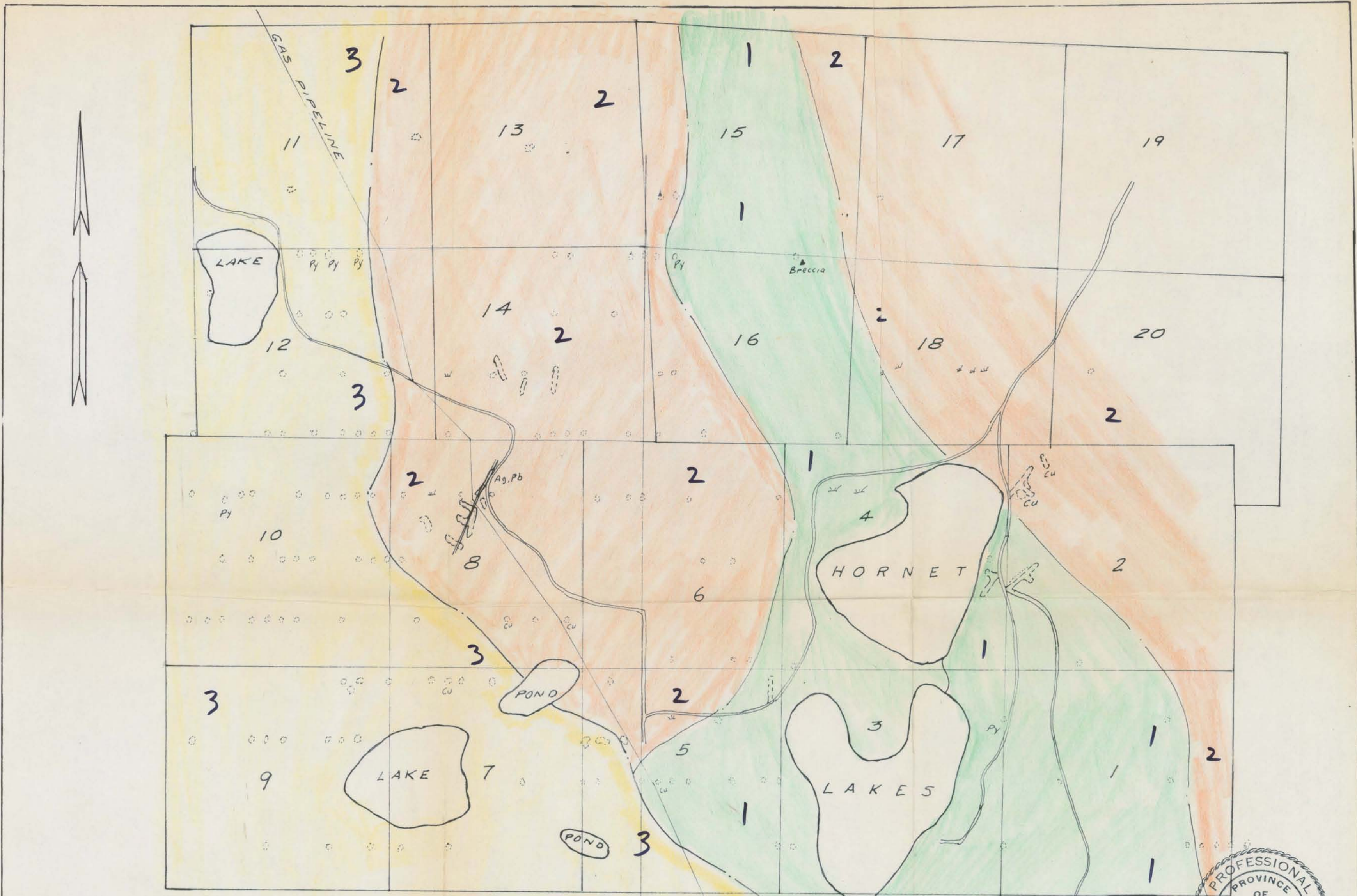

- LEGEND**
- 3 Granodiorite
 - 2 Diorite
 - 1 Andesite
 - Contact
 - Vein
 - Trench
 - Outcrop

Department of
 Mines and Petroleum Resources
ASSESSMENT REPORT
 NO. 5082 MAP #3



BRONSON MINES LTD
 MOB GROUP GEOLOGY
 Scale 1"=500' Date 17,7,74.

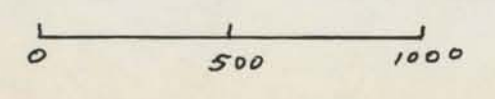

5082
 M3