

5094

93L/6E



LUNDA CLAIM GROUP  
DIAMOND DRILL REPORT  
AUGUST 1974  
OMINECA M.D.

LONKIE CLAIM GROUP  
 FLAT TOP MTD -  
 HOUSTON TOMMY CRK AREA  
 OMINICA MINING DIVISION

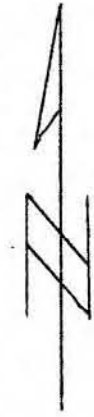
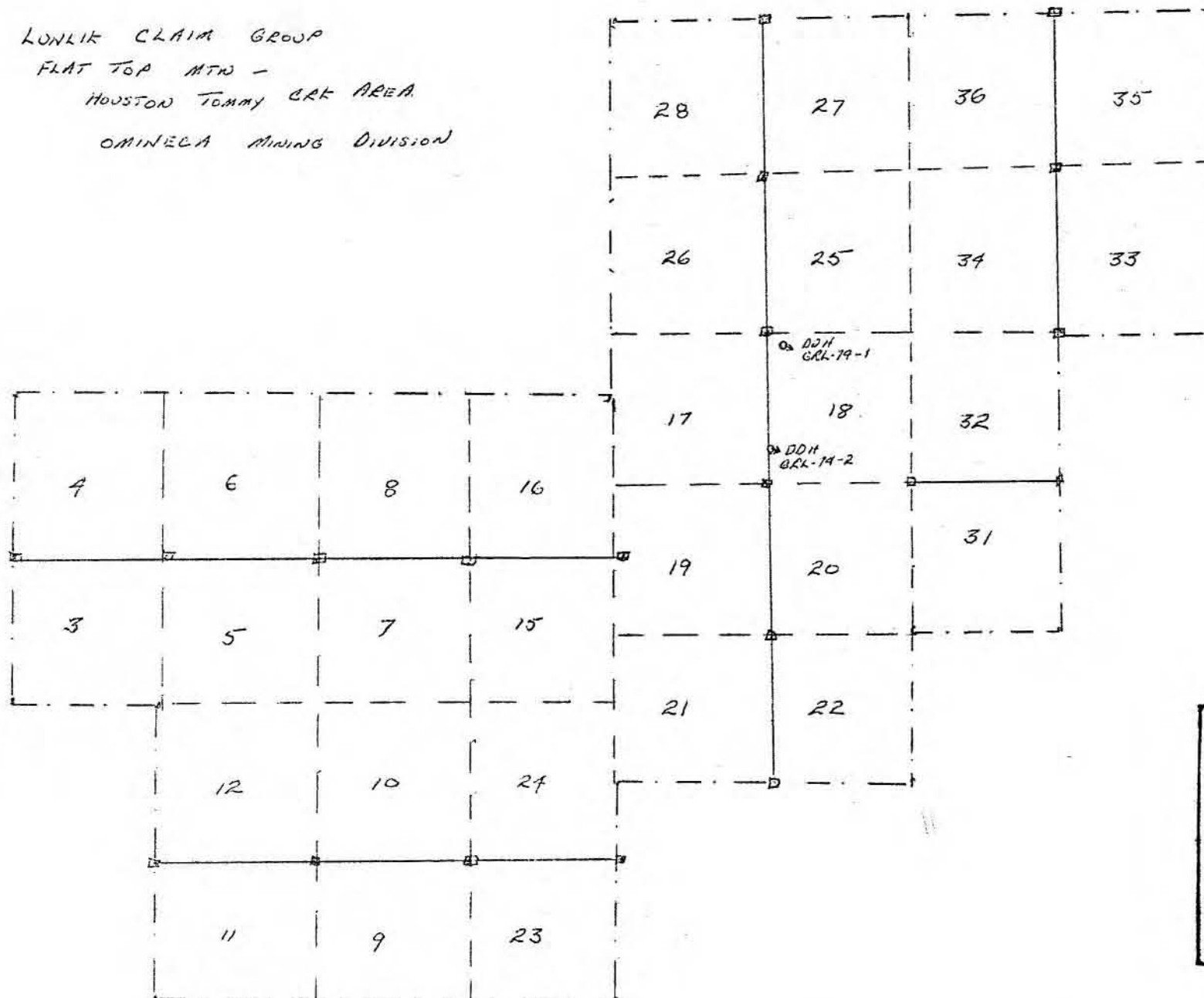

Department of  
 Mines and Petroleum Resources  
 ASSESSMENT REPORT  
 NO. 5094 MAP # 1

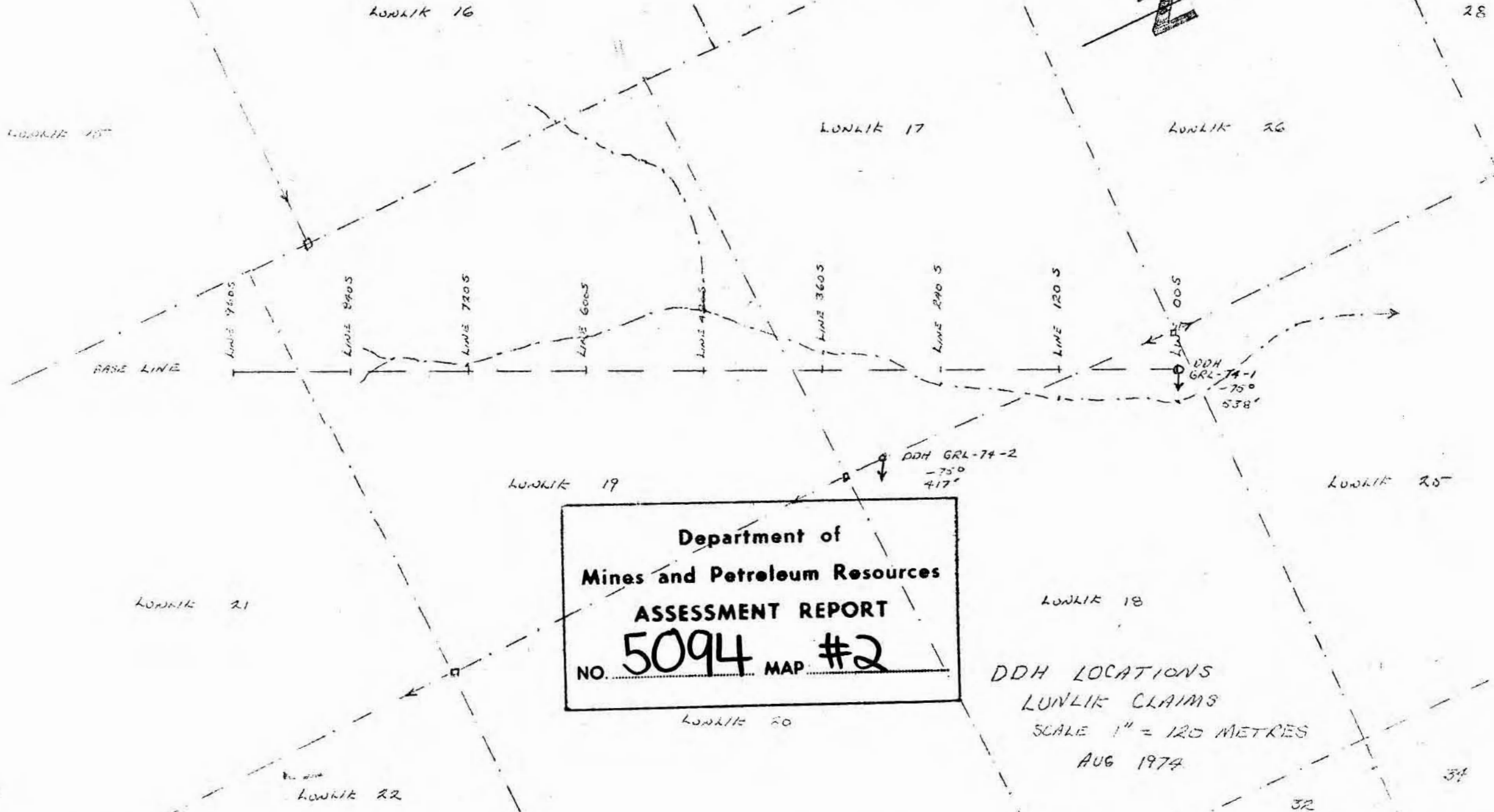
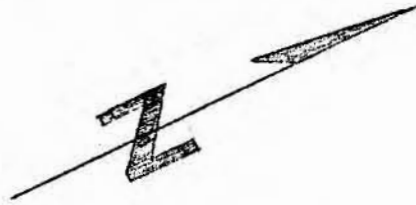

Department of  
Mines and Petroleum Resources  
ASSESSMENT REPORT  
NO. 5094 MAP #2

DDH LOCATIONS  
LUNLIK CLAIMS  
SCALE 1" = 120 METRES  
AUG 1974

28

LUNLIK 25

LUNLIK 18

LUNLIK 20

LUNLIK 21

LUNLIK 22

LUNLIK 19

LUNLIK 16

LUNLIK 17

LUNLIK 26

LUNLIK 15

34

32

STATEMENT OF COSTS

DIAMOND DRILLING PROGRAM  
LUNKIK CLAIM GROUP  
DOMINICA M. D.

|     |         |                      |          |
|-----|---------|----------------------|----------|
| DDH | GR-7A-1 | 538 FEET NQ DRILLING | 5,646.00 |
| DDH | GR-7A-1 | 417 FEET NQ DRILLING | 4,357.00 |

BELL 205 HELICOPTER TO MOVE DRILL  
AND CAMP ONTO CLAIMS;

6.7 HOURS AT \$625.00 PER HOUR 4,187.00

470 GALLONS OF FUEL AT 65¢ PER GAL. 305.00

HELICOPTER CONTRACTED FROM OKANABAN HELICOPTERS.

TOTAL \$19,495.00

Department of  
Mines and Petroleum Resources  
ASSESSMENT REPORT

NO. 5094 MAP.....

STATEMENT OF QUALIFICATIONS

- 1) I ROBERT E REID RESIDE AT 1345 W 13TH VANCOUVER B.C.
- 2) I HOLD FREE MINERS CERTIFICATE No 120361 ISSUED MAY 2, 1973
- 3) I GRADUATED IN 1971 FROM U.B.C. WITH A BSC DEGREE  
MAJORING IN GEOLOGY.
- 4) I HAVE BEEN EMPLOYED AS A FIELD GEOLOGIST  
BY GRANGES EXPLORATION AB SINCE GRADUATION.

Robert E Reid

|                               |          |
|-------------------------------|----------|
| Department of                 |          |
| Mines and Petroleum Resources |          |
| ASSESSMENT REPORT             |          |
| NO. 5094                      | MAP..... |



**GRANGES EXPLORATION AB**  
CANADIAN DIVISION  
**DIAMOND DRILL LOG**

CORE SIZE NO

Property LUNNK. OPTION Project No. .... Depth 169.0 (538') Date Began AUGUST 10 1974  
Hole No. GRL-74-1 Co ord. BASE LINE Horizontal Length 73.89 (149') Date Completed AUGUST 11 1974  
Sheet No. 1 ..... 00 Direction GRD. EAST Drilled By. D.W. CARTER  
Claim No. .... Elevation ..... Angle -75° Logged By. Robert E. Leid

| FOOTAGE METRES. | DESCRIPTION   | ALTERATION |    |  |  |  |  |  |  | % RECY CALC'D. |
|-----------------|---|------------|----|--|--|--|--|--|--|----------------|
|                 |   | FROM       | TO |  |  |  |  |  |  |                |
| 0 - 1.82        | CASING AND OVERBURDEN   |            |    |  |  |  |  |  |  |                |
| 1.82 - 167.0    | FINE TO MEDIUM GRAINED QUARTZ DIORITE<br>70% PLAGIOCLASE; 10% PINK ORTHOCLASE<br>5-10% QUARTZ; 20-25% MAFICS, MAINLY CHAOCRITIC BIOTITE.<br>LIGHT LIMONITE STAIN ON FRACTURES TO 8.1<br>CONTAINS 1-3% FINELY DISSEMINATED EPIDOTE<br>CORE WEAK TO MODERATELY MAGNETIC DUE TO 1-2% FINELY DISSEMINATED MARNETITE.<br>NARROW "IRIDS" PINK ORTHOCLASE ALONG FRACTURES.<br>0.5% TO 0.25% CHALCOPYRITE TO 8.5<br>AFTER 8.5 DECREASE TO LESS THAN 0.25% CHALCOPYRITE.<br>19.3 - 20.4 WEAK SHEAR INTENSE KAOLINITIC ALTERATION AND GOUGIE CONTAINS A FEW NARROW QUARTZ STRINGER<br>20.4 - 21.9 CORE FLOODED BY 40-60% PINK ORTHOCLASE. LARG SPECKLES OF PYRITE.<br>AFTER 20.9 FIND LOCAL SECTION OF PINK ORTHOCLASE "FLOODING" THROUGHOUT.<br>22.9 - 22.9 THIS SECTION CONTAINS A FEW DOGGY CARBONATE FRACTURES ALSO FIND A FEW MAFIC RICH INCLUSIONS GENERALLY CONTAINING 2-5% FINELY DISSEMINATED PYRITE. INCLUSIONS GENERALLY LESS THAN 5 CM. IN DIAMETER.<br>30.5 - 33.5 LOCAL AREAS OF WEAK SAUSSURITIZATION ALONG QUARTZOSE STRINGERS FIND LARG SPECKLES CHALCOPYRITE THROUGHOUT.<br>ROCKERY UP TO 5% EPIDOTE<br>CORE WEAK TO MODERATELY FRACTURED.<br>SLIGHT INCREASE IN CHALCOPYRITE FROM 50.9 TO 54.2 |            |    |  |  |  |  |  |  |                |

Department of  
Mines and Petroleum Resources  
ASSESSMENT REPORT  
NO. **5094** MAP .....



**GRANGES EXPLORATION AB**  
CANADIAN DIVISION  
**DIAMOND DRILL LOG**

Property *LUNNIE OPTION* Project No. .... Depth ..... Date Began .....  
 Hole No. *GR-79-1* Co ord. .... Horizontal Length ..... Date Completed .....  
 Sheet No. *2* Direction ..... Drilled By .....  
 Claim No. .... Elevation ..... Angle ..... Logged By *Robert E. Laird*

| FOOTAGE | DESCRIPTION   | ALTERATION |    |  |  |  |  |  |  | % RECY<br>CALC'D |  |
|---------|---|------------|----|--|--|--|--|--|--|------------------|--|
|         |   | FROM       | TO |  |  |  |  |  |  |                  |  |
|         | AT 52.9 A 5 cm. mafic rich inclusion with 2% garnets; 2-3% epidote and trace chloropyrite.  |            |    |  |  |  |  |  |  |                  |  |
|         | Local sections of weak kaolinitic alteration giving milky white plagioclase weak kaolinitic shears at 65.5 and 67.4 - slickensides on fractures in this area. |            |    |  |  |  |  |  |  |                  |  |
|         | 74.1-77.7 Shear zone; mainly "crummy", vuggy, kaolinitic material - coarse at 74.0 and 77.1-77.7  |            |    |  |  |  |  |  |  |                  |  |
|         | At 79.97 a 3 cm mafic rich inclusion containing 1% chloropyrite.  |            |    |  |  |  |  |  |  |                  |  |
|         | Few crystalline carbonate and a few fractures.  |            |    |  |  |  |  |  |  |                  |  |
|         | 86.86 - weak shear.   |            |    |  |  |  |  |  |  |                  |  |
|         | Very rare specks chloropyrite after 76.2  |            |    |  |  |  |  |  |  |                  |  |
|         | 5 cm contorted mylonitic band at 101.17   |            |    |  |  |  |  |  |  |                  |  |
|         | Intense pink orthoclase flooding from 96.62 to 107.28   |            |    |  |  |  |  |  |  |                  |  |
|         | 103.78 to 109.08 mafic rich mylonitic inclusion.  |            |    |  |  |  |  |  |  |                  |  |
|         | 119.65 weak shear.  |            |    |  |  |  |  |  |  |                  |  |
|         | Few vuggy fractures in local area - rock kaolinitic with pink orthoclase flooding along fractures.  |            |    |  |  |  |  |  |  |                  |  |
|         | 150.26 - 151.48 very quartzose fracture running at shallow angle to axis.   |            |    |  |  |  |  |  |  |                  |  |
|         | 169 metres end of hole.   |            |    |  |  |  |  |  |  |                  |  |

Department of  
**Mines and Petroleum Resources**  
**ASSESSMENT REPORT**  
 No. **5094** MAP .....



**GRANGES EXPLORATION AB**  
CANADIAN DIVISION  
**DIAMOND DRILL LOG**

Property .. LUNDA .. OPTION .. Project No. .... Depth . 127.10 M. (1917') ... Date Began . . August . 12 . 1974 . . .  
Hole No. . . . GRK-14-2 . . . . . Co ord. . . 30.400.5 . . . . . Horizontal Length 32.92M (108') . . . . . Date Completed . August . 19 . 1974 . . .  
Sheet No. . . . . 1 . . . . . 9.400.E . . . . . Direction . GRID . EAST . . . . . Drilled By . . D. W. BEATES . . . . .  
Claim No. . . . . Elevation . . . . . Angle . - 7.5° . . . . . Logged By . . Robert C. Reid

| FOOTAGE METERS | DESCRIPTION   | ALTERATION |    |  |  |  |  |  |  |  |  | % RECY CALC'D. |  |
|----------------|---|------------|----|--|--|--|--|--|--|--|--|----------------|--|
|                |   | FROM       | TO |  |  |  |  |  |  |  |  |                |  |
| 0 - 3.52       | CASING AND OVERBURDEN   |            |    |  |  |  |  |  |  |  |  |                |  |
| 3.52 - 57.95   | <p>RHYO-DACITE;</p> <p>GENERALLY A FINE GRAINED SILICIOUS MATERIAL SHOWING NUMEROUS LOCAL VARIATIONS IN TEXTURE AND COMPOSITION.</p> <p>THE MAIN VARIATIONS ARE;</p> <p>1) A DARK, SILICIOUS, FINE GRAINED TO MASSIVE RHYODACITE. COMPRISES 60-70% OF THE CORE.</p> <p>2) A PALE PINKISH GREY APLITIC MATERIAL CONTAINING A FEW MEDIUM TO COARSE ANHEDRAL SAUSSURITE GRAINS. LOCAL AREAS EXHIBIT OMBLITE TEXTURE.</p> <p>ACCESSORIES OF UP TO 10% PYRITE AND 3-5% EPIDOTE MAINLY IN FRACTURES AND AS STRINGS. THIS UNIT COMPRISES 15 TO 20% OF THE CORE.</p> <p>3) PORPHYRITIC CHLORITE - EPIDOTE - PINK FELDSPAR MATERIAL WITH THE MEDIUM GRAINED TO FELDSPARS IN A GROUNDMASS OF CHLORITE AND EPIDOTE. PORPHYRITIC ALTERATION? CONTAINS 3-5% FINELY ASSEMBLED PYRITE.</p> <p>THIS UNIT COMPRISES 10-20% OF THE CORE IN THIS SECTION.</p> <p>4) SILICIFIED FRAGMENTALS.</p> <p>WEAK BRICK, A OR AGGLOMERATE TEXTURE VISIBLE WITH LENSE. THIS UNIT COMPRISES LESS THAN 5% OF SECTION.</p> <p>THE CORE IS MODERATELY FRACTURED WITH FILLINGS OF CARBONATE, PYRITE AND PINK FELDSPAR. FINE WEAK OBVIOUS HEMATITE STAIN ON SOME FRACTURES.</p> <p>RARE SPECKS CHALCOPIRITE.</p> <p>RHYODACITE UNIT CONTAINS LOCAL PORPHYRITIC SECTIONS WITH FINE GRAINED WHITE PLAGIOCLASE PHENOCRYSTS.</p> <p>WITH THE EXCEPTION OF THE EPIDOTE</p> |            |    |  |  |  |  |  |  |  |  |                |  |

Department of  
Mines and Petroleum Resources  
**ASSESSMENT REPORT**  
NO. **5094** MAP





**GRANGES EXPLORATION AB**  
CANADIAN DIVISION  
**DIAMOND DRILL LOG**

Property . . . LUXUR . . . OPTION . . . Project No. . . . . Depth . . . . . Date Began . . . . .  
Hole No. . . . GR-79-2 . . . . . Co ord. . . . . Horizontal Length . . . . . Date Completed . . . . .  
Sheet No. . . . 2 . . . . . Direction . . . . . Drilled By . . . . .  
Claim No. . . . . Elevation . . . . . Angle . . . . . Logged By: Robert E. Reed

| FOOTAGE METRES.   | DESCRIPTION  | ALTERATION |    |  |  |  |  |  |  | % RECY CALCD. |  |
|-------------------|--|------------|----|--|--|--|--|--|--|---------------|--|
|                   |  | FROM       | TO |  |  |  |  |  |  |               |  |
|                   | AFTER 22 METRES THE MAJORITY OF THE CORE (95%) IS A DARK, MASSIVE RHYOLACITE. IT IS MODERATELY FRACTURED WITH CARBONATE, "PLATEY" PYRITE AND HEMATITE STAIN ON MOST FACES.   |            |    |  |  |  |  |  |  |               |  |
|                   | 39.80 - 1 CM. VUGGY QUARTZ - EPIDOTE STRINGER.   |            |    |  |  |  |  |  |  |               |  |
|                   | AFTER 50 METRES FIND VARIETY OF TEXTURAL AND COMPOSITIONAL CHANGES SIMILAR TO THOSE AT TOP OF HOLE.  |            |    |  |  |  |  |  |  |               |  |
| 57.95 -<br>127.10 | GREY SILICIFIED FRAGMENTAL;<br>LACKS EITHER A DISTINCT BRECCIA OR AGGLOMERATE TEXTURE CHARACTERIZED BY COARSE (UP TO 5 CM.) PLATY FRAGMENTS IN A GROUNDMASS OF MASSIVE TO MEDIUM GRAINED, ANHEAL, FELDSPAR, QUARTZ AND MAFICS. GRAIN BOUNDARIES INDISTINCT.<br>WEAK, CRACKLED FRACTURE PATTERN WITH FILLINGS OF CARBONATE AND PINK FELDSPAR.<br>TRACE AMOUNTS OF PYRITE AND EPIDOTE AS SMALL BLENDS.<br>CORE IS MODERATELY MAGNETIC.<br>89.0 - 88.58 - PERHYDRIC RHYOLACITE.<br>SIMILAR TO ABOVE.<br>86.74 - 87.09 - SHEAR ZONE.<br>FIND NARROW BANDS EXHIBITING A RELATIVELY CLEAR BRECCIA TEXTURE, ALSO A FEW MYXENITIC AREAS AND A FEW RHYOLACITE AREAS WITHIN REMAINDER OF HOLE.<br>RARE SPECKS SCLERIDES AND WEAK OBVIOUS HEMATITE STAIN ON FRACTURES THROUGHOUT.<br>127.10 METRES END OF HOLE. |            |    |  |  |  |  |  |  |               |  |

Department of  
**Mines and Petroleum Resources**  
**ASSESSMENT REPORT**  
No. **5094** MAP