

5126

92I/TW

REPORT TO
ASHCROFT RESOURCES LTD.

COVERING A LINE CUTTING PROGRAM
ON ITS
TIL GROUP OF MINERAL CLAIMS

NEAR MERRITT, IN THE
NICOLA MINING DIVISION, B.C.

BY
SHERWIN F. KELLY, P. ENG.
GEOLOGIST AND GEOPHYSICIST

SEPTEMBER 6, 1974

#1 Location map
#2 Claim map

Department of	
Mines and Petroleum Resources	
ASSESSMENT REPORT	
NO. 5126	MAP

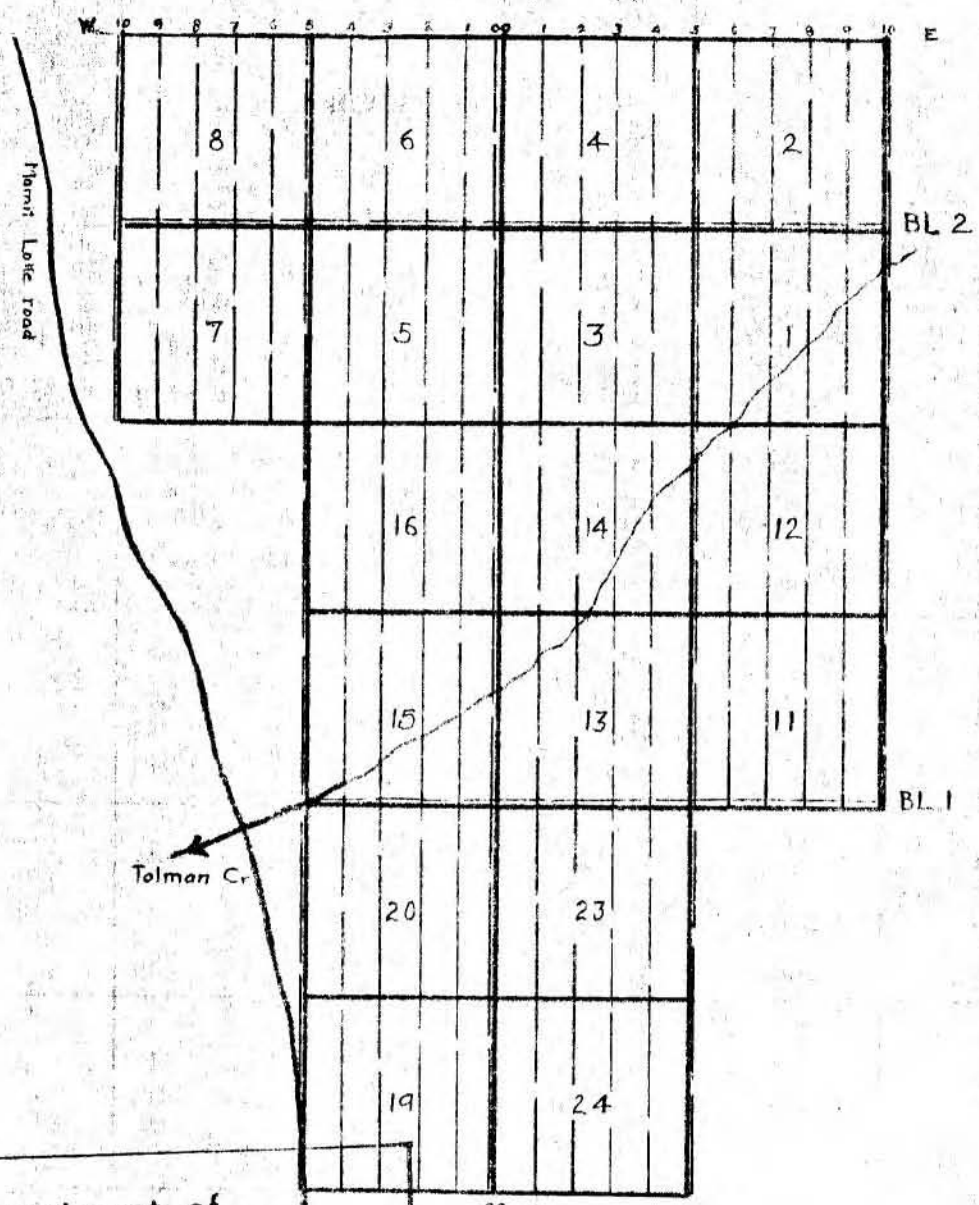
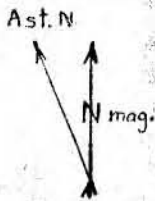

Department of
 Mines and Petroleum Resources
 To Merritt
 ASSESSMENT REPORT
 No. **5126** MAP **#2**

TIL GROUP
 Claims & Grid Lines

Scale

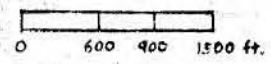

4 Claim nos.
 6 line nos. E & W
 of center line, 00.

5126
M2 *Therewith Kelly, P. Eng.*

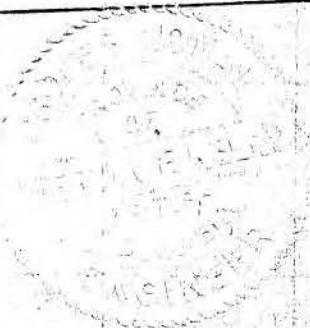

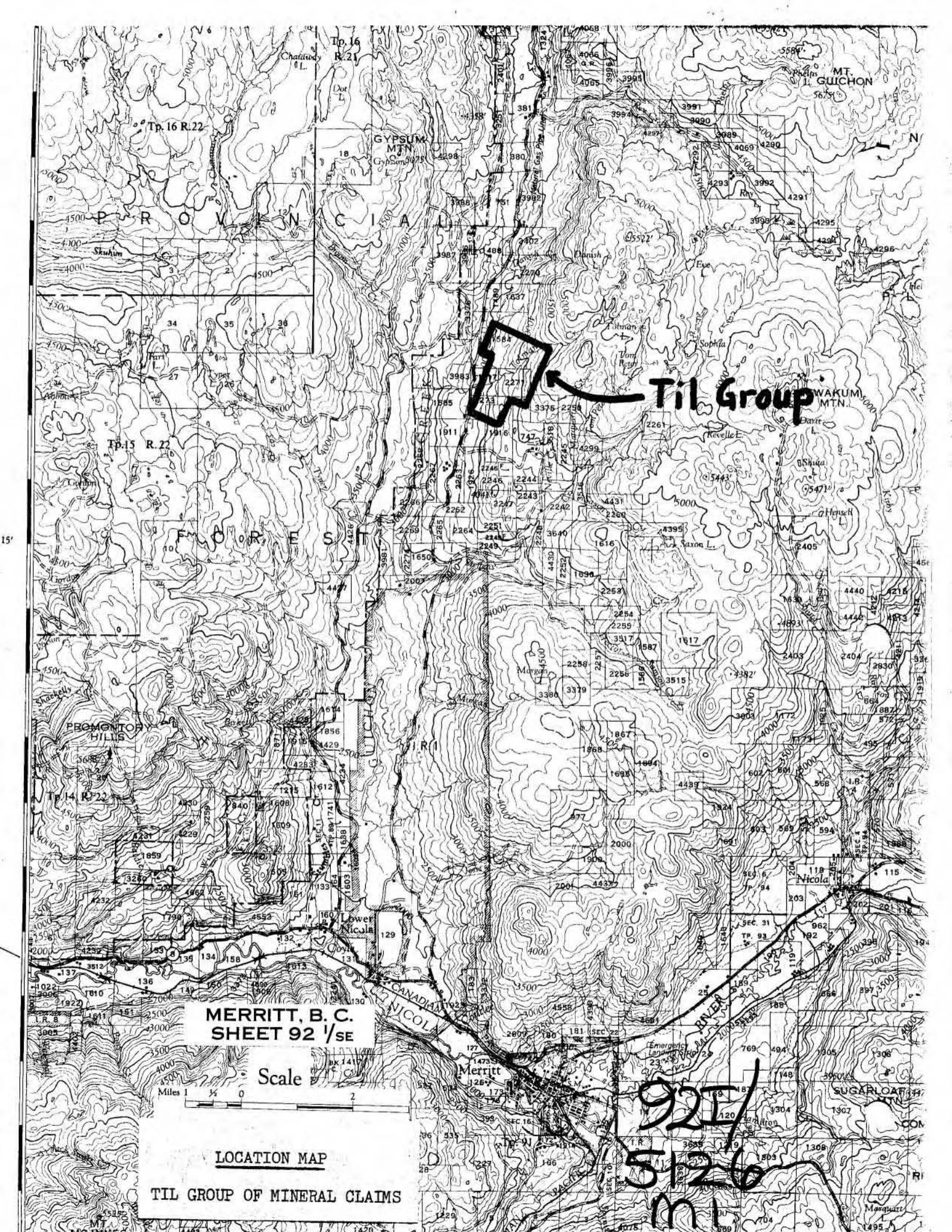

Til Group

MERRITT, B. C.
SHEET 92 1/SE



LOCATION MAP

TIL GROUP OF MINERAL CLAIMS

92I/
S126
MI

REPORT ON LINE-CUTTING PROGRAM
ON THE TIL GROUP OF MINERAL CLAIMS
BELONGING TO
ASHCROFT RESOURCES LTD.
BY
SHERWIN F. KELLY, P. ENG.

A program of line-cutting and picketing was carried out in July and August 1974, on the Til group of 18 mineral claims in the Nicola Mining Division, belonging to Ashcroft Resources Ltd., of Vancouver, B.C. The work was reported in two "Affidavits on Application to Record Work," filed in the office of the Mining Recorder in Merritt, B. C., on July 24 and September 6, 1974. This report is on the entire program and is prepared pursuant to the regulations covering assessment work. The pertinent data follow.

The Til claim group straddles Tolman Creek on the east side of the Guichon Creek valley. Tolman Creek drains westerly into Guichon Creek, about 5 miles south of Mamit Lake. The claim group is just east of, and in places is adjacent to the Mamit Lake highway, some 12 miles north of Merritt. The claims are in the Nicola Mining Division.

The accompanying Location Map shows the relationship of the claim group to the geographical features of the area.

The line-cutting was conducted on claims Til #1 - #8, #11 - #16, #19 - #20 and #23 - #24. Because of the imminent anniversary dates for Til #23 and #24, the affidavit for work on those two claims was filed as soon as it was finished, July 24, 1974, without waiting for the completion

.....2

of the entire program. The affidavit for the work on the remaining 16 claims was filed September 6, 1974, also in the office of the Mining Recorder in Merritt.

The claim group is six claims long, north and south, and the width varies from two claims wide at the south end to four claims wide and the north end. Two base lines, running east and west, were cut across the claim group. No. 1 is 3,000 feet north of the south claim boundary and No. 2 is 1,500 feet south of the north claim boundary. Lines were cut and picketed north and south off these base lines, with a three hundred foot spacing between the grid lines. Appropriately numbered pickets were placed at 100 ft. intervals. The pickets were numbered north from the south claim boundary to No. 1 Base Line. Off No. 2 Base Line, the numbers run north to the north claim boundary and south to No. 1 Base Line. The accompanying map shows the claims and the grid lines in relation to the claim boundaries.

The work was carried out between July 18 and August 30, 1974, by Alver Enterprises Ltd., of Vancouver, on a contract basis of \$125.00 per mile of line cut and picketed. The personnel conducting the field work for Alver varied from time to time and consisted of Lorne McClelland, Larry McClelland, Ivan Brunet, Stan Cusack and Wendel Mingay, all of Merritt. The work was under my general supervision.

The affidavit filed on July 24, 1974, cited the expenditure of \$685.00 for line-cutting, including \$50.00 for the preparation of the report. At that time, only \$400.00 was claimed, covering Til #23 and #24. In the affidavit filed September 6, the total expenditure of \$3,700.00 was recorded, including the cost of the report. Of this, \$3,200.00 was claimed, to cover the sixteen remaining Til claims, nos. 1 to 8, 11 to 16 and 19 - 20. In the two affidavits, a total of \$3,600.00 was claimed, \$400.00 in the first and \$3,200.00 in the second, out of a total expenditure of \$3,700.00.

Lines cut and picketed were:

5 lines each 3,000 ft. long-----	15,000
11 lines each 9,000 ft. long-----	99,000
5 lines each 6,000 ft. long-----	30,000
2 base lines, 4,500 and 6,000 ft. long-----	<u>10,500</u>
	<u>154,500</u>

154,500 ft. = 29.2 miles.

29.2 miles @ \$125.00 per mile = \$3,650.00

Cost of report..... 50.00

\$3,700.00

The work described above, for which a total of \$3,600 was claimed, was carried out on, and applied to:

- Til nos. 1 - 8, record nos.-----58149/56(February)
- Til nos. 11 - 16, record nos.-----58157/62(February)
- Til nos. 19 - 20, record nos.-----58163/64(February)
- Til nos. 23 - 24, record nos.-----56666/67(July)

One year's work was to be applied to each of the above claims.

I hereby certify that the sum of \$3,600 was duly expended for the above described work, which was properly carried out.

Respectfully submitted,

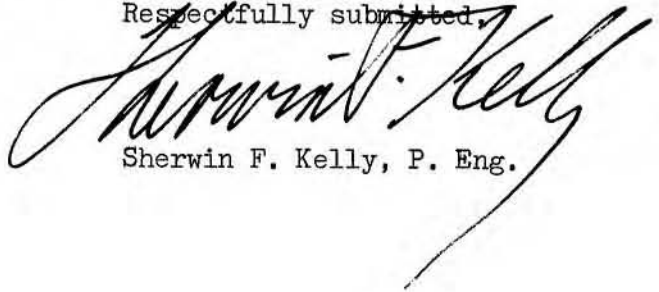

Sherwin F. Kelly, P. Eng.

Merritt, B. C.

September 6, 1974