

5205

REPORT ON

GEOCHEMICAL SOIL SURVEY

CLAIRE 1 FR.

82E/5E

OKANAGAN FALLS

OSOYOOS MINING DIVISION

LAT. 49°21' N.

LONG. 119°34' W.

FOR

DUSTY MAC MINES LTD.

By: James R. Glass, P. Eng.

October, 1974.

Department of Mines and Petroleum Resources ASSESSMENT REPORT NO. 5205 MAP.....
--

TABLE OF CONTENTS

	<u>Page</u>
SUMMARY	1
PROPERTY	1
HISTORY OF PROPERTY	2
GENERAL GEOLOGY	2
LOCAL GEOLOGY	3
ORE RESERVES	4
PRESENT PROGRAM	4 & 5
DISCUSSION OF RESULTS	6
STATEMENT OF COSTS	7

MAPS

- #1 Location map
- #2 Claim map
- #3 Geochemical Soil Sampling

SUMMARY

Dusty Mac Mines Ltd. (N.P.L.) carried out a detailed geochemical soil survey over part of the Claire 1 Fraction between the 3rd and 5th of May, 1974. Control for the survey was established by surveying a base line and chaining the sample locations.

PROPERTY

The Claire 1 Fraction, Record No. 30580, is part of Group No. 3 of the Dusty Mac Mines claims which are located 3/4 mile east of the village of Okanagan Falls, British Columbia, in the Osoyoos Mining Division at 49°21' N. Lat. and 119°34' W. Long.

Department of
 Mines and Petroleum Resources
 ASSESSMENT REPORT
 NO. **5205** MAP **#1**

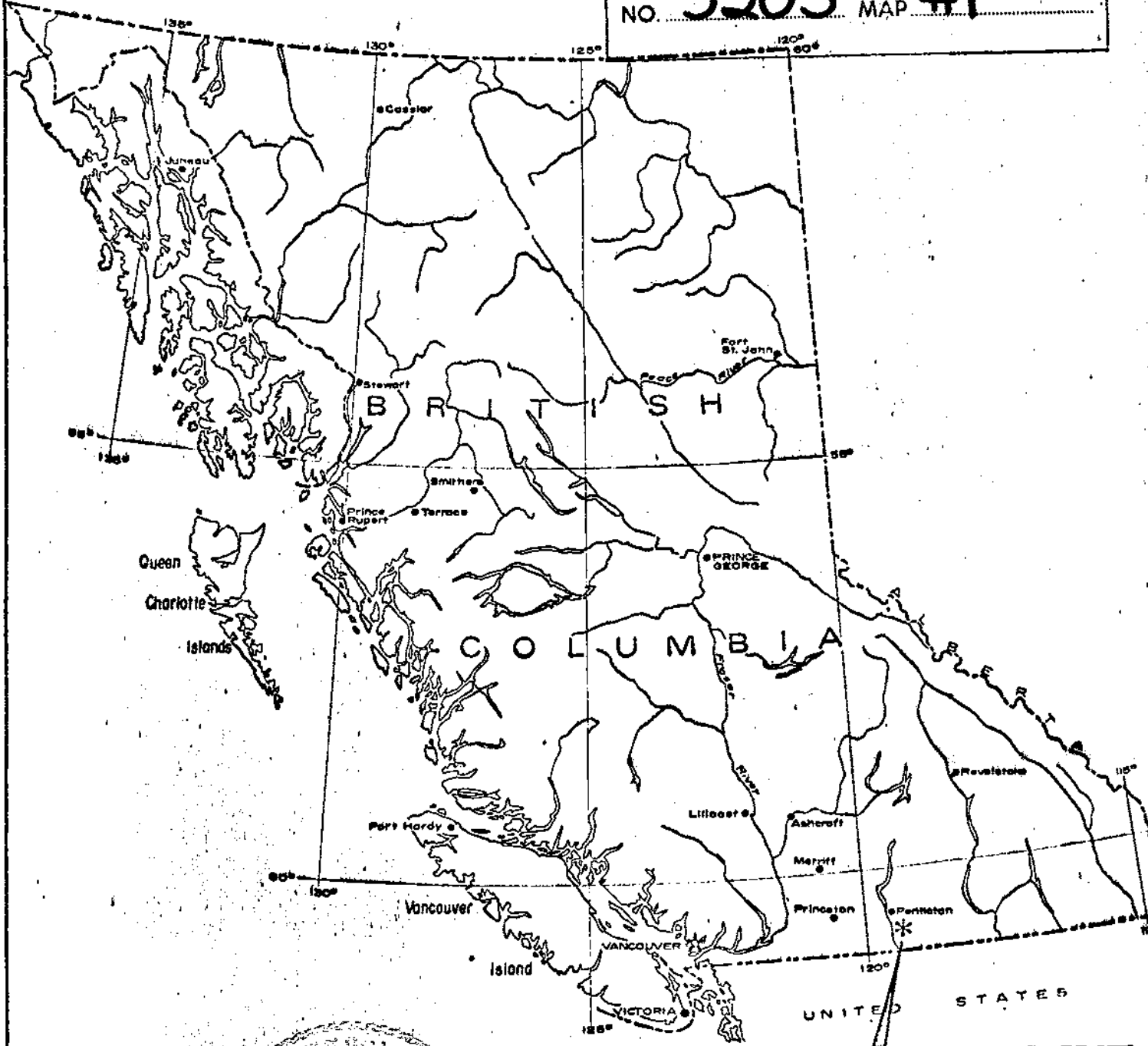

THE DUSTY MAC MINE

James R. Glass **5205**
M1



To Accompany Report by J. R. Glass
 Oct. 1974

LOCATION MAP
THE DUSTY MAC MINE
 OKANAGAN FALLS, BC.

HISTORY OF PROPERTY

Dusty Mac Mines Ltd. acquired the Claim Group during 1968 and has held the ground since that time.

In 1968 and 1969 Dusty Mac Mines Ltd. carried out an extensive exploration program. In 1970 the property was optioned to Noranda Mines Ltd. who carried out additional diamond drilling and performed geochemical soil sampling. In 1973 an additional exploration program which included 120 percussion drill holes and additional geochemical soil sampling was carried out by Dusty Mac Mines Ltd.

GENERAL GEOLOGY

The main rock-unit around the area is the White Lake Formation which has been mapped by the Geological Survey of Canada as Cenozoic. (Map 627-A, 1941; Okanagan Falls). The White Lake Formation consists of lake and stream deposits intermixed with pyroclastics and volcanic breccia which were deposited in the down-faulted down-warped White Lake syncline and Okanagan Falls syncline.

A major fault striking N 35° W separates the White Lake Formation from the Vaseaux Paleozoic paragneiss, schist and quartzite to the east of the area.

LOCAL GEOLOGY

Gold-silver mineralization within the Dusty Mac orebody is associated with the volcanic breccia which has been silicified and rebrecciated. The gold-silver is generally proportional to the amount of silicification. Pyrite is found as an erratic envelope around the ore zone and appears to be either late or post gold-silver mineralization.

The structural control of the ore zone is thought to be a pre-mineral fault system which strikes N 30° W parallel to and associated with the major regional fault separating the White Lake Formation and the Vaseaux Formation.

Post mineral faults, one set striking N - S and one set E - W cut the main orebody but the displacement or truncation of ore at this time is unknown.

A number of gold bearing silicified breccia zones outside the main ore zone have been mapped. To date 16 areas of breccia have been noted.

ORE RESERVES

Dusty Mac Mines Ltd. has announced the following ore reserve figures:

	<u>Tonnage</u>	<u>oz/ton Au.</u>	<u>oz/ton Ag.</u>
Measured Ore	132,585	.206	3.60
Indicated Ore	23,673	.134	1.68
Inferred Ore	3,470	.181	2.71

PRESENT PROGRAM

The Claire 1 Fraction is located less than 400 feet south of the "South Meadow Extension", which is a zone of silicified brecciated andesite containing low grade gold-silver mineralization and which has an anomalous amount of silver in the soil. The anomaly as indicated in the 1973 work was still open to the south.

The 1974 program carried out on the Claire 1 Fraction was designed to detect any geochemical expression south of the "open anomaly".

A base line was surveyed using a Brunten Compass; stations were chained and marked with pickets. The cross lines were established in the same way.

All samples were taken using a shovel to dig holes three to four feet deep to obtain samples below the leached surface material - samples from

the same horizon as the 1973 surveys. When the samples were taken the holes were filled in. Samples were sent to General Testing Laboratories in Vancouver where they were analyzed for silver as follows:

1. Dried at 100° C
2. Sieved to -80 mesh
3. One gm sample dissolved in 20 ml of nitric acid
and 10 ml of perchloric acid
4. Taken to dryness
5. Taken up in 25 ml of nitric acid solution and
stabilized in mercuric nitrate
6. Filtered
7. Filtrate run on atomic absorption
8. Results reported in p.p.m. and permanently recorded

The results of the survey are plotted on a map of scale 1" = 50' included with this Report.

DISCUSSION OF RESULTS

Geochemical soil sampling during 1968 and 1973 has established that threshold value in soil is 0.9 ppm and anomalous value is 1.7 ppm. There are no anomalous values in the soil in the northern part of the Claim. It is noteworthy however that the overburden cover is up to 50 feet thick in some parts of the survey area, so that blind mineralized zones could still exist.

STATEMENT OF COSTSPersonnel Employed and Dates

J. R. Glass, P. Eng. May 3, 1974

$\frac{1}{2}$ day May 5, 1974

Statement of Costs

Wages - J. R. Glass	\$200.00
Assaying	36.90
Expenses - Vehicle	45.00
- Food	<u>10.50</u>
	<u>\$292.40</u>

Respectfully submitted

James R. Glass, P. Eng.



James R. Glass

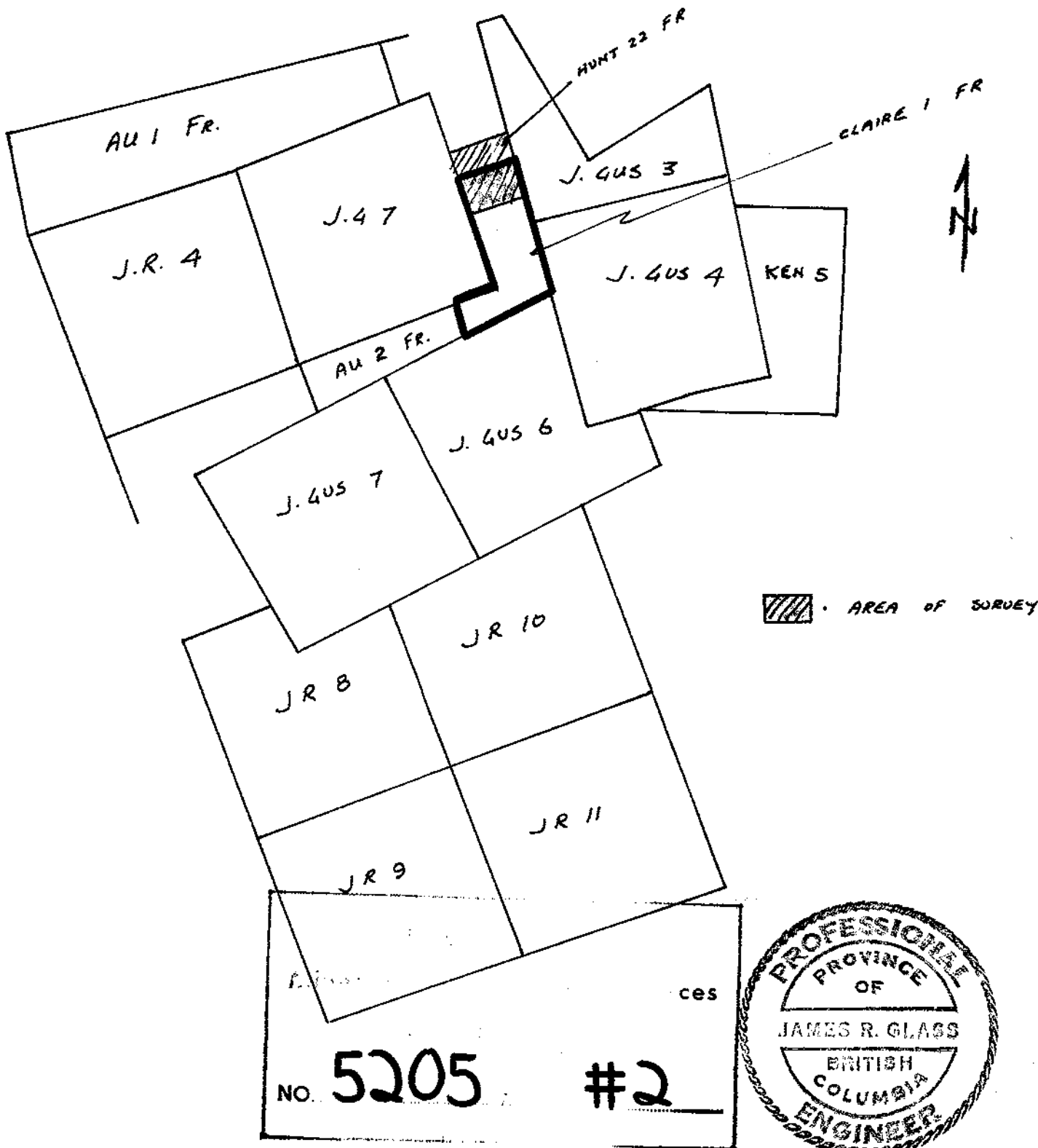

NO. **5205** #2

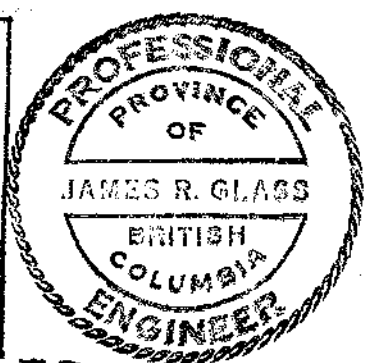

DUSTY MAC MINES LTD.

CLAIM MAP
GROUP NO. 3

James R. Glass

scale 1 in = 1000 ft.

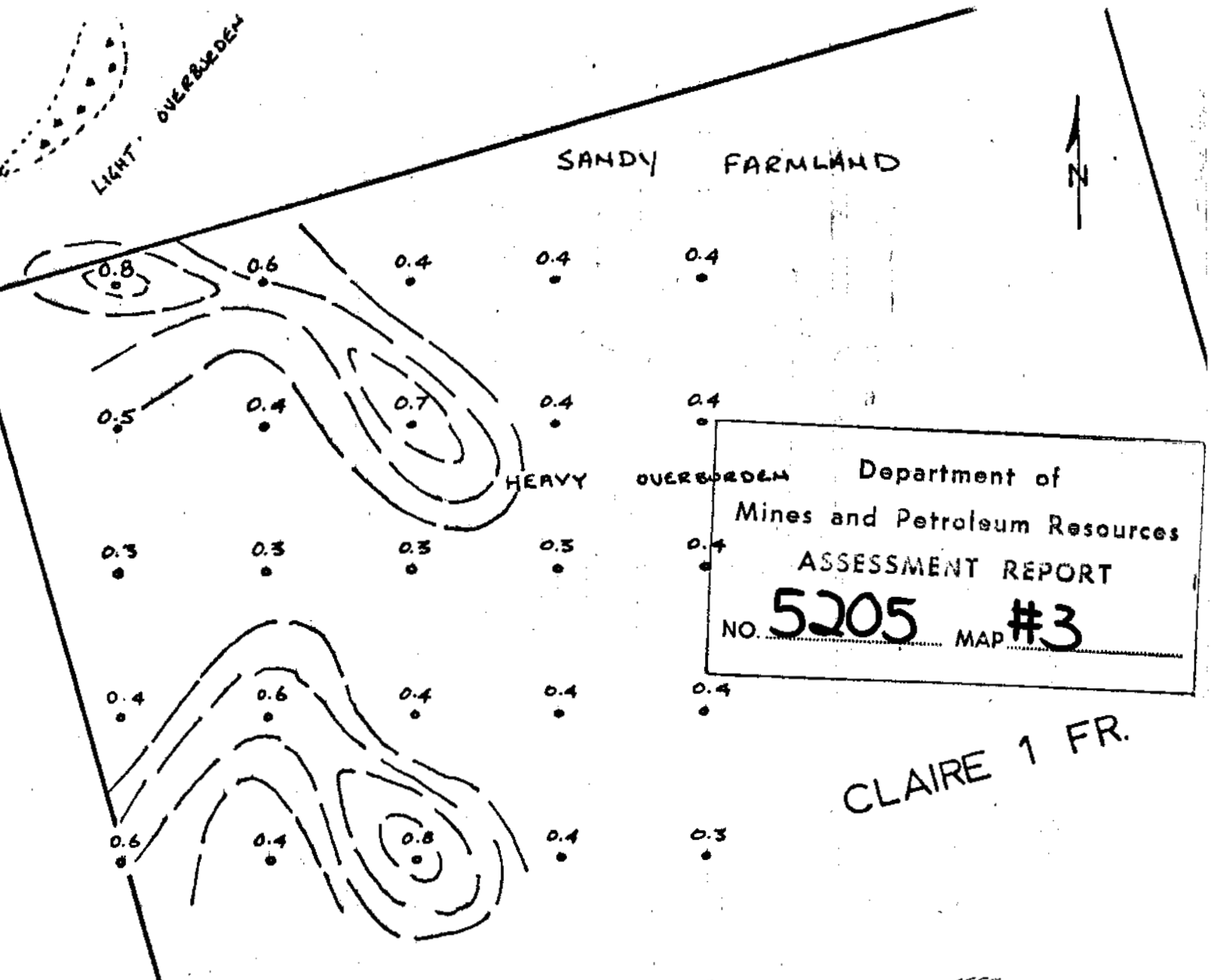

Department of
 Mines and Petroleum Resources
 ASSESSMENT REPORT
 NO. **5205** MAP **#3**

CLAIRE 1 FR.

LEGEND

- SAMPLE LOCATION
- 0.3 SILVER IN P.P.M.
- ⊖ OUTCROP

SANDY FARMLAND

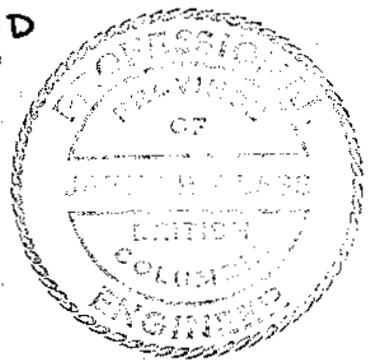

James R. Glass

DUSTY MAC MINES LTD.
 GEOCHEMICAL SOIL SAMPLING
 CLAIRE 1 FR.

scale 1 in. = 50 ft. Oct. 1974