

5227

93K/3E

PERCUSSION DRILLING REPORT

FOR

ELK 5, NU 2 AND 4

GROUPS OF MINERAL CLAIMS

By

Canex Placer Limited, Endako Mines Division

And

Denak Mines Ltd.

Omineca Mining Division
Endako, B.C.

(Latitude 54°N, Longitude 125°)

Percussion drilling, sampling and assaying
Undertaken during period 15 May, 1974, to 15 August, 1974.

E. T. Kimura

Department of September 23, 1974.

Mines and Petroleum Resources

ASSESSMENT REPORT

NO. 5227 MAP

TABLE OF CONTENTS

	<u>Page</u>
Introduction	1
Mineral Claim Groups	1
Percussion Drill Program	2
Statement of Expenditures	3
Conclusion	4

Appendices:

#1 Location map

#2 I Percussion Drill Hole Location Map

II Percussion Drill Hole Logs for Eight Holes

INTRODUCTION

Eight two-inch diameter percussion drill holes totalling 2,080 feet were drilled during period May 15, 1974, to July 31, 1974. Drilling and assaying costs are being submitted for assessment work on Elk 5, Nu 2 and 4 Groups of Mineral Claims.

MINERAL CLAIM GROUPS

Elk 5, Nu 2 and 4 Groups of Mineral Claims are located about five miles southwest of Endako, B.C. in Omineca Mining Division. The property is geographically located in southeast quadrant of quadrilateral, Latitude 54°N and Longitude 125°.

The following mineral claims comprise three separate groups.

<u>Group</u>	<u>Mineral Claims</u>	<u>Record Numbers</u>	<u>Owner</u>
Elk 5	Elk 5 Fr & 9 Fr	24915 & 24914	Canex Placer
	Ti 2	14132	"
	Dat 2 Fr, 4 Fr - 6 Fr	81822, 81822-81826	Denak
	Dat 408 - 412	17296 - 17300	"
	Dat 413 Fr	17301	"
	Elk 5, 7 & 9	13442, 13444 & 13446	"
	Elk 3 Fr & 13 Fr	40225 & 130448	"
	Nu 9 & 10	14493 & 14494	"
Nu 2	Sam 11 - 16	73896 - 73901	Canex Placer
	Sam 35 - 44	73920 - 73929	"
	Sam 48 - 51	73933 - 73936	"
	Sam 81 & 83	80201 & 80203	"
	Sam 85 - 87	80205 - 80207	"
	Dat 1 Fr & 8 Fr	81821 & 81828	Denak
	Dat 403, 405 & 406	17291, 17293 & 17294	"
	Dis 26 & 28-32	15265 & 15267-15271	"
	Elk 12 Fr	81820	"
Nu 1 - 3	14485 - 14487	"	
Nu 4	Elk 2 Fr & 8 Fr	40224 & 42475	Canex Placer



15'

125° W COPIED FROM NATIONAL TOPOGRAPHIC SYSTEM SHEET 93 K

5227
M1

(Nu 4 continued)

<u>Group</u>	<u>Mineral Claims</u>	<u>Record Numbers</u>	<u>Owner</u>
	Sam 5 - 10	73890 - 73895	Canex Placer
	Sam 17 - 32	73902 - 73917	"
	Sam 80, 82 & 84	80200, 80202 & 80204	"
	Dat 3 Fr	81823	Denak
	Dat 407 & 414 Fr	17295 & 17302	"
	Dis 2 Fr	77326	"
	Dis 33 - 36	15272 - 15275	"
	Nu 4 & 5	14488 & 14489	"
	Nu 6	130273	"
	Nu 7 & 8	14491 & 14492	"

PERCUSSION DRILL PROGRAM

A series of vertical two-inch-diameter percussion drill holes were drilled on Elk 5, 13 Frac. and Nu 3 - 5 inclusive Mineral Claims. Sludge samples were collected from bedrock in ten-foot intervals. No samples were obtained from overburden. Samples were dried and assayed for MoS₂ content at Placer Development Laboratory in Vancouver, B.C. Assaying was completed by August 15, 1974.

Two D8 dozers were employed to prepare access roads and drill sites. Part of the road construction was contracted to A. McCubbin, Endako, B.C.; remaining work was undertaken by Endako Mines dozer.

Percussion drilling was contracted to Josco Mining Co. Ltd. Hole R61 on Elk 13 Fractional Mineral Claim was drilled during spring program. Remaining holes were drilled during a separate follow-up program.

The following is a list of percussion drill holes that are being submitted for assessment work purposes on Elk 5, Nu 2 and 4 Groups of Mineral Claims. An appended map on 1" = 1,000' scale shows spatial location of drill holes on mineral claims. Assay results of each hole are also appended.

<u>Hole No.</u>	<u>Location Mineral Claim</u>	<u>Incline</u>	<u>Hole Depth</u>	<u>Overburden Depth</u>	<u>Drilling Period 1974</u>
R61	Elk 3 Frac	-90°	230 feet	10 feet	May 15
R73	Elk 5	"	200 feet	30 feet	July 27 & 28
R74	Elk 5	"	200 feet	10 feet	July 28

<u>Hole No.</u>	<u>Location Mineral Claim</u>	<u>Incline</u>	<u>Hole Depth</u>	<u>Overburden Depth</u>	<u>Drilling Period 1974</u>
(continued)					
R75	Nu 5	-90°	300 feet	5 feet	July 28 & 29
R76	Nu 3	"	300 feet	15 feet	July 29
R77	Nu 3	"	300 feet	10 feet	July 30
R78	Nu 3	"	250 feet	10 feet	July 30
R79	Nu 4	"	300 feet	15 feet	July 31

Hole collars are located in the field by tape and compass traverses from known survey points. Actual collars for completed percussion holes are not surveyed, so as a result, the latitude and departure as recorded on drill logs represent measurements of hole plot on a detailed map. Similarly, collar elevations are estimated to within five feet from a contour map.

STATEMENT OF EXPENDITURES

The following expenditures were incurred by Canex Placer Limited, Endako Mines Division and Denak Mines Ltd. for above eight percussion drill holes.

<u>Personnel</u>	<u>Period Employed</u>	<u>Hours and Rate</u>	<u>Cost</u>
K. Griffith	July 5 - Aug. 1	35 hrs. @ \$4.35 =	\$152.25
A. J. Peters	May 15 & July 5	9 hrs. @ \$5.40 =	48.60
S. W. Wilson	July 5 - Aug. 1	41 hrs. @ \$5.05 =	207.05
			\$ 407.90
Office overhead @ 15% on personnel wages =			61.18

Percussion Drilling Costs

Josco Mining Co. Ltd. invoices dated May 21, 1974, and August 7, 1974 2,080 feet @ \$2.85 per foot	\$5,928.00	
Mobilization to and from property	400.00	\$6,328.00

Assaying Costs

199 Samples for % MoS ₂ @ \$3.00 per assay	597.00
---	--------

Bull-dozer Costs

1. A. McCubbin invoice dated July 15, 1974		
4 hrs. D8 dozer @ \$30.00	120.00	
Mobilization to and from property	181.00	
2. Endako Mines D8 dozer		
2 hrs. @ \$33.00	<u>66.00</u>	367.00

Vehicle Costs

Nine days: 4 hrs. each day @ \$20.00 per
8 hour day 90.00

Miscellaneous Costs

Sampling supplies, repairs, warehouse parts, etc. 100.00

Total Percussion Drilling Costs for above holes = \$7,951.08

Average drilling cost = \$3.80 per foot

CONCLUSION

Eight percussion drill holes totalling 2,080 feet were drilled at average cost of \$3.80 per foot on Elk 5, Nu 2 and 4 Groups of Mineral Claims.

Submitted by:

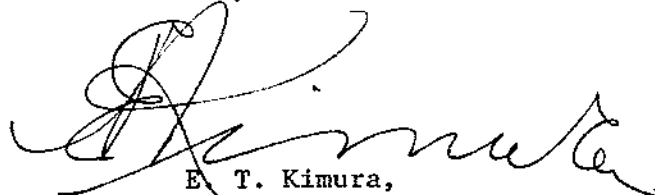
E. T. Kimura,
Senior Geologist.

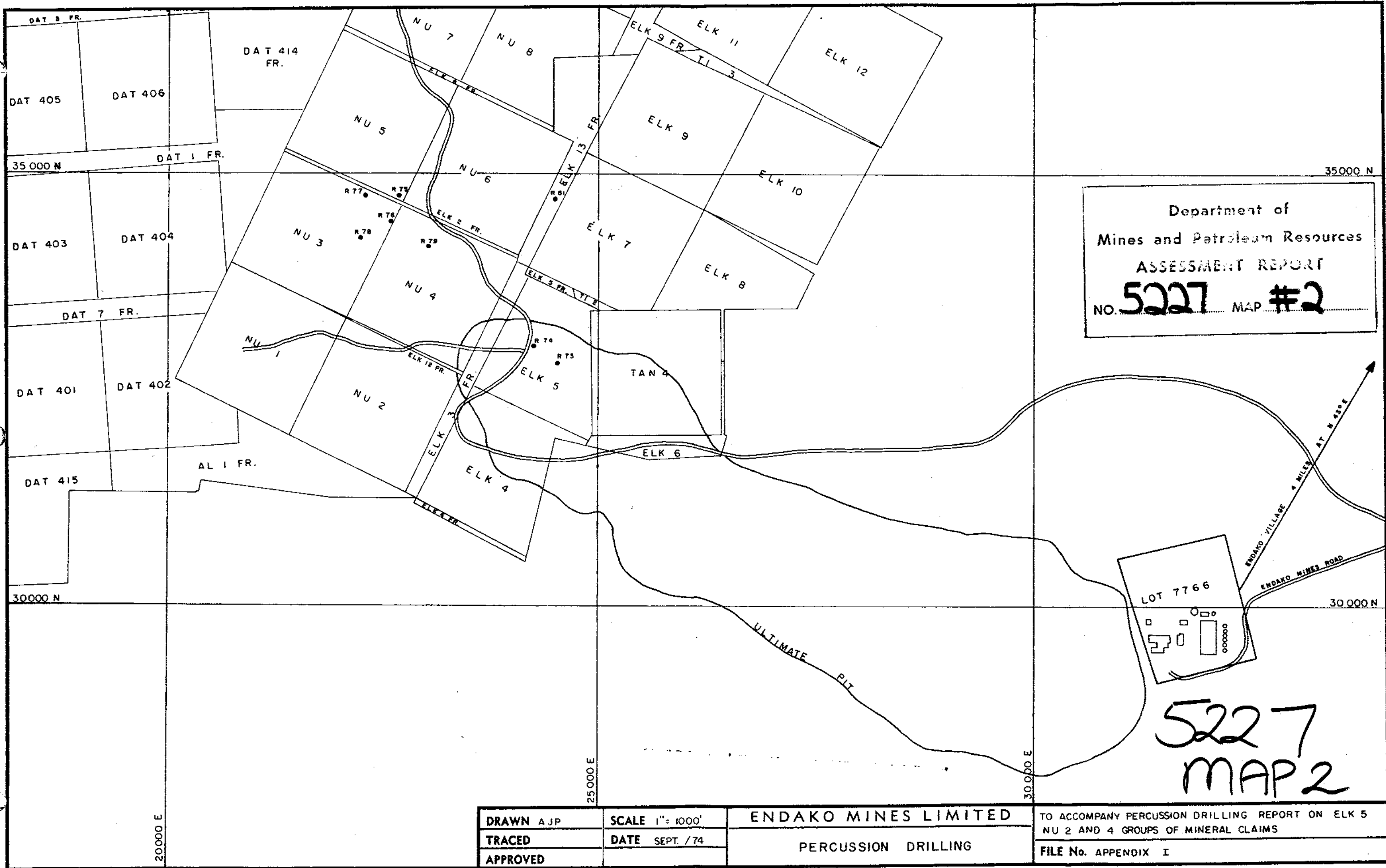

Department of
Mines and Petroleum Resources
ASSESSMENT REPORT
NO. **5227** MAP **#2**

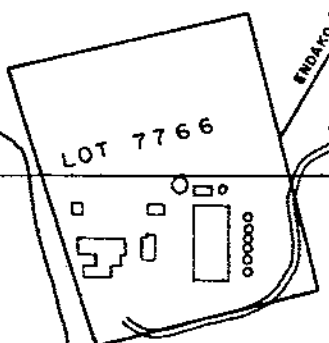

5227
MAP 2

<table border="1"> <tr> <td>DRAWN</td> <td>AJP</td> </tr> <tr> <td>TRACED</td> <td></td> </tr> <tr> <td>APPROVED</td> <td></td> </tr> </table>	DRAWN	AJP	TRACED		APPROVED		<table border="1"> <tr> <td>SCALE</td> <td>1" = 1000'</td> </tr> <tr> <td>DATE</td> <td>SEPT. / 74</td> </tr> </table>	SCALE	1" = 1000'	DATE	SEPT. / 74	<table border="1"> <tr> <td>ENDAKO MINES LIMITED</td> </tr> <tr> <td>PERCUSSION DRILLING</td> </tr> </table>	ENDAKO MINES LIMITED	PERCUSSION DRILLING	<table border="1"> <tr> <td>TO ACCOMPANY PERCUSSION DRILLING REPORT ON ELK 5 NU 2 AND 4 GROUPS OF MINERAL CLAIMS</td> </tr> <tr> <td>FILE No. APPENDIX I</td> </tr> </table>	TO ACCOMPANY PERCUSSION DRILLING REPORT ON ELK 5 NU 2 AND 4 GROUPS OF MINERAL CLAIMS	FILE No. APPENDIX I
DRAWN	AJP																
TRACED																	
APPROVED																	
SCALE	1" = 1000'																
DATE	SEPT. / 74																
ENDAKO MINES LIMITED																	
PERCUSSION DRILLING																	
TO ACCOMPANY PERCUSSION DRILLING REPORT ON ELK 5 NU 2 AND 4 GROUPS OF MINERAL CLAIMS																	
FILE No. APPENDIX I																	

GRID Sec 6700 R/L + 4230'N CANEX PLACER LIMITED ENDAKO MINES DIVISION

HOLE No. R-61
SHEET No. 1 of 2

LOCATION Denak Elk 13 Fr.

BEARING --

LATITUDE 34730 N

LOGGED BY A.J.P.

DATE COLLARED 15/5/74

LENGTH 230'

DEPARTURE 24522 E

DATE 30/5/74

DATE COMPLETED 15/5/74

DIP -90°

ELEVATION 3095

ROCK TYPE AND ALTERATION	SAMPLE WIDTH	TAG NUMBER	% MoS ₂	% Cu	% Zn	% Pb	% Ag	COMMENTS
0 - 10' Overburden								
	10-20	17797	.01					
	20-30	17798	Tr					
	30-40	17799	Tr					
	40-50	17800	Tr					
	50-60	17801	Tr					
	60-70	17802	Tr					
	70-80	17803	Tr					
	80-90	17804	.01					
	90-100	17805	Tr					
	100-110	17806	Tr					
	110-120	17807	Tr					
	120-130	17808	Tr					
	130-140	17809	.02					
	140-150	17810	.01					
	150-160	17811	Tr					
	160-170	17812	.01					

GRID Sec 6900 RL + 2295'N CANEX PLACER LIMITED ENDAKO MINES DIVISION

HOLE No. R 73
SHEET No. 1 of 2

LOCATION Denak Elk 5

BEARING --

LATITUDE 32795 N

LOGGED BY S.W.

DATE COLLARED July 27/1974

LENGTH 200 ft.

DEPARTURE 24485 E

DATE July 29/1974

DATE COMPLETED July 28/1974

DIP -90°

ELEVATION 3202

ROCK TYPE AND ALTERATION	SAMPLE WIDTH	TAG NUMBER	% MoS ₂	% Cu	% Zn	% Pb	% Ag	COMMENTS
0 - 30 ft. Overburden								
	30-40	19155	.02					
	40-50	19156	.05					
	50-60	19157	.05					
	60-70	19158	.15					
	70-80	19159	.18					
	80-90	19160	.10					
	90-100	19161	.12					
	100-110	19162	.07					
	110-120	19163	.04					
	120-130	19164	.05					
	130-140	19165	.11					
	140-150	19166	.20					
	150-160	19167	.11					
	160-170	19168	.08					
	170-180	19169	.14					
	180-190	19170	.13					

GRID Sec 6700 R/L +2500'N CANEX PLACER LIMITED ENDAKO MINES DIVISION

HOLE No. R 74
SHEET No. 1 of 2

LOCATION Denak Elk 5

BEARING --

LATITUDE 33010 N

LOGGED BY S.W.

DATE COLLARED July 28/1974

LENGTH 200 ft.

DEPARTURE 24310 E

DATE July 29/1974

DATE COMPLETED July 28/1974

DIP -90°

ELEVATION 3179

ROCK TYPE AND ALTERATION	SAMPLE WIDTH	TAG NUMBER	% MoS ₂	% Cu	% Zn	% Pb	% Ag	COMMENTS
0 - 10 ft. Overburden								
	10-20	19172	.04					
	20-30	19173	.14					
	30-40	19174	.05					
	40-50	19175	.06					
	50-60	19176	.05					
	60-70	19177	.07					
	70-80	19178	.12					
	80-90	19179	.04					
	90-100	19180	.04					
	100-110	19181	.03					
	110-120	19182	.04					
	120-130	19183	.03					
	130-140	19184	.12					
	140-150	19185	.10					
	150-160	19186	.10					
	160-170	19187	.06					

GRID Sec 4900 R/L +4095N CANEX PLACER LIMITED ENDAKO MINES DIVISION

HOLE No. R 75
SHEET No. 1 of 2

LOCATION Denak Nu 5

BEARING ---

LATITUDE 34750 N

LOGGED BY S.W.

DATE COLLARED July 28/1974

LENGTH 300 ft.

DEPARTURE 22715 E

DATE July 30/1974

DATE COMPLETED July 29/1974

DIP -90°

ELEVATION 3058

ROCK TYPE AND ALTERATION	SAMPLE WIDTH	TAG NUMBER	% MoS ₂	% Cu	% Zn	% Pb	% Ag	COMMENTS
0 - 5 ft. Overburden								
	5-10	19191	.03					
	10-20	19192	.03					
	20-30	19193	.15					
	30-40	19194	.03					
	40-50	19195	.03					
	50-60	19196	.05					
	60-70	19197	.07					
	70-80	19198	.06					
	80-90	19199	.06					
	90-100	19200	.27					
	100-110	19201	.20					
	110-120	19202	.13					
	120-130	19203	.14					
	130-140	19204	.08					
	140-150	19205	.10					
	150-160	19206	.09					

GRID Sec 4900 R/L +3795N CANEX PLACER LIMITED ENDAKO MINES DIVISION

HOLE No. R 76
SHEET No. 1 of 2

LOCATION Denak Nu 3

BEARING --

LATITUDE 34455 N

LOGGED BY S.W.

DATE COLLARED July 29/1974

LENGTH 300 ft.

DEPARTURE 22675 E

DATE July 30/1974

DATE COMPLETED July 29/1974

DIP -90°

ELEVATION 3070

ROCK TYPE AND ALTERATION	SAMPLE WIDTH	TAG NUMBER	% MoS ₂	% Cu	% Zn	% Pb	% Ag	COMMENTS
0 - 15 ft. Overburden								
	15-20	19221	.01					
	20-30	19222	.01					
	30-40	19223	.02					
	40-50	19224	.05					
	50-60	19225	.33					
	60-70	19226	.13					
	70-80	19227	.11					
	80-90	19228	.25					
	90-100	19229	.10					
	100-110	19230	.07					
	110-120	19231	.09					
	120-130	19232	.08					
	130-140	19233	.08					
	140-150	19234	.05					
	150-160	19235	.04					
	160-170	19236	.14					

GRID Sec 4500 R/L + 4020'N CANEX PLACER LIMITED ENDAKO MINES DIVISION

HOLE No. R 77
SHEET No. 1 of 2

LOCATION Denak Nu 3

BEARING --

LATITUDE 34715 N

LOGGED BY S.W.

DATE COLLARED July 30/1974

LENGTH 300 ft.

DEPARTURE 22305 E

DATE July 31/1974

DATE COMPLETED July 30/1974

DIP -90°

ELEVATION 3054

ROCK TYPE AND ALTERATION	SAMPLE WIDTH	TAG NUMBER	% MoS ₂	% Cu	% Zn	% Pb	% Ag	COMMENTS
0 - 10 ft. Overburden								
	10-20	19250	.01					
	20-30	19251	.05					
	30-40	19252	.05					
	40-50	19253	.10					
	50-60	19254	.25					
	60-70	19255	.06					
	70-80	19256	.06					
	80-90	19257	.03					
	90-100	19258	.04					
	100-110	19259	.23					
	110-120	19260	.14					
	120-130	19261	.14					
	130-140	19262	.06					
	140-150	19263	.14					
	150-160	19264	.07					
	160-170	19265	.06					

GRID Sec 4500 R/L +3580'N CANEX PLACER LIMITED ENDAKO MINES DIVISION

HOLE No. R 78
SHEET No. 1 of 2

LOCATION Denak Nu 3

BEARING --

LATITUDE 34285 N

LOGGED BY S.W.

DATE COLLARED July 30/1974

LENGTH 250 ft.

DEPARTURE 22255 E

DATE July 31/1974

DATE COMPLETED July 30/1974

DIP -90°

ELEVATION 3057

ROCK TYPE AND ALTERATION	SAMPLE WIDTH	TAG NUMBER	% MoS ₂	% Cu	% Zn	% Pb	% Ag	COMMENTS
0 - 10 ft. Overburden								
	10-20	19279	.01					
	20-30	19280	.01					
	30-40	19281	.02					
	40-50	19282	.02					
	50-60	19283	.32					
	60-70	19284	.23					
	70-80	19285	.29					
	80-90	19286	.34					
	90-100	19287	.12					
	100-110	19288	.11					
	110-120	19289	.10					
	120-130	19290	.08					
	130-140	19291	.05					
	140-150	19292	.18					
	150-160	19293	.19					
	160-170	19294	.11					

GRID Sec 5300 R/L +3505'N CANEX PLACER LIMITED ENDAKO MINES DIVISION

HOLE No. R 79
SHEET No. 1 of 2

LOCATION Denak Nu 4

BEARING --

LATITUDE 34135 N

LOGGED BY S.W.

DATE COLLARED July 31/1974

LENGTH 300 ft.

DEPARTURE 23040 E

DATE July 31, 1974

DATE COMPLETED July 31/1974

DIP -90°

ELEVATION 3120

ROCK TYPE AND ALTERATION	SAMPLE WIDTH	TAG NUMBER	% MoS ₂	% Cu	% Zn	% Pb	% Ag	COMMENTS
0 - 15 ft. Overburden								
	15-20	19303	.10					
	20-30	19304	.03					
	30-40	19305	.03					
	40-50	19306	.04					
	50-60	19307	.06					
	60-70	19308	.07					
	70-80	19309	.08					
	80-90	19310	.09					
	90-100	19311	.04					
	100-110	19312	.07					
	110-120	19313	.05					
	120-130	19314	.04					
	130-140	19315	.02					
	140-150	19316	.02					
	150-160	19317	.03					
	160-170	19318	.03					

