

QUINLANA MINERALS CORPORATION
1215 - TWO BENTALL CENTRE
VANCOUVER, BRITISH COLUMBIA V7X 1G4

(AREA CODE 604)
TELEPHONE 688-4683

January 6, 1975

Mr. R. Rutherford
Deputy Chief Gold Commissioner
Mineral Resources Branch
Department of Mines and
Petroleum Resources
Victoria, B. C.

Dear Sir:

Re: File No. 166 - Omineca

In reply to your letter of Dec. 31, 1974,

<u>Holes Drilled</u>	<u>Total Depth</u>	<u>Depth of Overburden</u>
PDH-74-22	130	50
23	110'	110'
24	130	20
25	110'	90

Yours very truly,

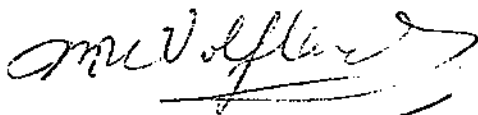

M.R. Wolfhard

MRW:jl

Department of Mines and Petroleum Resources ASSESSMENT REPORT NO. <u>5277</u> MAP.....

LILY PROJECT

ITEMIZED COST STATEMENT

Wages, G. Richards Nov. 4 to 8 @ \$60/day	\$ 300.00
Contract slashing, G. Audet	200.00
Percussion drilling, 500' @ \$4/ft.	2000.00
Mobilize drill	300.00
Water truck rental	150.00
Board & Room, G. Richards	<u>90.00</u>
	\$3040.00

Declared before me at the city
of Vancouver, in the
Province of British Columbia, this 12
day of November 1974, A.D.

[Handwritten Signature]

[Handwritten Signature]
A Commissioner for taking Affidavits within the Province
A Notary Public and for the Province
Joan Gunn

Sub-mining Recorder

Department of
Mines and Petroleum Resources
ASSESSMENT REPORT
NO. 5277 MAP _____

Department of
 Mines and Petroleum Resources

ADVISORY REPORT

NO. 5277 MAP #1

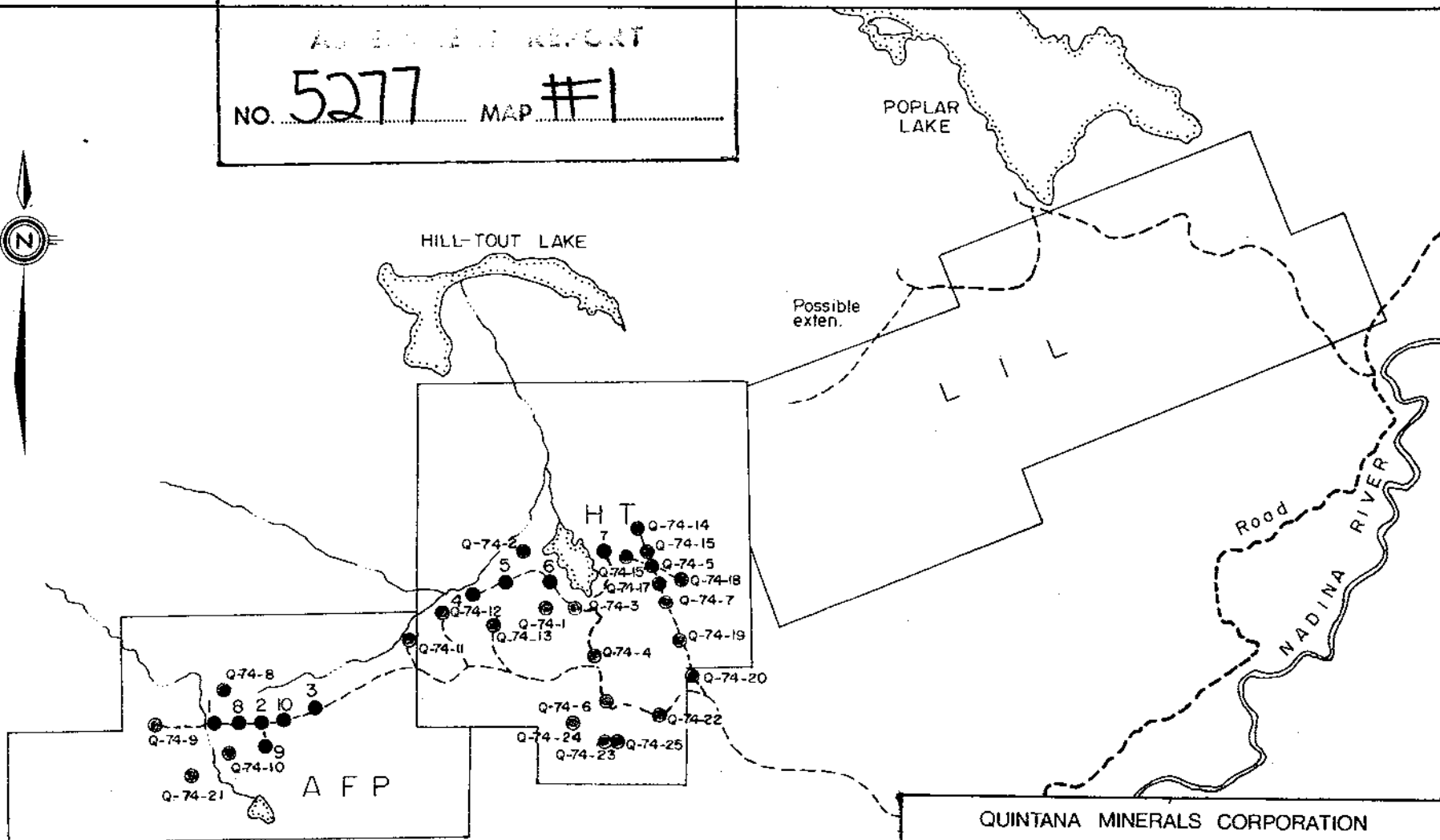

- PERCUSSION HOLES PROPOSED
- ◐ " " IN PROGRESS
- " " COMPLETED
- PERCUSSION DRILL HOLES COMPLETED 1973

M. D. O'Leary

QUINTANA MINERALS CORPORATION

LILY PROJECT

AFP, HT and LIL GROUP
 DRILLING PROGRESS MAP

SCALE

1.25 inch to 1 mile approx.

Prepared by: M.R.W.
 Drawn by: ATK.

Date: July 74.
 Revised: 16/8/80
 Sept. 1974 Oct 18

NTS MAP AREA
 93-E, 14, 15

DRAWING No.

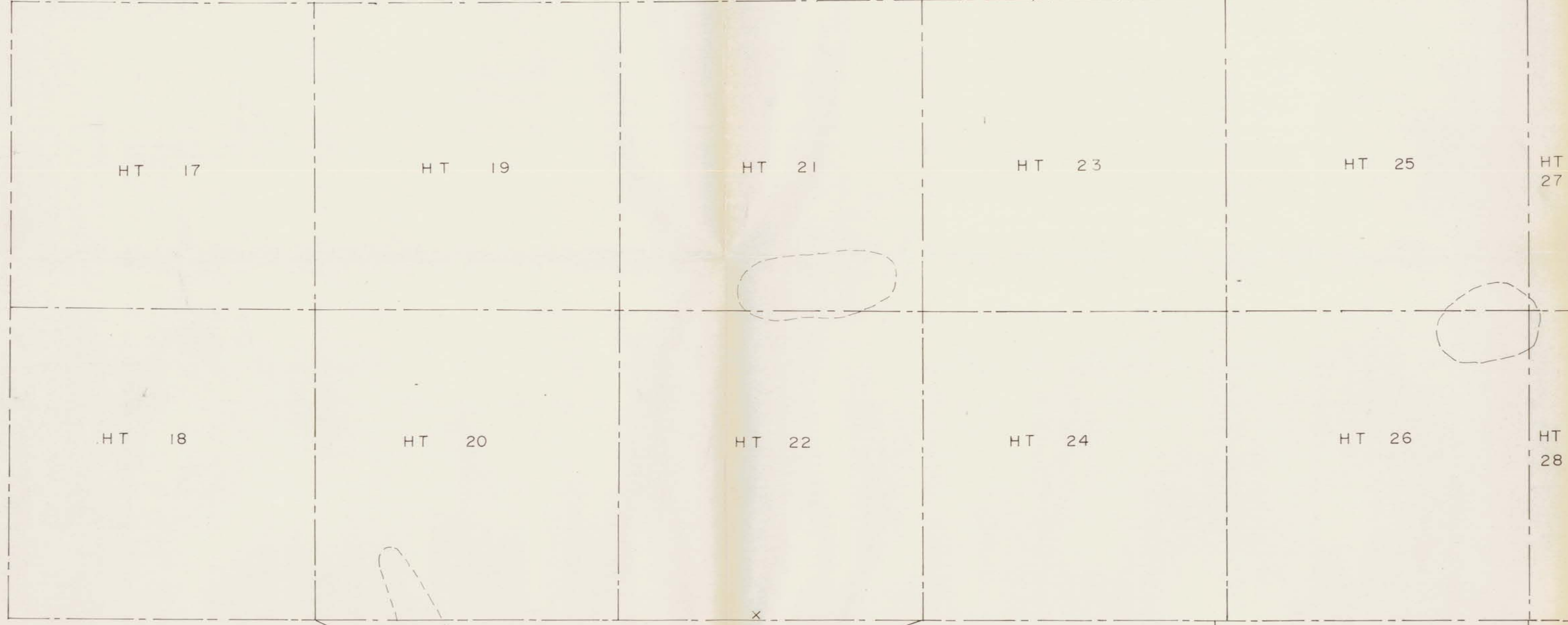

- REFERENCE**
- $\Delta 20$ Survey station
 - Road or cut trail
 - Percussion drill hole
 - Outcrop on road
 - Small outcrop
 - Area of scattered outcrop
 - Outcrop
 - Claim post, surveyed
 - Claim boundary
- Survey data: MRW, topofil and compass

Department of
Mines and Petroleum Resources
ALBERTA REPORT
NO. 5277 MAP #2

5277
MAP 2

QUINTANA MINERALS CORPORATION

LILY PROJECT

DRILLING AND ROADS

MRW

SCALE 1" = 400'

Prepared by: MRW Date: Oct 9/73
Drawn by: A.T.K. Revised: Oct 8/74, Nov 6/74

NTS MAP AREA
93 - E

DRAWING No.