

NORTH

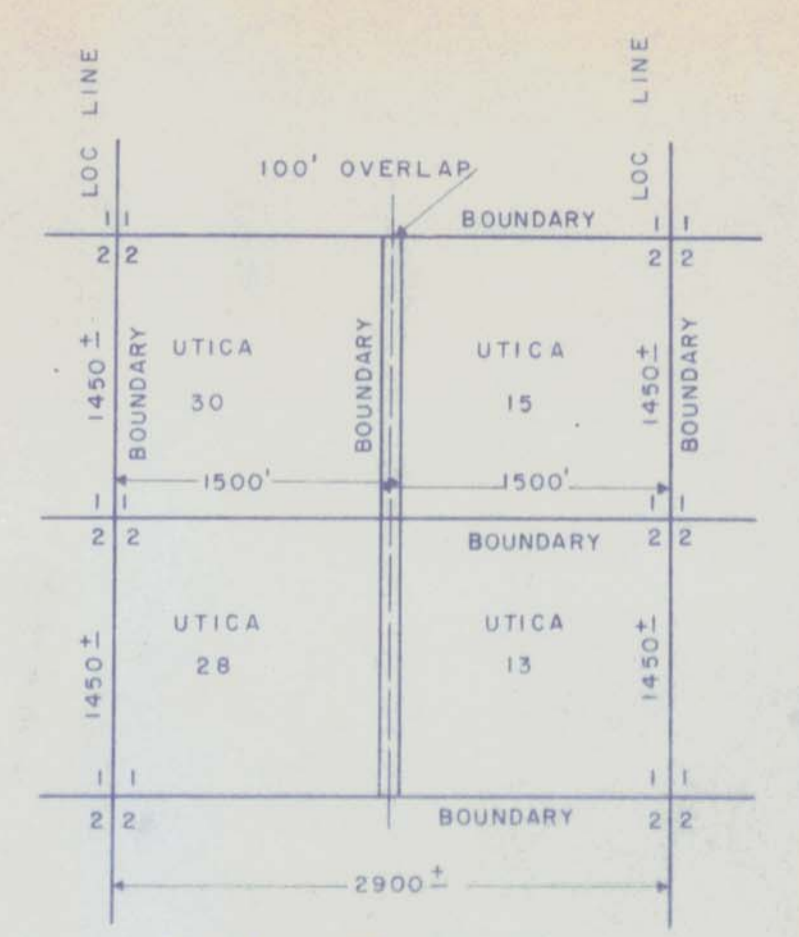

LEGEND

CO-ORDINATES
 CO-ORDINATES BASED ON MINE STATION TR 1 AS
 N26187.2 E278284 GRID AZIMUTH REFERRED
 TO MINE BEARING BETWEEN TR 1 AND TR 2 AS
 S24° 16' 11" W. ELEVATIONS ON GEODETIC DATUM.
 BASE MAP
 COMPILED IN JULY 1966 BY
 WELSHANNEY SURVEYING & ENGINEERING LTD.
 FROM AERIAL PHOTOGRAPHS FLOWN IN JUNE 1966
 AT AN APPROXIMATE SCALE OF 1 INCH = 2000 FEET
 MAP COMPILED AT 1 INCH = 400 FEET AND REDUCED
 PHOTOGRAPHICALLY TO 1 INCH = 2000 FEET

THE STAKING SURVEY WAS CARRIED OUT BY MEANS
 OF LOW ORDER SURVEY METHODS CHECKED
 AGAINST PHOTOGRAMMETRICALLY CO-ORDINATED POINTS
 TIED TO DURING THE PROGRESS OF THE WORK
 THE POSITIONING OF THE STAKING POSTS IS
 ESTIMATED TO BE WITHIN AN ACCURACY OF 1.15 FEET.
 EACH CLAIM HAS BEEN STAKED WITH A SUFFICIENT
 OVERLAP ALLOWANCE THAT ANY POSSIBLE FRACTION
 CREATED BY INACCURATE POST POSITIONS WILL BE ELIMINATED

STAKING POST — 4"x4" CEDAR 4' HIGH
 PAINTED WITH RED FLOUORESCENT PAINT
 CONTROL MONUMENT AND IDENTIFYING
 NUMBER MONUMENT CONSISTS OF 1/2"
 ALUMINUM BAR WITH TAG

Department of Mines and Petroleum Resources
 ASSESSMENT REPORT
 No. 5293 MAP #6

5293 M6

DANKOE MINES LTD
 RICHTER MOUNTAIN — OSOYOOS MINING DISTRICT
 MINERAL CLAIMS
 JAN 1967





DANKOE
UTICA MINES LTD.

5293

2210 LEVEL
SCALE: 1" = 30 FT.

Department of
Mines and Petroleum Resources
ASSESSMENT REPORT
NO. 5093 MAP #3

DATE:

MAP 3



LEGEND

Co-ordinate	— 21 —
Claim Boundary	— 21 —
Road	— —
Cat Road	- - - -
Surface Track	— —
Survey Station	⊙
Triangulation Point	△
1700 Level	— 17 —
2200 Level	— 22 —
2400 Level	— 24 —
2500 Level	— 25 —
2600 Level	— 26 —
3000 Level	— 30 —
Raise	— —
Raise Start	⊠
Raise Top	⊠
Ore Pass	⊠

Department of
Mines and Petroleum Resources
ASSESSMENT REPORT
NO. 5293 MAP #5

DANKOE MINES LTD.
PLATE NO. 1022
COMPOSITE

Scale: 1" = 100' Drawn By: JBC Date: 12/73
Revisions:

5293 M5