

5294

104 I / IW

IMPERIAL OIL LIMITED
AND
ARCTIC DIAMOND DRILLING LTD.

6-23

STATEMENT OF QUALIFICATIONS

I, J. Peter Neilans, of Vancouver, British Columbia, hereby certify the following qualifications:

(a) I obtained a B.A.Sc. degree in Geological Engineering (1973) from the University of British Columbia, Vancouver, B.C.

(b) I have been practising my profession as a geological engineer in Canada for the last year.

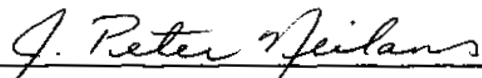

J. Peter Neilans



Kutcho Creek

Rainbow Lakes

Wolverine Lake

Gray Lake

Hortah Lake

LOCATION OF JEFF CLAIMS

GROUPS I, II, III

CRY LAKE - 104 I/1

SPATSIZI

PLATEAU

MT BLAIR

5294
MAP I

1:250,000

45'

10'

15'

125 00'

60'
43
17
46
15
15
14
13

125° 30'

58° 15'

CLAIM INDEX MAP - JEFF CLAIMS

104 I/LW

54577 H
 54578 H
 54579 H
 54580 H
 54581 H
 54582 H
 54583 H
 54584 H
 54585 H
 54586 H
 54587 H
 54588 H
 54589 H
 54590 H
 54591 H
 54592 H
 54593 H
 54594 H
 54595 H
 54596 H
 54597 H
 54598 H
 54599 H
 54600 H

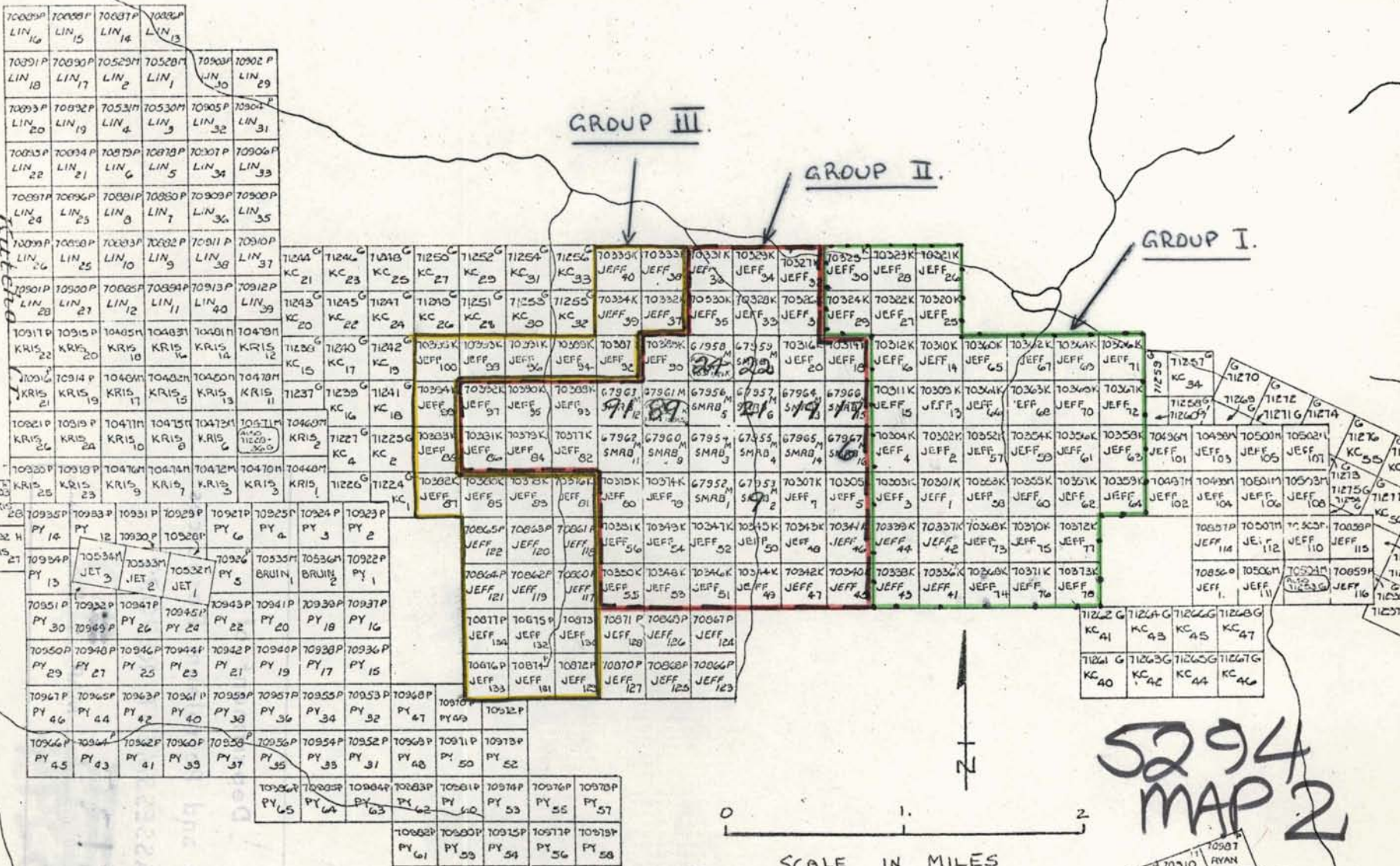

6

5

71431 H BOW 20
 71432 H BOW 19
 71433 H BOW 18
 71434 H BOW 17
 71435 H BOW 16
 71436 H BOW 15
 71437 H BOW 14
 71438 H BOW 13
 71439 H BOW 12
 71440 H BOW 11
 71441 H BOW 10
 71442 H BOW 9
 71443 H BOW 8
 71444 H BOW 7
 71445 H BOW 6
 71446 H BOW 5
 71447 H BOW 4
 71448 H BOW 3
 71449 H BOW 2
 71450 H BOW 1

70990 RYAN 6
 70991 RYAN 5
 70992 RYAN 4
 70993 RYAN 3
 70994 RYAN 2
 70995 RYAN 1
 70996 JANE 33
 70997 JANE 32
 70998 JANE 31
 70999 JANE 30
 71000 JANE 29
 71001 JANE 28
 71002 JANE 27
 71003 JANE 26
 71004 JANE 25
 71005 JANE 24
 71006 JANE 23
 71007 JANE 22
 71008 JANE 21
 71009 JANE 20
 71010 JANE 19
 71011 JANE 18
 71012 JANE 17
 71013 JANE 16
 71014 JANE 15
 71015 JANE 14
 71016 JANE 13
 71017 JANE 12
 71018 JANE 11
 71019 JANE 10
 71020 JANE 9
 71021 JANE 8
 71022 JANE 7
 71023 JANE 6
 71024 JANE 5
 71025 JANE 4
 71026 JANE 3
 71027 JANE 2
 71028 JANE 1

DIAMOND DRILL CORE LOG

DRILL HOLE NO. Jeff #1 LOCATION: Jeff #4 claim
AZIMUTH: 180° CORE SIZE: BQ
INCLINATION: -50° CORE STORAGE: Property

DESCRIPTION

FROM	TO	DESCRIPTION
0	23	Overburden and casing.
23	65	Quartz-Talc Schist: very fine-grained, whitish-grey; moderately sheared at 70° c/a; acid fragments and quartz eyes common; trace pyrite.
65	78	Quartz Eye Schist: very fine-grained, greenish-white; acid fragments and quartz eyes to 3/4"; moderately sheared at 70° c/a with chlorite, sericite, limonite and pyrite on foliation planes.
78	136	Dacite (?): very fine-grained, greenish-grey; minor quartz and carbonate fragments; weakly sheared at 70° c/a with chlorite and sericite on foliation planes; minor disseminated pyrite.
136	172.5	Quartz-Talc Schist: white, very fine-grained; fragments of carbonate and feldspar common; strongly sheared at 70° c/a; minor pyrite, trace chalcopyrite and sphalerite.
172.5	179.5	Dolomite Augen-Talc-Chlorite Schist: very fine-grained, greyish-green; dolomite augens to 1/4"; strongly sheared at 75° c/a with talc and sericite along foliations.
179.5	207.5	Quartz-Dolomite: fine-grained, white; intermixed quartz and dolomite; inclusions of the above schists; minor pyrite, trace chalcopyrite, tetrahedrite.
207.5	376	Quartz-Talc Schist: very fine-grained, greyish-white; minor quartz and carbonate fragments; strongly sheared at 75° c/a with talc on foliation planes; mainly pyrite, minor chalcopyrite, bornite, sphalerite.
376	386	Dolomite Augen Schist: like 172.5' - 179.5'.
386	468	Quartz-Talc Schist: like 207.5' - 376', minor pyrite only.
468	537	Dolomite Augen-Talc Schist: like 172.5' - 179.5'.
537	537	End of Hole.

J. Peter Neilans

DIAMOND DRILL CORE LOG

DRILL HOLE NO.	Jeff #2	LOCATION:	Jeff #6 Claim
AZIMUTH:	171°	CORE SIZE:	BQ
INCLINATION:	-50°	CORE STORAGE:	Property

DESCRIPTION

FROM	TO	
0	9	Overburden and casing.
9	161	Quartz Augen-Sericite Schist: fine-grained, greyish-white; quartz eyes to ¼", occasional acid fragments; moderately sheared at 75° c/a with chlorite and sericite on foliation planes; trace pyrite.
161	284.5	Quartz-Talc Schist: very fine-grained, dark grey; sheared acid fragments; talc and chlorite on foliation planes at 75° c/a; mainly pyrite, minor chalcopyrite, sphalerite, bornite.
284.5	304.5	Dolomite Augen-Talc-Chlorite Schist: very fine-grained, greyish-green; dolomite augens and minor feldspar fragments common; talc and chlorite along foliation planes at 75° c/a; minor pyrite.
304.5	377	Quartz Chlorite Schist: very fine-grained, green; minor acid and dolomitic fragments; sericite and chlorite on foliation planes at 80° c/a; minor pyrite, trace chalcopyrite, sphalerite, bornite.
	377	END OF HOLE.

J. Peter Feilans

DIAMOND DRILL CORE LOG

DRILL HOLE NO. Jeff #3 LOCATION: Jeff #4 claim
AZIMUTH: 180° CORE SIZE: BQ
INCLINATION: -50° CORE STORAGE: Property

DESCRIPTION

FROM	TO	DESCRIPTION
0	16	Overburden and casing.
16	41	Quartz-Sericite Schist: fine-grained, grey-white; acid fragments common; weakly sheared at 65° c/a; chlorite and sericite on foliation planes.
41	66	Quartz-Talc Schist: very fine-grained, light grey; minor acid fragments; moderately sheared at 65° c/a.
66	178	Chlorite-Talc Schist: very fine-grained, green; acid fragments to ¼"; weakly sheared at 70° c/a with chlorite and talc on foliation planes; trace pyrite.
178	195	Quartz-Talc Schist: very fine-grained, grey; minor acid fragments; highly sheared at 75° c/a with talc on foliation planes; minor pyrite, trace chalcopryite, bornite.
195	268	Chlorite - Talc Schist: like 66' - 178'.
268	346	Dolomite Augen-Chlorite-Talc Schist; very fine-grained, greyish green; augens of dolomite to ½"; moderately sheared at 75° c/a with talc and chlorite on foliation planes; minor pyrite.
346	493.5	Quartz-Talc Schist; like 178' - 195'; minor pyrite, trace chalcopryite, sphalerite (?).
493.5	547	Dolomite Augen-Chlorite-Talc Schist and Quartz-Talc Schist; alternating bands 4' - 20' wide.
	547	END OF HOLE.

J. Peter Neilans

DIAMOND DRILL CORE LOG

DRILL HOLE NO.	Jeff #4	LOCATION:	Jeff #6 claim
AZIMUTH:	171°	CORE SIZE:	BQ
INCLINATION:	-50°	CORE STORAGE:	Property

DESCRIPTION

FROM	TO	
0	20.5	Overburden and casing.
20.5	174	Quartz Augen-Sericite Schist: fine-grained, bluish-grey; quartz augens to $\frac{1}{4}$ " ; minor acid fragments; moderately sheared at 75° c/a; chlorite and sericite on foliation planes; minor pyrite, limonite.
174	292.5	Quartz-Talc Schist: fine-grained, grey; acid fragments to $\frac{1}{4}$ " ; strongly sheared at 75° c/a; pyrite, chalcopyrite, sphalerite, bornite present.
292.5	357	Quartz-Chlorite Schist: very fine-grained, grey-green acid and carbonate fragments to $\frac{3}{4}$ " ; chlorite and sericite on foliation planes (75° c/a); moderately sheared; minor pyrite, trace chalcopyrite.
	357	END OF HOLE.

J. Peter Neilans

DIAMOND DRILL CORE LOG

DRILL HOLE NO.	Jeff #5	LOCATION:	Jeff #4 claim
AZIMUTH:	171°	CORE SIZE:	BQ
INCLINATION:	-50°	CORE STORAGE:	Property

DESCRIPTION

FROM	TO	
0	12	Overburden and casing.
12	134.5	Quartz Augen-Sericite Schist; fine-grained, grey; quartz eyes to ¼"; mostly sericite on foliation planes (65° c/a); moderately sheared; trace pyrite.
		117 - 123 - Dolomite Augen-Talc Schist.
134	277	Quartz-Talc Schist; very fine-grained, bluish-grey to grey-white; acid and carbonate fragments to ¼"; strongly sheared at 80° c/a with talc and minor chlorite on foliation planes; mainly pyrite, minor chalcopyrite, sphalerite, bornite.
	277	END OF HOLE.

J. Peter Neilans

DIAMOND DRILL CORE LOG

DRILL HOLE NO. Jeff #6 LOCATION: Jeff #6 claim
AZIMUTH: 189° CORE SIZE: BQ
INCLINATION: -50° CORE STORAGE: Property

DESCRIPTION

FROM	TO	DESCRIPTION
0	3	Overburden and casing.
3	188	Quartz Augen-Sericite Schist: fine-grained, grey-green; quartz eyes to ¼" with minor acid fragments; shearing weak to moderate at 70° c/a with chlorite and sericite on foliation planes; minor pyrite and limonite.
188	317	Quartz-Talc Schist: very fine-grained, grey; acid fragments to ¼", highly sheared; mainly talc on foliation planes (80° c/a); mainly pyrite, with chalcopyrite, sphalerite, bornite.
	317	END OF HOLE.

J. Peter Neilans

DIAMOND DRILL CORE LOG

DRILL HOLE NO. Jeff #7 LOCATION: Jeff #6 claim

AZIMUTH: 180° CORE SIZE: BQ

INCLINATION: -50° CORE STORAGE: Property

DESCRIPTION

FROM	TO	DESCRIPTION
0	9	Overburden and casing.
9	117	Quartz Augen-Sericite Schist: fine-grained, greyish-green; quartz eyes to ¼", minor acid fragments; moderately sheared at 70° c/a; chlorite and sericite on foliation planes; minor pyrite and limonite.
117	229	Quartz-Talc Schist: very fine-grained, greenish-grey; highly sheared at 70° c/a; sericite, talc and minor chlorite on foliation planes; minor acid and carbonate fragments; mainly pyrite, minor chalcopyrite, sphalerite, bornite.
229	260	Quartz-Chlorite Schist: very fine-grained, green; acid fragments to ½", minor quartz eyes; highly sheared at 80° c/a; chlorite and talc on foliation planes; trace pyrite.
260	287	Quartz-Talc Schist: like 117' - 229'; trace pyrite only.
	287	END OF HOLE.

J. Peter Neilans

DIAMOND DRILL CORE LOG

DRILL HOLE NO.	Jeff #8	LOCATION:	Jeff #4 claim
AZIMUTH:	180°	CORE SIZE:	BQ
INCLINATION:	-50°	CORE STORAGE:	Property

DESCRIPTION

FROM	TO	DESCRIPTION
0	19	Overburden and casing.
19	270	Quartz Augen-Sericite Schist: fine-grained, greyish-green; quartz eyes to ¼" with minor acid fragments; weakly to moderately sheared at 75 - 80° c/a; chlorite and sericite on foliation planes; minor pyrite, limonite, ankerite (?).
270	504.5	Quartz-Talc Schist: very fine-grained, grey; acid fragments to ¼", rarely to 3/4"; strongly sheared at 80° c/a, with mainly talc on foliation planes; pyrite with minor chalcopyrite, bornite.
504.5	607	Quartz-Chlorite Schist: very fine-grained, green; moderately sheared at 80° c/a; chlorite and talc on foliation planes; acid fragments to ½"; minor pyrite.
	607	END OF HOLE.

J. Peter Neilans

DIAMOND DRILL CORE LOG

DRILL HOLE NO.	Jeff #9	LOCATION:	Jeff #6 claim
AZIMUTH:	180°	CORE SIZE:	IEX
INCLINATION:	-50°	CORE STORAGE:	Property

DESCRIPTION

FROM	TO	
0	10	Overburden and casing.
10	41	Metagabbro: medium-grained, dark green; matrix strongly altered to biotite and chlorite; minor carbonate and magnetite; moderately foliated at 35° c/a.
41	54	Quartz-Sericite Schist; fine-grained, grey-green; minor acid fragments; sericite on foliation planes (55° c/a); minor limonite and pyrite.
54	122	Quartz-Sericite (Talc) Schist: very fine-grained, grey; more siliceous than above unit; minor acid fragments to 1/8"; sericite and talc on foliation planes (60 - 65° c/a); minor pyrite.
122	198	Quartz Augen-Sericite Schist: fine-grained; greyish-green; quartz eyes and acid fragments to 1/8"; moderately sheared with chlorite and sericite on foliation planes (70° c/a); trace pyrite.
198	258	Dacite (?): fine-grained, grey-green; feldspar fragments to 1/8" plus rare quartz eyes; minor sericite on foliation planes at 75-80° c/a; minor pyrite.
	258	END OF HOLE.

J. Peter Neilans

DIAMOND DRILL CORE LOG

DRILL HOLE NO. Jeff B-1 LOCATION: Jeff #40 claim
AZIMUTH: 180° CORE SIZE: IEX
INCLINATION: -50° CORE STORAGE: Property

DESCRIPTION

FROM	TO	DESCRIPTION
0	17	Overburden and casing.
17	166	Limey Argillite: black to dark grey, aphanitic; soft, banded argillite and grey limestone; banding at 70° c/a; minor pyrrhotite, graphite and chalcopyrite.
166	191.5	Grey Limestone: mottled grey and white, fine-grained, crystalline; brecciated texture; becomes more argillaceous down hole.
191.5	199	Argillite: black, aphanitic; strongly graphitic; foliated at 70° c/a.
	199	END OF HOLE.

J. Peter Neilans

SUMMARY OF DRILLING - GROUP NO. I.

HOLE NO.	GRID LOCATION	DATES	CONTRACTOR	DRILL TYPE	AZIMUTH	ANGLE	TOTAL LENGTH	HORIZ. PROJ.	VERT. PROJ.	TOTAL COST	COST/FO
1	L24W; 7+50 N	25/6-2/7	Arctic Diamond Drilling Ltd.	BBS-1	180°	-50°	537'	345'	412'	\$10,778.95	\$20.07
3	L20W; 6+50 N	6/7 - 7/7	Arctic Diamond Drilling Ltd.	BBS-1	180°	-50°	547'	352'	419'	8,480.13	15.50
5	L26+20W; 6+00N	10/7-11/7	Arctic Diamond Drilling Ltd.	BBS-1	171°	-50°	277'	178'	212'	5,714.23	20.63
8	L28W; 8+50N	18/7-21/7	Arctic Diamond Drilling Ltd.	BBS-1	180°	-50°	607'	390'	464'	10,188.75	16.79
							TOTAL:			1968'	\$35,162.06

SUMMARY OF DRILLING - GROUP NO. II.

HOLE NO.	GRID LOCATION	DATES	CONTRACTOR	DRILL TYPE	AZIMUTH	ANGLE	TOTAL LENGTH	HORIZ. PROJ.	VERT. PROJ.	TOTAL COST	COST/FOOT
2	L28+20W;6+00N	3/7-5/7	Arctic Diamond Drilling Ltd.	BBS-1	171°	-50°	377'	242'	288'	\$ 7,566.37	\$20.07
4	L30+20W;6+00N	8/7-9/7	Arctic Diamond Drilling Ltd.	BBS-1	171°	-50°	357'	230'	273'	6,208.79	17.39
6	L35+80W;5+20N	12/7-13/7	Arctic Diamond Drilling Ltd.	BBS-1	189°	-50°	317'	204'	242'	6,192.51	19.53
7	L32W; 4+50N	14/7-17/7	Arctic Diamond Drilling Ltd.	BBS-1	180°	-50°	287'	184'	220'	6,724.93	23.43
9	L28W; 9+50N	28/7-1/8	D.W. Coates Enterprises Ltd.	Morex 350	180°	-50°	258'	166'	197'	4,149.68	16.08
							TOTAL:			1596'	\$30,842.28

SUMMARY OF DRILLING - GROUP NO. III.

HOLE NO.	GRID LOCATION	DATES	CONTRACTOR	DRILL TYPE	AZIMUTH	ANGLE	TOTAL LENGTH	HORIZ. PROJ.	VERT. PROJ.	TOTAL COST	COST/FOOT
Jeff B-1	L00; 2+25S	18/7-22/7	D.W. Coates Enterprises Ltd.	Morex 350	180°	-50°	199'	128'	152'	\$ 5,426.27	\$ 27.27

DRILL COST SUMMARY

GROUP NO. I.

HOLE NO.	DIRECT DRILL.	MOB/DEMOB	FUEL	HELICOPTER	CAMP	SALARIES SUPERVISORY/COOK	TOTAL	COST/FOOT
1	\$ 4,584.55	\$ 811.53	\$ 527.35	\$ 512.00	\$ 3,607.52	\$736.00	\$10,778.95	\$ 20.07
3	5277.55	811.53	537.17	768.00	901.88	184.00	8,480.13	15.50
5	2776.80	811.53	272.02	768.00	901.88	184.00	5,714.23	20.63
8	6339.05	811.53	596.09	640.00	1,546.08	256.00	10,188.75	16.79
						TOTAL:	\$35,162.06	

DRILL COST SUMMARY

GROUP NO. II

HOLE NO.	DIRECT DRILL.	MOB/DEMOB	FUEL	HELICOPTER	CAMP	SALARIES SUPERVISORY/COOK	TOTAL	COST/FOOT
2	\$ 3,731.80	\$ 811.53	\$ 370.22	\$ 1,024.00	\$ 1,352.82	\$ 276.00	\$ 7,566.37	\$ 20.07
4	3,448.80	811.53	350.58	512.00	901.88	184.00	6,208.79	17.39
6	3,151.80	811.53	311.30	832.00	901.88	184.00	6,192.51	19.53
7	2,947.80	811.53	281.84	512.00	1,803.76	368.00	6,724.93	23.43
9	1,829.27	702.11		512.00	966.30	140.00	4,149.68	16.08
						TOTAL:	\$30,842.28	

DRILL COST SUMMARY

GROUP NO. III

HOLE NO.	DIRECT DRILL.	MOB/DEMOB	FUEL	HELICOPTER	CAMP	SALARIES SUPERVISORY/COOK	TOTAL	COST/FOOT
Jeff B-1	\$ 1,825.26	\$ 702.11		\$ 1,792.00	\$ 966.30	\$ 140.00	\$ 5,426.27	\$ 27.27

COST STATEMENT

A. CAMP COST CALCULATION (for entire drilling project)

Equipment (tents, lumber, radios, etc.)	\$6268.10
Fuel (stove oil, propane, gas, etc.)	1362.37
Food	3489.14
Air Support (includes mobilization costs)	11298.55
Fixed Wing	3360.21
Helicopter	7938.34
	<hr/>
TOTAL:	\$22,418.16

\$22,418.16 ÷ 348 man-days = \$64.42/man-day
- camp costs were calculated at a rate of \$64.42/man-day

B. SALARY CALCULATION (Supervisory & Cook)

1. Group I.

HOLE NO.	DATES	PERSONNEL*	RATE	TOTAL
1	25/6-2/7	P. Neilans (G)	8 d x \$35/d	\$736.00
		R. Wittebolle (A)	8 d x \$21/d	
		D. Lindwall (C)	8 d x \$36/d	
3	6/7-7/7	P. Neilans (G)	2 d x \$35/d	184.00
		R. Wittebolle (A)	2 d x \$21/d	
		D. Lindwall (C)	2 d x \$36/d	
5	10/7-11/7	P. Neilans (G)	2 d x \$35/d	184.00
		R. Wittebolle (A)	2 d x \$21/d	
		D. Lindwall (C)	2 d x \$36/d	
8	18/7-21/7	P. Neilans (G)	2 d x \$35/d	256.00
		R. Wittebolle (A)	2 d x \$21/d	
		D. Lindwall (C)	4 d x \$36/d	

* (G) geologist, (A) assistant, (C) cook

2. Group II.

HOLE NO.	DATES	PERSONNEL	RATE	TOTAL
2	3/7-5/7	P. Neilans (G)	3 d x \$35/d	\$276.00
		R. Wittebolle (A)	3 d x \$21/d	
		D. Lindwall (C)	3 d x \$36/d	
4	8/7-9/7	P. Neilans (G)	2 d x \$35/d	184.00
		R. Wittebolle (A)	2 d x \$21/d	
		D. Lindwall (C)	2 d x \$36/d	

2. Group II. (Cont'd)

HOLE NO.	DATES	PERSONNEL	RATE	TOTAL
6	12/7-6/7	P. Neilans (G)	2 d x \$35/d	\$184.00
		R. Wittebolle (A)	2 d x \$21/d	
		D. Lindwall (C)	2 d x \$36/d	
7	14/7-17/7	P. Neilans (G)	4 d x \$35/d	368.00
		R. Wittebolle (A)	4 d x \$21/d	
		D. Lindwall (C)	4 d x \$36/d	
9	28/7-1/8	P. Neilans (G)	2.5 d x \$35/d	140.00
		R. Wittebolle (A)	2.5 d x \$21/d	

3. Group III.

HOLE NO.	DATES	PERSONNEL	RATE	TOTAL
Jeff B-1	18/7-22/7	P. Neilans (G)	2.5 d x \$35/d	140.00
		R. Wittebolle (A)	2.5 d x \$21/d	

THIS AGREEMENT DATED THIS 15 DAY OF April 1974

BETWEEN:

IMPERIAL OIL LIMITED:
1281 West Georgia Street
Vancouver 5, B.C.

herein called the Company
OF THE FIRST PART

AND:

ARCTIC DIAMOND DRILLING LTD.
184 Industrial Road
Whitehorse, Y.T.
Y1A 2V1

herein called the Contractor
OF THE SECOND PART

WHEREAS the Company is the owner of or is otherwise well entitled to enter upon and explore groups of mining claims in the Rainbow Lake area in the Province of British Columbia and herein called the Claims.

NOW THEREFORE IT IS WITNESSED:

1. The Contractor will diamond drill or cause to be diamond drilled not less than two thousand (2,000) feet upon the Claims at drill sites to be selected by the Company.

2. The Contractor will commence drilling on a date agreed upon by the Contractor and the Company.

3. The work under this agreement will be continued with reasonable diligence until completed.

4. All holes shall be drilled with a standard size drill producing AQ or BQ Wireline size core and equipped with a steel mast.

5. The dip of all holes shall be minus 45 degrees or steeper unless otherwise agreed by both parties.

6. No hole shall exceed a length of five hundred (500) feet unless otherwise agreed by both parties.

7. Measurements of all holes shall be made from the top of the casing.

8. Penetrating Overburden - The price per foot for drilling in overburden shall be \$7.90 AQ/\$8.40 BQ per foot from 0 to 50 feet in depth. If the cost to the contractor of penetrating overburden deeper than 50 feet is greater than \$7.90 AQ/\$8.40 BQ per foot, then the Company shall pay the Contractor at field cost for drilling in overburden below such depth.

9. The Company shall pay for all regular core drilling at the following rates:

Core Drilling

	<u>AQ</u>	<u>BQ</u>
Bedrock to 500 feet	\$7.90 per foot	\$8.40 per foot
500 feet to 1000 feet	\$8.65 per foot	\$9.15 per foot

10. Reaming Casing - The price per foot for reaming casing in bedrock shall be \$7.00 per foot (AQ or BQ) from bedrock to 50 feet in depth. If the cost to the Contractor of reaming casing deeper than 50 feet is greater than \$7.00 per foot, then the Company shall pay the Contractor at field cost for reaming casing below such depth.

11. The Company agrees to pay for the following operations on a field cost basis:

- (a) All cementing operations.
- (b) All wedging operations.
- (c) The Company agrees to pay for all casing left in holes at the Company's request.
- (d) All costs arising from a mud and/or calcium chloride circulation operation at the rate of two man hours and one machine hour for every two bags of mud used or part thereof, plus the cost of mud at \$8.00 per bag.
- (e) The removal of all inserted casing and associated material upon completion of drilling on said setup.

12. All field cost operations will be charged to the Company employing the following applications:

Labour	\$8.00 per man hour
Drill Rental	\$7.00 per machine hour
Material Consumed	Cost plus 10%

13. In the event that permafrost, cavities or loose and caving material is encountered of such a nature as to prevent the successful completion of any holes, the Contractor does not, under such conditions, guarantee to drill to a predetermined depth, and in the event that it becomes necessary to abandon the holes, the Company agrees to pay for such uncompleted holes, and the cost of all material unretracted from said holes, at the rates herein specified for all footage completed, and at eighty percent (80%) of the manufacturers cost of equipment and diamond set items unretracted.

14. The Contractor will mobilize and demobilize his men, drill and supplies to and from Dease Lake and will charge the Company \$1,900.00 for same. Should the Contractors men, drill and supplies on the Sumitomo Metal Mining Canada Ltd. contract become available by commencement date of this contract, the Company will pay the Contractor that portion as agreed upon by the two companies of the mobilization and demobilization charge to Sumitomo Metal Mining Canada Ltd.

15. Moving in from the mobilization and demobilization point to the Company's property and setting up on hole #1 and tearing down and moving out to the same point at the completion of the contract will be charged to the Company at \$8.00 per man hour. Machine rental will not be chargeable while moving in and setting up and tearing down and moving out.

16. When water supply exceeds 2,000 feet in length and/or 500 feet in elevation, the Company agrees to pay all pumping at field cost. Delays due to frozen water lines or lack of water will be chargeable at field cost.

17. Moving between drill holes will be charged to the Company at field cost.

18. Standby time caused by the Company will be chargeable at field cost. Standby time caused by machine breakdown or lack of drill supplies and equipment will be at the Contractor's expense.

19. The Contractor agrees to assist the Company in the angle acid testing of holes as may be required and designated by the Company and the charge for this shall be \$23.00 per test.

20. The Contractor shall pay all cost and expense in connection with transportation of crews, equipment and supplies between Whitehorse and Dease Lake airstrip. Once at that point, the Company will assume all cost and expense of transportation to and from the property. The Company will supply one weekly sergice trip between Watson Lake and the property at no cost to the Contractor.

21. The Company will supply cook, food and camp supplies for the Contractors men at no cost to the Contractor.

22. It is agreed that the foreman's daily report will be signed by the Company's engineer and the Contractor's foreman. It is further agreed that the cost items on the signed foreman's daily reports will be invoiced to and paid for by the Company.

23. The Contractor agrees, at its own expense, to comply with all requirements of the Workmen's Compensation Act, Unemployment Insurance Act, Hours of Work and Vacations with Pay Act, and generally all Federal and Provincial Acts and Regulations applicable to the Contractor's operations.

24. Fuel, gas, oil and propane for drills, pumps, heaters and camp will be supplied by the Company at no cost to the Contractor.

25. The Company will provide radio for communication from the property.

26. ~~When travelling between drill and camp sites exceeds thirty (30) minutes each way per day per man, the time will be chargeable to the Company at \$8.00 per hour.~~

27. Delays caused by lack of transportation or choppers will be chargeable to the Company at field cost.

28. At the completion of two thousand feet (2,000') or more of drilling, the Company may elect to demobilize the men only and leave the drill equipment on the property to continue the programme at a later date. The Contractor will not charge machine rental or standby in that case, but the Company will pay for any extra expense incurred by the Contractor such as travelling time and expenses of the drill crew. Should drilling not recommence by June 5th, 1975, the Company will pay the Contractor \$100.00 per day from June 10, 1975 until recommencement of drilling, or demobilization of equipment.

29. The Contractor will supply a core splitter for the Company's use if required at \$50.00 per month.

30. The Contractor will not give out any information regarding drill results or permit access to any drill core to any person other than the Company's accredited representative except upon specific permission of responsible officials of the Company.

31. The Contractor shall comply with all the laws, ordinances, rules, safety and other regulations bearing upon the conduct of the work and shall bear all costs arising from any violation thereof.

32. ~~The Contractor shall at all times keep all parts of the work area in a neat and orderly condition. The Contractor shall remove all rubbish as fast as it accumulates. Upon completion of the work, the Contractor shall remove all excess materials, equipment and rubbish from the camp and drill areas. The Contractor shall do everything necessary to leave the entire premises in clean, neat and presentable condition.~~

33. Both the Company and the Contractor reserve the right to terminate this contract for any reason and at the absolute discretion of either party by giving the other ten (10) days written notice of such termination. If the Company so terminates this contract, it shall pay to the Contractor all amounts owing to the Contractor hereunder in respect of the diamond drilling work performed up to the date of termination.

34. Damages and Liability:

(a) The Contractor shall continuously maintain adequate protection of all the work from damage and shall protect the Company's property from injury or loss arising in connection with this contract. The Contractor shall be responsible for any such damage, injury or loss to property, except such as may be directly caused by the agents or employees of the Company.

(b) The Contractor assumes all liability and indemnifies the Company against any liability for injuries or damages to the Contractor's employees or to any other person or persons, incident to or relating from the operations of the Contractor hereunder. The Contractor specifically represents that in performing its obligations under this contract, its status is that of an independent Contractor and that its employees and the employees of the sub-contractors are not the employees of the Company for any purpose whatsoever.

35. In complying with the obligations of the agreement, neither the Company nor the Contractor shall be held responsible for strikes, fire, war or any damage or delay due to causes beyond their control.

36. The Company will pay to the Contractor for all work contemplated by this agreement as the work progresses as follows: For all work done on and before the last day of each calendar month, not later than the 30th day of the calendar month next following; interest at 1% per month will be charged on overdue accounts.

37. The Contractor shall carry public liability and property damage insurance for an amount of not less than five hundred thousand dollars (\$500,000.00).

38. This agreement shall be binding upon and enure to the benefit of the parties hereto and their respective successors and assigns.

39. The commencement date of drilling shall be approximately June 15th, 1974, or as soon thereafter as weather conditions permit.

SIGNED BY:

IN THE PRESENCE OF:

IMPERIAL OIL LIMITED

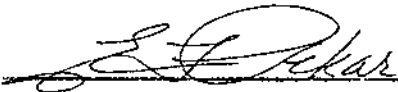



ARCTIC DIAMOND DRILLING LTD.

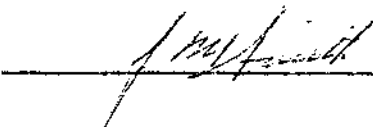





IMPERIAL OIL LIMITED

MAY 3 - REC'D

~~P~~
~~RWO~~

Minerals Section
E. L. Pekar
Chief Geologist, Western Canada

#314 - 1281 - W. Georgia Street
Vancouver 5, B. C.
Area Code 604 - 681-8231

MV-753

April 17, 1974

file in
Tennis Co.
with the
Drill contract
D

Mr. F.R. Doering
Arctic Diamond Drilling Ltd.
184 Industrial Road
Whitehorse, Yukon Territory
Y1A 2V1

Dear Sir:

Your drilling contract for the Rainbow Lake area is accepted on behalf of Imperial, subject to your agreement and acceptance of the following amendments:

Clause 26. - delete and replace with:

When travelling between drill and camp sites exceeds a total of one hour per day per man, the excess time will be charged to the Company at \$8.00 per man hour.

Clause 32. - delete and replace with:

The Contractor shall keep the work area and right of way in a neat and orderly condition and where possible remove all rubbish and waste as it accumulates. The Contractor agrees to comply with all the regulations provided by the surface owner and/or the Crown, including bucking, limbing, cutting and piling brush and logs, as may be specified. Upon completion of the work, the Contractor shall rake, fertilize and seed the disturbed portions of the work area and in general endeavour to leave the entire premises and associated rights of way as near to their original state as is reasonably possible, at field cost.

The Contractor and its employees agree to conduct their activities connected with the contract in a workman-like manner, with proper consideration and reasonable regard for the rights and privileges of third parties.

Handwritten initials

Clause 37. - add:

The Contractor, during the entire term of this agreement, will keep in full force and effect a policy of public liability and property damage insurance with respect to the work undertaken in this Agreement, in the amount of \$500,000 for any one accident.

The insurance shall be with an insurance company duly licensed to do business in the Province of British Columbia. Proof, in the form of a Certificate of Insurance, will be supplied by the Contractor prior to the commencement of the work. In addition, the Contractor agrees to supply details of the insurance policy to the Company upon request of the Company.

If the above meet with your approval, would you please signify your acceptance by signing this copy and returning it to this office.

Yours very truly

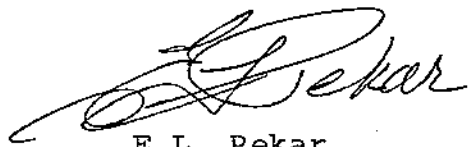
E.L. Pekar

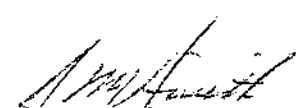
Accepted on behalf of
Arctic Diamond Drilling Ltd.

ELP/mj



INSURANCE
SINCE 1892

Telephone
667-2587

E.A. Whitehead Ltd.

3107 - 3rd Avenue at Main
Whitehorse, Yukon Territory

April 26, 1974

Insureds: Arctic Diamond Drilling Ltd.
Address: 184 Industrial Road, Whitehorse, Y.T.
Effective Date: Various - Please see below
Loss, in any
payable to: Insured or order
Insured With: Various Insurers - Please see below

COVERAGE

CERTIFICATE OF INSURANCE

1. Workmen's Compensation:

Policy: #W317225 through the Prudential Assurance Co. Ltd.
Effective Date: March 5, 1974 to January 1, 1975.
Limit of Liability: In accordance with the Workmen's Compensation ordinance of the Northwest Territory

2. Comprehensive General Liability - Including Products Liability and Non-Owned Automobile Liability Insurance:

PolicyA #104C837 through the Northern Assurance Company Limited
Effective date: February 28, 1974 for a term of one year
Limit of Liability: \$1,000,000 Inclusive any one Bodily Injury occurrence or Property Damage Accident and in aggregate where applicable.

3. Automobile Insurance:

Policy: A8 0918 43 through British America Assurance Company
Effective Date: February 26, 1974 for a term of one year
Limit of Liability: \$100,000 Inclusive any one Bodily Injury occurrence or Property Damage Accident and in aggregate where applicable.

E. A. WHITEHEAD LTD.

Per: *Alan Walker*

Montreal • Toronto • Calgary • Vancouver • Whitehorse

MAY 14 REC'D

RWO
Please check over

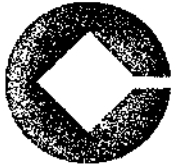

D. W. COATES
ENTERPRISES LTD.

diamond drilling contractors
1668 West 1st Avenue, Vancouver, B.C. V6J 1G1, 732-6721

May 3rd, 1974.

Imperial Oil Limited,
314 - 1281 West Georgia Street,
Vancouver 5, B.C.

Attention: Mr. E. L. Pekar,
Chief Geologist, Western Canada

Dear Mr. Pekar,

Re: Agreement between Imperial Oil Limited and
D. W. Coates Enterprises Ltd. on the Dease
Lake Area Project employing the Morex 350
Drill

1. Mobilization - Demobilization:

THAT the Company agrees that the movement of men, equipment and supplies from Vancouver to truck unload point and return from truck load point to Vancouver would be performed on an actual cost plus fifteen percent basis. Since the equipment is so light, a pick-up from Imperial and Coates could easily handle all the necessary equipment.

The Company would supply a helicopter at no cost to the Contractor for the mobbing, demobbing and for continuing supplies as the job progresses.

2. Labour:

THAT the Company agrees that labour would be supplied at the diamond drill labour rate prevailing at that time, plus benefits at 15%, plus eighteen percent for overhead and profit. A bonus agreeable to both parties would be instituted.

3. Drill:

THAT the Contractor agrees to rent the Morex 350 drill complete with the necessary drill equipment on the following basis:

- (a) Morex 350 Drill - complete with skids, tower, drill shack, small tools and plastic hose line:

\$575.00 / month

Imperial Oil Limited.

May 3rd, 1974.

- (b) Hypro Pump - 350 - 10 \$65.00 / month
- (c) Down the Hole Equipment (250') \$55.00 / month
plus 27¢ per foot drilled
- (d) Operating Charges - An hourly charge of \$1.70 per operating hour to cover running repairs.
- (e) Consumed materials - i.e. Casing, diamond bits, shells, casing shoes, cement if ever required, lost rods or core barrels, would be charged at cost on job site plus fifteen percent.

4. Security:

THAT the Contractor will not give out any information regarding the drill results or access to core to any person other than to the Company's representative.

5. Board and Lodging:

THAT the Company would supply free board and lodging to the Contractor's crew.

6. Fuel Oil and Gasoline:

THAT the Company would supply fuel for the pumps, drill and heating at no cost to the Contractor.

7. Indemnity:

Notwithstanding anything to the contrary herein expressly contained or implied, the Contractor will indemnify and save harmless the Company from and against all losses, costs, damages or demands of any nature whatsoever, which may be suffered or brought against the Company arising out of, and attributable in any manner to any or all operations conducted by the Contractor pursuant to this Agreement.

It is further agreed and understood that the Contractor is, while acting under this agreement, an Independent Contractor and not acting as an agent or servant of the Company and any person employed by the Contractor to conduct operations pursuant to this Agreement shall be the employees of the Contractor and not of the Company.

8. Environment and Public Relations:

The Contractor shall keep the work area and right of way

Imperial Oil Limited.

May 3rd, 1974.

in a neat and orderly condition and where possible remove all rubbish and waste as it accumulates. The Contractor agrees to comply with all the regulations provided by the surface owner and/or the Crown, including bucking, limbing, cutting and piling brush and logs, as may be specified. Upon completion of the work, the Contractor shall rake, fertilize and seed the disturbed portions of the work area and in general endeavour to leave the entire premises and associated rights of way as near to their original state as is reasonably possible.

The Contractor and its employees agree to conduct their activities connected with the contract in a workmanlike manner, with proper consideration and reasonable regard for the rights and privileges of third parties.

9. Compensation:

THAT the Contractor agrees at its own expense to comply with all requirements of the Workmen's Compensation Act, unemployment Insurance Act, Hours of Work and Vacations with Pay Act and, generally, all Federal and Provincial Acts and Regulations applicable to the Contractor's operations.

10. Insurance:

THAT the Contractor, during the entire term of this agreement, will keep in full force and effect a policy of public liability and property damage insurance with respect to the work undertaken in this Agreement, in the amount of \$500,000 for any one accident.

Should the above meet with your approval, would you kindly so signify by signing and forwarding the enclosed copy of this letter to the above address.

Yours very truly,

D. W. COATES ENTERPRISES LTD.

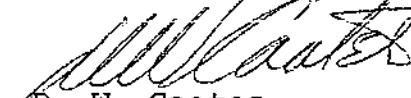
D. W. Coates,
President.

DWC:jlc

Accepted on Behalf of
IMPERIAL OIL LIMITED:



Accepted on Behalf of
D. W. COATES ENTERPRISES LTD.:



Aug 14 1974

INVOICE

Commercial Oil Limited,
1281 West Georgia Street,
Vancouver 5, B.C.

D.W. COATES ENTERPRISES LTD.

1668 - 1st AVENUE WEST
VANCOUVER 9, B.C.

INVOICE NO.: 761
JOB NO.: 211-8

Date: August 12, 1974.

Dease Lake Area Drilling.

PERIOD: July 10 - 31, 1974.

Labour	\$ 4,222.75
Mobilization	504.65
Drill Rental	383.33
Pump Rental	86.67
Down-the-Hole Equipment	212.71
Operating Charge	154.70
Materials Consumed	1,586.77
Diamond Cutout	(1,281.77)
	<u>\$ 5,869.81</u>

APPROVED
J. Mansel
 6053
 6055
 Service Diamond Drilling

E. & O. E.

Labour:

C. Bouvier:	✓ 120 hrs. @ \$5.91/hr.	\$ 709.20	
	✓ 56 hrs. @ 8.87/hr.	496.72	
W. Coates :	✓ 104 hrs. @ \$4.51/hr.	469.04	
	✓ 56 hrs. @ 6.77/hr.	379.12	
Bonus:	✓ July 16 - 31, 1974:	<u>1,057.75</u>	
		\$3,111.83	
	✓ Employee Benefits @ 15%:	<u>466.77</u>	
		3,578.60	
	✓ Overhead & Profit @ 18%:	<u>644.15</u>	\$ 4,222.75

Mobilization

✓ 2 Air fares Vancouver to Watson Lake @ \$90.00	\$180.00	
✓ Canadian Freightways Inv. #483811	<u>258.83</u>	
	438.83	
✓ Plus 15%:	<u>65.82</u>	\$ 504.65

Drill Rental

Morex 350 Drill :	✓ 2/3 mo. @ \$575.00/month	\$ 383.33
-------------------	----------------------------	-----------

Pump Rental

2 Hypro Pumps :	✓ 2/3 mo. @ \$65.00/month/pump	\$ 86.67
-----------------	--------------------------------	----------

Down-the-Hole Equipment

✓ 2/3 month @ \$55.00/month	✓	\$ 36.67	
✓ 652 feet @ .27/foot		<u>176.04</u>	\$ 212.71

Operating Charges:

<u>Date</u>	<u>Hours</u>		
Aug. 1	2		
" 2	3½		
" 3	9		
" 4	8½		
" 5	4½		
" 6	9½		
" 7	9		
" 8	<u>7½</u>		
	53½ hours @ \$1.70/hr.	\$	90.95

Materials Consumed (Returned)

3 IEX Fine Stone Morisette Core Bits @ \$117.30	\$ 351.90	
1 IEX 100's AA Core Bits	82.65	
2 IEX 200's AA " " @ \$83.40	166.80	
2 IEX Morisette Reaming Shells @ \$122.00	244.00	
1 IEX Reaming Shell @ \$110.25	110.25	
2 EW Casing Shoes @ \$53.85	<u>107.70</u>	
	\$ 1,063.30	
Plus 15%	<u>159.50</u>	
	\$(1,222.80)	\$(1,222.80)

Operating Charge

<u>Date</u>	<u>Hours</u>		
July 20	9 ✓		
" 21	8½ ✓		
" 22	9 ✓		
" 23	2½ ✓		
" 24	7½ ✓		
" 25	9 ✓		
" 26	9 ✓		
" 27	9 ✓		
" 28	1½ ✓		
" 29	7½ ✓		
" 30	9 ✓		
" 31	9½ ✓		
	<u>91</u>	hours @ \$1.70/hr.	\$ 154.70

Consumed Materials

5	IEX	Fine Stone Morisette Core Bits @ \$117.30	\$ 586.50	
4	IEX	200's AA Core Bits @ \$83.40	333.60	
2	IEX	100's AA " " @ 82.65	165.30	
2	IEX	Morisette Reaming Shells @ \$122.00	244.00	
12	IEX	Core Springs @ \$4.20	50.40	
			<u>\$1,379.80</u>	
		Plus 15%:	206.97	\$ 1,586.77

Diamond Cutout

6	IEX	200's Bits (J.K.Smit)	141'	\$ 216.30	
6	IEX	100's " (" ")	151'	233.30	
12	IEX	100's " (" ")	254'	466.87	
5	IEX	100's " (Wesdrill)	97'	198.11	
				<u>\$1,114.58</u>	
		Plus 15%:	167.19		\$ (1,281.77)

1120 10 1100

Imperial Oil Ltd.,
314 - 1281 West Georgia St.,
Vancouver 5, B.C.

INVOICE

D.W. COATES ENTERPRISES LTD.

1668 - 1st AVENUE WEST
VANCOUVER 9, B.C.

INVOICE NO.: 774

JOB NO.: 211-8

Date: August 26, 1974.

RE: Morex Drilling - Dease Lake Area.

PERIOD: August 1 - 11, 1974.

Labour	\$ 2,883.02
Demobilization	293.83
Drill Rental	287.50
Pump Rental	65.00
Down-the-Hole Equipment	129.02
Operating Charge	90.95
Materials Consumed	(1,222.80)
	<u>\$ 2,526.52</u>

E. & O.E.

Labour

C. Bouvier:	56	hours	@	\$ 5.91/hr.	\$ 330.96	
	10	"	@	11.82/hr.	118.20	
	46	"	@	8.87/hr.	408.02	
W. Coates :	56	hours	@	\$ 4.51/hr.	252.56	
	10	"	@	9.02/hr.	90.20	
	46	"	@	6.77/hr.	311.42	
Bonus :					<u>613.20</u>	
					2,124.56	
Employee Benefits @ 15%					<u>318.68</u>	
					2,443.24	
Overhead & Profit @ 18%					<u>439.78</u>	\$ 2,883.02

Demobilization:

2 Air Fares Watson Lake to Vancouver @ \$90.00	\$ 180.00	
C P Air Inv. #18-17770546	<u>75.50</u>	
	255.50	
Plus 15%	<u>38.33</u>	\$ 293.83

Drill Rental:

Morex 350 Drill: ½ month @ \$575.00/mo.		\$ 287.50
---	--	-----------

Pump Rental:

2 Hypro Pumps: ½ month @ \$65.00/mo.		\$ 65.00
--------------------------------------	--	----------

Down-the-Hole Equipment:

½ month @ \$55.00/mo.	\$ 27.50	
376 feet @ .27/foot	<u>101.52</u>	\$ 129.02

ARCTIC DIAMOND DRILLING LTD.

Page 2

Invoice #1610 - Imperial Oil Limited - Cont'd

<u>Overburden</u>			
0 - 9 = 9 feet @ \$8.40 per foot =	\$ 75.60	\$	75.60
<u>Coring</u>			
9 - 307 = 298 feet @ \$8.40 per foot =			\$2,503.20
<u>Reaming Casing</u>			
9 - 11 = 2 feet @ \$7.00 per foot =		\$	<u>14.00</u>
			\$3,189.80

Hole: Jenn-1 x 50° x BQ

<u>Moving</u>			
56 man hours @ \$8.00 per hour =	\$448.00		
16 machine hours @ \$7.00 per hour =	<u>112.00</u>	\$	560.00
<u>Testing</u>			
2 tests @ \$23.00 per test =		\$	46.00
<u>Overburden</u>			
0 - 20 = 20 feet @ \$8.40 per foot =		\$	168.00
<u>Coring</u>			
20 - 357 = 337 feet @ \$8.40 per foot =			\$2,830.80
<u>Reaming Casing</u>			
20 - 21 = 1 foot @ \$7.00 per foot =		\$	<u>7.00</u>
			\$3,611.80

Hole:-----

<u>Moving</u>			
100 man hours @ \$8.00 per hour =	\$800.00		
22 machine hours @ \$7.00 per hour =	<u>154.00</u>		
		\$	<u>954.00</u>

TOTAL INVOICE \$18,177.45

Deduct 384.00
 Pay Bal. 17,793.45

APPROVED

W. Hamon

6053 = 17,793.45

Services -
 Diamond Drilling

NB Item deducted
 Frontier Helicopters Ltd
 Invoice dated Aug 2/74
 Paid by Imperial Oil Ltd
 for Arctic D.D. account
 See attached copies
J.S.

AUG 19 REC'D

ARCTIC DIAMOND DRILLING LTD.

P.O. Box 3204, 10th Industrial Road
Whitehorse, Yukon Territory Y1A 2V1

730 - 510 W. Hastings Street.
Vancouver, B.C.

Marwell Area - Phone 668-2440 667-0454

Phone 688-3328

August 8, 1974

INVOICE #1621

IN ACCOUNT WITH:

Imperial Oil Limited,
1201 West Georgia Street,
Vancouver 5, B.C.

APPROVED

[Signature]
6053

Drilling charges August 1 - 8, 1974 (Rainbow Lake Project)

Service - Diamond Drilling

Hole: Yrin-0-1 x 50° x BQ

Moving

6 man hours @ \$8.00 per hour = \$ 48.00

3 machine hours @ \$7.00 per hour = 21.00

\$ 69.00

Testing

2 test @ \$23.00 per test =

\$ 46.00

Overburden

0 - 6 = 6 feet @ \$8.40 per foot =

\$ 50.40

Coring

6 - 307 = 301 feet @ \$8.40 per foot =

\$2,528.40

Reaming (Casing)

6 - 7 = 1 foot @ \$7.00 per foot =

\$ 7.00 \$2,700.80

Hole: Lin-1 x 50° x BQ

Moving

45 man hours @ \$8.00 per hour = \$360.00

10.5 machine hours @ \$7.00 per hour = 73.50

\$ 433.50

Testing

2 tests @ \$23.00 per test =

\$ 46.00

Overburden

0 - 15 = 15 feet @ \$8.40 per foot =

\$ 126.00

Coring

15 - 207 = 192 feet @ \$8.40 per foot =

\$1,612.80 \$2,218.30

Moving Out (to Dease Lake)

180 man hours @ \$8.00 per hour =

\$1,440.00

Demobilization Charge

(Re: article 14 of Contract) 1/2 x 1900.00 =

\$ 950.00

TOTAL INVOICE

\$7,309.10

(Total Contract - 4,891 feet)

Mailed to Calgary Aug 19

AUG 12 REC'D

ARCTIC DIAMOND DRILLING LTD.

184 Industrial Road
 P.O. Box 3204
 Whitehorse, Yukon Territory Y1A 2V1

Marwell Area - Phone 668-2440 667-6434

730 - 510 W. Hastings Street,
 Vancouver, B.C.

Phone 688-3328

July 31, 1974

INVOICE #1610

IN ACCOUNT WITH:

Imperial Oil Limited,
 1281 West Georgia Street,
 Vancouver 5, B.C.

Drilling charges July 16 - 31, 1974 (Rainbow Lake Project)

Hole: 8 x 50° x BQ

Moving

109 man hours @ \$8.00 per hour = \$872.00
 28 machine hours @ \$7.00 per hour = 196.00 \$1,068.00

Testing

4 tests @ \$23.00 per test = \$ 92.00

Overburden

0 - 19 = 19 feet @ \$8.40 per foot = 159.60

Coring

19 - 500 = 481 feet @ \$8.40 per foot = \$4,040.40
 500 - 607 = 107 feet @ \$9.15 per foot = 979.05 \$5,019.45 \$6,339.05

Hole: B-1 x 50° x BQ

Moving

56 man hours @ \$8.00 per hour = \$448.00
 18 machine hours @ \$7.00 per hour = 126.00 \$ 574.00

Testing

3 tests @ \$23.00 per test = \$ 69.00

Overburden

0 - 6 = 6 feet @ \$8.40 per foot = \$ 50.40

Coring

6 - 407 = 401 feet @ \$8.40 per foot = \$3,368.40

Reaming Casing

6 - 9 = 3 feet @ \$7.00 per foot = \$ 21.00 \$4,082.80

Hole: A-1 x 50° x BQ

Moving

54 man hours @ \$8.00 per hour = \$432.00
 17 machine hours @ \$7.00 per hour = 119.00 \$ 551.00

Testing

2 tests @ \$23.00 per test = \$ 46.00

Invoice #1601 - Imperial Oil Limited - Cont'd

Hole: 4 x 50° x BQ

<u>Moving</u>		
40 man hours @ \$8.00 per hour =	\$ 320.00	
9 machine hours @ \$7.00 per hour =	<u>63.00</u>	\$ 383.00
<u>Testing</u>		
2 tests @ \$23.00 per test =		\$ 46.00
<u>Overburden</u>		
0 - 10 = 10 feet @ \$8.40 per foot =		\$ 84.00
<u>Coring</u>		
10 - 357 = 347 feet @ \$8.40 per foot =		\$2,914.80
<u>Reaming Casing</u>		
10 - 13 = 3 feet @ \$7.00 per foot =		\$ 21.00
		<u>\$3,448.80</u>

Hole: 5 x 50° x BQ

<u>Moving</u>		
40 man hours @ \$8.00 per hour =	\$ 320.00	
8 machine hours @ \$7.00 per hour =	<u>56.00</u>	\$ 376.00
<u>Testing</u>		
2 tests @ \$23.00 per test =		\$ 46.00
<u>Overburden</u>		
0 - 9 = 9 feet @ \$8.40 per foot =		\$ 75.60
<u>Coring</u>		
9 - 277 = 268 feet @ \$8.40 per foot =		\$2,251.20
<u>Reaming Casing</u>		
9 - 13 = 4 feet @ \$7.00 per foot =		\$ 28.00
		<u>\$2,776.80</u>

Hole: 6 x 50° x BQ

<u>Moving</u>		
44 man hours @ \$8.00 per hour =	\$ 352.00	
10 machine hours @ \$7.00 per hour =	<u>70.00</u>	\$ 422.00
<u>Testing</u>		
2 tests @ \$23.00 per test =		\$ 46.00
<u>Overburden</u>		
0 - 2 = 2 feet @ \$8.40 per foot =		\$ 16.80
<u>Coring</u>		
2 - 317 = 315 feet @ \$8.40 per foot =		\$2,646.00
<u>Reaming Casing</u>		
2 - 5 = 3 feet @ \$7.00 per foot =		\$ 21.00
		<u>\$3,151.80</u>

Hole: 7 x 50° x BQ

<u>Moving</u>		
50 man hours @ \$8.00 per hour =	\$ 400.00	
9 machine hours @ \$7.00 per hour =	<u>63.00</u>	\$ 463.00
<u>Testing</u>		
2 tests @ \$23.00 per test =		\$ 46.00
<u>Overburden</u>		
0 - 9 = 9 feet @ \$8.40 per foot =		\$ 75.60
<u>Coring</u>		
9 - 287 = 278 feet @ \$8.40 per foot =		\$2,359.20
<u>Reaming Casing</u>		
9 - 13 = 4 feet @ \$7.00 per foot =		\$ 28.00
		<u>\$2,947.80</u>

APPROVED
<i>Il Samail</i>
6053
<i>Services - Diamond & Suez</i>

TOTAL INVOICE

\$24,264.30

Mailed to Calgary

JUL 22 REC'D

ARCTIC DIAMOND DRILLING LTD.

P.O. Box 3204, 184 Industrial Road
Whitehorse, Yukon Territory Y1A 2V1

730 - 510 W. Hastings Street,
Vancouver, B.C.

Marwell Area - Phone ~~668-2440~~ x 667-6434

Phone 688-3328

June 30, 1974

INVOICE #1593

IN ACCOUNT WITH:

Imperial Oil Limited,
1281 West Georgia Street,
Vancouver 5, B.C.

Drilling charges June 23 - 30, 1974 (Rainbow Lake Project)

Mobilization Charge (@ cost)

<u>Travelling Time</u>		
16 man hours @ \$8.00 per hour =	\$128.00	
<u>Third Party Air Charter</u>		
June 23/74 C.P. Air #018-7400021400		
4 men & gear =	<u>\$100.00</u>	\$ 228.00

<u>Moving In - From Watson Lake</u>		
130 man hours @ \$8.00 per hour =		\$1,040.00

<u>Hole: 1 x 50" x BQ</u>		
<u>Overburden</u>		
0 - 21 = 21 feet @ \$8.40 per foot =	\$176.40	
<u>Coring</u>		
21 - 197 = 176 feet @ \$8.40 per foot =	<u>\$1,478.40</u>	<u>\$1,654.80</u>

TOTAL INVOICE

\$2,922.80

APPROVED
[Signature]
 6053
 Services - Arctic Drilling

Mailed to Calgary
July 26/74

MAR 28 RECEIVED

ARCTIC DIAMOND DRILLING LTD.

~~PO BOX 3204~~ 184 Industrial Road
Whitehorse, Yukon Territory Y1A 2V1

730 - 510 W. Hastings Street.
Vancouver, B.C.

Marwell Area - Phone 668-2440 667-6434

Phone 688-3328

March 15, 1974

INVOICE #1533

IN ACCOUNT WITH:

Imperial Oil Limited,
314 - 1281 West Georgia Street,
Vancouver 5, B.C.

Trucking Charge

March 1/74 Truckways Transport - 1/2 x \$732.50 = \$366.25
(Hauling fuel from Whitehorse to Dease Lake)

TOTAL INVOICE

\$366.25

APPROVED
<i>Samuel</i>
Services - Freight Charges
6053

Mailed to Calgary April 2

ARCTIC DIAMOND DRILLING LTD.

~~PO BOX 3204~~ 18 1/2 Industrial Road
Whitehorse, Yukon Territory Y1A 2V1

730 - 510 W. Hastings Street,
Vancouver, B.C.

Marwell Area - Phone ~~688-2440~~ 667-6434

Phone 688-3328

July 15, 1974

INVOICE #1601

IN ACCOUNT WITH:

Imperial Oil Limited,
1281 West Georgia Street,
Vancouver 5, B.C.

Drilling charges July 1 - 15, 1974		(Rainbow Lake Project)	
<u>Hole: 1 x 50° x BQ</u>			
<u>Testing</u>			
2 tests @ \$23.00 per test =		\$ 46.00	
<u>Coring</u>			
197 - 500 = 303 feet @ \$8.40 per foot =	\$2,545.20		
500 - 537 = 37 feet @ \$9.15 per foot =	<u>338.55</u>	<u>\$2,883.75</u>	\$2,929.75
<u>Hole: 2 x 50° x Bq</u>			
<u>Moving</u>			
50 men hours @ \$8.00 per hour =	\$ 400.00		
13 machine hours @ \$7.00 per hour =	<u>91.00</u>	\$ 491.00	
<u>Testing</u>			
2 tests @ \$23.00 per test =		\$ 46.00	
<u>Overburden</u>			
0 - 9 = 9 feet @ \$8.40 per foot =		\$ 75.60	
<u>Coring</u>			
9 - 377 = 368 feet @ \$8.40 per foot =		\$3,091.20	
<u>Reaming Casing</u>			
9 - 13 = 4 feet @ \$7.00 per foot =		<u>\$ 28.00</u>	<u>\$3,731.80</u>
<u>Hole: 3 x 50° x BQ</u>			
<u>Moving</u>			
59 men hours @ \$8.00 per hour =	\$ 472.00		
15.5 machine hours @ \$7.00 per hour =	<u>108.50</u>	\$ 580.50	
<u>Testing</u>			
2 tests @ \$23.00 per test =		\$ 46.00	
<u>Overburden</u>			
0 - 16 = 16 feet @ \$8.40 per foot =		\$ 134.40	
<u>Coring</u>			
16 - 500 = 484 feet @ \$8.40 per foot =	\$4,065.60		
500 - 547 = 47 feet @ \$9.15 per foot =	<u>430.05</u>	<u>\$4,495.65</u>	
<u>Reaming Casing</u>			
16 - 19 = 3 feet @ \$7.00 per foot =		<u>\$ 21.00</u>	<u>\$5,277.55</u>

LOCATION MAP

JEFF cls.

GROUP III

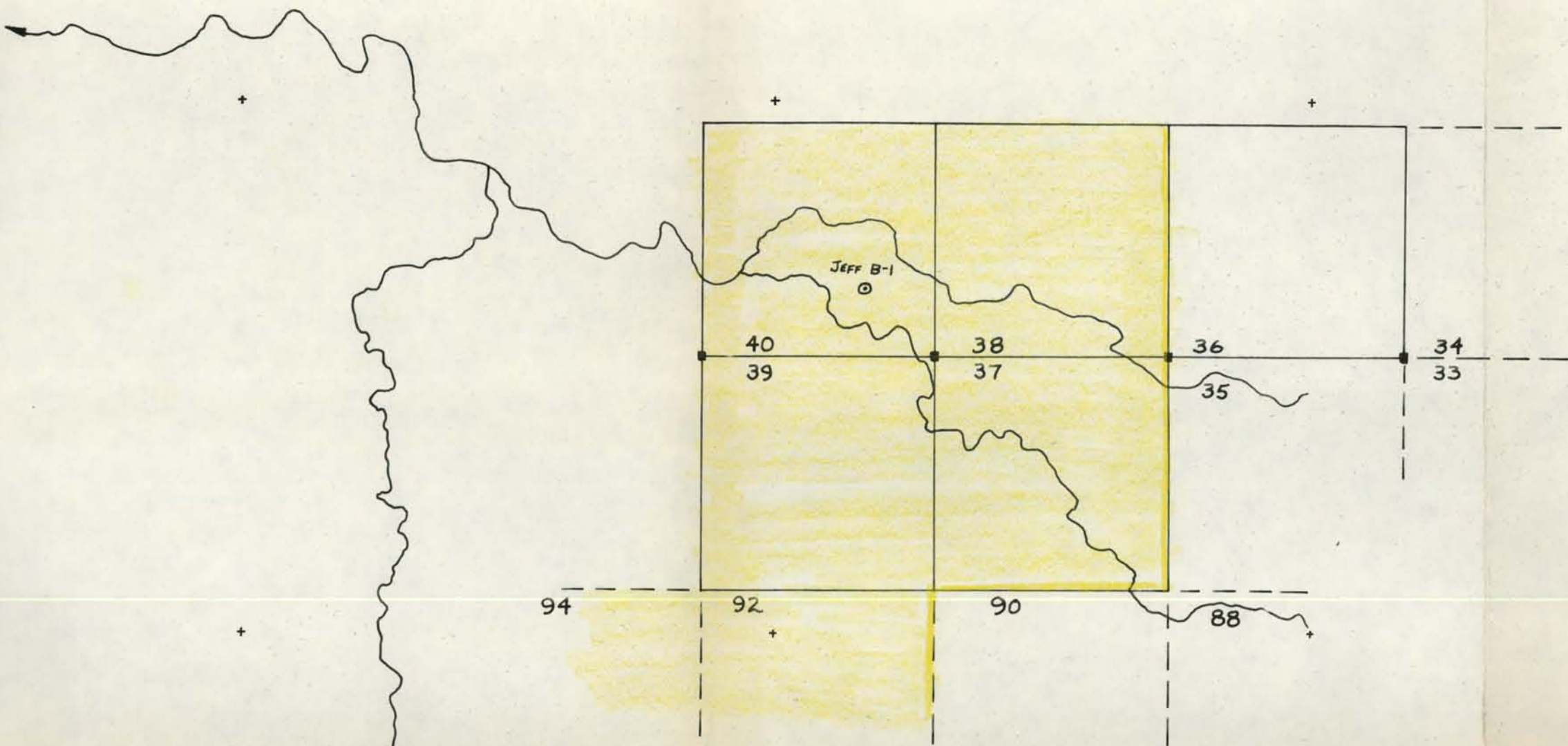
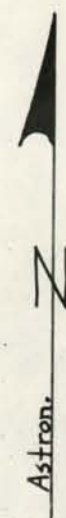

Department of
Mines and Petroleum Resources
ASSESSMENT REPORT
NO. ~~5293~~ #5
5294

- Contours ~ 2500 ~
- Stream or creek (Perennial, intermittent)
- Marsh
- Lake
- Road
- Jeep Road
- Trail
- Trees

1 in. = 800 ft.

IMPERIAL OIL LIMITED - MINERALS

J. Peter Neilans

Project No. _____
Mining Division LIARD
Latitude 58° 12' N
Longitude 128° 24' W
NTS 104 I/1W
To Accompany a Report By: RWB + JPN
Dated Aug 27/74
Map No. 3

5294
MAP 5

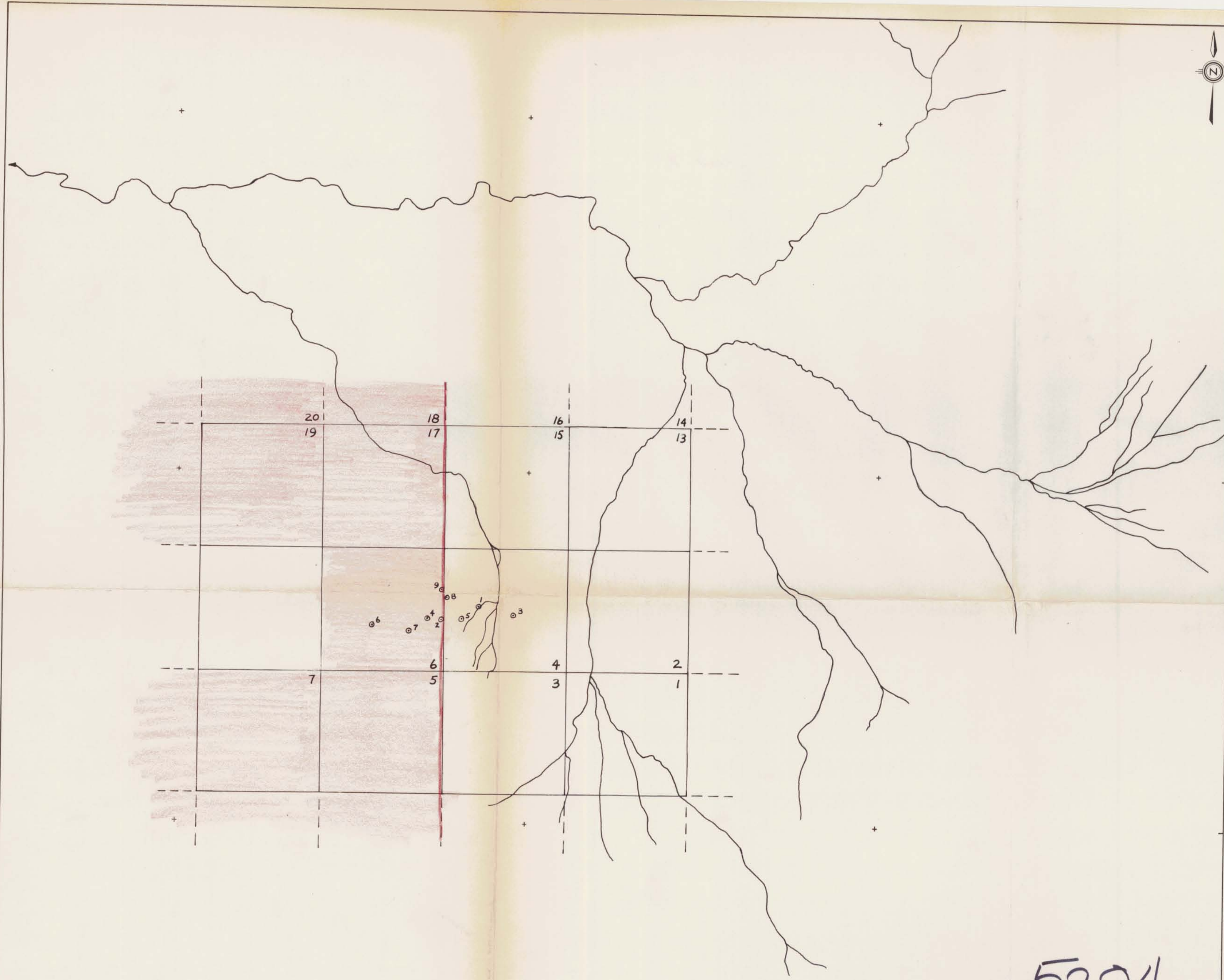

LOCATION MAP
JEFF CLS.
GROUP II.

Department of
Mines and Petroleum Resources
ASSESSMENT REPORT
NO. ~~5235~~ 5294 MAP #4

SYMBOLS

- Drift-covered area
- Rock outcrop, area of outcrop, float
- Geological boundary (defined, approximate interpreted)
- Bedding, tops known (horizontal, inclined, vertical, overturned, dip unknown)
- Bedding, tops unknown (inclined, vertical, dip unknown)
- Schistosity, gneissosity, cleavage, foliation (horizontal inclined, vertical, dip unknown)
- Lineation, axes of minor folds (horizontal, inclined, vertical)
- Drag-fold (arrow indicates plunge)
- Fault (defined, approximate, interpreted)
- Fault (inclined, vertical)
- Fault (solid circle indicated downthrow side, arrows indicate relative movement)
- Thrust fault (approximate, interpreted)
- Shearing and dip
- Joint (horizontal, inclined, vertical, dip unknown)
- Syncline (defined, approximate)
- Anticline (defined, approximate)
- Anticline and syncline (overturned)
- Intensity (weak, moderate, strong)

- Trench
- Adit or tunnel
- Rock dump or tailings
- Quarry or mine
- Shaft, raise, winze
- Diamond-drill hole

- Contours 2500 C.I.
- Stream or creek (Perennial, intermittent)
- Marsh
- Lake
- Road
- Jeep Road
- Trail
- Trees

1 in. = 800 ft.

IMPERIAL OIL LIMITED - MINERALS

A. Peter Neilans

Project No. _____ Mining Division LIARD
Latitude 58°12'N Longitude 128°22'W
NTS 104-I-1W

To Accompany A Report By: RWO 3 JAN
Dated: Aug 27/74
Map No. 2

5294
MAP 4



LOCATION MAP
JEFF CLS.
GROUP I

Department of
Mines and Petroleum Resources
ASSESSMENT REPORT
NO. ~~5294~~ MAP #3
5294

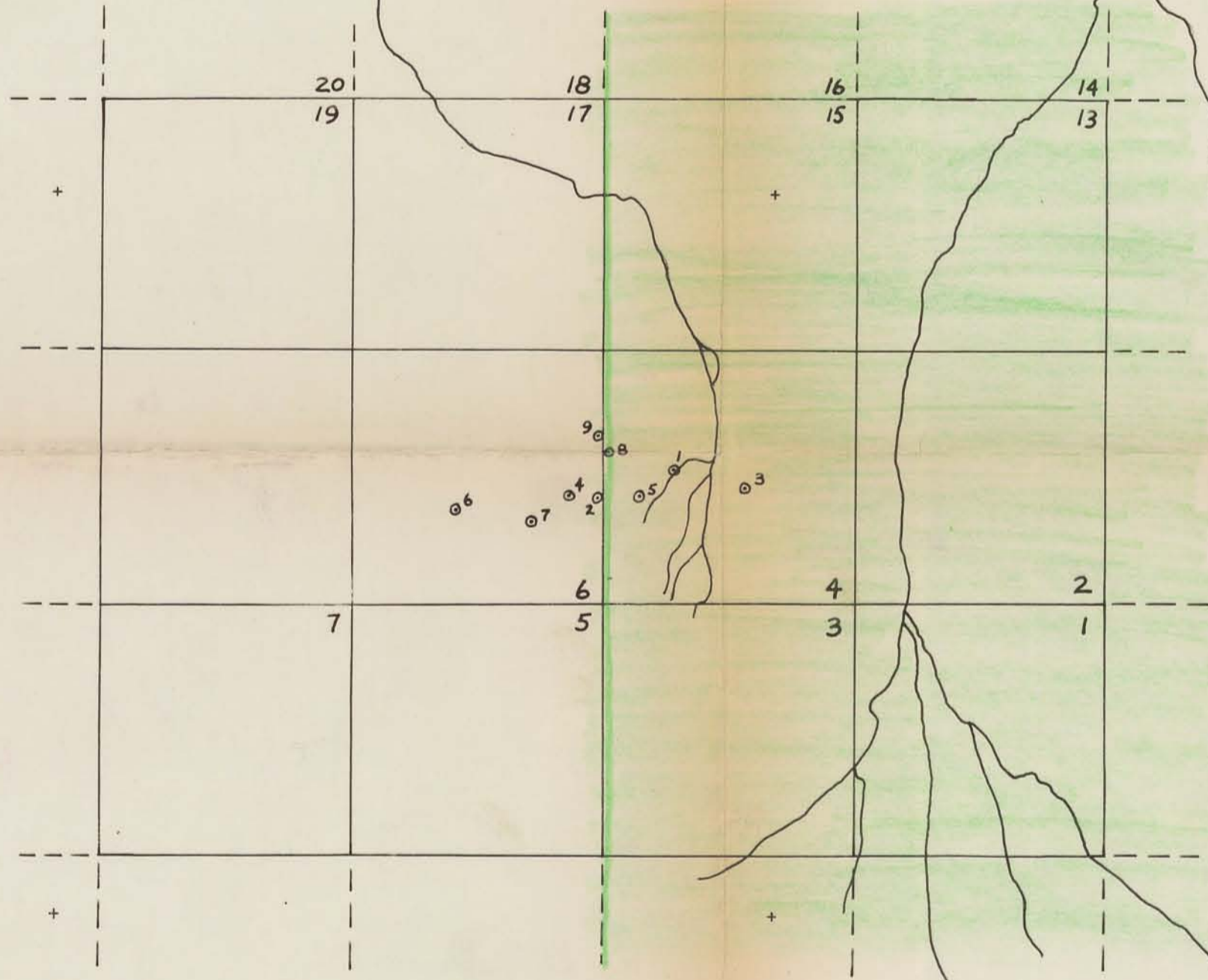

SYMBOLS

- Drift-covered area
- Rock outcrop, area of outcrop, float X (XXX) X
- Geological boundary (defined, approximate interpreted)
- Bedding, tops known (horizontal, inclined, vertical, overturned, dip unknown)
- Bedding, tops unknown (inclined, vertical, dip unknown)
- Schistosity, gneissosity, cleavage, foliation (horizontal inclined, vertical, dip unknown)
- Lineation, axes of minor folds (horizontal, inclined, vertical)
- Drag-fold (arrow indicates plunge)
- Fault (defined, approximate, interpreted)
- Fault (inclined, vertical)
- Fault (solid circle indicated downthrow side, arrows indicate relative movement)
- Thrust fault (approximate, interpreted)
- Shearing and dip
- Joint (horizontal, inclined, vertical, dip unknown)
- Syncline (defined, approximate)
- Anticline (defined, approximate)
- Anticline and syncline (overturned)
- Intensity (weak, moderate, strong)
- Trench
- Adit or tunnel
- Rock dump or tailings
- Quarry or mine
- Shaft, raise, winze
- Diamond-drill hole
- Contours 2500 C.I.
- Stream or creek (Perennial, intermittent)
- Marsh
- Lake
- Road
- Jeep Road
- Trail
- Trees

1 in. = 800 ft.

IMPERIAL OIL LIMITED - MINERALS

J. Peter Pfeilans

Project No. _____ Mining Division **LIARD**
 Latitude **58°12'N** Longitude **128°20'W**
 NTS **104-I-1W**
 To Accompany A Report By: **RWO & JPN**
 Dated: **Aug 27/74** Map No. **1**

5294
MAP 3