

Statement of Qualifications

I, E.S. Holt, of North Vancouver, British Columbia, do hereby certify:

1. That I am a geologist residing at 4091 St. Albans Avenue, North Vancouver, B.C.
2. That I graduated in geology from the University of Minnesota in 1969 and have practiced my profession for 15 years.
3. That I am a Professional Engineer registered in the Province of British Columbia.

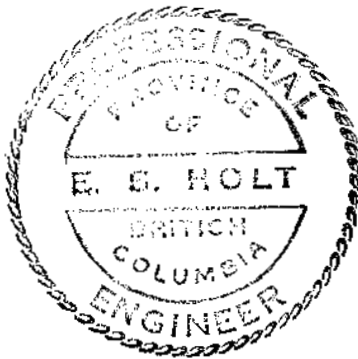

  
\_\_\_\_\_  
E.S. Holt

ESH:dc

Statement of Qualifications

I, J.B. Richards, of 5501 MacKenzie Street, Vancouver, B.C. state that:

1. I am a graduate of The University of British Columbia with the B.A.Sc. degree in Geological Engineering.
2. I am a registered Professional Engineer in the Province of British Columbia.
3. I have practiced my profession for more than four years.

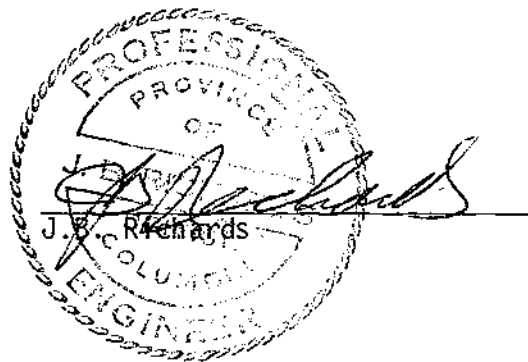

JBR:dc

Split core specimens and crusher rejects are stored on the property.

DEC - 9 1974

## INVOICE

S. S. Mining, Inc.,  
908 - 1111 West Hastings St.,  
Vancouver, B.C.

## D.W. COATES ENTERPRISES LTD.

1668 - 1st AVENUE WEST  
VANCOUVER 9, B.C.

INVOICE NO.: 831

JOB NO.: 245

Date: December 4, 1974.

RE: Houston Area Drilling.

PERIOD: November 16 - 30, 1974.

Drilling Detail

Transportation

Moving, Setting Up &amp; Tearing Down

Water Supply

Drilling with Mud

Camp Costs

ORIGINAL			
Coding		\$	¢
621		21,601.18	
609		517.50	
Invoice Total			
Adds and Extensions	Goods Received	Prices	App'd for Payment

\$ 18,629.71 ✓

1,366.70 ✓

968.20 ✓

552.85

83.72

517.50 ✓

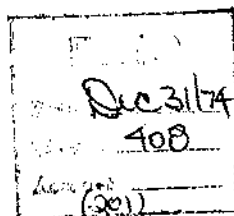
\$ 22,118.68\$ 18,076.99 Claimed

E. &amp; O. E.

Drilling Detail

Hole #	Size	From	To	Footage	Rate/Foot	Amount
168	NQ	0	22	22	\$9.50	\$ 209.00
"	"	22	398	376	9.07	3,410.32
169	NQ	0	20	20	9.50	190.00
"	"	20	195	175	9.07	1,587.25
170	NQ	0	11	11	9.50	104.50
"	"	11	408	397	9.07	3,600.79
171	NQ	0	24	24	9.50	228.00
"	"	24	292	268	9.07	2,430.76
172	NQ	0	24	24	9.50	228.00
"	"	24	204	180	9.07	1,632.60
173	NQ	0	16	16	9.50	152.00
"	"	16	151	135	9.07	1,224.45
174	NQ	0	25	25	9.50	237.50
"	"	25	27	2	10.25	20.50
"	"	27	338	311	9.07	2,820.77
116	NQ	157	218	61	9.07	553.27
				2047'		<del>\$ 18,629.71</del>
						<u>\$ 18,076.44</u>

Transportation

(a) Lump Sum:

Demobilization: 50% x \$1,340.00 \$ 670.00

(b) Labour & Equipment:

Date	Memo	Man Hours	Tractor	Truck 4 x 4	
Nov. 28 D	Teardown & start move to road	28	10	6	
" 29 D	Finish move to road	24	4	5	
		52	14	11	
	Labour : 52 hours @ \$9.60/hr.				\$ 499.20
	Tractor: 14 " @ 9.00/hr.				126.00
	Truck : 11 " @ 6.50/hr.				<u>71.50</u>
					\$ 696.70
Total Transportation:					<u>\$ 1,366.70</u>

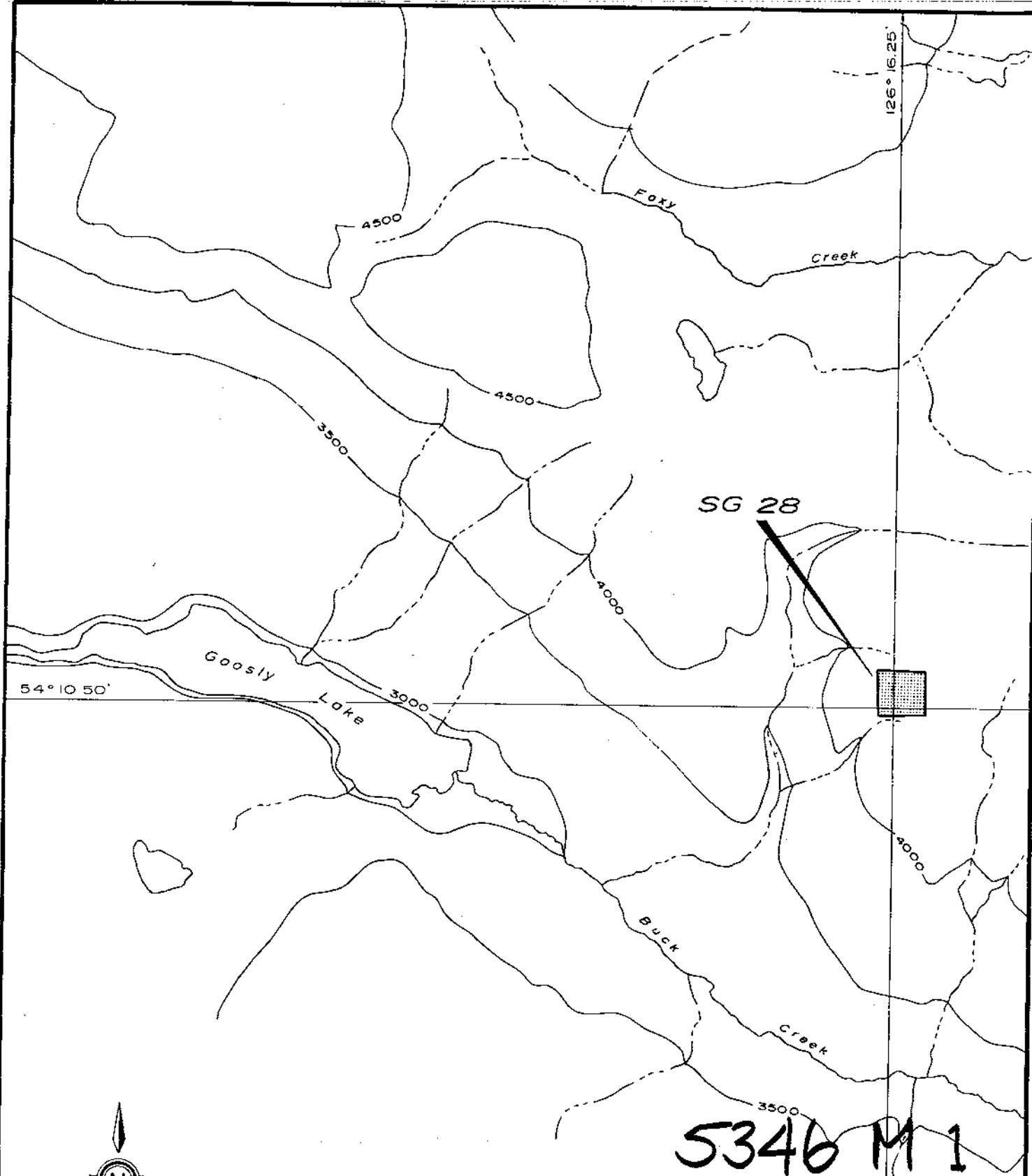

Department of  
Mines and Petroleum Resources  
ASSESSMENT REPORT

NO. 5346 MAP #1

SAM GOOSLY PROJECT  
INDEX MAP  
FOR SG 28

1:50,000

MILES 4 2 0 4 MILES

93L/1M

9000 N.

9000 N.

126° 16.25'

8500 N.

170

171

172

173

161

110

166

169

162

165

174

163

111

164

167

160

159

112

113

SG 28

Department of  
Mines and Petroleum Resources  
ASSESSMENT REPORT

NO. 5346

MAP

#2

54° 10.50'

7500 N.



12,000 E.

12,500 E.

13,000 E.

5346 M2

SAM GOOSLY PROJECT  
SG 28 MINERAL CLAIM  
DIAMOND DRILLING PLAN

FEET 200

SCALE

0

200 FEET

## SAM GOOSLY PROPERTY

Drill hole number 168  
 Core type NO  
 Date November 17 1974  
 Logged by E. S. Hall  
 Page 1 of 2

## DRILL HOLE GEOLOGIC LOG

Northing 8603.45  
 Easting 12,060.34  
 Elevation 4235.4  
 Dip -45°  
 Bearing East  
 Total Length 398 ft

## Alteration Scale

- 5 - Extreme Alteration  
 4 - High Alteration  
 3 - Moderate Alteration  
 2 - Some Alteration  
 1 - Weak Alteration  
 0 - No Alteration

Footage		Description	Graphic Log		Alteration						
From	To		Sketch	Remarks	Sil.	Clay	Chl.	Carb.	Seri.	Ep.	
0	28	Overburden									
28	99	Dust Tuff; varriable grey-yellowish and green, some badly broken sections, considerable coarse white silty fractures				2	1				
99	105	Andesite dyke, dark green, fine grained, sharp contacts, some fine white and galena ? l					2				
105	375	Dust Tuff, typical host horizon yellowish-grey, white as blocks and along fractures up to 3" wide, well fractured			2	3					
		184 - 2' andesite dyke		minor							
		198 - 24" andesite dyke		fault							
		175' to 215' highly altered yellowish, contains much py									
		271 - Coarse choker in late gte stringer									
		296 - 6" fault zone		fault							
		298 - 24" andesite dyke									

*E. S. Hall*



# DRILL HOLE GEOLOGIC LOG

SAM GOOSLY PROPERTY

Hole Number 168  
Page 2 of 2

Footage		Description	Graphic Log		Alteration						
From	To		Sketch	Remarks	Sil.	Clay	Chl.	Carb.	Seri.	Ep.	
305	340	Dust Tuff, gray-green with abundant alteration along fractures, minor coarse white along fractures rock is impregnated with numerous volcanic fragments				2	2				
340	348	Basaltic Dyke, dark green fine crained sharp chilled contacts, a few white amorphous					2				
348	398	Dust Tuff, chloritic, fine-grained variety, minor white along fractures, rare black shales		Chloritic		2	3				
		398 ft - end of hole									

*[Handwritten signature]*

## SAM GOOSLY PROPERTY

Drill hole number 160  
 Core type 115  
 Date May 19 1944  
 Logged by E. S. M.  
 Page 1 of One

## DRILL HOLE GEOLOGIC LOG

Northing 8407.97  
 Easting 12,272.05  
 Elevation 4302.6  
 Dip -45°  
 Bearing -090°  
 Total Length 195 ft

## Alteration Scale

5 - Extreme Alteration  
 4 - High Alteration  
 3 - Moderate Alteration  
 2 - Some Alteration  
 1 - Weak Alteration  
 0 - No Alteration

Footage		Description	Graphic Log		Alteration						
From	To		Sketch	Remarks	Sil.	Clay	Chl.	Carb.	Seri.	Ep.	
0	20	Overburden									
20	187	Dust Tuff. Silicious breccia intermittently, badly broken, pyrite and laterite as streaks and blebs and also fractures or with and by sh- eering			4	2			2		
		72' - 24" massive to silty		shearing andesite							
		87' - 16" andesite dikes									
		142' - 4" massive silty tuff									
		75' to 85' shearing, badly broken core		det							
		120' to 130' coarse chert as blebs and patches									
		170' - 6" massive pyrite + det									
		173' - 8" " " "									
		174' fault zone		fault							
		181' - 6" heavy pyrite									
187	195	Dust Tuff. Latrall variety chloritization along fractures minor pyrite weakly schistose									
		195 ft - end of hole				1	2	1			

## SAM GOOSLY PROPERTY

Drill hole number 170Core type NODate Nov 21, 1974Logged by E. S. H.Page 1 of Three

## DRILL HOLE GEOLOGIC LOG

Northing 8504.96Easting 11907.51Elevation 4231.6Dip -45°Bearing EastTotal Length 408 ft

## Alteration Scale

5 - Extreme Alteration

4 - High Alteration

3 - Moderate Alteration

2 - Some Alteration

1 - Weak Alteration

0 - No Alteration

Footage		Description	Graphic Log		Alteration						
From	To		Sketch	Remarks	Sil.	Clay	Chl.	Carb.	Seri.	Ep.	
0	3	Overburden									
3	15	Tricone d									
15	22	Dust tuff, badly broken, poor recovery, typical buff color with minor fine pyrite				2			1		
22	41	Andesite Dyke, competent dark green rock with small white patches filling amygdules, chilled contact, some fine pyrite		Andesite			2				
41	194	Dust tuff, very fine grey to buff color, well fractured and healed with pyrite and grey quartz (some of which appears to carry fine tetrahedrite?) glz-py stringers up to 4"			2	2			2		
		62' 4" quartz pyrite									
		69' 4" " "									
		91' 10" breccia healed with quartz-pyrite									
		102' 6" massive coarse pyrite									
		111' - 24" " " "									

*[Signature]*

# DRILL HOLE GEOLOGIC LOG

SAM GOOSLY PROPERTY

Hole Number 170  
Page 2 of 3

Footage		Description	Graphic Log		Alteration						
From	To		Sketch	Remarks	Sil.	Clay	Chl.	Carb.	Seri.	Ep.	
		143-193 10% pyrite, mainly Billings fractures, coarse crystalline									
194	208	Andersite Dyke, medium grey-green fine grained sharp irregular contacts approx 65° to core, chalcoprite with quartz-carbonate healing fine fractures, aka galena?		Andersite			1				
208	275	Dust Tuff, as above, buff to grey with considerable coarse pyrite, healing fractures or gashes, possibly some lot with pyrite, weakly tallose.			1	1			2		
275	292	273-6" massive pyrite Feldspar Porphyry, yellowish- green with white clay phenocrysts, sharp contacts with brecciation of tuff adjacent to contacts		Brecciation sulphides		3					
295	370	Dust Tuff, well mineralized horizon, tetrahedrite as random patches and stringers sometimes with and sometimes cutting quartz, typical dust tuff, weakly tallose, fractures in all directions		Fault Brecciation	2	1					
		337'-36" massive pyrite									

*EJH*

## DRILL HOLE GEOLOGIC LOG

SAM GOOSLY PROPERTY

Hole Number 170  
Page 3 of 3

Footage		Description	Graphic Log		Alteration					
From	To		Sketch	Remarks	Sil.	Clay	Chl.	Carb.	Seri.	Ep.
		355 - 36" andesite dike								
		364 - 15" - fault zone		fault						
370	408	Dust tuff, chloritic Sertumall varieties, chlorite concentrated along fractures, a few pyrite filled fractures, chalc and - siderite also noted, gradational contact				2	1		2	
		293' - 34" andesite dike					1			
		408 ft - end of hole					3			

*C. J. Hart*

## SAM GOOSLY PROPERTY

Drill hole number 171Core type NODate November 23, 74Logged by E.S.H.Page 1 of 2

## DRILL HOLE GEOLOGIC LOG

Northing 8499.82Easting 12097.92Elevation 4265.6Dip -45°Bearing EastTotal Length 292 ft

## Alteration Scale

- 5 - Extreme Alteration  
 4 - High Alteration  
 3 - Moderate Alteration  
 2 - Some Alteration  
 1 - Weak Alteration  
 0 - No Alteration

Footage		Description	Graphic Log		Alteration						
From	To		Sketch	Remarks	Sil.	Clay	Chl.	Carb.	Seri.	Ep.	
0	8	Overburden									
8	20	Tricoped									
20	139	Dust Tuff, typical host rock unit, yellowish-grey, highly brecciated along talcose fractures, white with minor tetrahedrite and chlorite, mainly along fractures, in filling, ashlike soil.				2			1		
139	142	Andesite Dyke, dark green, fine grained, hard, dense, sharp contacts		Andesite Breccia Andesite			1				
		144-24" breccia brecciated with ashlike soil		Fault							
142	148	Dust tuff, typical ore horizon, white & tetrahedrite bearing, fractures & cashes			1	2			2		
148	163	Andesite Dyke, dark green, fine grained, hard, dense, sharp, irregular contact		Fault			1				
163	173	Dust Tuff, yellowish-grey, highly fractured, white along fractures, some greyish alter-			1	3			2		

*E. H. Hall*

# DRILL HOLE GEOLOGIC LOG

SAM GOOSLY PROPERTY

Hole Number 171

Page 2 of 2

Page 2 of 2

Footage		Description	Graphic Log		Alteration					
From	To		Sketch	Remarks	Sil.	Clay	Chl.	Carb.	Seri.	Ep.
		ation adjacent to quartz								
264	292	Dye - (fracture variety) green-green color with dark green alteration along fracture, weakly crystalline, rather brittle		Andesite		2	2			
		264 - 48" andesite dyke								
		292 ft - End of bore								

## SAM GOOSLY PROPERTY

Drill hole number 172  
 Core type NQ  
 Date 25/11/74  
 Logged by J.B.R.  
 Page 1 of 1

## DRILL HOLE GEOLOGIC LOG

Northing 2493.71  
 Easting 12305.32  
 Elevation 4300.3  
 Dip -45°  
 Bearing 090°  
 Total Length 204

## Alteration Scale

5 - Extreme Alteration  
 4 - High Alteration  
 3 - Moderate Alteration  
 2 - Some Alteration  
 1 - Weak Alteration  
 0 - No Alteration

Footage		Description	Graphic Log		Alteration						
From	To		Sketch	Remarks	Sil.	Clay	Chl.	Carb.	Seri.	Ep.	
		0-24' Overburden									
24	128	Dust Tuft.									
		24' → 48' Bx + silica filled			5						
		bx. 34'-46" 80%+ replaced by silica.									
		48' - 128 More typical dust tuft. Py. veinlets, minor tet. Occasional Bx. Tet filled over 2" @ 105'		135°							
128	158	Andesite Dike. Fine grained white zeolite filled vesicles.		Broken							
158	170	Dust tuft. Some welded tuft. abundant slump structures. Chlorite		Ground up.			2				
170	191	Andesite Dike 10 to 5x mm hornblende lites. 1070 3mm. white zeolite filled vesicles.									
191	204	Dust Tuft Typical Fordwall. Chlorite. py. Veinlets.									
		199-202 - Andesite Dike									

*J.B.R.*



## SAM GOOSLY PROPERTY

Drill hole number 173  
 Core type NQ  
 Date 26/11/73  
 Logged by JBR  
 Page 1 of 1

## DRILL HOLE GEOLOGIC LOG

Northing 8491.10  
 Easting 12409.07  
 Elevation 4314.7  
 Dip -45°  
 Bearing 090  
 Total Length 151

## Alteration Scale

- 5 - Extreme Alteration  
 4 - High Alteration  
 3 - Moderate Alteration  
 2 - Some Alteration  
 1 - Weak Alteration  
 0 - No Alteration

Footage		Description	Graphic Log		Alteration						
From	To		Sketch	Remarks	Sil.	Clay	Chl.	Carb.	Seri.	Ep.	
		0-16' Traced. 6' AB.									
16	50	Dust Tuff. Moderate brecciation filled with py. silica and tet. 33'-39' 30% py. 40% silica Fault @ 33' @ 50°		50°	5						
50	60	Andesite Dyke. white zedite filled vesicles. ~107°.		70°							
60	76	Ash Tuff. Slumped structures w. minor bx. Tet. filled gashes and tears.		70°							
76	87	Andesite Dyke.		60°							
87	123	Dust Tuff. Buff colored chlorite increasing with depth. Py veinlets in chlorite.					1				
		108-109 andesite dyke. 109-113 hematite staining in fractures									
123	148	Andesite Dyke.		ground.			2				
148	151	Dust Tuff. Typical footwall material		Broken			2				

*J. B. Richards*

## SAM GOOSLY PROPERTY

Drill hole number 174  
 Core type NQ  
 Date 27/11/74  
 Logged by JBR  
 Page 1 of 2

## DRILL HOLE GEOLOGIC LOG

Northing 8199.56  
 Easting 11998.64  
 Elevation 4281.7  
 Dip -45°  
 Bearing 090  
 Total Length 338

## Alteration Scale

5 - Extreme Alteration  
 4 - High Alteration  
 3 - Moderate Alteration  
 2 - Some Alteration  
 1 - Weak Alteration  
 0 - No Alteration

Footage		Description	Graphic Log		Alteration						
From	To		Sketch	Remarks	Sil.	Clay	Chl.	Carb.	Seri.	Ep.	
		0-28' Overburden									
28	148	Dust tuft									
		28-42 - 15% recovery.									
		heavily limonite stained, acid leached.									
		On to 52'									
		52-70' minor ash tuft.									
		70'-112 moderate to heavily fractured. No veinlets and py filling 1-2" bx zones.									
		112-115 py filling bx. ~ 50% py.									
		115-124 crushed, minor py filling									
		124-126 Andesite Duke									
		126-146 Dust & Ash Tuft. moderate to heavy fracturing, occasional minor bx. py veinlets									
		146-147 Andesite Duke									
		147-148 Bx Dust Tuft. py.									
148	161	Andesite duke. Aphanitic to medium grained porphyritic. 3 separate intrusions									

*Richard*

