

5369

MAPS
L. 1002

#1 Location on Map
#2 Line Cutting
& Grid Establishment

#5369

REPORT ON

LINECUTTING & GRID ESTABLISHMENT

R-1, D-3 and D-7 MINERAL CLAIMS

KINGFISHER MINING DIVISION

VERNON MINING DIVISION

NTS 82L/10 E

by

COLBY MINES LTD.

82L/10E

Department of	
Mines and Petroleum Resources	
ASSESSMENT REPORT	
NO. 5369	MAP

GRID SPECIFICATIONS

1. Base Line from 0N to 18N (1800 feet).
2. Cross lines every 100 feet from 0N to 15N and from 5E to 5W (16,000 Feet).
3. Bearing of Base Line N54E (True).
4. Bearing of Cross Lines N36W (True).
5. Lines cut out and picketed at intervals of 25 and 50 feet.

Department of Mines and Petroleum Resources ASSESSMENT REPORT NO. 5369 MAP

KINGFISHER GROUP, VERNON MINING DIVISION

Statement of Expenditures and Personnel Employed

Linecutting & Grid Establishment

R-1, D-3 and D-7 Mineral Claims

by Colby Mines Limited

August 20-21 and September 10, 1974

LABOUR COSTS:

August 20 - 21:	G. Strong, W. Strong, C. Lynes, V. Lynes, W. Rotar, J. O'Neill, V. Boglac	\$700.00
September 10:	R. Yorston, W. Rotar, J. O'Neill, M. Heyland, W. Paterson, V. Lynes, C. Lynes	\$390.00

TRANSPORT, ROOM & BOARD, SUPPLIES, ETC. \$240.00

TOTAL \$1330.00

COLBY MINES LTD

Linecutting & Grid Establishment

R-1, D-3 & D-7 Mineral Claims

Kingfisher Group

Vernon, M.D.

January 1975 *John*

Mile 12 Grid

- Marble
- Quartzite
- Gneiss
- Feldspar porphyry
- Mineralisation Sphalerite, pyrochroite, galena

Department of
Mines and Petroleum Resources
ASSESSMENT REPORT
NO. 5369 MAP #2

Scale 1 inch = 100 feet

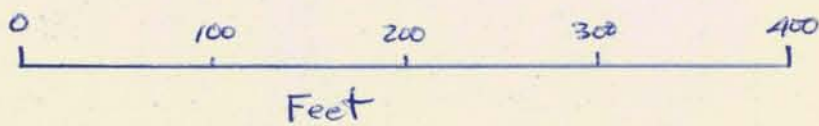

2.P.
R-1 Mineral Claim
(Approved)

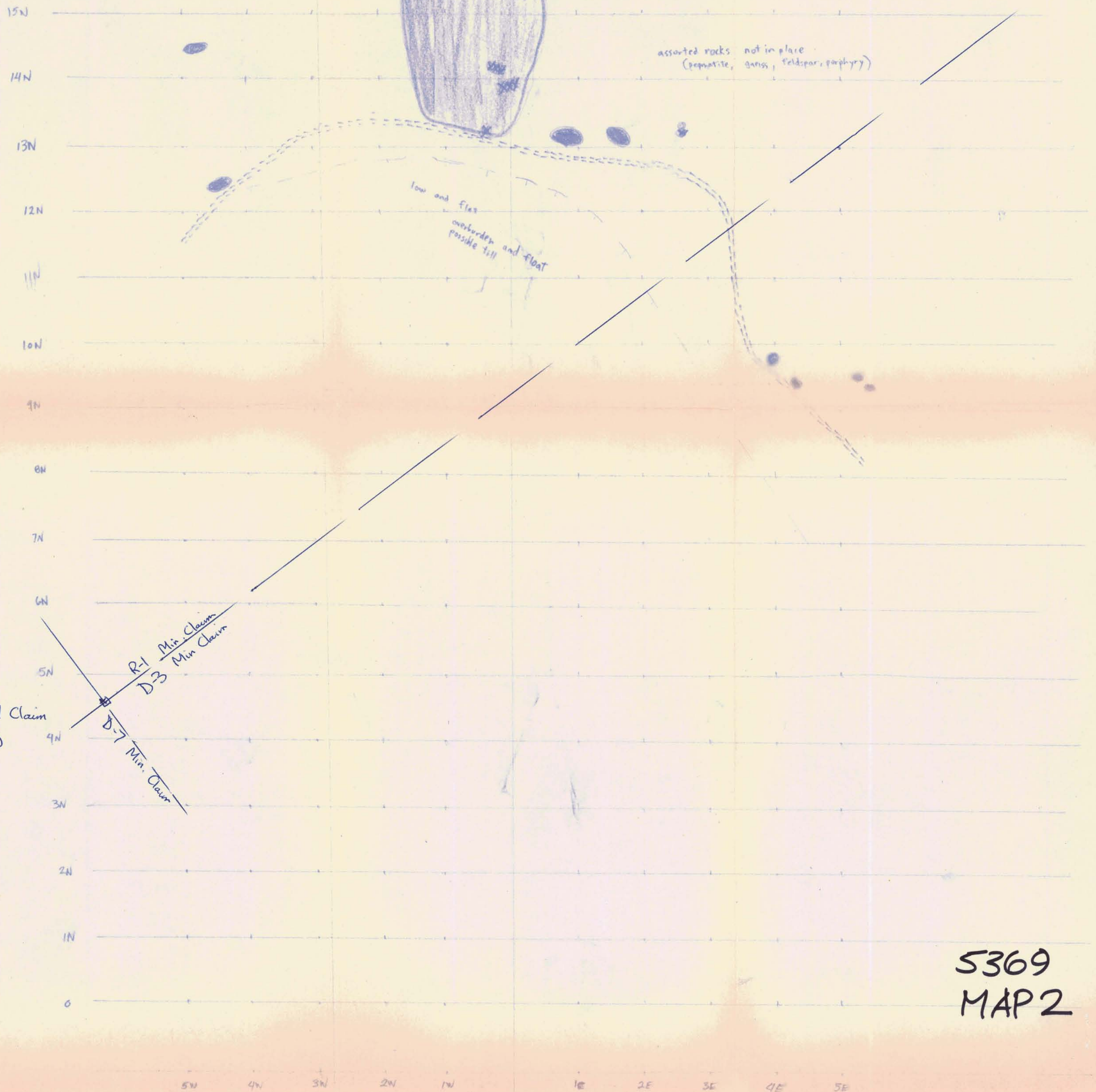

5369
MAP 2