

DON TULLY ENGINEERING LTD.
SUITE 102 - 2222 BELLEVUE AVENUE
WEST VANCOUVER, BRITISH COLUMBIA
V7V 1C7

5382

REPORT ON A

#5382

GEOPHYSICAL RONKA EM-16 SURVEY
ON CLAIMS

92I/9W

DAVE 26, 28 (RECORD NOS. 106861, 106863)

TOWNSHIP 19, RANGE 18, WEST 6
JACKO LAKE AREA
KAMLOOPS MINING DIVISION
KAMLOOPS, BRITISH COLUMBIA

N. LAT 50°-37'

W. LONG. 120°-23'

FOR

NEW MINEX RESOURCES LTD.
210 - 470 GRANVILLE STREET
VANCOUVER, B.C. V6C 1V5

Department of Mines and Technical Surveys 100 - 1111 14th Street NO. 5382
--

BY

DONALD W. TULLY, P.ENG.

MARCH 4, 1974

WEST VANCOUVER, B.C.

TABLE OF CONTENTS

	<u>PAGE</u>
INTRODUCTION.....	1
SUMMARY AND CONCLUSIONS.....	1
PROPERTY - LOCATION, ACCESS, TOPOGRAPHY.....	2
CLAIMS.....	2
HISTORY - PREVIOUS DEVELOPMENT - REFERENCES.....	3
GEOLOGY AND MINERALIZATION.....	3
GEOPHYSICAL SURVEY - GROUND CONTROL.....	4
- INSTRUMENT USED.....	4
- METHOD.....	4
- RESULTS.....	5
- INTERPRETATION.....	5
TIME - COST DISTRIBUTION.....	6
CERTIFICATE.....	7

MAPS

- #1 LOCATION MAP..... Following Page 1
- #2 PLAN OF RONKA EM-16 READINGS (Scale 1" = 100')..... In Pocket
- #3 KEY PLAN (McElhanney Associates, May 22, 1973)..... In Pocket

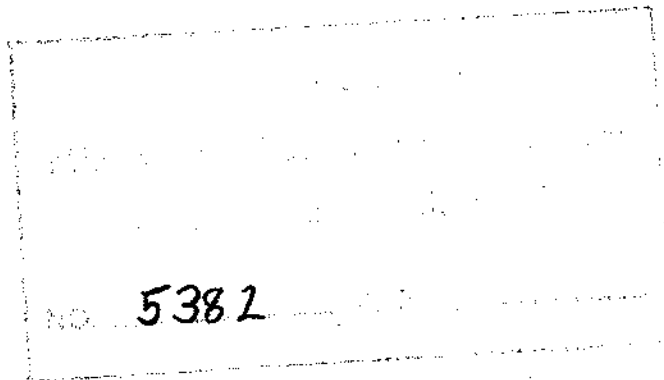

LOCATION MAP

SCALE: 1" = 30 Miles



WILLIAMS LAKE

Department of
Mines and Petroleum Resources
ASSESSMENT REPORT

NO. 5382 MAP #1

DAVE 26, 28 CLAIMS

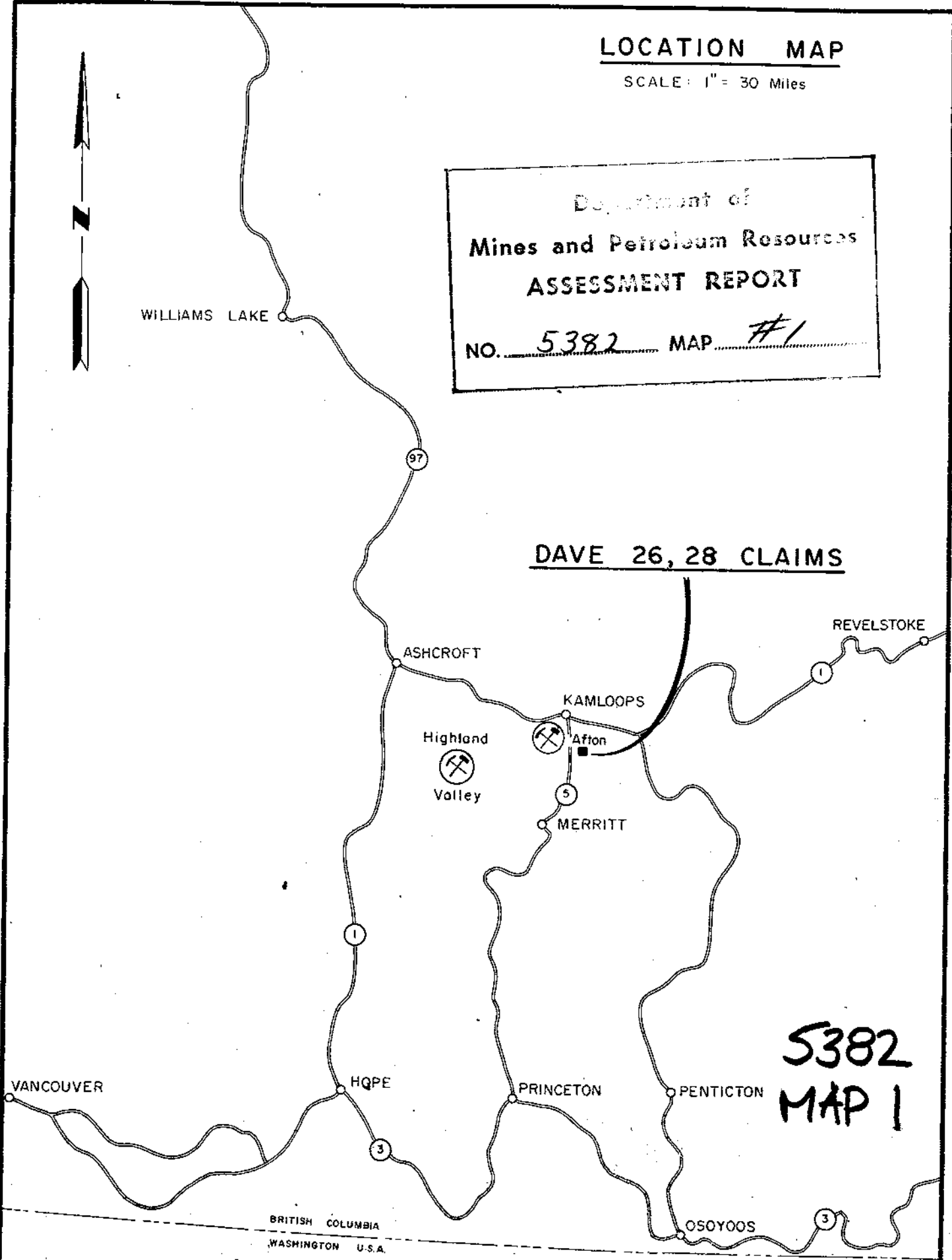

5382
MAP 1

BRITISH COLUMBIA
WASHINGTON U.S.A.

Donald W. Zully

INTRODUCTION

This report summarizes the results of a Ronka EM-16 electromagnetic survey performed by the writer on the DAVE 26 and 28 mineral claims in the period February 25-27, 1975.

The purpose of the geophysical survey was to search for conductor elements on the claimed area as a guide to further mineral development and perform assessment work for the credit of New Minex Resources Ltd.

Recent exploration work on the AJAX (L. 4710) Crown Grant mineral claim have reportedly outlined a modest tonnage of low-grade chalcopyrite-pyrite mineralization.

The purpose of the survey was to fulfil the assessment work credit requirements for the ensuing year and also test for any possible conductive mineral extensions from the AJAX claim.

SUMMARY AND CONCLUSIONS

No rock outcrops occur on the DAVE 26 and 28 claims. Clay, sand and gravel overburden is dominant in the valley of Peterson Creek.

The anomalous conductive zone extending north-south along line 21W is caused apparently by the Trans-Mountain pipeline.

No conductor zones of mineral significance have appeared in the survey results.

Work on adjacent ground may show conductive zones that could project into the DAVE 26 and 28 claim area.

PROPERTY - LOCATION, ACCESS, TOPOGRAPHY

The property is located about five miles south of Kamloops, British Columbia, in Township 19, Range 18, West 6, just beyond the southern limit of the new boundary of the City of Kamloops and about one claim southeast of Jacko Lake.

Access is by paved highway (No. 5) to Knutsford and thence via the Edith Lake and Goose Lake gravel roads to Peterson Creek at the location of Morrison Ranches Ltd. The claim area is open ranchland and can be traversed by ordinary automobile under most circumstances. Surface Lot L. 411 covers a small portion of the claim area.

Open undulating grassland, mostly under grazing lease, characterizes the topography. Elevations vary between 3000 and 3100 feet above sea-level. Snow conditions prevailed at the time of the Ronka EM-16 survey.

CLAIMS

The claims are recorded in the Kamloops Mining Division as follows:

<u>CLAIM NAME</u>	<u>RECORD NO.</u>	<u>RECORD HOLDER</u>	<u>GROUPING</u>
DAVE 26	106861 (March)	New Minex Resources Ltd.	Jacko West
DAVE 28	106863 (March)	"	Jacko West

HISTORY - PREVIOUS DEVELOPMENT - REFERENCES

Rolling Hills Copper Mines Ltd. previously filed assessment work on the nearby FOX and X claims. Vanco Explorations filed assessment reports on this area during the 1960's. Cominco also filed work on the adjoining AJAX (L. 4710) Crown Grant.

The following includes some of the available assessment reports on the surrounding area of the DAVE 26 and 28 claims.

1. "Dave and Bev claims", February 2, 1972 - W.R. Bacon, P.Eng.
2. "Rolling Hills and Dave claims", March 13, 1972 - R.H. Seraphim, P.Eng.
3. "Geological Report and Magnetic Survey on Rolling Hills claims, Jacko Lake", April 24, 1972 - R.H. Seraphim, P.Eng.
4. "Minex - Rolling Hills - Summary of Percussion Drilling", May 19, 1972 - R.H. Seraphim, P.Eng.
5. "Rolling Hills and Dave claims - Jacko Lake Area", Minex Development Ltd., August 22, 1972 - R.H. Seraphim, P.Eng.
6. "Rolling Hills and Dave claims - Jacko Lake Area", Minex Development Ltd., January 5, 1973 - R.H. Seraphim, P.Eng.

There are no test pits on the claim area excepting a north-south pipeline trench held by Trans-Mountain.

GEOLOGY AND MINERALIZATION

Rock outcrops are scarce. Bedrock geology is assumed to be largely Nicola volcanics and related intrusive phases of

the Iron Mask batholith. It is known that copper mineralization appears in some cases to occur within or on the flanks of the Iron Mask batholith.

There is no known economic mineralization on the DAVE 26 and 28 mineral claims although copper is known on the AJAX (L. 4710) Crown Grant adjoining on the north.

GEOPHYSICAL SURVEY

GROUND CONTROL

In 1972 McElhanney Associates were retained by Minex Development Ltd. (now New Minex Resources Ltd.) to survey the claim posts in their area of interest around Peterson Creek. A copy of this plan accompanies this report as Key Plan.

A base line was established on bearing $N84^{\circ}W$ (True) from the southeast corner of L. 4712.

From this base line compass and chain lines were established along bearings $N6^{\circ}E$ and $S6^{\circ}W$ over the claim area. Points along the chain and compass lines were marked with flagging.

INSTRUMENT USED

A Ronka model EM-16, serial number 3329, rented from Geonics Limited, Vancouver, British Columbia, was used in the field work.

METHOD

First, the instrument was oriented on station NPG, Seattle, Washington, by obtaining as "Null" a position as possible. Readings were then taken in the vertical plane and perpendicular

I, DONALD WILLIAM TULLY, MAKE OATH AND SAY as follows that on the dates herein specified, I incurred the following costs during the field survey and compilation of the field work on the DAVE 26 and 28 mineral claims.

TIME - COST DISTRIBUTION

	<u>WAGES AND EXPENSES</u>
Feb. 25-27/75 - D.W. Tully - Mobilization for field work, grid layout and Ronka EM-16 readings	\$ 150.00
March 4/75 - D.W. Tully - Field and office expenses, printing, stenographic services, map and report preparation covering period Feb. 25-27, March 4, 1975	<u>340.00</u>
TOTAL.....	\$ 490.00 =====

And I make this solemn declaration conscientiously believing it to be true, and knowing that it is of the same force and effect as if made under oath and by virtue of the "Canada Evidence Act".

DECLARED before me at the *City*
of *Vancouver* in the
Province of British Columbia,
this *11th* day of *March*
1975.

Jean Paul Sub-mining Recorder

Donald W. Tully

to the primary field at the "Null" position on both the quadrature and in-phase dials on the instrument.

RESULTS

The results were plotted on scale 1 inch = 100 feet on the accompanying map to this report.

Stronger in-phase and quadrature response was noted along the Trans-Mountain pipeline that extends through claim DAVE 26 on line 21W.

INTERPRETATION

Clay and loam overburden overlies most of the claim and should be considered in any interpretation.

No conductive area of significance was noted in the survey area.

Respectfully submitted,



Donald W. Tully, P.Eng.

March 4, 1975

CERTIFICATE

I, DONALD WILLIAM TULLY, of the Municipality of West Vancouver, in the Province of British Columbia, hereby certify as follows:

1. I am a Consulting Geologist with an office at Suite 102, 2222 Bellevue Avenue, West Vancouver, British Columbia.
2. I am a registered Professional Engineer in the Provinces of British Columbia and Ontario.
3. I graduated with a degree of Bachelor of Science, Honours Geology, from McGill University in 1943.
4. I have practiced my profession for twenty-nine years.
5. I have an interest in the shares of NEW MINEX RESOURCES LTD.
6. This report dated March 4th, 1975, is based on a personal knowledge of the area and the property. I did the work in the field.

DATED at West Vancouver, British Columbia, this 4th day of March, 1975.

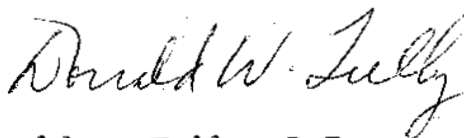

Donald W. Tully, P.Eng.
Consulting Geologist

MINEX DEVELOPMENT LTD.
PLAN OF MINERAL CLAIMS
IN JACKO LAKE - PETERSON CREEK AREA
KAMLOOPS MINING DIVISION.

MAP 92 19
 SCALE: 1 INCH = 500 FEET

REV. NO.	DATE	REVISION	DR	CH	APP.
1	5/22/73	Recognition of Dave 3 Fr. Loc Feb 13/72			
2	5/22/73	Dave 44 A plotted			
3	5/22/73	Detail Dave 26			
4	5/22/73	Jacko 18 Fr. plotted			
5	5/22/73	CIP cap pictures			
6	6/23/73	Expiry date PAM 30-31 plotted			

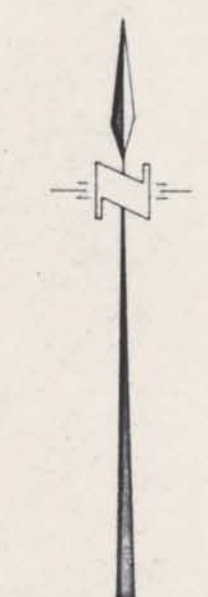
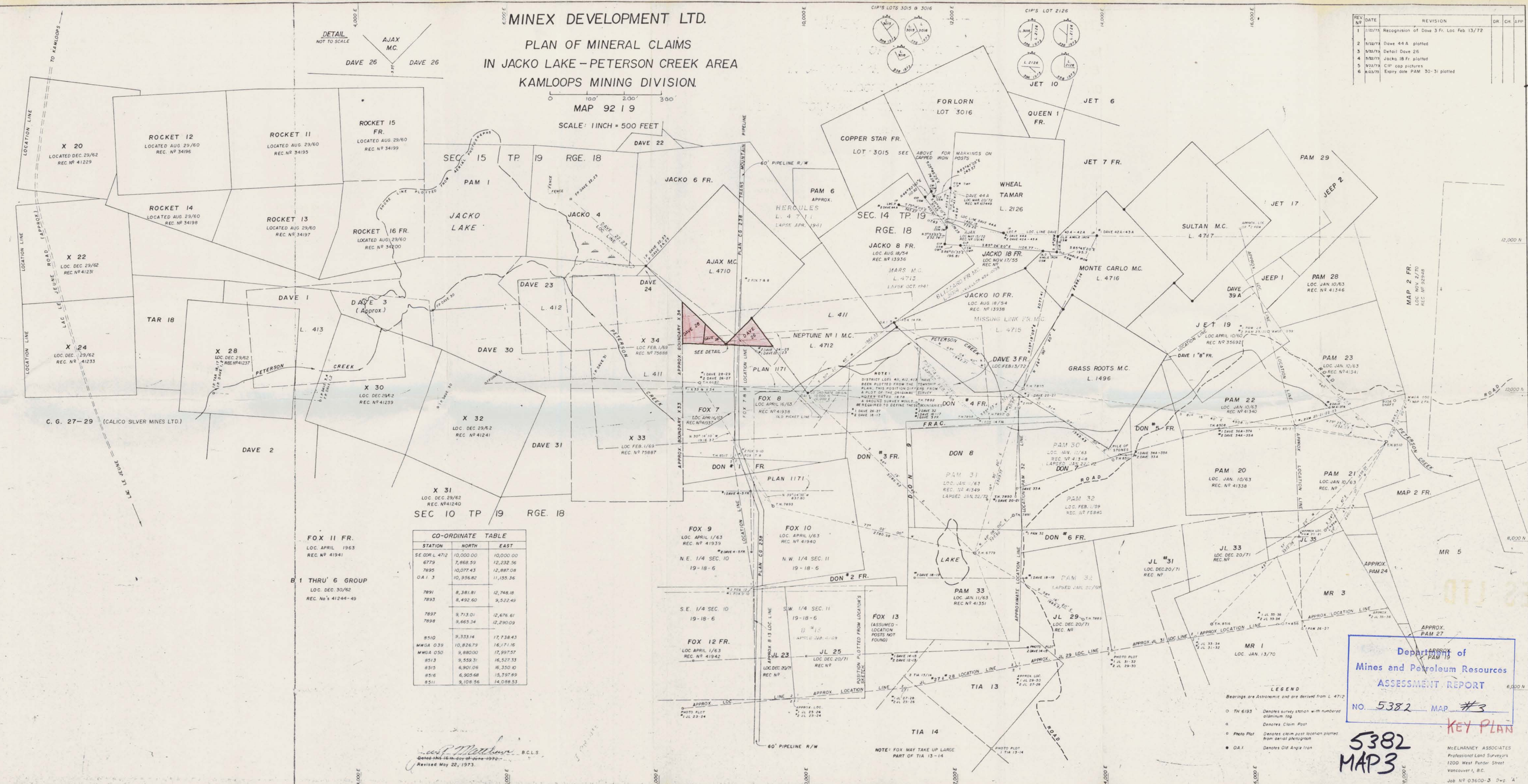

CO-ORDINATE TABLE

STATION	NORTH	EAST
SE COR L 472	10,000.00	10,000.00
6779	7,868.59	12,232.56
7895	10,077.43	12,887.08
O.A. 1.3	10,956.82	11,155.36
7891	8,381.81	12,748.18
7893	8,492.60	9,522.49
7897	9,713.01	12,676.61
7898	9,665.34	12,290.09
8510	9,333.14	12,738.43
MWSA 039	10,824.79	16,171.16
MWSA 050	9,880.00	17,897.57
8513	9,559.31	16,527.33
8515	6,901.06	6,350.10
8516	6,905.68	15,397.89
8511	9,108.56	14,088.53

FOX II FR.
 LOC. APRIL 1963
 REC. NO. 41941

B 1 THRU 6 GROUP
 LOC. DEC. 30/62
 REC. NO. 41244-49

Department of
Mines and Petroleum Resources
ASSESSMENT REPORT

NO. 5382 MAP #3

KEY PLAN

5382
MAP 3

McELMONEY ASSOCIATES
 Professional Land Surveyors
 1200 West Pender Street
 Vancouver 1, B.C.
 Job No. 03600-3 Draw. 4

W. P. Matthews B.C.L.S.
 Dated this 16th day of June 1973
 Revised May 22, 1973.

- LEGEND**
- TH 6193 Denotes survey station with numbered aluminum tag
 - Denotes Claim Post
 - Photo Plot Denotes claim post location plotted from aerial photograph
 - O.A. 1 Denotes Old Angle Iron

NOTE: FOX MAY TAKE UP LARGE PART OF TIA 13-14

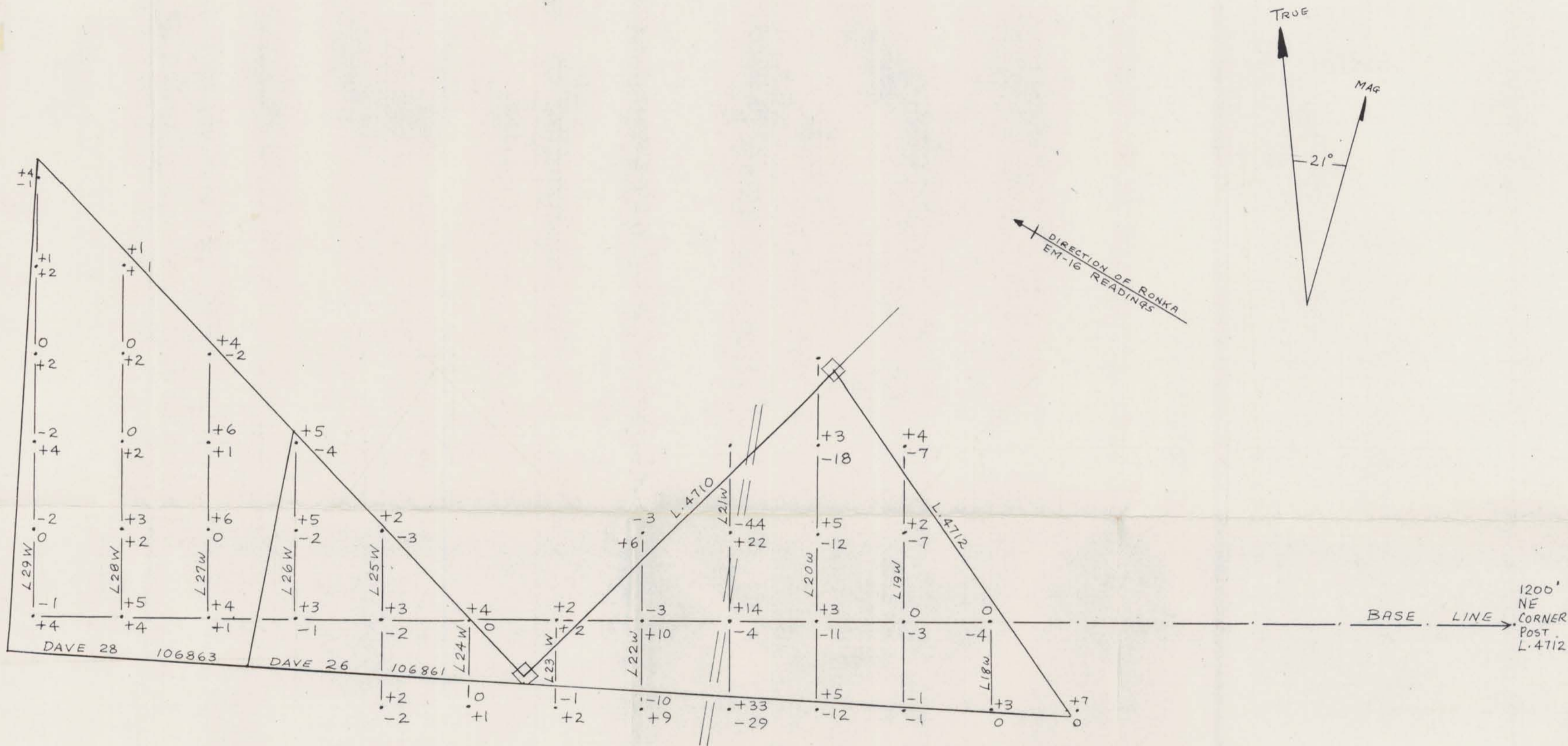

LEGEND

- □ — CLAIM LINE, POST
- 106863 CLAIM NUMBER
- -3 — IN-PHASE STATION READING
- +7 — QUADRATURE
- • — CHAIN-COMPASS LINE, FLAGGED POINT
- == == TRANS MOUNTAIN PIPELINE

NEW MINEX RESOURCES LTD

PLAN

RONKA EM-16 GEOPHYSICAL SURVEY OVER DAVE 26, 28 CLAIMS

Department of
Mines and Petroleum Resources
ASSESSMENT REPORT
NO. 5382 MAP # 2

SHOWING

INSTRUMENT READINGS

**5382
MAP 2**

SCALE: 1"=100'

DONALD W. TULLY, P.ENG.

MARCH 4, 1975

Donald W. Tully