

# 5408

NEVEX MINES LTD.

GEOCHEMICAL and MAGNETOMETER SURVEY

BALDY and RICE CLAIM GROUPS

## 82E/3E

Greenwood Mining Division

Latitude 49° 3'

Longitude 119° 10'

by

W. Meyer, P.Eng.

On work performed May 25 to June 2, 1974

BALDY 1 - 12

RICE 1 - 6

Department of  
Mines and Petroleum Resources  
ASSESSMENT REPORT

NO. 5408 MAP

March 3, 1975

TABLE of CONTENTS

	<u>Page</u>
INTRODUCTION .....	1
LOCATION and ACCESS .....	1
CLAIMS .....	2
HISTORY .....	2
GEOLOGY .....	2
MAGNETOMETER SURVEY .....	3
GEOCHEMISTRY .....	4
CONCLUSIONS .....	6

APPENDIX 1	Author's Certificate
"    11	Personnel and Dates
"    111	Affidavit re: Cost of Survey

<u>Maps</u>	<u>After Page</u>
Fig. 1 #1 Location Map .....	1
Fig. 2 #2 Claim Location Map .....	2
Fig. 3 #3 Magnetometer Survey .....	(In pocket)
Fig. 4 #4 Magnetometer Survey .....	" "
Fig. 5 #5 Geochemical Survey .....	" "
Fig. 6 #6 Geochemical Survey .....	" "

## INTRODUCTION

The "BALDY" and "RICE" claims comprise 18 full size mineral claims situated in the Greenwood Mining Division, Camp McKinney area.

The claims were originally staked as a result of a stream sediment geochemical survey in the McKinney Creek drainage basin. The anomaly staked occurs along Rice Creek, one of the principal tributaries of McKinney Creek. Follow up geochemical and geophysical programmes were carried out to evaluate this anomaly.

## LOCATION and ACCESS

The claim groups straddle Rice Creek, a major tributary of McKinney Creek in the Greenwood Mining Division in south central British Columbia, a distance of 275 miles east of Vancouver.

The claims may be reached from Vancouver via the Trans Canada Highway to Hope and Highway No. 3 to Rack Creek Canyon, some 23 miles east of Osoyoos, B.C.. From the Canyon Bridge access is by 5 miles of good gravel, all-weather road leading to the Baldy Mountain ski area and passing through Camp McKinney.

NO. 5408 MAP #1  
ASSESSMENT REPORT  
Mines and Petroleum Resources  
Department of  
A C F I C

INDEX MAP

BRITISH  
COLUMBIA



**NEVEX MINES PROPERTY**  
( RICE AND BALDY GROUP )

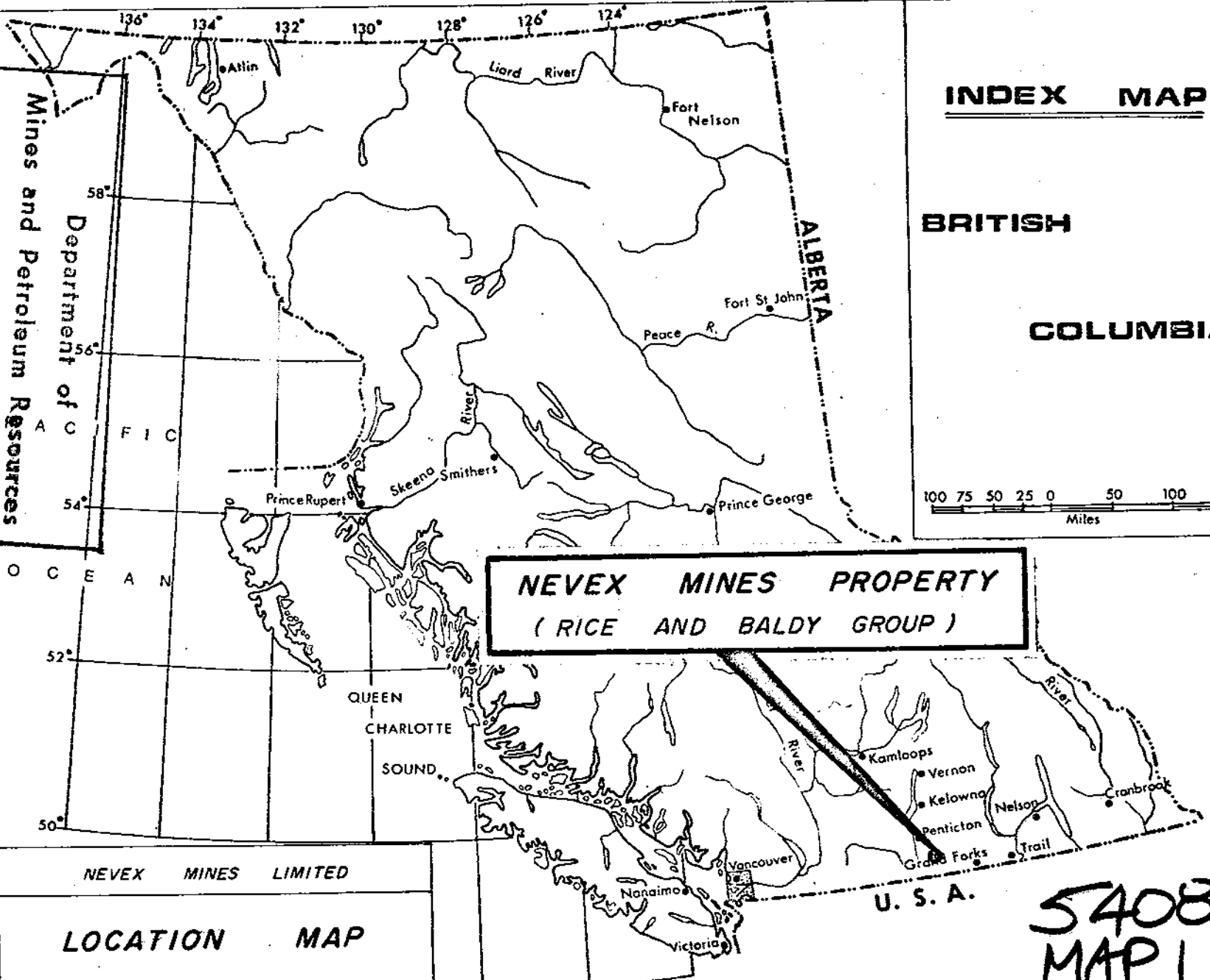

NEVEX MINES LIMITED  
LOCATION MAP

5408  
MAP 1

CLAIMS

The "BALDY" and "RICE" claims owned by Nevex Mines Ltd. consist of 18 full size claims in two nearby groups. Their location relative to local geology and topography is shown on Fig. 2.

<u>Claim Name</u>	<u>Record No.</u>	<u>Expiry Date</u>
Baldy I - 12	37125 - 37136	May 8, 1975
Rice I - 6	37119 - 37124	May 8, 1975

HISTORY

The Camp McKinney area has had a long history of gold exploration, development and production dating back to the 19th century.

This production has included mining both lode and placer deposits. The principal lode gold deposit was the Cariboo-Amelia producing over \$1,000,000 in gold (\$20 gold) during the period 1894 - 1903. The bulk of the placer gold in the past has been taken from Rock and McKinney Creeks.

Since the turn of the century the area has seen intermittent production of both lode and placer mining. In more recent times the area has been subjected to exploration programmes directed towards copper, nickel and other base metal deposits.

Current high prices for base and precious metals have led to yet another review of the areas potential.

GEOLOGY

The McKinney Creek area is underlain by rocks of the Anarchist series which consist of highly metamorphised sedimentary rocks

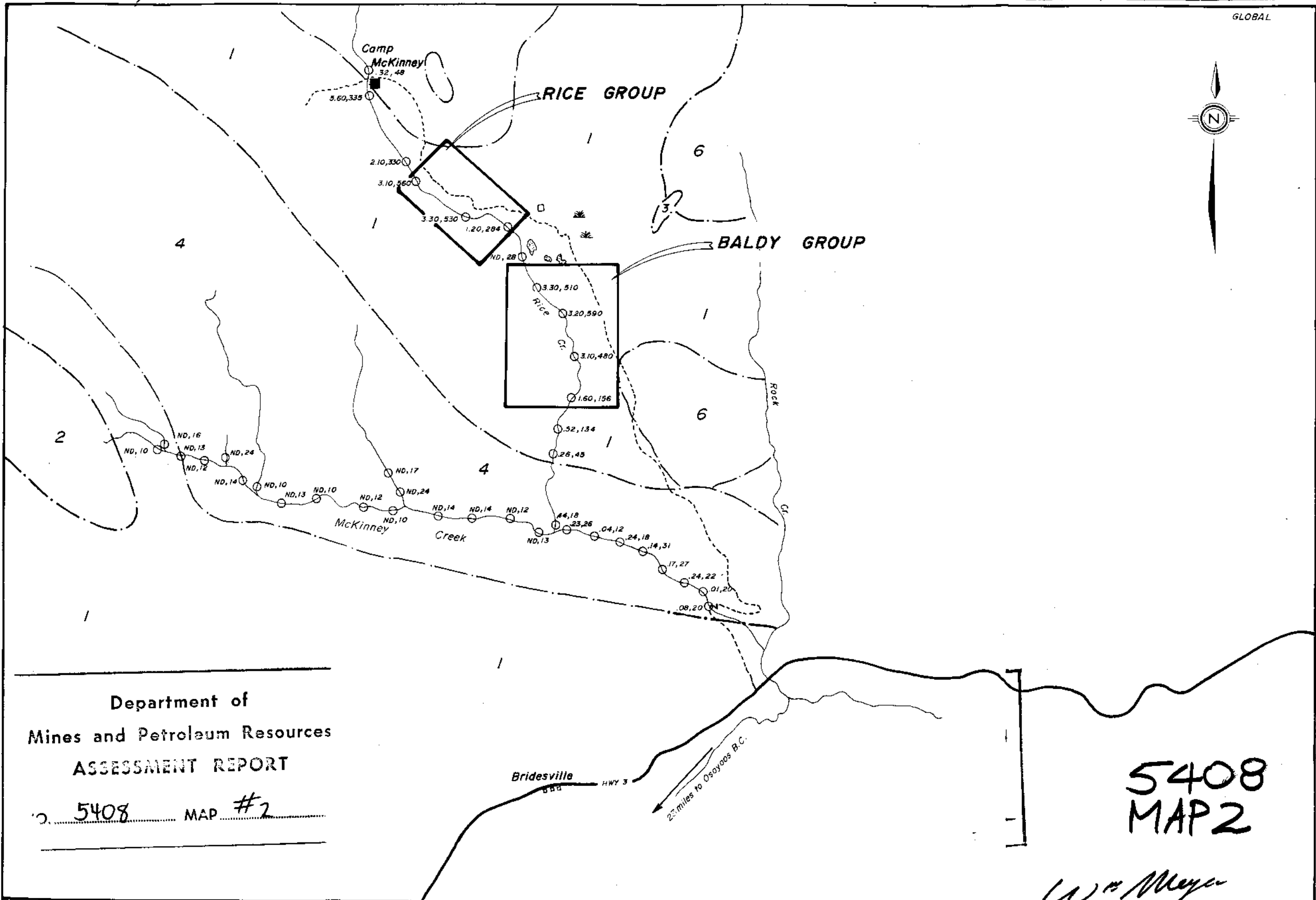

Department of  
Mines and Petroleum Resources  
ASSESSMENT REPORT

5408 MAP #2

5408  
MAP 2

*W. Meyer*

- LEGEND**
- 6 Lavas
  - 4 Granodiorite, quartz diorite
  - 3 Sheared amphibolite and serpentine
  - 2 Gneissic granite
  - 1 Anarchist Series

○.44, 31 — Au, Cu in ppm

Map to accompany Geochemical and Magnetometer Survey report on the "Baldy" and "Rice" Claim Groups by W. Meyer P. Eng. Dated March 3 1975

NEVEX MINES LIMITED		
CLAIM LOCATION, GEOCHEMISTRY & GEOLOGY		
DATE: May 1974	SCALE: 1in. = 1mile	FIGURE No - 2

which are altered equivalents of sandstone, shale and limestone. The unit also contains minor altered intrusive and extrusive rocks.

The Anarchist Group is intruded locally by at least two and possibly four intrusive types. (ref: G.S.C. Map 316A by W.E. Cockfield, 1935). The intrusive rocks vary in composition from granodiorite to ultrabasics and in age from Jurassic to Tertiary.

Locally, the claim group is underlain by Anarchist Group metasediments near the contact of the largest intrusive mass of the area (Oliver Granite).

Exposures noted during the course of the examination of the claim area were of dark, schistose metasediments impregnated with stringers and lenses of rusty quartz.

#### MAGNETOMETER SURVEY

A magnetometer survey aggregating 17 line miles was carried out on the two claim groups. Variations in the vertical component of the earth's field were measured using a McPhar Model M-700 magnetometer at 100 foot intervals on flagged, chain and compass lines spaced 400 feet apart. The object of the survey was to outline rock units and geological structures.

The field data is plotted on two separate maps accompanying this report. (Fig. 3 and Fig. 4)

Most of the surveyed area is characterized by a relatively low, uniform magnetic field corresponding to the metamorphic rocks of the Anarchist Group.

4.

Several areas of slightly higher magnetic field and higher density of contours occur on both the "BALDY" and "RICE" claims. The shape of these features, as outlined on the two maps, suggests small intrusive masses or dykes within the Anarchist rocks rather than higher susceptibility rocks of the Anarchist Group itself.

A slight high trend on the "RICE" claims subparallel to Rice Creek may represent a structural feature. The possibility that it corresponds to magnetite in an old stream channel, however, should not be overlooked. This feature may have some significance in assessing the placer potential of the ground.

#### GEOCHEMISTRY

A soil geochemical survey was carried out for copper and gold on a 200 foot x 800 foot grid. A total of 218 samples were taken from just below the "A" horizon where possible, using mattocks.

Samples were placed in Kraft paper envelopes, partially dried and shipped to Acme Analytical Laboratories in Burnaby for analysis by atomic absorption.

The field data is plotted on the accompanying Figures 5 and 6. Anomalous gold-copper anomalies of two distinct types occur in the area; one group associated with the Rice Creek drainage and one group associated with possible bedrock sources.

Gold values of 2.8 ppm and 4.5 ppm with corresponding anomalous copper values were obtained in a wide part of the Rice Creek drainage on L 12 + 00 S. Previously taken silt samples in the drainage



5.

on the claim group returned gold values varying from 1.6 ppm to 3.3 ppm Au.

The distribution of values in the more detailed soil grid indicates that the high values obtained in the original silt sampling are related to the drainage from Camp McKinney rather than a similar downstream source.

Many of the weak copper anomalies outlined in the present survey can be related to drainage features.

Data on the extreme west side and extreme east side of the group outlined weak to moderate gold anomalies associated with magnetic features. The magnetic features (see previous discussion above) have been interpreted as intrusive dykes or stocks. These anomalies, particularly on the west side, centred around L 20 + 00 S - 12 + 00 W, are significant in that they may well reflect mineralized bedrock structures on the margins of intrusive dykes. More detailed surveys will be required in these areas.

CONCLUSIONS

Significant gold anomalies were outlined in the soil geochemical survey.

One group of anomalies is associated with the Rice Creek drainage and has values up to approximately 0.1 oz. Au per ton as placer gold. These are unusually high values and this drainage warrants a further study for its placer potential.

Significant gold anomalies were outlined at the extreme edges of the claim group. These may be related to bedrock sources near the margins of intrusive dykes.

Respectfully submitted,



W. Meyer, P. Eng.

Vancouver, B.C.

March 3, 1975

CERTIFICATE

I, William Meyer, do hereby certify that:

1. I am a geologist with residence at 911 Jarvis Street, Coquitlam, B.C.
2. I am a graduate of the University of British Columbia (B.Sc., 1962)
3. I am a registered member of the Association of Professional Engineers of the Province of British Columbia.
4. I have worked as an exploration geologist for 13 years for the following companies: Phelps Dodge Corporation of Canada Ltd., Gibraltar Mines Ltd., Associated Geological Services Ltd., Western Geological Services Ltd. (senior partner). I am presently a senior partner in W. Meyer & Associates Ltd.
5. I personally examined the "BALDY" and "RICE" claims on April 18, 1974.
6. I have no interest, direct or indirect, nor do I anticipate receiving any, in the properties or securities of Nevex Mines Ltd.

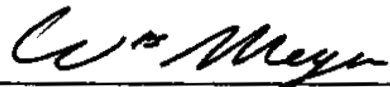

W. Meyer, P. Eng.

March 1975

APPENDIX 11

PERSONNEL:

W. Meyer #1015 - 470 Granville St. Vancouver, B.C.	Geologist	6/12/74 - 6/13/74	2
P. W. Dunsford	Magnetometer Operator	5/24/74 - 6/8/74	16
M. Maybury	Helper	5/24/74 - 6/2/74	10

AFFIDAVIT re COST OF SURVEY

I, William Meyer of 911 Jarvis Street in the Municipality of Coquitlam in the Province of British Columbia, DO SOLEMNLY DECLARE that the geophysical and geochemical surveys of Nevex Mines Ltd. were conducted during the field season of 1974 and are described in this report. The data was obtained by consultants to Nevex Mines Ltd. at a total property related cost of at least \$3,600.00

AND I make this solemn declaration conscientiously believing it to be true, and knowing that it is of the same force and effect as if made under oath and by virtue of the "Canada Evidence Act".

DECLARED before me at the City of Vancouver, in the Province of British Columbia, this 26 day of March, A.D. 1975

  
W. Meyer, P. Eng.

  
Sub-mining Recorder





Department of  
Mines and Petroleum Resources  
ASSESSMENT REPORT  
NO. 5408 MAP #4

5408 MAP4

*W. Meyer*  
NEVEX MINES LTD.  
RICE CLAIM GROUP  
GREENWOOD MINING DIVISION  
**MAGNETOMETER SURVEY**  
Scale 0 200 400 feet  
Date - June 1974 Figure No - 3

Map to accompany Geochemical and Magnetometer Survey  
report on the "Baldy" and "Rice" Claim Groups by W. Meyer  
P. Eng. Dated March 3 1975





Department of  
Mines and Petroleum Resources  
ASSESSMENT REPORT  
NO. 5408 MAP #3

5408  
MAP #3

W. Meyer  
NEVEX MINES LTD.

BALDY CLAIM GROUP  
GREENWOOD MINING DIVISION  
MAGNETOMETER SURVEY  
Scale 0 200 400 feet  
Date - June 1974 Figure No. 4

Map to accompany Geochemical and Magnetometer Survey  
report on the "Baldy" and "Rice" Claim Groups by W. Meyer  
P. Eng. Dated March 3 1975









**LEGEND**

- 18 — Copper in ppm
- .01 — Gold in ppm
- ND — Not detected
- — Outcrop

Department of  
Mines and Petroleum Resources  
ASSESSMENT REPORT  
NO. 5408 MAP #6

*W. Meyer*  
5408  
MAP 6

NEVEX MINES LTD.

RICE CLAIM GROUP  
GREENWOOD MINING DIVISION

**GEOCHEMICAL SURVEY  
COPPER & GOLD**

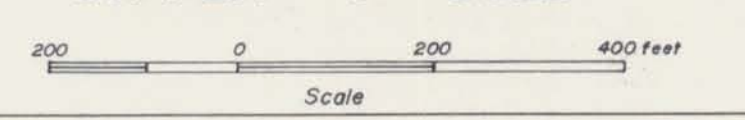

Map to accompany Geochemical and Magnetometer Survey  
report on the "Baldy" and "Rice" Claim Groups by W. Meyer  
P.Eng. Dated March 3 1975