

5443

92F/2E

ASSESSMENT REPORT

SAM GROUP OF CLAIMS

ALBERNI M.D. B. C.

92/10E

SAM 4, 6, 9-13

May 1, 1975.

E.P. SHEPPARD P. Eng.

Department of
Mines and Petroleum Resources
ASSESSMENT REPORT

NO. 5443 MAP

SAMPLING REPORT

SAM GROUP
Alberni MINING DIVISION
British Columbia

Keywest Resources Ltd.

During the period May 13, 14, 15, 1974, the old workings on the Sam Group were examined and sampled. The results of this sampling are shown on the accompanying 40-scale map.

The veins sampled were the Lower Mac and the Upper and Lower Belcher. The raises between the Upper and Lower Belcher and from the sub-level on Lower Mac to surface were also sampled.

The assay results indicated that the gold is evenly distributed throughout the structure. Although values obtained were fairly low, it is felt that further work is warranted, especially in the vicinity of the shear zone.

E. P. Sheppard

E. Percy Sheppard, P. Eng.
Consulting Geologist

Vancouver, B.C.
May 1, 1975





CHEMEX LABS LTD.

212 BROOKSBANK AVE.
 NORTH VANCOUVER, B.C.
 CANADA
 TELEPHONE: 985-0648
 AREA CODE: 604

• ANALYTICAL CHEMISTS • GEOCHEMISTS • REGISTERED ASSAYERS

CERTIFICATE OF ASSAY

TO: Keywest Resources Ltd.,
 #818 - 510 W. Hastings,
 Vancouver, B. C.

CERTIFICATE NO. 22871
 INVOICE NO. 11346
 RECEIVED May 16/74
 ANALYSED May 21/74

ATTN: Mr. James Szakacs

SAMPLE NO. :	Oz/Ton Silver	Oz/Ton Gold	
22001		< 0.003	900' FROM CLAIM LINE 5' SHEAR
22002		0.005	1280' FROM CLAIM LINE 6' SHEAR 3' QUARTZ
22003		0.005	1740' FROM CLAIM LINE TUFF WELL PYRATIZED
22004		0.019	2670' FROM CLAIM LINE 6' SHEAR
22005		0.005	290' N. FROM LOWER S.H. ADIT 8' SHEAR
22006		0.016	QUARTZ FLOAT
22007		0.022	190' NORTH FROM LAST STATION 6' SHEAR U. SIDE
22008		0.003	QUARTZ BOULDERS FROM SHEAR
22009		0.029	HANGING WALL 0'-6' SHEAR SOME QUARTZ
22010		0.003	" " 6'-12' SHEAR
22011		0.026	" " 12'-18' SHEAR
22012		0.026	" " 18'-24' SHEAR
22013		0.016	AT A5 QUARTZ FLOAT
22014		0.050	15' EAST FROM A5 6' SHEAR
22015		0.047	DARK GRAY QUARTZ FROM HANGING WALL WELL PYRATIZED
22016	0.03	< 0.003	15' QUARTZ YELLOWES C.R.
22017	0.03	< 0.003	YELLOWES C.R. SHEAR 6 FEET EL 2400'
22018	0.04	< 0.003	YELLOWES C.R. S.H. 10' W. FROM ABOVE
22019	0.04	< 0.003	YELLOWES C.R. S.H. 8' EL 2500'
22020	0.09	< 0.003	GRAY S.H. YELLOWES C.R. WELL PYRATIZED SOME QUARTZ
22021	0.10	< 0.003	SOME AS ABOVE EL 2000'
22022	0.06	< 0.003	" " " "
✓ 22023	AU .091	0.022	FROM UPPER BECKER DRIFT DOWN FROM FACE 24'
✓ 22024		0.022	UPPER BECKER DRIFT 8' 34" + " 34"
✓ 22025		0.008	UPPER BECKER DRIFT 14' 34"
✓ 22026		0.23	" " SMALL SLOPE 12" QUARTZ
✓ 22027	.020	0.037	" " IRON 25' 20"
✓ 22028		0.063	" " " 35' 34"
✓ 22029	.12	0.031	" " " 40' 34"
✓ 22030		1.25	" " " 45' 38"
✓ 22031		3.30	" " " 55' 30"
22032		0.016	" " " 65' 34"
22033	7.00	0.015	" " " 70' 38"
22034		0.059	" " " 75' 38"
22035	2.48	0.029	" " " 80' 36"
22036		0.011	" " " 85' 38"
✓ 22037	.033	0.13	" " " 90' 36"
✓ 22038	.13	0.15	" " " 100' 36"
✓ 22039	.40	0.095	" " " 120' 16"
22040)	.020	0.022	" " " 140' 12"
22041)			



MEMBER
 CANADIAN TESTING
 ASSOCIATION

B. Swaine
 REGISTERED ASSAYER, PROVINCE OF BRITISH COLUMBIA



CHEMEX LABS LTD.

212 BROOKSBANK AVE.
 NORTH VANCOUVER, B.C.
 CANADA
 TELEPHONE: 985-0648
 AREA CODE: 604

• ANALYTICAL CHEMISTS • GEOCHEMISTS • REGISTERED ASSAYERS

CERTIFICATE OF ASSAY

TO: Keywest Resources Ltd.,
 818 - 510 W. Hastings,
 Vancouver, B. C.

ATTN: Mr. Cook

CERTIFICATE NO. 23543

INVOICE NO. 11289

RECEIVED April 22/74

ANALYSED April 26/74

SAMPLE NO. :	Oz/Ton Silver	Oz/Ton Gold	
YF	0.07	<0.003	YELLOWIS CR SHEAR 30' FOOT WALL
YH	0.36	<0.003	YELLOWIS CR SHEAR 30' HANGING WALL
YQ #1	0.54	<0.003	YELLOWIS CR SLICELINE ZONE 7'
18051	0.12	0.052	LOWER MAC AT PORTAL 4" QUARTZ
✓18052	1.05	0.011	LOWER MAC AT PORTAL 17" OF SHEAR
✓18053	0.69	2.71	LOWER MAC 5' IN FROM PORTAL 4" QUARTZ
✓18054	0.09	0.11	LOWER MAC 10' IN FROM PORTAL 2" & 10" SHEAR
✓18055	1.22	4.31	LOWER MAC 15' IN FROM PORTAL 3" QUARTZ
✓18056	0.18	0.020	LOWER MAC 20' IN FROM PORTAL 5" QUARTZ
✓18057	0.23	0.069	LOWER MAC 25' IN FROM PORTAL 10"
✓18058	0.06	0.024	LOWER MAC 30' IN FROM PORTAL 4"
✓18059	0.07	0.091	LOWER MAC 35' IN FROM PORTAL 11"
✓18060	0.21	0.71	LOWER MAC 40' IN FROM PORTAL 7"
✓18061	0.03	0.005	LOWER MAC 45' IN FROM PORTAL 22"
✓18062	0.06	0.011	LOWER MAC 50' IN FROM PORTAL 3"
✓18063	0.06	0.020	LOWER MAC 55' IN FROM PORTAL 8"
✓18064	0.07	0.097	LOWER MAC 60' IN FROM PORTAL 2"
✓18065	0.06	0.008	LOWER MAC 60' IN FROM PORTAL 12" OF SHEAR F.W.
✓18066	0.04	0.011	LOWER MAC 65' IN FROM PORTAL 4" OF QUARTZ
✓18067	0.03	0.016	LOWER MAC 70' IN FROM PORTAL 4" OF QUARTZ
✓18068	0.03	0.005	LOWER MAC 90' IN FROM PORTAL 3" OF QUARTZ
✓18069	0.04	0.011	LOWER MAC FIRST X CUT 0'-5'
✓18070	0.06	0.031	LOWER MAC FIRST X CUT 5'-10'
✓18071	0.04	0.005	LOWER MAC FIRST X CUT 13' OF QUARTZ
18072	0.04	0.003	LOWER MAC FIRST X CUT 10'-15'
✓18073	0.04	<0.003	LOWER MAC FIRST X CUT 15'-20'
✓18074	0.01	0.003	LOWER MAC 100' IN FROM PORTAL 7"
✓18075	0.12	0.20	LOWER MAC 107' IN FROM PORTAL 3"
✓18076	0.06	0.011	LOWER MAC NO. 2 X CUT 6" OF QUARTZ
✓18077	0.03	0.003	LOWER MAC 142' IN FROM PORTAL 2"
✓18078	0.07	0.015	LOWER MAC 147' IN FROM PORTAL 5"
✓18079	0.03	0.008	LOWER MAC 167' IN FROM PORTAL 4"
✓18080	0.06	0.015	LOWER MAC 172' IN FROM PORTAL FACE OF DRIFT 5"
✓18081	<0.01	0.003	MAC RAISE 58' FROM LOWER MAC DRIFT 6"
✓18082	<0.01	0.031	MAC SUB DRIFT 6' NORTH FROM RAISE 4"
✓18083	0.01	0.16	MAC SUB DRIFT 12' NORTH FROM RAISE 6"
✓18084	0.03	0.041	MAC SUB DRIFT 12' NORTH FROM RAISE 6"
✓18085	0.31	0.008	MAC SUB DRIFT 30' NORTH FROM RAISE 2"
✓18086	0.03	0.015	MAC SUB DRIFT FACE 7'
✓18087	0.04	0.003	UPPER MAC ADIT AT END 3' QUARTZ



MEMBER
 CANADIAN TESTING
 ASSOCIATION

REGISTERED ASSAYER, PROVINCE OF BRITISH COLUMBIA



CHEMEX LABS LTD.

212 BROOKSBANK AVE.
NORTH VANCOUVER, B.C.
CANADA
TELEPHONE: 985-0648
AREA CODE: 604

• ANALYTICAL CHEMISTS • GEOCHEMISTS • REGISTERED ASSAYERS

CERTIFICATE OF ASSAY

TO: Keywest Resources Ltd.,
818 - 510 W. Hastings,
Vancouver, B. C.
ATTN: Mr. Cook

CERTIFICATE NO. 23544
INVOICE NO. 11289
RECEIVED April 22/74
ANALYSED April 26/74

SAMPLE NO. :	Oz/Ton Silver	Oz/Ton Gold	
✓ 18088	0.07	0.016	UPPER MAC ADIT AT END 2' WALL
18089	0.03	0.016	UPPER BELCHER DUMP SURFACE
18090	0.04	0.016	UPPER BELCHER DUMP 1' DEEP
18091	0.04	0.008	UPPER BELCHER DUMP SURFACE
18092	0.06	0.061	UPPER BELCHER DUMP 1' DEEP
18093	0.06	0.020	UPPER BELCHER DUMP SURFACE
18094	0.04	0.020	UPPER BELCHER DUMP 1' DEEP
✓ 18095	0.07	0.091	UPPER BELCHER 0' NORTH FROM RAISE 12" 9
✓ 18096	0.03	0.020	" " 25' " " " 20"
✓ 18097	0.12	0.12	" " 40' " " " 24"
✓ 18098	0.04	0.022	" " 50' " " " 30"
✓ 18099	0.07	0.078	UPPER BELCHER ADIT 60' N. FROM R 24"
✓ 18011	0.09	0.16	UPPER BELCHER 180' NORTH FROM RAISE 30"
✓ 180112	0.04	0.035	190' 22"
✓ 180113	0.06	0.035	200' 24"
✓ 180114	0.07	0.015	210' 42"
✓ 180115	0.03	<0.003	220' 48"
✓ 180116	0.01	0.005	230' 26"
✓ 180117	0.06	0.008	240' 22"
✓ 180118	RAISE HERE 0.07	0.029	250' 48"
✓ 180119	0.04	0.011	260' 27"
✓ 180120	0.04	0.005	270' 27"
✓ 180121	0.04	0.020	280' 37"
✓ 180122	0.04	0.015	310' 59"
✓ 180123	0.03	0.019	320' 53"
✓ 180124	0.04	0.005	330' 74"
180125	0.07	0.059	LOWER SHEAR ADIT NO. 3 X CUT 2'
180126	0.03	0.005	LOWER SHEAR ADIT NO. 3 X CUT 4' BACK FROM EDGE 9" 9
180127	2.39	9.18	FLOAT FROM LOWER MAC DUMP
✓ 18100	1.71	7.00	UPPER BELCHER 70' NORTH FROM RAISE 36"
✓ 18101	0.64	2.48	" " 80' " " " 16"
✓ 18102	0.06	0.033	" " 90' " " " 37"
✓ 18103	0.10	0.13	" " 100' " " " 32"
✓ 18104	0.27	0.70	" " 110' " " " 30"
✓ 18105	END OF STONE 0.16	0.40	" " 120' " " " 30"
✓ 18106	0.04	0.075	" " 130' " " " 37"
✓ 18107	0.04	0.020	" " 140' " " " 37"
✓ 18108	0.06	0.011	" " 150' " " " 20"
✓ 18109	0.06	0.008	" " 160' " " " 18"
✓ 18110	0.06	0.069	" " 170' " " " 22"



MEMBER
CANADIAN TESTING
ASSOCIATION

P. J. Twites
REGISTERED ASSAYER, PROVINCE OF BRITISH COLUMBIA



CHEMEX LABS LTD.

212 BROOKSBANK AVE.
NORTH VANCOUVER, B.C.
CANADA
TELEPHONE: 985-0648
AREA CODE: 604

• ANALYTICAL CHEMISTS • GEOCHEMISTS • REGISTERED ASSAYERS

CERTIFICATE OF ASSAY

TO: Keywest Resources Ltd.,
#818 - 510 W. Hastings,
Vancouver, B. C.

ATTN: Mr. James Szakacs

CERTIFICATE NO. 22872
INVOICE NO. 11357
RECEIVED May 16/74
ANALYSED May 22/74

SAMPLE NO. :	Oz/Ton Silver	Oz/Ton Gold
22042		0.005
✓22043		0.015
✓22044		0.011
✓22045		0.015
✓22046		0.024
✓22047		0.33
✓22048		0.006
✓22049		0.015
✓22050		0.15 <i>Large Sample</i>
✓22051		0.011
✓22052		0.011
✓22053		0.022
✓22054		0.019
✓22055		0.004
✓22056		0.037 <i>Large Sample</i>
✓22057		0.015
✓22058		0.016
✓22059		0.011
✓22060		0.015
✓22061		0.078
✓22062		0.005
✓22063		0.008
✓22064		0.005
✓22065		0.024
✓22067		0.20
✓22068		0.019
✓22069		0.88
✓22070		0.035
22071	0.06	0.003
22072	0.07	<0.003



MEMBER
CANADIAN TESTING
ASSOCIATION

P. L. Twites
REGISTERED ASSAYER, PROVINCE OF BRITISH COLUMBIA

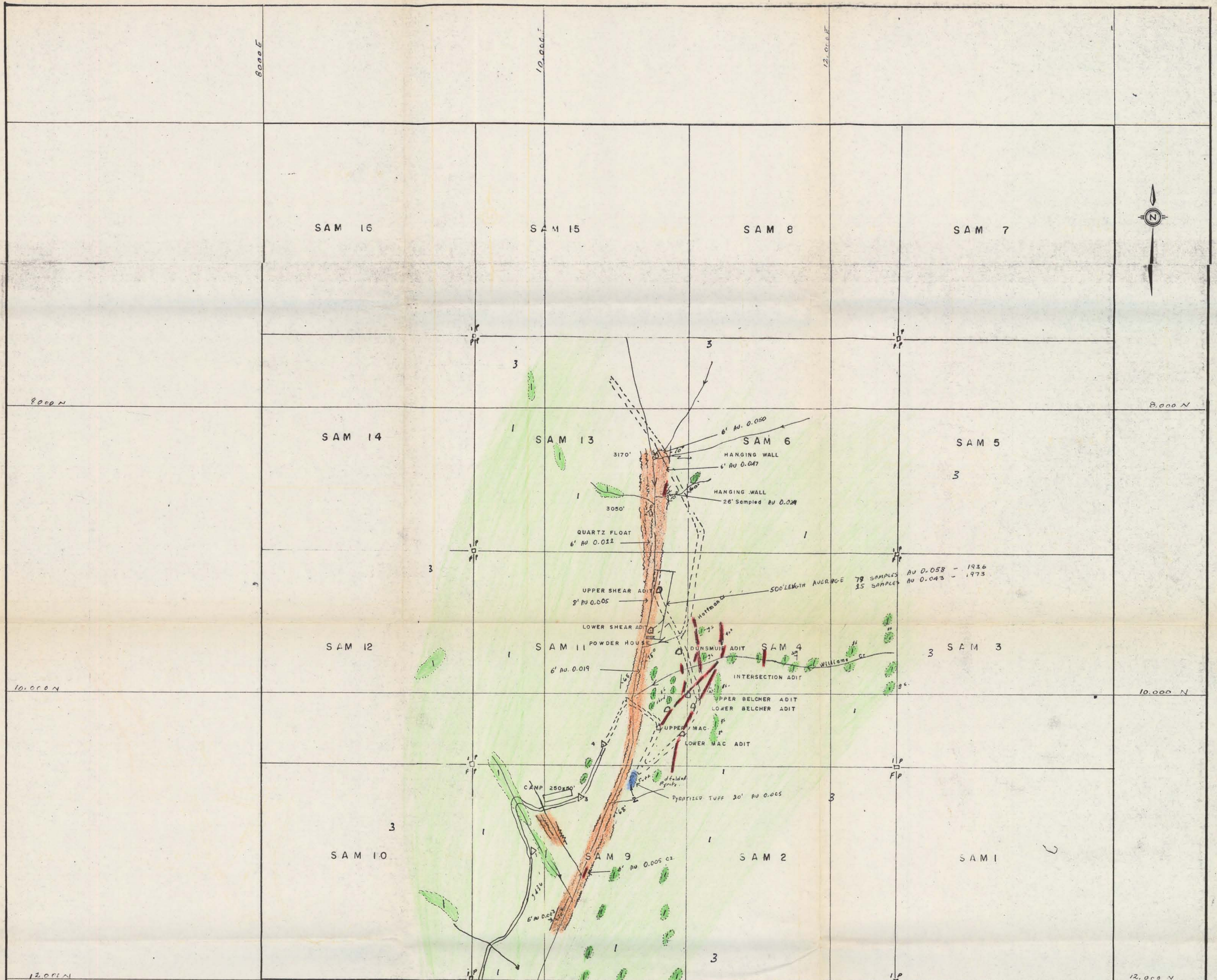

LEGEND

- QUATERNARY
PLEISTOCENE & RECENT
Glacial and alluvial deposits
- PERMIAN & EARLIER
SICKER GROUP
- 3 LIMESTONE, ARGILLITE
- 2 Greywacke, argillite, conglomerate,
banded tuff
- 1 Volcanic breccia and tuff, altered to
greenstone and greenschist; banded tuff, chert
- QUARTZ VEIN
- SHEAR
- BEDDING DIP & STRIKE
- OUTCROP
- ROAD, BUILDING

FROM	TO	FEET
BREAK	4	3436
"	4	N END 4276
"	"	WIDTH 10'

Department of
Mines and Petroleum Resources
ASSESSMENT REPORT
NO. 5443 MAP 1
GEOLOGY MAP



KEYWEST RESOURCES LTD (N-P-L)

SAM GROUP 5443
ALBERNI M-D, B-C MAP 1
SCALE 1" = 400'

MARCH 1974

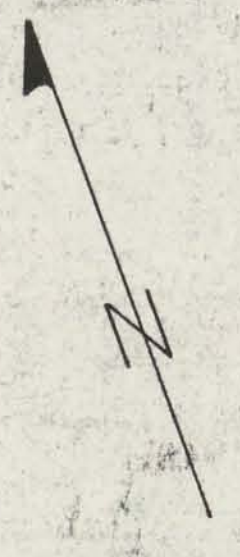

Dunsmuir Adit

Williams Cr

Mineral Creek

Lower Belcher Adit

Lower Mac Adit

3000 EL

2500 EL

2800 EL

2700 EL

2600 EL

Compressor House



LEGEND

Quartz Vein
Stoped
Shear

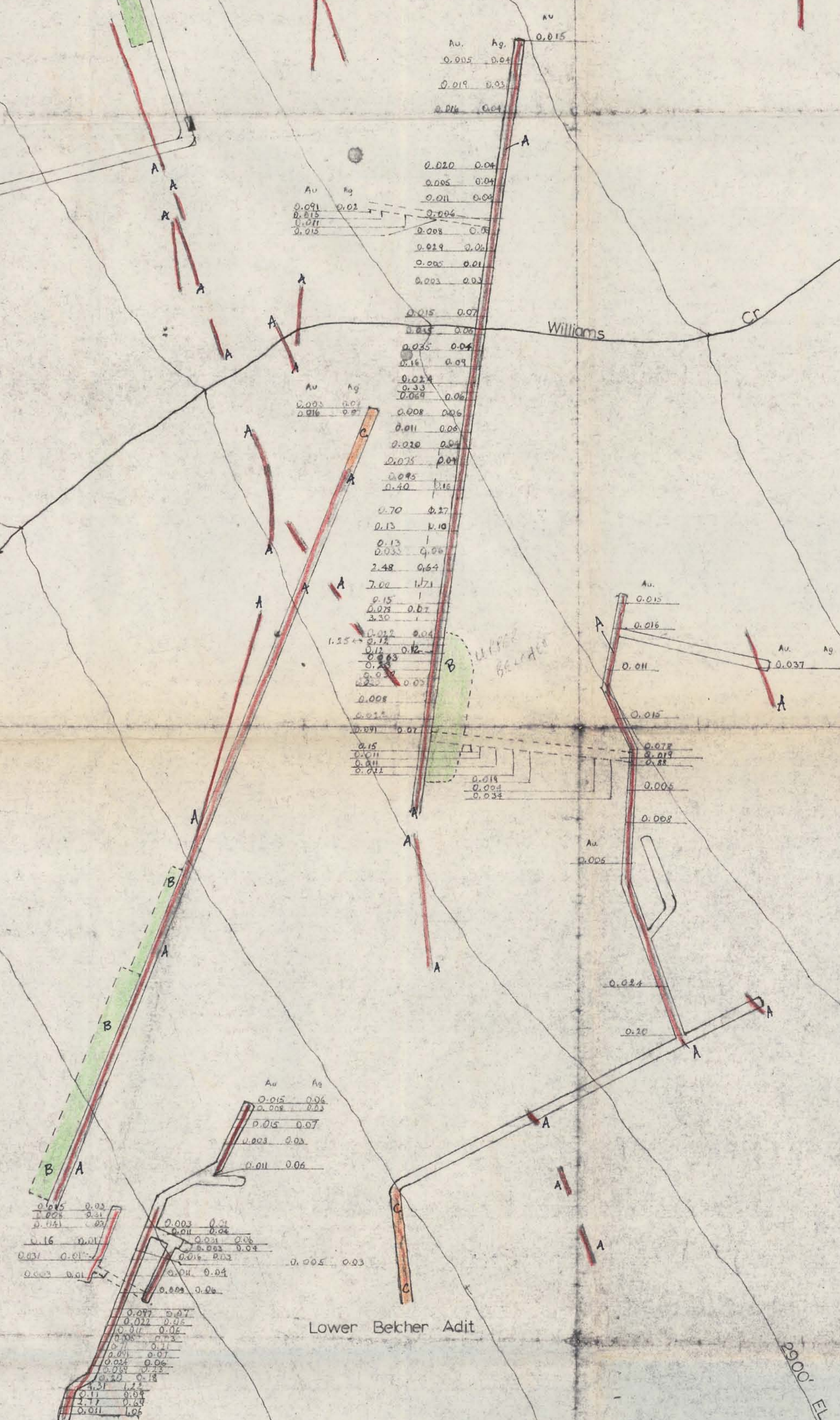
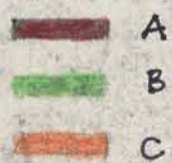

ASSAY MAP
KEYWEST RESOURCES LTD (NPL)
SAM GROUP
ALBERNI M.D. BC

SCALE

1 Inch to 40 Feet

5443
MAP 2



Department of
Mines and Petroleum Resources
ASSESSMENT REPORT
NO. 5443 MAP 2