

5493

Department of
Mines and Petroleum Resources
ASSESSMENT REPORT

REPORT

- on -

NO. 5493 MAP

DIAMOND DRILLING PROGRAMME

104P/5E

- on the -

DORCHESTER GOLD PROPERTY

CASSIAR DISTRICT

LIARD MINING DIVISION

BRITISH COLUMBIA

- for -

DORCHESTER RESOURCES LTD. (N.P.L.),

#1100 - 235 First Avenue,

KAMLOOPS, B. C.

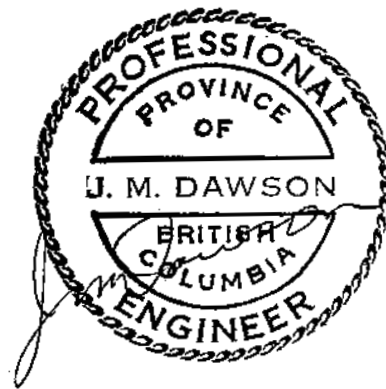

COVERING:

Copco #1 - #6 inc., Roy #1 - #4 inc., Roy Fraction,
Tod #7 - #8 inc., Atlas #1 - #11 inc., Atlas #12
Fraction, Thrush, Dor #1.

WORK PERFORMED:

April 9th. - June 28th., 1975.

LOCATED:

59° 16' N, 129° 42' W.

NTS Map 104 P/5 E.

On Quartzrock Creek, 5 miles east of Cassiar, B. C.

PREPARED BY:

Kerr, Dawson & Associates Ltd.,
#1 - 219 Victoria Street,
KAMLOOPS, B. C.
J. M. Dawson, P. Eng.,
June 28th., 1975.

TABLE OF CONTENTS

| | <u>Page No.</u> |
|--|-----------------|
| INTRODUCTION | 1 |
| PROPERTY | 1 |
| LOCATION AND ACCESS | 2 |
| PHYSIOGRAPHY, VEGETATION AND CLIMATE | 3 |
| HISTORY | 3 |
| SCOPE OF THE PRESENT PROGRAMME | 5 |
| GEOLOGY | 6 |
| MINERALIZATION | 7 |
| DISCUSSION OF DRILLING RESULTS | 9 |
| SUMMARY AND CONCLUSIONS | 12 |

APPENDICES

- Appendix A - Personnel
- Appendix B - Statement of Expenditures
- Appendix C - Affidavit in Support of Statement
of Expenditures
- Appendix D - Drill Logs
- Appendix E - Assay Results
- Appendix F - References
- Appendix G - Writer's Certificate
- Appendix H - Maps:
- #1 Figure #107 - 1 Location Map
 - #2 Figure #107 - 2 Claim Map
 - 3 Figure #107 - 3 Plan of Underground
Workings and Location
of Drill Holes.
 - 4 Figure #107 - 4 Assay Plan-Drill Hole 75-1.
 - 5 Figure #107 - 5 Assay Plan-Drill Hole 75-2.
 - 6 Figure #107 - 6 Assay Plan-Drill Hole 75-3.

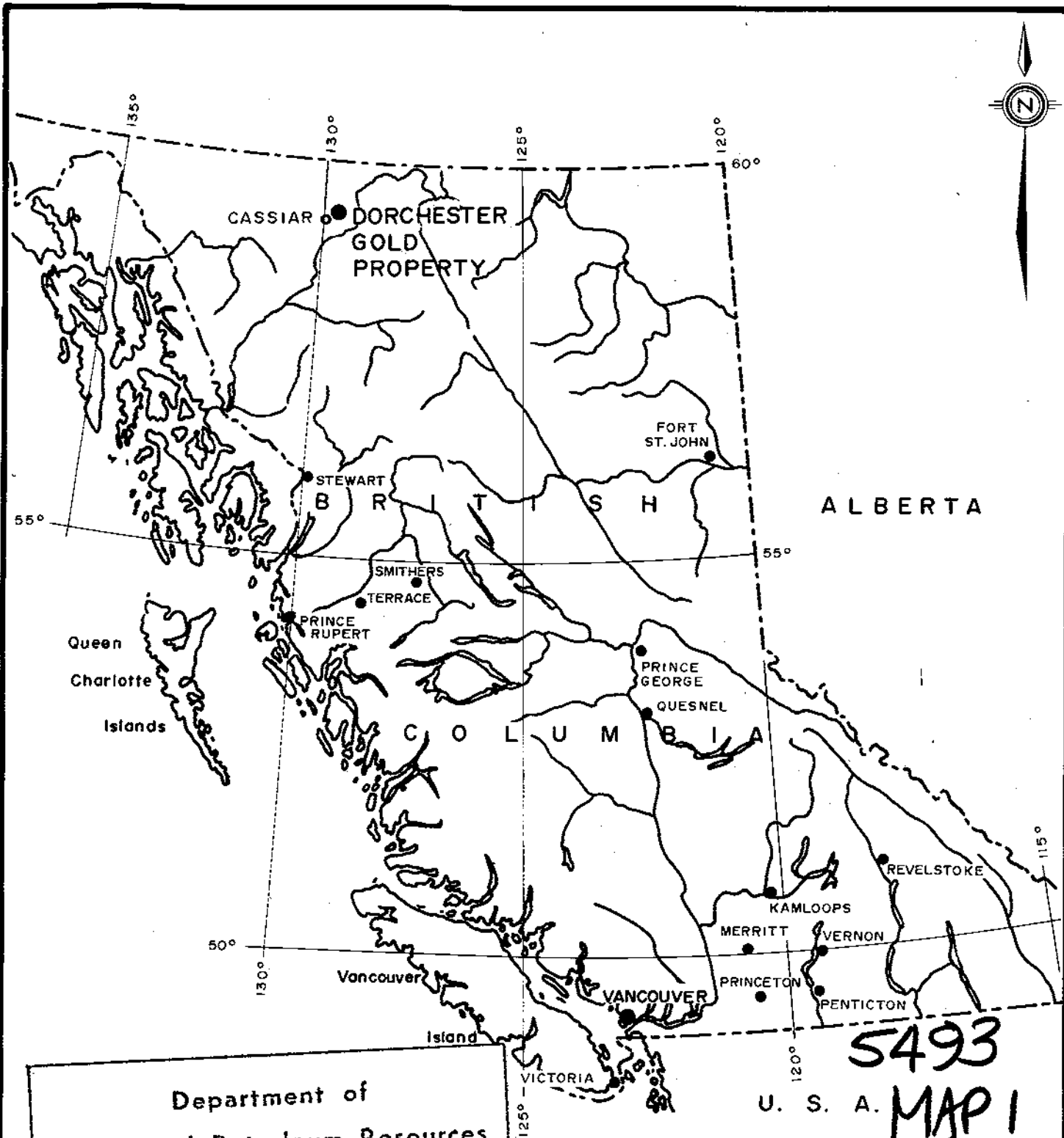

Department of
 Mines and Petroleum Resources
 ASSESSMENT REPORT
 NO. **5493** MAP **1**

DORCHESTER RESOURCES LTD. (N.P.L.)
 LOCATION MAP
 DORCHESTER GOLD PROPERTY
 CASSIAR DISTRICT
 LIARD MINING DIVISION -
 BRITISH COLUMBIA

| | |
|--|------------------------|
| DATE : June 5, 1975 | SCALE : 1" = 138 Miles |
| TECH. WORK BY: Kerr - Dawson & Assoc. | DWG. No. 107 - 1 |

To Accompany A Report By J. M. DAWSON, P. Eng.

INTRODUCTION

This report has been prepared at the request of Mr. M. M. Rahal, president of Dorchester Resources Ltd. (N.P.L.). It describes the results of an underground drilling programme carried out at the Dorchester gold property near Cassiar, B. C. during the spring of 1975.

Because the outer parts of the tunnel system were filled with ice, approximately one month was spent by a 2 to 3 man crew removing ice so that access could be gained to the proposed drill sites. From May 14th. to June 8th., 744 feet of diamond drilling was completed in three BQ sized holes. The core was logged and selected sections were split and submitted for Assay.

A series of maps showing property location, claims, underground workings and location of drill holes were prepared and are appended along with the drill logs in this report.

PROPERTY

The property consists of 27 claims as follows:

| <u>Claim Name</u> | <u>Record No.</u> | <u>Rental Paid to</u> | <u>Work Recorded to</u> |
|-------------------|-------------------|-----------------------|-------------------------|
| Copco #1 | 8213 | Sept. 29/75 | Sept. 29/82 |
| Copco #2 | 8214 | Sept. 29/75 | Sept. 29/82 |
| Copco #3 | 8215 | Sept. 29/75 | Sept. 29/81 |
| Copco #4 | 8216 | Sept. 29/75 | Sept. 29/81 |
| Copco #5 | 8217 | Sept. 29/75 | Sept. 29/81 |
| Copco #6 | 8218 | Sept. 29/75 | Sept. 29/81 |

| <u>Claim Name</u> | <u>Record No.</u> | <u>Rental Paid to</u> | <u>Work Recorded to</u> |
|--------------------|-------------------|-----------------------|-------------------------|
| Roy #1 - | 55511 - | Sept. 14/75 | Sept. 14/75 |
| Roy #4 inc. | 55514 inc. | | |
| Roy Fraction | 8515 | July 11/75 | July 11/82 |
| Tod #7 | 57648 N | Oct. 20/75 | Oct. 20/81 |
| Tod #8 | 57649 N | Oct. 20/75 | Oct. 20/81 |
| Atlas #1 - | 69566 - | Mar. 21/76 | Mar. 21/76 |
| Atlas #11 inc. | 69576 inc. | | |
| Atlas #12 Fraction | 69577 | Mar. 21/76 | Mar. 21/76 |
| Thrush | 7329 M | Sept. 11/75 | Sept. 11/81 |
| Dor #1 | 69692 | April 13/76 | April 13/76 |

The registered owner is Dorchester Resources Ltd.
(N. P. L.), F. M. C. No. 136707.

LOCATION AND ACCESS

The property is located in northern British Columbia, about 5 miles east of the town of Cassiar in the Liard Mining Division. The approximate geographic co-ordinates are 59° 16' north latitude and 129° 42' west longitude.

The claims are accessible by road from Cassiar, or from Watson Lake, Yukon Territory, which is located approximately 95 road miles to the NNE. A 1/4 mile spur road runs north just east of the Quartzrock Creek bridge

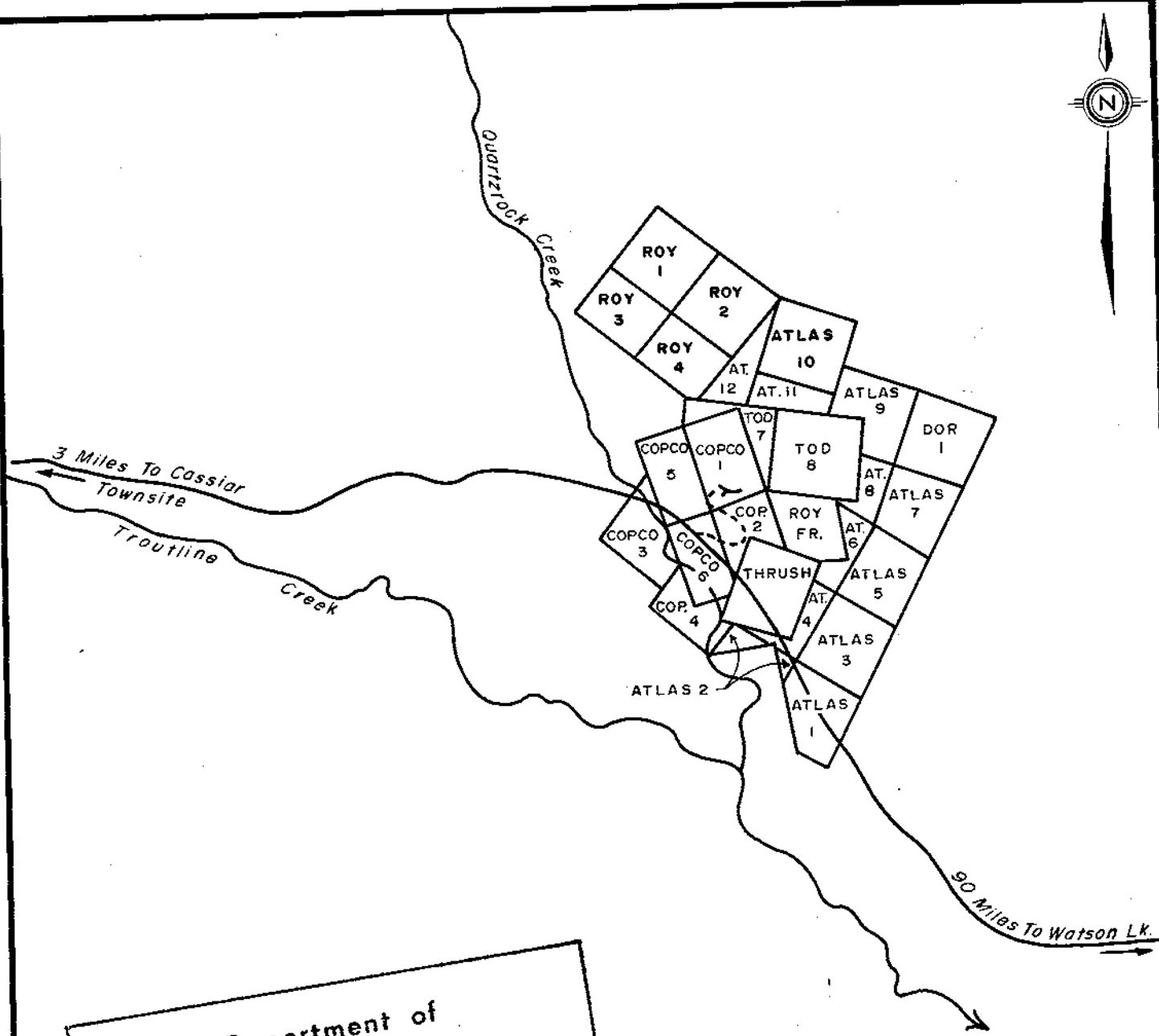

Department of
 Mines and Petroleum Resources
 ASSESSMENT REPORT
 NO. 5493 MAP 2

5493
 MAP 2

| | |
|---|-------------------|
| DORCHESTER RESOURCES LTD. (N.P.L.) | |
| CLAIM MAP | |
| DORCHESTER GOLD PROPERTY CASSIAR DISTRICT LIARD MINING DIVISION - BRITISH COLUMBIA | |
| DATE: June 5, 1975 | SCALE: 1" = 3000' |
| TECH. WORK BY: Kerr - Dawson & Assoc. | DWG. No. 107 - 2 |

To Accompany A Report By J. M. DAWSON, P. Eng.

to the main mine portal. Watson Lake has daily air service with Vancouver via C. P. Air. A gravel strip at Cassiar can accomodate light aircraft during daylight hours.

PHYSIOGRAPHY, VEGETATION AND CLIMATE

The property is located on parts of a gentle southwest - sloping hillside in the valley containing Quartzrock Creek. Local elevations on the claims vary from 3,500 to 4,000 feet A. S. L.; however, the regional topography is quite mountainous, the peak of Mount Robertson rising to about 6,500 feet A. S. L. about 2 miles to the northeast.

The property is covered by a moderate to heavy growth of pine, fir and spruce with scattered deciduous underbrush. Climate is typical of northern British Columbia and the Yukon with long cold winters and snow at any month of the year. The property is generally snow-free at the end of May because of its low elevation and southerly exposure and surface work can be carried out from June to September.

HISTORY

Mining activity began in this region in 1874 when placer gold was discovered in McDame Creek. Total value of placer production from this region is estimated to be about \$2,000,000.00. The placer gold is undoubtedly

derived from the known gold - bearing quartz veins which occur in the Table Mountain - Quartzrock Creek area.

The subject property was originally staked as the Cornucopia Group in 1935. It was sold to Benroy Gold Mines Ltd. in 1946. This company carried out surface stripping and diamond drilling during the 1940's and 1950's but allowed the claims to lapse in 1961.

In 1961, the property was staked by local prospectors who set up a small mill and did some surface high-grading from what is now known as the Upper Adit. It is reported that about 150 oz. of gold were recovered from approximately 100 tons of ore treated.

The property was purchased in 1961 by Hanna Gold Mines and an underground exploration programme was initiated. Hanna completed approximately 3,000 feet of lateral underground development and 2,800 feet of underground diamond drilling prior to 1964. Surface work including trenching and sampling was also carried out by Hanna. In 1964 the property was optioned by Newconnex Canadian Exploration Ltd. and a further surface and underground programme was completed. Because of the prevailing price of gold, Newconnex declined to place the property into production and no further work was carried out until the company was reorganized as Dorchester Resources Ltd. in 1972.

Limited surface and underground sampling was carried out by Dorchester in 1973 and 1974. In addition,

underground sampling was done by Rio Tinto Canadian Exploration Ltd. during the summer of 1973.

SCOPE OF THE PRESENT EXPLORATION PROGRAMME

The present programme was initiated to test various areas of the property where previous drilling and sampling indicated higher values in quartz veins, and where it was thought that wider zones of possible economic grade might be encountered.

Upon examination of the underground workings in early April, 1975, it was found that the first 350 feet of the main drift was filled with ice. Approximately one month was spent removing this ice to a point just beyond the 220 cross-cut south. Because of the expense entailed in removing this ice, the projected drilling programme had to be curtailed.

The originally proposed programme called for the drilling of 10 holes aggregating about 1,600 feet in holes varying from 70 to 350 feet long. This drilling was to confirm and extend areas of mineralization outlined by underground sampling of a number of veins as well as to redrill the area near DDH No. 4 (see figure #107-3). Drill hole No. 4 was drilled in 1964 and because of poor recovery, sludge values were assayed in some of the mineralized zones.

Time did not permit the removal of ice as far as the 350 cross-cut north (site of the collar of DDH No. 4), so the bulk of the present drilling was done from the 196 cross-cut north. Two drill holes aggregating 623 feet were drilled from a point near the face of this cross-cut. One drill hole totalling 121 feet was drilled from the 220 cross-cut south to test the vein exposed in the main drift just inside the portal (see figure #107-3).

A slash was taken from the back about 60 feet inside the portal along the main drift. Three samples were taken from this material and the results are included in Appendix E.

GEOLOGY

The Dorchester property is underlain by rocks of the Middle Paleozoic Sylvester Group. This group consists of a sequence of mixed volcanics and detrital sediments with subordinate limestone and chert. At the Dorchester property the rocks consist primarily of andesite flows and tuffs. The flows are medium to fine grained, dark green to grayish andesites which are finely porphyritic and vesicular in part. Lesser amounts of fragmental rocks contain angular to sub-rounded andesite fragments up to 1 cm. in diameter in a matrix of similar material. Where the volcanics have been oxidized in surface trenches and on the mine dump, they frequently have a distinctive orange-brown coloration.

Numerous easterly-striking quartz veins are emplaced within the andesite. These veins usually dip moderately to steeply south and vary from more than four feet, to less than one inch in width. A number of calcite veinlets and stringers also have this same orientation. The quartz veins pinch, swell and horsetail along strike.

Later faulting and brecciation has caused considerable dislocation of the veins and vein systems. Post mineral faulting along the veins has caused brecciation, gouge and horses of waste within some systems. Several sets of transverse faults frequently displace the veins for short distances. Several zones of shattering and brecciation were noted within the drill holes.

MINERALIZATION

Pyrite is found as scattered discrete masses of subhedral to euhedral crystals within the host rock adjacent to quartz veins and as very fine grained material in stringers and clots along fractures and seams and as fillings in some of the interstices in brecciated zones. Minor fine grained tetrahedrite and traces of chalcopyrite are sometimes found associated with the fine grained pyrite in areas of shearing and brecciation.

In some of the quartz veins pyrite and minor arsenopyrite occur as stringers and semi-massive lenses as much as 6" wide. Previous workers have noted native gold in flakes within the quartz and in contact with the sulphides. However, the only free gold seen by the writer was in quartz on some of the dumps from previous high grading in near surface workings. In the extensive work carried out by Newconnex it was determined that minor sphalerite often indicated strong gold values.

According to Phelps (1973) "six gold-bearing veins have been located by underground exploration. A seventh vein is the faulted offset segment of one of the first six. There are many more gold-bearing veins which were exposed on surface by the Hanna and Newconnex surface exploration programmes, and have not been explored by underground development. The high gold to silver ratio within the gold itself indicates that the mineralization may have a deep-seated hypothermal or mesothermal origin. The very strong hydrothermal alteration which accompanied the emplacement of the gold-bearing veins is evidence that the mineralization may be expected to extend for a considerable distance both laterally and vertically wherever the structure was favourable for deposition.

Extensive dolomitic alteration of the wall rock accompanied the mineralization. The alteration is gradational from occasional dolomitic patches away from the vein to intense massive dolomite at the vein contacts. The strong alteration zones are characterized by a bleached appearance and light gray to buff colouring. The dolomitic alteration is often accompanied by

sufficient disseminated pyrite adjacent to the veins to give assays of ore grade."

DISCUSSION OF DRILLING RESULTS

A total of 744' of BQ size core drilling was carried out from two stations in the underground workings (see figure #107-3). Core recovery was excellent in all holes, even in sections of highly sheared and brecciated rock and averaged more than 97% for all three holes.

Drill hole No. 75-1 was drilled at an oblique angle under the quartz vein exposed near the portal in the main drift. Rock encountered in the drill hole was primarily dark, greenish-gray andesite which is bleached to pale grayish and brecciated in some short sections, particularly on either side of the 5 foot quartz vein intersection from 72.2' to 77.5'. In such areas of altered rock scattered pyrite is usually present both as large euhedral crystals and as very fine grained material in stringers and filling interstices in brecciated zones. Minor fine grained tetrahedrite is sometimes mixed with the fine grained pyrite. The quartz vein contained sporadic stringers and clumps of pyrite up to 1" wide, however no arsenopyrite or free gold was noted.

A section containing the bulk of the quartz vein, from 72' - 77' assayed 0.33 oz. Au/Ton and 0.07 oz. Ag/Ton. A 5 foot section of hanging wall material adjacent to the quartz vein (67'-72') assayed 0.03 oz. Au/Ton and 0.01 oz. Ag/Ton. The foot wall section was better mineralized (see

drill log of hole 75-1), and a 20 foot intersection assayed 0.074 oz. Au/Ton and 0.027 oz. Ag/Ton. It should be emphasized that the true width would be slightly less than half the length of this intersection.

Drill hole #75-2 was drilled due north from a point near the face of the 196 cross-cut north (see figure #107-3). The purpose of this hole was to test the on strike projection of high values encountered in DDH No. 4 which was drilled from the 350 cross-cut north.

The bulk of the rock encountered in this drill hole is dark greenish gray andesite, finely porphyritic in part. Thin quartz veins and stringers (varying from 5" to less than 1") are common throughout the hole; some bleaching and chloritization of andesite is common near these veins. Scattered thin seams and veinlets of calcite are not uncommon. Most of the quartz veins are barren; however, minor pyrite, tetrahedrite and occasionally chalcopyrite may sometimes be seen in the nearby wall rock.

From 264 to 319 feet a fairly strong zone of pale gray, bleached, brecciated and sheared volcanics contains frequent stringers and fracture fillings of very fine grained pyrite; minor tetrahedrite usually accompanies this pyrite. In some areas 4" to 2' sections of almost massive pyrite were noted.

In this hole, five foot samples of split core were taken from the entire section between 94' and 324' (see figure #107-5). In general, assays from this hole were low even though a strong altered, mineralized zone

was encountered. The best 5 foot section assayed 0.055 oz. Au, 0.04 oz. Ag per ton.

Drill hole #75 - 3 was drilled from the same set - up as #75 - 2, but was inclined easterly to again test the possible extensions of mineralization reported from DDH No. 4.

The rock encountered in this hole is primarily dark, greenish gray andesite which contains scattered narrow barren quartz veins. A few narrow bleached and brecciated sections were encountered, but generally the sulphide content is much lower than that encountered in drill hole #75 - 2. Minor tetrahedrite and traces of chalcopyrite occur adjacent to some quartz stringers. A section of bleached and brecciated andesite was encountered between 119 to 159 feet. Scattered fine grained pyrite in thin stringers and blebs, as well as traces of arsenopyrite and chalcopyrite were noted in this section.

Because the mineralization was much less intense in this hole than in hole #75 - 2, only a few selected sections were split and submitted for assay. Generally the values were very low. The best 5 foot section assayed 0.04 oz. Au and 0.02 oz. Ag per ton. The bleached and brecciated section between 119 to 159 feet ran very low, the best five foot sections assaying only 0.005 oz. Au and 0.01 oz. Ag per ton.

A five ton slash across the width of the main drift was taken from the back about 60 feet from the portal.

Two representative samples were taken from the material and assayed respectively: 0.15 oz. Au, 0.02 oz. Ag per ton and 0.13 oz. Au, 0.03 oz. Ag per ton. A selected sample of vein quartz carrying heavy sulphides - primarily pyrite with traces of arsenopyrite assayed 0.60 oz. Au, 0.20 oz. Ag per ton.

SUMMARY AND CONCLUSIONS

- (1). The Dorchester Gold Property consists of 27 contiguous located claims, located about 5 miles east of the town of Cassiar in the Liard Mining Division. The property is less than 1/2 mile by road from the main Cassiar - Watson Lake highway.
- (2). The property was first staked in 1935 and sporadic exploration was carried out until 1946 when it was acquired by Benroy Gold Mines. This company carried out surface stripping and diamond drilling in the late 1940's and 1950's, but allowed the claims to lapse in 1961. In 1961, some minor high grading was carried out from surface cuts and about 150 oz. of gold was recovered. Hanna Gold Mines acquired the property in 1961 and did extensive underground drifting and diamond drilling. The property was optioned in 1964 by Newconnex Canadian Exploration which company carried out further surface and underground exploration but declined to put the property into production. Hanna Gold Mines was reorganized as Dorchester Resources Ltd. in 1972 and further limited sampling programmes were carried out in 1973 and 1974. In an attempt to verify some of the previous work, Dorchester carried out a limited programme of underground drilling in May and June, 1975.

- (3). The subject property is underlain predominantly by dark greenish gray andesites of the Middle Paleozoic Sylvester Group. These rocks are cut by numerous easterly trending quartz veins and stringers which dip moderately to steeply south. Later faulting has greatly complicated the continuity of the quartz veins. Bleaching, brecciation and dolomitization is common in the vicinity of the quartz veins - at least six of which have been explored in some detail and are known to be gold - bearing.
- (4). Most of the narrow quartz veins are barren; however, a number of the wider ones (1 - 4 feet wide) are mineralized with stringers and clumps of sulphides. The bulk of the sulphides is pyrite; however, minor arsenopyrite and tetrahedrite are sometimes present. Free gold has been reported from some of the veins; however, none was identified by the writer.
- (5). The present programme consisted of three 3Q sized drill holes from two underground set-ups. Hole #75 - 1 was drilled to 121 feet under the vein exposed in the main drift near the portal. It encountered a 5 foot intersection of quartz with five feet of sparse mineralization on the hanging wall and a further 20 feet of scattered mineralization on the foot wall of the vein. This hole was drilled oblique to the vein and a true width would be somewhat less than half the drill - indicated width.

Holes #75 - 2 and #75 - 3 were drilled near the face of the 196 cross-cut north and encountered some zones of bleached and brecciated andesite which carried scattered to heavy pyrite, with minor tetrahedrite.

- (6). In general, low values in gold and silver were encountered in all three holes and the programme did not succeed in verifying the results obtained from drill hole No. 4, drilled by Newconnex in 1964.

Respectfully submitted:

KERR, DAWSON & ASSOCIATES LTD.,



James M. Dawson

James M. Dawson, P. Eng.,
GEOLOGIST

KAMLOOPS, B. C.,
June 28th., 1975.

A P P E N D I X A

PERSONNEL

PERSONNEL

Field:

J. M. Dawson, P. Eng., Geologist:

April 16, 17, 29, 30, 1975
May 1 - May 31, 1975
June 7 - June 11, 1975 ----- 40 days

J. Hope, Miner:

April 5 - April 14, 1975 ----- 10 days

Bill Elsner, Fieldman:

April 5 - April 18, 1975 ----- 13.5 days

Jay Warsell, Fieldman:

April 5 - April 10, 1975 ----- 6 days

Ron Schmidt, Fieldman:

April 18 - April 30, 1975
May 1 - May 12, 1975 ----- 25 days

Don Fullmer, Fieldman:

April 24 - April 30, 1975
May 1 - May 4, 1975 ----- 11 days

Jim McIntire, Fieldman:

May 6 - May 12, 1975 ----- 7 days

OFFICE: J. M. Dawson, P. Eng., Geologist:

June 24 - June 28, 1975 ----- 5 days

A P P E N D I X B

STATEMENT OF EXPENDITURES

PROGRAMME COSTS

- on -

DORCHESTER GOLD PROPERTY

(1). Labour:

| | | |
|-----------------------------|-------|---------------|
| 1 geologist | | |
| 45 days @ \$100.00 per day | ----- | \$4,500.00 |
| 1 miner | | |
| 10 days @ \$50.00 per day | ----- | 500.00 |
| 1 fieldman | | |
| 13.5 days @ \$48.00 per day | ----- | 648.00 |
| 1 fieldman | | |
| 6 days @ \$48.00 per day | ----- | 288.00 |
| 1 fieldman | | |
| 25 days @ \$48.00 per day | ----- | 1,200.00 |
| 1 fieldman | | |
| 11 days @ \$48.00 per day | ----- | 528.00 |
| 1 fieldman | | |
| 7 days @ \$48.00 per day | ----- | <u>336.00</u> |
| | | \$8,000.00 |

(2). Contract Diamond Drilling:

| | | |
|-----------------------------|-------|------------|
| 744 feet @ \$10.00 per foot | ----- | 7,440.00 ✓ |
|-----------------------------|-------|------------|

(3). Expenses and Disbursements:

| | | |
|---|-------|---------------|
| (a). Truck Rental | ----- | \$ 721.70 |
| (b). Compressor Rental | ----- | 1,800.00 |
| (c). Room and Board | ----- | 1,240.00 |
| (d). Fuels and lubes | ----- | 2,181.79 |
| (e). Rental of light plant and steam heating plant | ----- | 1,300.00 |
| (f). Travel | ----- | 576.40 |
| (g). Powder, fuse, and primacord | ---- | 321.75 |
| (h). Assays | ----- | 619.50 |
| (i). Telephone, freight, xerox, blueprints and secretarial | ---- | <u>445.60</u> |
| | | 9,206.64 |

TOTAL ----- \$24,646.64

A P P E N D I X C

AFFIDAVIT IN SUPPORT OF STATEMENT OF EXPENDITURES

C A N A D A

Province of British Columbia

TO WIT:

)
)
)
)
)
)

IN THE MATTER OF the Statement
of Expenditures for Diamond
Drilling on the Dorchester Gold
Property in the Liard Mining
Division.

I, JAMES M. DAWSON, geologist of 2753 Sunset Drive, in
the City of Kamloops, in the Province of British Columbia

DO SOLEMNLY DECLARE:

- (1). THAT the diamond drilling programme on the Dorchester Gold Property was carried out under my direction.
- (2). THAT the Statement of Expenditures set out in Appendix B of my report entitled "Report on Diamond Drilling Programme on the Dorchester Gold Property" dated April 9th. to June 28th., 1975 truly represents the amount expended on diamond drilling of the said claims.

AND I make this solemn declaration conscientiously believing it to be true and knowing that it is of the same force and effect as if made under oath and by virtue of the Canada Evidence Act.

DECLARED before me at the City)
of Kamloops, in the Province)
of British Columbia, this 26th.)
day of June, A. D., 1975.)
)
)
)

A COMMISSIONER for taking Affidavits
for British Columbia.

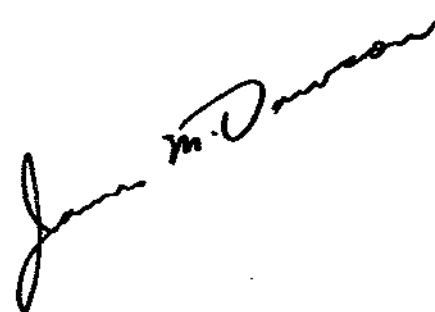

A P P E N D I X D

DRILL LOGS

KERR-DAWSON & ASSOCIATES LTD. - DIAMOND DRILL RECORD

Suite 1 - 219 Victoria St.
Kamloops, B.C.
Phone 374-0544

PROPERTY Dorchester Resources

HOLE No. 75 - 1

| DIP AND AZIMUTH TEST | | |
|----------------------|-------|---------|
| Corrected | | |
| Footage | Angle | Azimuth |
| | | |
| | | |
| | | |

Core Size BQ
 Angle of Hole -35
 Claim.....
 Section.....
 Bearing 287° T

Total Depth 121
 % Recovery.....
 Elev. Collar.....
 Latitude.....
 Departure.....

Sheet No 1 of 7
 Logged by James M. Dawson
 Date Begun 15/5/75
 Date Finished.....
 Core Stored At.....

| DEPTH | CORE LOST | DESCRIPTION | SAMPLE No. | WIDTH of SAMPLE | | | | |
|----------|-----------|--|------------|-----------------|--|--|--|--|
| | | Casing to 8 feet, started coring at 3'. | | | | | | |
| 3 - 4 | 0 | Hard, fine grained, grayish andesite; very finely porphyritic in part; minor fine grained disseminated pyrite in euhedral cubes. | | | | | | |
| 4 - 6 | 0 | Similar to last section; porphyry texture more pronounced; pyrite in some rehealed fracture zones. | | | | | | |
| 6 - 8 | 2" | Similar to last section; minor shearing 2" fault gouge near beginning of section. | | | | | | |
| 8 - 9.5 | 0 | Dark gray to black andesite - finely porphyritic in part. | | | | | | |
| 9.5 - 11 | 0 | Similar to last section; some fracturing and silicification with quartz and jasper in first 10" of section. | | | | | | |
| 11-12.5 | 8" | Dark gray andesite as before. | | | | | | |
| 12.5-14 | 0 | Similar to last section. | | | | | | |

KERR—DAWSON & ASSOCIATES LTD. - DIAMOND DRILL RECORD

Suite 1 - 219 Victoria St.
Kamloops, B.C.
Phone 374-0544

PROPERTY..... Dorchester Resources

HOLE No. 75 - 1

| DIP AND AZIMUTH TEST | | |
|----------------------|-------|---------|
| Corrected | | |
| Footage | Angle | Azimuth |
| | | |
| | | |
| | | |
| | | |

Core Size BQ

Angle of Hole -35

Claim.....

Section.....

Bearing 287°T

Total Depth.....

% Recovery.....

Elev. Collar.....

Latitude.....

Departure.....

Sheet No. 2 of 7

Logged by James M. Dawson

Date Begun 15/5/75

Date Finished.....

Core Stored At.....

| DEPTH | CORE LOST | DESCRIPTION | SAMPLE No. | WIDTH of SAMPLE | | | | |
|---------|-----------|---|------------|-----------------|--|--|--|--|
| 14 - 17 | 0 | Dark gray, finely porphyritic andesite, becoming light greenish gray in colour in last 15" of section, minor pyrite blebs. | | | | | | |
| 17 - 22 | 0 | Light greenish-gray andesite; minor tiny quartz and calcite veinlets; pyrite common as stringers and disseminated grains; 2" veinlet of quartz @ 21.3 @ 15° to core axis. | | | | | | |
| 22-27 | 4" | Similar to last section; calcite veining from 24' to 25'; minor f.g. pyrite in thin stringers. | | | | | | |
| 27-29 | 2" | Similar to last section; minor calcite veining. | | | | | | |
| 29-30 | 0 | Similar to last section. | | | | | | |
| 30-35 | 3" | Light gray, fine dense silicified andesite? Minor calcite veining, some areas of brecciation & rehealing; very fine grained pyrite in narrow stringers and in some of interstices in breccia. | | | | | | |

KERR—DAWSON & ASSOCIATES LTD. - DIAMOND DRILL RECORD

Suite 1 - 219 Victoria St.
Kamloops, B.C.
Phone 374-0544

PROPERTY.....Dorchester Resources.....

HOLE No.75 - 1.....

| DIP AND AZIMUTH TEST | | |
|----------------------|-------|---------|
| Corrected | | |
| Footage | Angle | Azimuth |
| | | |
| | | |
| | | |

Core SizeBQ.....
 Angle of Hole-35.....
 Claim.....
 Section.....
 Bearing287°T.....

Total Depth.....
 % Recovery.....
 Elev. Collar.....
 Latitude.....
 Departure.....

Sheet No. 3 of 7
 Logged by James M. Dawson
 Date Begun 15/5/75
 Date Finished.....
 Core Stored At.....

| DEPTH | CORE LOST | DESCRIPTION | SAMPLE No. | WIDTH of SAMPLE | | | | |
|-------|-----------|---|------------|-----------------|--|--|--|--|
| 35-37 | 0 | Pale gray andesite? from 35.5 - 36.4 many stringers and blebs of pyrite, lesser blebs and grains of tetrahedrite? from 36.9 - 37 barren, milky quartz. | | | | | | |
| 37-42 | 0 | From 37-38.2 barren, white quartz vein; minor inclusions of wall rock; 38.2-39.4 pale gray silicified andesite? with frequent thin stringers of f.g. pyrite, 39.4-40.7 vein of white quartz with minor inclusions of wall rock always accompanied by stringers of fine grained pyrite; 40.7-42 fine grained, pale gray andesite? with frequent stringers of pyrite; traces of tetrahedrite, stringers of quartz from 41.3-42 ≈ parallel to core axis. | | | | | | |
| 42-46 | 0 | Pale gray andesite; brecciated in part; scattered pyrite in stringers and as isolated grains. | | | | | | |
| 46-47 | 5" | Similar to last section; no visible pyrite. | | | | | | |
| 47-52 | 0 | Fine grained, grayish andesite - brecciated in some sections; minor quartz veinlets, sporadic | | | | | | |

KERR-DAWSON & ASSOCIATES LTD. - DIAMOND DRILL RECORD

Suite 1 - 219 Victoria St.
Kamloops, B.C.
Phone 374-0544

PROPERTY Dorchester Resources

HOLE No. 75 - 1

| DIP AND AZIMUTH TEST | | |
|----------------------|-------|---------|
| Corrected | | |
| Footage | Angle | Azimuth |
| | | |
| | | |
| | | |

Core Size BQ
 Angle of Hole -35
 Claim.....
 Section.....
 Bearing 287°T

Total Depth.....
 % Recovery.....
 Elev. Collar.....
 Latitude.....
 Departure.....

Sheet No 4 of 7
 Logged by James M. Dawson
 Date Begun 15/5/75
 Date Finished.....
 Core Stored At.....

| DEPTH | CORE LOST | DESCRIPTION | SAMPLE No. | WIDTH of SAMPLE | | | | |
|-------|-----------|---|------------|-----------------|--|--|--|--|
| | | pyrite in thin stringers and as larger isolated grains; whole section is slightly calcareous probably due to tiny calcite veinlets. | | | | | | |
| 52-57 | 2" | From 52 to 52.2 similar to last section; from 52.2-52.9 white quartz vein with minor altered wall rock and accompanying f.g. pyrite; from 52.9 to 57 pale gray andesite with scattered stringers and grains of pyrite; last one foot section highly shattered - fault zone? | | | | | | |
| 57-62 | 4" | f.g. grayish andesite; first 15" section is broken and friable; minor, scattered, very fine grained pyrite. | | | | | | |
| 62-64 | 4" | Fine grained, gray andesite. | 20180 | 5' | | | | |
| 64-67 | 0 | Pale gray andesite; broken and friable for first 2 feet; brecciated in part for next one foot; minor f.g. pyrite on fractures. | | | | | | |

KERR-DAWSON & ASSOCIATES LTD. - DIAMOND DRILL RECORD

Suite 1 - 219 Victoria St.
Kamloops, B.C.
Phone 374-0544

PROPERTY.....Dorchester Resources.....

HOLE No.75 - 1.....

| DIP AND AZIMUTH TEST | | |
|----------------------|-------|---------|
| Corrected | | |
| Footage | Angle | Azimuth |
| | | |
| | | |
| | | |

Core SizeBQ.....
 Angle of Hole-35.....
 Claim.....
 Section.....
 Bearing287°T.....

Total Depth.....
 % Recovery.....
 Elev. Collar.....
 Latitude.....
 Departure.....

Sheet No5..... of7.....
 Logged by.....James M. Dawson.....
 Date Begun.....15/5/75.....
 Date Finished.....
 Core Stored At.....

| DEPTH | CORE LOST | DESCRIPTION | SAMPLE No. | WIDTH of SAMPLE | | | | |
|-------|-----------|--|------------|-----------------|--|--|--|--|
| 67-72 | 0 | Similar to last section; minor calcite veinlets near beginning of section; sporadic pyrite in thin stringers and larger grains. | 20179 | 5' | | | | |
| 72-77 | 0 | From 72-72.2. similar to last section; 72.2-77 quartz vein - milky white, sporadic stringers and clumps of pyrite up to 1" wide; some inclusions of wall rock. | 20176 | 5' | | | | |
| 77-80 | 4" | From 77-77.5 quartz vein with some inclusions of chloritized wall rock. 77.5-80 pale gray andesite scattered stringers and blebs of pyrite; fine blebs of quartz-satellite to main vein. | 20177 | 5' | | | | |
| 80-82 | 0 | Pale gray andesite; porphyritic in part; frequent pyrite in brecciated section in first 1.5 feet as thin stringers and larger crystals - up to 1/4" across, last 6" is devoid of pyrite. | | | | | | |
| 82-87 | 0 | Pale gray to medium gray andesite, brecciated and recemented in part; sporadic pyrite as very fine grained material in stringers and as larger more | 20178 | 5' | | | | |

KERR-DAWSON & ASSOCIATES LTD. - DIAMOND DRILL RECORD

Suite 1 - 215 Victoria St.
Kamloops, B.C.
Phone 374-0544

PROPERTY Dorchester Resources

HOLE No. 75 - 1

| DIP AND AZIMUTH TEST | | |
|----------------------|-------|---------|
| Corrected | | |
| Footage | Angle | Azimuth |
| | | |
| | | |
| | | |

Core Size BQ

Angle of Hole -35

Claim.....

Section.....

Bearing 287°T

Total Depth

% Recovery

Elev. Collar

Latitude

Departure

Sheet No 6 of 7

Logged by James M. Dawson

Date Begun 15/5/75

Date Finished

Core Stored At

| DEPTH | CORE LOST | DESCRIPTION | SAMPLE No. | WIDTH of SAMPLE | | | | |
|---------|-----------|--|------------|-----------------|--|--|--|--|
| | | | | | | | | |
| | | | | | | | | |
| 87 - 92 | 3" | Primarily brecciated andesite - cemented by white calcite and quartz - fragments sub-rounded and up to 1/2" in diameter; minor f.g. pyrite in stringers and isolated grains. | 20181 | 5' | | | | |
| 92-97 | 10" | Similar to last section some quartz fragments; pyrite - very f.g. in some stringers. | 20182 | 5' | | | | |
| 97-102 | 20" | Fine grained, greenish gray andesite; brecciated in part; minor scattered f.g. pyrite; 2" quartz vein @ 97.6 feet @ 30° to core axis - barren. | | | | | | |
| 102-107 | 0 | f.g. dark greenish gray andesite; vesicular and ? amygdaloidal in part; very g.f. amygdules - less than 1/16 in diameter; traces f.g. pyrite along slip surfaces. | | | | | | |
| 107-112 | 0 | f.g. greenish gray to purplish, relatively fresh andesite. | | | | | | |

KERR-DAWSON & ASSOCIATES LTD. - DIAMOND DRILL RECORD

Suite 1 - 219 Victoria St.
Kamloops, B.C.
Phone 374-0544

PROPERTY Dorchester Resources

HOLE No. 75 - 2

| DIP AND AZIMUTH TEST | | |
|----------------------|-------|---------|
| Corrected | | |
| Footage | Angle | Azimuth |
| | | |
| | | |
| | | |
| | | |

Core Size BQ
 Angle of Hole -45
 Claim.....
 Section.....
 Bearing 000°T

Total Depth.....
 % Recovery.....
 Elev. Collar.....
 Latitude.....
 Departure.....

Sheet No 1 of 16
 Logged by James M. Dawson
 Date Begun 20/5/75
 Date Finished.....
 Core Stored At.....

| DEPTH | CORE LOST | DESCRIPTION | SAMPLE No. | WIDTH of SAMPLE | | | | |
|-------|-----------|---|------------|-----------------|--|--|--|--|
| | | 2' casing, started coring @ 1'. | | | | | | |
| 1 - 2 | 3" | Greenish gray, relatively fresh andesite; slightly porphyritic in part. | | | | | | |
| 2 - 4 | 11" | Similar to last section; 2" barren quartz vein near end of run. | | | | | | |
| 4 - 9 | 0 | Fresh greenish gray andesite; fracturing common, fractures filled with dk gray to black material which seems to be a mixture of chlorite and quartz-trace of pyrite in some of these filled fractures. | | | | | | |
| 9-14 | 0 | Greenish gray, fresh andesite - finely porphyritic in part; minor fracturing as before; 3/4" quartz vein @ 9.7' @ 60° to core axis-barren. | | | | | | |
| 14-19 | 0 | Similar to last section - some fracturing; fractures filled with chlorite-a few with white quartz. | | | | | | |
| 19-24 | 0 | Dark greenish gray to pale gray andesite; some veining with narrow quartz veins one grain of | | | | | | |

KERR-DAWSON & ASSOCIATES LTD. - DIAMOND DRILL RECORD

Suite 1 - 219 Victoria St.
Kamloops, B.C.
Phone 374-0544

PROPERTY Dorchester Resources

HOLE No. 75 - 2

| DIP AND AZIMUTH TEST | | |
|----------------------|-------|---------|
| Corrected | | |
| Footage | Angle | Azimuth |
| | | |
| | | |
| | | |
| | | |

Core Size BQ
 Angle of Hole -45
 Claim.....
 Section.....
 Bearing 000°T

Total Depth.....
 % Recovery.....
 Elev. Cellar.....
 Latitude.....
 Departure.....

Sheet No 2 of 16
 Logged by James M. Dawson,
 Date Begun 20/5/75
 Date Finished.....
 Core Stored At.....

| DEPTH | CORE LOST | DESCRIPTION | SAMPLE No. | WIDTH of SAMPLE | | | | |
|-------|-----------|--|------------|-----------------|--|--|--|--|
| | | chalcopyrite in one 1/4" quartz vein; minor pyrite in discrete grains at several places in andesite proper. | | | | | | |
| 24-29 | 0 | Greenish gray, relatively massive andesite; some minor quartz veining; minor pyrite as discrete cubes or pyritohedra. | | | | | | |
| 29-33 | 0 | Pale greenish gray andesite with frequent rounded ghost-like spherules of ? epidote-zoisite; minor quartz veining - barren. | | | | | | |
| 33-34 | 0 | Similar to last section. | | | | | | |
| 34-38 | 0 | Similar to last section; some brecciation and filling of voids with quartz stringers - minor f.g. pyrite in some fractures; 5" barren quartz vein @ 37.3 @ 80° to core axis. | | | | | | |
| 38-39 | 0 | f.g. gray, dense andesite, few tiny stringers of quartz-trace pyrite. | | | | | | |

KERR—DAWSON & ASSOCIATES LTD. - DIAMOND DRILL RECORD

Suite 1 - 219 Victoria St.
Kamloops, B.C.
Phone 374-0544

PROPERTY.....Dorchester Resources.....

HOLE No.75 - 2.....

| DIP AND AZIMUTH TEST | | |
|----------------------|-------|---------|
| Corrected | | |
| Footage | Angle | Azimuth |
| | | |
| | | |
| | | |

Core SizeBQ.....
 Angle of Hole-45.....
 Claim.....
 Section.....
 Bearing000°T.....

Total Depth.....
 % Recovery.....
 Elev. Collar.....
 Latitude.....
 Departure.....

Sheet No.3..... of16.....
 Logged by.....James M. Dawson.....
 Date Begun.....20/5/75.....
 Date Finished.....
 Core Stored At.....

| DEPTH | CORE LOST | DESCRIPTION | SAMPLE No. | WIDTH of SAMPLE | | | | |
|-------|-----------|---|------------|-----------------|--|--|--|--|
| 39-43 | 0 | Similar to last section - traces pyrite as discrete grains; some faint spherules of ? epidote - zoisite. | | | | | | |
| 43-44 | 0 | Similar to last section - traces f.g. pyrite. | | | | | | |
| 44-46 | 0 | Similar to last section; minor quartz stringers. | | | | | | |
| 46-49 | 4" | Similar to last section. | | | | | | |
| 49-53 | 0 | Fine grained, dense gray andesite; minor qtz veining; 2' section from 51-53 has many thin stringers of very f.g. pyrite; this section brecciated in part. | | | | | | |
| 53-54 | 0 | Relatively fresh, dense, gray andesite. | | | | | | |
| 54-59 | 0 | Similar to last section. | | | | | | |
| 59-64 | 0 | Similar to last section; @ 61.3 a 1" barren quartz vein @ 60° to core axis, minor pyrite and tetrahedrite in 1/2" of wall rock on either side of quartz vein; | | | | | | |

KERR—DAWSON & ASSOCIATES LTD. - DIAMOND DRILL RECORD

Suite 1 - 219 Victoria St.
Kamloops, B.C.
Phone 374-0544

PROPERTY Dorchester Resources

HOLE No. 75 - 2

| DIP AND AZIMUTH TEST | | |
|----------------------|-------|---------|
| Corrected | | |
| Footage | Angle | Azimuth |
| | | |
| | | |
| | | |
| | | |

Core Size BQ
 Angle of Hole -45
 Claim
 Section
 Bearing 000°T

Total Depth
 % Recovery
 Elev. Collar
 Latitude
 Departure

Sheet No. 4 of 16
 Logged by James M. Dawson
 Date Begun 20/5/75
 Date Finished
 Core Stored At

| DEPTH | CORE LOST | DESCRIPTION | SAMPLE No. | WIDTH of SAMPLE | | | | |
|-------|-----------|--|------------|-----------------|--|--|--|--|
| | | several discrete pyrite grains up to 1/3" at 2 other places. | | | | | | |
| 64-68 | 0 | Similar to last section; @67.2 a 2 1/2" quartz vein with minor f.g. pyrite @ 55° to core axis. | | | | | | |
| 68-69 | 0 | f.g. gray, dense andesite. | | | | | | |
| 69-74 | 0 | Similar to last section; scattered pyrite as discrete cubes up to 1/4" across fairly common; @ 61.5' a 2 1/2" white, barren quartz vein @ 60° to core axis. | | | | | | |
| 74-79 | 0 | Pale gray andesite; last 2' section is fracture and rehealed by black material - silica and chlorite? There are at least 5-6 small 1/4" - 1" barren white quartz veins - all at 40-50° to core axis; scattered pyrite as discrete cubes and pyritohedra in a few places. | | | | | | |
| 79-84 | 0 | Pale gray to dark gray andesite; finely porphyritic in part; minor discrete cubes of | | | | | | |

KERR-DAWSON & ASSOCIATES LTD. - DIAMOND DRILL RECORD

Suite 1 - 219 Victoria St.
Kamloops, B.C.
Phone 374-0544

PROPERTY Dorchester Resources

HOLE No. 75 - 2

| DIP AND AZIMUTH TEST | | |
|----------------------|-------|---------|
| Corrected | | |
| Footage | Angle | Azimuth |
| | | |
| | | |
| | | |
| | | |

Core Size BQ
 Angle of Hole -45
 Claim
 Section
 Bearing 000°T

Total Depth
 % Recovery
 Elev. Collar
 Latitude
 Departure

Sheet No 5 of 16
 Logged by James M. Dawson
 Date Begun 20/5/75
 Date Finished
 Core Stored At

| DEPTH | CORE LOST | DESCRIPTION | SAMPLE No. | WIDTH of SAMPLE | | | | |
|--------|-----------|--|------------|-----------------|--|--|--|--|
| | | pyrite in a few places. | | | | | | |
| 84-89 | 0 | From 84 - 85.3 pale grayish, bleached andesite; 3 narrow quartz veins - minor f.g. pyrite in narrow fractures and on slip surfaces, 85.3-89 medium to dark greenish gray andesite; few stringers and clots of chloritic material. | | | | | | |
| 89-94 | 0 | Pale greenish gray to dark green andesite; bleached in places; several very narrow quartz stringers; minor pyrite as larger blebs. | | | | | | |
| 94-99 | 0 | Dark greenish gray andesite; few quartz stringers - few irregular stringers of chloritic material; minor pyrite as isolated, euhedral grains. | | | | | | |
| 99-104 | 0 | Pale to dark greenish gray andesite; @ 100.5 to 100.8 zone of two 1/2" quartz veins with associated minor pyrite and traces of arsenopyrite and tetrahedrite; @ 102 a 1" vein of barren bull quartz @ 45° to core axis; @ 102.4 a 1/2" quartz vein with some scattered pyrite near borders @ 45° to core axis. | | | | | | |

KERR—DAWSON & ASSOCIATES LTD. - DIAMOND DRILL RECORD

Suite 1 - 219 Victoria St.
Kamloops, B.C.
Phone 374-0544

PROPERTY.....Dorchester Resources.....

HOLE No. 75 - 2.....

| DIP AND AZIMUTH TEST | | |
|----------------------|-------|---------|
| Corrected | | |
| Footage | Angle | Azimuth |
| | | |
| | | |
| | | |

Core SizeBQ.....
 Angle of Hole-45.....
 Claim.....
 Section.....
 Bearing000°T.....

Total Depth.....
 % Recovery.....
 Elev. Collar.....
 Latitude.....
 Departure.....

Sheet No 6.....of 16.....
 Logged by James M. Dawson.....
 Date Begun 20/5/75.....
 Date Finished.....
 Core Stored At.....

| DEPTH | CORE LOST | DESCRIPTION | SAMPLE No. | WIDTH of SAMPLE | | | | |
|---------|-----------|--|------------|-----------------|--|--|--|--|
| 104-109 | 0 | Similar to last section - bulk is dark greenish gray with paler bleached and silicified areas near some of the narrow quartz stringers; also few calcite stringers; @ 104 - a 1" barren vein of quartz - minor pyrite in wall rock; a number of other thin quartz stringers in section; 2 or 3 have minor pyrite associated with them. | | | | | | |
| 109-114 | 0 | Light to medium gray andesite; few minor quartz stringers; several narrow calcite stringers; traces pyrite. | | | | | | |
| 114-119 | 0 | Similar to last section; @ 118.1 a 3 1/2" barren, bull quartz vein @ 60° to core axis; minor pyrite in wall rock near this vein; from 118.6-119 barren white quartz @ 45° to core axis. | | | | | | |
| 119-124 | 0 | From 119-119.4 barren white quartz-minor inclusions of chlorite and dolomite minor pyrite in nearby altered wall rock; from 119.4 to end light, greenish gray, somewhat altered andesite; @ 123.5' a 2" barren white quartz vein. | | | | | | |

KERR-DAWSON & ASSOCIATES LTD. - DIAMOND DRILL RECORD

Suite 1 - 219 Victoria St.
Kamloops, B.C.
Phone 374-0544

PROPERTY Dorchester Resources

HOLE No. 75 - 2

| DIP AND AZIMUTH TEST | | |
|----------------------|-------|---------|
| Corrected | | |
| Footage | Angle | Azimuth |
| | | |
| | | |
| | | |

Core Size BQ

Angle of Hole -45

Claim.....

Section.....

Bearing 000°T

Total Depth

% Recovery

Elev. Collar

Latitude

Departure

Sheet No. 7 of 16

Logged by James M. Dawson

Date Begun 20/5/75

Date Finished

Core Stored At

| DEPTH | CORE LOST | DESCRIPTION | SAMPLE No. | WIDTH of SAMPLE | | | | |
|---------|-----------|---|------------|-----------------|--|--|--|--|
| 124-129 | 0 | Medium to dark greenish gray andesite; irregular zone of quartz stringers and blebs @ from 126.1 to 126.5; traces pyrite in several parts of whole section. | | | | | | |
| 129-134 | 0 | Medium to dark gray andesite; frequent thin stringers of quartz and some calcite trace chalcopyrite in two thin quartz stringers; minor pyrite in larger grains. | | | | | | |
| 134-139 | 0 | Medium to light gray, partly bleached andesite; scattered pyrite in thin seams and stringers; 5" white, barren quartz vein @ 136.5'. | | | | | | |
| 139-140 | 0 | Similar to last section; minor pyrite. | | | | | | |
| 140-144 | 0 | Light to dark gray andesite - frequent thin stringers of quartz and calcite; @ 142.3' a 1/2 quartz vein with some included serpenitine? minor pyrite and tetrahedrite associated with this vein minor pyrite in several other parts of section. | | | | | | |

KERR-DAWSON & ASSOCIATES LTD. - DIAMOND DRILL RECORD

Suite 1 - 219 Victoria St.
Kamloops, B.C.
Phone 374-0544

PROPERTY Dorchester Resources

HOLE No. 75 - 2

| DIP AND AZIMUTH TEST | | |
|----------------------|-------|---------|
| Corrected | | |
| Footage | Angle | Azimuth |
| | | |
| | | |
| | | |

Core Size BQ
 Angle of Hole -45
 Claim.....
 Section.....
 Bearing 000°T

Total Depth.....
 % Recovery.....
 Elev. Collar.....
 Latitude.....
 Departure.....

Sheet No 8 of 16
 Logged by James M. Dawson
 Date Begun 20/5/75
 Date Finished.....
 Core Stored At.....

| DEPTH | CORE LOST | DESCRIPTION | SAMPLE No. | WIDTH of SAMPLE | | | | |
|---------|-----------|--|------------|-----------------|--|--|--|--|
| 144-149 | 0 | Dark greenish andesite; frequent quartz and calcite stringers; minor pyrite. | | | | | | |
| 149-154 | 0 | Dark greenish chloritic andesite. | | | | | | |
| 154-159 | 0 | Similar to last section; 1" barren white quartz vein @ 155.3'. | | | | | | |
| 159-164 | 0 | Dark green to gray andesite; @ 160 a 7" barren quartz vein @ 70° to core axis; @ 164.3 a 3" barren quartz vein @ 70° to core axis. | | | | | | |
| 164-167 | 0 | Grayish broken andesite; some brecciation minor f.g. pyrite in some of interstices between fragments. | | | | | | |
| 167-169 | 0 | Similar to last section. | | | | | | |
| 169-174 | 0 | From 169-170.6 broken and brecciated andesite with some very f.g. pyrite in interstices between fragments; 170.6 - 174 greenish gray, partly chloritized andesite. | | | | | | |

KERR—DAWSON & ASSOCIATES LTD. - DIAMOND DRILL RECORD

Suite 1 - 219 Victoria St.
Kamloops, B.C.
Phone 374-0544

PROPERTY Dorchester Resources

HOLE No. 75 - 2

| DIP AND AZIMUTH TEST | | |
|----------------------|-------|---------|
| Corrected | | |
| Footage | Angle | Azimuth |
| | | |
| | | |
| | | |
| | | |

Core Size BQ
 Angle of Hole -45
 Claim.....
 Section.....
 Bearing 000°T

Total Depth.....
 % Recovery.....
 Elev. Collar.....
 Latitude.....
 Departure.....

Sheet No 9 of 16
 Logged by James M. Dawson
 Date Begun 20/5/75
 Date Finished.....
 Core Stored At.....

| DEPTH | CORE LOST | DESCRIPTION | SAMPLE No. | WIDTH of SAMPLE | | | | |
|---------|-----------|--|------------|-----------------|--|--|--|--|
| 174-179 | 0 | Pale greenish gray andesite; 1/2" barren quartz vein @ 176' @ 20° to core axis. | | | | | | |
| 179-182 | 0 | Pale greenish gray andesite; minor very f.g. pyrite in some narrow fractures. | | | | | | |
| 182-184 | 3" | Similar to last section; minor pyrite in isolated larger grains. | | | | | | |
| 184-189 | 0 | Fine grained, greenish gray andesite; frequent thin stringers of quartz and calcite. | | | | | | |
| 194-199 | 0 | Fine grained, greenish-gray partly chloritized andesite becoming bleached to pale grayish in last 2' of section; @ 197 a 1/2" quartz stringer with associated very f.g. pyrite @ 60° to core axis. | | | | | | |
| 199-204 | 0 | Pale greenish gray, partly chloritized andesite; @ 202.9 a 1/2" barren quartz vein @ 50° to core axis. | | | | | | |

KERR-DAWSON & ASSOCIATES LTD. - DIAMOND DRILL RECORD

Suite 1 - 219 Victoria St.
Kamloops, B.C.
Phone 374-0544

PROPERTY Dorchester Resources

HOLE No. 75 - 2

| DIP AND AZIMUTH TEST | | |
|----------------------|-------|---------|
| Corrected | | |
| Footage | Angle | Azimuth |
| | | |
| | | |
| | | |
| | | |

Core Size BQ
 Angle of Hole -45
 Claim.....
 Section.....
 Bearing 000°T

Total Depth.....
 % Recovery.....
 Elev. Collar.....
 Latitude.....
 Departure.....

Sheet No 10 of 16
 Logged by James M. Dawson
 Date Begun 20/5/75
 Date Finished.....
 Core Stored At.....

| DEPTH | CORE LOST | DESCRIPTION | SAMPLE No. | WIDTH of SAMPLE | | | | |
|---------|-----------|---|------------|-----------------|--|--|--|--|
| 204-209 | 0 | Greenish gray f.g. andesite, porphyritic in part; first 3-4 feet are fractured to brecciated and re-cemented with a mixture of chlorite and quartz; @ 205.1 a 1" quartz vein with minor chalcopyrite and tetrahedrite in wall rock near it; vein dips @ 60° to core axis. | | | | | | |
| 209-214 | 0 | Greenish gray, partly chloritized andesite; scattered narrow, barren quartz veinlets; @ 210.2 a 1/2" barren, quartz vein @ 70° to core axis. | | | | | | |
| 214-219 | 0 | Greenish gray andesite becoming lighter gray and somewhat bleached in last 2 feet of section; @ 217.5 a 1 1/2" vein of barren quartz @ 70° to core axis; @ 218.7 a 1/2" zone of quartz with some very f.g. pyrite @ 45° to core axis. | | | | | | |
| 219-224 | 0 | Greenish gray andesite. | | | | | | |
| 224-229 | 0 | Greenish gray, partly chloritized andesite; few scattered, barren quartz stringers. | | | | | | |

KERR—DAWSON & ASSOCIATES LTD. - DIAMOND DRILL RECORD

Suite 1 - 219 Victoria St.
Kamloops, B.C.
Phone 374-0544

PROPERTY.....Dorchester Resources.....

HOLE No. 75 - 2.....

| DIP AND AZIMUTH TEST | | |
|----------------------|-------|---------|
| Corrected | | |
| Footage | Angle | Azimuth |
| | | |
| | | |
| | | |

Core SizeBQ.....
 Angle of Hole-45.....
 Claim.....
 Section.....
 Bearing000°T.....

Total Depth.....
 % Recovery.....
 Elev. Collar.....
 Latitude.....
 Departure.....

Sheet No11..... of16.....
 Logged by.....James M. Dawson.....
 Date Begun.....20/5/75.....
 Date Finished.....
 Core Stored At.....

| DEPTH | CORE LOST | DESCRIPTION | SAMPLE No. | WIDTH of SAMPLE | | | | |
|---------|-----------|--|------------|-----------------|--|--|--|--|
| 229-234 | 0 | Similar to last section; last 2' section is bleached to light gray in part; minor scattered pyrite; @ 232.7 a 1/2" vein of quartz with associated minor pyrite @ 50° to core axis. | | | | | | |
| 234-239 | 0 | Greenish gray, medium to f.g. andesite - few irregular stringers of quartz and chlorite filling fractures. | | | | | | |
| 239-244 | 0 | Somewhat bleached, pale greenish gray andesite; fractured and brecciated in part; very f.g. pyrite filling some of the interstices and fractures. | | | | | | |
| 244-249 | 0 | Similar to last section. | | | | | | |
| 249-254 | 0 | Similar to last section; pyrite as very f.g. material in stringers and as larger discrete crystals. | | | | | | |
| 254-259 | 0 | Pale grayish, partly bleached andesite; fractured and brecciated in part; minor pyrite as very f.g. crystals in thin shear zones and as larger discrete grains. | | | | | | |

KERR-DAWSON & ASSOCIATES LTD. - DIAMOND DRILL RECORD

Suite 1 - 219 Victoria St.
Kamloops, B.C.
Phone 374-0544

PROPERTY Dorchester Resources

HOLE No. 75 - 2

| DIP AND AZIMUTH TEST | | |
|----------------------|-------|---------|
| Corrected | | |
| Footage | Angle | Azimuth |
| | | |
| | | |
| | | |

Core Size BQ

Angle of Hole -45

Claim.....

Section.....

Bearing 000°T

Total Depth.....

% Recovery.....

Elev. Collar.....

Latitude.....

Departure.....

Sheet No 12 of 16

Logged by..... James M. Dawson

Date Begun 20/5/75

Date Finished.....

Core Stored At.....

| DEPTH | CORE LOST | DESCRIPTION | SAMPLE No. | WIDTH of SAMPLE | | | | |
|---------|-----------|--|------------|-----------------|--|--|--|--|
| 259-261 | 0 | Pale to dark gray andesite; becoming darker and less altered near end of section; minor pyrite as before. | | | | | | |
| 261-264 | 0 | Pale grayish, finely porphyritic andesite; minor scattered pyrite. | | | | | | |
| 264-265 | 0 | Highly fractured, purplish gray andesite; some quartz veining, brecciated in places; abundant f.g. pyrite in stringers and clots. | | | | | | |
| 265-267 | 0 | Similar to last section - less pyrite. | | | | | | |
| 267-268 | 0 | Purplish gray, partly brecciated andesite; pyrite in thin stringers and as isolated grains. | | | | | | |
| 268-269 | 3" | Brecciated purplish andesite; minor quartz veining pyrite as very f.g. material in thin stringers and as discrete larger grains; minor scattered tetrahedrite. | | | | | | |
| 269-274 | 0 | Brecciated purplish, gray andesite; frequent scattered pyrite; 2' section from 271 to 273 | | | | | | |

KERR—DAWSON & ASSOCIATES LTD. - DIAMOND DRILL RECORD

Suite 1 - 219 Victoria St.
Kamloops, B.C.
Phone 374-0544

PROPERTY.....Dorchester Resources.....

HOLE No.75 - 2.....

| DIP AND AZIMUTH TEST | | |
|----------------------|-------|---------|
| Corrected | | |
| Footage | Angle | Azimuth |
| | | |
| | | |
| | | |

Core SizeBQ.....
 Angle of Hole-45.....
 Claim.....
 Section.....
 Bearing000°T.....

Total Depth.....
 % Recovery.....
 Elev. Collar.....
 Latitude.....
 Departure.....

Sheet No.14..... of16.....
 Logged byJames M. Dawson.....
 Date Begun20/5/75.....
 Date Finished.....
 Core Stored At.....

| DEPTH | CORE LOST | DESCRIPTION | SAMPLE No. | WIDTH of SAMPLE | | | | | |
|---------|-----------|---|------------|-----------------|--|--|--|--|--|
| 284-285 | 0 | Similar to last section; one 1/2" quartz vein - barren at $\hat{\wedge}$ 45° to core axis. | | | | | | | |
| 285-289 | 15" | First 2 feet badly ground - lost core here; material is grayish, altered and brecciated andesite with frequent quartz stringers some @ 20° to core axis; frequent pyrite as both the fine and coarse material. | | | | | | | |
| 289-294 | 0 | Grayish brecciated and chloritized andesite with frequent quartz stringers; @ 291 a 2" quartz stringer with smaller stringers of f.g. pyrite in it @ 30° to core axis; scattered pyrite of both types in rest of section. | | | | | | | |
| 294-299 | 0 | Pale gray, bleached andesite; brecciated in part; scattered stringers and veinlets of quartz; f.g. pyrite in a number of thin stringers and breccia zones @ 20-30° to core axis; from 295.3 to 297.5 zone of semi massive f.g. pyrite stringers in altered breccia zone - 20° to core axis. | | | | | | | |

KERR-DAWSON & ASSOCIATES LTD. - DIAMOND DRILL RECORD

Suite 1 - 219 Victoria St.
Kamloops, B.C.
Phone 374-0544

PROPERTY Dorchester Resources

HOLE No. 75 - 2

| DIP AND AZIMUTH TEST | | |
|----------------------|-------|---------|
| Corrected | | |
| Footage | Angle | Azimuth |
| | | |
| | | |
| | | |
| | | |

Core Size BQ
 Angle of Hole 45
 Claim.....
 Section.....
 Bearing 000°T

Total Depth.....
 % Recovery.....
 Elev. Collar.....
 Latitude.....
 Departure.....

Sheet No 15 of 16
 Logged by James M. Dawson
 Date Begun 20/5/75
 Date Finished.....
 Core Stored At.....

| DEPTH | CORE LOST | DESCRIPTION | SAMPLE No. | WIDTH of SAMPLE | | | | |
|---------|-----------|--|------------|-----------------|--|--|--|--|
| 299-304 | 0 | Pale gray bleached andesite; minor quartz veining few traces of pyrite in thin dark gray stringers. | | | | | | |
| 304-307 | 0 | Similar to last section. | | | | | | |
| 307-309 | 0 | Pale gray andesite; brecciated in part; few stringers of quartz - few thin dark gray stringers of f.g. pyrite @ 30° to core axis. | | | | | | |
| 309-311 | 0 | Pale grayish, bleached andesite; brecciated in part; scattered quartz stringers; scattered thin stringers and blebs of f.g. pyrite @ 20-30° to core axis. | | | | | | |
| 311-314 | 3" | Pale grayish, brecciated andesite; thin stringers and streaks of very f.g. pyrite fairly common; most are at 20-30° to core axis. | | | | | | |
| 314-316 | 0 | Grayish brecciated and altered andesite; few quartz stringers - section of semi massive, black f.g. pyrite from 314.7 - 318.7 @ 20-30° to core axis. | | | | | | |

KERR—DAWSON & ASSOCIATES LTD. - DIAMOND DRILL RECORD

Suite 1 - 219 Victoria St.
Kamloops, B.C.
Phone 374-0544

PROPERTY Dorchester

HOLE No. 75 - 3

| DIP AND AZIMUTH TEST | | |
|----------------------|-------|---------|
| Corrected | | |
| Footage | Angle | Azimuth |
| | | |
| | | |
| | | |

Core Size BQ
 Angle of Hole -43
 Claim
 Section
 Bearing 028°T

Total Depth 299
 % Recovery
 Elev. Collar
 Latitude
 Departure

Sheet No 1 of 11
 Logged by James M. Dawson
 Date Begun May 31st, 1975
 Date Finished June 8th, 1975
 Core Stored At Property

| DEPTH | CORE LOST | DESCRIPTION | SAMPLE No. | WIDTH of SAMPLE | | | | | |
|---------|-----------|--|------------|-----------------|--|--|--|--|--|
| | | 2' casing - started coring @ 2' | | | | | | | |
| 2 - 3 | 5" | Greenish gray, fairly fresh, finely porphyritic andesite. | | | | | | | |
| 3-4.5 | 3" | Similar to last Section. | | | | | | | |
| 4.5-6 | 2" | Greenish gray, fairly massive andesite. | | | | | | | |
| 6-7.5 | 0 | Greenish gray andesite, finely porphyritic in part | | | | | | | |
| 7.5-9.5 | 0 | Similar to last section; minor narrow quartz stringers. | | | | | | | |
| 9.5-14 | 0 | f.g., greenish gray, fresh andesite, scattered pyrite as isolated grains and blebs; @ 10.7 a 3" quartz vein @ 45° to core axis; few pyrite blebs; @ 13.6' @ 1 1/2" a 1 1/2" composite quartz-dolomite ? vein @ 30° to core axis. | | | | | | | |
| 14-19 | 0 | Greenish gray, finely porphyritic andesite; brecciated in part; @ 16.7' a 1/4" quartz vein | | | | | | | |

KERR—DAWSON & ASSOCIATES LTD. - DIAMOND DRILL RECORD

Suite 1 - 219 Victoria St.
Kamloops, B.C.
Phone 374-0544

PROPERTY.....Dorchester.....

HOLE No. 75 - 3.....

| DIP AND AZIMUTH TEST | | |
|----------------------|-------|---------|
| Corrected | | |
| Footage | Angle | Azimuth |
| | | |
| | | |
| | | |

Core SizeBQ.....
 Angle of Hole-43.....
 Claim.....
 Section.....
 BearingQ28°T.....

Total Depth299.....
 % Recovery.....
 Elev. Collar.....
 Latitude.....
 Departure.....

Sheet No. 2..... of 11.....
 Logged by James M. Dawson
 Date Begun May 31st., 1975
 Date Finished June 8th., 1975
 Core Stored At Property.....

| DEPTH | CORE LOST | DESCRIPTION | SAMPLE No. | WIDTH of SAMPLE | | | | |
|-----------|-----------|---|------------|-----------------|--|--|--|--|
| | | with scattered f.g. pyrite @ 40° core axis. | | | | | | |
| 19-21 | 0 | Similar to last section. | | | | | | |
| 21-24.5 | 0 | Greenish gray, finely porphyritic andesite becoming very f.g. and buff coloured in last 6" of section - tuff horizon? | | | | | | |
| 24.5-29.5 | 0 | Greenish gray to buff, f.g. andesite; few barren quartz stringers; @ 24.6 @ 2 1/2" barren quartz vein @ 70° to core axis. | | | | | | |
| 29.5-34.5 | 0 | Similar to last section; @ 31.5 a 2" vein of barren white quartz @ 70° to core axis. | | | | | | |
| 34.5-36 | 0 | Similar to last section; @ 34.8 a 4" vein of barren quartz @ 35° to core axis. | | | | | | |
| 36-39 | 0 | f.g. greenish gray andesite; minor quartz stringers. | | | | | | |
| 39-41 | 0 | Similar to last section. | | | | | | |

KERR-DAWSON & ASSOCIATES LTD. - DIAMOND DRILL RECORD

Suite 1 - 219 Victoria St.
Kamloops, B.C.
Phone 374-0544

PROPERTY.....Dorchester.....

HOLE No.75 - 3.....

| DIP AND AZIMUTH TEST | | |
|----------------------|-------|---------|
| Corrected | | |
| Footage | Angle | Azimuth |
| | | |
| | | |
| | | |

Core SizeBQ.....
 Angle of Hole-43.....
 Claim.....
 Section.....
 Bearing028°T.....

Total Depth299.....
 % Recovery
 Elev. Collar
 Latitude
 Departure

Sheet No ...3... of ...11...
 Logged by...James M. Dawson...
 Date Begun...May 31st... 1975...
 Date Finished...June 8th... 1975...
 Core Stored At...Property.....

| DEPTH | CORE LOST | DESCRIPTION | SAMPLE No. | WIDTH of SAMPLE | | | | |
|-------|-----------|--|------------|-----------------|--|--|--|--|
| 41-44 | 0 | Greenish gray andesite; section from 41.8 to 43.5 is fractured; contains a few quartz stringers and a few thin stringers and fillings of the very f.g. pyrite. | | | | | | |
| 44-45 | 0 | f.g. greenish gray andesite; minor quartz veining and minor pyrite. | | | | | | |
| 45-49 | 0 | Greenish gray to purplish andesite; finely porphyritic in part. | | | | | | |
| 49-52 | 0 | Dark greenish gray andesite. | | | | | | |
| 52-54 | 0 | Similar to last section; finely porphyritic in part. | | | | | | |
| 54-59 | 0 | Greenish gray to purplish andesite; finely porphyritic in part; few quartz stringers; few stringers of f.g. pyrite. | | | | | | |
| 59-64 | 0 | Purplish gray to greenish gray andesite; fragmented in first 3 feet; fragments rounded | | | | | | |

KERR—DAWSON & ASSOCIATES LTD. - DIAMOND DRILL RECORD

Suite 1 - 219 Victoria St.
Kamloops, B.C.
Phone 374-0544

PROPERTY Dorchester

HOLE No. 75 - 3

| DIP AND AZIMUTH TEST | | |
|----------------------|-------|---------|
| Corrected | | |
| Footage | Angle | Azimuth |
| | | |
| | | |
| | | |

Core Size BQ
 Angle of Hole -43
 Claim
 Section
 Bearing 028T

Total Depth 299
 % Recovery
 Elev. Collar
 Latitude
 Departure

Sheet No 5 of 11
 Logged by James M. Dawson
 Date Begun May 31st, 1975
 Date Finished June 8th, 1975
 Core Stored At Property

| DEPTH | CORE LOST | DESCRIPTION | SAMPLE No. | WIDTH of SAMPLE | | | | |
|---------|-----------|---|------------|-----------------|--|--|--|--|
| 89-91.5 | 0 | Greenish gray andesite; fragmental in part; minor barren quartz stringers. | | | | | | |
| 91.5-94 | 0 | Pale greenish gray andesite; fragmental in part; minor quartz stringers. | | | | | | |
| 94-96 | 0 | Purplish - gray andesite. | | | | | | |
| 96-99 | 0 | Greenish gray andesite; fragmental in part; @ 97.6 a 1" vein of barren quartz @ 15° to core axis. | | | | | | |
| 99-102 | 0 | Greenish gray to gray andesite; @ 100.7 a 3/4" quartz vein @ 20° to core axis. | | | | | | |
| 102-104 | 3" | Greenish gray andesite; minor quartz stringers; trace f.g. pyrite. | | | | | | |
| 104-105 | 0 | f.g. grayish andesite. | | | | | | |
| 105-109 | 0 | Greenish gray to pale gray andesite; bleached and brecciated in part; @ 107.4 a 1/3" quartz | | | | | | |

KERR—DAWSON & ASSOCIATES LTD. - DIAMOND DRILL RECORD

Suite 1 - 219 Victoria St.
Kamloops, B.C.
Phone 374-0544

PROPERTY Dorchester

HOLE No. 75 - 3

| DIP AND AZIMUTH TEST | | |
|----------------------|-------|---------|
| Corrected | | |
| Footage | Angle | Azimuth |
| | | |
| | | |
| | | |

Core Size BQ
 Angle of Hole -43
 Claim.....
 Section.....
 Bearing 028°T

Total Depth 299
 % Recovery
 Elev. Collar
 Latitude
 Departure

Sheet No 6 of 11
 Logged by James M. Dawson
 Date Begun May 31st., 1975
 Date Finished June 8th., 1975
 Core Stored At Property.....

| DEPTH | CORE LOST | DESCRIPTION | SAMPLE No. | WIDTH of SAMPLE | | | | | |
|-----------|-----------|--|------------|-----------------|--|--|--|--|--|
| | | vein with associated f.g. pyrite and arsenopyrite @ 70° to core axis. | | | | | | | |
| 109-109.5 | 1" | Primarily white barren quartz. | | | | | | | |
| 109.5-114 | 0 | Greenish gray, partly chloritized andesite; brecciated in part. | | | | | | | |
| 114-118 | 0 | Similar to last section; quartz stringers and blebs common. | | | | | | | |
| 118-119 | 0 | Similar to last section; few barren quartz veins and stringers. | | | | | | | |
| 119-124 | 0? | Greenish gray, chloritic andesite; brecciated and broken in part; some f.g. pyrite in interstices between fragments; some scattered quartz stringers; some pyrite as larger isolated grains. | | | | | | | |
| 124-129 | 2 3/4' | Grinding of core!; greenish gray to purplish gray andesite. | | | | | | | |

KERR—DAWSON & ASSOCIATES LTD. - DIAMOND DRILL RECORD

Suite 1 - 219 Victoria St.
Kamloops, B.C.
Phone 374-0544

PROPERTY.....Dorchester.....

HOLE No.75 - 3.....

| DIP AND AZIMUTH TEST | | |
|----------------------|-------|---------|
| Corrected | | |
| Footage | Angle | Azimuth |
| | | |
| | | |
| | | |

Core SizeBQ.....
 Angle of Hole-43.....
 Claim.....
 Section.....
 Bearing028°T.....

Total Depth299.....
 % Recovery.....
 Elev. Collar.....
 Latitude.....
 Departure.....

Sheet No7..... of11.....
 Logged by.....James M. Dawson.....
 Date Begun.....May 31st., 1975.....
 Date Finished.....June 8th., 1975.....
 Core Stored At.....Property.....

| DEPTH | CORE LOST | DESCRIPTION | SAMPLE No. | WIDTH of SAMPLE | | | | | |
|---------|-----------|---|------------|-----------------|--|--|--|--|--|
| 129-134 | 6" | Greenish gray, partly chloritized andesite; minor f.g. disseminated pyrite. | | | | | | | |
| 134-139 | 2' | Grinding of core!; greenish gray andesite; minor scattered f.g. pyrite. | | | | | | | |
| 139-143 | 2 1/2' | Grinding of core! ; greenish gray to purplish gray andesite. | | | | | | | |
| 143-144 | 0 | Greenish gray andesite; brecciated in part; minor quartz blebs and stringers. | | | | | | | |
| 144-149 | 0 | Pale grayish, brecciated andesite; bleached in part; dark greenish material (quartz and chlorite) filling interstices. | | | | | | | |
| 149-154 | 0 | Pale greenish gray, brecciated andesite; scattered quartz veins and stringers; @ 152.3 a 1" quartz vein with traces of arsenopyrite @ 45° to core axis; @ 152.7' small bleb of chalcopyrite; scattered, minor pyrite throughout section. | | | | | | | |

KERR—DAWSON & ASSOCIATES LTD. - DIAMOND DRILL RECORD

Suite 1 - 219 Victoria St.
Kamloops, B.C.
Phone 374-0544

PROPERTY.....Dorchester.....

HOLE No.75 - 3.....

| DIP AND AZIMUTH TEST | | |
|----------------------|-------|---------|
| Corrected | | |
| Footage | Angle | Azimuth |
| | | |
| | | |
| | | |

Core SizeBQ.....
 Angle of Hole-43.....
 Claim.....
 Section.....
 Bearing028°T.....

Total Depth299.....
 % Recovery
 Elev. Collar
 Latitude
 Departure

Sheet No8..... of11.....
 Logged by.....James M. Dawson.....
 Date Begun.....May 31st., 1975.....
 Date Finished.....June 8th., 1975.....
 Core Stored At.....Property.....

| DEPTH | CORE LOST | DESCRIPTION | SAMPLE No. | WIDTH of SAMPLE | | | | |
|---------|-----------|--|------------|-----------------|--|--|--|--|
| 154-159 | 0 | Similar to last section; scattered quartz stringers; scattered pyrite as very f.g. material in thin stringers and as larger euhedral, discrete grains. | | | | | | |
| 159-164 | 0 | Pale grayish, f.g. andesite; brecciated in part; minor f.g. pyrite. | | | | | | |
| 164-169 | 3" | Pale gray to dark greenish gray andesite; scattered quartz stringers; traces f.g. pyrite. | | | | | | |
| 169-174 | 0 | Dark greenish to pale greenish gray andesite; scattered quartz stringers and veins; from 172 to 172.7 barren white quartz vein at 45° to core axis. | | | | | | |
| 174-179 | 0 | Greenish gray andesite; scattered quartz stringers; minor pyrite. | | | | | | |
| 179-184 | 0 | Greenish gray andesite; minor calcite stringers - traces pyrite. | | | | | | |

KERR-DAWSON & ASSOCIATES LTD. - DIAMOND DRILL RECORD

Suite 1 - 219 Victoria St.
Kamloops, B.C.
Phone 374-0544

PROPERTY.....Dorchester.....

HOLE No.75 - 3.....

| DIP AND AZIMUTH TEST | | |
|----------------------|-------|---------|
| Corrected | | |
| Footage | Angle | Azimuth |
| | | |
| | | |
| | | |

Core SizeBQ.....
 Angle of Hole43.....
 Claim.....
 Section.....
 Bearing028°T.....

Total Depth299.....
 % Recovery.....
 Elev. Collar.....
 Latitude.....
 Departure.....

Sheet No.9..... of11.....
 Logged by.....James M. Dawson.....
 Date Begun.....May 31st., 1975.....
 Date Finished.....June 8th., 1975.....
 Core Stored At.....Property.....

| DEPTH | CORE LOST | DESCRIPTION | SAMPLE No. | WIDTH of SAMPLE | | | | |
|---------|-----------|---|------------|-----------------|--|--|--|--|
| 184-189 | 0 | Similar to last section. | | | | | | |
| 189-194 | 0 | Greenish gray, chloritic andesite to 191; from 191 to 192.8 pale greenish yellow altered andesite with scattered quartz stringers; from 192.8 to 194 greenish gray, chloritic andesite. | | | | | | |
| 194-199 | 0 | Greenish gray andesite; bleached and friable in part between 192 and 193.5; minor pyrite. | | | | | | |
| 199-204 | 0 | Greenish, chloritized andesite; brecciated in part; minor quartz stringers; traces pyrite. | | | | | | |
| 204-209 | 0 | Similar to last section. | | | | | | |
| 209-214 | 0 | Greenish, chloritic andesite to 210.5; from 210.5, to 211.9 bleached and partly friable section; from 211.9 to 219, greenish, chloritic andesite. | | | | | | |
| 214-219 | 0 | Greenish, chloritic andesite. | | | | | | |
| 219-224 | 0 | Greenish to pale greenish gray andesite. | | | | | | |

KERR-DAWSON & ASSOCIATES LTD. - DIAMOND DRILL RECORD

Suite 1 - 219 Victoria St.
Kamloops, B.C.
Phone 374-0544

PROPERTY.....Dorchester.....

HOLE No.75 - 3.....

| DIP AND AZIMUTH TEST | | |
|----------------------|-------|---------|
| Corrected | | |
| Footage | Angle | Azimuth |
| | | |
| | | |
| | | |

Core SizeBQ.....
 Angle of Hole43.....
 Claim.....
 Section.....
 Bearing028°T.....

Total Depth299.....
 % Recovery
 Elev. Collar
 Latitude
 Departure

Sheet No10..... of11.....
 Logged byJames M. Dawson.....
 Date Begun...May...31st...1975.....
 Date Finished June 8th...1975.....
 Core Stored At Property.....

| DEPTH | CORE LOST | DESCRIPTION | SAMPLE No. | WIDTH of SAMPLE | | | | |
|---------|-----------|--|------------|-----------------|--|--|--|--|
| 224-229 | 0 | Similar to last section; minor scattered pyrite. | | | | | | |
| 229-234 | 0 | Similar to last section; scattered quartz stringers. | | | | | | |
| 234-239 | 0 | Similar to last section; last 2' section bleached and brecciated in part. | | | | | | |
| 239-244 | 0 | Light to dark greenish gray andesite. | | | | | | |
| 244-249 | 0 | Similar to last section. | | | | | | |
| 249-254 | 0 | Greenish gray andesite; becoming pale grayish and brecciated in last 2 1/2 foot section; minor f.g. pyrite in thin stringers. | | | | | | |
| 254-259 | 0 | Pale greenish gray, brecciated andesite; last 1 1/2 foot section more massive; scattered pyrite in f.g. stringers and as larger discrete grains. | | | | | | |
| 259-264 | 0 | Greenish gray andesite. | | | | | | |

A P P E N D I X E

ASSAY RESULTS

P. O. Box 160
Cassiar, B.C.

CERTIFICATE OF ASSAY

Samples submitted: May 22/75
Results completed: May 23, 75

I hereby certify that the following are the results of assays made by us upon the herein described core samples.

| MARKED | GOLD | | SILVER | | | | | | | | TOTAL VALUE PER TON (2000 LBS.) |
|--------|-------------------|------------------|-------------------|---------|---------|---------|---------|---------|---------|---------|---------------------------------------|
| | Ounces per Ton | Value per Ton | Ounces per Ton | Percent | Percent | Percent | Percent | Percent | Percent | Percent | |
| 20176 | 0.33 | | 0.07 | DDH | 75-1 | 72-77 | | | | | |
| 20177 | 0.14 | | 0.04 | DDH | 75-1 | 77-82 | | | | | |
| 20178 | 0.04 | | 0.02 | DDH | 75-1 | 82-87 | | | | | |
| 20179 | 0.03 | | 0.01 | DDH | 75-1 | 67-72 | | | | | |
| 20180 | trace | | trace | DDH | 75-1 | 62-67 | | | | | |

cc Kerr-Dawson & Assoc.
Mr. M. M. Rahal

CERTIFICATE OF ASSAY

I hereby certify that the following are the results of assays made by us upon the herein described core samples.

| MARKED | GOLD | | SILVER | | | | | | | | TOTAL VALUE PER TON (2000 LBS.) |
|--------|-------------------|------------------|-------------------|----------|---------|---------|---------|---------|---------|--|---------------------------------------|
| | Ounces per Ton | Value per Ton | Ounces per Ton | Percent | Percent | Percent | Percent | Percent | Percent | | |
| 20100 | 0.005 | | 0.02 | DDH 75-2 | | 302-314 | | | | | |
| 20181 | 0.075 | | 0.03 | DDH 75-1 | | 87-92 | | | | | |
| 20182 | 0.040 | | 0.02 | DDH 75-1 | | 92-97 | | | | | |
| 20183 | trace | | trace | DDH 75-2 | | 94-99 | | | | | |
| 20184 | 0.005 | | 0.02 | DDH 75-2 | | 99-104 | | | | | |
| 20185 | trace | | trace | DDH 75-2 | | 104-109 | | | | | |
| 20186 | trace | | trace | DDH 75-2 | | 109-114 | | | | | |
| 20187 | trace | | trace | DDH 75-2 | | 114-119 | | | | | |
| 20188 | 0.005 | | 0.02 | DDH 75-2 | | 119-124 | | | | | |
| 20189 | trace | | trace | DDH 75-2 | | 124-129 | | | | | |
| 20190 | trace | | trace | DDH 75-2 | | 129-134 | | | | | |
| 20191 | trace | | trace | DDH 75-2 | | 134-139 | | | | | |
| 20192 | 0.020 | | 0.02 | DDH 75-2 | | 139-144 | | | | | |
| 20193 | trace | | trace | DDH 75-2 | | 144-149 | | | | | |
| 20194 | trace | | trace | DDH 75-2 | | 149-154 | | | | | |
| 20195 | trace | | trace | DDH 75-2 | | 154-159 | | | | | |
| 20196 | trace | | trace | DDH 75-2 | | 159-164 | | | | | |
| 20197 | trace | | trace | DDH 75-2 | | 164-169 | | | | | |
| 20198 | trace | | trace | DDH 75-2 | | 169-174 | | | | | |
| 20199 | trace | | trace | DDH 75-2 | | 174-179 | | | | | |
| 20200 | trace | | trace | DDH 75-2 | | 179-184 | | | | | |

1 - 219 Victoria Street
Kamloops, B.C.

CERTIFICATE OF ASSAY

Samples submitted: June 2, 1975
Results completed: June 4/ 1975

I hereby certify that the following are the results of assays made by us upon the herein described core samples.

| MARKED | GOLD | | SILVER | | | | | | | | TOTAL VALUE PER TON (2000 LBS.) |
|--------|-------------------|------------------|-------------------|---------|---------|---------|---------|---------|---------|---------|---------------------------------------|
| | Ounces per Ton | Value per Ton | Ounces per Ton | Percent | Percent | Percent | Percent | Percent | Percent | Percent | |
| 20051 | 0.040 | | 0.02 | DDH | 75-2 | 314 | 319 | | | | |
| 20052 | trace | | trace | DDH | 75-2 | 319 | 324 | | | | |
| 20076 | trace | | trace | DDH | 75-2 | 184 | 189 | | | | |
| 20077 | trace | | trace | DDH | 75-2 | 189 | 194 | | | | |
| 20078 | trace | | trace | DDH | 75-2 | 194 | 199 | | | | |
| 20079 | trace | | trace | DDH | 75-2 | 199 | 204 | | | | |
| 20080 | trace | | trace | DDH | 75-2 | 204 | 209 | | | | |
| 20081 | trace | | trace | DDH | 75-2 | 209 | 214 | | | | |
| 20082 | trace | | trace | DDH | 75-2 | 214 | 219 | | | | |
| 20083 | trace | | trace | DDH | 75-2 | 219 | 224 | | | | |
| 20084 | trace | | 0.02 | DDH | 75-2 | 224 | 234 | | | | |
| 20085 | trace | | 0.02 | DDH | 75-2 | 234 | 239 | | | | |
| 20086 | trace | | trace | DDH | 75-2 | 239 | 244 | | | | |
| 20087 | trace | | 0.02 | DDH | 75-2 | 244 | 249 | | | | |
| 20088 | 0.005 | | 0.02 | DDH | 75-2 | 249 | 254 | | | | |
| 20089 | trace | | trace | DDH | 75-2 | 254 | 259 | | | | |
| 20090 | trace | | trace | DDH | 75-2 | 259 | 264 | | | | |
| 20091 | 0.005 | | 0.02 | DDH | 75-2 | 264 | 269 | | | | |
| 20092 | 0.035 | | 0.03 | DDH | 75-2 | 269 | 274 | | | | |
| 20093 | trace | | 0.02 | DDH | 75-2 | 274 | 279 | | | | |
| 20094 | trace | | 0.02 | DDH | 75-2 | 279 | 284 | | | | |
| 20095 | 0.055 | | 0.04 | DDH | 75-2 | 284 | 289 | | | | |
| 20096 | 0.010 | | 0.02 | DDH | 75-2 | 289 | 294 | | | | |
| 20097 | 0.020 | | 0.02 | DDH | 75-2 | 294 | 299 | | | | |
| 20098 | trace | | 0.02 | DDH | 75-2 | 299 | 304 | | | | |
| 20099 | 0.005 | | 0.02 | DDH | 75-2 | 304 | 309 | | | | |

9 - 219 Victoria Street
Kamloops, B.C.

CERTIFICATE OF ASSAY

Samples submitted: June 12/75
Results completed: June 18/75

I hereby certify that the following are the results of assays made by us upon the herein described ore & core samples.

| MARKED | GOLD | | SILVER | | | | | | | | TOTAL VALUE PER TON (2000 LBS.) | |
|--------|-------------------|------------------|-------------------|--|---------|---------|---------|---------|---------|---------|---------------------------------------|--|
| | Ounces per Ton | Value per Ton | Ounces per Ton | Percent | Percent | Percent | Percent | Percent | Percent | Percent | | |
| 20053 | 0.15 | | 0.02 | REPRESENTATIVE SAMPLE FROM 5 TON SLASH | | | | | | | | |
| 20054 | 0.60 | | 0.20 | SELECTED SAMPLE FROM 5 TON SLASH | | | | | | | | |
| 20055 | 0.04 | | 0.02 | DDH 75-3 | | 79-84 | | | | | | |
| 20056 | trace | | trace | DDH 75-3 | | 105-110 | | | | | | |
| 20057 | trace | | trace | DDH 75-3 | | 119-124 | | | | | | |
| 20058 | trace | | trace | DDH 75-3 | | 124-129 | | | | | | |
| 20059 | trace | | trace | DDH 75-3 | | 129-134 | | | | | | |
| 20060 | trace | | trace | DDH 75-3 | | 134-139 | | | | | | |
| 20061 | 0.005 | | 0.01 | DDH 75-3 | | 139-144 | | | | | | |
| 20062 | trace | | 0.02 | DDH 75-3 | | 144-149 | | | | | | |
| 20063 | 0.005 | | 0.01 | DDH 75-3 | | 149-154 | | | | | | |
| 20064 | trace | | trace | DDH 75-3 | | 154-159 | | | | | | |
| 20065 | 0.005 | | 0.01 | DDH 75-3 | | 254-259 | | | | | | |
| 20066 | 0.13 | | 0.03 | REPRESENTATIVE SAMPLE FROM 5 TON SLASH | | | | | | | | |

A P P E N D I X F

REFERENCES

REFERENCES

- Gabrielse, H. (1963): - McDame Map Area, Cassiar District,
British Columbia; G. S. C. Memoir #319.
- Phelps, G. B. (1973): - Summation Report on the Dorchester
Resources Ltd. Cassiar Gold Property;
Private Report to Dorchester Resources
Ltd.
- Westervelt, R. D. (1965): - Summary Report on the Hanna Gold
Mines Property, Cassiar, B. C.;
Private Report to Newconnex Canadian
Exploration Ltd.
- Clarke, W. E. (1963): - Report of Examination of Hanna Gold
Mines Property, Cassiar, B. C.;
Private Report for Discovery Gold
Mines Ltd.
- Howard, H. M. (1963): - Hanna Gold Mines, Metallurgical
Report; Private Report for Hanna
Gold Mines Ltd.
- Personal Communication: - M. M. Rahal, Kamloops, B. C.
- Various Files of Dorchester Resources Ltd.

A P P E N D I X G

WRITER'S CERTIFICATE

JAMES M. DAWSON, P. ENG.
GEOLOGIST

9-219 VICTORIA STREET
KAMLOOPS, B.C.

PHONE (604) 374-6427

CERTIFICATE

I, JAMES M. DAWSON, OF KAMLOOPS, B. C. DO HEREBY CERTIFY THAT:

- (1). I am a geologist residing at 2753 Sunset Drive, Kamloops and employed by Kerr, Dawson and Associates Ltd. of Suite #1 - 219 Victoria Street, Kamloops, B. C.
- (2). I am a graduate of the Memorial University of Newfoundland - B. Sc. (1960), M. Sc. (1963), a fellow of the Geological Association of Canada and a member of the Association of Professional Engineers of B. C. I have practised my profession for 12 years.
- (3). I am the author of this report which is based on an exploration programme that included underground diamond drilling and was carried out on the Dorchester Gold group of claims.
- (4). I have no beneficial interest in Dorchester Resources Ltd. (N. P. L.) or in the property discussed in this report, nor do I expect to receive any.

KERR, DAWSON & ASSOCIATES LTD.,



James M. Dawson
James M. Dawson, M. Sc., P. Eng.,
GEOLOGIST

Kamloops, B. C.,
June 28th., 1975.

196 X - C N

DRILL HOLE SIZE : B Q
BEARING : 028° T
DIP : - 43°

| Au oz/T | Ag oz/T |
|---------|---------|
| 0.04 | 0.02 |
| Tr. | Tr. |
| Tr. | Tr. |
| Tr. | Tr. |
| Tr. | Tr. |
| Tr. | Tr. |
| Tr. | Tr. |
| Tr. | Tr. |
| Tr. | Tr. |
| Tr. | Tr. |
| 0.005 | 0.01 |
| Tr. | 0.02 |
| 0.005 | 0.01 |
| Tr. | Tr. |

Department of
Mines and Petroleum Resources
ASSESSMENT REPORT

NO. 5493 MAP 6



DORCHESTER RESOURCES LTD. (N.P.L.)

1100 - 235 FIRST AVENUE, KAMLOOPS, B.C.

DORCHESTER GOLD PROPERTY

ASSAY PLAN

DRILL HOLE No. 75 - 3

CASSIAR AREA

LIARD MINING DIVISION - BRITISH COLUMBIA

Tech. Work By :
KERR - DAWSON & ASSOCS. LTD.

Scale : 1" = 20'

Drawn By : T. V.

Date : JUNE 25, 1975.

Approved By : J.M.DAWSON, P.Eng.

Drawing No. 107 - 5

To Accompany A Report By J. M. DAWSON, P. Eng.

299' BOTTOM
OF HOLE

5493
MAP 6

DRILL HOLE SIZE : BQ
BEARING : 287° T
DIP : -35°

220 X - C S

| Au 02/T Ag 02/T | |
|-----------------|------|
| Tt. | Tt. |
| 0.03 | 0.01 |
| 0.33 | 0.07 |
| 0.14 | 0.04 |
| 0.04 | 0.02 |
| 0.075 | 0.03 |
| 0.060 | 0.02 |

Department of
Mines and Petroleum Resources
ASSESSMENT REPORT

NO. 5493 MAP 4

121' BOTTOM OF HOLE



DORCHESTER RESOURCES LTD. (N.P.L.)

1100 - 235 FIRST AVENUE, KAMLOOPS, B.C.

DORCHESTER GOLD PROPERTY

ASSAY PLAN

DRILL HOLE No. 75 - 1

CASSIAR AREA

LIARD MINING DIVISION - BRITISH COLUMBIA

Tech. Work By :
KERR - DAWSON & ASSOCS. LTD.

Scale : 1" = 20'

Drawn By : T. V.

Date : JUNE 25, 1975.

Approved By : J.M. DAWSON, P.Eng.

Drawing No. 107 - 6

To Accompany A Report By J. M. DAWSON, P. Eng.

5493
MAP 4

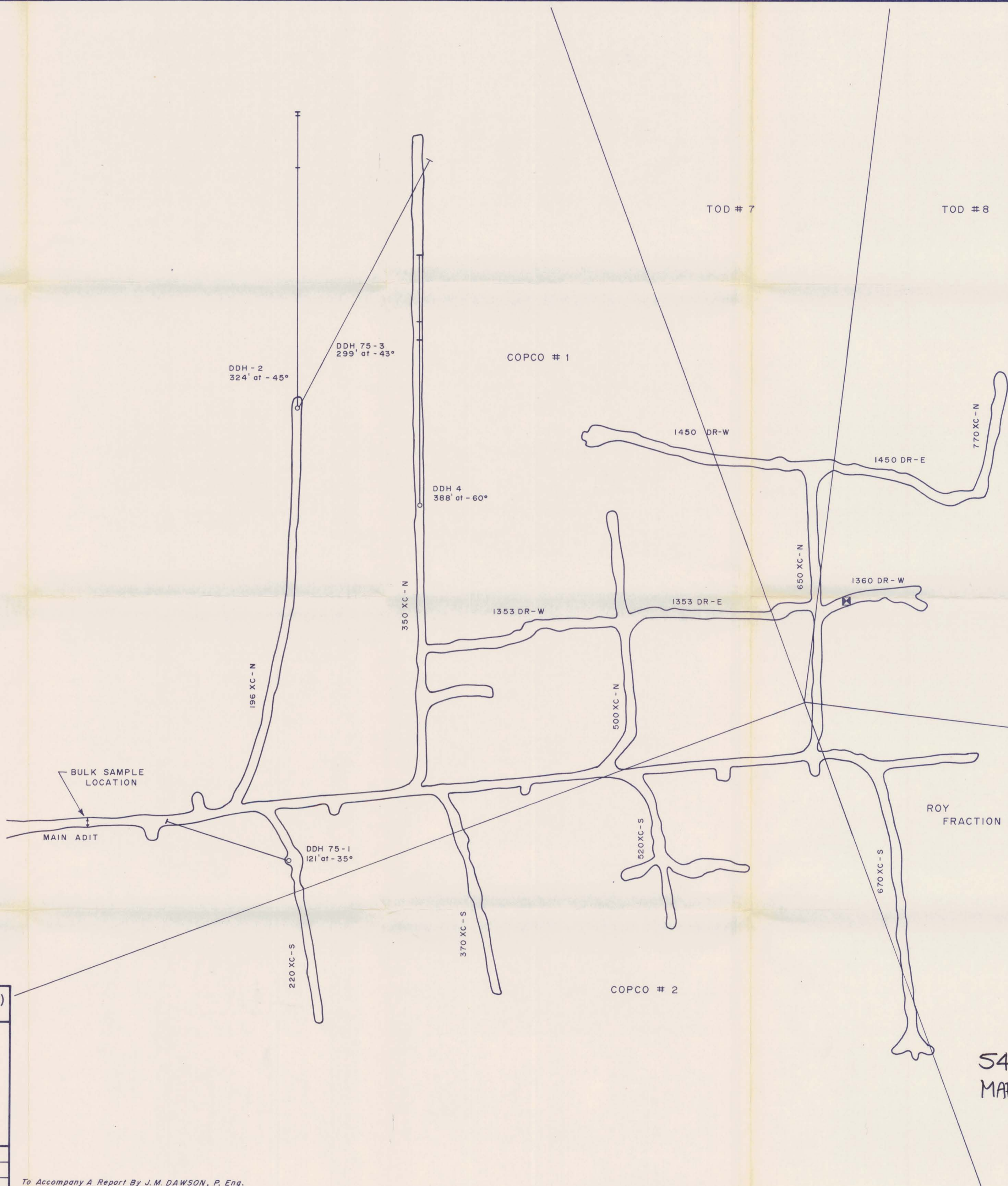

Department of
Mines and Petroleum Resources
ASSESSMENT REPORT
NO. 5493 MAP 3



DORCHESTER RESOURCES LTD. (N.P.L.)
1100 - 235 FIRST AVENUE, KAMLOOPS, B.C.

PLAN OF UNDERGROUND WORKINGS
DORCHESTER GOLD PROPERTY
CASSIAR DISTRICT
LIARD MINING DIVISION - BRITISH COLUMBIA

| | |
|--|---------------------|
| Tech. Work By: KERR - DAWSON & ASSOCS. LTD. | Scale: 1" = 40' |
| Drawn By: T. V. | Date: JUNE 5, 1975 |
| Approved By: | Drawing No. 107 - 3 |

To Accompany A Report By J. M. DAWSON, P. Eng.

5493
MAP 3