

DON TULLY ENGINEERING LTD  
SUITE 102 - 2222 BELLEVUE AVENUE  
WEST VANCOUVER, BRITISH COLUMBIA  
V7V 1C7

5512

ASSESSMENT REPORT

on the

#5512

104B/8W

D.O.C. #1,3,4,11-13,27-32  
RECORD NOS. 37736E-8E, 37745E, 38052M-3M, 38929M-34M  
SOUTH UNUK RIVER AREA  
SKEENA MINING DIVISION  
STEWART, BRITISH COLUMBIA

56°-16<sup>3</sup> N. LAT.  
20

130°-29<sup>3</sup> W. LONG.  
27

104 B/8W  
CLAIMS - DOC GROUP

for

NEW MINEX RESOURCES LTD.  
202 - 640 WEST HASTINGS STREET  
VANCOUVER, BRITISH COLUMBIA

Department of  
Mines and Petroleum Resources  
ASSESSMENT REPORT  
NO. 5512 MAP

by

DONALD W. TULLY, P.ENG.

JUNE 30, 1975

WEST VANCOUVER, B.C.



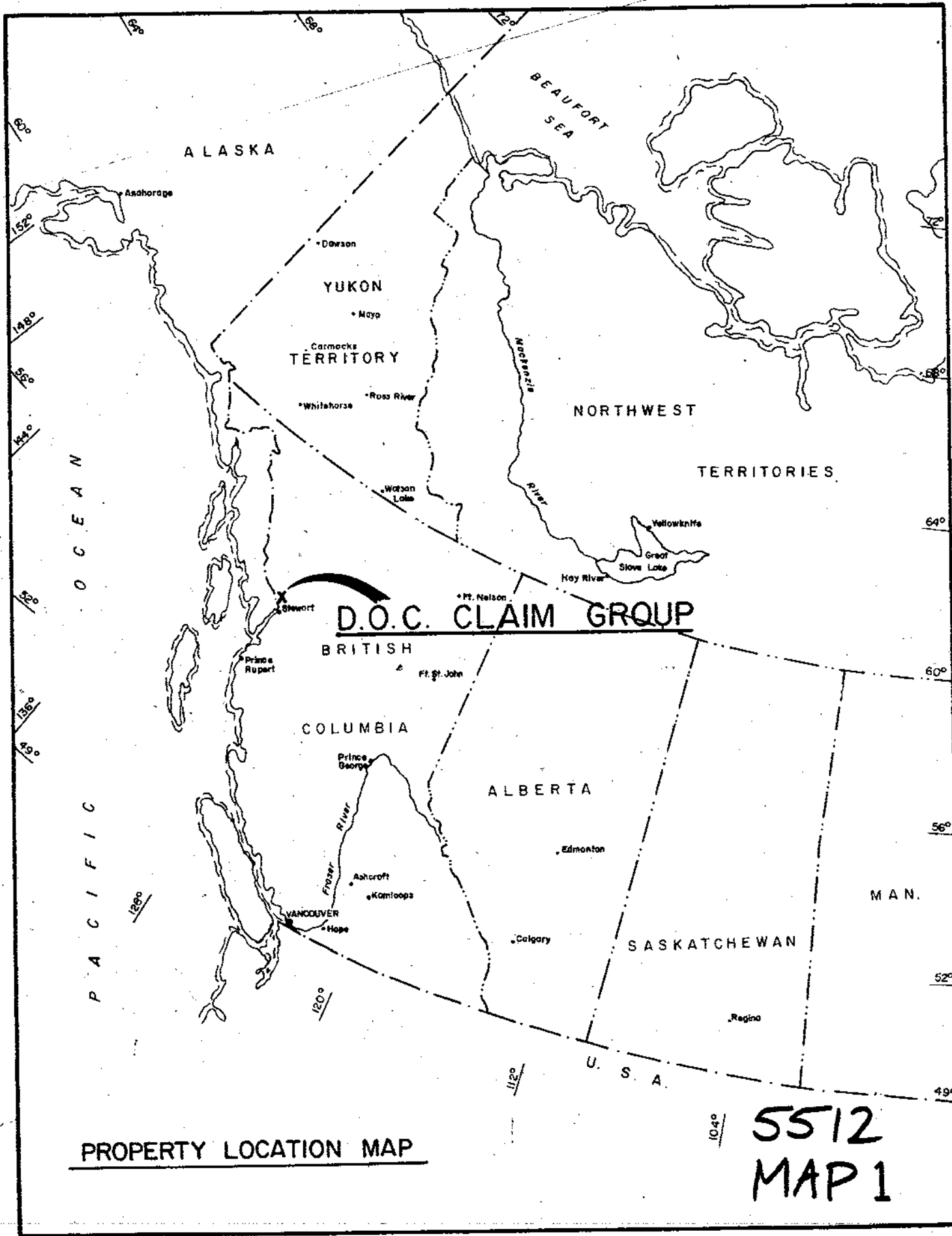

PROPERTY LOCATION MAP

1040  
**5512  
MAP 1**

### INTRODUCTION

This report was prepared at the request of New Minex Resources Ltd., Suite 202 - 640 West Hastings Street, Vancouver, British Columbia, to fulfil the assessment work requirements of the British Columbia Department of Mines and Petroleum Resources.

Work was performed by Mr. Uno Leis of Strato Geological Ltd. and the writer during the period June 7th to 16th, 1975 inclusive.

19.1 kilometres of Ronka EM-16 electromagnetic traversing were completed in the general area of the strike of the quartz vein structures with 249 reading stations mostly at 50 metre intervals.

### SUMMARY AND CONCLUSIONS

The electromagnetic work shows no apparent response to known gold-bearing quartz-vein structures. The sulphide (pyrite, galena, sphalerite and minor chalcopyrite) content appears to be too low to respond electromagnetically.

An apparent conductor in a snow-field area in the north corner of D.O.C. claim #32 is noted.

Geological mapping is warranted when summer conditions prevail to further prospect the potential of the property prior to any further exploration work.

PROPERTY - LOCATION, ACCESS, TOPOGRAPHY

The property is situated on the east flank of the Coast Mountains.

Nineteen mineral claims comprise the property which is located eight miles northwest of the Leduc Portal at Granduc Mines and about thirty miles in a direct line northwest of Stewart, British Columbia, in the Skeena Mining Division.

Helicopter access from Stewart, B.C., is the best means of travel. A former bulldozer trail is visible from the air leading from the Leduc Portal area at the Granduc Mine traversing the Leduc Glacier and trending northward along the headwaters of the South Fork of the Unuk River to a former sawmill site at the mouth of Divilbliss (Cabin) Creek. Early prospecting activity on the claims was achieved through access by boat from Burroughs Bay, Alaska, to the Canadian Border area and a fifty-mile hike thence to the property along the Unuk and the South Fork of the Unuk River.

Elevations over the claim group vary from 3800 to 4500 feet above sea-level.

Above 4000 feet the property is generally glaciated and free of vegetation. Remnants of glaciers still remain on the upper reaches of the claims.

CLAIMS

The claims are situated in the Skeena Mining Division. The following information is on file with the British Columbia Department of Mines and Petroleum Resources:

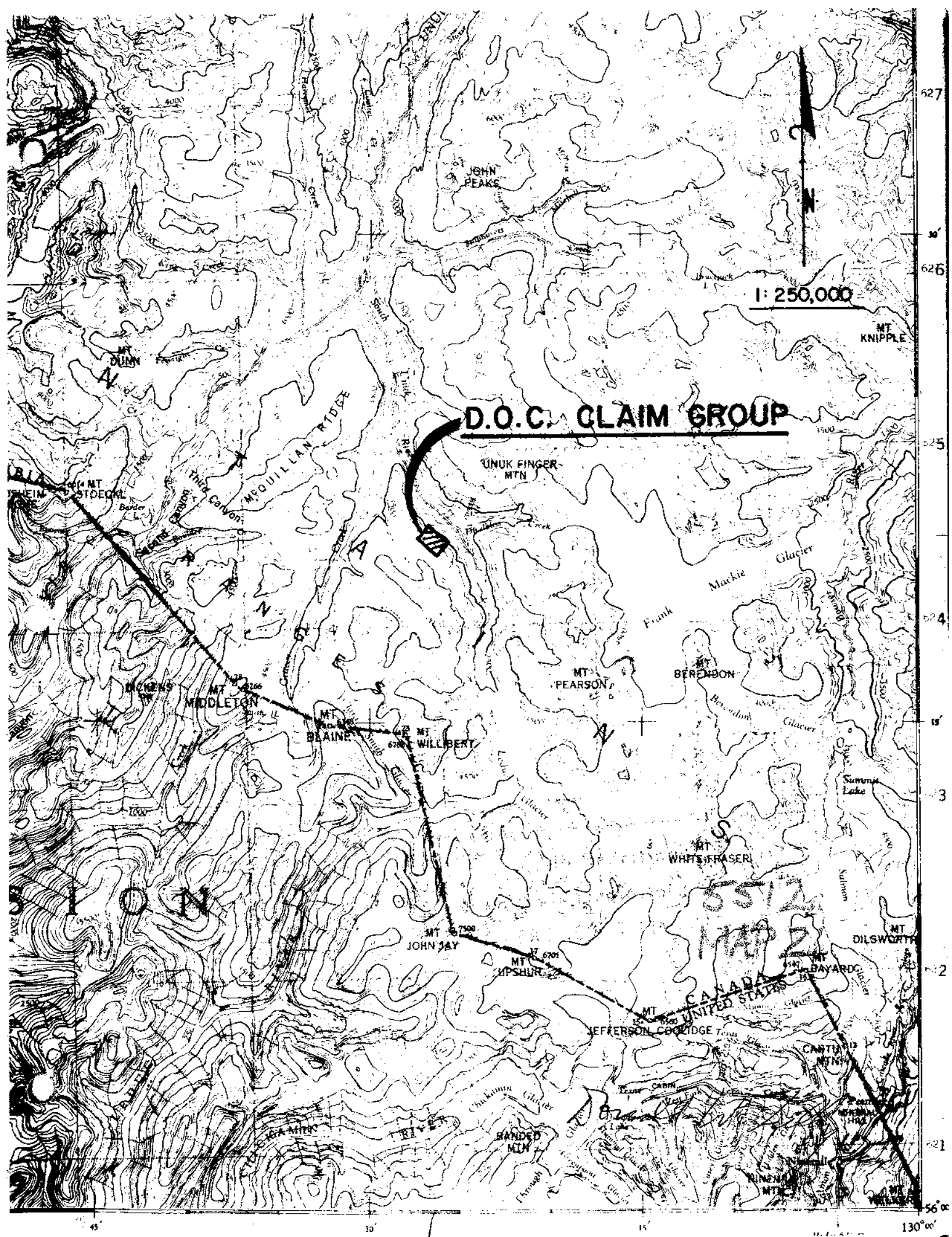

1:250,000

**D.O.C. CLAIM GROUP**

527  
526  
525  
524  
523  
522  
521  
56°

45 30 15 130°

<u>CLAIM NAME</u>	<u>RECORD NUMBER</u>	<u>RECORDED HOLDER</u>
D.O.C. #1	37736E	T. J. McQuillan
" #3	37E	" "
" #4	38E	" "
" #11	37745E	" "
" #12	38052M	New Minex Resources Ltd.
" #13	53M	" "
" #14	54M	" "
" #15	55M	" "
" #17	38057M	" "
" #19	38059M	" "
" #21	38061M	" "
" #25	38927M	" "
" #26	28M	" "
" #27	29M	" "
" #28	30M	" "
" #29	31M	" "
" #30	32M	" "
" #31	33M	" "
" #32	38934M	" "

HISTORY - PREVIOUS DEVELOPMENT

In 1946, Thomas J. McQuillan and his partner, Pat Onhasy, staked the Gracey group of claims between Gracey Creek and the South Fork of the Unuk River opposite Divilbliss (Cabin) Creek. More than twenty quartz veins were sampled. Some of these assayed over half an ounce of gold with minor values in gold and silver.

Halport Mines Limited acquired the Gracey claims in 1947 and did considerable exploration work. Most of the equipment and supplies were flown from Stewart and air-dropped at the

D.O.C. CLAIMS

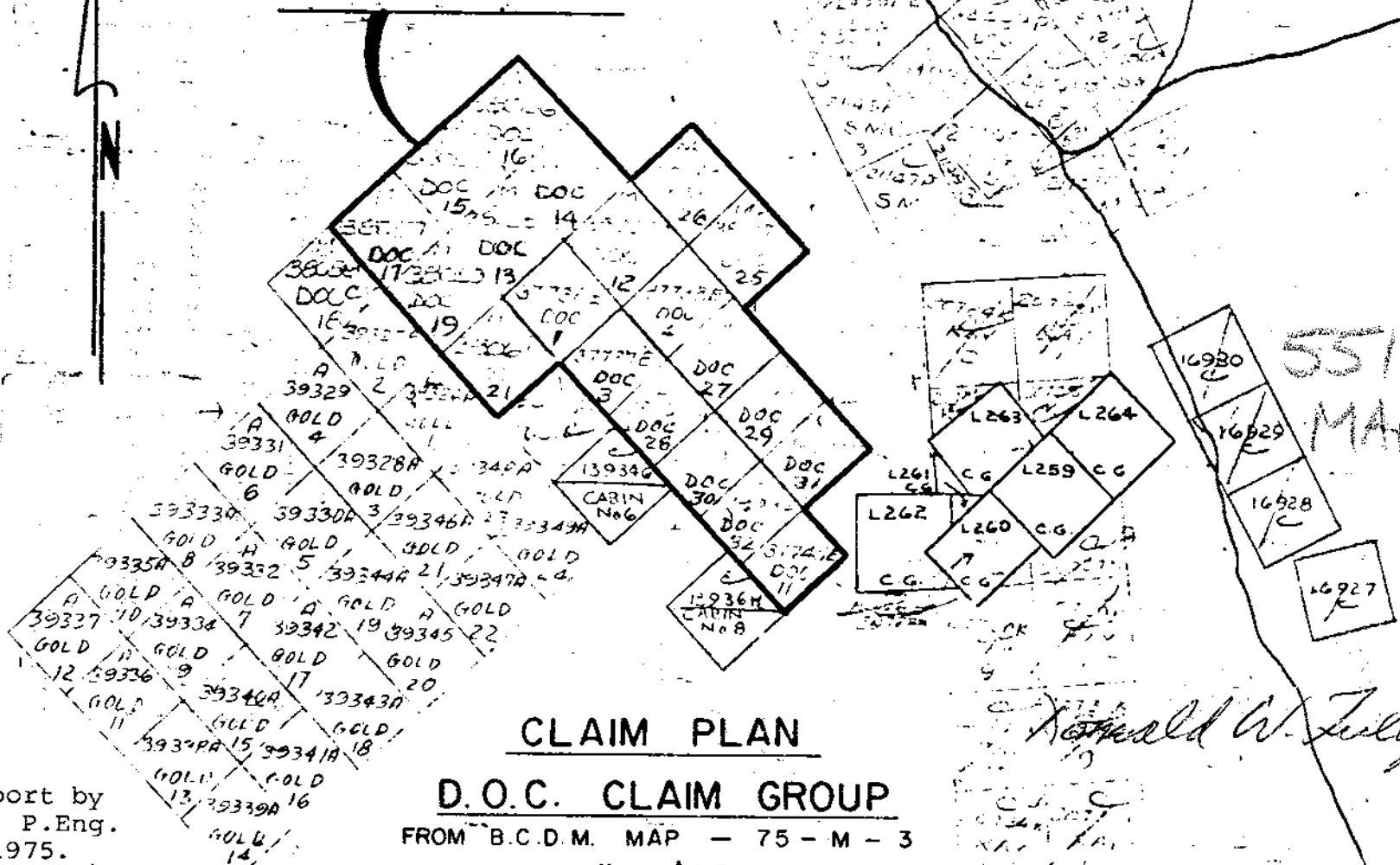

CLAIM PLAN

D.O.C. CLAIM GROUP

FROM B.C.D.M. MAP - 75 - M - 3

Scale: 1" = 1/2 mile (APPROX.)

*Donald W. Tully*

To accompany report by  
Donald W. Tully, P.Eng.  
dated June 30, 1975.



work site for this program.

Surface trenching was done on several quartz veins in 1947 and 1948. In 1948 two of these veins were diamond drilled and this work plus further trenching appeared to indicate that the two veins were actually the same, being separated by a minor fault. In all, 19 EX holes were drilled for a total footage of 4,230 feet. This work was stated to prove the persistence of the Q-17 lode for a strike length of 1250 feet and to a depth of 250 feet.

In 1949 ten holes were diamond drilled for a total footage of 2044 feet on the Q-25 lode.

Coring of the vein material was somewhat less than satisfactory. The quartz cored reasonably well but the sheared margins of the veins (where the values are apparently concentrated) cored poorly. In addition, sludges were not recovered and thus the diamond drilling results to date are not quantitatively conclusive. They did indicate economically (at \$35 gold) interesting gold (plus silver) values across widths up to 5.8 feet.

Most of the results of the diamond drilling by Halport Mines are not immediately available.

Magnetometer surveying and channel sampling was done in 1974 on the Q-17 vein.

#### GENERAL GEOLOGY

The D.O.C. Claim group is underlain by sediments and intrusives of the Coast Intrusions Group.

Limestone, argillite, siltstone and tuff are the main lithological units observed on the property. Intrusives are mainly dikes of aplite, felsite, syenite, gneissic diorite and lamprophyre and a small plug of diorite which underlies a magnetic anomaly on D.O.C. claim #1.

Strikes of the sediments are generally along a northwest trend with local dragfolded areas. Dips vary from southwest to northeast suggesting the presence of local fold-axes. Dikes of intrusive trend both northwesterly and northeasterly suggesting these filled a post-folding tension fracture pattern.

Vein structures strike northwesterly and dip at angles above 60 degrees to the northeast.

#### MINERALIZATION

Mineralization is generally restricted to quartz vein structures. Hematite, specularite, pyrite, galena, sphalerite and free gold are present in that order of apparent abundance.

The main vein is Q-17. This vein is exposed in previously dug trenches and pits.

A second vein (Q-25) rich in gold and silver was noted in a sample taken in the 1974 field season.

#### ELECTROMAGNETIC SURVEY

The instrument used was Ronka #3329 manufactured by Geonics Ltd., Toronto, Ontario.

The period of the survey was between June 7th and June 16th, 1975.

CONTROL PROCEDURE:

A baseline was established in a direction southeast (True azimuth  $133^{\circ}$ ) from a small lake on D.O.C. claim #13. Points were marked using a chain and compass at every 50 metre interval along the baseline with red flagging at marker points for a distance of 3200 metres.

Chain and compass lines were run at 50 or 100 metres apart, on true azimuth  $43^{\circ}$  and true azimuth  $223^{\circ}$ . Electromagnetic readings were taken mostly at 50-metre intervals along these lines and occasionally at lesser intervals, where deemed necessary. Because of the open and snow-covered nature of the terrain intervisibility of points established as the progress permitted relatively easy control of the tie-in closures on the survey. 19.1 kilometres of line were surveyed. 249 station readings were taken.

The survey covered for the most part the area of D.O.C. claims #1, 3, 13, 28, 30 and parts of #11, 12, 31 and 32.

RESULTS:

The results are plotted on the plan on scale 1 cm = 20 metres accompanying this report.

No electromagnetic conductors are apparent except a small zone in the north corner of D.O.C. claim #32.

Known gold-bearing quartz veins apparently do not contain enough sulphides to cause an electromagnetic response, i.e. Q-17 and Q-25 veins.

June 30, 1975

Respectfully submitted,

DON TULLY ENGINEERING LTD.  
SUITE 102 - 2222 BELLEVUE AVENUE  
WEST VANCOUVER BRITISH COLUMBIA  
V7V 1C7

*Donald W. Tully*  
Donald W. Tully, P.Eng.

TIME - COST DISTRIBUTION

<u>Description</u>	<u>Cost Detail</u>	<u>Amount</u>
Don Tully Engineering Ltd.	- field supplies, travel costs and equipment rental	\$1,373.32
Vancouver Island Helicopters	- transportation	\$ 951.28
Donald W. Tully	- wages and report preparation	\$1,250.00
Don Tully Engineering Ltd.	- maps, drafting and printing	\$ 233.67
TOTAL.....		\$3,808.27
		=====

STATUTORY DECLARATION

*168M* I, DONALD WILLIAM TULLY, do hereby make oath and swear that *the contents of the foregoing report are true and* I make this solemn declaration conscientiously believing it to be true, and knowing that it is of the same force and effect as if made under oath and by virtue of the "Canada Evidence Act".

DECLARED before me at the City )  
of Vancouver, in the Province )  
of British Columbia, this 3rd )  
day of July, 1975. )

*Donald W. Tully*  
DONALD W. TULLY

*H. R. Armer*  
A Commissioner for the Province of British Columbia )

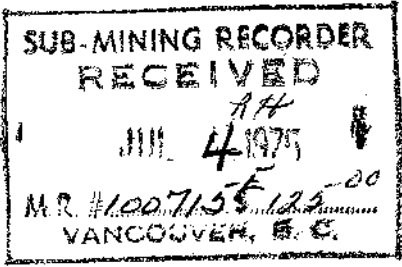

CERTIFICATE

I, DONALD WILLIAM TULLY, of the Municipality of West Vancouver, in the Province of British Columbia, hereby certify as follows:

1. I am a Consulting Geologist with an office at Suite 102, 2222 Bellevue Avenue, West Vancouver, British Columbia.
2. I am a registered Professional Engineer in the Provinces of British Columbia and Ontario.
3. I graduated with a degree of Bachelor of Science, Honours Geology, from McGill University, in 1943.
4. I have practiced my profession for thirty years.
5. I have a direct interest in the D.O.C. mineral claims and the shares of NEW MINEX RESOURCES LIMITED.
6. This report dated June 30, 1975 is based on a personal examination of the ground and assistance in performance of the work in the period June 7th through June 16th, 1975.

DATED at West Vancouver, British Columbia, this 30th day of June, 1975.

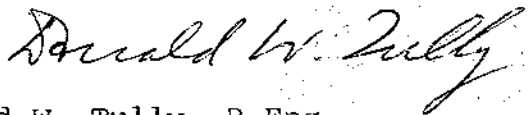

Donald W. Tully, P.Eng.  
Consulting Geologist



950 E 1000 E 1050 E 1100 E 1150 E 1200 E 1250 E 1300 E 1350 E 1400 E 1450 E 1500 E 1550 E 1600 E 1650 E 1700 E 1750 E 1800 E 1850 E 1900 E 1950 E 2000 E 2050 E 2100 E 2150 E 2200 E 2250 E 2300 E 2350 E 2400 E 2450 E 2500 E 2550 E 2600 E 2650 E 2700 E 2750 E 2800 E 2850 E 2900 E 2950 E 3000 E 3050 E 3100 E 3150 E 3200 E

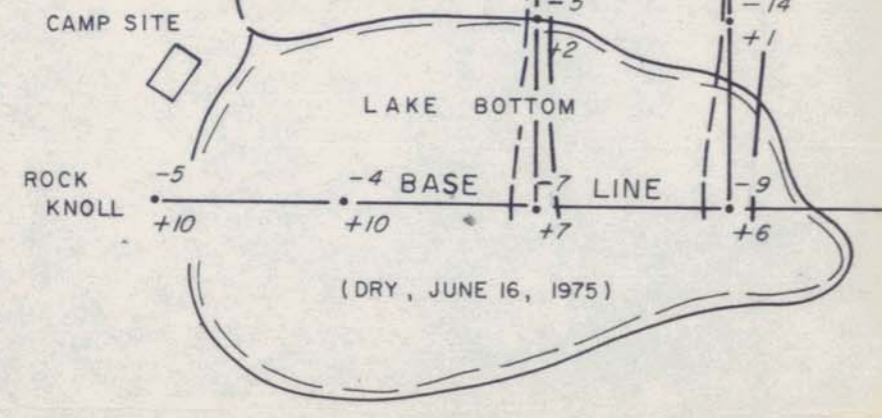
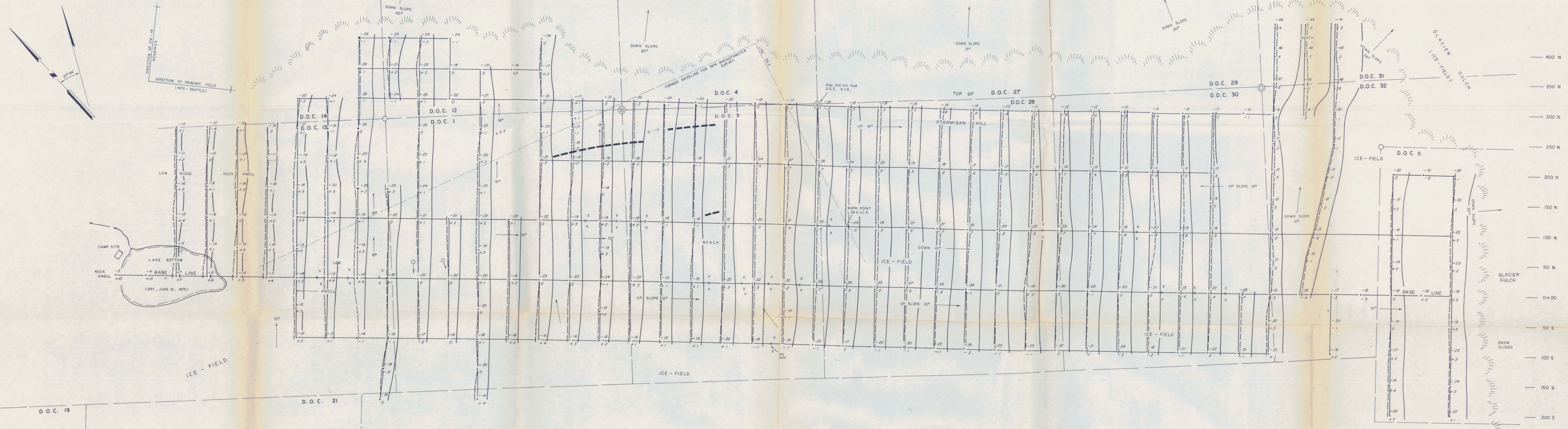

**LEGEND and SYMBOLS**

- CLAIM POST - POSITION ESTABLISHED - ASSUMED
- CLAIM LINE
- CHAIN AND COMPASS LINE WITH FLAGGED STATIONS
- RONKA EM-16 READINGS IN-PHASE QUADRATURE (PROFILE LINE)
- APPROX. BOUNDARY OF PRECIPITOUS AREA
- CREEK
- ROCK OUTCROP AREA
- DIRECTION OF SLOPE
- GOLD-BEARING VEIN
- OLD D.D. HOLE LOCATION

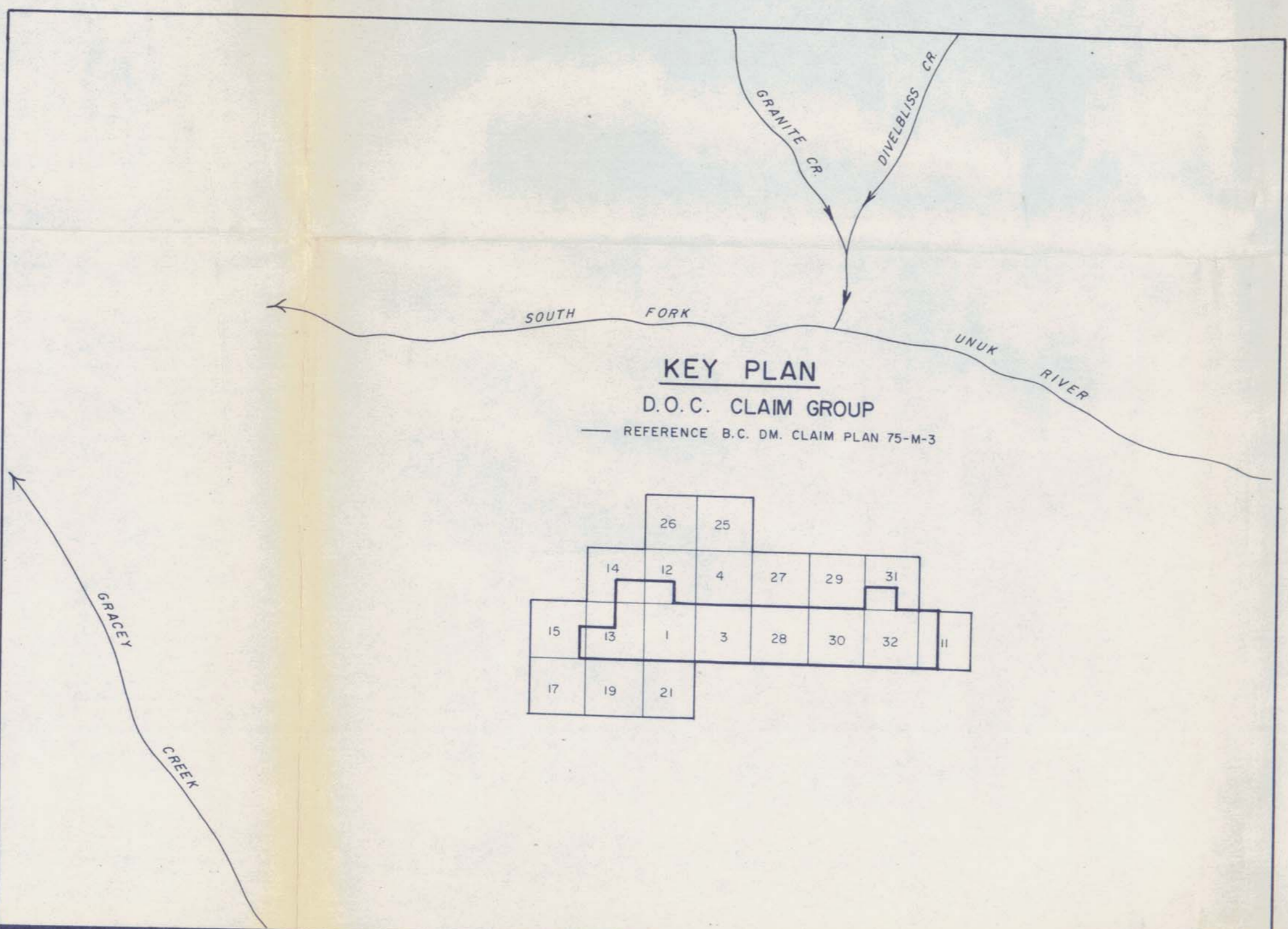

Department of  
Mines and Petroleum Resources  
ASSESSMENT REPORT  
NO. 5512 MAP 4

**NEW MINEX RESOURCES LTD.**

PLAN

PART OF D.O.C. CLAIM GROUP  
SKEENA MINING DIVISION - STEWART, B.C.

SHOWING

RONKA EM-16 ELECTROMAGNETIC READINGS  
WITH  
IN-PHASE AND QUADRATURE PROFILES

Scale: 1 cm = 20 metres - June 30, 1975

Field Readings and Plan Prepared by: STRATO GEOLOGICAL LTD.  
39-448 SEYMOUR STREET, VANCOUVER, B.C.

TO ACCOMPANY REPORT DATED JUNE 30, 1975 BY DONALD W. TULLY, P.Eng.

5512  
MAP 4

Donald W. Tully