

# 5525

DIAMOND DRILLING REPORT

Quis Mineral Claims 7 miles N.E. of Beaverdell

Greenwood Mining Division, British Columbia

Lat. 49° 34' N Long. 119° <sup>01'</sup> W N.T.S. 82E/11E

82E/11E

Owner-A uthor: H.O. Plank, Prospector

Driller: L.G. Haldey and H.O. Plank

Date of Work: October 23 - 28, 1974

Date of Report: June 2, 1975

Department of Mines and Petroleum Resources ASSESSMENT REPORT NO. <u>5525</u> MAP.....
---

C O N T E N T S:

	<u>Page</u>
Introduction . . . . .	1
Property, Location and Access . . . .	1
Previous Work . . . . .	1
Diamond Drilling and Cost Statement .	2
Drill Hole Location . . . . .	2
Diamond Drill Core Log . . . . .	2
Location of Core Storage . . . . .	2
Statement of Qualifications . . . . .	3
Index Maps . . . . .	4

# 1 - CLAIM MAP

# 2 - LOCATION MAP

INTRODUCTION:

From October 23 - 28, 1974, L. Hadley and H.O. Plank, Prospectors, conducted a limited amount of diamond core drilling on the Quis 3 Mineral Claim, N.E. of Beaverdell area, owned by H.O. Plank.

The purpose of the drilling was to examine a previously conducted electromagnetic survey with high anomalies conductor zones for minerals.

PROPERTY, LOCATION AND ACCESS:

The Quis 3 Mineral Claim is located some seven miles north-east of St. Johan Creek, at an elevation of 4,400 feet, Greenwood Mining Division, Lat.  $49^{\circ} 34' N$  Long.  $119^{\circ} 01' W$  N.T.S. 82E/11, the Province of British Columbia.

Access to the property is by a secondary gravel road, which passes through Mineral Claim 3 Quis.

PREVIOUS WORK:

This property is discussed in several of the Minister of Mines Reports and is known as the Rosemont property. A number of trenches and pits were dug in the early thirties in search for gold and silver which seemed to be associated with pyrite, pyrrhotite and minor chalcopyrite mineralization. The property was then worked by Highland Bell Ltd., who shipped several small shipments of gold and silver ore. The property has reportedly over 400 feet of underground development work completed on it.

DIAMOND DRILLING AND COST STATEMENT:

2 men working 6 days (84 hours @ \$5.00 per hour)	\$420.00
1 Pack Sack Diamond Drill 1 Water Pump (both on rental basis)	\$190.00
Diamond Bits	\$225.00
Transportation, Gas, Oil, Misc.	<u>\$114.00</u>
Total cost for 86 feet of drilling:	<u>\$949.00</u>

DIAMOND DRILL CORE LOG:

Drill core recovery on all 86 feet were good. One drill hole 47 feet and one drill hole 39 feet. All were in ganitized sediments of the Wallace formation.

DRILL HOLE LOCATION:

It is 300 feet east and 700 feet south of the north-west corner of Quis 3 Mineral Claim.

The elevation is approx. 4,400 feet, drill hole inclination of two holes are 90°.

LOCATION OF THE CORE STORAGE:

The cores are stored in a cabin 200 feet north and 60 feet west of south-east corner of Quis 3 Mineral Claim.

STATEMENT OF QUALIFICATIONS

Name: Herman O. Plank  
Profession: Prospector  
Experience: Prospecting and Mining and  
Diamond drilling since 1956  
to present time.  
Active experience:  
Torwest Resources Limited  
Craigmont Mine Limited  
Rio Tinto Canada Limited  
Stella Metal Limited  
Highland Bell Limited  
Austro-Can Explorations Limited  
Interior Diamond Drilling Limited

DATED AT Penticton, British Columbia, this 2nd day of June 1975  
at Post Office Box 413.

Signed:

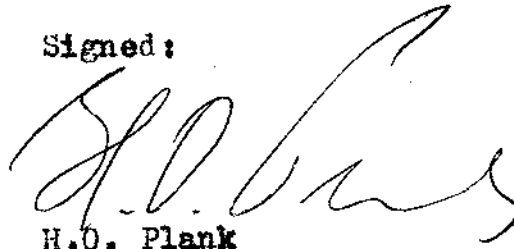

H.O. Plank

Department of  
Mines and Petroleum Resources  
ASSESSMENT REPORT  
NO. 5525 MAP 1

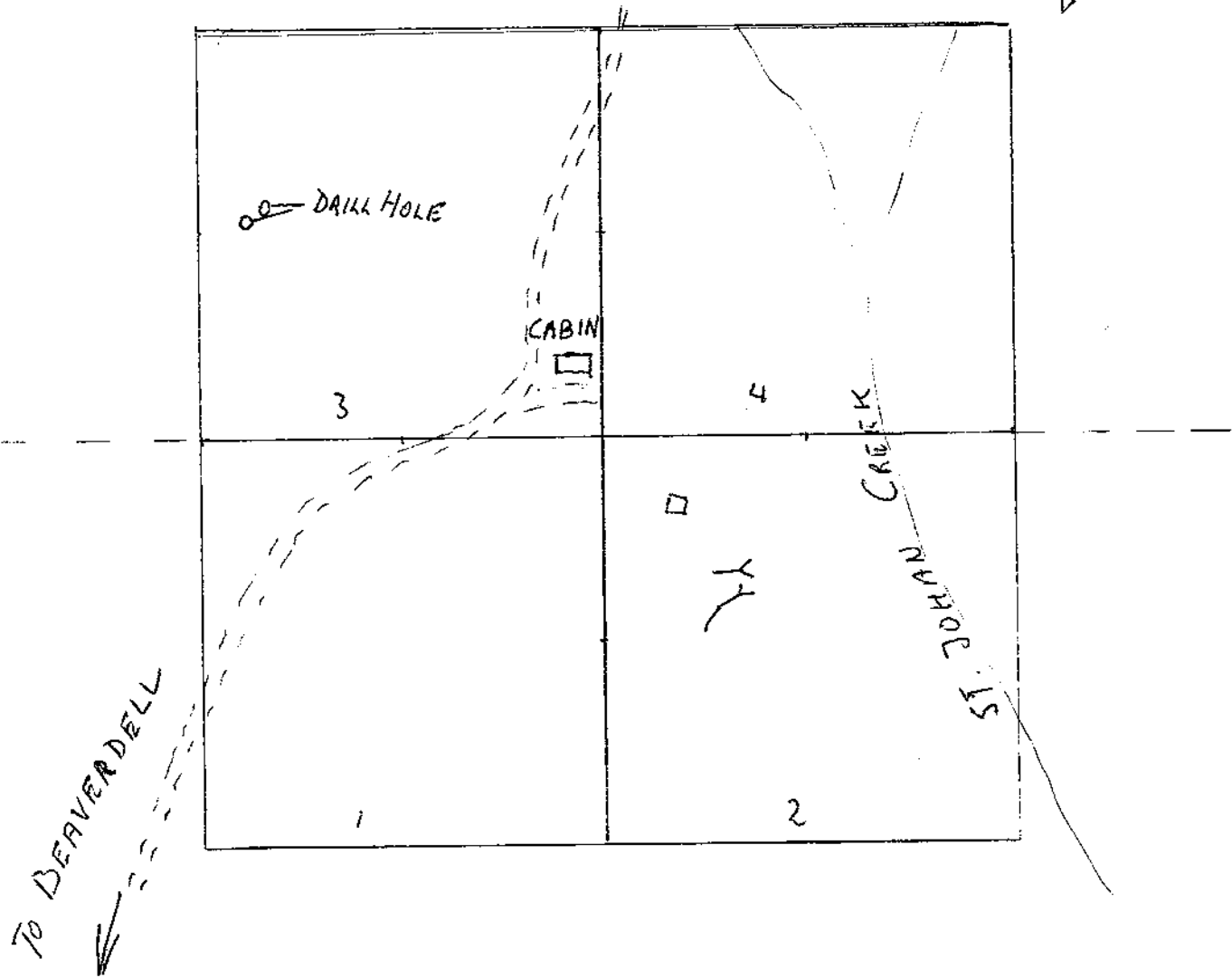
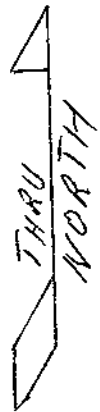

QUIS 1-4 CLAIMS

SCALE 1 INCH TO 750'

OWNER H.D. PLANK

5525  
MAP 1



ÉCHELLE DES COURBES 100 PIEDS  
 100 pieds au-dessus du niveau moyen de la mer  
 de référence nord-américain 1927  
 projection transverse de Mercator

Les noms inscrits sur cette carte ne sont  
 pas officiels. La Direction des levés et  
 de la cartographie saurait gré au public de lui  
 adresser des corrections et additions.  
 L'erreur provisable est l'équivalente d'une  
 ligne au point de vue précision de  
 l'échelle.

Rédigée en 1964, par la DIRECTION DES LEVÉS ET DE LA CARTOGRAPHIE,  
 MINISTÈRE DE L'ÉNERGIE, DES MINES ET DES RESSOURCES, à partir des  
 photographies aériennes prises en 1959. Levés sur le terrain et vérification des relevés en  
 1960 imprimée en 1968.

Ces cartes sont en vente au Bureau de distribution des cartes,  
 ministère de l'Énergie, des Mines et des Ressources, Ottawa.

QUIS 1-4  
 H.O. PLANK

5525  
 MAP 2