

December 2, 1974.

Twin Peak Resources Ltd.,
5424 Halifax street,
Burnaby, B. C.
V5B 2N7

JILL JOINT VENTURE

Invoice # 7 - Jill Project

CHARGES FOR OCTOBER 1974 -

<u>Personnel</u>	<u>No. of man days</u>	<u>Rate</u>	
Geologist	20	\$100	\$ 2,000.00
Helper	6	30	180.00
			<hr/>
			2,180.00
<u>Equipment</u>			
Field Office			200.00
Power Saw	6	8	48.00
Mobile Camp			300.00
			<hr/>
			548.00
<u>Disbursements</u>		<u>Chq #.</u>	
Expendable hardware, supplies, accommodation, meals, etc. -			
Lakeside Motel (1974)		350	225.00
Tyee Motor Hotel Ltd.		370	22.60
Goodacres' Stores Ltd.		371	200.52
Art Johnson Agencies Ltd.		373	37.52
Smithers Super Service Ltd.		375	41.11
Canadian Propane Gas & Oil Ltd.		376	63.15
			<hr/>
Carried Forward			\$ 3,317.90

CHARGES FOR OCTOBER 1974 -

Disbursements (continued)

	<u>Chq #.</u>	
Brought Forward		\$ 3,317.90
Assays -		
Coots-Coddington <i>Thin sections</i>	372	79.80
Telephone -		
B.C. Telephone	382	69.46
B.C. Telephone	383	12.45
Truck rental -		
Groot & DenBoer Trucking	374	420.00
Freight -		
Canadian Freightways Ltd.	357	28.90
Travel -		
Mackenzie Travel Service	354	112.00
Nechako Airways Ltd.	361	45.00
Backhoe rental -		
Hidber Bros.	377	2,100.00
		<hr/>
Total invoice		\$ 6,185.51
		<hr/> <hr/>

E & O E

December 2, 1974.

Twin Peak Resources Ltd.,
5424 Halifax Street,
Burnaby, B. C.
V5B 2N7

JILL JOINT VENTURE

Invoice # 8 - Jill Project

DIAMOND DRILLING TO NOVEMBER 20, 1974 -

H. Allen Diamond Drilling Ltd.,

\$ 9,367.40

E & O E

, P. Eng.

January 21, 1975.

Twin Peak Resources Ltd.,
5424 Halifax St.,
BURNABY, B. C.
V5B 2N7

JILL JOINT VENTURE

Invoice # 9 - Jill Project

CHARGES FOR NOVEMBER 1974 -

<u>Personnel</u>	<u>No. of man days</u>	<u>Rate</u>	
Geologist	12	\$100	\$ 1,200.00
Helper	2	30	60.00
			<hr/>
			1,260.00

Disbursements

Chq #

Expendable hardware, supplies,
accommodation, meals, etc. -

Lakeside Motel(1974)	381	225.00 ✓
Goodacres' Stores Ltd.	401	160.24 ✓
Versatile Industries Ltd.	398	18.90 ✓
Canadian Propane Gas & Oil	402	40.00 ✓
Art Johnson Agencies Ltd.	403	40.68 ✓
Smithers Super Service Ltd.	405	69.14 ✓
DDS Ltd.	421	3.70 ✓
South Cariboo Food Market	RW #65	4.64
Chilcotin Inn	RW #65	13.13 ✓
Meals	RW #65	11.00
Marshall Wells	RW #65	3.02
Groceries	RW #66	5.39

Carried Forward

\$ 1,854.84

CHARGES FOR NOVEMBER 1974 -

Disbursements Continued

	<u>Chq #</u>	<u>\$</u>
Brought Forward		1,854.84
Assays -		
Coots-Coddington <i>Thin sections</i>	397	184.00 ✓
Telephone -		
B.C. Telephone	410	30.59 ✓
B.C. Telephone	411	26.33 ✓
Recording, rental fees etc. -		
Mining Recorder	RW #65	155.00 ✓
Truck Rental -		
Groot & Den Boer Trucking	420	210.00 ✓
Freight -		
Canadian Freightways Ltd	384	47.56 ✓
Greyhound	RW #65	13.65
Canadian Freightways Ltd.	RW #65	16.80 ✓
Greyhound	RW #66	2.75
Travel -		
Cab fare	RW #65	12.00 ✓
Cab fare	RW #66	12.00 ✓
Backhoe rental -		
Hidber Bros.	419	1,000.00 ✓
		<hr/>
Total invoice		\$ 3,565.52 ✓
		<hr/> <hr/>

Evergreen Explorations Ltd.

2007 STATION AT 5120 - Halifax
 Borehole Sheet 1

PROPERTY JACOB DRILL HOLE 1
 LATITUDE 93L/9W DATE STARTED October 30, 1974
 DEPARTURE _____ DATE COMPLETED October 31, 1974
 DIP -90° DRILLED BY J. Thomas (H. Allen)
 ELEVATION _____ LOGGED BY R. W. Woolverton

PRELIMINARY LOG

Depth	Geology	Sample No	Width		
1 - 35	Casing (left in place)				
35 - 95	Tuff-breccia, reddish, met. hematite, calcite fractures, very weakly to non magnetic, most fragments are andesite porph. fairly crumbly, a 6" bleached zone (45° to core axis) at 83' with pyrite in calcite stringers.				
95 - 96	Weakly pyritized coarse grained tuff, bleached, vuggy, very weakly to non magnetic				
96 - 131	Very weakly magnetic tuff-breccia, 2" weakly pyritized bleached zone (20° to core axis) at 117'.				
131 - 140	Mostly bleached tuff, contact at 60° to core axis, non magnetic, fair fine grained pyrite sections which are no longer confined to calcite stringers but also occur as disseminated grains and along hair-line fractures, pyrite decreases towards 140.				
140 - 157	Tuff-breccia				
157 - 163	Fault gouge? at steep angle to core axis, fair fine grained pyrite starts at 161				
163 - 174	Typical iron rim bleached tuff, fair fine grained pyrite, odd quartz stringer, numerous carbonate stringers, non magnetic gradually changes to				
174 - 198	irregularly bleached tuff breccia, still some metallic hematite, pyrite and possibly magnetite (spec. Ja-187) with carbonate				

R. Woolverton

Evergreen Explorations Ltd.

Sheet 1

PROPERTY JACOB DRILL HOLE 3

LATITUDE _____ DATE STARTED November 4, 1974
 DEPARTURE _____ DATE COMPLETED November 5, 1974
 DIP -90° DRILLED BY J. Thomas (H. Allen)
 ELEVATION _____ LOGGED BY R. W. Woolverton

PRELIMINARY LOG

Depth	Geology	Sample No	Width		
1 - 30	Casing, pulled but hole could be deepened				
30 - 49	Pyritized tuff?, chloritized along fractures clumps and stringers of magnetite, quartz- carbonate stringers with odd cpy, MoS ₂ , and ZnS				
49 - 87	Weakly pyritized, coarse grained chloritized andesite, magnetic, odd quartz-carbonate stringers. Tuff 66' to 68', cpy 65' to 76' with odd hydrothermal biotite? stringers.				
87 - 90	Chloritized and pyritized tuff, 45° contact to core axis				
90 - 94	Chloritized and pyritized coarse grained andesite				
94 - 125	Chloritized and pyritized tuff				
125 - 128	Chloritized and pyritized tuff or andesite, fair cpy becoming spectacular at 126'				
128 - 147	Chloritized and pyritized tuff or andesite				
147 - 152	Moderately chloritized tuff or andesite, pyrite, fair cpy, odd ZnS				
152 - 167	Weakly chloritized tuff or andesite, odd ZnS				
167 - 175	Chloritized tuff or andesite, pyrite and fair cpy				
175 - 188	Chloritized and pyritized tuff or andesite				
188 - 202	Qtz eye BFP. Chilled contact at 60° to core axis, mafics gone to carbonate and sericite, feldspars gone to irregular patches of green sericite, fair flooding of groundmass with sericite, minor pyrite,				

JACOB CLAIM GROUP

BC7492 No 1085

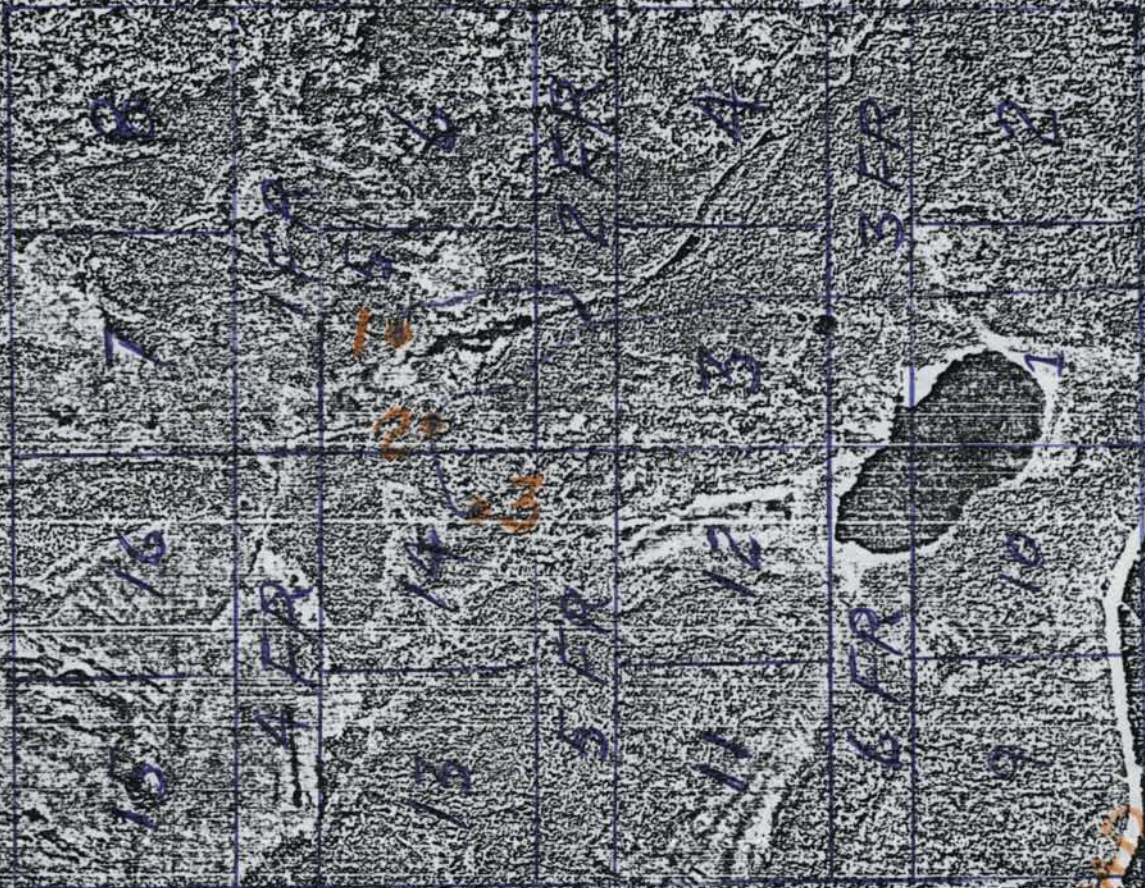

5396
MAP 2

DDH LOCATIONS
all -90°

1" = 1/4 mile

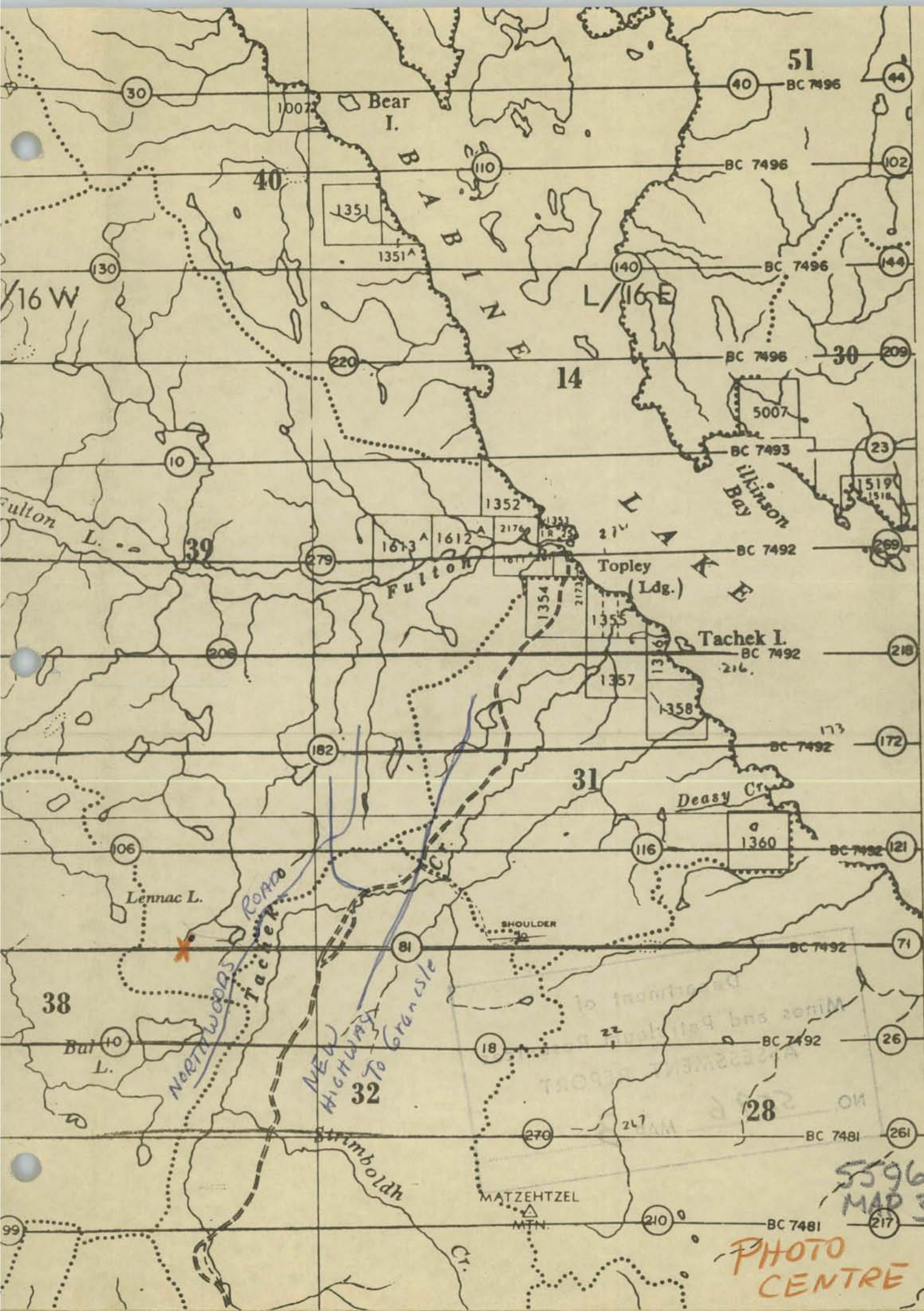

H. ALLEN DIAMOND DRILLING LTD.

P.O. BOX 1397
MERRITT, B.C.

TELEPHONE 378-4494

CONTRACT (Houston Area)

BETWEEN: Evergreen Explorations,
5424 Halifax Street,
Burnaby, B.C. V5B 2N7.

(Hereinafter referred to as the
"COMPANY" of the First Part.)

AND: H. ALLEN DIAMOND DRILLING LTD.,
Box 1397,
Merritt, B.C. VOK 2B0.

(Hereinafter referred to as the
"CONTRACTOR" of the Second Part.)

A. THE CONTRACTOR COVENANTS AND AGREES:

1. That all holes shall be drilled with BQ wireline equipment providing a core approximately 1 7/16" in diameter.
2. That the Contractor shall use his best endeavour to complete all holes according to the wishes of the Company, but should rock conditions prevent successful completion of the hole, the Contractor is not obliged to complete the same, but shall be paid for such incomplete holes at contract rates for the completed footage.
3. Contractor will supply all necessary equipment, board and transportation for his crew.
4. Contractor will pay the cost of moving between drill holes up to a distance of 1500 feet. Moves beyond this distance charged to the Company at cost.
5. Contractor will pay the cost of supplying water to the drill for a distance of 1500 feet or vertical lift of 300 feet. Supplying water beyond these limits to be negotiated.

B. THE COMPANY COVENANTS AND AGREES:

1. That payment for the herein described work shall be \$15.00 pr. ft. for core drilling and overburden for the initial 500 ft. Should the Company wish to drill more than 500 ft. the cost of additional footage will be \$12.00 per ft for overburden and \$10.00 per ft. for core drilling.
2. Cementing drill holes will be charged to the Company at cost plus 10%. Cost of labour being union rates. Cost of equipment rental during cementing will be \$20.00 per day.
3. Casing which is non-recoverable charged to the Company.
4. Moving costs on this job will be \$500.00.
5. Company will supply a camp for the drill crew.

Hereinafter referred to as the "COMPANY" of the First Part.)

AND: H. ALLEN DIAMOND DRILLING LTD.,
Box 1397,
Merritt, B.C. VOK 2B0.

(Hereinafter referred to as the "CONTRACTOR" of the Second Part.)

A. THE CONTRACTOR COVENANTS AND AGREES:

1. That all holes shall be drilled with BQ wireline equipment providing a core approximately 1 7/16" in diameter.
2. That the Contractor shall use his best endeavour to complete all holes according to the wishes of the Company, but should rock conditions prevent successful completion of the hole, the Contractor is not obliged to complete the same, but shall be paid for such incomplete holes at contract rates for the completed footage.
3. Contractor will supply all necessary equipment, board and transportation for his crew.
4. Contractor will pay the cost of moving between drill holes up to a distance of 1500 feet. Moves beyond this distance charged to the Company at cost.
5. Contractor will pay the cost of supplying water to the drill for a distance of 1500 feet or vertical lift of 300 feet. Supplying water beyond these limits to be negotiated.

B. THE COMPANY COVENANTS AND AGREES:

1. That payment for the herein described work shall be \$15.00 pr. ft. for core drilling and overburden for the initial 500 ft. Should the Company wish to drill more than 500 ft. the cost of additional footage will be \$12.00 per ft for overburden and \$10.00 per ft. for core drilling.
2. Cementing drill holes will be charged to the Company at cost plus 10%. Cost of labour being union rates. Cost of equipment rental during cementing will be \$20.00 per day.
3. Casing which is non-recoverable charged to the Company.
4. Moving costs on this job will be \$500.00.
5. Company will supply a camp for the drill crew.

IN WITNESS WHEREOF the a presents have been executed by the parties hereto this 2 day of April A.D. 1974.

Evergreen Explorations

H. Allen Diamond Drilling Ltd.

[Handwritten signature]

44
15,400
132
B45

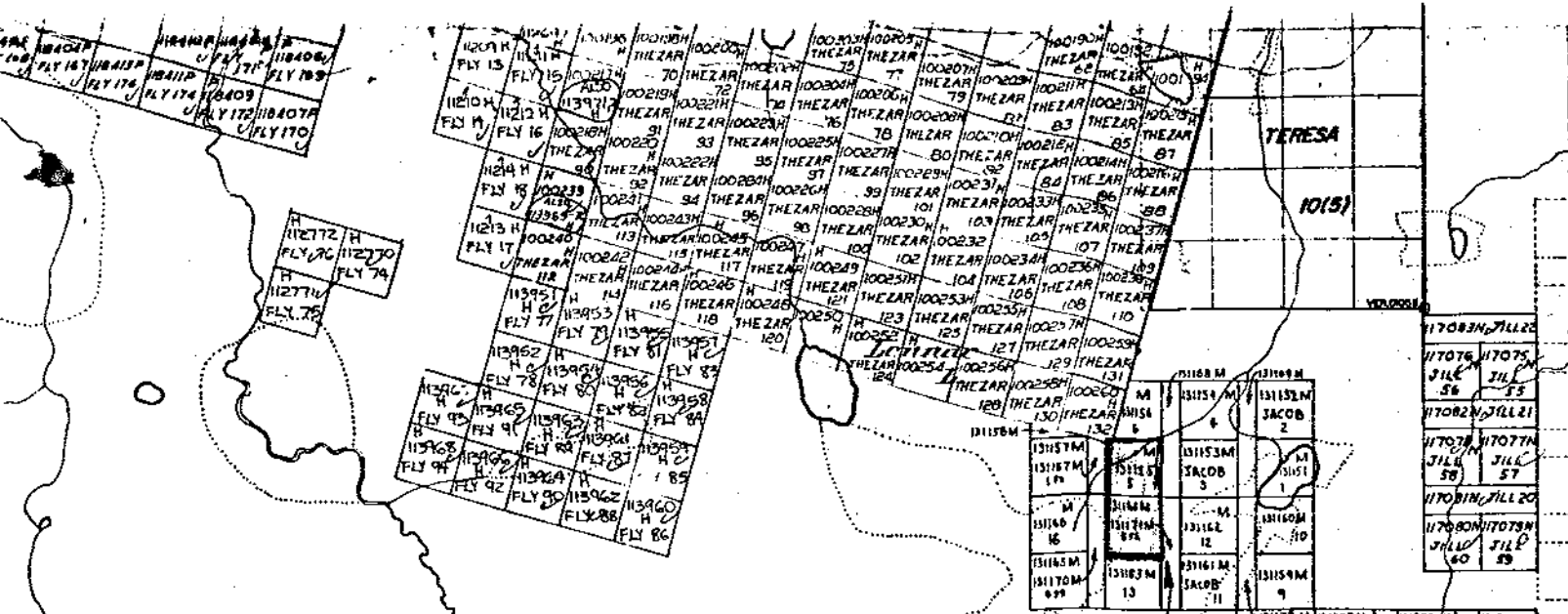

130909A	130907A	130905A	130903A
SIX 16	SIX 14	SIX 12	SIX 10
130908A	130906A	130904A	130902A
SIX 15	SIX 13	SIX 11	SIX 9
130907H	130905H	130903H	130901H
SIX 8	SIX 6	SIX 4	SIX 2
130899A	130897A	130895A	130893A
SIX 5	SIX 3	SIX 1	

180003	180004	180005	180006	180007	180008	180009	180010	180011	180012	180013	180014	180015	180016	180017	180018	180019	180020	180021	180022	180023	180024	180025	180026	180027	180028	180029	180030	180031	180032	180033	180034	180035	180036	180037	180038	180039	180040	180041	180042	180043	180044	180045	180046	180047	180048	180049	180050	180051	180052	180053	180054	180055	180056	180057	180058	180059	180060	180061	180062	180063	180064	180065	180066	180067	180068	180069	180070	180071	180072	180073	180074	180075	180076	180077	180078	180079	180080	180081	180082	180083	180084	180085	180086	180087	180088	180089	180090	180091	180092	180093	180094	180095	180096	180097	180098	180099	180100	180101	180102	180103	180104	180105	180106	180107	180108	180109	180110	180111	180112	180113	180114	180115	180116	180117	180118	180119	180120	180121	180122	180123	180124	180125	180126	180127	180128	180129	180130	180131	180132	180133	180134	180135	180136	180137	180138	180139	180140	180141	180142	180143	180144	180145	180146	180147	180148	180149	180150	180151	180152	180153	180154	180155	180156	180157	180158	180159	180160	180161	180162	180163	180164	180165	180166	180167	180168	180169	180170	180171	180172	180173	180174	180175	180176	180177	180178	180179	180180	180181	180182	180183	180184	180185	180186	180187	180188	180189	180190	180191	180192	180193	180194	180195	180196	180197	180198	180199	180200
--------	--------	--------	--------	--------	--------	--------	--------	--------	--------	--------	--------	--------	--------	--------	--------	--------	--------	--------	--------	--------	--------	--------	--------	--------	--------	--------	--------	--------	--------	--------	--------	--------	--------	--------	--------	--------	--------	--------	--------	--------	--------	--------	--------	--------	--------	--------	--------	--------	--------	--------	--------	--------	--------	--------	--------	--------	--------	--------	--------	--------	--------	--------	--------	--------	--------	--------	--------	--------	--------	--------	--------	--------	--------	--------	--------	--------	--------	--------	--------	--------	--------	--------	--------	--------	--------	--------	--------	--------	--------	--------	--------	--------	--------	--------	--------	--------	--------	--------	--------	--------	--------	--------	--------	--------	--------	--------	--------	--------	--------	--------	--------	--------	--------	--------	--------	--------	--------	--------	--------	--------	--------	--------	--------	--------	--------	--------	--------	--------	--------	--------	--------	--------	--------	--------	--------	--------	--------	--------	--------	--------	--------	--------	--------	--------	--------	--------	--------	--------	--------	--------	--------	--------	--------	--------	--------	--------	--------	--------	--------	--------	--------	--------	--------	--------	--------	--------	--------	--------	--------	--------	--------	--------	--------	--------	--------	--------	--------	--------	--------	--------	--------	--------	--------	--------	--------	--------	--------	--------	--------	--------	--------	--------	--------	--------	--------	--------	--------

46787	46788	46789	46790	46791	46792	46793	46794	46795	46796	46797	46798	46799	46800	46801	46802	46803	46804	46805	46806	46807	46808	46809	46810	46811	46812	46813	46814	46815	46816	46817	46818	46819	46820	46821	46822	46823	46824	46825	46826	46827	46828	46829	46830	46831	46832	46833	46834	46835	46836	46837	46838	46839	46840	46841	46842	46843	46844	46845	46846	46847	46848	46849	46850	46851	46852	46853	46854	46855	46856	46857	46858	46859	46860	46861	46862	46863	46864	46865	46866	46867	46868	46869	46870	46871	46872	46873	46874	46875	46876	46877	46878	46879	46880	46881	46882	46883	46884	46885	46886	46887	46888	46889	46890	46891	46892	46893	46894	46895	46896	46897	46898	46899	46900
-------	-------	-------	-------	-------	-------	-------	-------	-------	-------	-------	-------	-------	-------	-------	-------	-------	-------	-------	-------	-------	-------	-------	-------	-------	-------	-------	-------	-------	-------	-------	-------	-------	-------	-------	-------	-------	-------	-------	-------	-------	-------	-------	-------	-------	-------	-------	-------	-------	-------	-------	-------	-------	-------	-------	-------	-------	-------	-------	-------	-------	-------	-------	-------	-------	-------	-------	-------	-------	-------	-------	-------	-------	-------	-------	-------	-------	-------	-------	-------	-------	-------	-------	-------	-------	-------	-------	-------	-------	-------	-------	-------	-------	-------	-------	-------	-------	-------	-------	-------	-------	-------	-------	-------	-------	-------	-------	-------	-------	-------	-------	-------	-------	-------

130807	130808	130809	130810	130811	130812	130813	130814	130815	130816	130817	130818	130819	130820	130821	130822	130823	130824	130825	130826	130827	130828	130829	130830	130831	130832	130833	130834	130835	130836	130837	130838	130839	130840	130841	130842	130843	130844	130845	130846	130847	130848	130849	130850	130851	130852	130853	130854	130855	130856	130857	130858	130859	130860	130861	130862	130863	130864	130865	130866	130867	130868	130869	130870	130871	130872	130873	130874	130875	130876	130877	130878	130879	130880	130881	130882	130883	130884	130885	130886	130887	130888	130889	130890	130891	130892	130893	130894	130895	130896	130897	130898	130899	130900
--------	--------	--------	--------	--------	--------	--------	--------	--------	--------	--------	--------	--------	--------	--------	--------	--------	--------	--------	--------	--------	--------	--------	--------	--------	--------	--------	--------	--------	--------	--------	--------	--------	--------	--------	--------	--------	--------	--------	--------	--------	--------	--------	--------	--------	--------	--------	--------	--------	--------	--------	--------	--------	--------	--------	--------	--------	--------	--------	--------	--------	--------	--------	--------	--------	--------	--------	--------	--------	--------	--------	--------	--------	--------	--------	--------	--------	--------	--------	--------	--------	--------	--------	--------	--------	--------	--------	--------	--------	--------	--------	--------	--------	--------

115542M	115544M	115546M	115548M	115550M	115552M	115554M	115556M	115558M	115560M	115562M	115564M	115566M	115568M	115570M	115572M	115574M	115576M	115578M	115580M	115582M	115584M	115586M	115588M	115590M	115592M	115594M	115596M	115598M	115600M	115602M	115604M	115606M	115608M	115610M	115612M	115614M	115616M	115618M	115620M	115622M	115624M	115626M	115628M	115630M	115632M	115634M	115636M	115638M	115640M	115642M	115644M	115646M	115648M	115650M	115652M	115654M	115656M	115658M	115660M	115662M	115664M	115666M	115668M	115670M	115672M	115674M	115676M	115678M	115680M	115682M	115684M	115686M	115688M	115690M	115692M	115694M	115696M	115698M	115700M	115702M	115704M	115706M	115708M	115710M	115712M	115714M	115716M	115718M	115720M	115722M	115724M	115726M	115728M	115730M	115732M	115734M	115736M	115738M	115740M	115742M	115744M	115746M	115748M	115750M	115752M	115754M	115756M	115758M	115760M	115762M	115764M	115766M	115768M	115770M	115772M	115774M	115776M	115778M	115780M	115782M	115784M	115786M	115788M	115790M	115792M	115794M	115796M	115798M	115800M
---------	---------	---------	---------	---------	---------	---------	---------	---------	---------	---------	---------	---------	---------	---------	---------	---------	---------	---------	---------	---------	---------	---------	---------	---------	---------	---------	---------	---------	---------	---------	---------	---------	---------	---------	---------	---------	---------	---------	---------	---------	---------	---------	---------	---------	---------	---------	---------	---------	---------	---------	---------	---------	---------	---------	---------	---------	---------	---------	---------	---------	---------	---------	---------	---------	---------	---------	---------	---------	---------	---------	---------	---------	---------	---------	---------	---------	---------	---------	---------	---------	---------	---------	---------	---------	---------	---------	---------	---------	---------	---------	---------	---------	---------	---------	---------	---------	---------	---------	---------	---------	---------	---------	---------	---------	---------	---------	---------	---------	---------	---------	---------	---------	---------	---------	---------	---------	---------	---------	---------	---------	---------	---------	---------	---------	---------	---------	---------	---------	---------

D 6310	D 6311	D 6312	D 6313	D 6314	D 6315	D 6316	D 6317	D 6318	D 6319	D 6320	D 6321	D 6322	D 6323	D 6324	D 6325	D 6326	D 6327	D 6328	D 6329	D 6330	D 6331	D 6332	D 6333	D 6334	D 6335	D 6336	D 6337	D 6338	D 6339	D 6340	D 6341	D 6342	D 6343	D 6344	D 6345	D 6346	D 6347	D 6348	D 6349	D 6350	D 6351	D 6352	D 6353	D 6354	D 6355	D 6356	D 6357	D 6358	D 6359	D 6360	D 6361	D 6362	D 6363	D 6364	D 6365	D 6366	D 6367	D 6368	D 6369	D 6370	D 6371	D 6372	D 6373	D 6374	D 6375	D 6376	D 6377	D 6378	D 6379	D 6380	D 6381	D 6382	D 6383	D 6384	D 6385	D 6386	D 6387	D 6388	D 6389	D 6390	D 6391	D 6392	D 6393	D 6394	D 6395	D 6396	D 6397	D 6398	D 6399	D 6400
--------	--------	--------	--------	--------	--------	--------	--------	--------	--------	--------	--------	--------	--------	--------	--------	--------	--------	--------	--------	--------	--------	--------	--------	--------	--------	--------	--------	--------	--------	--------	--------	--------	--------	--------	--------	--------	--------	--------	--------	--------	--------	--------	--------	--------	--------	--------	--------	--------	--------	--------	--------	--------	--------	--------	--------	--------	--------	--------	--------	--------	--------	--------	--------	--------	--------	--------	--------	--------	--------	--------	--------	--------	--------	--------	--------	--------	--------	--------	--------	--------	--------	--------	--------	--------	--------	--------	--------	--------	--------	--------

75270	75271	75272	75273	75274	75275	75276	75277	75278	75279	75280	75281	75282	75283	75284	75285	75286	75287	75288	75289	75290	75291	75292	75293	75294	75295	75296	75297	75298	75299	75300	75301	75302	75303	75304	75305	75306	75307	75308	75309	75310	75311	75312	75313	75314	75315	75316	75317	75318	75319	75320	75321	75322	75323	75324	75325	75326	75327	75328	75329	75330	75331	75332	75333	75334	75335	75336	75337	75338	75339	75340	75341	75342	75343	75344	75345	75346	75347	75348	75349	75350	75351	75352	75353	75354	75355	75356	75357	75358	75359	75360	75361	75362	75363	75364	75365	75366	75367	75368	75369	75370	75371	75372	75373	75374	75375	75376	75377	75378	75379	75380	75381	75382	75383	75384	75385	75386	75387	75388	75389	75390	75391	75392	75393	75394	75395	75396	75397	75398	75399	75400
-------	-------	-------	-------	-------	-------	-------	-------	-------	-------	-------	-------	-------	-------	-------	-------	-------	-------	-------	-------	-------	-------	-------	-------	-------	-------	-------	-------	-------	-------	-------	-------	-------	-------	-------	-------	-------	-------	-------	-------	-------	-------	-------	-------	-------	-------	-------	-------	-------	-------	-------	-------	-------	-------	-------	-------	-------	-------	-------	-------	-------	-------	-------	-------	-------	-------	-------	-------	-------	-------	-------	-------	-------	-------	-------	-------	-------	-------	-------	-------	-------	-------	-------	-------	-------	-------	-------	-------	-------	-------	-------	-------	-------	-------	-------	-------	-------	-------	-------	-------	-------	-------	-------	-------	-------	-------	-------	-------	-------	-------	-------	-------	-------	-------	-------	-------	-------	-------	-------	-------	-------	-------	-------	-------	-------	-------	-------	-------	-------	-------	-------

5596

5596
MAP 1

Tachek

Finlay L.

Cr.