

5638

ASSESSMENT REPORT

On

KIM CLAIMS

KIMBERLEY, B.C.

Long. 45°40' Lat. 115°51.5'

N.T.S. 82G 12E

By

W. Simpson, M.Sc.

82G/12E
For

KIM

CHEVRON STANDARD LIMITED
MINERALS STAFF

Department of Mines and Petroleum Resources ASSESSMENT REPORT	
NO. 5638	MAP.....

Vancouver, B.C.
October 1, 1975

TABLE OF CONTENTS

Page No.

I. Introduction	1
II. Details of Hole	1
III. Core Storage Location	1

ILLUSTRATIONS

<i>Map # 1</i> Figure (1) General Location Map	2
<i># 2</i> Figure (2) Detailed Location Map	3

APPENDICES

- (1) Diamond Drill log
- (2) Statement of Costs
- (3) Statement of Qualification

I. Introduction

On August 28 and 29, E. Dodson travelled to the claim group and located the drill hole and consulted with the contractors.

Drilling commenced on September 6 and was completed to a depth of 482 feet on September 19.

On September 25 and 26, J. Simpson travelled to the claim group and examined the core. Samples were taken at 25 foot intervals for later analysis.

II. Details of Hole

BQ core was obtained from the vertical hole from 68 feet (base of overburden) to 482 feet. Accurate collar elevation is unknown but it is approximately 3,800 feet.

III. Core Storage

The core is stored by E. Frost, General Delivery, Fort Steele, B.C. at his home.

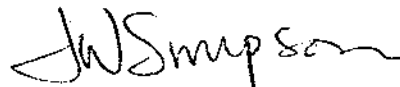

J.W. SIMPSON



43°
40'

86 3425 LUKE 88	89 3421 LUKE 20	15758 BINTY 25	15759 BINTY 26	15760 BINTY 27	15761 BINTY 28	15762 BINTY 29	15763 BINTY 30	15764 BINTY 31	15765 BINTY 32	15766 BINTY 33	15767 BINTY 34	15768 BINTY 35	15769 BINTY 36	15770 BINTY 37	15771 BINTY 38	15772 BINTY 39	15773 BINTY 40	15774 BINTY 41	15775 BINTY 42	15776 BINTY 43	15777 BINTY 44	15778 BINTY 45	15779 BINTY 46	15780 BINTY 47	15781 BINTY 48	15782 BINTY 49	15783 BINTY 50	15784 BINTY 51	15785 BINTY 52	15786 BINTY 53	15787 BINTY 54	15788 BINTY 55	15789 BINTY 56	15790 BINTY 57	15791 BINTY 58	15792 BINTY 59	15793 BINTY 60	15794 BINTY 61	15795 BINTY 62	15796 BINTY 63	15797 BINTY 64	15798 BINTY 65	15799 BINTY 66	15800 BINTY 67	15801 BINTY 68	15802 BINTY 69	15803 BINTY 70	15804 BINTY 71	15805 BINTY 72	15806 BINTY 73	15807 BINTY 74	15808 BINTY 75	15809 BINTY 76	15810 BINTY 77	15811 BINTY 78	15812 BINTY 79	15813 BINTY 80	15814 BINTY 81	15815 BINTY 82	15816 BINTY 83	15817 BINTY 84	15818 BINTY 85	15819 BINTY 86	15820 BINTY 87	15821 BINTY 88	15822 BINTY 89	15823 BINTY 90	15824 BINTY 91	15825 BINTY 92	15826 BINTY 93	15827 BINTY 94	15828 BINTY 95	15829 BINTY 96	15830 BINTY 97	15831 BINTY 98	15832 BINTY 99	15833 BINTY 100
--------------------------	--------------------------	----------------------	----------------------	----------------------	----------------------	----------------------	----------------------	----------------------	----------------------	----------------------	----------------------	----------------------	----------------------	----------------------	----------------------	----------------------	----------------------	----------------------	----------------------	----------------------	----------------------	----------------------	----------------------	----------------------	----------------------	----------------------	----------------------	----------------------	----------------------	----------------------	----------------------	----------------------	----------------------	----------------------	----------------------	----------------------	----------------------	----------------------	----------------------	----------------------	----------------------	----------------------	----------------------	----------------------	----------------------	----------------------	----------------------	----------------------	----------------------	----------------------	----------------------	----------------------	----------------------	----------------------	----------------------	----------------------	----------------------	----------------------	----------------------	----------------------	----------------------	----------------------	----------------------	----------------------	----------------------	----------------------	----------------------	----------------------	----------------------	----------------------	----------------------	----------------------	----------------------	----------------------	----------------------	----------------------	-----------------------

DDH
K-14

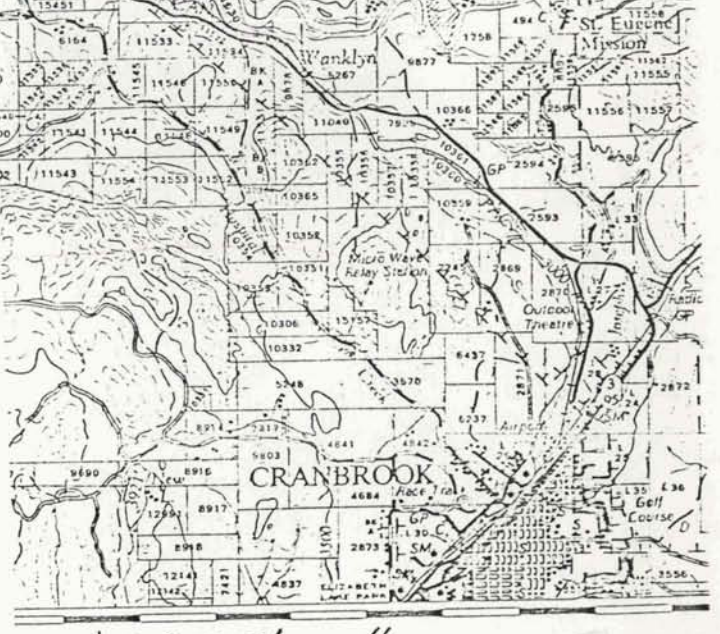

115° 51.5' // 45'
To Morye To Yahk—38 miles
SCALE 1 1/2 mi

5638

FIGURE 1 Map 1

LOCATION MAP,
KIM GROUP CLAIMS

SCALE 1:50,000

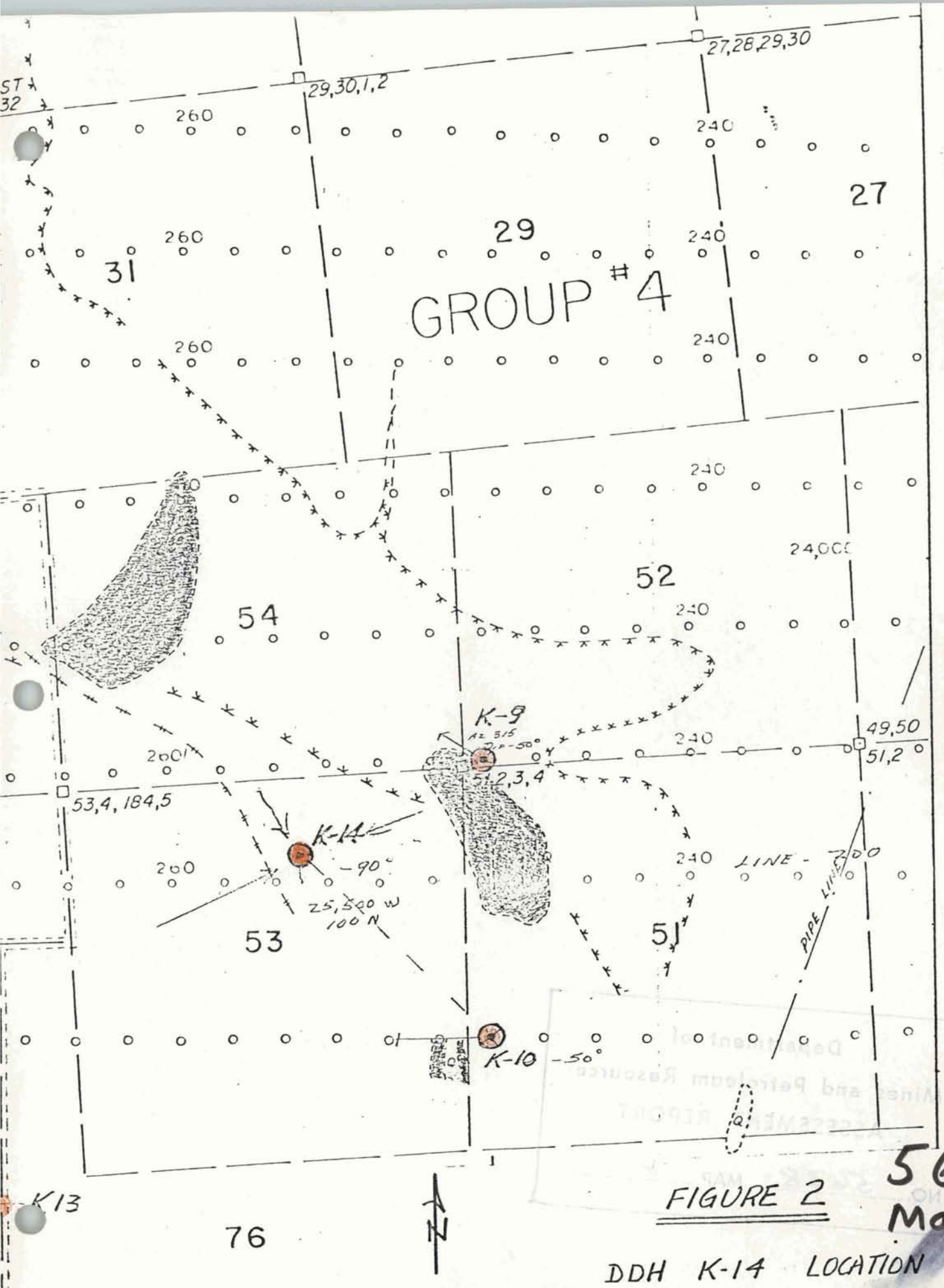

5638
Map 2

DDH K-14 LOCATION

SCALE 1" = 500'

DLT 75

Appendix (1)

DIAMOND DRILL LOG

K-14

KIM CLAIMS

Project #C-440

DIAMOND DRILL RECORD

PROPERTY Kim Claims

HOLE No. K-14

DIP TEST		
Footage	Reading	Angle <u>-90°</u> Corrected

Hole No. K-14 Sheet No. 2 Lot. 100 N
 Section..... Dep. 25,500W
 Date Begun..... Bearing N/A
 Date Finished..... Elev. Collar.....

Total Depth. 482 ft.
 Logged By. J.W. Simpson
 Claim Kim 53
 Core Size BQ

DEPTH	DESCRIPTION	SAMPLE No.	WIDTH OF SAMPLE				
	100-101'- Sample fairly typical of well sorted, light grey quartzite, Fe stains on fractures, moderately well-rounded, quartz grains. 101-104'- 2' core lost, fairly rusty, argillaceous section - possible fault zone.	K-14-2	100-101'				
	109-111'- Argillaceous section with some laminations, possible cross bedding on a small scale, over 6" very weak graded bedding. Fine-grained pyrite with possible pyrrhotite form approximately 5% of this interval usually concentrated in specific laminae. Interval shows evidence of cycles of deposition with some current reworking near top - some mudstone "fragments" near bottom. 114'- Pure quartz lense (?) about 6" wide - possibly due to recrystallization - moderate pyrite.						
122 - 163'	Medium-grey, laminated argillite. Sample shows pyrite in laminae and also in fine fractures - presumably there was minor remobilization into the fractures. Laminae vary from less than 1 mm to .5 cm and are alternating whitish (quartz) with dark, grey (clay) bands. There are minor slips which offset the laminae and these may be soft, sediment slumps. Sulphides (All pyrite?) form about 5% of the rock. Minor fractures are filled with	K-14-3	125-126'				

DIAMOND DRILL RECORD

PROPERTY Kim Claims

HOLE No. K-14

DIP TEST		
	Angle <u>-90°</u>	
Footage	Reading	Corrected

Hole No. K-14 Sheet No. 3 Lat. 100 N Total Depth. 482 ft.
 Section..... Dep. 25,500W Logged By. J.W. Simpson
 Date Begun..... Bearing N/A Claim Kim 53
 Date Finished..... Elev. Collar..... Core Size BQ

DEPTH	DESCRIPTION	SAMPLE No.	WIDTH OF SAMPLE				
	quartz (not calcite). Core angle has remained at about 30 to 35° and is remarkably uniform. Pyrite is concentrated in quartz-rich layers normally and is often associated with quartz in fine fractures.	K-14-4	150-151'				
	160' minor recumbent fold. Sulphide content has gradually increased and forms about 8% of the rock around 140 - 160'.						
163 - 167'	Medium grained, light grey quartzite, approximately 1.5' core lost - minor pyrite.						
167 - 205'	Contorted and brecciated argillite - uniform lamination virtually disappears. Pyrite often in fractures and irregular patches. Post diagenetic deformation indicated here by angular relationships of blocks.	K-14-5	175-176'				
	Sulphide content 8-10%, deformation decreases from about 180' on and composition becomes more argillaceous - i.e. - darker grey color since fewer quartz laminae.						
	198 - 200' - 1' core lost -(quartz is mostly in fractures here)	K-14-6	200-201'				
205 - 232'	Medium grey, laminated argillite, similar to 122 - 163' section (possibly a little more argillaceous) - fairly uniform alteration of light and dark laminae at 2 - 3 mm						

DIAMOND DRILL RECORD

PROPERTY Kim Claims

HOLE No. K-14

DIP TEST		
	Angle <u>-90°</u>	
Footage	Reading	Corrected

Hole No. K-14 Sheet No. 4 Lat. 100 N
 Section..... Dep. 25,500W
 Date Begun..... Bearing N/A
 Date Finished..... Elev. Collar.....

Total Depth 482 ft.
 Logged By J.W. Simpson
 Claim Kim 53
 Core Size BQ

DEPTH	DESCRIPTION	SAMPLE No.	WIDTH OF SAMPLE				
	intervals, pyrite content down to 2 - 3% again. 225 -						
	226' sample is slightly more argillaceous than average						
	for this section.	K-14-7	225-226'				
	226 - 227' - brecciated - very dark grey, about 12% pyrite.						
<u>232 - 334'</u>	- - -quartzite, similar to 68 - 122' section.						
	232 - 234' - 1' core lost - probable fault zone.						
	234 - 234.5' - laminated argillite. In general this						
	quartzite is finer-grained than 68-122 and contains						
	somewhat more pyrite. 241 - 246' - argillaceous section						
	with laminations - grades down to quartzite, upper						
	contact fairly sharp. 265' onwards - dark grey, argill-	K-14-8	250-251'				
	aceous lenses become common - light grey mudstone lenses						
	or fragments also become fairly common. Rock is still						
	dominantly quartzite, pyrite content now up slightly -						
	approximately 2 - 3%, minor deformations (probably soft						
	sediment) are visible since compositional variations.						
	Sample 9 shows some of those deformations. 278-280' -	K-14-9	275-276'				
	laminated argillite, core angle approximately 20%.						
	287' - Soft deformation in clayey lens. 302 - 303' -						
	Steep fractures with quartz fillings. 315 - 322' -	K-14-10	300-301'				
	More argillaceous - with heavier pyrite (still very fine						
	grained):						

DIAMOND DRILL RECORD

PROPERTY Kim Claims

HOLE No. K-14

DIP TEST

DIP TEST		
	Angle <u>-90°</u>	
Footage	Reading	Corrected

Hole No. K-14 Sheet No. 5 Lat. 100 N Total Depth 482 ft.
 Section..... Dep. 25,500W Logged By J.W. Simpson
 Date Begun..... Bearing N/A Claim Kim 53
 Date Finished..... Elev. Collar..... Core Size BQ

DEPTH	DESCRIPTION	SAMPLE No.	WIDTH OF SAMPLE				
334 - 353'	Very siliceous argillite - weakly laminated, darker than preceding quartzite. Minor gashes and fractures filled with quartz. 339 - 341' - breccia zone. Probably slump generated. No calcite - pyrite, biotite(?) both extremely fine-grained, associated with siliceous laminae. Generally coarser grained than dark clay (+graphite?) laminae.	K-14-11	325-326'				
353 - 391'	Medium-grey, medium-grained homogeneous quartzite, very rare pyrite, minor fracturing and quartz veining (these veinlets are never more than 3 mm wide). 382 - 383' - laminated argillite.	K-14-12	350-351'				
391 - 412'	Laminated argillite - quite siliceous similar to 334 - 353' interval. Pyrite up to 4 or 5% now. Core angle about 30% and very uniform again.	K-14-13	375-376'				
412 - 482'	Quartzite, brecciated and quartz veined to 418' - then minor laminations to 420'	K-14-14	400-401'				
	Sample - representative quartzite - shows bedding. Subtle change to coarser grain size from about 420' on.	K-14-15	425-426'				

Appendix (2)

Statement of Costs

<u>Date</u>	<u>Employee</u>	<u>Function</u>	<u>Cost</u>
Aug. 28, 29	E. Dodson	Locate hole (Wages & Expenses)	\$ 400.00
Sept. 6-19	E. Frost	Supervise Drilling (Wages)	520.00
Sept. 6-19	Elgin Exploration Company Limited	Drilling Contractor	7,203.19
Sept. 25, 26	J. Simpson	Log core (Wages & Expenses)	400.00
Sept. 30, Oct. 1	J. Simpson	Report (Wages)	200.00
		T O T A L :	<u>\$ 8,723.19</u>

STATEMENT

Elgin Exploration Company Limited

3504A - 72 Avenue South East
 CALGARY, ALBERTA T2C 1J9
 Phone (403) 279-4469

By J. L. K.

RECEIVED
 SEP 29 1975

DATE September 26th, 1975

TO

Chevron Standard Ltd.,
 #901, 355 Burrard Street,
 VANCOUVER, B.C.
 V6C 2G8

Minerals Staff
 SHEVRON STANDARD LTD.
 VANCOUVER OFFICE

DESCRIPTION

BQ Diamond Drilling Services Rendered Sept. 6 - 19, 1975

Wesdrill Model "60"

20 feet Overburden @ \$ 12.00 per foot	\$ 240.00
48 feet Overburden: 24 hours @ \$ 40.00 per hour	960.00
414 feet Cored @ \$ 12.00 per hour foot	4,968.00

Materials Used In Hole

2 only 2 15/16" Tricone Bits @ \$ 85.18 ea. plus 5% (new)	178.86
2 only BW Shoes @ \$ 138.00 ea. plus 5% (new)	289.80
1 only 10" BW Casing lost (used)	40.00
4 only 2" BW Casing left in hole (used)	50.00
6 only 10" BW Casing left in hole (new) plus freight (\$43.75)	362.53
24 only 50 lb. Bags Mud @ \$ 4.75 ea.	114.00

APPROVED		DATE
PROJECT	EXP. CODE	AMOUNT
<i>C440</i>		<i>7203.19</i>

TOTAL Due \$ 7,203.19

S T A T E M E N T

For Contract Work and Expenses completed on
Diamond Drill Hole No. K 14 between Saturday
September 6th 1975 and Friday September 19th
1975.

The sum of \$520.00.

E. J. Frost.

THIS AGREEMENT made this day of 1975.

BETWEEN: CHEVRON STANDARD LTD.,
#901, 355 Burrard Street,
VANCOUVER, British Columbia
V6C 2G8

(hereinafter referred to as the "COMPANY")

AND ELGIN EXPLORATION COMPANY LIMITED
3504A - 72nd Avenue South East
CALGARY, ALBERTA T2C 1J9

(hereinafter referred to as the "CONTRACTOR")

WHEREAS the COMPANY hereby requests that the CONTRACTOR carry out certain surface diamond drilling and other services, on properties, in the Kimberley areas of British Columbia.

AND WHEREAS the CONTRACTOR hereby agrees to perform said diamond drilling and other services requested, under the terms and conditions hereinafter contained.

1. DESCRIPTION OF WORK

The Work is to consist of a series of drill holes, drilled at locations specified by the COMPANY. A total minimum footage of 500 feet shall be drilled but, total footage may be extended by mutual consent. Holes shall be drilled with BQ tools producing 1 7/16" diameter core. Maximum depth of any hole shall not exceed 500 feet. The CONTRACTOR will not be called upon to drill any hole at a flatter angle than -45 degrees unless mutually agreed upon. Measurement of all holes shall be taken from the top of the casing pipe. If holes of a greater depth than 500 feet are desired, such drilling shall be performed only upon such conditions and at such rates as may be agreed upon before commencement of such drilling.

2. COMMENCEMENT AND EXECUTION OF WORK

Work shall be commenced: As near as possible to the limits specified by the COMPANY, i.e., *By Sept 12, 1975. [Signature]*

3. LABOUR EQUIPMENT MATERIALS AND SUPPLIES AND SERVICES

All labour equipment and material supplies and services necessary to the normal operation or maintenance of the drilling equipment shall be furnished by the CONTRACTOR.

4. SCHEDULE OF RATES

Subject to all of the other provisions hereof, the COMPANY agrees to

pay the CONTRACTOR for the work performed, services rendered and the materials equipment and supplies furnished by CONTRACTOR a sum as hereinafter prescribed.

(i) BQ Drilling

From bedrock to 500 feet at \$ 12.00 per foot.

(ii) Overburden Drilling

0 - 20 feet at \$ 12.00 per foot

For overburden greater than 20 feet in depth if costs are greater than \$ 12.00 per foot than the rate shall be \$ 40.00 per hour plus in hole costs.

(iii) TRANSPORTATION AND MOVES

It is agreed for the above mentioned drilling the moving of drill equipment supplies and personnel for the CONTRACTORS WAREHOUSE to the initial drill site, between drill site and return from the final drill site to the CONTRACTORS WAREHOUSE shall be for the CONTRACTORS account. Such costs shall include transportation, laying waterline up to 800 feet and setting up drill up to 8 hours after which day rate be paid.

(iv) FIELD COST

Field Cost rates will be as follows:

(a) Operating Field Costs

Two men and equipment \$ 40.00 per hour

(b) DELAYS

Delays occasioned by COMPANY representative or engineer will be for the COMPANY'S account at the rate of \$ 25.00 per hour.

Delays occasioned because of cementing, drilling out cement at \$ 40.00 per hour and setting time of cement shall be for the COMPANY'S account at \$ 25.00 per hour.

(c) MATERIALS

Additional material such as drilling mud, cement, or other additives required for the proper drilling and completion of the job shall be furnished by the CONTRACTOR at field cost to the COMPANY and shall be for the CONTRACTOR'S account.

(d) CORE BOXES

Core boxes and lids if required will be supplied by the CONTRACTOR at no cost to the COMPANY.

(v) EQUIPMENT

The CONTRACTOR will supply a Wesdrill Model 60 Diamond Drill mounted on a Nodwell FN-110 with a 4 x 4 service truck. The CONTRACTOR will also supply a 10' x 24' self-contained trailer to accommodate the drill crew.

(vi) ROOM AND BOARD

Room and board for CONTRACTOR'S personnel will be provided by the CONTRACTOR at no cost to the COMPANY. ~~The CONTRACTOR will provide board for COMPANY representatives at a rate of \$ 15.00 per day.~~ ^{10.}

5. ACCESS AND TIMBER RIGHTS

The COMPANY shall provide at no cost to the CONTRACTOR all rights of ingress and egress to all lands that may be required to enable the CONTRACTOR to carry out the specified work.

The CONTRACTOR shall be permitted to cut and fell any timber on the COMPANY'S property as may be required in the course of the work hereunder, and the COMPANY shall indemnify and save harmless the CONTRACTOR from any assessment for stumpage or other charges of every kind and nature whatsoever.

6. DRILLING

The CONTRACTOR agrees to case and drill on the sites and at angles and azimuths selected by the COMPANY representative and to follow the instructions of the COMPANY representative relating to place and time of drilling.

The CONTRACTOR shall at all times enforce discipline and maintain good order among its employees and shall not retain on the job any person not skilled in the work assigned to him.

Any employees of the CONTRACTOR who are objectionable or unsatisfactory to the COMPANY shall be removed from the job and replaced by an employee satisfactory to the COMPANY.

The drilling shall be conducted so as to produce as high a percentage of core as the nature of the ground being drilled shall allow. All cores recovered shall be delivered to the COMPANY at the drill site, carefully marked.

7. CAVITIES

In the event that cavities or loose and caving materials or excessive water flows are encountered of a nature so as to prevent the successful completion of any hole, the CONTRACTOR does not, under such conditions guarantee to drill to a predetermined depth and, in the event that it becomes necessary to abandon the hole, the COMPANY agrees to pay for such uncompleted holes at the rates herein specified for all footage completed. However, should the COMPANY request that further work be carried out in the hole beyond this point, then the CONTRACTOR shall continue work in the hole, but such continuing work shall be at Field Cost rates.

8. HOLE DIRECTION AND DEPTH

The CONTRACTOR does not guarantee the direction of the hole beyond the collar nor guarantee to drill any hole to any specified depth. The CONTRACTOR will however, expend every reasonable effort to complete all holes to the satisfaction of the COMPANY.

9. SECRECY

The CONTRACTOR will not give out any information regarding drill results or permit any access to drill core to any individual other than the COMPANY'S representative, except upon specific permission of responsible officials of the COMPANY.

10. LIENS

The CONTRACTOR shall be responsible for, and will pay promptly all costs and charges, incurred by itself for labour, machinery, tools and supplies used in completing the work hereunder so that no lien or other such charge relative to the CONTRACTOR, may be registered against the COMPANY or the property. The CONTRACTOR shall be responsible for the payment of all assessments for Workmen's Compensation, Holiday Pay, Canada Pension, Unemployment Insurance, Sales Tax, or other such applicable charges relative to its own labour and supplies purchased.

11. ECOLOGY AND SANITATION

During the course of the work, the CONTRACTOR shall keep the site of any drilling and camp areas free from accumulation of waste materials, rubbish or garbage and upon completion of the work, shall remove all tools, scaffolding, surplus materials, rubbish and garbage and leave the working and camp site in a clean condition. The CONTRACTOR shall observe and comply with all applicable Federal and Provincial Laws, regulations and orders relating to prevention of forest fires and sanitation in the bush and shall bear all costs arising from any violation thereof.

12. PAYMENTS

The COMPANY shall pay CONTRACTOR for the services and/or material and equipment furnished by the CONTRACTOR at the rate stipulated in this agreement, within 30 days of invoicing. Invoices shall be submitted twice monthly.

13. INSURANCE

The CONTRACTOR shall save the COMPANY harmless from all claims and

demands arising directly or indirectly out of or in connection with the work, whether such claims or demands are made by members of the public or persons employed or engaged on or in connection with the work; and the CONTRACTOR shall compensate the COMPANY for any damage done to its buildings, machinery, and equipment arising out of or in connection with the work.

The CONTRACTOR shall provide, maintain, and pay for Comprehensive General Liability Insurance protecting himself, his subcontractor, and the COMPANY against damage arising from personal injury (including death) and from claims for property damage which may arise out of his operations under this contract. Such insurance shall;

- (i) Have a limit of liability of not less than \$ 1,000,000.00 inclusive for any one occurrence or such greater amount as may at the discretion of the COMPANY, be required.
- (ii) Cover all liability arising out of products, either the CONTRACTOR'S or supplied by him, completed operations, contingent employer's liability and liability assumed by the CONTRACTOR under this contract.

Evidence of insurance, in such form as may be required, shall be lodged with the COMPANY'S representative before the work is commenced.

The CONTRACTOR shall also provide, maintain and pay for automobile insurance on his own vehicles and non-owned automobile insurance protecting himself and the COMPANY against damages arising from personal injury (including death) and from claims for property damage arising out of their use on his operations under this contract. Such insurance shall have a limit of liability of not less than \$ 1,000,000.00 inclusive for any one occurrence or such greater amount as may, at the discretion of the COMPANY, be required.

14. FORCE MAJEURE

Neither COMPANY nor CONTRACTOR shall be liable to the other for any delays or damages or any failure to act due, occasioned, or caused by reason of Provincial laws of the rules, regulations or orders of any public body or official purporting to exercise authority or control respecting the operations covered hereby, including the use of tools and equipment, or due, occasioned, or caused by strikes, action of the elements, or causes beyond the control of the elements, or causes beyond the control of the parties affected hereby, and delays due to the above causes, or any of them shall not be deemed to be a breach of or failure to perform under this Agreement.

15. NOT ASSIGNABLE

It is mutually agreed that this Agreement shall be binding upon and enure to the benefit of the parties hereto, their respective successors and permitted assigns, but shall not be assignable by either party without the consent in writing of the other party first had and obtained.

16. MAILING ADDRESSES

That any notice required to be given hereunder shall be properly given if mailed by registered letter addressed to the COMPANY as follows:

CHEVRON STANDARD LTD.
#901, 355 Burrard Street
VANCOUVER, British Columbia
V6C 2G8

or to the CONTRACTOR by registered letter addressed as follows:

ELGIN EXPLORATION COMPANY LIMITED
3504A - 72nd Avenue South East
CALGARY, ALBERTA
T2C 1J9

17. TIME IS OF THE ESSENCE

Time is expressly declared to be the essence of this Contract. If either party hereto defaults in the performance of this Contract of work commenced under work orders as provided for herein, the other party has the option to terminate this Contract and the work order involved.

IN WITNESS WHEREOF THE COMPANY AND THE CONTRACTOR set their hands this 29th day of August 1975.

Witness

Suzanne Dodson

COMPANY - CHEVRON STANDARD LTD.

E. P. Dodson

Witness

Suzanne Dodson

CONTRACTOR - ELGIN EXPLORATION COMPANY LIMITED

A. D. Mack

ADDENDUM TO AGREEMENT

1. All moves over 8 hours to be paid at day rate.
2. All actual cost of material, rod, casing, core barrels, etc., lost in the hole to be at the Company's expense.
3. Maximum distance to water to be 800 feet.
4. The cost of casing any hole below 20 feet to be done at day rate with the Company supplying the in hole costs.

Witness

Suzanne Dodson
0

Chevron Standard Ltd.

E. D. Dodson

Witness

Suzanne Dodson
0

Contractor

A. D. Mack

Appendix (3)

Statement of Qualifications : J.W. SIMPSON

- (1) Graduated from University of Toronto 1967,
Geology, B.Sc.;
- (2) Graduated from University of Toronto 1970,
Geology, M.Sc.;
- (3) Employed by Ducanex Resources, Regional
Geologist, 1970 - 1973;
- (4) Self-employed, consulting geologist,
1973 - 1974;
- (5) Employed by Chevron Standard Limited,
Minerals Staff, 1974 to present date.

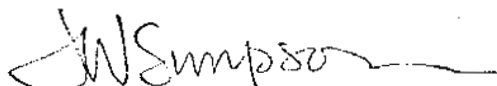
J.W. SIMPSON, M.Sc.

Vancouver Office,

September 30, 1975