

ASSESSMENT REPORT

DIAMOND DRILLING

ON THE

SIBOLA PROPERTY

127° 14' W, 53° 50' N

Omineca Mining Division

by

G. Belik

Noranda Exploration Company, Limited
(No Personal Liability)

August 6 - 31, 1975.

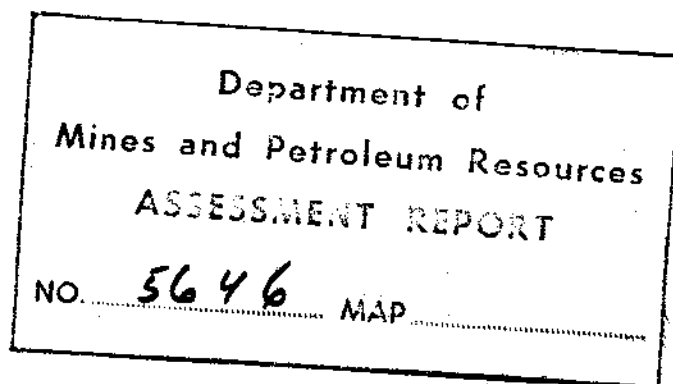

Maps

1. Loc. Map

2. DDM loc.

DIAMOND DRILLING

ON THE

SIBOLA PROPERTY

INTRODUCTION

The Sibola Property, consisting of the Tara 1, 9-20 and 25-38 mineral claims, is underlain by pyritized, altered intrusive and hornfels.

Diamond drilling was completed on certain of these claims to test various geochemical, geophysical and geological parameters outlined during earlier surveys.

LOCATION AND ACCESSIBILITY

The Tara claims are located within the Whitesail Lake Map-Area, British Columbia, on the north slope of the Sibola Range (Fig. 1) and the Town of Houston is about 45 miles to the north.

Access to the property from Houston is by helicopter or road. A gravel road, used mainly for access to the Berg copper-moly prospect, passes through the property.

CLAIMS AND OWNERSHIP

<u>Claim</u>	<u>Owner</u>	<u>Record Number</u>
Tara 1 (15 units)	Noranda Exploration Company, Limited (No Personal Liability)	9
Tara 9-20	Noranda Exploration Company, Limited (No Personal Liability)	132189-132200
Tara 25-28	Noranda Exploration Company, Limited (No Personal Liability)	132201-132204
Tara 29-38	Noranda Mines Limited	132356-132365

Figure 1

SIBOLA PROPERTY

Omineca Mining Division
127° 14' W, 53° 50' N

by

G. Belik

NORANDA EXPLORATION COMPANY, LIMITED
(No Personal Liability)

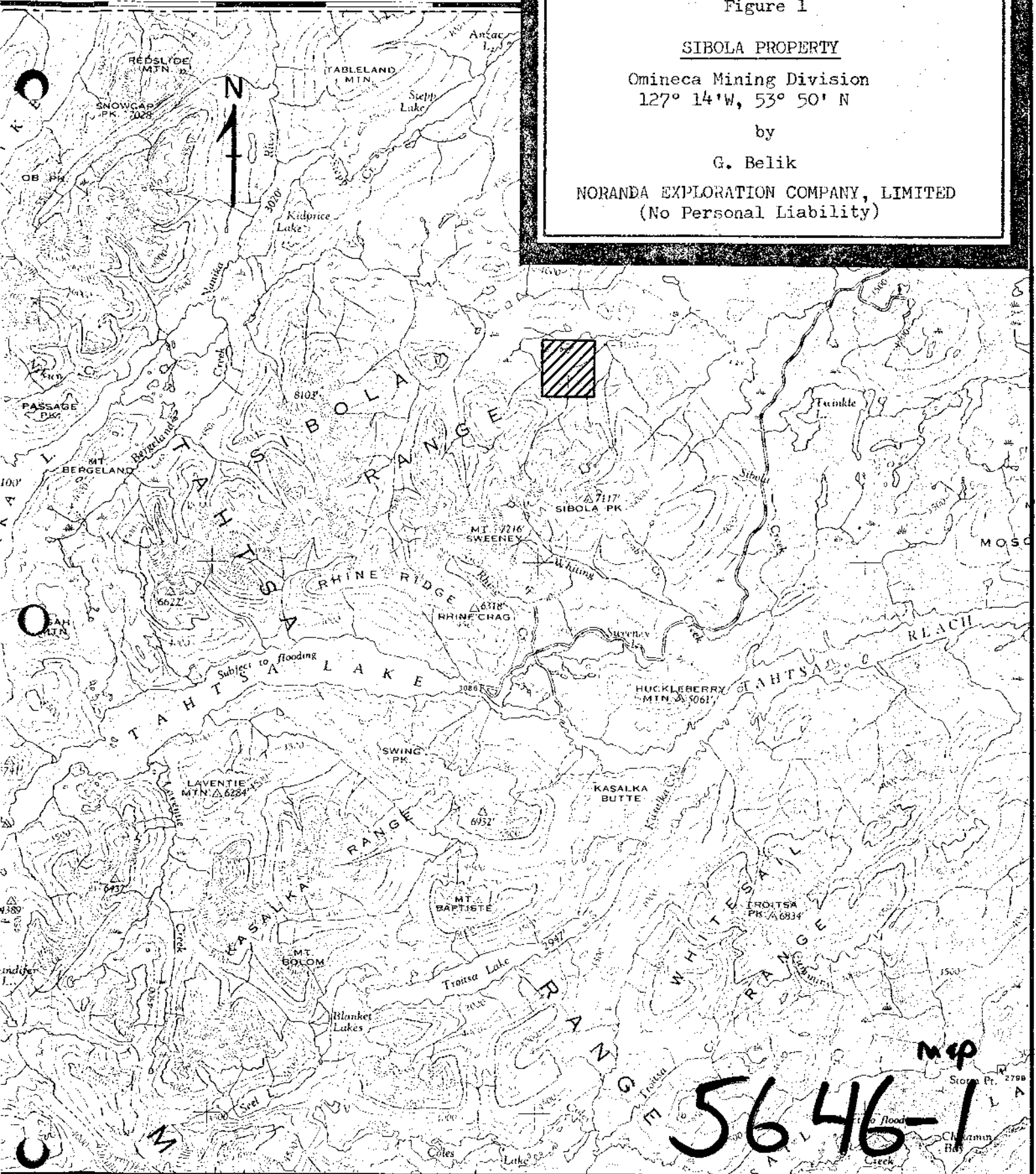

Map
5646-1



G. Belik

DIAMOND DRILLING

Six diamond drill holes, with a total footage of 1,726 feet, were completed on Tara 32, 33 and 34 during the period August 6 to August 31, 1975 (Table 1). Drilling was under contract to H. Allen Diamond Drilling Limited, Box 1397, Merritt, British Columbia. A longyear 38 drill rig with BQ wireline equipment was used to bore the holes.

Drill core is stored in wooden boxes, placed in a rack near the Noranda campsite located on the Tara 32 mineral claim.



Gary Belik,
Geologist.

Table #1

SIBOLA PROPERTYDIAMOND DRILL HOLE DATA

Hole No.	Latitude	Departure	Elevation	Claim	Dip	Bearing	Depth	Start	Finish
D.D.H. 75-1	102N	112E	1160 M	Tara 32	-44°	0°	346'	15/8/75	16/8/75
D.D.H. 75-2	100N	110E	1163 M	Tara 32	-60°	0°	112'	17/8/75	18/8/75
D.D.H. 75-3	99+25N	108E	1160 M	Tara 32	-61½°	2°	347'	19/8/75	20/8/75
D.D.H. 75-4	98N	106E	1180 M	Tara 33	-45°	180°	308'	21/8/75	23/8/75
D.D.H. 75-5	100N	111E	1168 M	Tara 32	-60°	0°	356'	23/8/75	25/8/75
D.D.H. 75-6	101+56N	106E	1166 M	Tara 34	-60°	180°	257'	25/8/75	26/8/75

[Handwritten signature]

STATEMENT OF QUALIFICATION

I, Gary Belik of the Town of Smithers, Province of British Columbia do certify that:

1. I have been an employee of Noranda Exploration Company, Limited since May 1970.
2. I am a graduate of the University of British Columbia with a Bachelor of Science Degree in Geology and a Master of Science Degree in Geology.
3. I am an Associate Fellow of the Geological Association of Canada and a member of the Canadian Institute of Mining and Metallurgy.
4. I have held the position of Geologist for Noranda Exploration Company, Limited since May 1970.



Gary Belik
Geologist
NORANDA EXPLORATION COMPANY,
LIMITED
(No Personal Liability)

NORANDA EXPLORATION COMPANY, LIMITED

Collared 15/8/75	Completed 16/8/75	Core Size BQ	Property Sibola	Project No 11	NTS No. 93E/14
FIELD COORDINATES			SURVEYED COORDINATES		
Lat. 102N	Elev.	Dip -44°	Lat.	Elev.	Dip
Dep. 112E	Depth 346'	Bearing 0°	Dep.	Depth	Bearing
					Sheet 1 of 3
					Hole No. 1

Footage	Rec'y	Graphic Log	Description	% Sulp.	Est. Grade	Sample No.	Lt.	Cu	Mo
0-180	0		Overburden						
180-190	100		White to pale green feldspar porphyry; intensely sericitized. Pyrite and minor Cpy and Moly occur as fracture fillings, and disseminations. Chalcocite? Fine Hematite locally imparts a pink colour to the rock.	10		P7326	10	0.02	0.001
190-200	100		" "	10		P7327	10	0.04	0.001
200-210	100		" "	7		P7328	10	0.03	0.001
210-220	100		" "	7		P7329	10	0.03	0.002
220-230	100		" "	9		P7330	10	0.15	0.003
			Past 227' increase in Matrix QTZ						
230-240	100		" "	8		P7331	10	0.04	0.003
240-250	100		" "	9		P7332	10	0.03	0.006
250-260	100		" "	9		P7333	10	0.05	0.003
260-270	100		260-267' " "	7		P7334	10	0.11	0.002

DATE 17/8/75 LOGGED BY G. Belik

NORANDA EXPLORATION COMPANY, LIMITED

Collared			Completed			Core Size			Property			Project No			NTS No.			
FIELD COORDINATES									SURVEYED COORDINATES						Sheet 2 of 3			
Lat.			Elev.			Dip			Lat.			Elev.			Dip			
Dep.			Depth			Bearing			Dep.			Depth			Bearing			
Footage	Rec'y	Graphic Log	Description						% Sulp.	Est. Grade	Sample No.	Lt.	Cu	Mo				
			267'-270' Medium green HBD-Felds															
			Porphyry; a few biotite books. HBD altered															
			to Chlorite + Sericite. Pyrite and minor															
			Cpy and Moly occur as fracture fillings															
			and disseminations.															
270-280	100		As 267'-270'; a few fractures with						6		P7335	10	0.03	0.001				
			sericitized envelopes.															
280-290	100		" "						9		P7336	10	0.03	0.001				
			A few Carbonate and Gypsum veins															
290-300	100		290'-293' " "						9		P7337	10	0.04	0.001				
			293'-300' White to pale green feldspar															
			porphyry; intensely sericitized with															
			Hydrothermal Qtz. Pyrite and minor															
			Cpy and Moly occur as fracture fillings															
			and disseminations. Sections with pale green															

DATE _____ LOGGED BY _____

NORANDA EXPLORATION COMPANY, LIMITED

Collared			Completed			Core Size			Property Sibola			Project No 11			NTS No.					
FIELD COORDINATES						SURVEYED COORDINATES						Sheet 3 of 3								
Lat.			Elev.			Dip			Lat.			Elev.			Dip			Hole No.		
Dep.			Depth			Bearing			Dep.			Depth			Bearing			1		
Footage	Rec'y	Graphic Log	Description						% Sulp.	Est. Grade	Sample No.	Lt.	Cu	Mo						
			Hydrothermal Sericite																	
300-310	100		As 293'-300'						9		P7338	10	0.02	0.001						
310-320	100		" "						10		P7339	10	0.05	0.001						
320-330	100		" "						7		P7340	10	0.05	0.001						
330-340	100		" "						8		P7341	10	0.02	0.001						
340-346	100		" "						7		P7342	6	0.01	0.001						
<i>Henry Salib</i>																				

DATE _____

LOGGED BY _____

NORANDA EXPLORATION COMPANY, LIMITED

Collared 19/8/75		Completed 20/8/75		Core Size BQ		Property Sibola			Project No 11		NTS No. 93E/14			
FIELD COORDINATES						SURVEYED COORDINATES						Sheet 1 of 3		
Lat. 99+25N		Elev.		Dip -61½°		Lat.		Elev.		Dip		Hole No.		
Dep. 108E		Depth 347'		Bearing 2°		Dep.		Depth		Bearing		3		
Footage	Rec'y	Graphic Log	Description				% Sulp.	Est. Grade	Sample No.	Lt.	Cu	Mo		
0-75	0		Overburden											
75-80	0		No core; Triconed 5 ft. into bedrock											
80-90	99		Pale green feldspar porphyry;				7		P7343	10	<0.01	0.001		
			Intense sericitization with 10% secondary											
			Quartz. Pyrite and trace Cpy occur											
			as fracture fillings and disseminations.											
			Chalcocite?											
90-100	98		"	"	"	10		P7344	10	<0.01	0.001			
100-110	100		"	"	"	10		P7345	10	<0.01	0.001			
110-120	99		"	"	"	9		P7346	10	<0.01	0.001			
120-130	99		"	"	"	9		P7347	10	<0.01	0.001			
130-140	99		"	"	"	5		P7348	10	<0.01	0.001			
			Locally hematitic and chloritic.											
140-150	96		"	"	"	1.5		P7349	10	<0.01	0.001			
			Hematitic and chloritic.											

DATE 21/8/75

LOGGED BY G. Belik

NORANDA EXPLORATION COMPANY, LIMITED

Collared			Completed			Core Size			Property Sibola			Project No 11			NTS No.		
FIELD COORDINATES						SURVEYED COORDINATES						Sheet 2 of 3					
Lat.		Elev.		Dip		Lat.		Elev.		Dip		Hole No.					
Dep.		Depth		Bearing		Dep.		Depth		Bearing		3					
Footage	Rec'y	Graphic Log	Description						% Sulp.	Est. Grade	Sample No.	Lt.	Cu	Mo			
			146'-148' Slip surfaces with gouge.														
150-160	100		As 80'-90'.						9		P7350	10	< 0.01	0.001			
160-170	100		" "						9		P7351	10	< 0.01	0.001			
170-180	99		" "						8		P7352	10	< 0.01	0.001			
			Hematitic. Quartz vein with molybdenite.														
180-190	100		" "						5		P7353	10	< 0.01	0.001			
190-200	99		" "						4		P7354	10	< 0.01	0.001			
200-210	98		" " Locally chloritic.						7		P7355	10	< 0.01	0.001			
210-220	99		210'-215' " "						9		P7356	10	< 0.01	0.001			
			215'-220' White, siliceous, sericitized														
			Feldspar porphyry.														
220-230	99		As 215'-220'						9		P7357	10	< 0.01	0.001			
230-240	99		" "						9		P7358	10	< 0.01	0.001			
240-250	99		240-248½' " "						9		P7359	10	0.01	0.001			
			248½-250' Dark green, andesite dyke;														

DATE _____ LOGGED BY _____

NORANDA EXPLORATION COMPANY, LIMITED

Collared		Completed		Core Size		Property		Sibola		Project No		11		NTS No.	
FIELD COORDINATES						SURVEYED COORDINATES						Sheet 3 of 3			
Lat.		Elev.		Dip		Lat.		Elev.		Dip		Hole No.			
Dep.		Depth		Bearing		Dep.		Depth		Bearing		3			
Footage	Rec'y	Graphic Log	Description				% Sulp.	Est. Grade	Sample No.	Lt.	Cu	Mo			
			Chloritized. Disseminated pyrite and Cpy.												
			Contact with porphyry 45°/core.												
250-260	100		250'-251½'	"	"	8		P7360	10	0.01	0.001				
			251½-260'	As	240'-248½'										
260-270	99		"	"	"	6		P7361	10	<0.01	0.001				
270-280	99		"	"	"	9		P7362	10	<0.01	0.001				
280-290	99		"	"	"	9		P7363	10	<0.01	0.001				
290-300	100		"	"	"	8		P7364	10	<0.01	0.001				
300-310	100		"	"	Minor Moly.	8		P7365	10	<0.01	0.001				
310-320	100		"	"	"	8		P7366	10	<0.01	0.001				
320-330	99		"	"	Minor Moly.	9		P7367	10	<0.01	0.001				
330-340	99		"	"	"	9		P7368	10	<0.01	0.001				
340-347	99		"	"	"	9		P7369	10	<0.01	0.001				

[Handwritten Signature]

DATE _____ LOGGED BY _____

NORANDA EXPLORATION COMPANY, LIMITED

Collared 21/8/75	Completed 23/8/75	Core Size BQ	Property Sibola	Project No 11	NTS No. 93E/14
FIELD COORDINATES			SURVEYED COORDINATES		
Lat. 98N	Elev.	Dip 45°	Lat.	Elev.	Dip
Dep. 106E	Depth 308	Bearing 180°	Dep.	Depth	Bearing
					Sheet 1 of 4
					Hole No. 4

Footage	Rec'y	Graphic Log	Description	% Sulp.	Est. Grade	Sample No.	Lt.	Cu	Mo
0-85	0		Overburden						
85-90	97		Fine-grained diorite/qtz diorite; mafics (30%) altered to chlorite ± sericite. Hairline fractures with 'bleached' envelopes; 1% secondary K-spar as fracture 'envelopes' and disseminations; locally, secondary biotite adjacent to fracture walls. Mineralization consists of minor pyrite and Cpy as disseminations and in fractures.	0.3					
90-100	98		90-93 " "	0.5	4.1	P7370		0.01	0.001
			93-100 " "						
			Increased biotite content. Biotite secondary and fracture controlled (2% to 15%).						

DATE 25/8/75 LOGGED BY G. Belik

NORANDA EXPLORATION COMPANY, LIMITED

Collared		Completed		Core Size		Property		Sibola		Project No		11		NTS No.	
FIELD COORDINATES						SURVEYED COORDINATES						Sheet 2 of 4			
Lat.		Elev.		Dip		Lat.		Elev.		Dip		Hole No.			
Dep.		Depth		Bearing		Dep.		Depth		Bearing		4			
Footage	Rec'y	Graphic Log	Description				% Sulp.	Est. Grade	Sample No.	Lt.	Cu	Mo			
00-110	99		"	"		0.4									
10-120	99		"	"		0.2									
			A few magnetite veins												
20-130	99		"	"		0.2									
30-140	98		"	"		0.3									
40-150	98		"	"		0.6									
			A few magnetite veins												
50-160	98		"	"		1	<.1	P7371		0.03	0.001				
60-170	99		"	"		1	<.1	P7372		0.02	0.001				
			Several magnetite veins with accessory pyrite and Cpy.												
70-180	98		"	"		0.5									
80-190	99		"	"		0.5									
90-200	99		"	"		0.5	.1	P7373		0.06	0.001				
00-210	99		"	"		0.7	.1	P7374		0.07	0.001				

DATE

LOGGED BY

NORANDA EXPLORATION COMPANY, LIMITED

Collared			Completed			Core Size			Property Sibola			Project No 11			NTS No.		
FIELD COORDINATES						SURVEYED COORDINATES						Sheet 3 of 4					
Lat.		Elev.		Dip		Lat.		Elev.		Dip		Hole No.					
Dep.		Depth		Bearing		Dep.		Depth		Bearing		4					
Footage	Rec'y	Graphic Log	Description						% Sulp.	Est. Grade	Sample No.	Lt.					
210-220	99		" "						0.3								
220-230	96		" "						Tr								
230-240	96		230-232 " "						Tr								
			232-240 Very fine-grained, green intrusive; mafics altered to chlorite [±] sericite; plagioclase saussuritized. Disseminated hematite and magnetite. A few qtz/carbonate veins with magnetite and hematite														
240-250	97		240-242 " "						Tr								
			242-247 As 230-232														
			247-250 Fine-grained diorite/qtz diorite; mafics altered to chlorite [±] sericite; minor biotite. Little fracturing or veining.														

DATE

LOGGED BY

NORANDA EXPLORATION COMPANY, LIMITED

Collared	Completed	Core Size	Property	Sibola	Project No	11	NTS No.
----------	-----------	-----------	----------	--------	------------	----	---------

FIELD COORDINATES				SURVEYED COORDINATES				Sheet	4	of	4
-------------------	--	--	--	----------------------	--	--	--	-------	---	----	---

Lat.	Elev.	Dip	Lat.	Elev.	Dip	Hole No.
Dep.	Depth	Bearing	Dep.	Depth	Bearing	

Footage	Rec'y	Graphic Log	Description	% Sulp.	Est. Grade	Sample No.	Lt.					
250-260	99		" "	Tr								
260-270	99		" "	Nil								
270-280	99		" "	Nil								
280-290	99		" "	Nil								
290-300	100		" "	Nil								
300-308	100		" "	Nil								
<i>Henry B. Bell</i>												

DATE _____ LOGGED BY _____

NORANDA EXPLORATION COMPANY, LIMITED

Collared 23/8/75		Completed 25/8/75		Core Size BQ		Property Sibola		Project No 11		NTS No. 93E/14				
FIELD COORDINATES						SURVEYED COORDINATES						Sheet 1 of 5		
Lat. 100N		Elev.		Dip -60°		Lat.		Elev.		Dip		Hole No.		
Dep. 111E		Depth 356		Bearing 0°		Dep.		Depth		Bearing		5		
Footage	Rec'y	Graphic Log	Description				% Sulp.	Est. Grade	Sample No.	Lt.	Cu	Mo		
0-65	0		Overburden											
65-70	98		Pale green to pink feldspar porphyry;				0.5		P7276	5	0.01	0.001		
			Sericitized. 15% plagioclase pheno-											
			crysts (Sausuritized). 6% red & black											
			hematite as fracture fillings and											
			disseminations. Mineralization consists											
			of pyrite and minor Cpy as fracture											
			fillings and disseminations; minor											
			chalcocite?											
70-80	98		70-77	"	"	4		P7277	10	0.01	0.001			
			77-80	Same lithology but with										
			hydrothermal chlorite (imparts a											
			green colour). Stockwork of Quartz											
			veins with pyrite and minor Cpy.											
80-90	99		As 77-80 5% Hydrothermal				2		P7278		0.01	0.001		

DATE 26/8/75

LOGGED BY

G. Belik

NORANDA EXPLORATION COMPANY, LIMITED

Collared		Completed		Core Size		Property Sibola			Project No 11		NTS No.			
FIELD COORDINATES						SURVEYED COORDINATES						Sheet 2 of 5		
Lat.		Elev.		Dip		Lat.		Elev.		Dip		Hole No.		
Dep.		Depth		Bearing		Dep.		Depth		Bearing		5		
Footage	Rec'y	Graphic Log	Description				% Sulp.	Est. Grade	Sample No.	Lt.	Cu	Mo		
			Chlorite (irregular patches, disseminations, fracture envelopes).											
90-100	98		"	"		3		P7279	10	0.01	0.001			
100-110	99		100-109	"	"	2		P7280	10	0.02	0.001			
			109-110	Breccia consisting of subrounded intrusive fragments within a hematitic matrix.										
110-120	99		Pale pink feldspar porphyry; sericitized. 4% disseminated hematite. Quartz veining 45°/core. Disseminated pyrite and minor cpy.			3		P7281	10	0.01	0.001			
120-130	99		"	"		3		P7282	10	0.01	0.001			
130-140	97		Same as above lithology with 2% to 5% hydrothermal chlorite (patches, disseminations, fracture fillings and			1.5		P7283	10	0.02	0.001			

DATE _____ LOGGED BY _____

NORANDA EXPLORATION COMPANY, LIMITED

Collared		Completed		Core Size		Property			Project No		NTS No.				
FIELD COORDINATES						SURVEYED COORDINATES						Sheet 3 of 5			
Lat.		Elev.		Dip		Lat.		Elev.		Dip		Hole No.			
Dep.		Depth		Bearing		Dep.		Depth		Bearing		5			
Footage	Rec'y	Graphic Log	Description					% Sulp.	Est. Grade	Sample No.	Lt.	Cu	Mo	Ag	Au
			Envelopes adjacent to fractures).												
			3% hematite occurs evenly disseminated												
			and in fractures. Cpy and lesser pyrite												
			occur disseminated, with												
			hematite veins and in fractures.												
			Hematite and sulphide grains often												
			have chlorite halos. From 160' - 356'												
			the copper content changes back												
			and forth from 0.3% - 0.6% to trace												
			amounts over a few inches to												
			several feet. An average for the												
			section would be about 0.2%.												
140-150	98		"	"			1.5		P7284	10	0.02	0.001			
150-160	99		"	"			1.5		P7285	10	0.02	0.001			
160-170	99		"	"			4.1		P7286	10	0.05	0.001			

DATE _____ LOGGED BY _____

NORANDA EXPLORATION COMPANY, LIMITED

Collared		Completed		Core Size		Property Sibola			Project No 11		NTS No.			
FIELD COORDINATES						SURVEYED COORDINATES						Sheet 4 of 5		
Lat.		Elev.		Dip		Lat.		Elev.		Dip		Hole No.		
Dep.		Depth		Bearing		Dep.		Depth		Bearing		5		
Footage	Rec'y	Graphic Log	Description				% Sulp.	Est. Grade	Sample No.	Lt.	Cu	Mo	Ag	Au
170-180	99		"	"		<1		P7287	10	0.04	0.001			
180-190	96		"	"		1.5		P7288	10	0.05	0.001			
190-200	96		190-191	Gouge		1		P7289	10	0.05	0.001			
200-210	99		"	"		.5		P7290	10	0.01	0.001			
210-220	99		"	"		.5		P7291	10	0.01	0.001			
220-230	97		"	"		1		P7292	10	0.08	0.001			
230-240	96		"	"		.5		P7293	10	0.04	0.001			
240-250	99		"	"		1		P7294	10	0.04	0.001			
250-260	99		"	"		1		P7295	10	0.03	0.001			
260-270	99		"	"		1		P7296	10	0.08	0.001			
270-280	99		"	"		.5		P7297	10	0.04	0.001			
280-290	99		"	"		1		P7298	10	0.12	0.002			
290-300	99		"	"		.5		P7299	10	0.02	0.001			
300-310	99		"	"		.5		P7300	10	0.05	0.002			
310-320	99		"	"		.5		P7301	10	0.01	0.001			

DATE _____

LOGGED BY _____

NORANDA EXPLORATION COMPANY, LIMITED

Collared	25/8/75	Completed	26/8/75	Core Size	BQ	Property	Sibola	Project No	11	NTS No.	93E/14			
FIELD COORDINATES						SURVEYED COORDINATES								
Lat.	101 + 56N	Elev.		Dip		Lat.		Elev.		Dip				
Dep.	106E	Depth	257	Bearing		Dep.		Depth		Bearing				
											Sheet	1	of	3
											Hole No.		6	

Footage	Rec'y	Graphic Log	Description	% Sulp.	Est. Grade	Sample No.	Lt.	Cu	Mo	Ag	Au
0-12	0		Overburden								
12-20	99		White to pale green feldspar porphyry; strongly sericitized and silicified (Matrix Quartz). Mineralization consists of pyrite and traces of Cpy as fracture fillings and disseminations. Disseminated hematite. Chalcocite?	6							
20-30	98		" "	3							
			Locally Chloritic								
30-40	98		" "	7							
40-50	99		" "	8							
50-60	100		" "	7		P7306	10	0.01	0.001		
60-70	100		" "	10							
70-80	100		" "	9							
80-90	100		" "	7							

DATE 27/8/75

LOGGED BY G. Belik

NORANDA EXPLORATION COMPANY, LIMITED

Collared		Completed		Core Size		Property Sibola		Project No 11		NTS No.				
FIELD COORDINATES						SURVEYED COORDINATES						Sheet 2 of 3		
Lat.		Elev.		Dip		Lat.		Elev.		Dip		Hole No.		
Dep.		Depth		Bearing		Dep.		Depth		Bearing		6		
Footage	Rec'y	Graphic Log	Description				% Sulp.	Est. Grade	Sample No.	Lt.	Cu	Mo	Ag	Au
			Sections with pink hue (Hematitic).											
90-100	98		"	"		7								
100-110	97		"	"		8								
110-120	97		"	"		8		P7307	10	0.01	0.001			
120-130	99		"	"		6								
130-140	98		"	"		7		P7308		0.01	0.001			
140-150	99		"	"		3								
150-160	98		"	"		6								
			Sections with pink hue (Hematitic).											
160-170	95		"	"		5								
170-180	99		"	"		9								
180-190	99		"	"		8								
190-200	99		"	"		8								
200-210	99		"	"		8								
210-220	99		"	"		7								

DATE _____ LOGGED BY _____

NORANDA EXPLORATION COMPANY, LIMITED

Collared		Completed		Core Size		Property Sibola			Project No 11		NTS No.			
FIELD COORDINATES						SURVEYED COORDINATES						Sheet 3 of 3		
Lat.		Elev.		Dip		Lat.		Elev.		Dip		Hole No.		
Dep.		Depth		Bearing		Dep.		Depth		Bearing		6		
Footage	Rec'y	Graphic Log	Description				% Sulp.	Est. Grade	Sample No.	Lt.	Cu	Mo	Ag	Au
220-230	98		"	"	"	"	5							
230-240	100		"	"	"	"	6							
240-250	100		"	"	"	"	7	P7309	10	0.01	0.001			
250-257	100		"	"	"	"	5							
Casing left in hole.														
														

DATE _____ LOGGED BY _____

NORANDA EXPLORATION COMPANY, LIMITED

STATEMENT OF COST

PROJECT: SIBOLA

TYPE OF REPORT: DIAMOND DRILLING

(a) Employees: D. Baptiste, G. Belik, G. Holland, J. Fraser
Number of days: 58
Dates worked: Between Aug 6 and Aug 31

(b) Average cost per day \$43.60
Total cost \$43.60 X 58 \$ 2,528.80

(c) Cost of food & accomodation \$ 558.18

(d) Cost of transportation
i. During work period
type: Truck
cost: 329.56
ii. To and from Claims from
within B.C.
cost: 1,110.78 \$ 1,440.34

(e) Cost of aircraft
i. Fixed wing:
ii. Helicopter:

(f) Cost of instruments
i. Rental:
ii. Supplies

(g) Cost of geochem analysis
(details attached):

(h) Cost of report preparation: \$ 250.00

(i) Other: H. Allen Diamond Drilling \$25,321.00
Rossbacher Laboratory \$ 705.50
Core rack materials 33.78

TOTAL

\$ 30,837.60

H. ALLEN DIAMOND DRILLING LTD.

TELEPHONE 378-4494

P.O. BOX 1397
MERRITT, B.C.
VOK 2B0

CONTRACT (Nadina Area)

Between: NORANDA EXPLORATION CO. LTD.,
1050 Davie Street, P.O. Box 2380,
Vancouver, B.C. V6B 3T5

(Hereinafter referred to as the
"COMPANY" of the First Part.)

AND: H. ALLEN DIAMOND DRILLING LTD,
Box 1397,
Merritt, B.C. VOK 2B0

(Hereinafter referred to as the
"CONTRACTOR" of the Second Part.)

A. THE CONTRACTOR COVENANTS AND AGREES:

1. That all holes shall be drilled with BQ wireline equipment providing a core approximately 1 7/16" in diameter.
2. That the Contractor shall use his best endeavour to complete all holes according to the wishes of the Company, but should rock conditions prevent successful completion of the hole, the Contractor is not obliged to complete the same, but shall be paid for such incomplete holes at contract rates for the completed footage.
3. Contractor will supply all necessary equipment and transportation for his crew. ✓
4. Contractor will supply a cat for preparing drill sites and moving the drill. Cost of this cat will be \$600.00 per month plus \$10.00 per hour when it is in use.
5. Contractor will pay the cost of moving between drill holes up to a distance of 1,500 ft. Moves beyond this distance will be charged to the Company at cost.
6. Contractor will pay the cost of supplying water to the drill for a distance of 1,500 ft. or vertical lift of 300 ft. Supplying water beyond these limits to be negotiated.
7. Contractor will supply camps @ \$400.00 each.
8. Contractor will supply board for Company men @ \$10.00 per man per day.

H. ALLEN DIAMOND DRILLING LTD.

TELEPHONE 378-4494

P.O. BOX 1397
MERRITT, B.C.

Contract - Nadina Area continued.....

B. THE COMPANY COVENANTS AND AGREES:

1. That payment for the herein described work shall be \$12.00 per foot for overburden and \$10.00 per ft. for core drilling.
2. Cost of cementing drill holes will be \$25.00 per hour plus cement at cost. Cost of drilling out cement at \$25.00 per hr.
3. Drilling mud if required charged at cost.
4. Transportation costs on this job will be \$400.00.
5. From the off loading point till the drill is set up, crew wages charged to the Company at \$9.00 per hour for drillers and \$8.00 per hour for helpers.
6. Casing and casing shoes which are non recoverable charged at cost.

IN WITNESS WHEREOF these presents have been executed by the parties hereto this _____ day of _____ A.D. 1975.

NORANDA EXPLORATION CO. LTD.

H. ALLEN DIAMOND DRILLING LTD.

M. Klein

Herb Allen

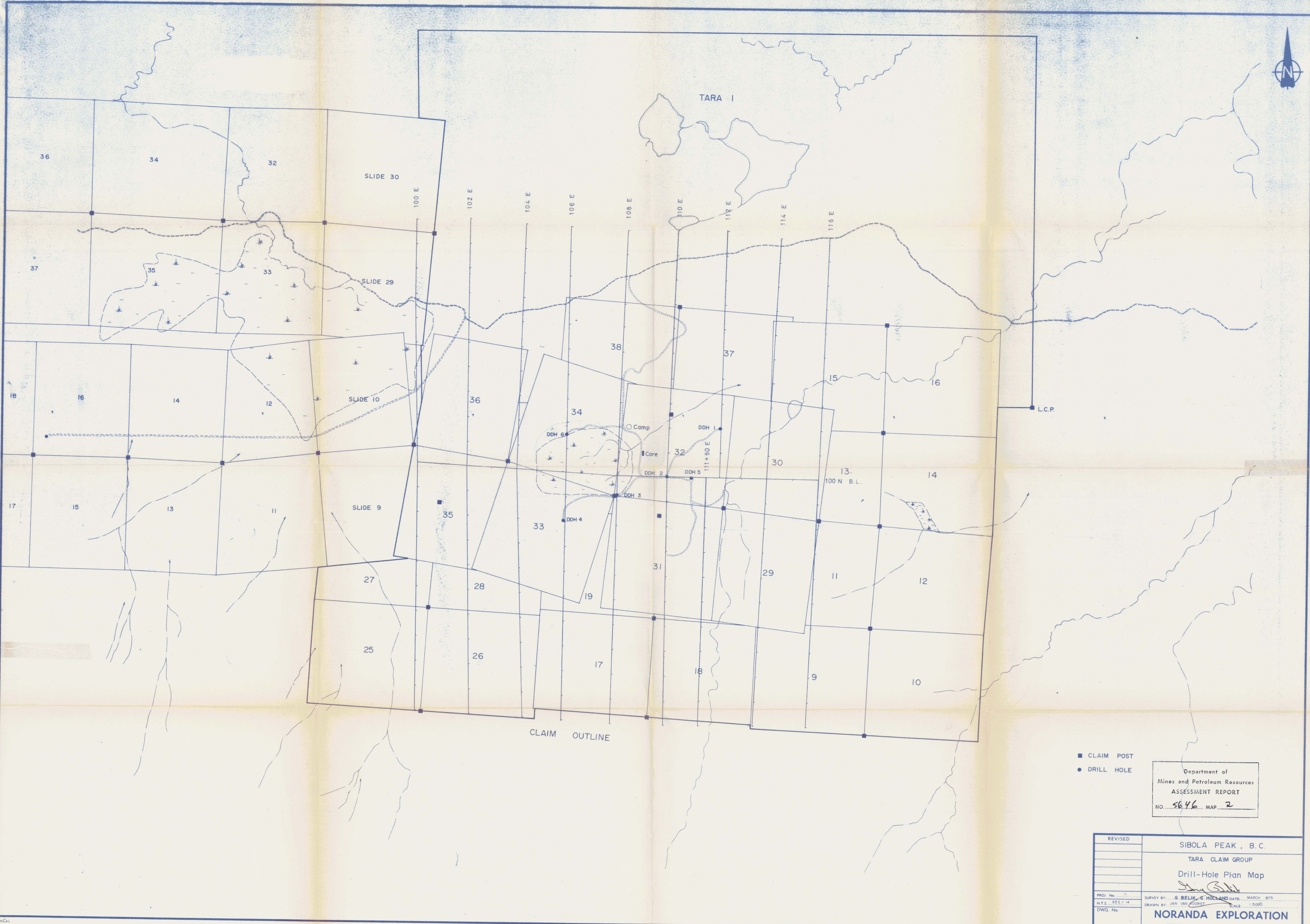

- CLAIM POST
- DRILL HOLE

Department of
Mines and Petroleum Resources
ASSESSMENT REPORT
NO. 5646 MAP 2

REVISED	SIBOLA PEAK, B.C.
	TARA CLAIM GROUP
	Drill-Hole Plan Map
PROJ. No. 11	SURVEY BY: G. BELIK, G. HOLLAND DATE: MARCH 1975
N.T.S. 93 E / 14	DRAWN BY: JAN VAN KOOBST SCALE: 1:5000
DWG. No.	NORANDA EXPLORATION
	OFFICE