

5705

FILE # LIARD
To accompany Affidavit on
Application to Record Work

DRILLING REPORT
ROBB LAKE PROPERTY

June 14 - Sept. 14, 1975

ROBB LAKE
56° 123° S.E. NTS 94B
LIARD MINING DISTRICT
N.E. BRITISH COLUMBIA

CLAIM GROUPS - AIRSTRIP, ARROW, HALFWAY, PINE POINT, TALIS MTN.,
TGS, DISCOVERY, TENNESSEE MTN., CLEO, WEST, CLEO WEST,
SHEEP CREEK, CASCADE SURPRISE, WEBB SOUTH BOUNDARY,
STRIP.

CLAIMS - 440 CLAIMS - SEE CLAIM SCHEDULE

OPERATOR - ROBB LAKE JOINT VENTURE

OWNERS - TEXASGULF CANADA LTD., 701-1281 West Georgia St.,
Vancouver 5, B.C.
FMC # 140686
issued December 23, 1974.

- ARROW INTER-AMERICA CORP, 1114 Ave. of the Americas,
New York 10036, U.S.A.
FMC # 136578
issued December 18, 1974

- BARRIER REEF RESOURCES LTS.(N.P.L.)
355 Burrard St.,
Vancouver, B.C.
FMC # 136597
issued December 19, 1974.

REPORT BY - Peter Boyle Texasgulf Inc.

September, 1975

Vancouver, B.C.

FILE # LIARD
To accompany Affidavit on
Application to Record Work

EXPLORATION REPORT ON
THE ROBB LAKE PROPERTY DURING
THE 1975 FIELD SEASON
June 14 - Sept. 14/75

ROBB LAKE
56° 123° S.E. NTS 94B
LIARD MINING DISTRICT
N.E. BRITISH COLUMBIA

- CLAIM GROUPS - AIRSTRIP, ARROW, HALFWAY, PINE POINT, TALIS MTN,
TGS, DISCOVERY, TENNESSEE MTN., CLEO, WEST, CLEO WEST
SHEEP CREEK, CASCADE SURPRISE, WEBB SOUTH BOUNDARY, STRIP.
- CLAIMS - 440 CLAIMS - SEE CLAIM SCHEDULE
- OPERATOR - ROBB LAKE JOINT VENTURE
- OWNERS - TEXASGULF CANADA LTD., 701-1281 West Georgia St.,
Vancouver 5, B.C.
FMC # 140686
issued December 23, 1974.
- ARROW INTER-AMERICA CORP, 1114 Ave. of the Americas,
New York 10036, U.S.A.
FMC # 136578
issued December 18, 1974
- BARRIER REEF RESOURCES LTD. (NPL)
355 Burrard St.,
Vancouver, B.C.
FMC # 136597
issued December 19, 1974.

REPORT BY Peter Boyle

Texasgulf Inc.

September, 1975

Vancouver, B.C.

TABLE OF CONTENTS

	<u>Page</u>
INTRODUCTION	1
CLAIM STATUS	1
LOCATION & ACCESS	1
PHYSIOGRAPHIC FEATURES	1
GEOLOGY	1
MINERALIZATION	2
OPERATIONS - 1975	2
DRILL REPORT	
A-1 Statement of Expenditures	4
A-2 Expenditure Summary	6
A-3 Drill Contract	11
A-4 Drill Logs	15
A-5 Summary of Claims on which Drilling was done	34
A-6 Drill Hole Co-ordinates	35
A-7 Core Storage	36
APPENDIX #1 Claim Schedule	37
APPENDIX #2 Statement of Qualifications	38

LIST OF ILLUSTRATIONS

# 1	Figure 1	Location Map
2	Figure 2	Claim Map showing Drill Hole Locations
3	Figure 3	Composite Plan of Mineral Claims

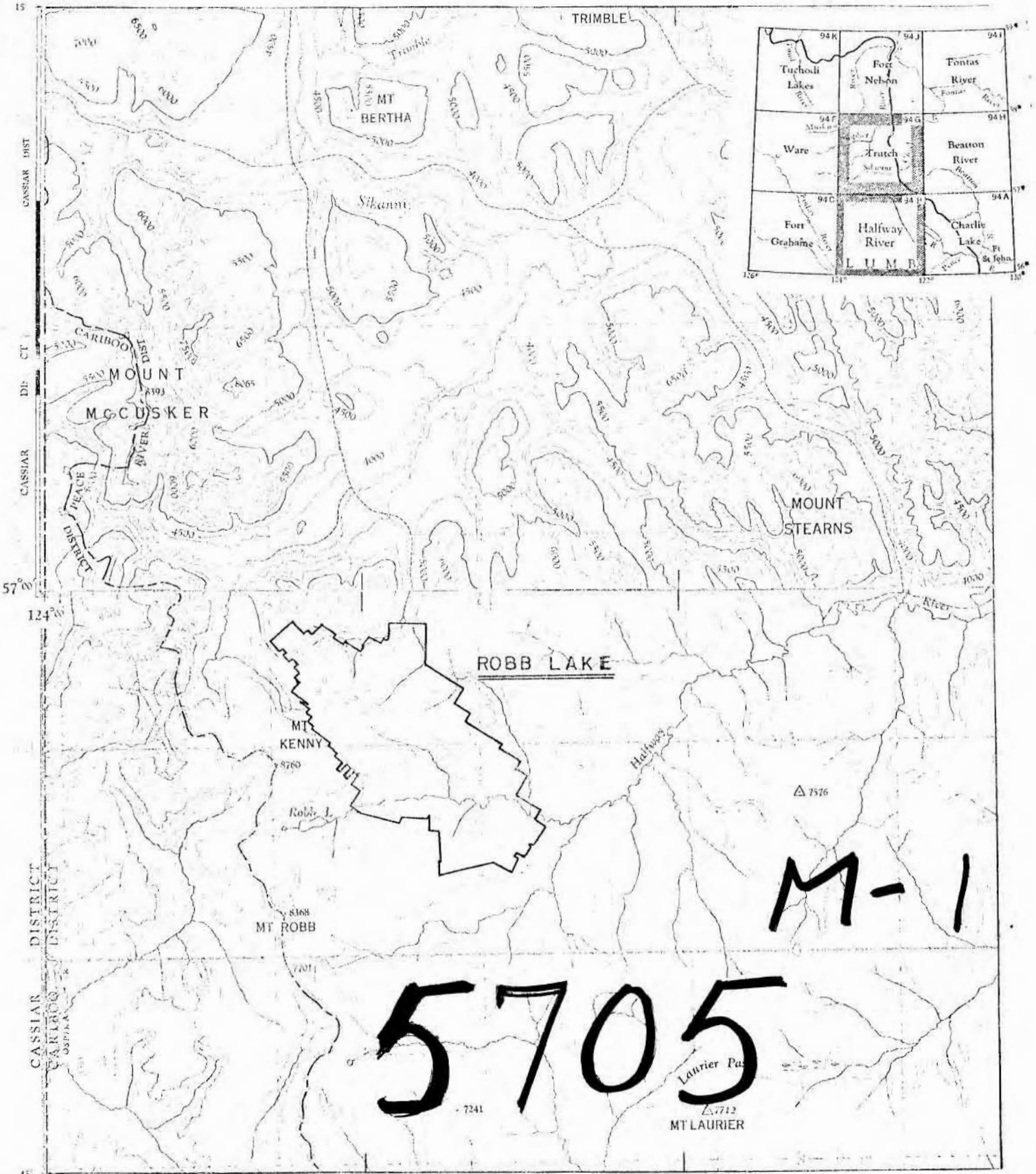

123° 56' SE.

scale 1:250,000.

ROBB LAKE JOINT VENTURE
LOCATION MAP 1975 FIGURE 1

INTRODUCTION

The report summarizes work completed on the Robb Lake property in northeastern British Columbia.

CLAIM STATUS

The claims included in the property are listed in the Claim Schedule. The registered owners are listed on the Title Page. The claims on which drilling was done are indicated on the Drill Hole Plan. This work was, however, credited to other claims in their respective groups. Compilation of the final report is in progress.

LOCATION & ACCESS

The Robb Lake property is situated at 56° 55'N, 123° 45'W (see location map). The property is supplied by aircraft from Mackenzie, 110 miles to the southwest. A 3,000 foot airstrip is located on the property and float planes can land on Robb Lake. Between Pink Mountain at Mile 136 on the Alaska Highway and Robb Lake are 30 miles of gravel highway and 20 miles of seismic trail.

PHYSIOGRAPHIC FEATURES

Mountains about Robb Lake rise to over 7,500 feet, the highest of which, Mt. Kenny, reaches an elevation of 8,760 feet. The Halfway River, draining out of Robb Lake, lies near the southern edge of the property. The unit of interest underlies Jed Ridge, Ed Ridge, Texas Ridge, Tennessee Mountain and Talis Mountain.

Long sharp ridges and high table mountains dominate the area. The bare hillsides drop steeply down to wide deeply glaciated valley floors, down which streams meander.

GEOLOGY

The area is underlain by thick sequence of Lower and Middle Palaeozoic sedimentary rocks, the most important being the dolomite of the Devonian Stone Formation.

Continued. . . .

MINERALIZATION

Sphalerite and galena and some pyrite occur in brecciated dolomites within the Stone Formation.

OPERATIONS - 1975

Approximately 20 tons of "heavy" drilling equipment and supplies were demobilized from the property to Pink Mountain, B.C. in late March.

In mid-June, camp supplies and 1½ tons of "light" drilling equipment were airlifted from Mackenzie, B.C.

The camp was opened on June 12th and the first drill hole collared on June 19th. Camp was closed on September 17th.

Geology - Geological mapping at 1" = 200' was undertaken on the Webb, Tennessee, Union, North Texas, TGS and Jed areas.

Stratigraphic Sections were measured and graphically logged at 1" = 10' at 3 localities: Union Creek; Sidenius Creek and South Texas Ridge.

Prospecting - Geologically guided prospecting has continued in a limited way. Work in the North Texas Ridge area resulted in some revision of marker trends.

Geochemistry - The Central Union anomaly was tested by two drill holes which failed to intersect significant mineralization. The test is regarded as inconclusive; a substantial fault displacement is indicated in the "re-entrant" area.

Surveys - Holes 67-69, and 72-74 have been surveyed in by transit. All holes drilled in previous years have been surveyed.

Construction - A heliport was constructed at the Jed Showing and at the upper level of the TGS Showing to assist access to these rugged areas. An access trail was constructed across the cliff face below the TGS heliport and a 300 gallon sump was built at the North Face Showing. The core racks in camp were enclosed to prevent snow damage.

Logistics - Field operations were serviced weekly by either Beech 18 or Twin Otter aircraft from Mackenzie, B.C., 110 air-miles to the south.

Continued. . . .

Personnel and diamond drill moves were supported full-time by a piston B helicopter based at camp, and intermittently by a turbo-jet 206B helicopter from Johanson Lake, or Mackenzie, about 2 hours return ferry time.

Drilling - A total footage of 2,447 feet has been drilled in fourteen holes in the Union, North Tennessee, TGS, Jed, Cascade and North Face areas.

Drilling at Central Union - a geochemical anomaly was tested by two drill holes in the South Union area, hole 63 had provided encouragement but no attractive mineralization was intersected by the 1975 drilling.

Permafrost conditions impeded drilling on the North Tennessee "Rubble" Showing. However three short scout holes were drilled and one was successful in intersecting attractive mineralization over a 30 foot core length.

At the TGS Showing three holes, collared approximately 100 feet behind the outcrop face intersected fair to good mineralization over 10-15 foot lengths, but were unsuccessful in establishing a trend.

Three holes, some 400 feet apart, were drilled on the Jed Showing to establish the thickness of breccia exposed on a dip slope. The breccia extends at least to maximum hole depth of approximately 200 feet, but only very weak, scattered mineralization was encountered.

Drilling on the Cascade area - a one-hole test of the Cascade anomaly was aborted short of its objective, at a depth of 90 feet, in poor ground. This test is also regarded as inconclusive though it indicates a lack of near-surface mineralization.

At the North Face, a re-examination of the surface outcrop in unusually snow-free conditions confirmed earlier work indicating a well mineralized breccia. An up-hole, at +20° was drilled to test this zone, but was stopped at 96 feet. The drill machine was unable to supply sufficient water to the drillbit to permit drilling beyond this point. Good Zn-Pb grades were encountered throughout the hole.

A vertical hole at -90° was drilled to a depth of 39 feet from the same site before equipment breakdown terminated the programme. Similar mineralized breccia was encountered though barren blocks are noticeably larger.

DRILL REPORT

A-1 STATEMENT OF EXPENDITURES

ROBB LAKE JOINT VENTURE PROJECT - 1975

Work on the Robb Lake project during 1975 was managed on behalf of the Joint Venture (Texasgulf Canada Ltd., Arrow Inter-America Corporation and Barrier Reef Resources Ltd. (NPL) by Texasgulf Inc.

The Expenditure Summary (A-2), which has been derived from a calculation in the field, shows the total cost of drilling at Robb Lake during the 1975 field season, to be \$64,096.50. Numerous invoices chargeable to the project have not been received at the time at which this report is being prepared, however costs are expected to be in excess of \$150,000.00 for the 1975 season. The total cost includes consulting fees charged by the project managers and the cost of geological mapping and related studies which have not been applied towards assessment requirements.

Texasgulf personnel engaged on the project to whom the above salaries, fringe benefits and fees apply are listed below:

<u>Name</u>	<u>Capacity</u>	<u>Dates</u>	<u>Daily rate of Compensation</u>
R.G.Gifford,P.Eng.	Project Geologist	29 days	\$ 100.00*
F.T.Manns, M.Sc.	Geologist	June 12 - Sept. 20, '75	60.00
P.J.S.Boyle, B.Sc.	Geologist	June 12 - Sept. 20, '75	55.00
P.C.Hubachek	Field Assistant	June 17 - Aug. 12, '75	30.00
B.W.Jacobson	Field Assistant	June 12 - Aug. 15, '75	28.00
R. Cotton	Field Assistant	June 19 - Aug. 5, '75	24.00
P.Potter	Field Assistant	June 19 - Aug. 25, '75	24.00
K.Kolterman	Cook	June 12 - Sept. 8, '75	28.00
A.Armstrong	Draftsman	5 days	55.00
J.M.Newell,P.Eng.	District Manager	3 days	150.00*

* Fee as per management contract.

In addition to the above Texasgulf Inc. personnel, contractors were engaged on the property as follows:

Wink International	2 - 4 men	June 15 - September 1, 1975
Alpine Helicopters	2 men	June 15 - September 1, 1975

Applications for Certificates of Work have been filed, reporting expenditures for diamond drilling and related support totalling \$ 64,096.50 i.e. less than 40% of total expenditures. Reasons for this short fall in cost-reported and total costs listed above are summarized as follows:

1. Inability to record more than ten years excess work.
2. Confining assessment work application to diamond drilling and directly related costs.
3. Non-applicability of certain costs listed above.
4. Confidentiality of assay data.



R. G. Gifford, P.Eng.

A-2 EXPENDITURE SUMMARY

DDH: 67, 68A, B, C, 69, 70, 71, 72, 73, 74, 75, 76, 77, 78, 79, 80A, B.

<u>HOLE # 67</u>	<u>Footage: 228</u>	<u>Days: 6</u>
Direct Drilling		\$ 2,677.80
Site Preparation		-
Helicopter Support (Shift Changes etc.)		1,260.00
Supervision: Logging etc. P.J.S.Boyle 1 day		55.00
Room & Board 12 man-days @ \$12.00		<u>144.00</u>
TOTAL		\$ <u>4,136.80</u>

All - up cost per foot = \$18.14/ft.

<u>HOLE # 68 A,B,C.</u>	<u>Footage: 106</u>	<u>Days: 11</u>
Direct Drilling		\$ 2,290.60
Site Preparation		-
Helicopter Support (Shift Changes etc.)		1,620.00
Supervision: Logging etc. P.J.S.Boyle 1 day		55.00
Room & Board 22 man-days @ \$12.00		<u>264.00</u>
TOTAL		\$ <u>4,229.60</u>

All - up cost per foot = \$39.90/ft.

<u>HOLE # 69</u>	<u>Footage: 267</u>	<u>Days: 9</u>
Direct Drilling		\$ 3,244.20
Site Preparation		-
Helicopter Support (Shift Changes etc.)		1,260.00
Supervision: Logging etc. P.J.S.Boyle 1 day		55.00
Room & Board 18 man-days @ \$12.00		<u>218.00</u>
TOTAL		\$ <u>4,777.20</u>

All - up cost per foot = \$17.89/ft.

Continued. . . .

<u>HOLE # 70</u>	<u>Footage: 211</u>	<u>Days: 5½</u>
Direct Drilling		\$ 2,346.10
Site Preparation		-
Helicopter Support (Shift Changes etc.)		360.00
Supervision, Logging etc. P.J.S.Boyle 1 day		55.00
Room & Board 11 man-days @ \$12.00		<u>132.00</u>
TOTAL		\$ <u>2,893.10</u>

All - up cost per foot = \$13.71/ft.

<u>HOLE # 71</u>	<u>Footage: 176</u>	<u>Days: 4</u>
Direct Drilling		\$ 1,877.60
Site Preparation		-
Helicopter Support (Shift Changes etc.)		540.00
Supervision: Logging etc. P.J.S.Boyle 1 day		55.00
Room & Board 8 man-days @ 12.00		<u>96.00</u>
TOTAL		\$ <u>2,568.60</u>

All - up cost per foot = \$14.59/ft.

<u>HOLE # 70 & 71</u>		
TOTAL COST		\$ <u>5,461.70</u>
Average cost per foot = \$14.11/ft.		

<u>HOLE # 72</u>	<u>Footage: 211</u>	<u>Days: 7</u>
Direct Drilling		\$ 2,254.48
Site Preparation		660.00
Helicopter Support (Shift Changes etc.)		2,340.00
Supervision: Logging etc. P.J.S.Boyle 1 day		55.00
Room & Board 14 man-days @ 12.00		<u>168.00</u>
TOTAL		\$ <u>5,771.60</u>

All - up cost per foot = \$27.35/ft.

HOLE # 73 Footage: 190 Days: 5½

Direct Drilling	\$ 2,186.00
Site Preparation	110.00
Helicopter Support (Shift Changes etc.)	1,080.00
Supervision: Logging etc. P.J.S. Boyle 1 day	55.00
Room & Board 11 man-days @ \$12.00	<u>132.00</u>
TOTAL	\$ <u>3,563.00</u>

All - up cost per foot = \$18.75/ft.

HOLE # 74 Footage: 164 Days: 13

Direct Drilling	\$ 2,731.40
Site Preparation	110.00
Helicopter Support (Shift Changes etc.)	3,520.00
Supervision: Logging etc. P.J.S. Boyle 3 days	165.00
Room & Board 27 man-days @ \$12.00	<u>312.00</u>
TOTAL	\$ <u>6,838.40</u>

All - up cost per foot = \$41.70/ft.

HOLE # 72, 73, 74

TOTAL COST	\$ <u>16,173.00</u>
------------	---------------------

Average Cost per foot = \$28.62/ft.

HOLE # 75 Footage: 235 Days: 6

Direct Drilling	\$ 2,567.00
Site Preparation	880.00
Helicopter Support (Shift Changes etc.)	3,372.00
Supervision: Logging etc. P.J.S. Boyle 1 day	55.00
Room & Board 12 man-days @ 12.00	<u>144.00</u>
TOTAL	\$ <u>7,018.00</u>

All - up cost per foot = \$29.86/ft.

<u>HOLE # 76</u>	<u>Footage: 185</u>	<u>Days: 7</u>
Direct Drilling		\$ 2,291.00
Site Preparation		-
Helicopter Support (Shift Changes etc.)		2,358.00
Supervision: Logging etc. P.J.S. Boyle 1 day		55.00
Room & Board 14 man-days @ \$12.00		<u>168.00</u>
TOTAL		\$ <u>4,872.00</u>
All-up cost per foot = \$26.34/ft.		

<u>HOLE # 77</u>	<u>Footage: 180</u>	<u>Days: 7</u>
Direct Drilling		\$ 2,541.00
Site Preparation		-
Helicopter Support (Shift Changes etc.)		1,818.00
Supervision: Logging etc. P.J.S. Boyle 1 day		55.00
Room & Board 14 man-days @ \$12.00		<u>168.00</u>
TOTAL		\$ <u>4,582.00</u>
All-up cost per foot = \$25.46/ft.		

<u>HOLE # 78</u>	<u>Footage: 73</u>	<u>Days: 2</u>
Direct Drilling		\$ 824.80
Site Preparation		-
Helicopter Support (Shift Changes etc.)		900.00
Supervision: Logging etc. P.J.S. Boyle 1 day		55.00
Room & Board 4 man-days @ \$12.00		<u>48.00</u>
TOTAL		\$ <u>1,827.80</u>
All-up cost per foot = \$25.04/ft.		

Continued. . . .

HOLE # 79

Footage: 93

Days: 6

Direct Drilling	\$ 1,516.80
Site Preparation	275.00
Helicopter Support (Shift Changes etc.)	2,070.00
Supervision: Logging etc. P.J.S.Boyle 2 days	110.00
Room & Board 12 man-days @ \$12.00	<u>144.00</u>
TOTAL	\$ <u>4,115.80</u>

All-up cost per foot = \$44.26/ft.

HOLE # 80 A, B.

Footage: 136

Days: 6

Direct Drilling	\$ 1,843.60
Site Preparation	444.00
Helicopter Support (Shift Changes etc.)	4,200.00
Supervision: Logging etc. P.J.S.Boyle 5 days	275.00
Room & Board 12 man-days @ \$12.00	<u>144.00</u>
TOTAL	\$ <u>6,902.60</u>

All-up cost per foot = \$50.75/ft.

GRAND TOTAL

\$ 64,096.50

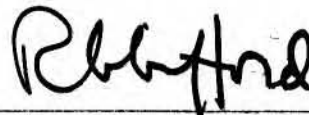

R. G. Gifford, P.Eng.

A- 3 DRILL CONTRACT



Winkie International Exploration Drilling Ltd.

CONTRACTORS & CONSULTANTS

TELEPHONE: (604) 943-7234
CABLE: "WINKIE", DELTA, B.C., CANADA

4814 DOGWOOD DRIVE
DELTA, B.C., CANADA

THIS AGREEMENT made this *31st* day of March, 1975,

BETWEEN: Texasgulf, Inc.
701 - 1255 West Georgia Street,
Vancouver, B. C. V6E 3J7

(hereinafter referred to as the Company)

AND: Wink International Exploration Drilling Ltd.
4814 Dogwood Drive,
Delta, B. C. V4M 1M4

(hereinafter referred to as the Contractor)

WHEREAS the Company hereby request that the Contractor perform certain surface Winkie drilling in the vicinity of Robb Lake, B. C.;

1. EQUIPMENT:

The Contractor will supply one Winkie drill and all drilling equipment including diamond items to drill to a depth of 350 feet or to the depth of the capacity of the Winkie drill in said rock formations, recovering 1-3/8" diameter core;

Depending on rock conditions, the Contractor will also supply drilling equipment to reduce the core size to 1" diameter if warranted to reach a greater drilling depth on said property;

One Winkie driller and one helper per drilling shift.

2. GUARANTEED FOOTAGE:

The Company guarantees a minimum of 1,500 feet of diamond drilling with an option of an additional 1,500 feet providing the Company is satisfied with the performance of the drilling equipment and ~~XXXXXXXXXX~~ geological conditions.

Winkie

3. WATER SUPPLY:

Normal pumping equipment supplied with the Winkie has a capacity of 1,000 feet, not exceeding 250 feet lift. Mr. J. M. Nowell estimated some of the drilling sites may require 3,500 ft. of water line with approximately 750 ft. lift. The additional cost to rent extra pumping units and supplies and maintenance thereof will be charged to the Company at the Contractor's cost.

4. INSURANCE:

The Contractor will be responsible and will pay promptly all dues and assessments payable under the Workmens Compensation Act, or other similar Acts, whether Provincial or Federal, in respect to it's employees. The Contractor is also covered with Third Party Liability Insurance, legal liability for bodily injury to or death of any person or damage to property, where warrented, in the amount of \$500,000.00.

5. SECURITY:

The Contractor will not give out any information regarding drill results or permit access to any drill core to any other person other than the Company's accredited representatives. It is agreed that the contents of this agreement shall remain confidential between Management of the Company and the Contractor.

6. SANITATION & ENVIRONMENT:

During the course of work, the Contractor shall at all times keep the Company's premises free from the accumulation of waste material or rubbish and upon completion of work shall remove all surplus material and rubbish and leave the premises clean and shall observe and comply with the Federal and Provincial Laws and Orders pertaining to the prevention of forest fires.

THE COMPANY AGREES:

To pay the Contractor for all footage drilled and other services rendered as follows:

Price:

(a) Drilling to a depth of 350 feet and/or the capacity of the drill at the rate of \$7.60 per lineal foot drilled;

(b) Plus \$135.00 per day per two man crew shift, commencing when the drill crew and drilling equipment leaves Vancouver and until the drill crew and drilling equipment returns to Vancouver. If the drill crew should request some time off and be absent from the project, the Contractor shall credit the Company at the rate of \$135.00 per day for each day the crew is absent from the drilling project, unless other arrangements are made.

(c) Plus the cost of all shipping and transportation, as well as all fuels and lubricants for drilling at no cost to the Contractor.

Reaming:

Reaming with diamond bits shall be at the same price as drilling, corresponding rates as set forth in paragraph (a).

Overburden:

Drilling casing through overburden to the capacity of the drill shall be at the same rate as core drilling, corresponding to rates set forth in paragraph (a). All drilling measurements taken from the top of casing. No holes shall be drilled flatter than 45° angle.

Lodging:

The Company will supply Board and Lodging and all transportation at no extra cost to the Contractor.

Payment:

The Contractor shall invoice the Company semi-monthly for the above services. Such invoices shall be due and payable within 15 days of invoice date.

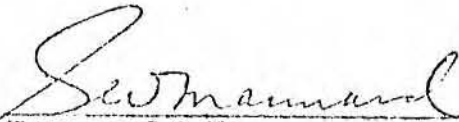
Texasgulf Inc.

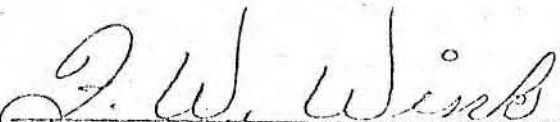
Wink International Exploration
Drilling Ltd.

A-4 DRILL LOGS

SURVEY METHOD:		
DEPTH	DIP	ERG.

Texasgulf Inc.
DRILL HOLE LOG

HOLE No. 67	PAGE No. 1 of 1
----------------	--------------------

LENGTH: 228' LOCATION: 85833 N
 DIP: -90° 57309 E
 ERG.: - ELEVATION: 5833' EL.

PROPERTY / CLAIM: ROBB LAKE
 Cleo 132 SW $\frac{1}{4}$
 PURPOSE:

START: June 19, 1975

FINISH: June 22, 1975
 CORE SIZE:

LOG / DATE: June 23, 1975

FOOTAGE		DESCRIPTION	ASSAY No.	ASSAYS FROM-TO/LENGTH	%	%	%	oz/T	oz/T
FROM	TO								
0.0	10.0	OVERBURDEN Casing to 17'							
10.0	51.0	<u>DOLOSTONE</u>							
		10.0 - 51.0 Tight sandy grainstone/silty mudstone cycles.							
	51.0	<u>B/C CONTACT</u> Laminated mudstone below.							
51.0	228.0	<u>DOLOSTONE EXTENSIVE BRECCIA</u>							
		65.0 - 80.0 Pb-Zn mineralization weak.							
		94.5 - 97.5 Floating $\frac{1}{2}$ mm. and 1 mm. sand grains.							
		60.0 - 192.0 Breccia - large fragments supported by white sparry dolomite.							
		96.0 - 96.5 Tectonic breccia.							
		180.0 - 181.0 Tectonic breccia.							
		192.0 - 228.0 Amphipora gravel.							
		51.0 - 228.0 High porosity, permeability.							
228		<u>E.O.H.</u>							

Peter Boyle

SURVEY METHOD:		
DEPTH	DIP	BRG.

Texasgulf Inc.

DRILL HOLE LOG

HOLE No.	PAGE No.
68A	1 of 1

START: June 23, 1975

FINISH: June 25, 1975

CORE SIZE: AIX

LOG/DATE: Peter Boyle

LENGTH: 54'
 DIP: -90°
 BRG.: -

LOCATION: 84263 N
 56689 E
 ELEVATION: 6416 EL.

PROPERTY / CLAIM: ROBB LAKE
 MV 55 SE¼

PURPOSE:

FOOTAGE		DESCRIPTION	ASSAY No.	ASSAYS FROM - TO/LENGTH	%	%	%	oz/T	oz/T
FROM	TO								
0.0	54.0	<u>DOLOSTONE</u>							
		0.0 - 54.0 Breccia, amhipora gravel and amhipora wackestone, white sparry dolomite matrix.							
		0.0 - 54.0 Numerous tr. Py., Sph., Ga.							
		0.0 - 54.0 High porosity, permeability.							
54		<u>E.O.H.</u>							

-17-

Peter Boyle

SURVEY METHOD:			
DEPTH	DIP	BRG.	

Texasgulf Inc.

DRILL HOLE LOG

HOLE No.	PAGE No.
68B	1 of 1

START: August 14, 1975

FINISH: August 17, 1975

CORE SIZE: AIX

LOG/DATE: Peter Boyle

LENGTH: 39'
 D/P: -90°
 BRG: -

LOCATION: 84239 N
 56610 E
 ELEVATION: 6412' El.

PROPERTY / CLAIM: ROBB LAKE
 MV 55 SE ¼

PURPOSE:

FOOTAGE		DESCRIPTION	ASSAY No.	ASSAYS FROM - TO / LENGTH	% Pb	% Zn	% Cu	oz/T Au	oz/T Ag
FROM	TO								
0.0	5.0	OVERBURDEN 10' Casing							
5.0	39.0	<u>DOLOSTONE BRECCIA</u> - Unit 'C'							
	5.0 - 8.0	Mudstone/grainstone cycle.							
	8.0 - 39.0	Mudstone (pelletal).							
	8.0 - 39.0	Good mineralization Sph. Ga. Py.							
39.0		<u>E.O.H.</u>							

Peter Boyle

SURVEY METHOD:

DEPTH	DIP	ERG.

Texasguif Inc.

DRILL HOLE LOG

HOLE No.

68C

PAGE No.

1 of 1

START: August 17, 1975

FINISH: August 19, 1975

CORE SIZE: AIX

LOG / DATE: Peter Boyle

LENGTH: 17'
 DIP: -90°
 ERG.: -

LOCATION: 84220 N
 56560 E
 ELEVATION: 6407' EL.

PROPERTY / CLAIM: ROBB LAKE
 MV 55 SE¼

PURPOSE:

FOOTAGE		DESCRIPTION	ASSAY No.	ASSAYS FROM - TO / LENGTH	%	%	%	oz/T	oz/T
FROM	TO								
0	4.5	OVERBURDEN 10' Casing							
4.5	17.0	<u>DOLOSTONE BRECCIA</u> - Unit 'C' 4.5 - 17.0 Pelletal mudstone breccia fragments with white sparry dolomite matrix.							
	17.0	<u>E.O.H.</u>							

Peter Boyle

SURVEY METHOD:		
DEPTH	DIP	BRG.

Texasgulf Inc.
DRILL HOLE LOG

HOLE No. 69	PAGE No. 1 of 1
----------------	--------------------

START: June 28, 1975

FINISH: July 7, 1975

CORE SIZE: AIX

LOG / DATE: Peter Boyle

LENGTH: 267'
DIP: -90°
BRG: -

LOCATION: 85353 N
57097 E

ELEVATION: 5990' EL.

PROPERTY / CLAIM: ROBB LAKE
Cleo 119 NW¼

PURPOSE:

FOOTAGE		DESCRIPTION	ASSAY No.	ASSAYS FROM-TO/LENGTH	% Pb	% Zn	% Cu	oz/T Au	oz/T Ag
FROM	TO								
0.0	15.0	OVERBURDEN 16' Casing							
15.0	267.0	<u>DOLOSTONE</u>							
		0.0 - 267.0 Tight bluish silty mudstone							
		0.0 - 267.0 Numerous breccia interbeds becoming more intense with depth, occasional trace pyrobitumen. No mineralization							
267.0		E.O.H							

Peter Boyle

SURVEY METHOD:		
DEPTH	DIP	BRG.

Texasgulf Inc.

DRILL HOLE LOG

HOLE No. 70	PAGE No. 1 of 1
----------------	--------------------

LENGTH: 211' LOCATION: 86940 N
 D.P.: -90° 57190 E
 BRG.: - ELEVATION: 5785' El.

PROPERTY / CLAIM: ROBB LAKE
 Cleo 129 SE¼
 PURPOSE:

START: Jul. 9, '75 & Aug. 12 '75

FINISH: July 10, '75 & Aug. 14 '75
 CORE SIZE: AIX

LOG / DATE: Peter Boyle

FOOTAGE		DESCRIPTION	ASSAY No.	ASSAYS	%	%	%	oz/T	oz/T
FROM	TO			FROM-TO/LENGTH	Pb	Zn	Cu	Au	Ag
0.0	14.5	OVERBURDEN 15' Casing							
14.5		<u>DOLOSTONE</u> - Unit 'C' lithologies							
		0.0 - 58.0 Pelletal mudstone cycles, locally amphipora wackestones.							
		58.0 - 101.0 Pelletal mudstone/silty mudstone cycles							
		0.0 - 106.5 Crackle brecciation, white sparry dolomite.							
101.0	106.5	<u>FAULT</u> Tectonic breccia 30% core loss.							
106.5	112.0	<u>FAULT</u> Cavern 100% core loss.							
112.0	139.5	<u>DOLOSTONE BRECCIA</u> - Unit 'B' lithologies							
		112.0 - 139.5 Breccia tight silty mudstone fragments with rock flour matrix scattered white sparry dolomite in matrix.							
139.5		<u>B/C CONTACT</u>							
139.5	211.0	<u>DOLOSTONE</u> - Unit 'C' lithologies							
		139.5 - 157.0 Amphipora Gravel.							
		157.0 - 211.0 Pelletal/homogeneous mudstone							
		182.0 - 189.0 Breccia, white sparry dolomite matrix							

Peter Boyle

SURVEY METHOD:		
DEPTH	DIP	BRG.

Texasgulf Inc.
DRILL HOLE LOG

HOLE No. 71	PAGE No. 1 of 1
-------------	-----------------

LENGTH: 176 LOCATION: 87070 N
 DIP: -90° 57432 E
 BRG: - ELEVATION: 5775' E1.

PROPERTY / CLAIM: ROBB LAKE
 Cleo 129 SE¼
 PURPOSE:

START: July 9, 1975
 FINISH: July 10, 1975
 CORE SIZE: AIX

LOG / DATE: Peter Boyle

FOOTAGE		DESCRIPTION	ASSAY No.	ASSAYS FROM-TO/LENGTH	% Pb	% Zn	% Cu	oz/T Au	oz/T Ag
FROM	TO								
0	10.0	OVERBURDEN 12' Casing							
10.0	141.5	<u>DOLOSTONE</u>							
	0.0 - 102.0	Tight Silty/Sandy mudstone cycles, sand grains @ 27', 40'-43', 55', 60' 92'.							
	91.0 - 91.5	Tectonic brecciation							
	99.0 - 100.0	Tectonic brecciation							
	102.0 - 141.5	Sandy mudstone							
	10.0 - 141.5	Crackle brecciation, white sparry dolomite filled carrying weak-trace Sph.							
141.5		<u>B/C CONTACT</u>							
141.5	176.0	<u>DOLOSTONE</u>							
	141.5 - 176.0	Amphipora gravel, amphipora wackestone breccia.							
176.0		E.O.H.							

Peter Boyle

SURVEY METHOD:			
DEPTH	DIP	BRG.	

Texasgulf Inc.
DRILL HOLE LOG

HOLE No. 72	PAGE No. 1 of 1
-------------	-----------------

LENGTH: 211 LOCATION: 82200 N
 DIP: -60° 48539 E
 BRG.: 015° Az ELEVATION: 6972' E1.

PROPERTY / CLAIM: ROBB LAKE
 MV5 NW¼
 PURPOSE:

START: July 11, 1975
 FINISH: July 14, 1975
 CORE SIZE: AIX
 LOG / DATE: Peter Boyle

FOOTAGE		DESCRIPTION	ASSAY No.	ASSAYS FROM-TO/LENGTH	% Pb	% Zn	% Cu	oz/T Au	oz/T Ag
FROM	TO								
0.0	0.0	OVERBURDEN 3' casing							
0.0	148.0	<u>DOLOSTONE BRECCIA</u>							
	0.0 - 148.0	Breccia - mixed fragments of tight silty mudstone, sandy mudstone and sandy grainstone, dark micrite vadose infilling extensive, white sparry dolomite matrix locally.							
	145.0 - 148.0	Pyrite dissem in large blocks in breccia							
	0.0 - 148.0	Numerous traces mineralization Sph, Ga., Py. Locally well mineralized.							
148.0	211.0	<u>DOLOSTONE</u>							
	148.0 - 211.0	Pelletal/silty mudstone cycles, some breccia interbeds locally weak mineralization.							
	211	E.O.H.							

Peter Boyle

SURVEY METHOD:		
DEPTH	DIP	BRG.

Texsgulf Inc.

DRILL HOLE LOG

HOLE No. 73	PAGE No. 1 of 1
----------------	--------------------

START: July 14, 1975

FINISH: July 17, 1975

CORE SIZE: AIX

LOG/DATE: Peter Boyle

LENGTH: 190' LOCATION: 82132 N
 DIP: -60° 48586 E
 BRG.: 015° Az ELEVATION: 6972' E1

PROPERTY / CLAIM: ROBB LAKE
 MV5 NW¼

PURPOSE:

FOOTAGE		DESCRIPTION	ASSAY No.	ASSAYS FROM-TO/LENGTH	%	%	%	oz/T	oz/T
FROM	TO								
0.0	0.0	OVERBURDEN 3' Casing							
0.0	18.0	<u>DOLOSTONE</u>							
	0.0 - 18.0	Pelletal Mudstone							
18.0	125.0	<u>DOLOSTONE BRECCIA</u>							
	18.0 - 125.0	Breccia, silty-sandy grainstone fragments							
	18.0 - 40.0	White sparry dolomite and qtz. matrix							
	40.0 - 75.0	White sparry dolomite matrix							
	75.0 - 125.0	Contorted dark matrix - vadose micrite infilling, matrix.							
	18.0 - 85.0	Scattered weak Ga. Sph. Py.							
	85.0 - 125.0	Good mineralization Ga. Sph. Py.							
125.0	190.0	<u>DOLOSTONE</u>							
	125.0 - 190.0	Pelletal Mudstone, numerous poorly preserved amphipora fragments.							
	125.0 - 190.0	No significant mineralization							
190.0		E.O.H.							

-25-

Peter Boyle

SURVEY METHOD:			
DEPTH	DIP	BRG.	

Texasgulf Inc.

DRILL HOLE LOG

HOLE No. 73	PAGE No. 1 of 1
----------------	--------------------

START: July 14, 1975

FINISH: July 17, 1975

CORE SIZE: AIX

LOG/DATE: Peter Boyle

LENGTH: 190' LOCATION: 82132 N
 DIP: -60° 48586 E
 BRG.: 0150 Az ELEVATION: 6972' E1

PROPERTY / CLAIM: ROBB LAKE
 MV5 NW¼

PURPOSE:

FOOTAGE FROM	TO	DESCRIPTION	ASSAY No.	ASSAYS	%	%	%	oz/T	oz/T
				FROM-TO/LENGTH	Pb	Zn	Cu	Ag	Ag
0.0	0.0	OVERBURDEN 3' Casing							
0.0	18.0	<u>DOLOSTONE</u>							
	0.0 - 18.0	Pelletal Mudstone							
18.0	125.0	<u>DOLOSTONE BRECCIA</u>							
	18.0 - 125.0	Breccia, silty-sandy grainstone fragments							
	18.0 - 40.0	White sparry dolomite and qtz. matrix							
	40.0 - 75.0	White sparry dolomite matrix							
	75.0 - 125.0	Contorted dark matrix - vadose micrite infilling, matrix.							
	18.0 - 85.0	Scattered weak Ga, Sph. Py.							
	85.0 - 125.0	Good mineralization Ga. Sph. Py.							
125.0	190.0	<u>DOLOSTONE</u>							
	125.0 - 190.0	Pelletal Mudstone, numerous poorly preserved amphipora fragments.							
	125.0 - 190.0	No significant mineralization							
190.0		E.O.H.							

-25-

Peter Boyle

SURVEY METHOD:		
DEPTH	DIP	ERG.

Texasgulf Inc.
DRILL HOLE LOG

HOLE No. 74	PAGE No. 1 of 1
-------------	-----------------

LENGTH: 164'
DIP: -90°
ERG: -

LOCATION: 82131 N
48586 E
ELEVATION: 6918' EL.

PROPERTY / CLAIM: ROBB LAKE
MV5 NW¼

PURPOSE:

START: July 17, 1975

FINISH: July 25, 1975

CORE SIZE: AIX

LOG / DATE: Peter Boyle

FOOTAGE		DESCRIPTION	ASSAY No.	ASSAYS FROM-TO/LENGTH	% Pb	% Zn	% Cu	oz/T Au	oz/T Ag
FROM	TO								
0.0	0.0	OVERBURDEN 3' casing.							
0.0	35.0	<u>DOLOSTONE</u>							
		0.0 - 35.0 Pelletal/silty/sandy mudstone cycles.							
35.0	48.0	<u>DOLOSTONE BRECCIA</u>							
		35.0 - 38.0 Breccia - pelletal mudstone fragments, white sparry dolomite matrix, scattered traces Sph. Ga.							
48.0	63.0	<u>DOLOSTONE</u>							
		48.0 - 63.0 Pelletal mudstone - grainstone (fossiliferous - small brachiopods unidentifiable). No significant mineralization.							
63.0	163.0	<u>DOLOSTONE BRECCIA</u>							
		63.0 - 163.0 Breccia - silty mudstone fragments, occasional sandy mudstone fragments. Dark grey vadose micrite infilling matrix.							
		85.0 - 100.0 Scattered weak Sph.							
		100.0 - 115.0 Good mineralization Sph. Ga.							
		115.0 - 145.0 Scattered traces Sph. Py.							
163'		<u>E.O.H.</u>							

Peter Boyle

SURVEY METHOD:		
DEPTH	DIP	ERG.

Texasgulf Inc.

DRILL HOLE LOG

HOLE No.	PAGE No.
75	1 of 1

LENGTH: 235'
 DIP: -90°
 ERG.: -

LOCATION: 89970 N
 40720 E
 ELEVATION: 6460' EL.

PROPERTY / CLAIM: ROBB LAKE
 Rex 14 SW $\frac{1}{4}$

PURPOSE:

START: July 26, 1975
 FINISH: July 30, 1975
 CORE SIZE: AIX
 LOG / DATE: Peter Boyle

FOOTAGE		DESCRIPTION	ASSAY No.	ASSAYS FROM-TO/LENGTH	% Pb	% Zn	% Cu	oz/T Au	oz/T Ag
FROM	TO								
0.0	8.0	OVERBURDEN 9' Casing							
8.0	202.0	<u>DOLOSTONE - SEDIMENTARY BRECCIA - Unit 'C'</u> 8.0 - 202.0 Homogeneous mudstone/grainstone with rock flour matrix. Sandy grainstone blocks at 40', 45', 102', 110', 114', 124'-130', 135'-137', 145'-155', 170'-171', 197'-198'. 8.0 - 85.0 Scattered traces Sph. Ga. Py. associated with white sparry dolomite in crackle breccia.							-27-
202.0	235.0	<u>DOLOSTONE</u> 202 - 217 Homogeneous silty mudstone/grainstone cyles.							
	235.0	<u>E.O.H.</u>							

Peter Boyle

SURVEY METHOD:		
DEPTH	DIP	BRG.

Texas Gulf Inc.
DRILL HOLE LOG

HOLE No. 76	PAGE No. 1 of 1
----------------	--------------------

START: July 30, 1975

FINISH: August 5, 1975
CORE SIZE: AIX

LOG/DATE: Peter Boyle

LENGTH: 185'
DIP: -90°
BRG.: -

LOCATION: 89611 N
40945 E
ELEVATION: 6390' El.

PROPERTY / CLAIM: ROBB LAKE
Rex 14 Fr. SE ¼

PURPOSE:

FOOTAGE		DESCRIPTION	ASSAY No.	ASSAYS FROM-TO/LENGTH	% Pb	% Zn	% Cu	oz/T Au	oz/T Ag
FROM	TO								
0.0	3.0	OVERBURDEN 53' Casing.							
3.0	132.0	<u>DOLOSTONE BRECCIA - Unit 'C'</u> 3.0 - 132.0 Mudstone/grainstone cycles brecciated, breccia shows distinctly bedded character, occasional scattered poorly preserved fossils. Scattered trace Sph., Ga., Py. associated with white sparry dolomite in crackle breccia overprint. Trace Py. (Sph.) on stylolites.							
132.0	184.5	<u>DOLOSTONE BRECCIA INTERBEDS</u> 132.0 - 184.5 Mudstone/grainstone cycles brecciated locally. Sand grains @ 161'-162', 164'-169', 178'-180' and 183-184'.							
184.5		<u>E.O.H.</u>							

Peter Boyle

SURVEY METHOD:				
DEPTH	DIP	BRG.		

Texasgulf Inc.
DRILL HOLE LOG

HOLE No. 77	PAGE No. 1 of 1
----------------	--------------------

START: August 1, 1975

FINISH: August 10, 1975

CORE SIZE: AIX

LOG / DATE: Peter Boyle

LENGTH: 170'
DIP: -90°
BRG.: -

LOCATION: 89237 N
41190 E

ELEVATION: 6420' E1

PROPERTY / CLAIM: ROBB LAKE
Rex 13 Fr. NE¼

PURPOSE:

FOOTAGE		DESCRIPTION	ASSAY No.	ASSAYS FROM-TO/LENGTH	% Pb	% Zn	% Cu	oz/T Au	oz/T Ag
FROM	TO								
0.0	3.0	OVERBURDEN 9' Casing							
3.0	159.0	<u>DOLOSTONE BRECCIA</u> - Unit 'C'							
		3.0 - 159.0 Mudstone/grainstone cycles brecciated, breccia shows bedded character. Sand grains @ 3'9', 54'-59', 106'-107', 145'-146', Sand grains @ 151'-159' in matrix.							
		10.0 - 35.0 Traces Py. (Sph.) associated with crackle brecciation.							
		65.0 - 135.0 Traces Py. (Sph.) associated with crackle brecciation.							
159.0	169.0	<u>DOLOSTONE</u>							
		159.0 - 169.0 Mudstone grainstone cycles.							
	169.0	<u>E.O.H.</u>							

Peter Boyle

SURVEY METHOD:		
DEPTH	DIP	ERG.

Texasgulf Inc.

DRILL HOLE LOG

HOLE No. 78	PAGE No. 1 of 1
----------------	--------------------

START: August 19, 1975

FINISH: August 21, 1975

CORE SIZE: AIX

LOG/DATE: Peter Boyle

LENGTH: 75'
DIP: -90°
ERG: -

LOCATION: 85366 N
56809 E
ELEVATION: 5940' EL.

PROPERTY / CLAIM: ROBB LAKE
Cleo 117 NE½

PURPOSE:

FOOTAGE		DESCRIPTION	ASSAY No.	ASSAYS FROM-TO/LENGTH	%	%	%	oz/T	oz/T
FROM	TO								
0.0	14.0	OVERBURDEN 23' Casing (removed)							
14.0	34.5	<u>DOLOSTONE</u> - Unit 'B' 14.0 - 134.5 Tight silty/sandy mudstone cycles.							
	34.5	<u>B/C CONTACT</u>							
34.5	75.0	<u>DOLOSTONE BRECCIA</u> - Unit 'C' 34.5 - 62.0 Brecciated amhipora gravel, angular fragments, white sparry dolomite matrix. 62.0 - 75.0 Brecciated homogeneous mudstone, white sparry dolomite matrix. Weak mineralization Ga. Sph. associated with rubble breccia at 50', 70' and 73'. Trace mineralization Ga. Sph. Py. associated with crackle breccia at 57' and 62'.							
75.0		<u>E.O.H.</u>							

Peter Boyle

SURVEY METHOD:			
DEPTH	DIP	BRG.	

Texasgulf Inc.
DRILL HOLE LOG

HOLE No.	PAGE No.
79	1 of 1

START: August 21, 1975

FINISH: August 27, 1975

CORE SIZE: AIX

LOG/ DATE: Peter Boyle

LENGTH: 93'
DIP: -90°
BRG: -

LOCATION: 75322 N
60376 E
ELEVATION: 5070' E1.

PROPERTY / CLAIM: ROBB LAKE
MV 23 NE¼

PURPOSE:

FOOTAGE		DESCRIPTION	ASSAY No.	ASSAYS FROM-TO/LENGTH	%	%	%	oz/T	oz/T
FROM	TO								
0.0	16.5	OVERBURDEN 31' Casing							
16.5	93.0	<u>DOLOSTONE</u> - Unit 'C' 16.5 - 93.0 Homogeneous/pelletal mudstone, occasional amphipora fragments and brachiopod fragments. Weak Sph. mineralization filling small vugs at 24' and 36'-42'. Weak Sph. mineralization associated with white sparry dolomite filling fractures at 88' and 92'.							
93.0		<u>E.O.H.</u>							

-31-

Peter Boyle

SURVEY METHOD:		
DEPTH	DIP	BRG.

Texasgulf Inc.

DRILL HOLE LOG

HOLE No.	PAGE No.
80A	1 of 1

START: August 27, 1975

FINISH: August 31, 1975

CORE SIZE AIX

LOG/DATE Peter Boyle

LENGTH: 96'
 DIP: +20°
 BRG: 130° AZ

LOCATION: 82097N
 55882E
 ELEVATION: 6750' EL.

PROPERTY / CLAIM: ROBB LAKE
 Cleo 8 Fr. W1/3

PURPOSE:

FOOTAGE		DESCRIPTION	ASSAY No.	ASSAYS FROM-TO/LENGTH	%	%	%	oz/T	oz/T
FROM	TO								
0.0	0.0	OVERBURDEN 3' Casing							
0.0	96.0	<u>DOLOSTONE BRECCIA - Unit 'C'</u>							
		0.0 - 96.0 Homogeneous/pelletal mudstone fragments with dark shaly matrix and locally white sparry dolomite matrix.							
		0.0 - 96.0 Very good mineralization Sph. Ga.							
	96.0	<u>E.O.H.</u>							

Peter Boyle

SURVEY METHOD:				
DEPTH	DIP	BRG.		

Texasgulf Inc.
DRILL HOLE LOG

HOLE No. 80B	PAGE No. 1 of 1
-----------------	--------------------

START: September 1, 1975

FINISH: September 1, 1975
CORE SIZE: AIX

LOG/DATE: Peter Boyle

LENGTH: 40'
DIP: -90°
BRG.: -

LOCATION: 82098 N
55878 E
ELEVATION: 7746' E1.

PROPERTY / CLAIM: ROBB LAKE
Cleo 8 Fr. W 1/3

PURPOSE:

FOOTAGE		DESCRIPTION	ASSAY No.	ASSAYS FROM -TO/LENGTH	%	%	%	oz/T	oz/T
FROM	TO								
0.0	0.0	OVERBURDEN 3' Casing							
0.0	38.5	<u>DOLOSTONE BRECCIA - Unit 'C'</u>							
		0.0 - 38.0 Pelletal/homogeneous mudstone cycles evident in breccia, large blocks - 2'-3' diameter, white sparry dolomite matrix predominates in matrix.							
		0.0 - 38.5 Fair to good mineralization Ga. Sph.							
	38.0	<u>E.O.H.</u>							

Peter Boyle

A - 5 SUMMARY OF CLAIMS ON WHICH DRILLING WAS DONE DURING THE 1975 FIELD SEASON

<u>DDH #</u>	<u>LENGTH</u>	<u>ORIENTATION</u>	<u>NORTHING</u>	<u>EASTING</u>	<u>ELEVATION</u>		<u>CLAIM</u>
67	228'	-90°	85833 N	57309 E	5833' e1	Surveyed	Cleo 132 SW ¼
68A	50'	-90°	84263 N	56689 E	6416' e1	Surveyed	MV 55 SE ¼
69	267'	-90°	85353 N	57097 E	5990' e1	Surveyed	Cleo 119 NW ¼
70	211'	-90°	86940 N	57190 E	5785'	Provisional	Cleo 129 SE ¼
71	176'	-90°	87070 N	57432 E	5775'	Provisional	Cleo 129 SE ¼
72	211'	015°az, -60°N	82200 N	48539 E	6972' e1	Surveyed	MV 5 NW ¼
73	190'	015°az, -60°N	82132 N	48586 E	6918' e1	Surveyed	MV 5 NW ¼
74	164'	-90°	82131 N	48586 E	6918' e1	Surveyed	MV 5 NW ¼
75	235'	-90°	89970 N	40720 E	6460'	Provisional	REX 14 SW ¼
76	185'	-90°	89611 N	40945 E	6390'	Provisional	REX 14 FR SE ¼
77	170'	-90°	89237 N	41190 E	6420'	Provisional	REX 13 FR NE ¼
68B	39'	-90°	84239 N	56610 E	6412' e1	Provisional	MV 55 SE ¼
68C	17'	-90°	84220 N	56560 E	6407' e1	Provisional	MV 55 SE ¼
78	75'	-90°	85366 N	56809 E	5940' e1	Provisional	Cleo 117 NE ¼
79	93'	-90°	75322 N	60376 E	5070' e1	Provisional	MV 23 NE ¼
80A	96'	130°az @+20° up	82097 N	55882 E	6750' e1	Provisional	Cleo 8 FR W 1/3
80B	40'	-90°	82098 N	55878 E	6746' e1	Provisional	Cleo 8 FR W 1/3

TOTAL 2,447'

Revised Sept. 1'75
Peter Boyle.

A - 6

DRILL HOLE COORDINATES 1975

<u>DDH #</u>	<u>LENGTH</u>	<u>ORIENTATION</u>	<u>NORTHING</u>	<u>EASTING</u>	<u>ELEVATION</u>	
33		-90 ^o	68982 N	58349 E	4999'	e1 Surveyed
53		-90 ^o	72933 N	58119 E	5063'	e1 Surveyed
54		-90 ^o	73139 N	57682 E	5206'	e1 Surveyed
55		-90 ^o	78894 N	56965 E	6801'	e1 Surveyed
56		-90 ^o	79645 N	50628 E	5896'	e1 Surveyed
57		-90 ^o	79294 N	50973 E	5875'	e1 Surveyed
58		-90 ^o	79945 N	50961 E	5813'	e1 Surveyed
59		-90 ^o	59825 N	56945 E	7082'	e1 Surveyed
60		-90 ^o	86598 N	57356 E	5768'	e1 Surveyed
61		-90 ^o	87391 N	57072 E	5809'	e1 Surveyed
62		-90 ^o	80651 N	53955 E	7133'	e1 Surveyed
63		-90 ^o	84988 N	56690 E	6034'	e1 Surveyed
64		-90 ^o	80494 N	55402 E	7478'	e1 Surveyed
65		-90 ^o	79630 N	50287 E	6057'	e1 Surveyed
66		-90 ^o	79283 N	50599 E	6022'	e1 Surveyed

A - 7 CORE STORAGE

All core, totalling 2,447 feet in 14 holes is stored in enclosed outdoor racks at the main camp along the upper reaches of the Halfway River.

Prepared by P. J. S. Boyle
P. J. S. Boyle

Supervised by R. G. Gifford
R. G. Gifford, P. Eng.

APPENDIX 1

CLAIM SCHEDULE - 440 CLAIMS, September, 1975

LOCATION: Robb Lake
56° 123° S.E. NTS 94B
LIARD MINING DISTRICT

CLAIM NAME & NO.

Bell 7-16 incl.
BM 1-6 incl., 8.
CLEO 1-28 incl., 31-33 incl., 41-43 incl.,
69-72 incl., 79, 81, 83, 85, 87,
89-96 incl., 98, 100, 105-108 incl.,
110, 112-117 incl., 119-148 incl., 151-176 incl.,
187-194 incl., 197-200 incl., 207-211 incl.,
221-236 incl.
CLEO Fr. 2, 8-11 incl., 16, 17.
FBW 6, 9-28 incl., 39-46 incl.
FG 1-4 incl., 25-34 incl.
FG Fr. 1
JOSH 8, 10, 12
KIM 9-12 incl.
KIM Fr. 5, 51, 52
MART 75, 77, 79, 81, 83, 85, 87
MV 3-6 incl., 23, 25-36 incl., 49-56 incl.,
60, 73-114 incl., 116-142 incl.
NMW 1-6 incl., 77-80 incl.
NORM 5-12 incl.
REX Fr. 1-7 incl., 12-17 incl., 20-22 incl., 29, 30.
ROB 1-48 incl., 50-52 incl., 63-67 incl., 69-72 incl.,
75-78 incl., 80-87 incl.
UNION Unit 1-16 incl.

APPENDIX - 2

STATEMENT OF QUALIFICATIONS

P. J. S. Boyle Obtained his B.Sc. degree in Geology from the University of Saskatchewan (Saskatoon) in 1972. Since that time he has been employed as a geologist by W. Meyer & Associates and Canadian Superior Exploration for six and eight months respectively. He joined the staff of Texasgulf in April, 1974.

F. T. Manns Obtained his B.A. in Geology in 1970 and M.A. in Geology in 1972 from Temple University, Philadelphia, Pa. He has been employed by Mobil Oil, Canadian Superior and Texasgulf as a geologist during the summer season. At present he is working towards his Ph.D. at the University of Toronto.

The above geologists are well qualified and experienced in the work assigned to them on this project which was undertaken under my general supervision.



R. G. Gifford, P. Eng.

1975 DRILLING DDH 67-80B

Department of
Mines and Petroleum Resources
ASSESSMENT REPORT
NO. 5705 MAP 2

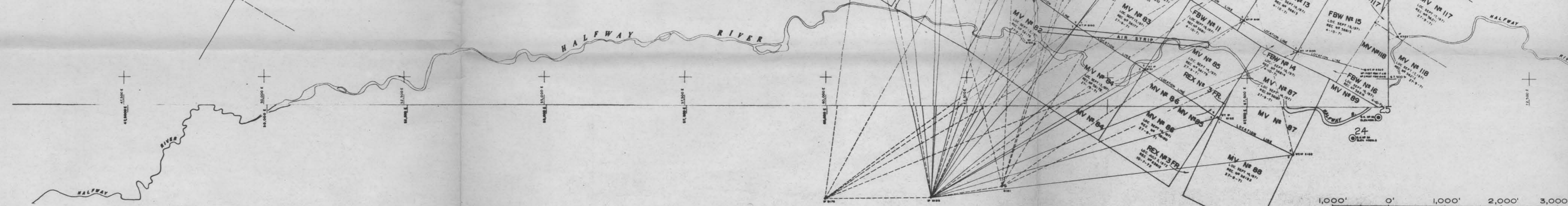

5705 M-2
ROBB LAKE JOINT VENTURE
CLAIM MAP SHOWING
DRILL HOLE LOCATIONS

TO ACCOMPANY DRILLING REPORT
ROBB LAKE 1975

2000 1000 0 2000 4000 6000

ROBB LAKE JOINT VENTURE

COMPOSITE PLAN OF MINERAL CLAIMS

WORK BY	DRAWN BY	DATE	DRWG NO.
J.M.M.		Sept. 1975	Fig. 3

TO ACCOMPANY DRILLING REPORT; ROBB LAKE 1975
R. J. H. H. H.

Department of
 Mines and Petroleum Resources
 ASSESSMENT REPORT
 NO. 5705 MAP 3

LEGEND

(15) GROUP NUMBER

GROUP BOUNDARY

EXPIRY DATES BY YEAR

1974	A	1978	E
1975	B	1979	F
1976	C	1980	G
1977	D	1981	H
		1982	
		1983	
		1984	
		1985 +	

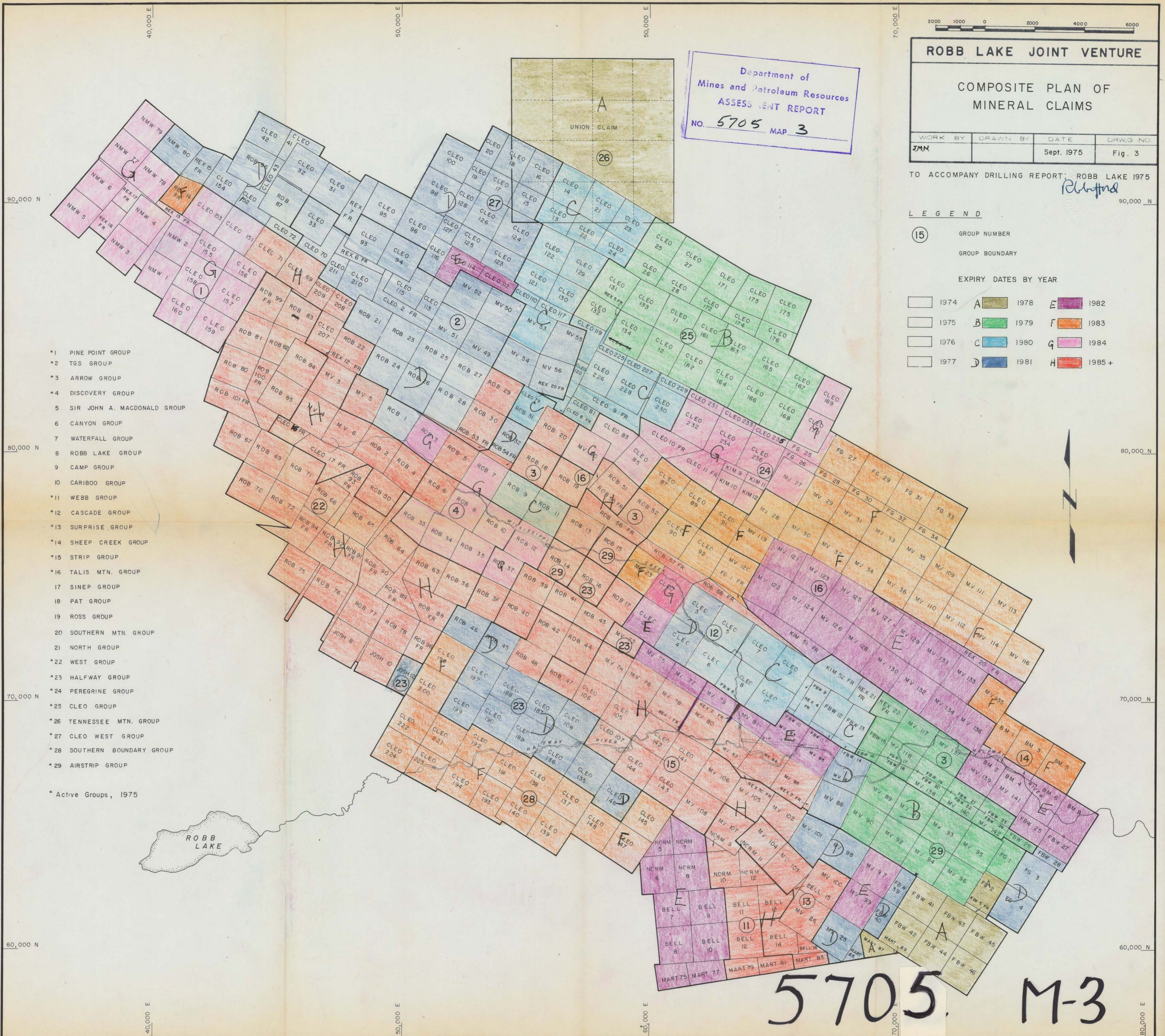

- *1 PINE POINT GROUP
- *2 TGS GROUP
- *3 ARROW GROUP
- *4 DISCOVERY GROUP
- 5 SIR JOHN A. MACDONALD GROUP
- 6 CANYON GROUP
- 7 WATERFALL GROUP
- 8 ROBB LAKE GROUP
- 9 CAMP GROUP
- 10 CARIBOO GROUP
- *11 WEBB GROUP
- *12 CASCADE GROUP
- *13 SURPRISE GROUP
- *14 SHEEP CREEK GROUP
- *15 STRIP GROUP
- *16 TALIS MTN. GROUP
- 17 SINEP GROUP
- 18 PAT GROUP
- 19 ROSS GROUP
- 20 SOUTHERN MTN. GROUP
- 21 NORTH GROUP
- *22 WEST GROUP
- *23 HALFWAY GROUP
- *24 PEREGRINE GROUP
- *25 CLEO GROUP
- *26 TENNESSEE MTN. GROUP
- *27 CLEO WEST GROUP
- *28 SOUTHERN BOUNDARY GROUP
- *29 AIRSTRIP GROUP
- * Active Groups, 1975

5705 M-3