

5886

MINING RECORDER
RECEIVED
JUN 22 1976

APPENDIX TO 1975 WORK ORDER
#1816, 1817, 1818, 1819
Recorded in Penticton, B.C.
Osoyoos Mining Division
on November 12, 1975

N.R. #..... \$
OSOYOOS MINING DIVISION

AU - RAIN CLAIM GROUP
Record No.: 30254/9, 30284/5, 31312/3

6-1/4 miles East-South-East of Okanagan Falls, B.C.
Lat. 49° 18' N., Long. 119° ~~26'~~ ^{18'} W. (82 E/6 W)

By Owners

Mr. K.G. Ewers, FMC 93421 issued at
Penticton, B.C. January 20, 1976

Mr. R.W. McLean, FMC 121674 issued at
Oliver, B.C. January 19, 1976

Mr. K.G. Thompson, FMC 148447 issued at
Rossland, B.C. January 9, 1976

Address for all correspondence:

Messrs. Ewers, McLean & Thompson
P.O. Box 106, Hody Drive
Okanagan Falls, B.C. VOH 1R0

Work period: November 3, 1975 to June 3, 1976

Prepared by: K.G. Thompson - June 21, 1976
Phone: K.G. Thompson - 497-5594
or
K.G. Ewers - 497-5220

K.G. Thompson

June 21, 1976

* * *

E. & O.E.

Department of
Mines and Petroleum Resources
ASSESSMENT REPORT
NO. **5886** MAP

AU - RAIN CLAIM GROUP
1976

TABLE OF CONTENTS

As filed on November 12, 1975 within 1975 Work Orders #1816, 1817, 1818, and 1819.

Location and Access
Property and Ownership
Method of Travel
General Geology
Summary of Work Done (to November 2, 1975)
Qualifications of Prospectors
Prospecting Report
Assay Report
Application of Work

Enclosed herewith:

Summary and application of work Page 1
Details of work done Page 2 & 3
Assay Sketch Map Page 4
Twig Sample Assays & Sketch Page 5 to 8
Report of Granby Mining Corp. After Page 8

List of Illustrations

#1 Assay Sketch Map Page 4
#2 Twig Sample Assay Sketch Page 8
#3 Location & Claim map
#4 Sample location & Assay Results
#5 Sample & Geology Detail, A & B
#6 Sample & Geology Detail, C & D
#7 Sample & Geology Detail, E & F
#8 Sample & Geology Detail, G

SUMMARY & APPLICATION OF WORK

Cost and/or value of work per "Affidavit on Application to record work".

A. Physical -	\$ 207.87
C. Prospecting -	1,043.50
D. Geological -	<u>250.00</u>
	1,501.37
<u>Add:</u> Carry forward balance as per Page 6 of November 12, 1975 Work Order No. 1816 to 1819	<u>1,009.52</u>
	2,510.89

<u>Deduct:</u> Amount disallowed per letter of January 28, 1976 from Penticton Mining Recorder re Prospecting to June 27, 1975 being Page 4 of Work Order No.1816 to 1819 4 Man Days at \$35.00 = \$140.00 Est. Cost of 1975 Report = <u>30.00</u>	<u>170.00</u>
	2,440.89

<u>Add:</u> Actual Cost of 1975 Report	53.35
Estimated Cost of 1976 Report	<u>40.00</u>
	\$ <u>2,534.24</u>

I wish to apply this work to the Claims listed below:

<u>Claim</u>	<u>Rec.No.</u>	<u>Date</u>	<u>Expire</u>	<u>Work Applied</u>	<u>Amount</u>
Au 1	30256	June 28, 1973	1977	1 Yr.	200.00
Au 2	30257	" " "	1977	1 "	200.00
Au 3	30258	" " "	1976	2 Yrs.	400.00
Au 4	30259	" " "	1977	1 Yr.	200.00
Au 5	30284	June 29, 1973	1977	1 "	200.00
Au 6	30285	" " "	1977	1 "	200.00
Rain 1	30254	June 27, 1973	1976	2 Yrs.	400.00
Rain 2	30255	" " "	1976	2 "	400.00
					<u>\$2,200.00</u>

DETAILS OF WORK DONEA Physical - Per Map Area "G", Page 4

November 22, 1975 - Trench in Rock

15 feet long x 3' deep x 3-1/2' wide =	
Volume 157 cu. ft. @ 65¢ =	\$ 102.05
Travel - 52 miles @ 25¢ =	13.00
Dynamite and Caps =	16.00
Drill rental - Atlas Copco Cobra =	20.00

May 6, 1976 - Trench in Dirt

20 feet long x 2' deep x 2-1.2' wide =	
Volume 90 cu. ft. @ 17¢ =	15.30
18 feet long x 1' deep x 2' wide =	
Volume 36 cu. ft. @ 17¢ =	6.12
Travel - 52 miles @ 25¢ =	13.00
Dynamite and Caps =	6.40
Pump rental =	<u>16.00</u>
	\$ 207.87

C. Prospecting Report - Qualifications as per Pages '3' to '5 of 1975 Work Order #1816, 1817, 1818 and 1819.

Assay Costs - Per Assay Map Figure 1, Page 4

By Cash by Owners:	1 @ \$7.50	\$ 7.50 ✓
	5 @ 8.50	42.50 ✓
	1 @ 49.50	49.50 ✓
By Granby Mining Corporation		
Per Plate 2 of Granby Report -		
26 samples @ \$7.50 value =		195.00 ✓
By Canex Placer Limited (Per letter)		
(NOTE: Results have not been received as of		
xxxx date of this report, but will be		
forwarded to you upon receipt)		
30 samples @ \$8.50 value =		255.00 X
Collection of twig samples - 8 man days		
plus 3 man days to burn ash =		
11 man days @ \$35.00 value =		385.00 ✓
Travel - 3 days @ 52 miles @ 25¢ =		39.00 ✓
Prospecting done by Owners Ewers and Thompson		
on May 4, 1976 - allocated on basis of \$5.00 per		
hour for 7 hours = \$35.00 x 2 man days =		<u>70.00</u>
		<u>\$1,043.50</u>

D. Geological Report

As prepared by Mr. Hun Kim, Chief Geologist,
Granridge Coal Project of The Granby Mining
Company Limited, Vancouver, B.C. -

Fair Market value of Report

One Geologist (H. Kim) 1 day =	\$ 100.00
One Assistant (G. Hingley) 1 day =	50.00
Travel from Grand Forks =	50.00
Report preparation =	<u>50.00</u>
	\$ 250.00

ASSAY MAP

FIGURE 1

GENERAL TESTING LABORATORIES	Sample #	Lab I.D. #	Au	Ag
	1	0626M	0.010	TR
	2	529	0.524	0.76
	3	530	0.244	0.30
	4	531	0.014	0.50
	5	532	0.064	0.33
	6	533	0.098	0.25
COMINCO	7	AL-536	0.004	-

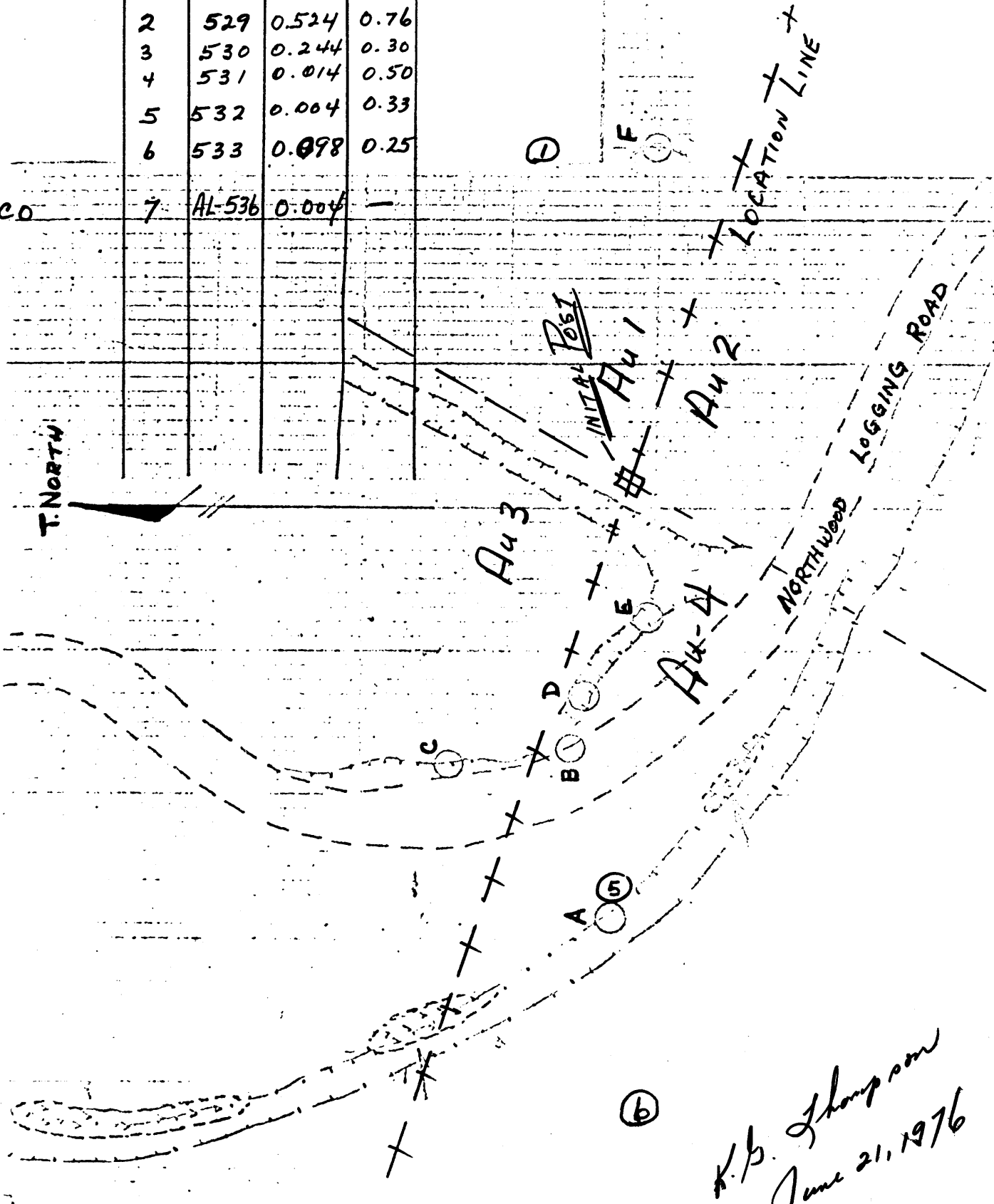

K.B. Thompson
June 21, 1976

Mr. K.G. Thompson
P.O. Box 22, Skaha Lake Rd.
Okanagan Falls, B.C. VOH 1R0
June 3, 1976

Mr. A.D. Drummond
Ass't. Exploration Manager
Canex Placer Limited
700 - 1030 W. Georgia St.
Vancouver, B.C. V6E 3A8

Dear Darryl:

Re: Au - Rain Claim Group
Lot 49° 18' N, Long. 119° 26' W. (82 E/6)
(Fish Creek Property - Osoyoos M.D.)

As per our discussions during your trip to the above property in May, I have forwarded today by double registered mail the thirty (30) twig samples in ash form. The following notes are applicable to these samples:

1. Samples #1 to #11 were taken on May 29, 1976 under and with the assistance of Doctor Harry Warren.
2. Samples #12 to #30 were taken on May 31, and June 1, 1976 by the property owners, Mr. K.G. (Dusty) Ewers, Mr. R.W. McLean and Mr. K.G. Thompson.
3. Where feasible the sample locations are marked
 - a) Blaze on tree and marked by felt pen i.e. Doc. #18
 - b) A strip of yellow spray paint across tree
 - c) Yellow flagging tape marked with ball-point pen, i.e. Doc. #18
4. Where necessary location lines between sample stations are marked with blue flagging tape.
5. Abbreviations used: F/C = Fish Creek
B.H.D. = Breast Height Diameter of tree
J.P. = Jack Pine (Lodge Pole Pine)
6. Sample #10 taken three (3) road miles from property over sandstone rock outcrop
7. A Grid Line was not used as the fir trees do not always grow where one would like them to.
8. We experienced some difficulty with some samples in burning down to the "white fluffy powdered ash" which Doctor Warren requested and therefore possibly all the samples should be checked to ensure that the required degree of burning and the required type of ash was obtained.

ASSESSMENT REPORT

... 2

ON

Mr. A.D. Drummond
Ass't. Exploration Mgr. Canex Placer Ltd. page 2. June 3/76

- 9. Fir samples taken represent three (3) years growth while Jack Pine and Juniper samples represent four (4) years growth.

We look forward to obtaining your opinion of the results of this experiment and again, thank you for your assistance.

Yours very truly



K. G. Thompson

KGT/mb
Attached: Detailed List
of 30 Samples

LIST OF TREE TWIG SAMPLES
from Au - Rain Group of Claims - Osoyoos M.D. (82 E/6)

Sample No.	Map Location	Sample Location (approximately)	Type of Ash	B.H.D.
1	A	15 ft West of Point A	Fir	1 of 12"
2	A	Above Point A	J.P.	2 of 3"
3	G	10 ft N.N.W. of Point G	Juniper	-
4	G	300 ft S.S.E. of " "	Fir	2 of 5"
5	G	300 ft East of " "	Fir	3 of 4"
6	F	8 ft West, South end of Trench	Juniper	-
7	F	50 ft N.W. of N. end of "	Fir	3 of 3"
8	D	15 ft N.N.E. of Point D	Fir	2 of 8"
9	C	50 ft East of Point C	Juniper	-
10		3 road miles West @ Mi.14	J.P.	2 of 3"
11		4 " " West @ Mi.13	J.P.	2 of 2"
12	A	100 ft West of Point A	J.P.	3 of 3"
13	A	200 ft W.N.W. of Point A	Fir	1 of 10"
14	A	200 ft West of Point A	Fir	1 of 11"
15	A	200 ft S.S.W. of Point A	Fir	1 of 9"
16	G	150 ft N. of road	Fir	1 of 12"
17	G	100 ft N. of #16, 100 ft S.E. #4	Fir	1 of 11"
18	G	100 ft N. of #17, 100 ft N.E. #4	Fir	1 of 13"
19	G	100 ft N.N.W. #5	Fir	1 of 12"
20	G	100 ft N. of #19	Fir	1 of 13"
21	A	375 ft W. of Point A; 175 ft W. of #14	Fir	1 of 12"
22	A	75 ft N.N.W. of #21	Fir	1 of 7"
23	A	125 ft N.N.W. of #22	Fir	1 of 10"
24	G	400 ft E. of Point G; 75 ft E. of #18	Fir	1 of 5"
25	G	100 ft S. of #24	Fir	1 of 2"
26	G	300 ft N.N.W. of Point G	Fir	1 of 6"
27	F	200 ft N.N.W. of Point F 150 ft E. of N. end of Bull Dozer Trench	Fir	1 of 4"
28	F	30 ft West of N. end of Bull Dozer Trench:	Fir	1 of 8"
29	F	200 ft S.S.W. of Point F	Fir	1 of 6"
30	F	250 ft S.S.W. of Point F	Fir	1 of 12"
				1 of 16"

NOTE: Reference points A to G as per attached sketch plan map of Au - Rain Group of Claims

June 3, 1976

Au-Rain Claim Group
Osoyoos M.D. 82 E/6
Approximate Sample Locations

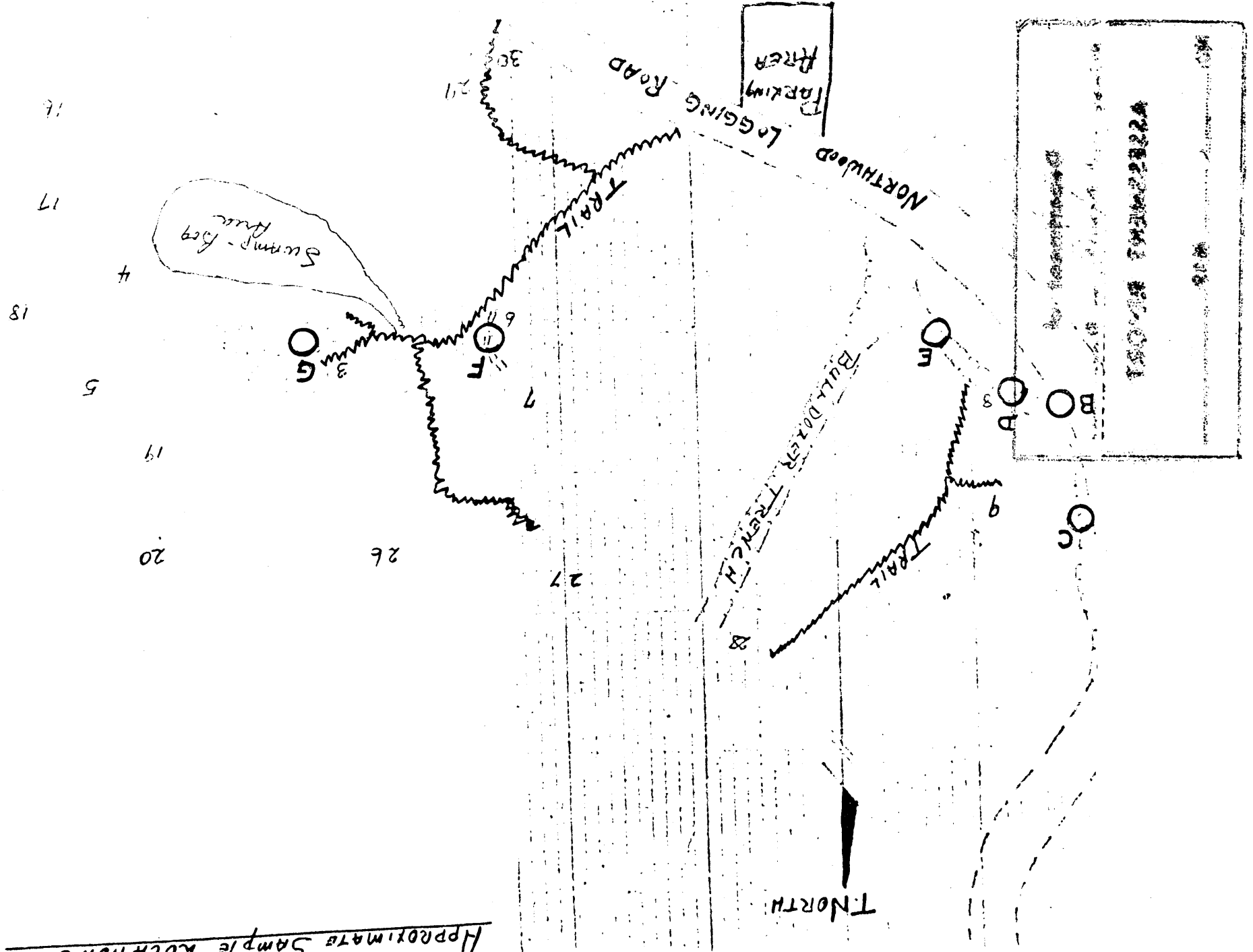

Mr. H. G. Ewers

c/o G. W. Hingley

REPORT OF INVESTIGATION

Au- RAIN CLAIM GROUP

6 Miles SE of Okanagan Falls, B.C.
Lat. $49^{\circ} 18'N$, Long. $119^{\circ} 26'W$ (82E/6).

H. Kim
Granby Mining Corporation

November 18, 1975

Vancouver, B.C.

Department of
Mines and Petroleum Resources
TECHNICAL REPORT
NO. 1000

Au-Rain CLAIM GROUP

OSOYOOS M. D. 82 E/6

APPROXIMATE SAMPLE LOCATIONS

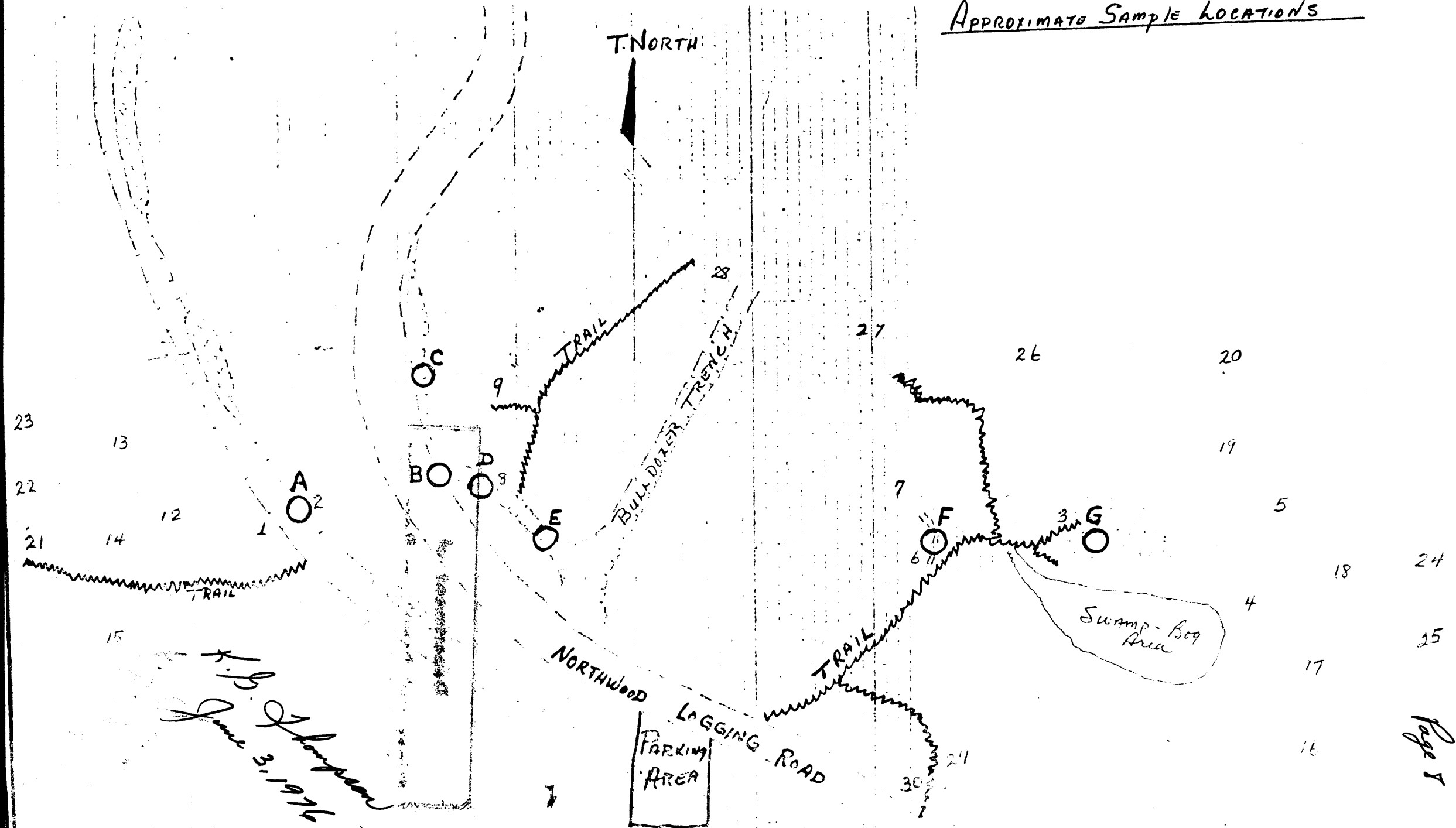

TABLE OF CONTENTS

	<u>Page</u>
GENERAL	1
OBSERVATIONS	1
GEOLOGY	3
CLAIM, LOCATION AND ACCESSIBILITY	3

LIST OF ILLUSTRATIONS

- #3 PLATE I Location and Claim Map
- #4 PLATE II Sample Location & Assay Results,
 Au-Rain Claim Group
- #5 PLATE III Sample & Geology Detail,
 Trenches A & B
- #6 PLATE IV Sample & Geology Detail,
 Trenches C & D
- #7 PLATE V Sample & Geology Detail,
 Trenches E & F
- #8 PLATE VI Sample & Geology Detail,
 Trench F

APPENDIX

1. Geochemical Report on the Au-Rain Group
 R. S. Verzosa, P. Eng., Teck Corporation Ltd., 1974
2. Geochemical and Geophysical Report on the Au-Rain Claim Group,
 R. S. Verzosa, P. Eng., Teck Corporation Ltd., 1973

GENERAL

This property was examined on November 2, 1975 in response to an October 29, 1975 request from co-owner Mr. K. G. (Dusty) Ewers through Mr. G. W. Hingley, Mill Superintendent of Phoenix Copper Division. This examination was requested by Mr. G. B. Hardwicke, Phoenix Mine Manager, on October 31, 1975.

The three co-owners, as listed below, and Mr. Hingley were present during this investigation:

Mr. K. G. Ewers, Box 106, Okanagan Falls, B.C. 497-5220

Mr. R. W. McLean, Okanagan Falls, B.C.

Mr. K. G. Thompson, Okanagan Falls, B.C. 492-7121 (Office)
497-5594 (Residence)

Previous reports on this property known to date are:

1. B.C.D.M. Geology, Exploration and Mining in B.C., 1973
"Au (82E/SW-112)" Page 47
2. R. S. Verzosa, Teck Corporation Ltd.: December 10, 1973
"Geochemical and Geophysical Report on the Au-Rain Claim Group"
3. R. S. Verzosa, Teck Corporation Ltd.: June 24, 1974
"Geochemical Report on the Au-Rain Claim Group"

OBSERVATIONS

1. At the date of investigation, most of the property area and access road were covered with snow (plus 10 inches) and deep overburden. These factors hindered surface examination. The geological investigation and sampling done were limited to five bulldozer trenches and one hand trench, most of which were also obscured by snow. The moil used for channel sampling was inefficient in breaking the silicified volcanics on the trench floors. Therefore representative sampling might not have been achieved due to possible differences in width or depth of the channel for one unit channel sample. Consequently, little information was gathered as to the potential of the property.
2. As is shown in Plates II-VI, a total of 26 channel samples were obtained from 7 separate locations. The sample cut width varied with location, depending on the geological conditions in place.

The trenches from "A" through "F" were all on the rusty and shear zones containing patches and bands of silicified material with calcite veins. These areas were known to be main showings on the property. Samples from these rusty showings returned values ranging from 0.005 oz/ton to 0.1525 oz/ton in gold and trace to 0.261 oz/ton in silver.

In contrast to the above showings, two 5-ft-cut samples, which were taken from the fresh looking andesitic rock at location "G" show appreciable values in gold and silver. These values range from 0.294 to 0.400 oz/ton Au and 0.847 to 1.186 oz/ton Ag, respectively. No recognizable gossan or quartz was noted at this location but a 6-inch calcite vein cuts the fresh andesite porphyry.

The auriferous mineralization defined in this investigation appears related to obscure outcrops with little quartz or recognizable gossan. Because of this, the gold mineralization is difficult to find and trace by surface mapping.

3. According to the 1974 Teck Corporation Ltd. report, page 1, rock samples taken from the main showing in 1973 returned values ranging from nil to 0.10 oz/ton in gold and 0.02 oz/ton to 0.90 oz/ton in silver. This main showing apparently corresponds to trench "A" or "C", hence it may be said that the average assay values of the previous sampling are in about the same general magnitude as from "A" or "C" channel sampling.
4. Teck's 1974 geochemical report concluded that "the gold, silver and mercury anomalies appear related to a nearby gold and silver mineralization of very limited aerial extension".

Relationship of the geochemical survey results to our sampling data is tabulated below.

Location		Geochem Anomalies			Assay Results		Remarks
Trench	Line Grid	Gold (ppb)	Silver (ppm)	Mercury (ppm)	Gold (oz/ton)	Silver (oz/ton)	
A	4+00E 0+50S	70	0.7	27-31	0.1525	0.228	Total cut 3'
	4+00E 4+00S	130	0.5	67	N/A	N/A	No Exposure
B	N/A	40?	0.7?	45?	0.0495	0.110	1. No soil sample on spot 2. Total cut 6'
C	6+00E 1+00N	80	1.8	25-31	0.0095 0.0980	0.026 0.258	Total cut 15'
D	5+50E 0+50S	30	0.8	48	0.005 0.118	0.032 0.261	Total cut 13'
E	5+80E 1+00S	30	0.8	48	0.001	Trace	Total cut 1'
F	9+00E 2+00S	30?	0.8?	40?	0.001 0.105	0.033 0.579	1. No soil sample on spot 2. Total cut 48'
G	10+00E 2+50S	500	3.5	60	0.294 0.400	0.847 1.186	Total cut 10'

5. Magnetometer (Scintrex MF-2) and VLF-EM survey conducted by Teck in 1973 failed reportedly to detect any magnetic intensity and significant structure that could be related to the known mineralization.

GEOLOGY

Regional geology for the property area is shown on the G.S.C. Map 15-1961 at a scale of one inch to four miles. According to this, the property is underlain by Tertiary (Eocene or Oligocene) volcanics and Tertiary (Paleocene or Eocene) sediments.

The area in general appears to be drift-covered and observable exposures on the property are apparently confined to those which are shown on Plate II. These exposures are all basically Tertiary volcanics of andesitic composition. Silicification, rusty weathering and calcite veining are predominantly associated with the volcanics in trenches A-F but the resultant sampling data showed feeble gold and silver mineralization.

One sample from the fresh-andesite looking rock returned values of 0.400 oz/ton in gold and 0.847 oz/ton in silver.

No sulphide minerals are evident in most of the exposures, but rare fine-grained pyritic metal was noted at one place on the Northwood logging roadcut, trench C.

CLAIM, LOCATION AND ACCESSIBILITY

The property consists of a total of 8 contiguous claims which were staked in June, 1973 by K. G. Ewer, in partnership with K. G. Thompson and R. W. McLean, all of Okanagan Falls, B.C. (Plate I). The claims are in good standing until June 1976.

The main showing and trenches are located at Latitude 49° 18' and Longitude 119° 17' within Osoyoos Mining Division, sheet 82E/6W. It is reported to be accessible from the town of Okanagan Falls, B.C. through ten miles of a well-maintained gravel road serviced by Northwood Pulp Mill and Noranda logging companies. However, this route was blockaded near Okanagan Falls by the logging company at the date of examination. Therefore, this trip took a roundabout route with a total road distance of about 26 miles from the town of Okanagan Falls.

CONCLUSIONS

On the basis of assay results, appreciable gold and silver mineralization occurs erratically in limited aerial extent, location of which is indicated on this report. It might merit additional detailed sampling and some exploration, but its potential is considered not enough for Granby at this time.

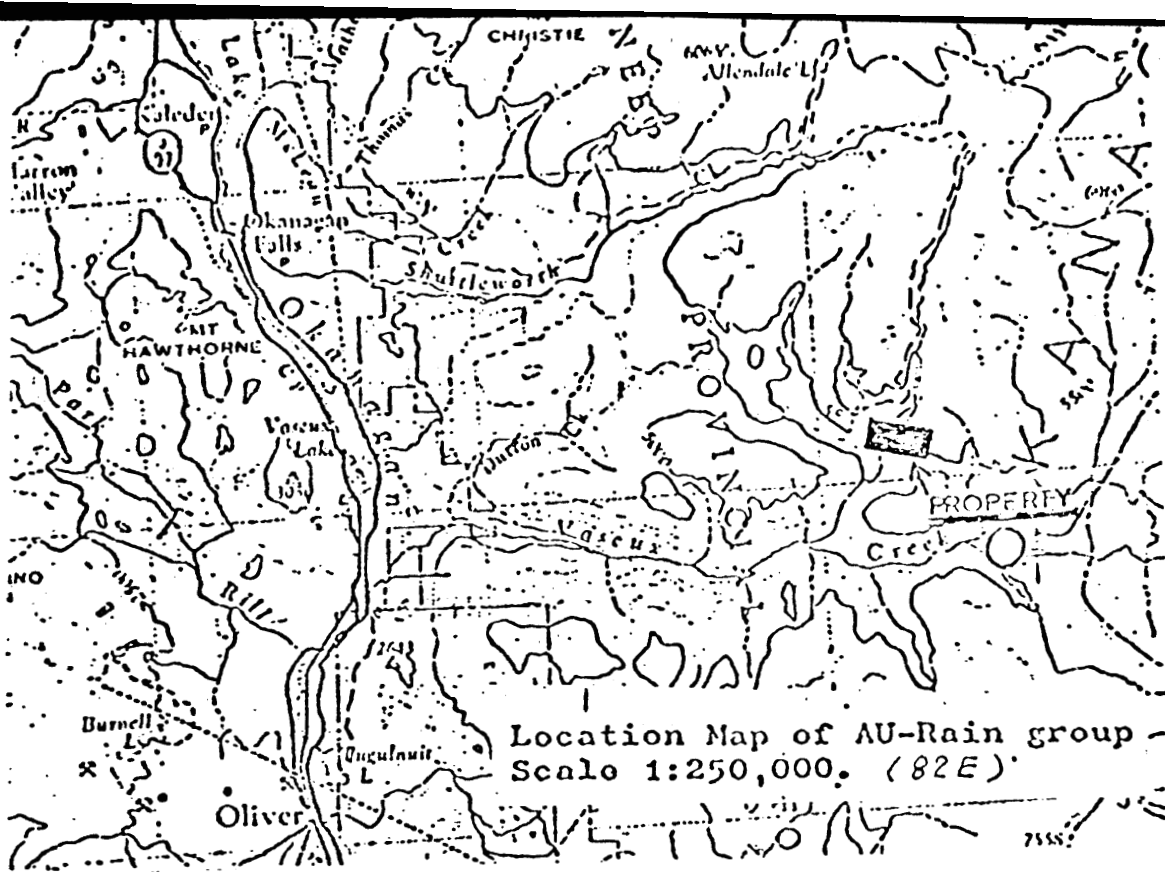

Location Map of AU-Rain group -
Scale 1:250,000. (82E)

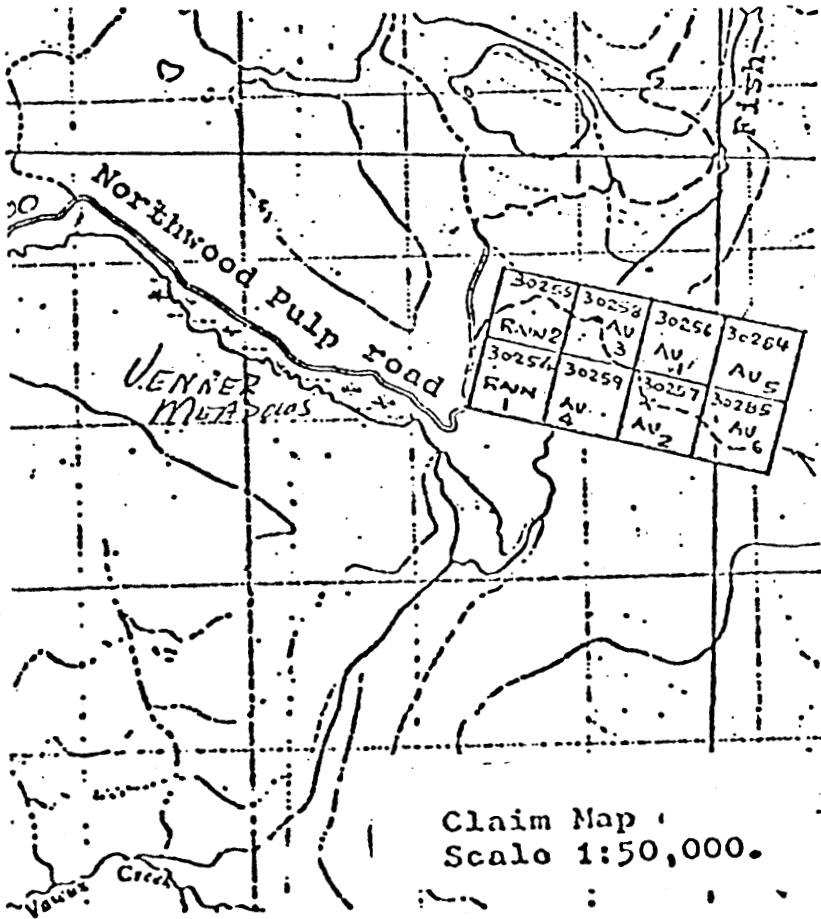

Claim Map
Scale 1:50,000.

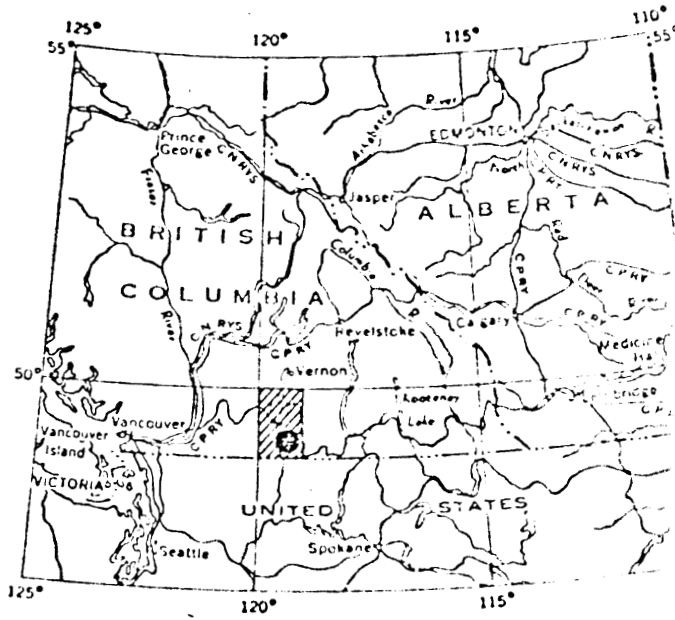

INDEX MAP

PLATE I

LOCATION AND CLAIM MAP

AU-RAIN CLAIM GROUP

(Traced from Map 15-1961, Kettle 11
British Columbia sheet 82E (West Strip).
Claim Map, 1:50,000 furnished from claim
owners)

G. M. C.
Nov. 17, 1978

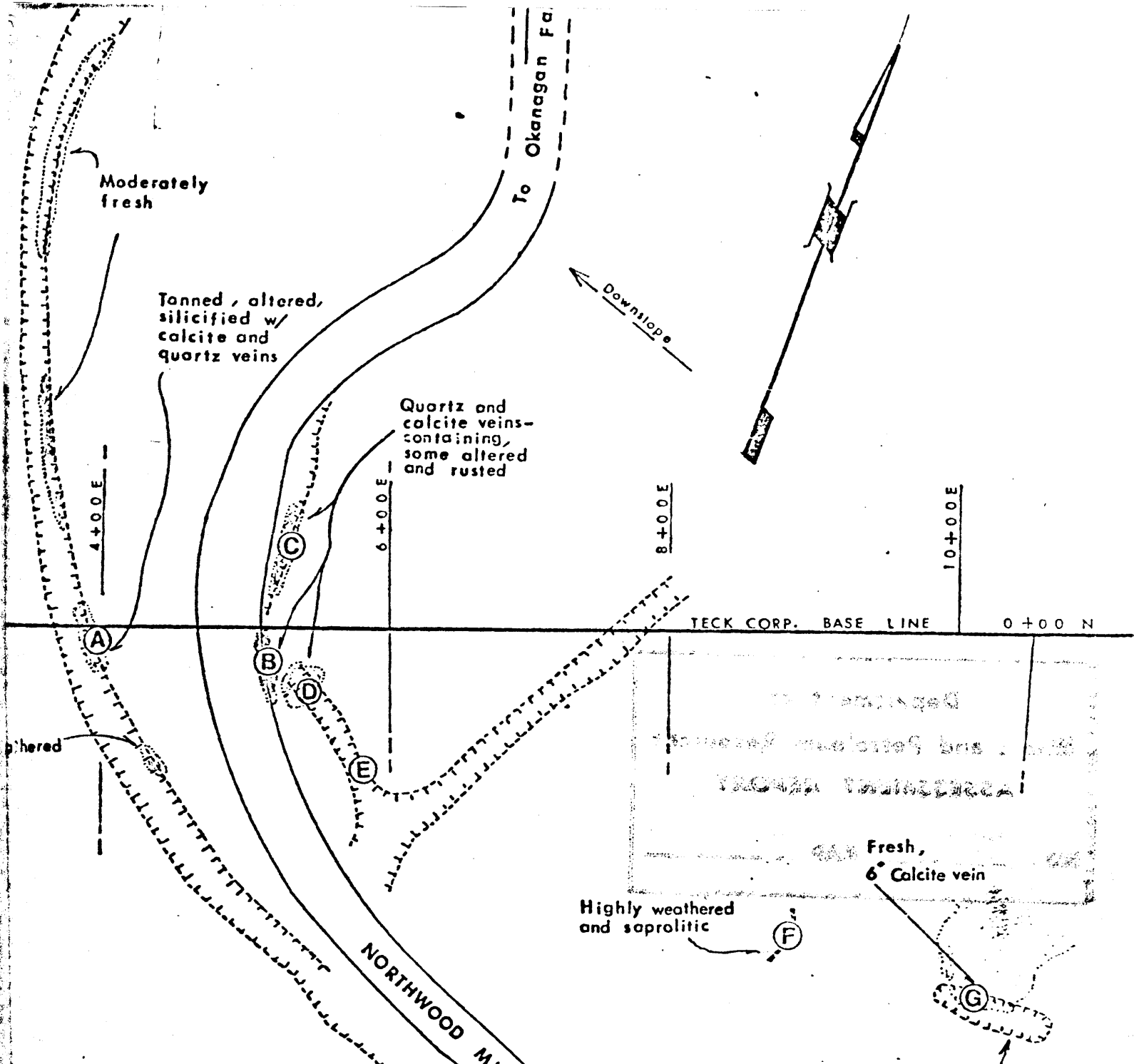

TECK CORP. BASE LINE 0+00 N

NORTHWOOD MILL/NORANDA LOGGING ROAD

ASSAY RESULTS
(By PHOENIX COPPER DIV.)

LOCATION	SAMPLE No.	CUT WIDTH (Ft)	Au Oz/100	Ag Oz/100	REMARKS
A	4960	3	.1525	.228	See: PLATE III
B	4961	6	.0495	.110	
C	4962	2	.0095	.026	See: PLATE IV
	4963	6	.095	.184	
	4964	7	.098	.258	
D	4965	2	.025	.150	See: PLATE V
	4966	2	.118	.203	
	4967	2	.142	.261	
	4968	2	.005	.032	
	4969	2	.008	.065	
E	4970	3	.0155	.080	See: PLATE VI
	4971	1	.001	Tr.	
	4972	14	.001	.033	
	4973	5	.021	.579	
	4974	5	.0025	.038	
	4975	5	.005	.038	
	4976	5	.007	.065	
G	4977	4	.0105	.0565	See: PLATE VI
	4978	5	.001	.025	
	4979	5	Tr.	.027	
	4980	5	Tr.	.013	
	4981	5	Tr.	.035	
	4982	5	.400	.847	
	4983	5	.294	1.186	
	4984	6	.0035	Tr.	
	4985	5	.1743	.534	

LEGEND

- TTTTT Trench
- Sample Location
- Rock Exposure, Mainly Andesite Fresh &/or Silicified and Altered with Quartz and Calcite Veins

* **NOTE**
Sample location is approximate.



PLATE II

SAMPLE LOCATION & ASSAY RESULTS
AU - RAIN CLAIM GROUP

6 Miles SE of Okanagan Falls, B.C.
(CONSTRUCTED FROM GEOCHEMICAL SURVEY MAP BY R.S. VERZOSA, TECK CORPORATION, 1974)

SCALE 1" = 100' November 12, 1975

GRANBY MINING CORPORATION

LOCATION "A"

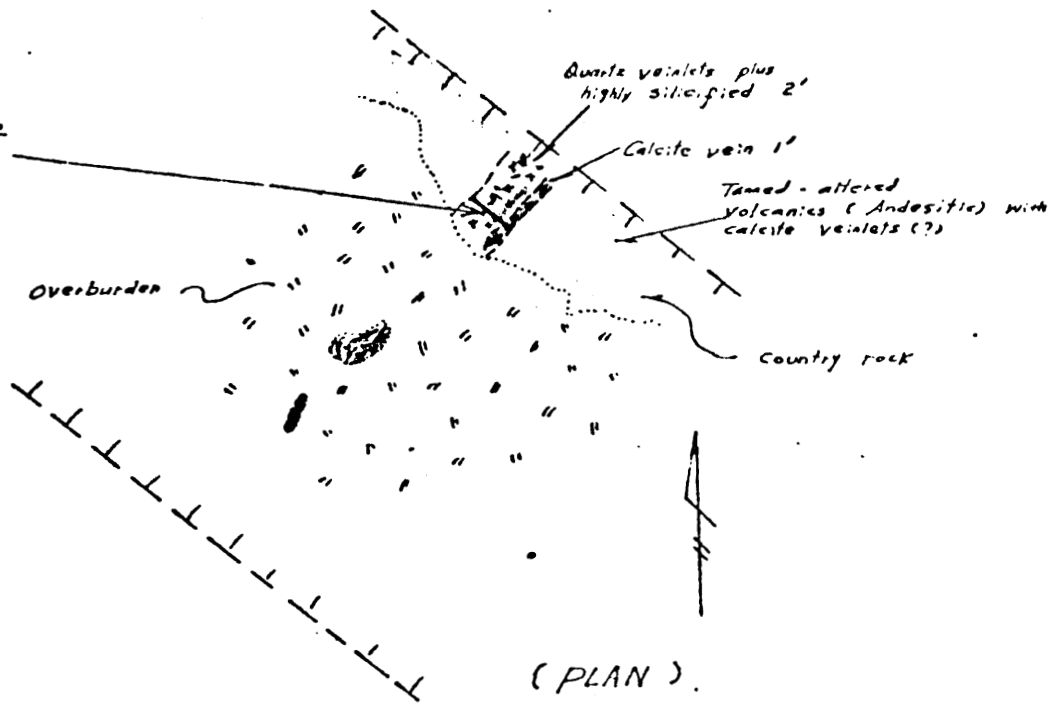

LOCATION "B"

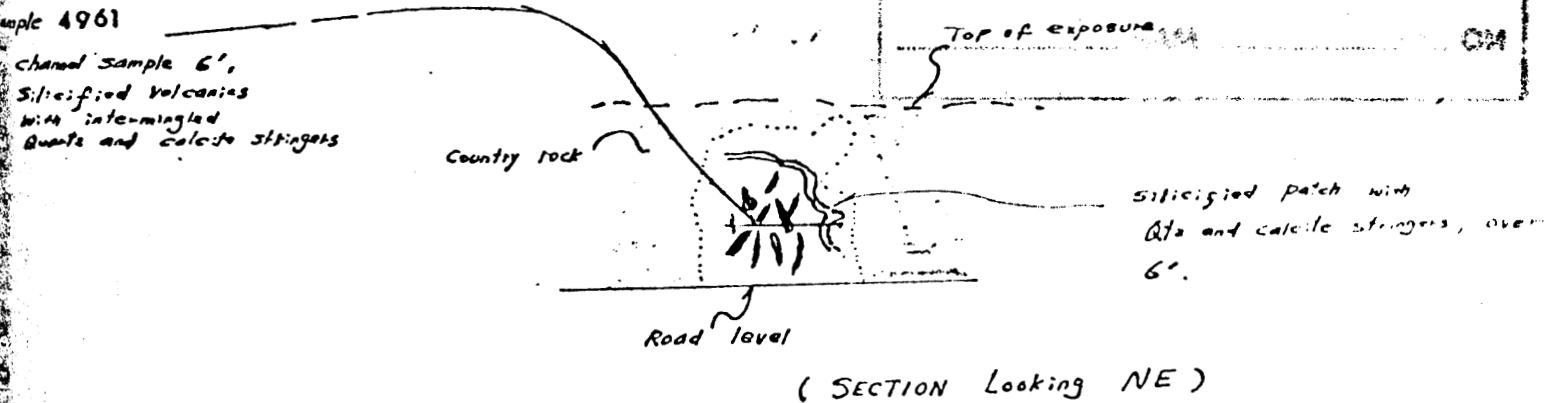

PLATE III
SAMPLE AND GEOLOGY DETAIL

A & B

SCALE 1" = 10'

November 12, 1975

LOCATION "C"

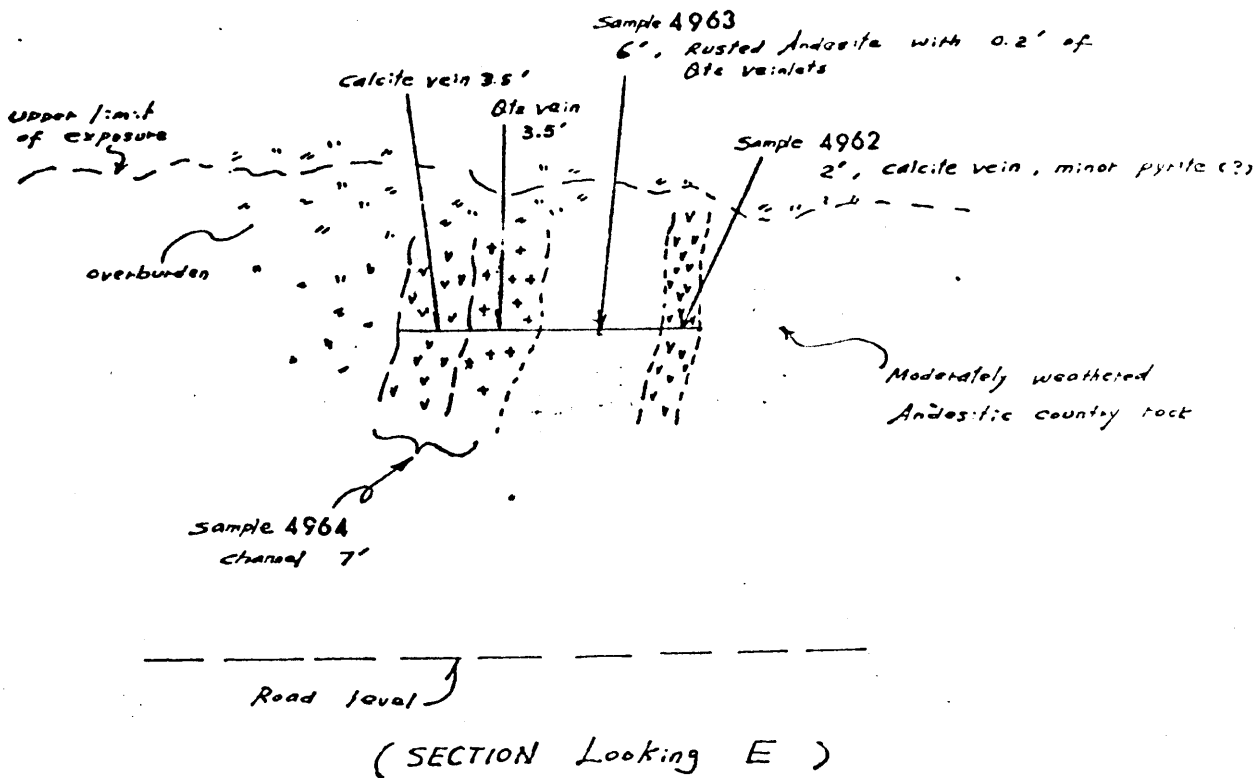

LOCATION "D"

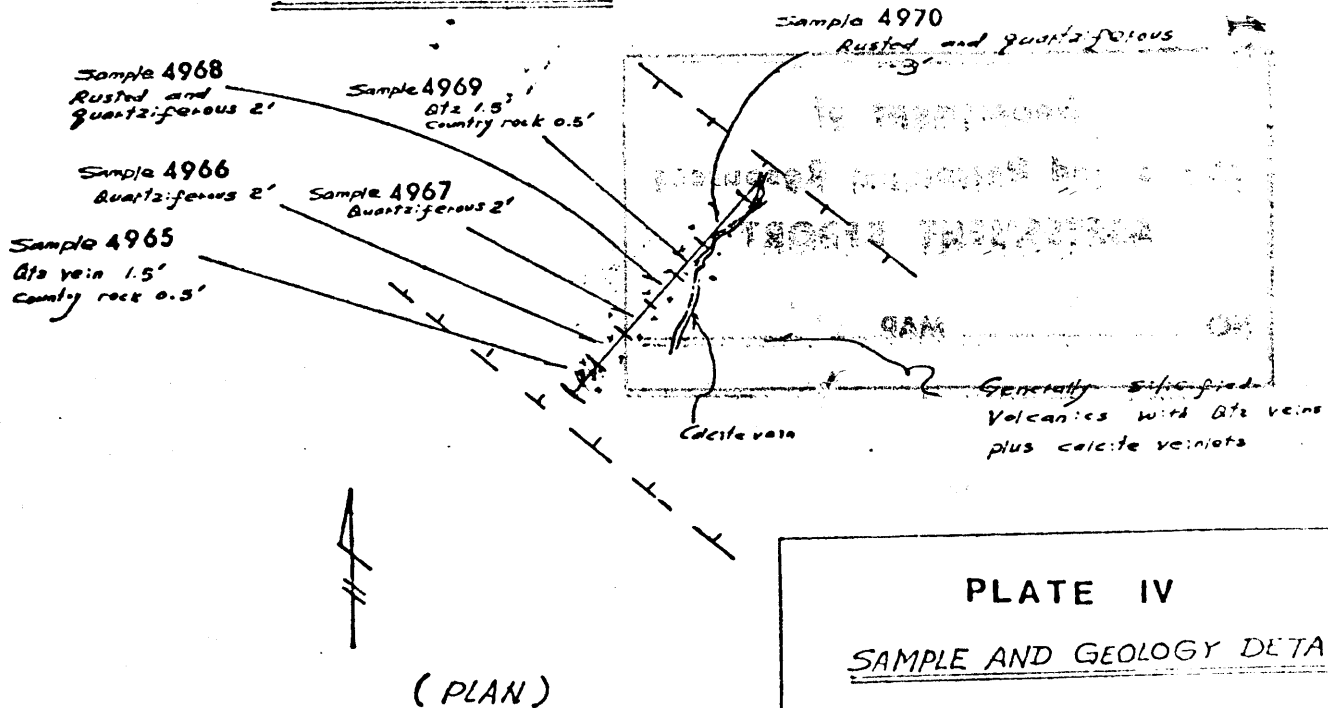

PLATE IV

SAMPLE AND GEOLOGY DETAILS

C & D

SCALE 1" = 10'

November 12, 1975

LOCATION "E"

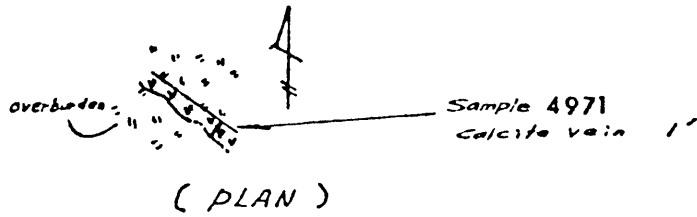

LOCATION "F"

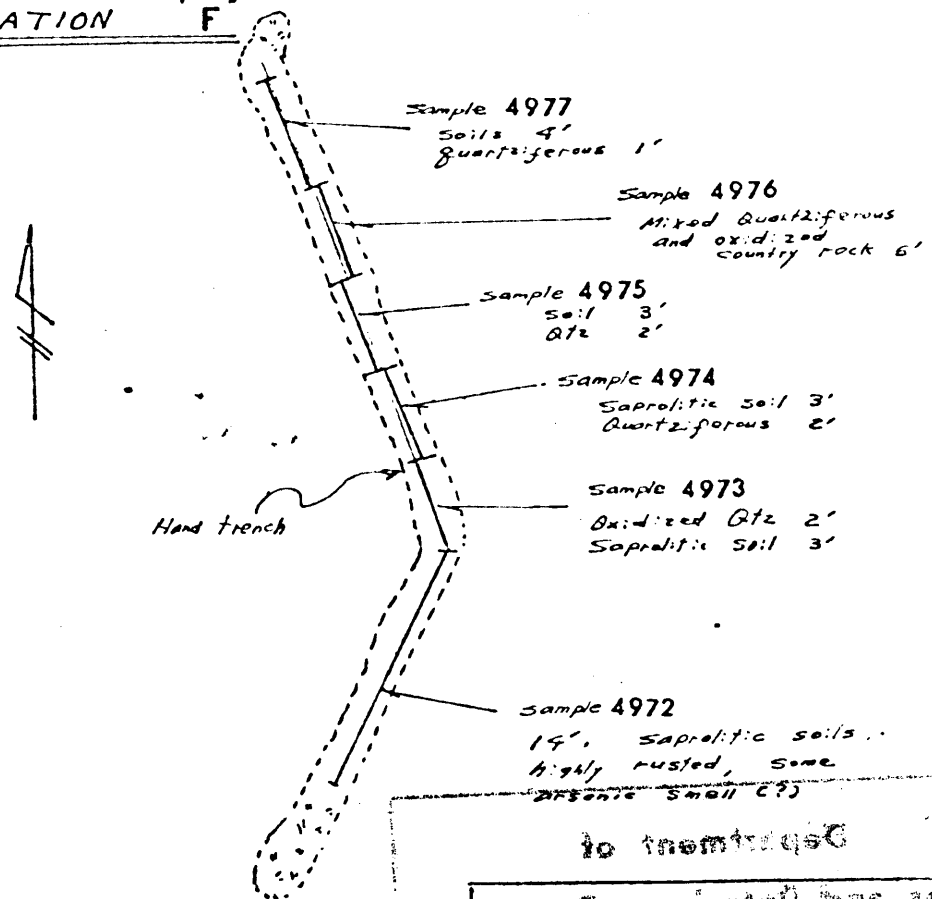

Department of
Mines and Petroleum Resources
PLATE V
ASSESSMENT REPORT
SAMPLE AND GEOLOGY DETAILS
E F

SCALE 1" = 10'

November 12, 1975

HK

LOCATION "G"

Snow covered

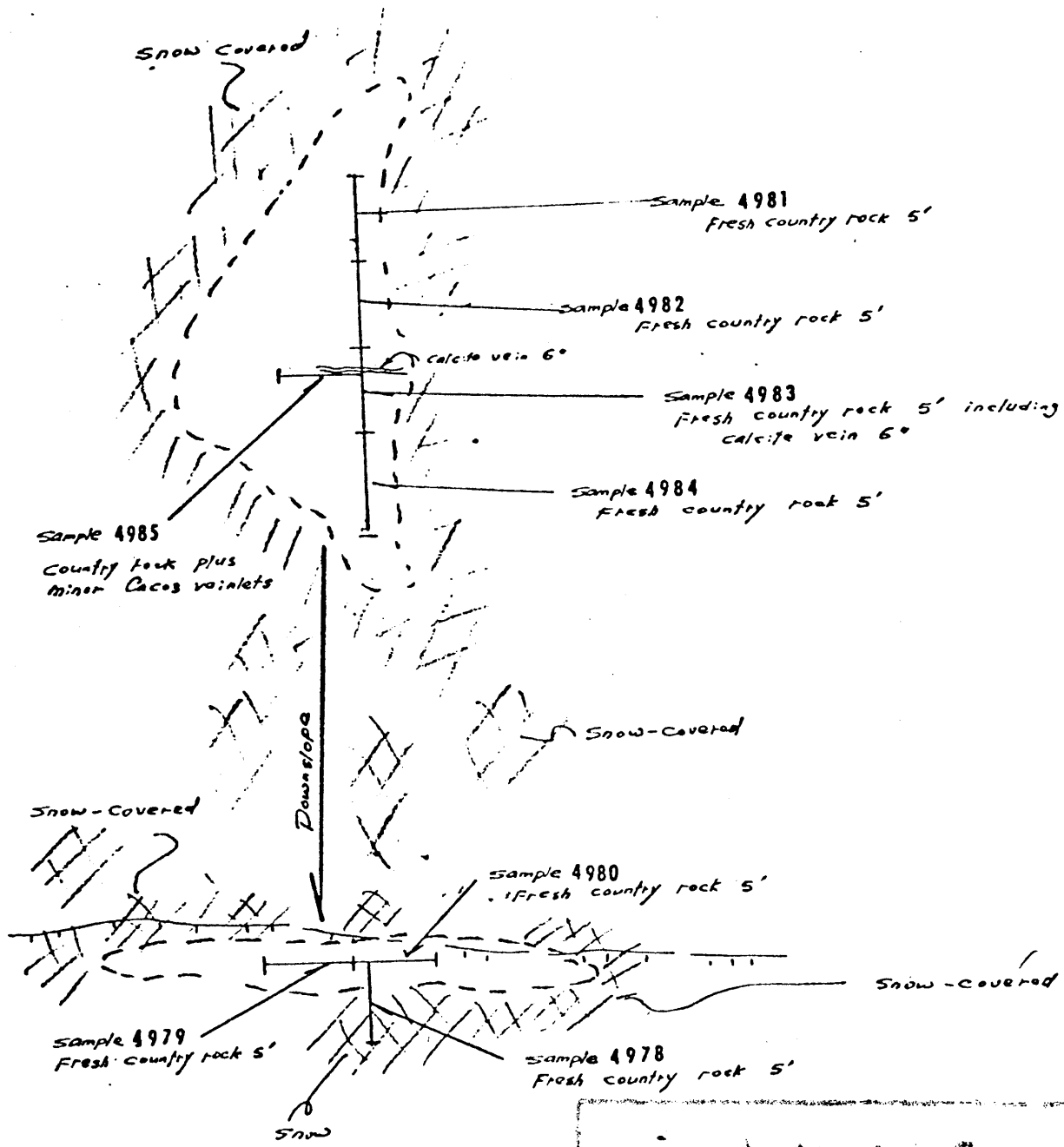

Sample 4985

Country rock plus
minor Calcis veinlets

Sample 4981

Fresh country rock 5'

Sample 4982

Fresh country rock 5'

Caliche vein 6'

Sample 4983

Fresh country rock 5' including
Caliche vein 6'

Sample 4984

Fresh country rock 5'

Snow-covered

Snow-covered

Sample 4980

Fresh country rock 5'

Snow-covered

Sample 4979

Fresh country rock 5'

Sample 4978

Fresh country rock 5'

Snow

(PLAN)

Approx. pit limit, bulldozed

Department of
Mineral and Petroleum Resources
ASSESSMENT REPORT

PLATE VI

SAMPLE AND GEOLOGY DETAIL

"G"

SCALE 1" = 10'

November 12, 1975

N.E.