

59/3

1976 Assessment Report on Getty Group of Mineral Claims

Getty 1 & 2 Record No. 128405-128406

Getty 3 - 24 Record No. 128545-128566

Getty "A" Fraction Record No. 128567

N T S 921 10W & 11E

GETTY

Kamloops Mining Division

Highland Valley, B.C.

- #1 DRILL HOLE LOCATION MAP
- #2 DRILL HOLE LOCATION MAP - 1"-400'
- #3 DRILL HOLE LOCATION MAP - 1"-1320'
- #4 DRILL HOLE AND CLAIM MAP

Department of
Mines and Petroleum Resources
ASSESSMENT REPORT

NO. 59/3 MAP X

July 20, 1976

W R Financial Consultants Ltd.
1650 - 701 W. Georgia Street
Vancouver, British Columbia

S T A T E M E N T

Professional services rendered and expenses advanced in your behalf regarding the Getty Claims, Highland Valley, B.C.

Review data, design, prepare and supervise percussion drilling program; log drill cuttings.

July 2 to July 15, 1976, 14 days @ \$100.00/ day	1,400.00
Meals & Accomodations, J. J. Oberbillig; 14 days @ \$30.00/ day	420.00
Vehicle Rental (1/2 T. Pick up, 2 W.D.), 15 days @ \$15.60/ day	225.00
Mileage:, Ashcroft to Property & Return; 70 miles X 15¢, 15 days	<u>157.50</u>
	\$2,202.50

Paid to John Lepinski, Ashcroft, B. C. Labour, 4 wheel drive truck rental, chain saw, ax, shovel, etc. For drill site and access preparation 4 days @ \$100.00 per day	<u>400.00</u>
	\$2,602.50

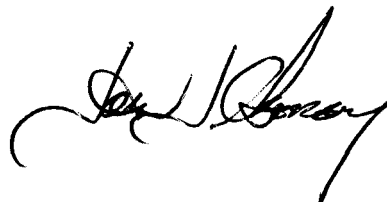

L & L DRILLING and EXPLORATIONS LTD.

Box 43, Cache Creek, B.C. V0K 1H0

Phone 457-9969

July 14th, 1976

W.R. Financial Consultants
1620-701 West Georgia St.
Vancouver, B.C.

Dear Sir:

The following is our account for drilling your property in the Highland Valley, Ashcroft, B.C.

<u>Hole No.</u>	<u>Feet Cased</u>	<u>Feet to Bedrock</u>	<u>Total Depth</u>
PD-1	20	25	70
PD-1A	20	30	300
PD-2	42	15	300
PD-3	20	15	300
PD-4	20	20	300
PD-5	10	20	300
PD-6	10	0	230
		TOTAL	1800'

1800' at 2.75/ft.	\$ 4950.00
170 sample bags at .45 ea.	76.50
Moving drill(after 2 hrs.) 1 hr. at \$50.00/hr.	50.00
Travelling time (after 1 hr.) 2 men 7 hrs ea.	
at 7.50 hr. each. 14 hrs. at \$7.50	100.00
Water truck-2 days at \$40.00/day	80.00
Mob and Demob at \$115.00 each way.	230.00
TOTAL DUE	\$ 5486.50

Respectfully Submitted,

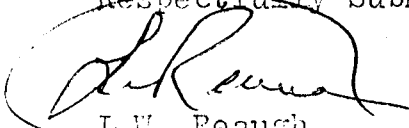

L.W. Reaugh
Managing Director

See 100 Scale Drill Hole
Location Map for this area.

John H. Gentry
July 21, 1974

GETTY CLAIMS
KAMLOOPS MINING
DIVISION

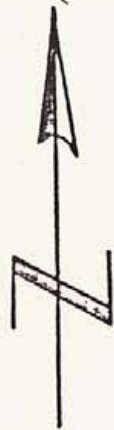
GEOLOGY MAP.
SCALE: 1"=400'



PQ
HV-13

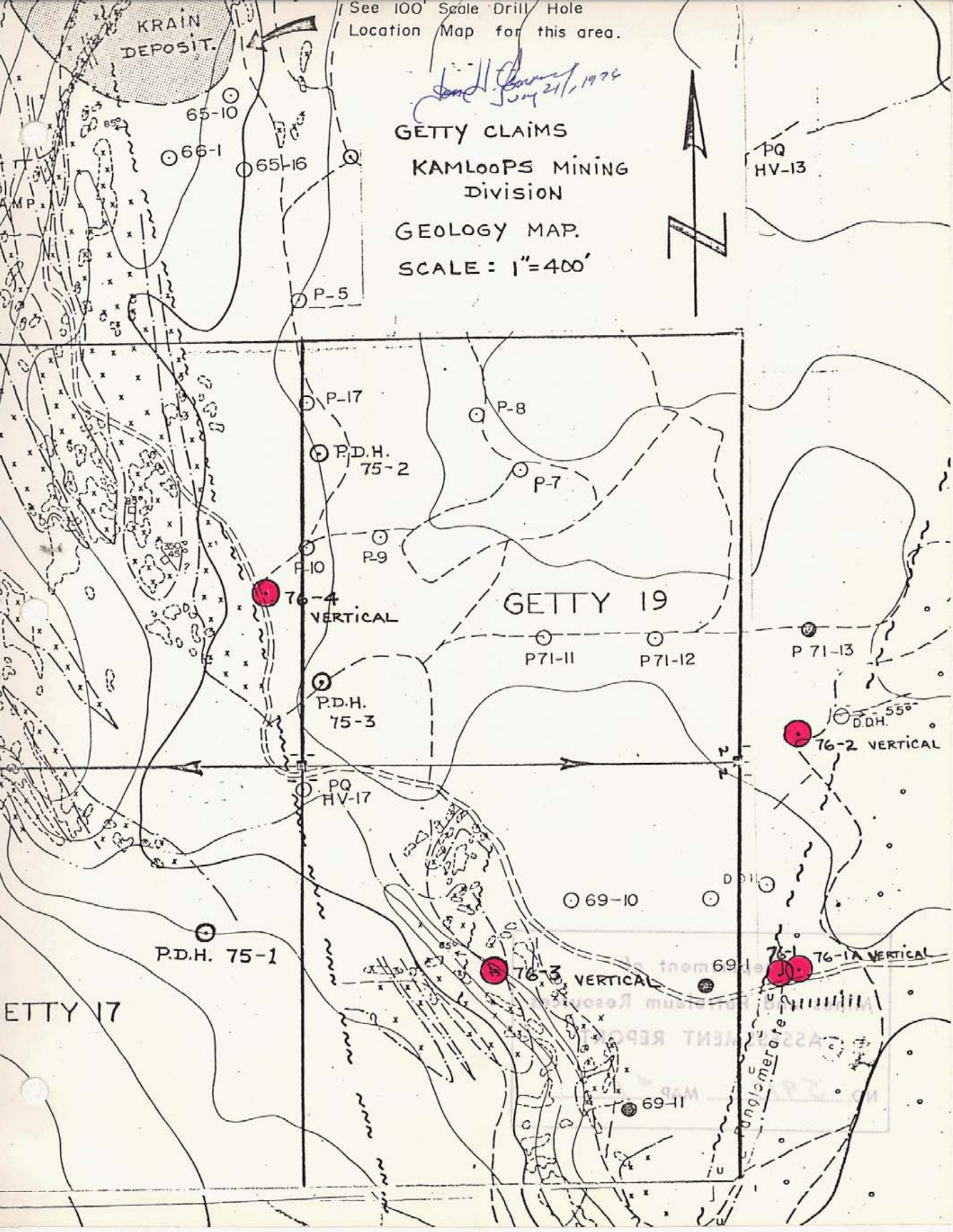

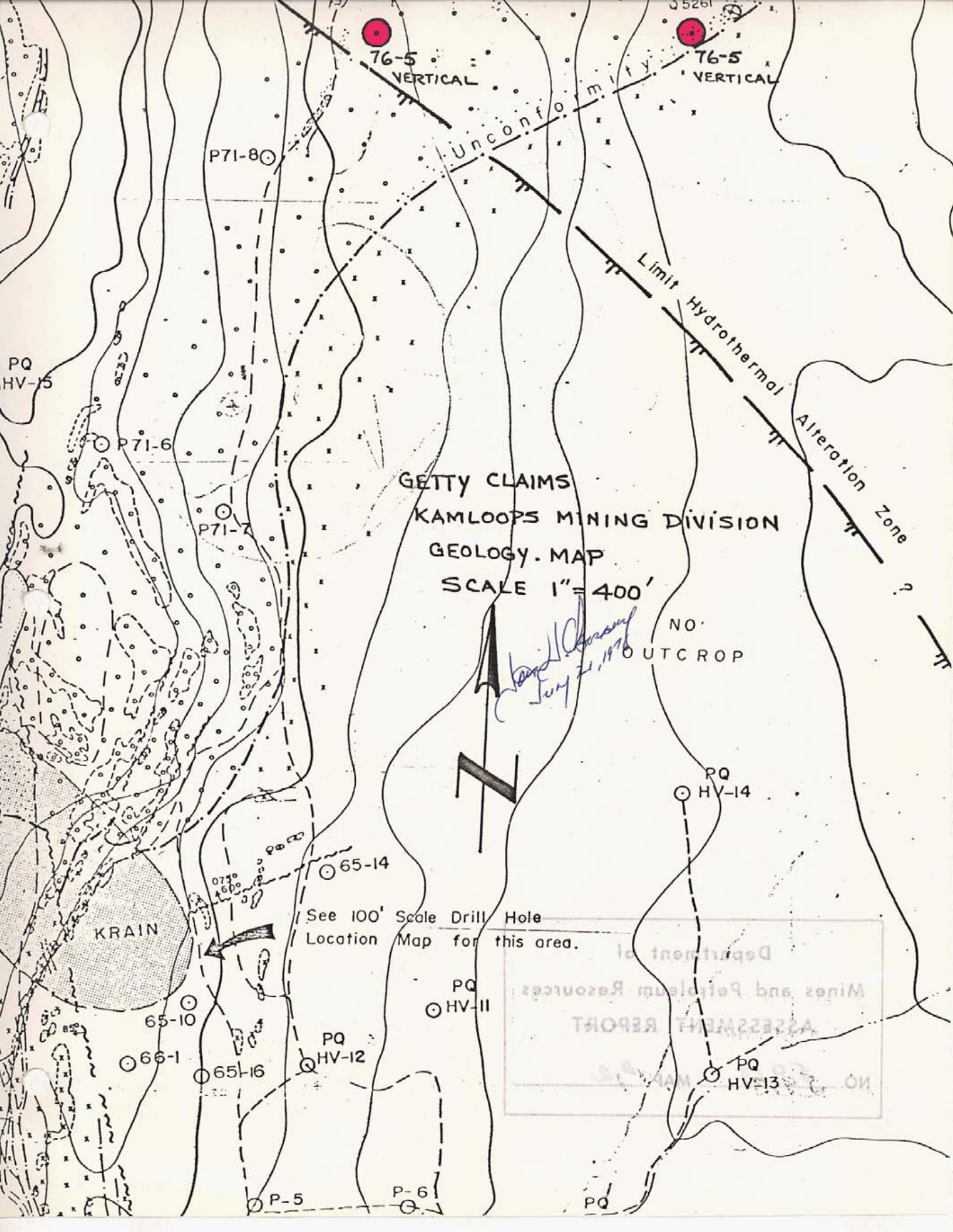

SCALE :
1" = 1320'

FORGE
MTN
6495'

76-5

VERTICAL

76-6

VERTICAL

76-4

VERTICAL

76-2

VERTICAL

76-3

VERTICAL

76-1

VERTICAL

76-1A

VERTICAL

KRAIN
DEPOSIT

SOIL GR

Panglomerate

Handwritten signature and date:
2/1/1976

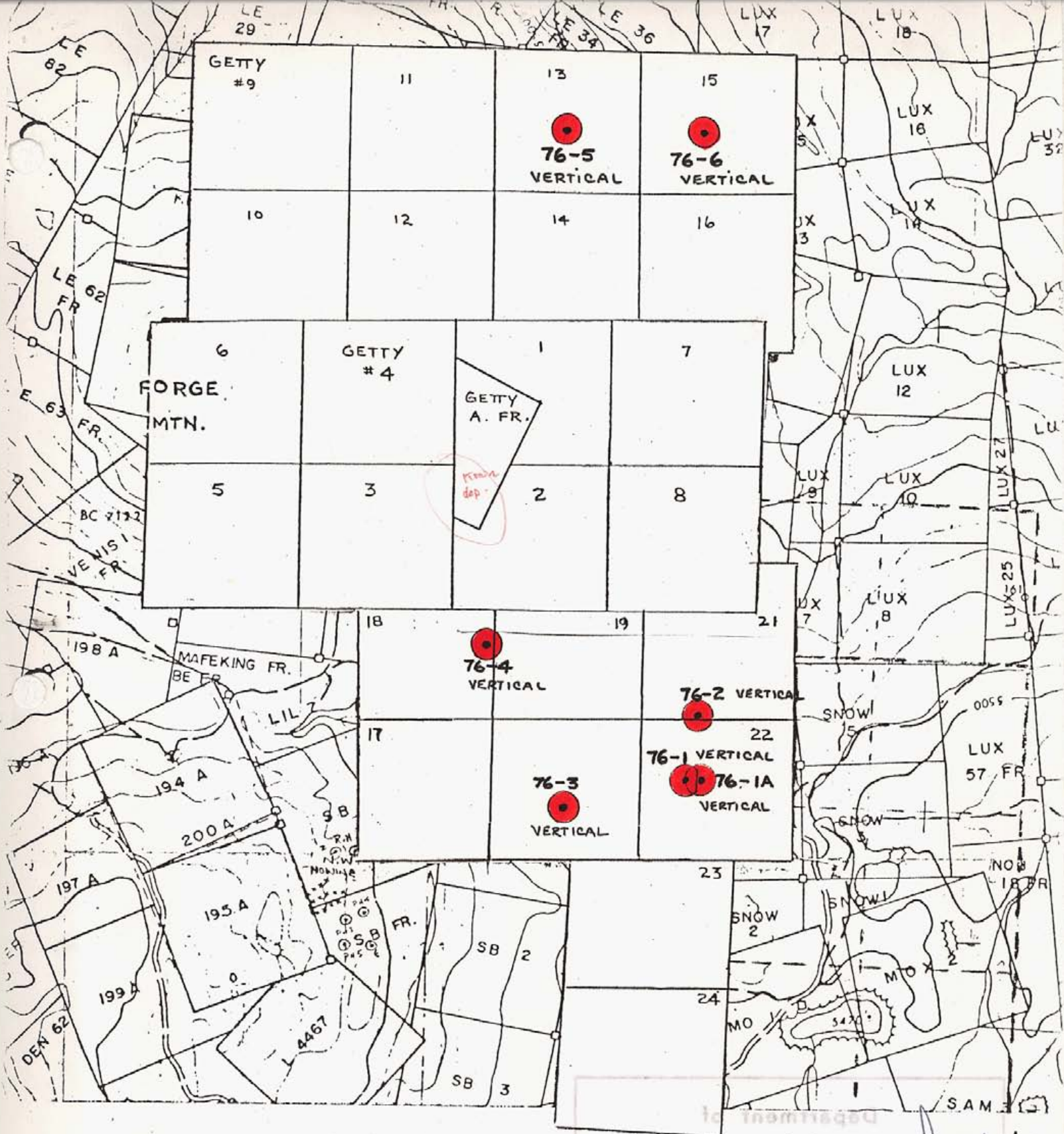

GETTY CLAIMS

#1-24 + A FRACTION

KAMLOOPS MINING DIVISION

HIGHLAND VALLEY, B.C.

CLAIM MAPS

92I/11E

92I/10W

SCALE 1"=1320'

Handwritten signature and date:
 July 21, 1976

