

# 5936

DIAMOND DRILLING REPORT

FOR

ROB AND FRAN MINERAL CLAIMS

OF UTICA NO. 65 GROUP

BY

DANKOE MINES LTD. (N.P.L.)

OMINECA MINING DIVISION

ENDAKO, B. C.

(LATITUDE 54° N., LONGITUDE 125°)

Department of  
Mines and Petroleum Resources  
ASSESSMENT REPORT

NO. 5936 MAP X

Field work, diamond drilling  
and core logging undertaken during  
period May 31 to June 7, 1976

AUGUST 5, 1976

---

T A B L E   O F   C O N T E N T S

---

Introduction . . . . .	Page 1
Mineral Claims . . . . .	Page 1
Diamond Drill Program . . . . .	Page 1 & 2
Statement of Expenditures . . . . .	Page 2 & 3
Conclusion . . . . .	Page 4

A P P E N D I C E S

---

I	Statment of Qualification
II	Diamond Drill Contract
<sup>#</sup> 1 III	Diamond Drill Hole Location Map 1 inch = 1,000 foot scale
IV	Diamond Drill Hole Logs For Holes U5 and U6

Introduction

Two NQ wireline diamond drill holes totalling 508 feet were drilled during the period May 31 to June 4, 1976. Drilling costs are being submitted for assessment work on the Rob and Fran Mineral Claims.

Mineral Claims

The Rob and Fran Mineral Claims are located about six and one half miles southwest of Endako, B. C. in the Omineca Mining Division. The property is geographically located in southeast quadrant of quadrilateral, Latitude 54°N. and Longitude 125°.

The mineral claims are grouped under Utica #65 Group. All claims are owned by Dankoe Mines Ltd. (N.P.L.)

<u>Grouping</u>	<u>Mineral Claim</u>	<u>Record Number</u>
Utica #65	Rob 1 - 10 inclusive	14180 - 14189 inclusive
	Fran 34 Rob "	14140 14190

Diamond Drill Program

Two vertical NQ wireline drill holes were drilled on the Rob 1 and 3 Mineral Claims. The first hole U5 on Rob 3 Mineral Claim was designed to a depth of 300 feet. This hole was stopped at 206 feet when it was apparent that the hole

was encountering an unfavourable and highly-fractured dyke rock. The second hole U6 was drilled to a depth of 302 feet. Partly kaolinitic altered Francois granite that is cross-cut by numerous narrow dykes was predominant rock type in this hole. The core was geologically logged on 1 inch = 10 feet graphic log. No molybdenite mineralization was encountered, and as a result, no samples were taken for assaying purposes. All drill core is stored at Endako Mines' core storage racks.

Preparatory field work for drill program commenced on May 31, 1976. A D8 dozer was employed to recondition an existing access road to the drill sites. The diamond drill was moved onto the first site on May 31, and drilling of both holes was completed on June 3, 1976. Drilling was conducted by Tonto Drilling Limited. The contract under which these two holes were drilled is appended (Appendix II).

An appended map (Appendix III) on 1 inch = 1,000 foot scale shows location of drill holes on the Rob and Fran Mineral Claims. Diamond drill logs for holes U5 and U6 are also appended (Appendix IV).

#### Statement of Expenditures

The following expenditures were incurred by Dankoe Mines Ltd. (N.P.L.) for the drilling of the two diamond drill holes.

Personnel Costs

<u>Personnel</u>	<u>Period Employed</u>	<u>Hours And Rate</u>	
E.T. Kimura	June 1-7/76	14 hrs.@\$14. =	\$196.00
A.J. Peters	May 31-June 7/76	22 hrs.@ 8. =	\$176.00
			<u>\$ 372.00</u>
Office Overhead @ 20% on personnel costs			74.00

Diamond Drilling Costs

Tonto Drilling Limited	Invoice No. 3069	\$ 473.00	
	Invoice No. 3072	<u>8,451.06</u>	8,924.06

Bull-dozer Costs

3 hours for roads and drill sites			
	Invoice No. 1416		238.03

Vehicle Costs

5 days - 3 hours each day @ \$30.00/8 hr. day			56.00
---	--	--	-------

Miscellaneous Costs

Core boxes, chainsaw rental, supplies, etc.			<u>20.00</u>
---	--	--	--------------

<u>TOTAL DIAMOND DRILLING COST FOR HOLES U5 AND U6</u>			<u>\$ 9,744.49</u>
--	--	--	--------------------

Conclusion

Two diamond drill holes totalling 508 feet were drilled on the Rob and Fran Mineral Claims of Utica No. 65 Group at a cost of \$9,744.49.

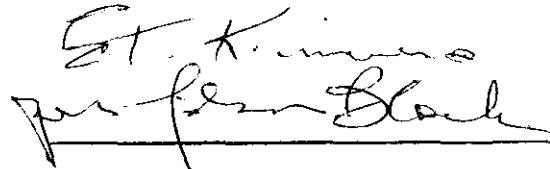
A handwritten signature in cursive script, appearing to read "E. T. Kimura" followed by a flourish that extends to the right.

E. T. Kimura

Appendix 1

STATEMENT OF QUALIFICATION

I, E. T. Kimura, of P. O. Box 29, Fraser Lake, B.C. do hereby certify that:

1. I am a geologist.
2. I am a graduate of the University of British Columbia with a B.A. degree in Geology and Physics in 1955.
3. From 1954 until the present I have been engaged in mining geology, both in underground and open pit operations, and in exploration geology in British Columbia, Saskatchewan and Yukon Territory.
4. I personally supervised and participated in the field work and have examined and logged the diamond drill core from this drilling program.
5. I do not own any shares or have any direct interest in Dankoe Mines Limited.

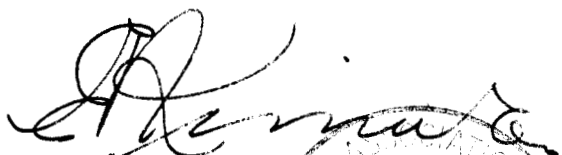
  
E. T. Kimura



THIS AGREEMENT MADE THE 28th. day of May, 1976.

BETWEEN: TONTO DRILLING COMPANY, of 1215 West 7th. Avenue, in the City of Vancouver, in the Province of British Columbia,

(hereinafter referred to as the "Contractor")

OF THE FIRST PART

AND: DANKOE MINES LTD. (NPL), a body corporate duly incorporated under the laws of the Province of British Columbia, and having its office at 1177 West Hastings Street, in the City of Vancouver, in the Province of British Columbia,

(hereinafter referred to as "Dankoe")

OF THE SECOND PART

WHEREAS:

A. Dankoe is the owner of the mineral claims on which the proposed diamond drill holes will be located;

B. The Contractor, in consideration of the payments hereinafter provided has agreed to carry out the said diamond drilling.

NOW THEREFORE THIS AGREEMENT WITNESSETH that in consideration of the premises and the mutual covenants herein contained, the Parties hereto covenant and agree as follows:

1. The Contractor agrees to find and supply all labour, materials, transportation, machinery, equipment and workmanship necessary to carry out a diamond drilling program on Dankoe's mineral claims and in accordance with the terms of this Agreement at the prices herein specified.

Guaranteed Footage:

2. Dankoe guarantees a minimum of six hundred (600) feet of diamond drilling in a series of holes, of a ~~maximum~~ maximum depth of two hundred (200) feet and a maximum depth of five hundred (500) feet. All measurements to be taken from top of casing.

*[Handwritten signature]*



Core Size:

3. The Contractor guarantees to sink with standpipe and/or bore by diamond drill, the specified minimum footage, recovering NQ wireline core, approximately one and seven-eighths (1 7/8) inches in diameter, and to supply forthwith one (1) drill outfit, along with necessary associated equipment, industrial diamonds and labour to commence the work with the time limits specified by Dankoe.

Price:

Schedule of Rates for Diamond Drilling Depth of Hole Range	Price Per Foot NQ Wireline
0 to 500 feet	\$13.75 per foot

If holes of a greater depth than five hundred (500) feet are desired, such drilling shall be performed only upon such conditions and at such rates as may be agreed upon before commencement of such drilling.

4. The Contractor agrees that all its labour, diamond wear and loss and all other operating expenses, except as hereinafter provided, shall be at its own cost and expense and for its own account.

Penetration  
of Overburden:

5. Wherever overburden or broken rock is encountered on a set-up, it is agreed that the Contractor's charge for penetrating such overburden or broken rock shall be at the following rates:

0 to 50 feet	\$13.75 per foot
--------------	------------------

If the cost of penetrating the additional overburden or broken rock is greater than thirteen dollars and seventy-five cents (\$13.75) per foot, Dankoe agrees to pay the Contractor at the Hourly Rate, plus ten percent (10%) on consumables. The cost of casing shoes will be charged at invoice cost plus 10%.

The Contractor agrees that the first four hours per hole for setting and pulling casing shall be at its own expense. In the event that casing cannot be set and pulled within four hours, Dankoe agrees to reimburse the Contractor at the Hourly Rate for the additional hours.

Hourly Rate:

6. It is agreed that Hourly Rates shall be interpreted here and hereinafter to mean the labour of a two-man crew, including supervision plus machine and equipment rental, at the rate of forty-three dollars (\$43.00) per hour; pipe and casing lost or left in holes; diamond loss and setting charges; materials and supplies consumed in the work at delivered cost plus ten percent (10%).

In the event extra labour over and above the regular two-man crew and supervision are required, the Contractor agrees to supply such additional labour at the rate of sixteen dollars and fifty cents (\$16.50) per man per hour.

Caves:

7. In the event that cavities or loose and caving materials are encountered of a nature as to prevent the successful completion of any hole, the Contractor does not, under such conditions, guarantee to drill to a predetermined depth, and in the event that it becomes necessary to abandon the hole, Dankoe agrees to pay for such uncompleted holes at the rates herein specified for all footage completed. If required to continue on such holes on specific orders and approval from Dankoe's Representative, then Contractor shall have the option to revert to drilling at the Hourly Rate, plus all required materials, supplies and equipment at delivered cost plus ten percent.

In the event it becomes necessary to resort to soluble oil, cementing, reaming, casing or mud circulation in bedrock or overburden, Dankoe agrees to reimburse the Contractor at the Hourly Rate, plus ten percent (10%) on consumables for the soluble oil, cementing, reaming, casing or mud circulation operations.

8. Wherever pipe, casing or other equipment is lost or is left in a hole on the instructions of Dankoe's Representative, Dankoe agrees to pay the Contractor for such pipe, casing or other equipment at their depreciated value, f.o.b. drill site. Dankoe agrees to pay the Contractor the cost of diamond set casing shoe bits in addition to the cost of any casing left in the hole. Dankoe further agrees to pay the Contractor the cost of recovery or attempted recovery of materials from holes at the Hourly Rate.

Tests:

9. The Contractor, when instructed so to do, shall take any clinometer dip tests desired by Dankoe. The Contractor's charge for such tests shall be at the Hourly Rate.

Water:

10. Water for drilling purposes shall be pumped by the Contractor up to a distance of two thousand five hundred (2,500) feet and up to two hundred and fifty (250) feet vertical lift. Should it be necessary to pump water to a greater distance than two thousand, five hundred (2,500) feet or two hundred and fifty (250) feet vertical, whichever applies, Dankoe agrees to pay the additional cost of supplying water to the drill site at the Hourly Rate.

Transportation and Moves:

11. a) It is agreed that the moving of drill and camp equipment, supplies and personnel, from the final hole at Endako to the initial drill site, and return from the final drill site to the loading point at Endako, shall be charged to Dankoe at the Hourly Rates.
- b) It is agreed that the moves between drill sites shall be for Dankoe's account at the Hourly Rates.
- c) Moving shall be interpreted to include tearing down, dismantling machinery, moving, securing timber, transportation and setting up.
- d) The Contractor agrees to supply a JD450 tractor for the purposes of moving drill and associated equipment between holes at no cost to Dankoe. In the event that Contractor's JD450 is unable to negotiate certain terrain, Dankoe will supply a tractor to assist in moving the drill rig from site to site. It is understood and agreed that waiting time for Dankoe's tractors on such moving operations shall be borne by Dankoe.
- e) Dankoe agrees to provide suitable access roads and drill sites in advance of the drilling operation at no cost to the Contractor.
- f) Interim service trips in connection with the maintenance of drill camps and the drilling operation shall be for the Contractor's account.

Waiting Time for Orders:

12. It is understood and agreed that time lost waiting for orders from Dankoe's Representative, shall be charged to Dankoe at the Hourly Rate.

5.

Travel Time: 13. The Contractor will provide transportation for its personnel to and from the drill sites. In the event travel time to and from the drill sites exceeds one hour per man shift, Dankoe agrees to reimburse the Contractor for all travel time in excess of one hour per man shift at the rate of sixteen dollars and fifty cents (\$16.50) per man hour.

Core: 14. The drilling shall be conducted so as to produce maximum core recovery with every reasonable precaution taken to prevent crushing, wearing or grinding of core. All cores recovered by the Contractor shall be carefully marked and placed in receptacles to be furnished by Dankoe at the drill site. To ensure maximum core recovery, the Contractor will supply experienced wireline operators. Dankoe will be responsible for the transportation of core from the drill site.

Security: 15. The Contractor will not give out any information regarding drill results or permit access to any drill core to any person other than Dankoe's accredited Representatives, except upon specific permission of responsible officials of Dankoe.

Moly Grease: 16. The Contractor will not use molybdenum-base grease on rods or on any parts of the drill where contamination of sludge and core may occur.

Camps: 17. The Contractor agrees to provide board and lodging for its own men at no cost to Dankoe.

Discipline: 18. The Contractor shall, at all times, enforce strict discipline and maintain good order among its employees, and shall not retain on the work any unfit person or anyone not skilled in the work assigned to him.

Any employees of the Contractor who are objectionable or unsatisfactory to Dankoe, shall be removed from the work and replaced by an employee satisfactory to Dankoe.

Insurance: 19. The Contractor shall insure and keep insured during the term of this contract with an insurer acceptable to and approved by Dankoe, at the Contractor's own expense and cost, the following liability insurances:

a) Comprehensive general liability insurance on an occurrence basis, and including but not limited to, operations, Contractor's protective, contractual, products and completed operations and non-owned automobile. Dankoe shall be added as an additional insured under this item and the following clause shall be made part of this agreement:

"Cross Liability - the insurance afforded by this policy shall apply to any action brought against any of the insureds by any other insured in the same manner as though separate policies were issued to each."

b) Automobile - owned.

The insurers limit of liability in respect to the above mentioned insurances shall not be less than one million dollars (\$1,000,000.) inclusive for bodily injury and/or property damage each occurrence, and one million dollars (\$1,000,000.) aggregate for products and completed operations.

20. The Contractor shall be responsible for and will pay promptly all dues and assessments payable under any Workmen's Compensation Act or other similar act, whether Provincial or Federal, in respect of its employees.

Environment:

21. During the course of the work, the Contractor shall at all times keep Dankoe's premises free from accumulation of waste material or rubbish and upon completion of the work, shall remove all tools, scaffoldings, surplus materials and rubbish, and leave the premises in a clean condition. The Contractor shall observe and comply with all applicable Federal and Provincial laws, regulations and orders relating to prevention of forest fires and sanitation in the bush.

Dankoe will be responsible for procuring and maintaining applicable permits for land and water usage. Dankoe will hold Contractor harmless for any liability claims which may arise from normal activity related to this Agreement, including pollution of ground water or surrounding land from discharge of drill water and wastes save if Contractor's employees act in an irresponsible manner.

Payment  
for Work:

22. Dankoe agrees to pay the Contractor, in Canadian funds, the above prices. Payment shall be made within thirty (30) days of the date of the account rendered. Invoices shall be submitted twice monthly to Dankoe Mines Ltd.(NPL), 1177 West Hastings Street, Vancouver, B. C. Interest at the rate of one percent (1%) per month shall be charged on overdue accounts.

Manner of  
Performing  
Work:

23. The Contractor shall perform his work in such a manner as to not interfere with or hold up the normal operations of Dankoe.

Safety:

24. The Contractor will abide by all provisions of The Mines Regulation Act that pertain to safety and such other matters relevant to this Agreement.

Equipment operated by the Contractor shall, at all times, yield the right of way to equipment operated by Dankoe.

The Contractor's equipment shall meet all Workmen's Compensation Board and Department of Mines regulations.

Engineer:

25. Dankoe's Engineer or Representative referred to herein and in the General Conditions of the contract shall be such person as Dankoe may nominate in writing as their representative.

Notices:

26. All communications in writing between the Parties shall be deemed to have been received by the addressee if delivered to the individual or to a member of the firm or to an officer of the corporation for whom they are intended, or sent by post or telegram addressed as follows:

The Contractor:

Tonto Drilling Company,  
1215 West 7th. Avenue,  
Vancouver, B.C.  
V6H 1B7

Dankoe:

Dankoe Mines Ltd. (NPL),  
1177 West Hastings St.,  
Vancouver, B. C.

General:

27. Whenever in this Agreement it is stipulated that anything shall be done or be performed by either of the Parties hereto, it shall be assumed that such Party does hereby enter into a covenant with the other Party to do or perform the same.

28. All grants, covenants, privileges and liabilities contained in this Agreement shall be read and held as made by and with and granted to and imposed upon the respective Parties hereto and their respective successors and assigns, in the same manner as if the words "Successors" and "Assigns" had been inscribed in all proper and necessary places, and in the event of more than one person being the Contractor, the said grants, covenants, provisos and liabilities, shall be construed and held to be several as well as joint.

29. Whenever the singular or masculine is used throughout this Agreement, the same shall be construed as meaning the plural or feminine or body corporate, as the context of the Parties so require.

30. Any condoning, excusing or overlooking by Dankoe of any breach, or non-performance by the Contractor at any time or times in respect to any covenant, term, condition, and proviso contained in this Agreement shall not operate as a waiver of Dankoe's right in respect of any continuing or subsequent default, breach or non-performance.

31. This Agreement may be altered only by written consent of both Parties hereto.

32. Time is of the essence in this Agreement.

IN WITNESS WHEREOF the Parties hereto have caused these presents to be executed as of the day and year first above written.

TONTO DRILLING COMPANY per: )



Authorized Signing Officer )

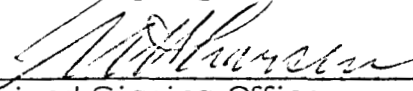

Authorized Signing Officer )

The Common Seal of DANKOE MINES LTD. )

(NPL) was hereunto affixed in the presence )

of: )



\_\_\_\_\_  
\_\_\_\_\_ )



**DANKOE MINES LTD.**  
~~ENDAKO MINE~~

HOLE No. U5  
SHEET No. 1 Of 3

SECTION \_\_\_\_\_

LOCATION Rob 1 Mineral Claim BEARING - LATITUDE \_\_\_\_\_ CORE SIZE NQ Wireline LOGGED BY F.T.K.  
DATE COLLARED June 1, 1976 LENGTH 206' DEPARTURE \_\_\_\_\_ SCALE OF LOG 1"=10' DATE June 3-4, 1976  
DATE COMPLETED June 2, 1976 DIP -90° ELEVATION 3325' approx. REMARKS Hole stopped @ 206' due to excessive caving

ROCK TYPES & ALTERATION						GRAPHIC LOG	MINERALIZATION & STRUCTURES			ROCK QUALITIES					RECOVERY		ASSAY RESULTS								
Qtz.	Plag.	K-Spar.	Mafic.	Texture	Hardness		Rock Name/ Appearance	Rock Type Alteration	Footage	Structure	∠ To Core Axis	Width of Vein	Mineralization / Faulting (type)	Envelopes (type)	Remarks	Fractures	Slickenside ∠ To Core Axis	R O D	Footage Blocks	Specific Gravity	Weight in Grams	Sample Number	% MoS <sub>2</sub>		
															∠ to core	Frequency				Core	Sludge	Core	Sludge	Core	Sludge
																				%	%	Estimated Grade	Estimated Grade	Combined	Combined
						(0-48) csq in overburden.																			
		5-7%	<1%	porph.	5-6	Feldspar Porphyry	48							(48-63) rusty orange oxidized structures.			0% over 2'								
	1/16-1/4"			aphanitic		Overall buff with creamy phenos. Highly fractured blocky core. Almost total lack of veins, locally finely peppered with pyrite.								(54-57) Highly shattered and partially ground core.			5%	63			60%	Tr			
	locally zoned																	65			90%	Tr			
						Several larger phenos showing poor rapakivi texture.												72 1/2			90%	Tr			
						Feld phenos becoming alt'd to soft Kaol <sup>1</sup>								Minor gr. core @ 82 1/2				82 1/2			90%	Tr			
																		92 1/2							
						Lower contact with QM sharp @ 25° to core axis 90 1/2												94 1/2			85%	Tr			

*F. T. K.*  
June 7, 1976



DANKOE MINES LTD.

~~ENDAKO MINES~~

HOLE No. U5  
SHEET No. 3 Of 3

SECTION \_\_\_\_\_

Qtz.	ROCK TYPES		ALTERATION			GRAPHIC LOG		MINERALIZATION & STRUCTURES				ROCK QUALITIES					RECOVERY		ASSAY		RESULTS					
	Flag	k-Spar.	Mafic.	Texture	Hardness	Rock Name/ Appearance	Rock Type Alteration	Footage Structure	L To Core Axis	Width of Vein	Mineralization/ Faulting (type)	Envelopes (type)	Remarks	Fractures		Slickenside L To Core Axis	R O D	Footage Blocks	Specific Gravity	Weight in Grams		Sample Number		% MoS <sub>2</sub>		
														L to core	Frequency					Core	Sludge	Core	Sludge	Core	Sludge	
																										%
		Estimated Grade		Combined																						
							180	2	1/16	Cal. fr.		(173-174) Ground core 174-175 Ground Core				4%	175 176		56%		Tr					
							180	70	ht	py							0%	183		80%		Tr				
							190	10	ht-1/2	Cal py							187 1/2		80%		Tr					
							190	40	1/8	Fault							195		80%		Tr					
							200	10	ht	py							9%			80%		Tr				
							200	15x2	1/2	Cal Calx2							0%	201 203 204		25%		Tr				
							206	40	1/4	vuggy Cal.		(201-206) Ground core-only small pebbles recovered. Drill hole started caving					0%	206		25%		Tr				
												End of Hole														

(199-206) Very intensely  
crackled, heavily  
brecciated and hostled  
by Cal.

DANKOE MINES LTD.

HOLE No. UG  
SHEET No. 1 Of 5

SECTION \_\_\_\_\_

LOCATION Rob 3 Mineral Claim BEARING \_\_\_\_\_ LATITUDE \_\_\_\_\_ CORE SIZE NQ Wireline LOGGED BY E.T.K.  
DATE COLLARED June 2, 1976 LENGTH 302' DEPARTURE \_\_\_\_\_ SCALE OF LOG 1"=10' DATE June 4-7, 1976  
DATE COMPLETED June 3, 1976 DIP -90° ELEVATION 3230' approx. REMARKS \_\_\_\_\_

ROCK TYPES & ALTERATION						GRAPHIC LOG	MINERALIZATION & STRUCTURES				ROCK QUALITIES					RECOVERY		ASSAY RESULTS					
Qtz.	Plag.	K-Spar.	Mafic.	Texture	Hardness		Rock Name / Appearance	L To Core Axis	Width of Vein	Mineralization / Faulting (type)	Envelopes (type)	Remarks	Fractures		Slickenside L To Core Axis	R O D	Footage Blocks	Specific Gravity	Weight in Grams		Sample Number		
													L to core	Frequency					Core	Sludge	Core	Sludge	Core
				aphan.	6	No oxidation Brecciated Qtz Feld Porph. Pale buff. 1' Francois Granite	50+60 50x2 40 30	1/16x2 1/8+1/16 1/16 1/32+1/16	fault + fault with 2" assoc. brecc. fault+py fault fault contact.				10 20 30 40 50 60 70 80		8%								
20%	15% white to cream	60-65% red-pink.	5-7% bio.	coarse med xln	6	Francois Granite	40 30	1/16	fault				10 20 30 40 50 60 70 80			30%		95%		Tr			
						Brecciated Qtz-Feld Porph.	40 30 20 10	1/8x2 1/16-1/8 1/16-1/16 1/16	py x2 fault (cal-chl. gg) cal py fault				10 20 30 40 50 60 70 80		7%	43		90%		Tr			
	plag alt'd to bleach. soft	Ksp also alt'd				Intense Karol. Fron. Granite 1' Brecc. QFP	25 30+20+80 70	8" 1/32 1/2+1'+2" 1/2	Fault py fault x3 fault				10 20 30 40 50 60 70 80		0%	52% 55%		79%		Tr			
						1' Brecc. QFP	70 40	1/32	cal				10 20 30 40 50 60 70 80		0%	62% 66		73%		Tr.			
						1/2' Brecc. QFP	45 30	2'	Major fault. QFP and some apilite fragments				10 20 30 40 50 60 70 80		4%	73		70%		Tr			
							60 40 30 20 10+40+25	1/16x2 1" 1/32+1/8+1/4	py x2 fault chl + fault + chl (gg.)				10 20 30 40 50 60 70 80				78 1/2						
							40 30 20 10+70+80	1/2 5/16 1" 1 1/4 + 1/2 1/2	fault fault fault fault x2 fault		Minor gr. core @ 85'		10 20 30 40 50 60 70 80			83							
						Apilite	80 30	1/2					10 20 30 40 50 60 70 80					63%		Tr			

*E.T.K.*  
June 7, 1976











ROB AND FRAN MINERAL CLAIM LOCATION MAP SCALE 1:50,000

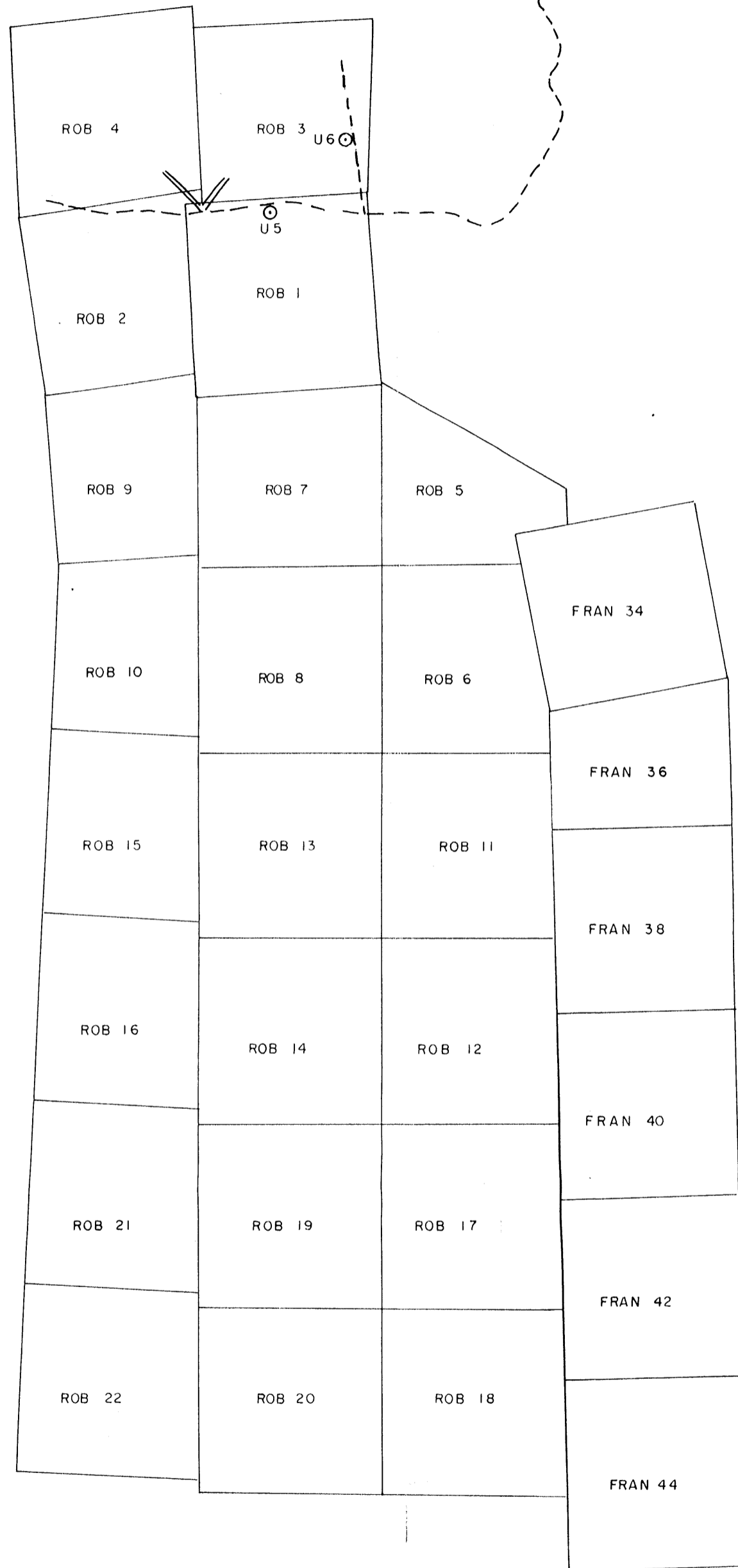
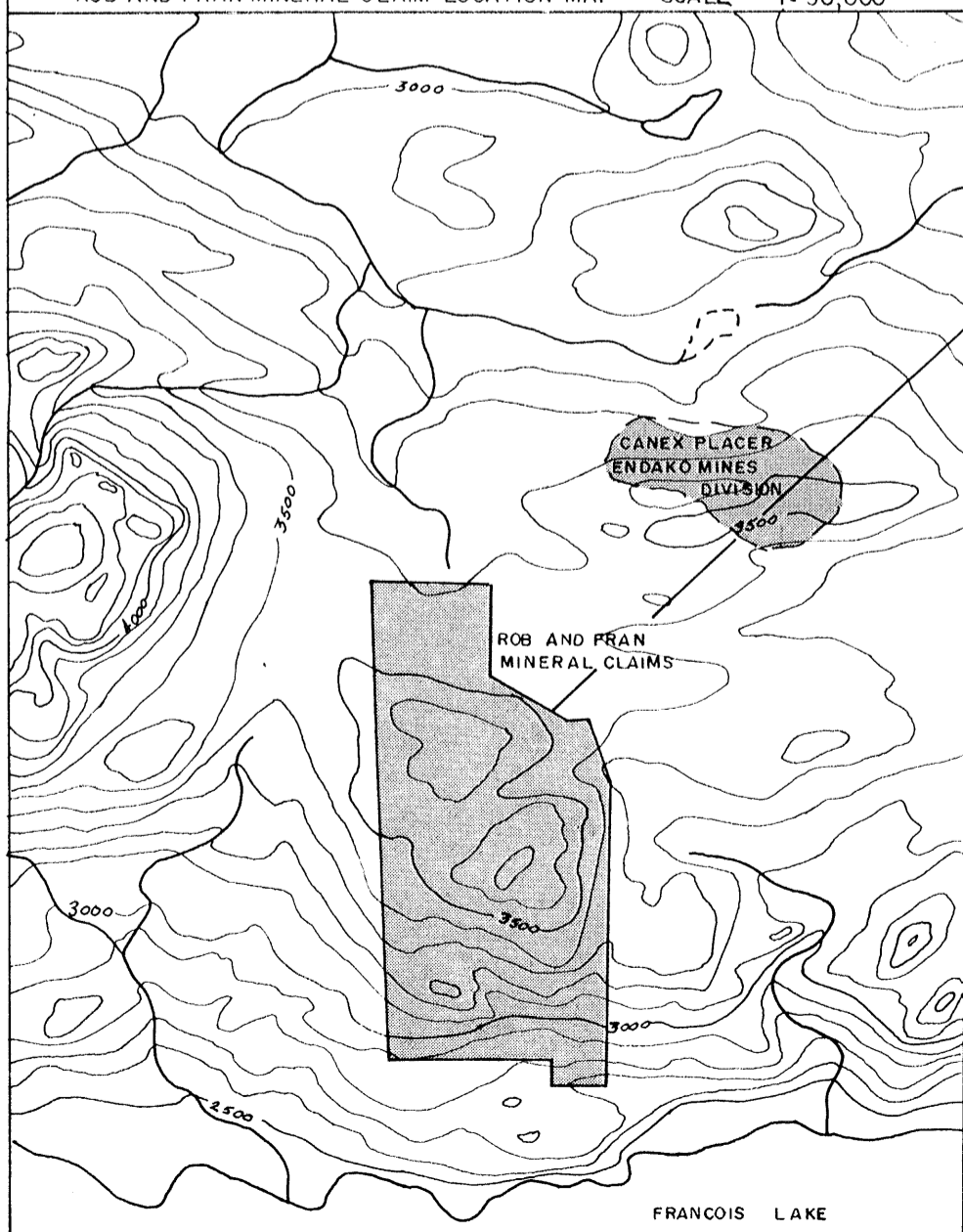

5936  
M-1

Department of  
Mines and Petroleum Resources  
ASSESSMENT REPORT  
NO. 5936 MAP #1

--- EXISTING ROAD  
○ DIAMOND DRILL HOLE

*A. K. Mulla*  
June 7, 1976

DRAWN AJP	SCALE 1"=1000'	DANKOE MINES LTD. (NPL)	ROB AND FRAN MINERAL CLAIMS
TRACED	DATE JUNE 7/76	DIAMOND DRILLING	
APPROVED			