

5973

KENNCO EXPLORATIONS, (WESTERN) LIMITED

REPORT ON SOIL GEOCHEMICAL SURVEY

BARRIERE LAKE IV CLAIM GROUP

East Barriere Lake Area,
Kamloops Mining Division,
British Columbia

51°15'N

119°45'W

Work Performed During the Period
July 9 - 13, 1976

By

Stephen C. Gower

R.W. Stevenson, P.Eng.

Department of
Mines and Petroleum Resources
ASSESSMENT REPORT

NO. 5973 MAP.....

TABLE OF CONTENTS

| | <u>Page</u> |
|--|-------------|
| INTRODUCTION | 1 |
| LOCATION AND ACCESS | 2 |
| CLAIMS | 3 |
| SAMPLE SITE CONTROL | 4 |
| SAMPLE COLLECTION, PACKAGING AND PREPARATION | 5 |
| ANALYSIS | 6 |
| INTERPRETATION | 7 |
| STATEMENT OF COSTS | 8 |
| CERTIFICATION | 9 |

PLATES

| | | |
|------------------|---|----------------------------|
| Plate #1 | Location Map REM & EBL Claims | 1:250,000 |
| <i>Map #1</i> #2 | REM & EBL Claim Map | 1" = 800' IN POCKET |
| #3A | Sample Numbers | " |
| #3B | Soil Geochemical Survey, Copper-in-PPM | " |
| #3C | " " " ,Zinc-in-PPM | " |
| #3D | " " " ,Lead-in-PPM | " |
| #3E | " " " ,Silver-in-PPM | " |
| #4 | Copper Profiles & Mineral Trends, Grid Coordinates | |

KENNCO EXPLORATIONS, (WESTERN) LIMITED

REPORT ON SOIL GEOCHEMICAL SURVEY

BARRIERE LAKE IV CLAIM GROUP

INTRODUCTION

The mineral claims discussed in this report are situated between East and North Barriere lakes, approximately 32 kilometers northeast of Barriere, B.C. Soil samples were taken over the suspected strike of a massive pyrrhotite body which outcrops on the property at soil sample site 31762. Purpose of the survey was to indicate areas along strike which might contain high concentrations of copper under shallow drift cover.

The sampling was performed by Kennco personnel in July, 1976. The samples were analyzed by Min-En Laboratories Ltd. of North Vancouver. Drafting was done by H.R. Goddard. The project was managed by S.C. Gower under the supervision of R.W. Stevenson, P.Eng.

CLAIMS

The Barriere Lake IV Claim Group consists of the following claims:

EBL 13, 16, 29, 30, 31, 32, 37, 38,50 and 55A

REM 4, 5, 6, 13, 14, 15, 16, 17, and 18

The above claims are wholly owned, one-third each, by George Moore, Jim Gourlay and Ruby Moore (Plate #2).

LOCATION AND ACCESS

The claims are situated about 32 kilometers north-east of Barriere, B.C., midway between North and East Barriere lakes (Plate #1). Access is by good forestry road to East Barriere Lake, then by six miles of old logging road, suitable for four-wheel drive vehicles only, to the property.

The claims are situated on an upland area of low relief which slopes southerly from an elevation of 4000', and drops abruptly along the north and south margins. A heavy growth of alpine fir, cedar, hemlock, spruce and Douglas fir, which has been partially logged, covers the claim area. The central part of the claim group was burned over about 25 years ago and is covered by an extremely dense second growth.

SAMPLE SITE CONTROL

A previously located and surveyed grid by Craigmont Mines Ltd. was utilized to provide sample site control (Plate #3A). Location of stations where the Craigmont grid was indistinct was established by chain and compass.

SAMPLE COLLECTION, PACKAGING AND PREPARATION

The soil samples were taken at 100-foot intervals along lines 400' apart using a trenching tool. Samples were taken from the 'B' horizon which was readily identifiable by its rusty colour. Samples were placed in a numbered 3" x 4 1/2" brown paper bag and closed with a triangular triple fold. The pertinent details were listed in notes. The samples were dried and sent to Min-En Laboratories for analysis. At Min-En Laboratories the samples were further dried and screened to minus 80 mesh using a stainless steel sieve.

ANALYSIS

The soil samples (0.5 gram sample) were digested in nitric and perchloric acids [HNO_3 , HClO_4] diluted and read by atomic absorption spectrophotometer for Cu, Pb, Zn, Ag. Results were reported in parts per million.

INTERPRETATION

Outcrop in the survey area is extremely sparse. Limited trenching had exposed lenses of massive pyrrhotite-magnetite-chalcopyrite in a limy schist. The purpose of the survey was to trace the zone along strike, and to pinpoint portions of the zone containing high concentrations of copper close to surface.

The suspected trend of the zone is shown on Plate #4. Based on geochemical copper values and topography, it is inferred that the zone crosses the lines at the following locations.

24N - 3W
28N - 6W
32N - 8W
36N - 10W
40N - 11W
44N - 13W
48N - 13W
56N - 24W
60N - 25W
64N - 26W
68N - 30W

Areas which may contain high concentrations of copper fairly close to surface are 32N-8W, 36N-10W, 44N-13W, and 56N-24W. These areas could be trenched to test grade of copper and other metals in rock.

Vancouver, B.C.

S. C. Gower

September 15, 1976



Robert W. Stevenson

STATEMENT OF COSTS

The costs incurred on analysis and evaluation of the Barriere Lake IV Group of mineral claims were as follows:

| | |
|--|---------------|
| <u>Analysis</u> of 99 soil samples for Cu,Pb,Zn & Ag | \$ 297.00 |
| <u>Wages:</u> | |
| Stan Siscoe July 9,11,12,13 @ \$32.50/day | 130.00 |
| Tom Tompkins July 9,11,12 @ \$32.50/day | 97.00 |
| Brian Flower July 12 @ \$38.00/day | 38.00 |
| S.C. Gower July 12 @ \$50.00/day | 50.00 |
| <u>Support:</u> 9 mandays @ \$16.00/day | 144.00 |
| <u>Truck Costs:</u> 4 days @ \$25.00/day | 100.00 |
| <u>Report, Typing & Reproduction.</u> | <u>150.00</u> |
| Total | \$1,006.00 |

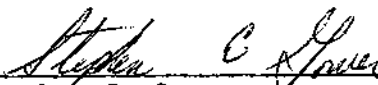
September 15, 1976



Stephen C. Gower



Robert W. Stevenson

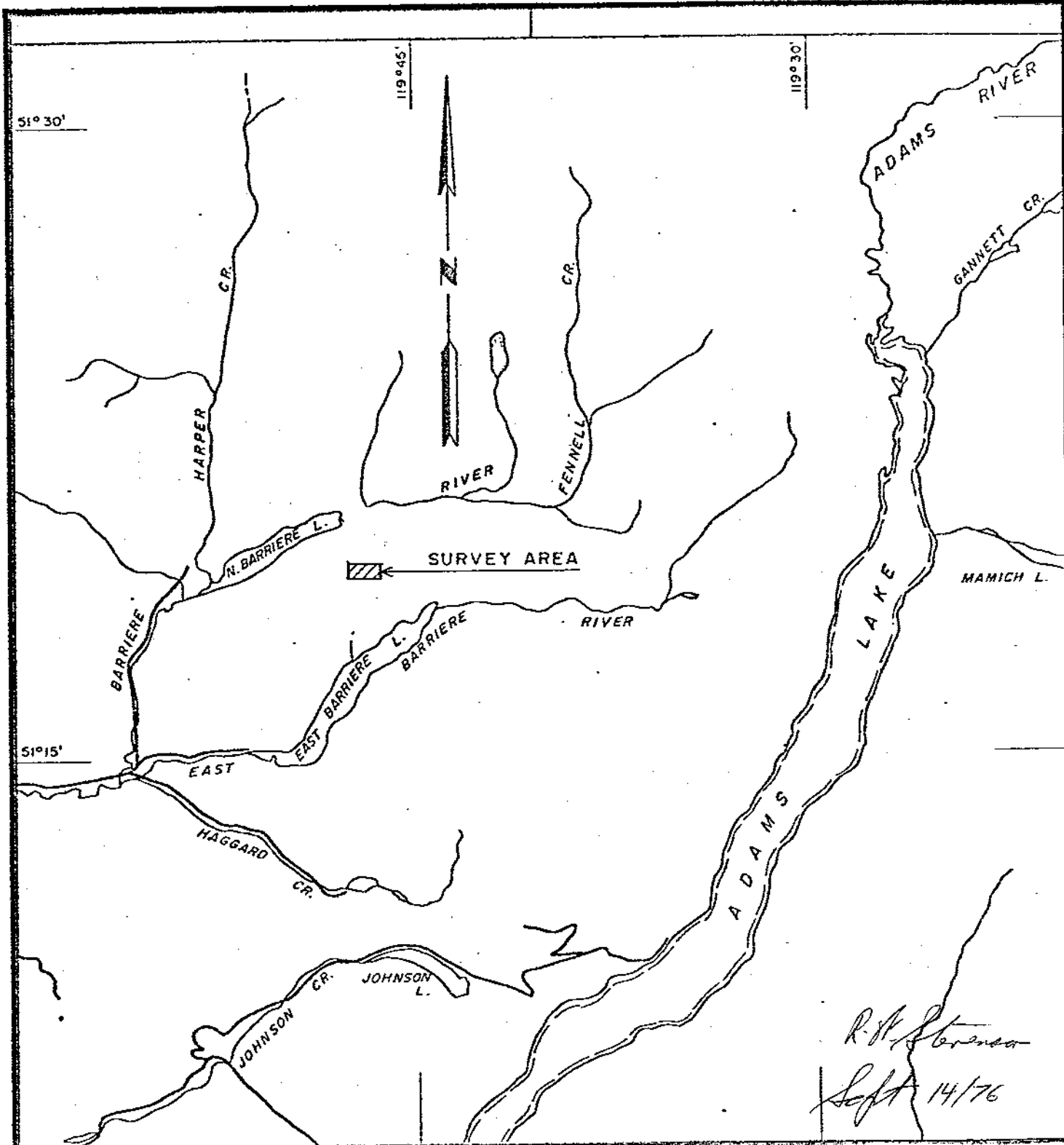

KENNCO EXPLORATIONS (WESTERN) LIMITED

LOCATION MAP
REM and EBL CLAIMS
BARRIERE LAKE IV GR.

5973

| | | | |
|------------|------------|--------------------|------------|
| DATA BY: | S. GOWER | N.T.S. 82M5W | PLY NO.: 1 |
| DRAWN BY: | DATE: 8-76 | SCALE: 1 : 250,000 | |
| TRACED BY: | DATE: | | |

CERTIFICATION

I, Stephen C. Gower of the Municipality of Coquitlam, Province of British Columbia, do certify that

1. I am a geologist residing at 987 Gatensbury Street, Coquitlam, British Columbia.
2. I am a graduate of the University of British Columbia with a Bachelor of Science degree in geology.
3. I have practised my profession for six years while in the employ of Kennco Explorations, (Western) Limited.

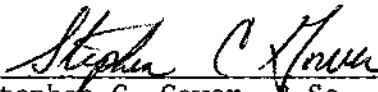

Stephen C. Gower, B.Sc.

I, Robert W. Stevenson of Vancouver, Province of British Columbia, do certify that I graduated in Mining Geology from the University of Toronto in 1952, and have practiced the profession of geology since that time. I have been registered as a Professional Engineer (Geological) in the Province of British Columbia since 1959. The work on the Barriere Lake IV Claim Group was conducted by Stephen C. Gower, Project Manager, under my supervision.

September 15, 1976

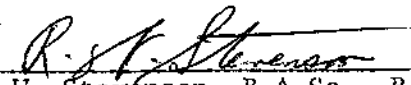

Robert W. Stevenson, B.A.Sc., P.Eng.

EXTRACTION by NITRIC and PERCHLORIC ACIDS, ANALYSED by ATOMIC ABSORPTION SPECTROPHOTOMETRY

FOR SOIL GRID LOCATION ON CLAIMS SEE PLATE 2

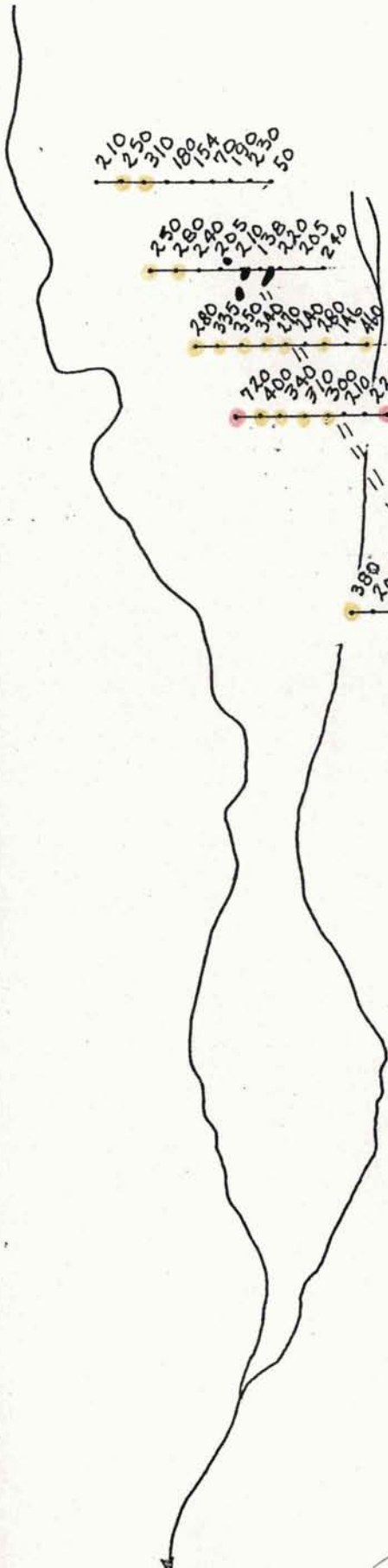

500 METERS

Suspected Strike of Mineralization

- ANOMALOUS
- WEAKLY ANOMALOUS
- SKARN ZONES EXPOSED in TRENCHES and ROAD CUTS (Pyrrhotite, Magnetite, Chalcopyrite)

#5973

KAMLOOPS MINING DIVISION

KENNCO EXPLORATIONS(WESTERN) LIMITED

BARRIERE LAKE IV GR.
REM and EBL CLAIMS
SOIL GEOCHEMICAL SURVEY
COPPER in PPM

R. A. Stevenson
8/14/76

| | | | |
|------------|----------|-------------|------------------|
| DATA BY: | S. GOWER | N.T.S 82M5W | PL. NO.: 3 b |
| DRAWN BY: | HRG | DATE: 8-76 | SCALE: 1" = 800' |
| TRACED BY: | | DATE: | |
| REVISIONS: | | FILE NO.: | |

EXTRACTION by NITRIC and PERCHLORIC ACIDS, ANALYSED by ATOMIC ABSORPTION SPECTROPHOTOMETRY

FOR SOIL GRID LOCATION ON CLAIMS SEE PLATE 2

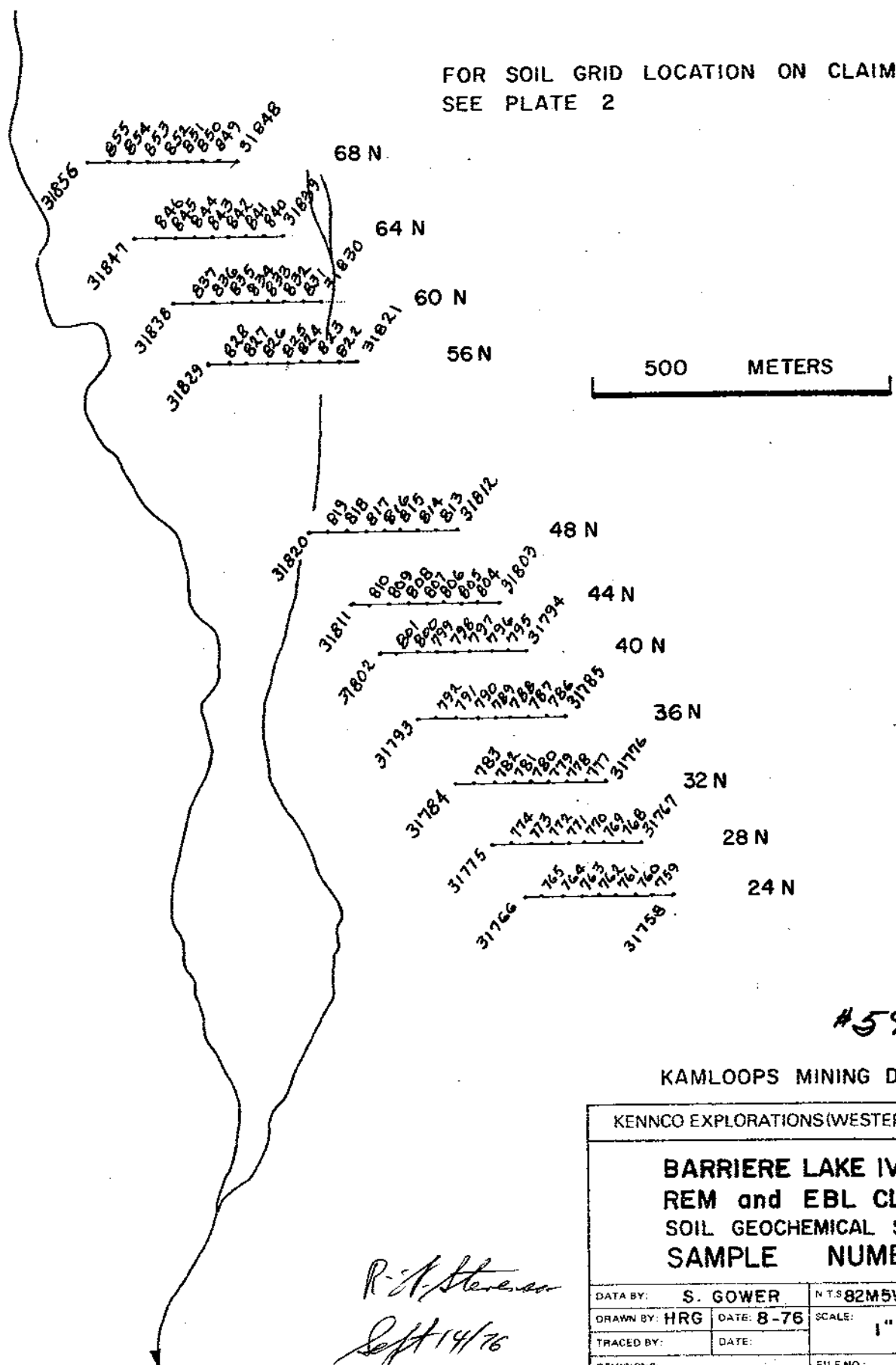

#5973

KAMLOOPS MINING DIVISION

KENNCO EXPLORATIONS(WESTERN) LIMITED

**BARRIERE LAKE IV GR.
REM and EBL CLAIMS
SOIL GEOCHEMICAL SURVEY
SAMPLE NUMBERS**

*R. A. Stevens
Sept 14/76*

| | | |
|-------------------|-------------|------------------|
| DATA BY: S. GOWER | N T S 82M5W | PL. NO.: 3 a |
| DRAWN BY: HRG | DATE: 8-76 | SCALE: 1" = 800' |
| TRACED BY: | DATE: | |
| REVISIONS: | FILE NO.: | |

EXTRACTION by NITRIC and PERCHLORIC ACIDS, ANALYSED by ATOMIC ABSORPTION SPECTROPHOTOMETRY

FOR SOIL GRID LOCATION ON CLAIMS SEE PLATE 2

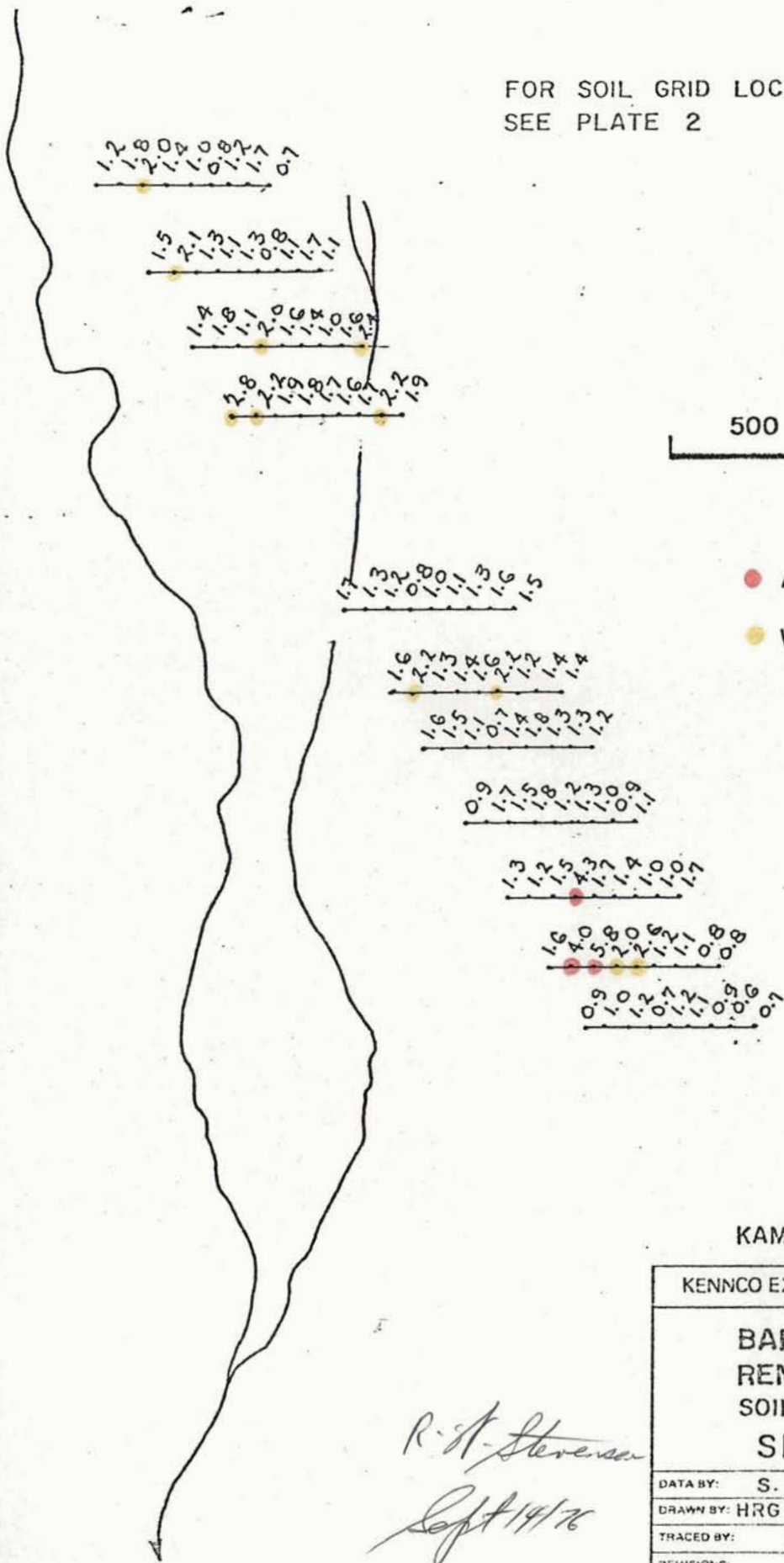

500 METERS

- ANOMALOUS
- WEAKLY ANOMALOUS

#5973

KAMLOOPS MINING DIVISION

KENNCO EXPLORATIONS(WESTERN) LIMITED

BARRIERE LAKE IV GR.
REM and EBL CLAIMS
SOIL GEOCHEMICAL SURVEY
SILVER in PPM

R. A. Stevenson
Sept 14/76

| | | |
|-------------------|-------------|------------------|
| DATA BY: S. GOWER | N.T.S 82M5W | PL. NO.: 3 e |
| DRAWN BY: HRG | DATE: 8-76 | SCALE: 1" = 800' |
| TRACED BY: | DATE: | |
| REVISIONS: | FILE NO.: | |

EXTRACTION by NITRIC and PERCHLORIC ACIDS, ANALYSED by ATOMIC ABSORPTION SPECTROPHOTOMETRY

FOR SOIL GRID LOCATION ON CLAIMS SEE PLATE 2



27 43 43 48 48 7 34 20

39 37 42 30 26 23 26

39 38 41 37 29 19 22

47 38 47 36 31 38 46 51

500 METERS

● WEAKLY ANOMALOUS

20 34 38 28 29 27 62

34 32 47 51 60 49 56 61

75 45 26 4 39 38 42 39 44

19 44 37 61 42 9 48 4 58

49 40 58 19 5 16 12 51 19 84

66 15 7 11 10 33 4 26 35

28 32 31 17 42 9 28 24 20

#5973

KAMLOOPS MINING DIVISION

KENNCO EXPLORATIONS (WESTERN) LIMITED

BARRIERE LAKE IV GR.
REM and EBL CLAIMS
SOIL GEOCHEMICAL SURVEY
LEAD in PPM

R. W. Stevenson
Sept 14/76

| | | |
|-------------------|-----------|------------------|
| DATA BY: S. GOWER | NTS 82M5W | PL NO: 3 d |
| DRAWN BY: HRG | DATE 8-76 | SCALE: 1" = 800' |
| TRACED BY: | DATE: | |
| REVISIONS: | | FILE NO.: |

EXTRACTION by NITRIC and PERCHLORIC ACIDS, ANALYSED by ATOMIC ABSORPTION SPECTROPHOTOMETRY

FOR SOIL GRID LOCATION ON CLAIMS SEE PLATE 2



34 18 81 100 71 5 81 72

68 97 89 89 89 89 61 10

90 110 68 71 04 68 58

130 100 63 78 150 130 150

71 108 110 71 135 132 120 240

98 140 230 300 94 180 380

116 154 27 162 80 96 172 184

66 118 115 250 114 202 155 115

108 110 130 240 114 162 190

168 325 310 190 178 68 85 69 78

128 98 104 92 174 102 110 71 99

500 METERS

- ANOMALOUS
- WEAKLY ANOMALOUS

#5973

KAMLOOPS MINING DIVISION

KENNCO EXPLORATIONS(WESTERN) LIMITED

**BARRIERE LAKE IV GR.
REM and EBL CLAIMS
SOIL GEOCHEMICAL SURVEY
ZINC in PPM**

*R. N. Stevenson
Sept 14/76*

| | | |
|-------------------|-------------|------------------|
| DATA BY: S. GOWER | N.T.S 82M5W | PL. NO.: 3 c |
| DRAWN BY: HRG | DATE: 8-76 | SCALE: 1" = 800' |
| TRACED BY: | DATE: | |
| REVISIONS: | | FILE NO.: |

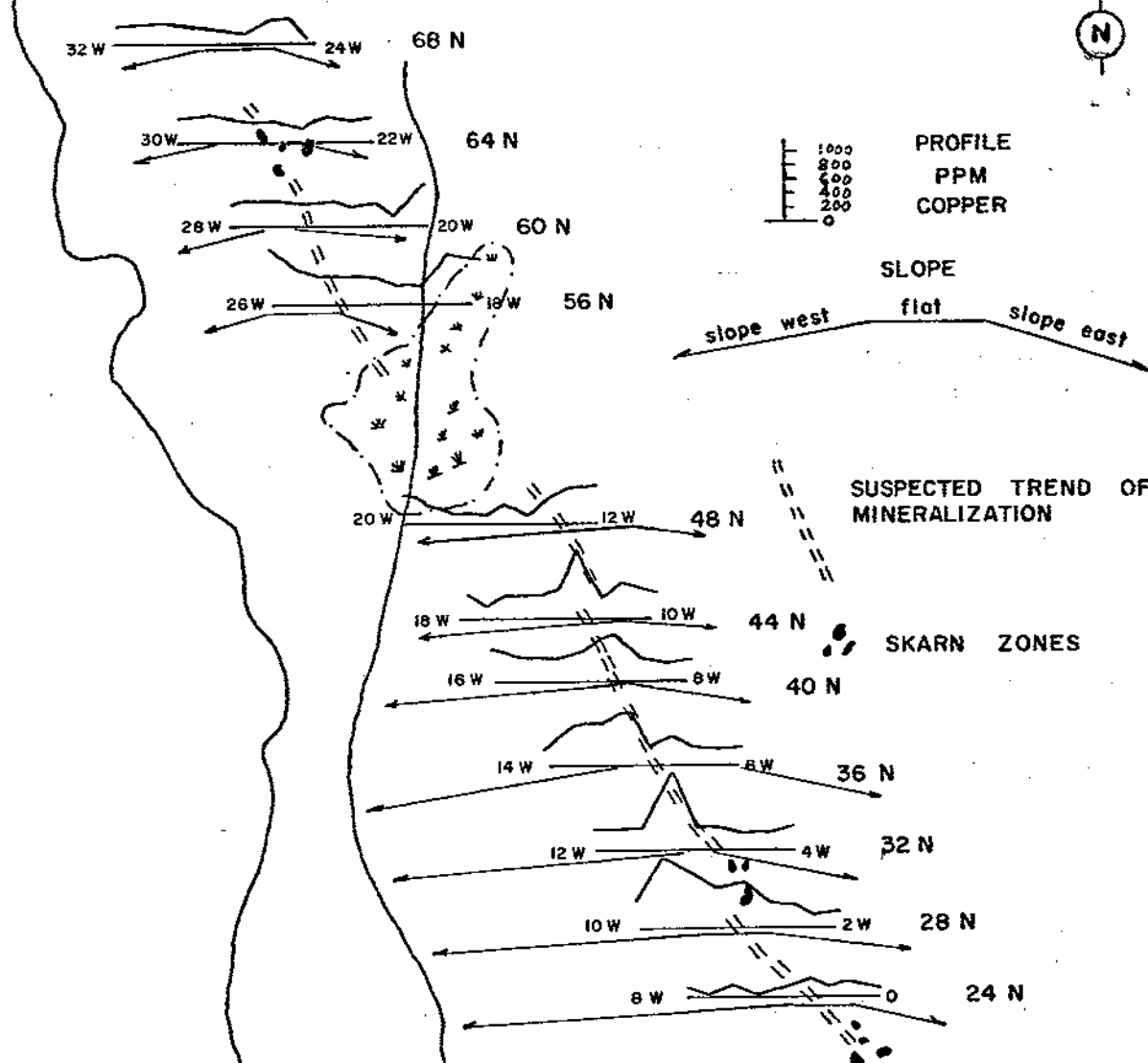

PROFILE
PPM
COPPER

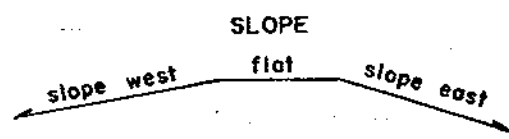

SUSPECTED TREND OF
MINERALIZATION

SKARN ZONES

500 METERS

#5973

| | | | |
|---|---------|------------|------------|
| KENNCO EXPLORATIONS(WESTERN) LIMITED | | | |
| BARRIERE LAKE IV GR. REM and EBL CLAIMS COPPER PROFILES, MINERAL TRENDS | | | |
| DATA BY: | S GOWER | N.T.S 82M | PL. NO.: 4 |
| DRAWN BY: | HRG | DATE: 8-76 | SCALE: |
| TRACED BY: | | DATE: | 1" = 800' |
| REVISIONS: | | FILE NO.: | |

R. A. Stevenson
Sept 14/76



3W, 6N

REM 19
451
MODIFIED GRID SYSTEM

3W

ROAD

14 MILES TO BARRIERE

1000 METERS

EBL 50
58284 M

EBL 55A
58291 M

EBL 29
960176

EBL 30
960177

EBL 31
960178

EBL 32
960179

EBL 37
58271 M

REM 18
947262

EBL 38
58272 M

REM 16
947264

REM 17
947261

EBL 13
901234

REM 15
947264

REM 14
947258

REM 6
905757

REM 13
947257

REM 4
905755

REM 5
905756

FOR SOIL GRID
RESULTS SEE PL. 3

REM 3
905754

EBL 16
901237

REM 1
905752

L.C.P.
REM 19

EBL 17
901238

EBL 18
901239

EBL 4
901225

EBL 6
901227

EBL 3
901224

EBL 5
901226

OUTLINE OF BARRIERE LAKE IV
GROUP

Showing
Showing

5973

M-1

Department of
Mines and Petroleum Resources
ASSESSMENT REPORT
NO. 5973 MAP #1

KENCO EXPLORATIONS (WESTERN) LIMITED

REM and EBL CLAIM MAP
BARRIERE LAKE IV GROUP

| | | |
|-------------------|---------------|------------------|
| DATA BY: S. GOWER | N.T.S. 82M 5W | PL. NO.: 2 |
| DRAWN BY: H.R.G. | DATE: 8-76 | SCALE: 1" = 800' |
| TRACED BY: | DATE: | |

R. H. Stevenson
Sept 14/76