

6048

GEOCHEMICAL REPORT

LIKE CLAIMS

CHINA MOUNTAIN PROJECT, B.C.

1976 WORK PROGRAM

JUNE 1976 - AUGUST 1976

30 MILES NE LIKELY, B.C.

LAT. $52^{\circ} 38'$ N LONG. $121^{\circ} 26'$ W

LIKE
93A/11W

OCTOBER 6, 1976

R. BUCKLEY, P.ENG.

MINERAL RESOURCES BRANCH
ASSESSMENT REPORT

NO. 6048

INDEX

	PAGE NUMBER
INTRODUCTION	1
HISTORY	1
GEOLOGY	4
GEOCHEMICAL SURVEY	5
SAMPLING METHOD	5
RECOMMENDATIONS	7
REFERENCES	8
QUALIFICATIONS	9
<i>Map #1</i> FIGURE I	POCKET
<i>#2</i> FIGURE II	POCKET

INTRODUCTION

This report summarizes a Geochemical Survey conducted over 6 mineral claims known as the China Mountain Project.

These claims, Like 1-6 inclusive, are located 7 miles north-east of Likely, B.C., or 64 miles northeast of 150 Mile House in the Cariboo District of Central B.C. The claims are located 1/2 mile north of Blackbear Creek, 2 1/2 miles east of where Blackbear Creek flows into Spanish Creek, on a mountain locally known as China Mountain.

HISTORY

Most mining operations in this portion of the Cariboo Valley consist of placer mining. However the Geological Survey of Canada Annual Report for 1887-88 by Amos Bowman (page 47) indicates that galena was found by a Mr. Moore in decomposed and rusty quartz veins near Blackbear Creek.

Work was begun on some showings in 1926 with additional work from time to time being done between 1926 and 1949 as referenced in the B.C. Minister of Mines reports.

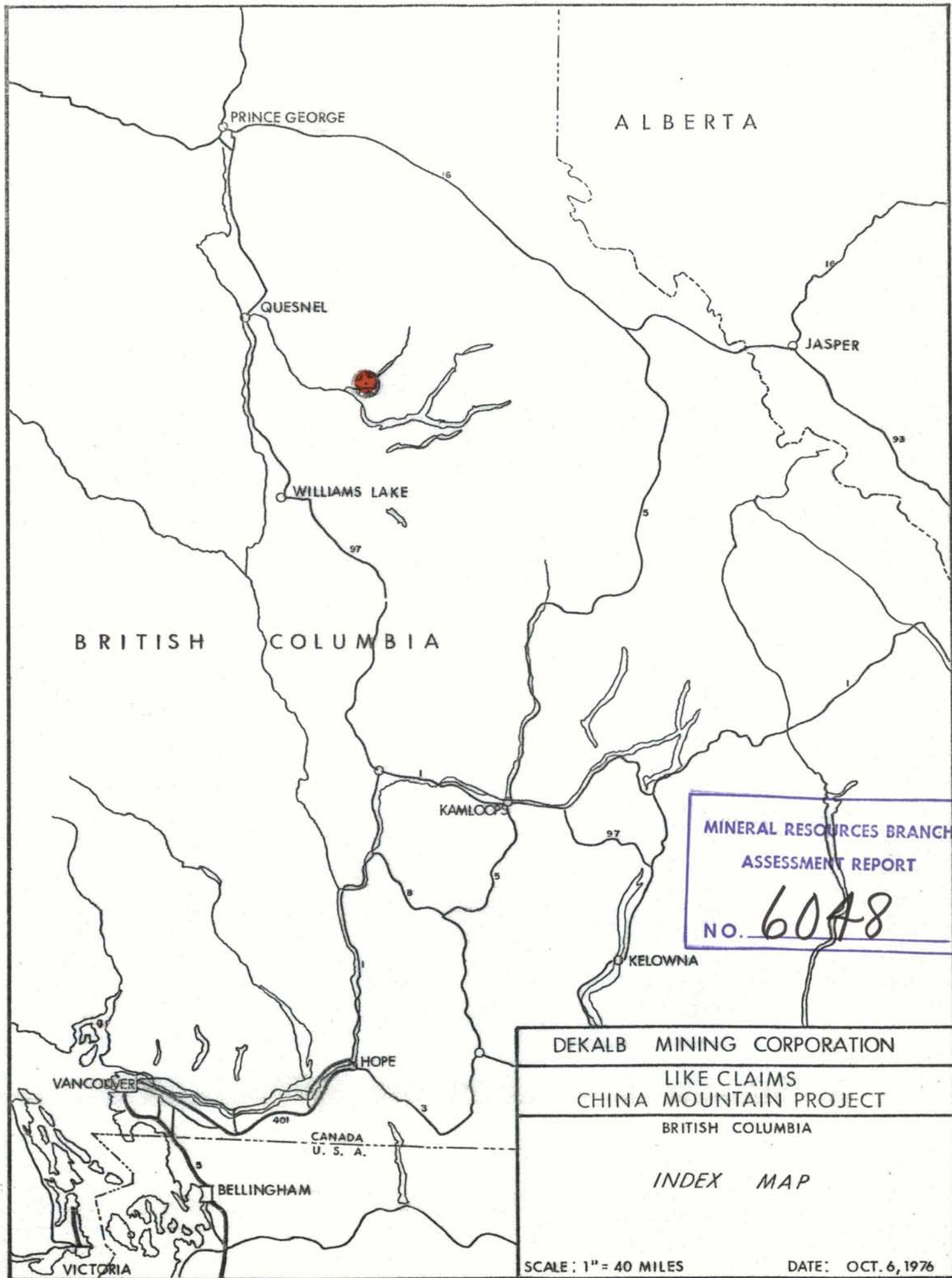

MINERAL RESOURCES BRANCH
ASSESSMENT REPORT
No. 6048

DEKALB MINING CORPORATION
LIKE CLAIMS
CHINA MOUNTAIN PROJECT
BRITISH COLUMBIA

INDEX MAP

SCALE: 1" = 40 MILES

DATE: OCT. 6, 1976

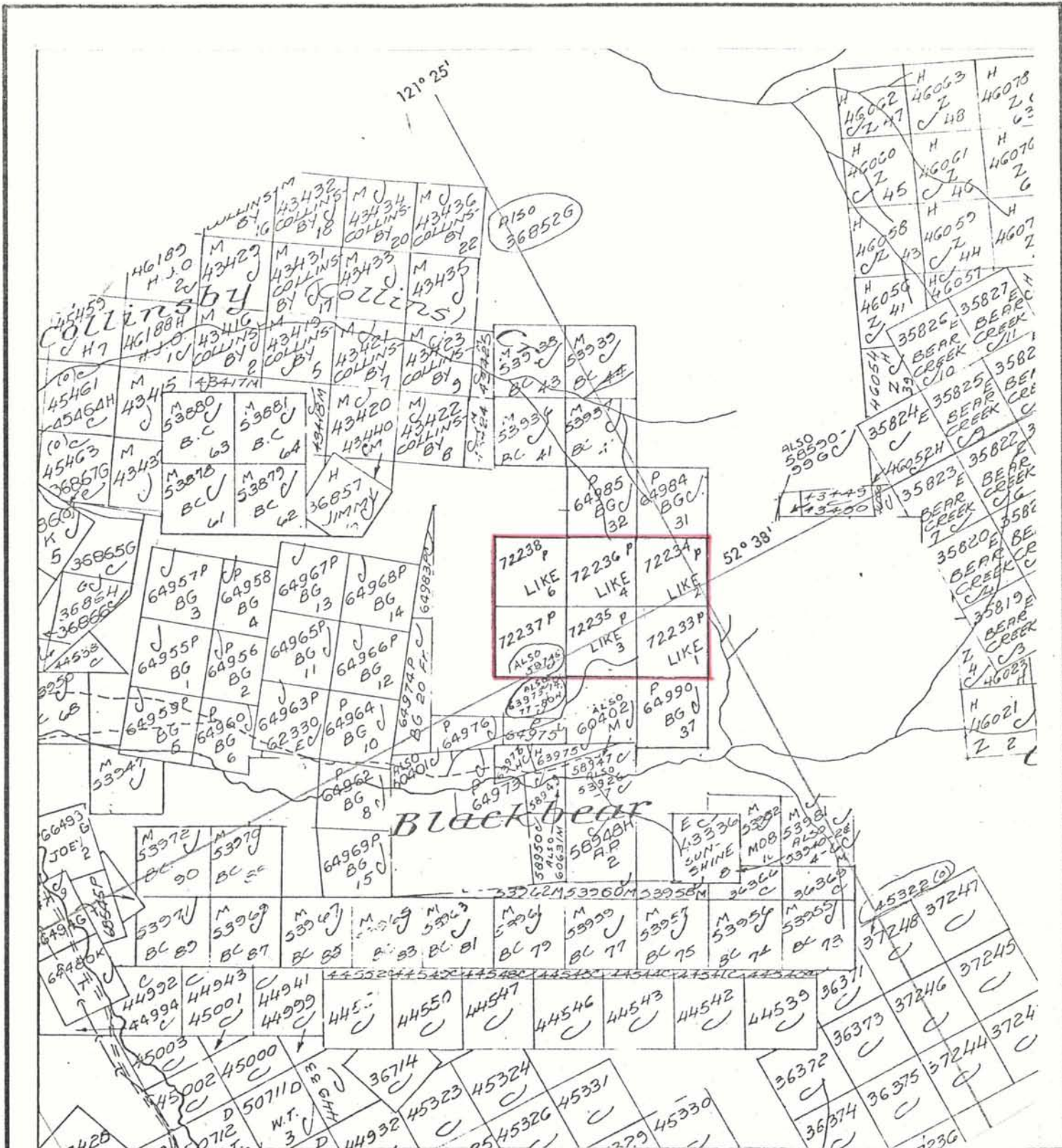

MINERAL RESOURCES BRANCH
 ASSESSMENT REPORT
 NO. 6048

DEKALB MINING CORPORATION
 LIKE CLAIMS
 CHINA MOUNTAIN PROJECT
 BRITISH COLUMBIA
 CLAIM MAP
 SCALE: 2" = 1 MILE
 DATE: OCT. 6, 1976

GEOLOGY

The area is underlain by the Cariboo Group of Cambrian Age consisting of phyllite, sericite schist and argillite. Major northwest faulting is mapped by the G.S.C. extending from Quesnel Lake to the south to about 30 miles northwest. Smaller northeast-southwest faults, mutually perpendicular to the main faulting have been mapped.

The local rock formation consists of brownish to grey phyllites and schistose rock with the schistosity striking northwest-southeast dipping at various shallow angles to the northeast.

The showings were trenched and sampled during the 1976 field season. The showings on Like 1-4 consist of weathered quartz-calcite veins. The veins strike northwest-southeast and have a shallow dip not exceeding 20° to the northeast. The veins vary in thickness between 2 to 10 feet. In certain areas the veins pinch out completely but appear again just a few feet later along strike.

Large fragments up to 1 foot of massive galena have been found in earlier years, however the mineralization noted during the 1976 season occurs either as inclusions in the quartz-calcite veins, or as fracture filling in both the white quartz vein, and along the cleavage planes of the grey pearl textured calcite.

Three separate veins occur on the property. Assays of trench samples indicates that these veins contain significant silver and lead values.

GEOCHEMICAL SURVEY

The purpose of the soil sampling was to map the lateral extensions of the vein exposures, to delineate the best locations where trenches could be excavated.

Survey lines were cut perpendicular to the vein system and soil samples collected in the usual manner, at 100 foot intervals. In order to add detail along the projected strike of the veins, the sample density was increased to 1 sample per 50 feet over the veins.

The data was plotted on a basemap and is enclosed in the pocket of this report. Anomalous high lead values have been spotted with coloured circles, while the silver values are contoured in the usual manner. This prospect is somewhat unique in that silver values from soil samples run as high as 160 ppm silver (line 2W). The prospect also exhibits silver values which are more normal background values of .2 to .5 ppm.

SAMPLING METHOD

Soil samples were collected in the normal accepted manner along previously cut survey lines, using a shovel to expose and sample the B soil horizon. The samples were then bagged and sent to a commercial laboratory for analysis. Samples from the 1976 program were sent to Min-En Laboratories Ltd., Vancouver.

The 1976 data has been combined with data from previous field

seasons. The 1972 soil samples were collected in the same manner as the 1976 program. Soil from the B soil horizon was packaged in the standard brown kraft paper bags and analysed by Bondar-Clegg Laboratories in North Vancouver. They used the -80 mesh fraction for a hot Aqua-Regid extraction followed by analysis by the Atomic Absorption method.

RECOMMENDATIONS

1. No additional geochemical surveys be conducted.
2. The prospect should be diamond drilled to evaluate the quartz-calcite veins at depth, below the oxidized zone.

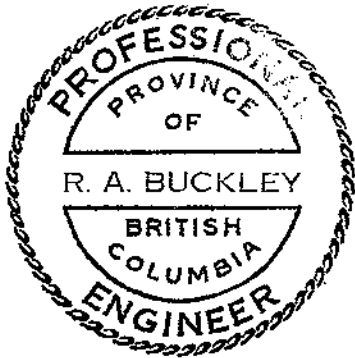

Respectfully submitted,

R. A. Buckley
R. A. Buckley, P.Eng.

REFERENCES

- Bjorkman, Victor B., Preliminary Report for Plutus Mines Ltd., near Likely, British Columbia, August 1967.
- Bjorkman, Victor B., Interim Progress Report of Plutus Mines Ltd., Cariboo District, British Columbia, April 1968.
- Campbell, R.B., Map 3-1961 (Revision of map 59-1959) Geology, Quesnel Lake, British Columbia 1" = 4 miles, G.S.C. 1961.
- Chaplin, Robert E., Blackbear Creek Silver-Lead Prospect, Cariboo Mining Division, British Columbia, November 2, 1966.
- Geological Survey of Canada, Reference Data, Bowman, Amos. Annual Report 1887-88 Vol. III Part I Report C, p. 47.
- Cockfield & Walker, Sum. Report, 1932 Part A1 pp. 76-143. Geology and Placer Deposits of Quesnel Forks Area, Cariboo District, British Columbia.
- Minister of Mines Reports, Province of British Columbia
1902 p. 86
1926 pp. 177-178
1947 pp. 127-128
1948 p. A91
1949 p. A103
- Stokes, R.B. Geochemical Report, B G Claims, October 31, 1972.
- Stokes, R.B. Summary of Geology & History. B G Claims, Likely, British Columbia. Undated.

QUALIFICATIONS

R. A. BUCKLEY

- A. I, Ronald A. Buckley, am by profession a Geologist, residing at R.R. #2, Cochrane, TOL OWO, in the Province of Alberta.
- B. I graduated in the year 1957 from Acadia University, Wolfville, Nova Scotia, with a Bachelor of Science Degree in Geology, with a minor in Chemistry and Physics.
- C. I graduated in the year 1959 from McGill University, Montreal, in the Province of Quebec, with a Master of Science Degree in Geology.
- D. Since graduation I have taken updating courses through the Department of Continuing Education at the University of Calgary in Structural Geology, Sedimentary Geology, Geochemical Surveying, Property Evaluation, Geology of Stratibound Lead Zinc Deposits, Geology of Reefs (2 courses) and Air Photo Interpretation.
- E. Since graduation, I have been employed by a Mining Company, a Provincial Department of Mines, and three Oil Companies in the search for oil, gas and metallic minerals.
- F. I am a member:

The Alberta Association of Petroleum Geologists
Mineralogical Association of Canada
Society of The Sigma XI
Canadian Institute of Mining and Metallurgy
Association of Professional Engineers of Alberta
Professional Engineers of British Columbia

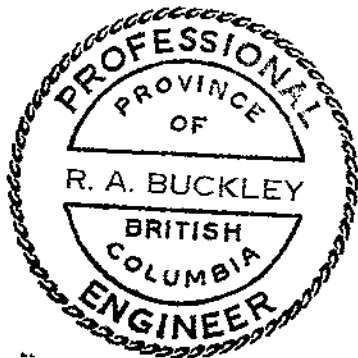

A handwritten signature in cursive script that reads "R. A. Buckley".

R.A. Buckley, B.Sc., M.Sc., P.Geol., P.Eng.

SUMMARY MANPOWER COSTS
CHINA MOUNTAIN

FIELD COSTS

R.A. Buckley	Aug. 23-26, Sept. 1	5 days @ 150	\$ 750
T. Morris	June 26-30, July 1-15	20 days @ 100	2000
N. Burhoe	Aug. 4-5	1½ days @ 60	90
R. Stokes	June 23,25-28,30 Aug.5,24-26	8½ days @ 150	1275
R. Bilquist	June 16,17,21-26	8 days @ 60	480
M. Wareing	June 21-26	6 days @ 60	360
M. Cutter	June 21-26	6 days @ 60	<u>360</u>

Total 55 man days
Total Cost \$ 5315.00

DeKalb Mining Corporation Truck and expenses 3,000 miles @ \$0.30 \$ 900.00

OFFICE COSTS

Data Interpretation, Report Preparation, Typing, Reproduction, etc.
30 man days, estimated cost \$ 4000.00

TOTAL \$10215.00

A P P E N D I X

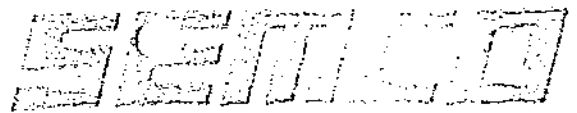

STOKES EXPLORATION MANAGEMENT CO. LTD./STE. 713 - 744 W. HASTINGS ST., VANCOUVER, B.C. V6C 1A5. TEL: 688-8541

August 12, 1976
Invoice No. 668

Dekalb Mining Corp.,
6th Floor, 630 - 6th Ave. SW.,
Calgary, Alberta T2P 0S8

REP LIKELY, B.C.

Min-En Laboratories Ltd.	\$140.80	
Min-En Lab - invoice to come	30.80	
Redhawk Rentals	117.12	
Glen White Geophysical	20.00	
Long distance calls	51.15	
Photocopying and drafting	14.16	
R.Bilquist expenses	286.86	
R.B.Stokes expenses	174.85	
Volvo rental	<u>111.45</u>	
		\$ 947.19

Plus 10%

94.72
1,041.91

Wages: Bilquist, Wareing and Chutter	900.00	
WCB, CPP, UIC and fringe benefits - 20%	<u>180.00</u>	
	1,080.00	
Engineering fees and office costs including insurance - 40%	<u>432.00</u>	
		1,512.00

R.B.Stokes to August 4th

850.00

TOTAL	\$3,403.91
Advance received	<u>3,000.00</u>
BALANCE OWING	<u>\$ 403.91</u>

STOKES EXPLORATION MANAGEMENT CO. LTD.

SOME MINOR AMOUNTS REMAIN
UNBILLED. RBS

COPY



STOKES EXPLORATION MANAGEMENT CO. LTD./STE. 713 - 744 W. HASTINGS ST., VANCOUVER, B.C. V6C 1A6, TEL: 608-8541

September 30, 1976
Invoice No. 677

Dekalb Mining Corp.,
6th Floor, 630 - 6th Avenue S.W.,
Calgary, Alberta. T2P 0S8

RE: LIKELY. B.C.

Altair Drafting Services	\$ 24.00	525
Long distance calls	10.87	535
R.B.Stokes expenses & mileage	<u>77.92</u>	521
		\$112.79
Wages: Burhoe - August 4 & 5	60.00	525
WCB, CPP, UIC and fringe benefits - 20%	<u>12.00</u>	
	72.00	541
Engineering fees and office costs including insurance - 40%	<u>28.80</u>	541
		100.80
R.B.Stokes, August 1-30 Field trip and office		<u>350.00</u> 521
		<u>\$563.59</u>
Balance owing on Inv. #668	\$403.91	
This invoice	<u>563.59</u>	
TOTAL OWING	<u>\$967.50</u>	

Handwritten notes:
No 1224
of 1224
4034

RE: \$2,000.00 Payment in 1975

Disbursed as follows:

Paid Mine Recorder re Likely Claims	\$1,320.00	521
Long distance calls	27.37	521
R.B.Stokes time charged to project	500.00	521
Office overhead & secretarial	<u>152.63</u>	541
	<u>\$2,000.00</u>	

STOKES EXPLORATION MANAGEMENT CO. LTD.

Handwritten signature:
R. Stokes

DEKALB MINING CORPORATION
 DEKALB MINING CORP. CHINA MOUNTAIN

10/31/76

P E COMMENCED
 P E COMPLETED

COMPANY # 100.00000
 P E NUMBER 4034

DESCRIPTION	PRIOR YEAR	CURR YEAR	TOTAL	ESTIMATE	VARIANCE
CLAIM ACQUISITION COSTS		3,000	3,000		3,000
ANNUAL WK RECORDING FEE	60	1,530	1,590		1,590
CONT LINE CUTTING COSTS	500		500	500	
BULLDOZING AND CLEANUP	1,909	328	2,237	1,300	737
CONT GEOCHEMICAL CHGES	1,000		1,000	1,000	
PROCESSING AND INTERPR	400		400	1,000	600-
CONSULTANT FEES		928	928	500	428
CO PERSONNEL & TRAVEL	1,614	956	2,570	500	2,070
DRAFTING AND REPROD.		84	84		84
COMMUNICATIONS		11	11		11
OVERHEAD		625	625		625
MISCELLANEOUS		13	13		13
CORE ASSAYING	173	25	198		198
PROJECT EXPENDITURES	5,656	7,500	13,156	5,000	8,156
COMPANY NET INTEREST	5,656	6,544	12,200	5,000	

DEKALB PETROLEUM CORPORATION
MONTHLY TIME ALLOCATION AND ATTENDANCE RECORD

September 4
September 13

DEPARTMENT: 941 MONTH OF: September 1976 EMPLOYEE: R. A. Buckley

(Please use check mark or "V" for Vacation
"S" for Sick

DATE	CALGARY OFFICE		FIELD AND/OR LOCATION OUT OF TOWN AREA OR A.M. P.M. OTHER CITY			VACATION OR SICK	DEPT	MINING	
	A.M.	P.M.	A.M.	P.M.	OTHER CITY			DKM	DM
1			✓	✓	B.C.?				✓
2	✓	✓						✓	
3	✓	—							✓
4	SATURDAY								
5	SUNDAY								
6	LABOUR DAY		(office closed all day)						
7	✓	✓						✓	
8	✓	✓						✓	
9	✓	✓						✓	
10	✓	✓							✓
11	SATURDAY								
12	SUNDAY								
13	✓	✓						✓	
14	✓	—	funeral in pm						✓
15	✓			✓	Jubilee				✓
16			✓	✓	Jubilee				✓
17			✓	✓	Jubilee				✓
18	SATURDAY								
19	SUNDAY								
20	✓	✓							✓
21	✓	✓							✓
22	✓	✓							✓
23	✓	✓							✓
24	✓	✓							✓
25	SATURDAY								
26	SUNDAY								
27	✓	✓							✓
28	✓	✓							✓
29	✓	✓							✓
30	✓	✓							✓

DEKALB
RECEIVED
OCT 5 1976
CANADIAN OIL DIVISION

MINING

APPROVED BY: R. A. Buckley
Manager of Department

[Signature]
Employee's Signature

DEWAS PETROLEUM CORPORATION
 MONTHLY WAGE ALLOCATION AND ATTENDANCE RECORD

Aug. 7/76
 Aug. 21/76

EMPLOYEE NO: 941 MONTH OF: AUGUST 1976 EMPLOYEE: R. A. Buckley

Number of days: 21 of "V" for Vacation
 or "S" for Sick

DATE	EMPLOYEE SPECIAL LEAVE AND VACATION		LOCATION				MINING	
	AM.	PM.	OUT OF TOWN	AREA OR OTHER CITY			DKM	DMK
SUNDAY								
MONDAY	Calgary Civic Holiday - office closed all day							
			✓	✓		4033		✓
			✓	✓		"		✓
			✓	✓		"		✓
			✓	✓		"		✓
SATURDAY			✓	✓		"		✓
SUNDAY								
			✓	✓		4033		✓
	✓	✓				4033		✓
	✓	✓				Gravity Jubilee Mt. 4032		✓
	✓	✓				General		✓
	✓					General		✓
SATURDAY								
SUNDAY								
			✓	✓		Dillion 4033		✓
			✓	✓		JUBILEE mt.		✓
	1/2 ✓	1/2 ✓	✓	✓		OK Sign.	✓	
			✓	✓		OK Sign.	✓	
			✓	✓		OK Sign.	✓	
SATURDAY				✓	CHINA mt.	JUBILEE mt.		✓
SUNDAY			✓			JUBILEE mt.		✓
			✓	✓	overhead account	China Mt. mt.		✓
			✓	✓		"		✓
			✓	✓		"		✓
			✓	✓		"		✓
	✓	✓				General		✓
SATURDAY								
SUNDAY								
	✓	✓				1/2 Ethc Dept. (Vancouver)		✓
	✓			✓		General admin		✓
				✓		China Mt.		✓

MINING

APPROVED BY: R. A. Buckley
 Manager of Department

Employee's Signature

TIME, MILEAGE AND EXPENSE REPORT

PAID TO

Unit No. _____
 Mileage 25800
 STOP 52700
 START 23930
 MILEAGE 1950
 COMPANY CREDIT CARD CHGS.

NAME Jerry Morris

ADDRESS General Delivery MONTH OF June 16-30 1976

Lively, B.C.

TIME AND MILEAGE REPORT

EXPENSE REPORT

Date	From -	To -	Mileage	Charge Battery or Location	Meals		Lodging		Misc.		Description	Total		Description	Total		
					\$												
16					\$	20.00			13	15	Chassis, repairs, wheelbarrow, rope	13	15				
17				June 16-25		20.00								Cash	13	50	
18						20.00									Cash	7	55
19	4032	509				20.00									Cash	7	00
20						20.00											
21						20.00									Cash	12	50
22						20.00									Cash	7	00
23						20.00										10	25
24						20.00									Cash	12	50
25						20.00									Cash	1	50
26						20.00									Cash	7	50
27					20.00									Cash	9	70	
28	4034	520			20.00				5	00	Cash (pd. cash)	5	00		12	15	
29					20.00				6	00	Cash (pd. cash)	6	00		11	50	
30					20.00										8	70	
TOTALS					\$	300.00			24	15		TOTAL EXPENSES	\$	324.15	TOTAL	130.05	

Distribution of Mileage: Company _____ Personal _____

LESS ADVANCES _____
 NET AMOUNT PAYABLE _____

ATTACH COPIES OF ALL CREDIT CARD CHARGES

J. Morris
 Signature

[Signature]
 Approved

8509

6048

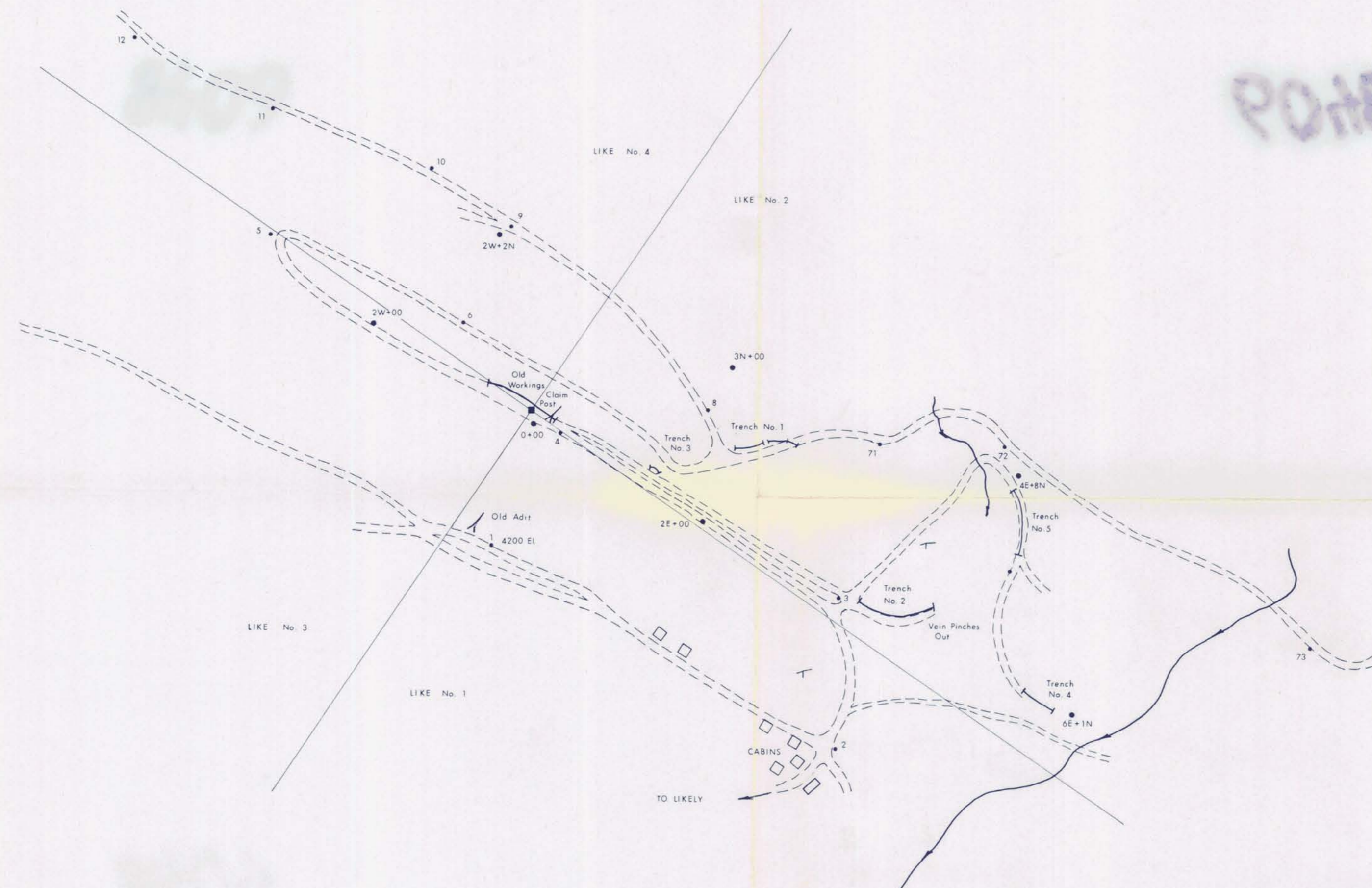

MINERAL RESOURCES BRANCH
 ASSESSMENT REPORT
 NO. 6048
 MAP NO. #1

LEGEND

- PREVIOUS GEOCHEMICAL STATIONS
- RECENT TRENCHES
- ROADS
- ~ CREEK



TO ACCOMPANY GEOCHEMICAL SURVEY OF LIKE CLAIMS
 REPORT BY *R. A. Buckley* DATED OCT. 7, 1976
 R. A. BUCKLEY P. ENG.

DEKALB MINING CORPORATION
LIKE CLAIMS
 CHINA MOUNTAIN PROSPECT
 BRITISH COLUMBIA
 TRENCHING PROGRAM
 1976

Oct. 1976 1" = 100' T. MORRIS

6048

6048

FIGURE I

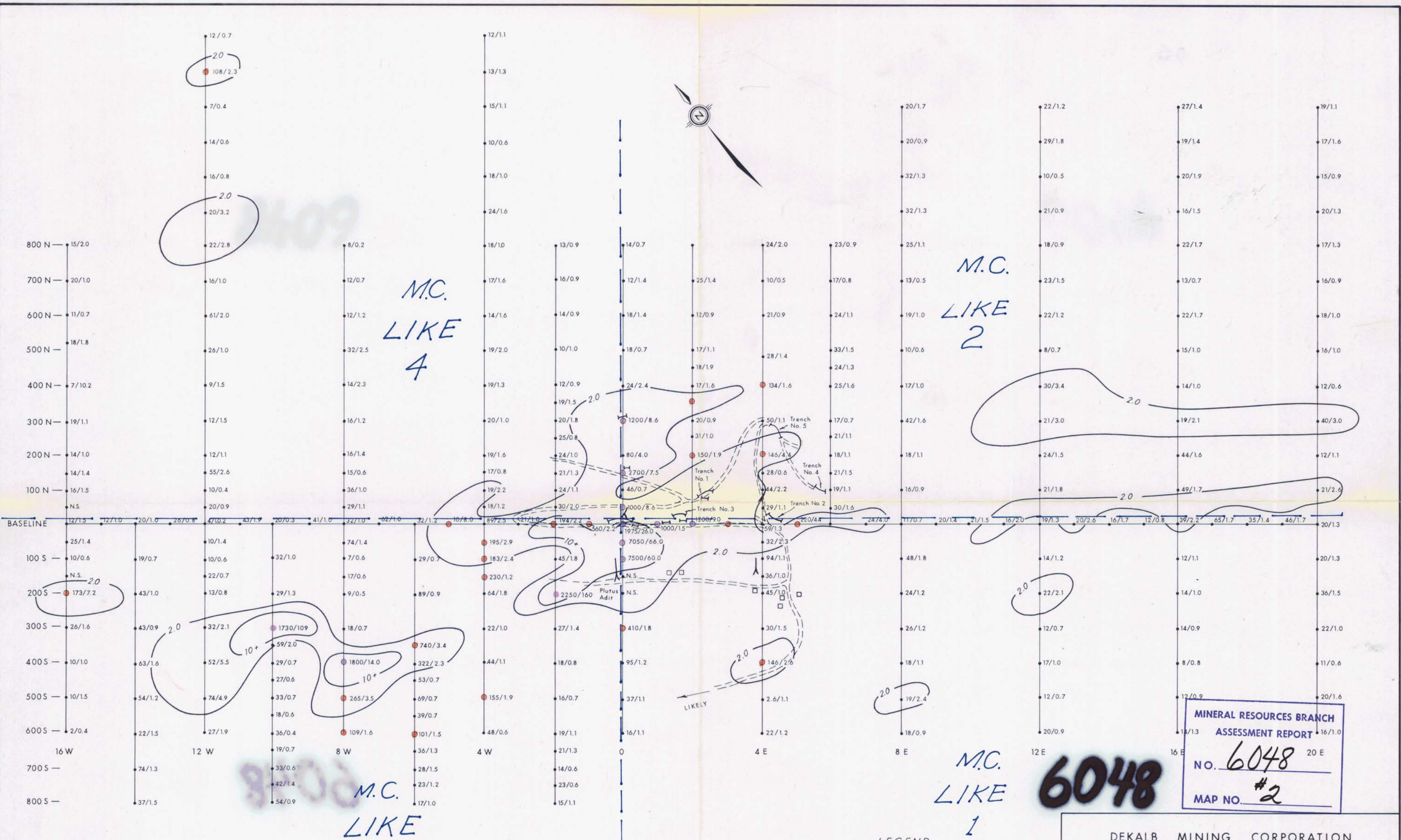

MINERAL RESOURCES BRANCH
ASSESSMENT REPORT
NO. 6048
MAP NO. #2

6048

M.C. LIKE 1

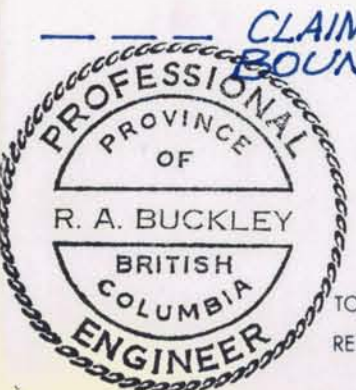

LEGEND

- COLOUR CODE
- 100 - 1000 LEAD
- 1000 + LEAD
- BACKHOE TRENCHES
- 'STOKES' HAND TRENCHES
- 19/1.1 PPM LEAD / PPM SILVER

TO ACCOMPANY GEOCHEMICAL SURVEY OF LIKE CLAIMS
REPORT BY R. A. BUCKLEY DATED OCT. 7, 1976
R. A. BUCKLEY P. ENG.

DEKALB MINING CORPORATION
LIKE CLAIMS
CHINA MOUNTAIN PROSPECT
BRITISH COLUMBIA
GEOCHEMICAL SOIL SURVEY
CONTOUR DATA - PPM SILVER
SOURCE OF DATA : STOKES EXPLORATION MANAGEMENT
Oct. 1976 1" - 200' R. BUCKLEY P. ENG.

FIGURE II