



PETRA GEM EXPLORATION of CANADA LTD.

3540 West 41st. Ave., Vancouver, B.C. V6N 3E6
BUS 263-2678 RES 733-6902

6068

DRILLING REPORT "OGDEN" CLAIMS
OGDEN MTN., OMINECA MINING DIST.
MAPSHEET P93N/13W, 55 52N/125 54W.

OGDEN

BY: B.J. PRICE, M.Sc., F.G.A.C.

FOR: FAR NORTH JADE LTD.
200 - 3540 W.41 AVE.
VANCOUVER, B.C.

93N/13W

NOVEMBER 23, 1976.

MINERAL RESOURCES BRANCH
ASSESSMENT REPORT
NO. <u>6068</u>



DRILLING REPORT - "OGDEN" CLAIMS

INTRODUCTION:

During the period July 25 to October 4, 1976, a crew averaging 4 men completed 454.8 feet of drilling on the "Ogden" 5 and 7 claims owned by Far North Jade Ltd.

LOCATION AND ACCESS:

Mt. Ogden is located in the Omineca mountains, approximately 195 air-miles north-west of Prince George, and 90 miles north-east of Smithers, B.C. The property is located on the north-west slope of the mountain, and is most easily reached by helicopter from Germansen Landing, 50 miles southeast, although a cat-road does lead to the property from a secondary road at Fall River, 20 miles south. Supplies and personnel were mobilized from Watson Lake in the Yukon, although normally, supply flights originate in Smithers.

CLAIMS:

The property includes 34 grouped claims, shown on the following page. A complete list of claims is given in the appendix. Work was done on a small area at the boundary of Ogden 5 and 7 claims.

WORK PROGRAM - 1976:

During the period July 25 to October 4, 1976. a drilling crew under the supervision of foreman Gerd Erasmus and sub-foreman Peter Howard completed 454.8 feet of "packsack" (XRPS) size diamond drilling in 152 holes in 87 separate jade masses, some of which had been drilled previously. Work was done by Nephro Jade Canada Ltd. for the owner, Far North Jade Ltd. A complete list of drilling data is provided in the appendix.

Drilling costs are higher than for other materials because of the tough finely-crystalline nature of jade. Complete cost data are provided. All material drilled was jade; no drill logs were made because of this. Core is stored at the company office in Vancouver.

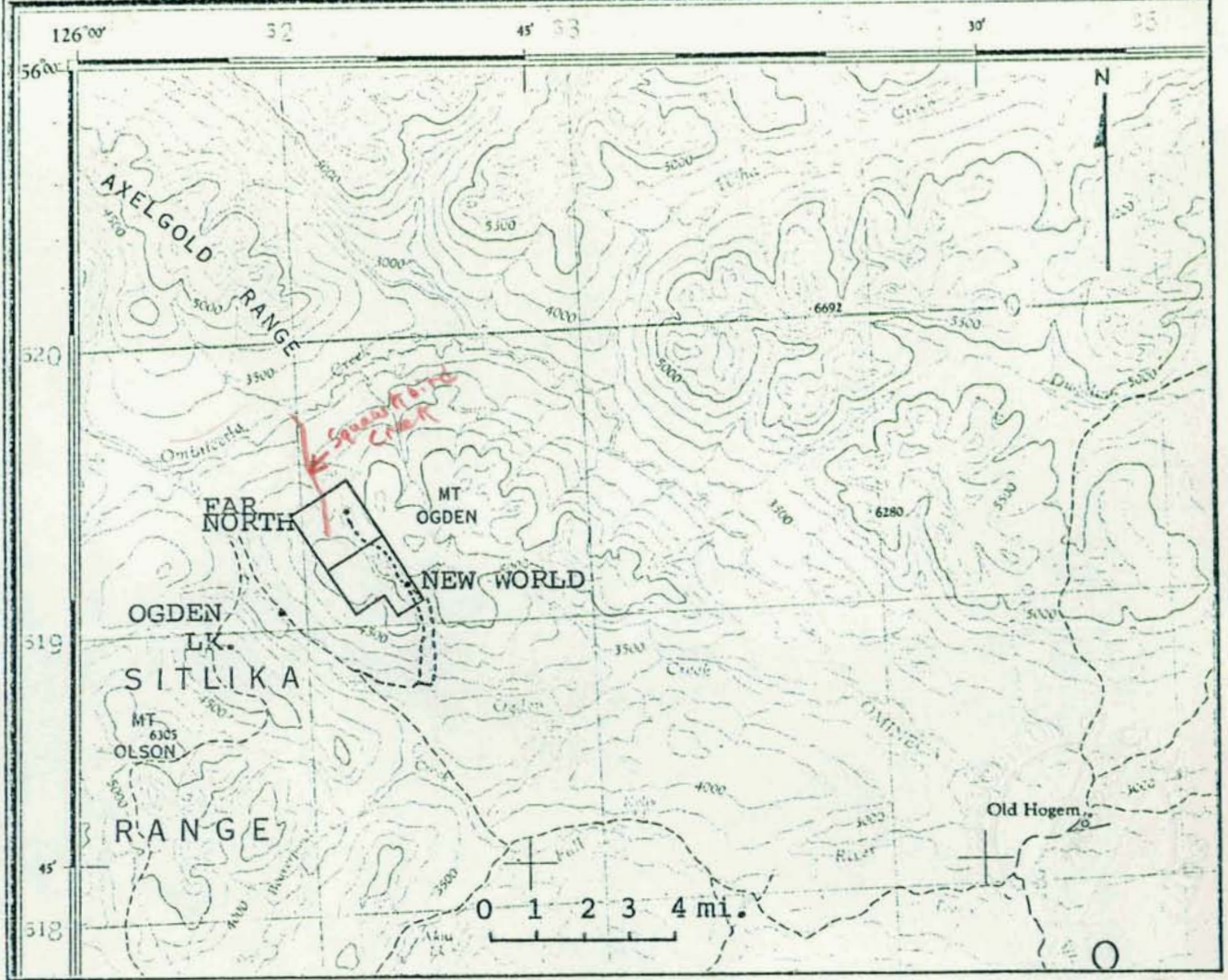

FIG. 1 . Map of Mt. Ogden area showing location of New World Jade and Far North Jade camps.

MINERAL RESOURCES BRANCH
ASSESSMENT REPORT

NO. 6068

*No. 23176
Barry Price*

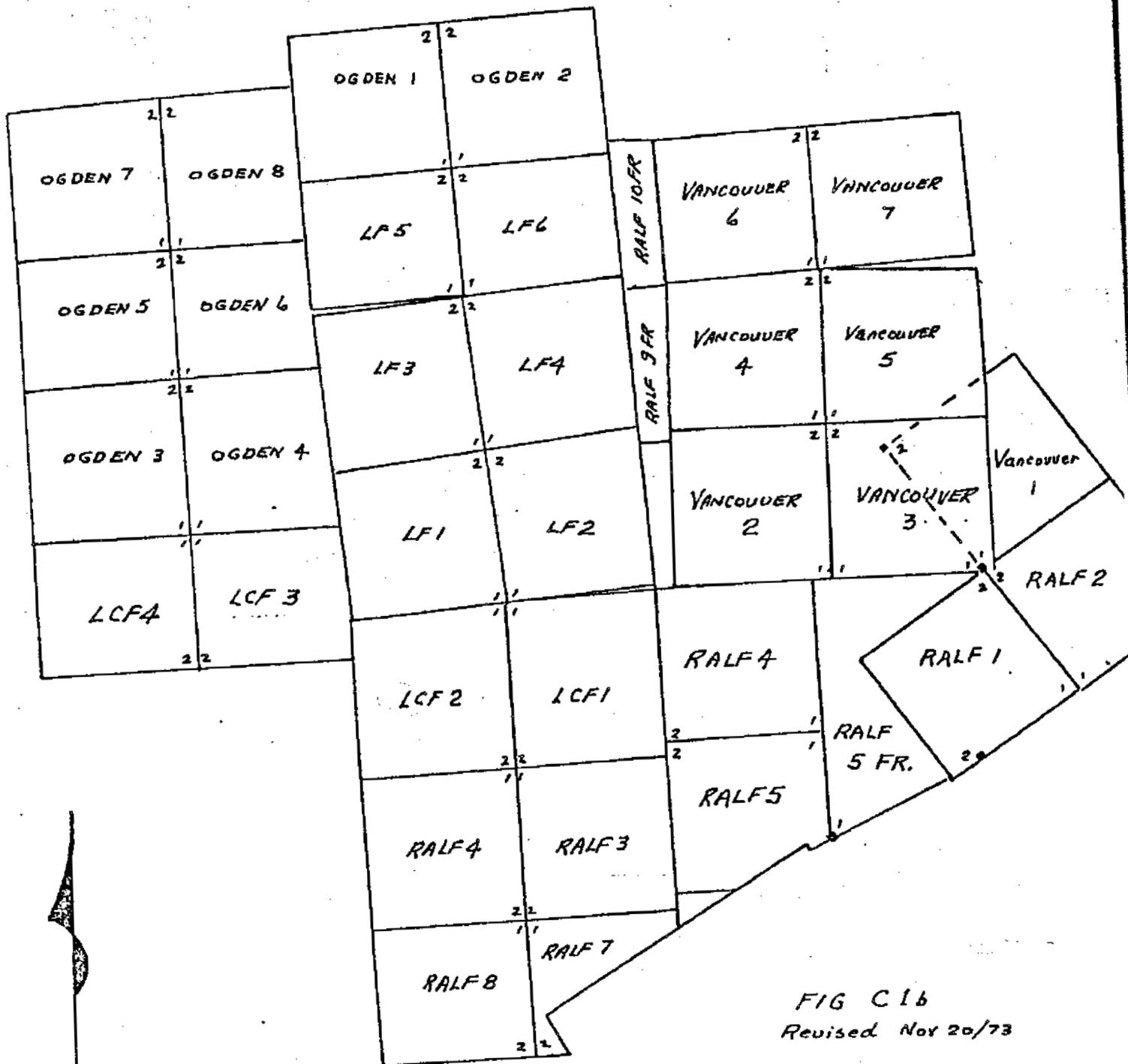

FIG C16
Revised Nov 20/73

FAR NORTH JADE LTD

SKETCH MAP OF CLAIMS
MT OGDEN

SCALE 1IN: 1500FT.

MINERAL RESOURCES BRANCH
ASSESSMENT REPORT
NO. 6068

Nov 23/76
Sam Price

MANEX MINING LTD
M.J. BELEY / B. PRICE

DRILLING EXPENSES - OGDEN MTN. 1976

1. WAGES:

<u>EMPLOYEE</u>	<u>POSITION</u>	<u>RATE</u>	<u>DATES</u>	<u>AMOUNT</u>
Gerd Erasmus	Foreman	\$2000/mo	july 25- sept 6	\$1944.76
Peter Howard	Foreman Driller	\$1500/mo	july 25- sept 6	\$2823.70
Janet Erasmus	Driller	\$1250/mo	aug 1- sept 6	\$1240.00
John Hilchey	Driller	\$1250/mo	july 25- sept 6	\$2097.50
Richard Beketa	Driller	\$1250/mo	july 25- sept 1	\$1689.50
Dan Clozza	Driller	\$1250/mo	july 25 - sept 1	\$1674.35
Ron George	Driller	\$1500/mo	sept 1- oct 4	\$2229.20
Rob Fejeller	Driller	\$1500/mo	sept 1- oct. 4	\$1957.80
Mark Kaarremaa	Driller	\$1500/mo	sept 4- oct 4	\$1500.00
Len Rae	Supervisor	\$2000/mo	sept 4- oct 4	\$1266.66
Barry Price	Geologist	\$150/day	aug 11- aug 14 nov 22,23	\$ 900.00
TOTAL WAGES				\$19323.47

2. SUPPLIES:

<u>Air Support:</u>	Okanagan Helicopters Ltd.	\$6672.88
	Watson Lake Flying Service	\$5656.50
	Trans Provincial Air	\$2246.50
	Columbia Air Services	\$ 318.75

DRILLING STATISTICS - 1976

No. of Boulders Drilled	87
No. of Holes Drilled	152
Total Footage Drilled	454.8 ft.
Tonnage Evaluated	1575 tons
Total drilling cost	\$50635.88
Drilling Cost per foot	\$ 111.34

Barry Price
Barry Price, M.Sc.
Geologist.



DRILLING DATA SHEET

FAR NORTH CAMP

BOULDER	DIMENS.	SIZE TONS	HOLES	INCHES DRILLED	COMMENTS
76-1		12.0	1	21 1/2	
76-2		1.8	1	17 1/2	
76-3		3.6	1	35	
76-4		1.6	1	24	
76-5		9.8	1	18	
76-6		10	1	23 1/2	
76-7		6	1	25	
76-8			2	25 1/2	
76-8		50	1	27	
76-9		20	1	61 1/2	
			2	46	
			3	52	
			4	46 1/2	
76-10		1.5	1	61	
76-11		16.5	1	47	
76-12		2.5	1	23	
76-13		10.2	1	45	
			2	25 1/2	
			3	65	
76-14		6 1/4	1	19	
* 76-15		10.8	1	27	2 marked.
76-16		10.5	1	35 1/2	
* 76-17		10	1	34 1/2	* Two boulders marked.
			2	11	
76-18		3	1	32 1/2	
76-19		6	1	24 1/2	
76-20		13.7	1	47	
76-21		64	1	48	
			2	49	
			3	59.5	
76-22		12	1	46.5	
			2	36	
76-23		4.5	1	22.5	
TOTALS					



DRILLING DATA SHEET

FAR NORTH CAMP

BOULDER	DIMENS.	SIZE TONS	HOLES	INCHES DRILLED	COMMENTS
76-43		14.4	1	38	
			2	43	
			3	26 1/2	
76-44		130	1	96 1/2	
			2	15	
76-45	?				
76-46		17.5	1	65 1/2	? Records not clear
			2	35 1/2	? "
			3	47	? "
76-47		6.4	1	45	
76-48		100	1	53	
			2	49	
			3	18	
* 76-48		1.2	1	16	2 marked.
76-49		18	1	31 1/2	
			2	52	
			3	69	
			4	50	
76-50		12	1	32 1/2	
			2	13	
76-51		3	1	46 1/2	
76-52		25	1	25	
			2	50	
			3	12	
76-53		300 lb	1	28 1/2	
76-54		180 lb	1	18	
76-55		120 lb	1	15	
76-56		400 lb	1	25	
76-57		120 lb	1	26	
76-58		2.4	1	26	
76-59		4	1	22 1/2	
76-60		3.5	1	57	
* 76-60		13.7	1	60"	* 2 marked.
TOTALS					



DRILLING DATA SHEET

FAR NORTH CAMP

BOULDER	DIMENS.	SIZE	TONS	HOLES	INCHES DRILLED	COMMENTS
76-60				2	48 1/2	
76-61		28.4		1	45 1/2	
				2	40	
				3	36	
				4	38.5	
76-62		30		1	21 1/2	
				2	41	
				3	85	
76-63		600lb.		1	11	
76-64		3.75		1	29	
76-65		8		1	43	
				2	27	
76-66		600lb.		1	12	
*76-66		100lb		1	4	* 2 marked.
76-67 ?						
76-68 ?						
76-69 ?						
76-70		17.5		1	36	
				2	33	
76-71		9.6		1	20	
				2	30	
76-72		0.4		1	19	
76-73		1		1	17	
76-74 ?						
76-75		100		1	65	
				2	15	
				3	59	
				4	12	
				5	12	
*76-75		2		1	20	* 2 marked.
76-76		6		1	30	
				2	22	
76-77		200lb		1	4	
TOTALS						



DRILLING DATA SHEET

FAR NORTH CAMP

BOULDER	DIMENS.	SIZE TONS	HOLES	INCHES DRILLED	COMMENTS
76-78		100lb	1	3"	
76-79					
76-80		4.8	1	29	
			2	17	
76-81		15	1	55 ?	Records not clear
			2	35 1/2	" "
			3	53 1/2	" "
76-82		4.5	1	33 1/2	
			2	32	
76-83		3.6	1	21	
			2	22 1/2	
76-84		6	1	37	
			2	29	
76-98		0.5	1	6"	
76-101		20	1	38 1/2	
76-103		?	1	60	
76-110		750lb	1	15	
76-111		800lb	1	11	
76-112		2	1	28	
76-113		1.6	1	51	
76-114		?	1	33 1/2	
T-12		?	1	86	
T-13		16 1/2	1	56	
Black Jade		200lb	1	12"	
*76-15		4.8	1	40 1/2	
			2	35 1/2	
			3	37	
*76-17		4T	1	19	
			2	25	
TOTALS					

QUALIFICATIONS

NAME: Barry James Price.

BORN: Smithers, B.C., August 19, 1944.

EDUCATION:

- A) High school: Smithers, B.C. Graduated 1961.
- B) University: B.Sc. Honors Geology 1965, Thesis topic:
(U.B.C.) "Tertiary Sediments at Driftwood
Creek, Smithers Map Area, B.C."
M.Sc., Geology, 1972, Thesis topic:
"Minor Elements in Pyrite and
Exploration Applications of
Minor Element Studies."

EMPLOYMENT RECORD:

- 1964, (summer): GEOLOGICAL SURVEY OF CANADA., junior assistant, mapping party in Rocky Mts., supervised by Dr. G.B.Leech.
- 1965 - 1968 CHEVRON STANDARD LTD., Alberta. Senior assistant, regional mapping party in Mackenzie and Richardson Mts. Subsurface geological studies, carbonate reef research, wellsite supervision and production department studies.
- 1968 (summer) MANEX MINING LTD. Smithers, B.C. Geological mapping and diamond-drill supervision.
- 1969 (summer) MANEX MINING LTD. Smithers, B.C. Property mapping and evaluation, geophysical and geochemical studies, supervision of diamond drilling, geological mapping for Jade Queen Mines Ltd.
- 1970 (summer) ARCHER, CATHRO AND ASSOC., Party chief, regional study of sedimentary copper potential of Mackenzie Mts. Reconnaissance mapping and geochemical interpretation.
- 1971 (summer) J.R. WOODCOCK CONSULTANTS LTD., Project geologist in charge of exploration of massive sulphide prospect, including geological mapping, geochemistry, geophysics, and diamond drilling. Concurrently supervised regional exploration program.

1972 - 1974

MANEX MINING LTD., Vancouver, Geologist in charge of field projects. Consulting geological work for New World Jade Ltd., and Delphi Resources Ltd.

1974 - 1976

Manex Mining Ltd., Geologist in charge of field projects. Consulting geologist for Delphi Resources Ltd., Territorial Gold Placers Ltd., Nephro-Jade Canada Ltd.

1976

Petra Gem Exploration Ltd. Geological Consulting.

1975

Elected Fellow, Geological Society of Canada.

<u>Placer Mining Lease Number</u>	<u>Date Lease Granted</u>	<u>Term</u>	<u>Work Recorded to</u>	<u>Rental Paid to</u>
1909	14 Jan 69	20 yr	13 Jan 77	13 Jan 72
1910	14 Jan 69	20 yr	13 Jan 77	13 Jan 72
1911	14 Jan 69	20 yr	13 Jan 77	13 Jan 72
1956	30 Oct 69	20 yr	29 Oct 76	29 Oct 72
1957	30 Oct 69	20 yr	29 Oct 76	29 Oct 72
1958	30 Oct 69	20 yr	29 Oct 76	29 Oct 72

<u>Name of Mineral Claim</u>	<u>Recorded</u>	<u>Work Recorded to</u>	<u>Record Number</u>
LF #1	6 Aug 69	6 Aug 75	79755
LF #2	6 Aug 69	6 Aug 75	79756
LF #3	6 Aug 69	6 Aug 75	79757
LF #4	6 Aug 69	6 Aug 75	79758
LF #5	6 Aug 69	6 Aug 75	79759
LF #6	6 Aug 69	6 Aug 75	79760
LF #7	8 Oct 69	8 Oct 73	81070
LF #8	8 Oct 69	8 Oct 73	81071
LCF #1	2 Sep 69	2 Sep 73	79871
LCF #2	2 Sep 69	2 Sep 73	79872
LCF #5	8 Oct 69	8 Oct 73	81064
LCF #6	8 Oct 69	8 Oct 73	81065
LCF #7	8 Oct 69	8 Oct 73	81066
LCF #8	8 Oct 69	8 Oct 73	81067
LCF #9	8 Oct 69	8 Oct 73	81068
LCF #10	8 Oct 69	8 Oct 73	81069
Vancouver #2	8 Oct 69	8 Oct 73	81056
Vancouver #3	8 Oct 69	8 Oct 73	81057
Vancouver #4	8 Oct 69	8 Oct 73	81058
Vancouver #5	8 Oct 69	8 Oct 73	81059
Vancouver #6	8 Oct 69	8 Oct 73	81060
Vancouver #7	8 Oct 69	8 Oct 73	81061