

Cost of Diamond drilling on the Rad No.1 M.C.  
June - July, 1976

74' casing (A) at 4.00 per ft.	= 296.00
gas oil for truck and drill	590.00
drill repairs	140.00
drill rental one month	600.00
IAX bits, reaming shell and casing shoes	1200.00
core boxes	36.00
wages two men for one month at 1000.00 per month *	2000.00
total cost	4862.00

certified correct

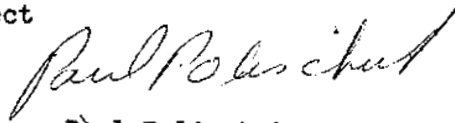

Paul Poldschuk,  
Box 466,  
Lillooet, B.C.

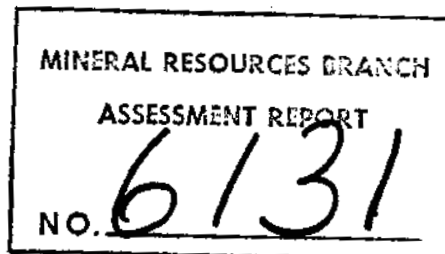

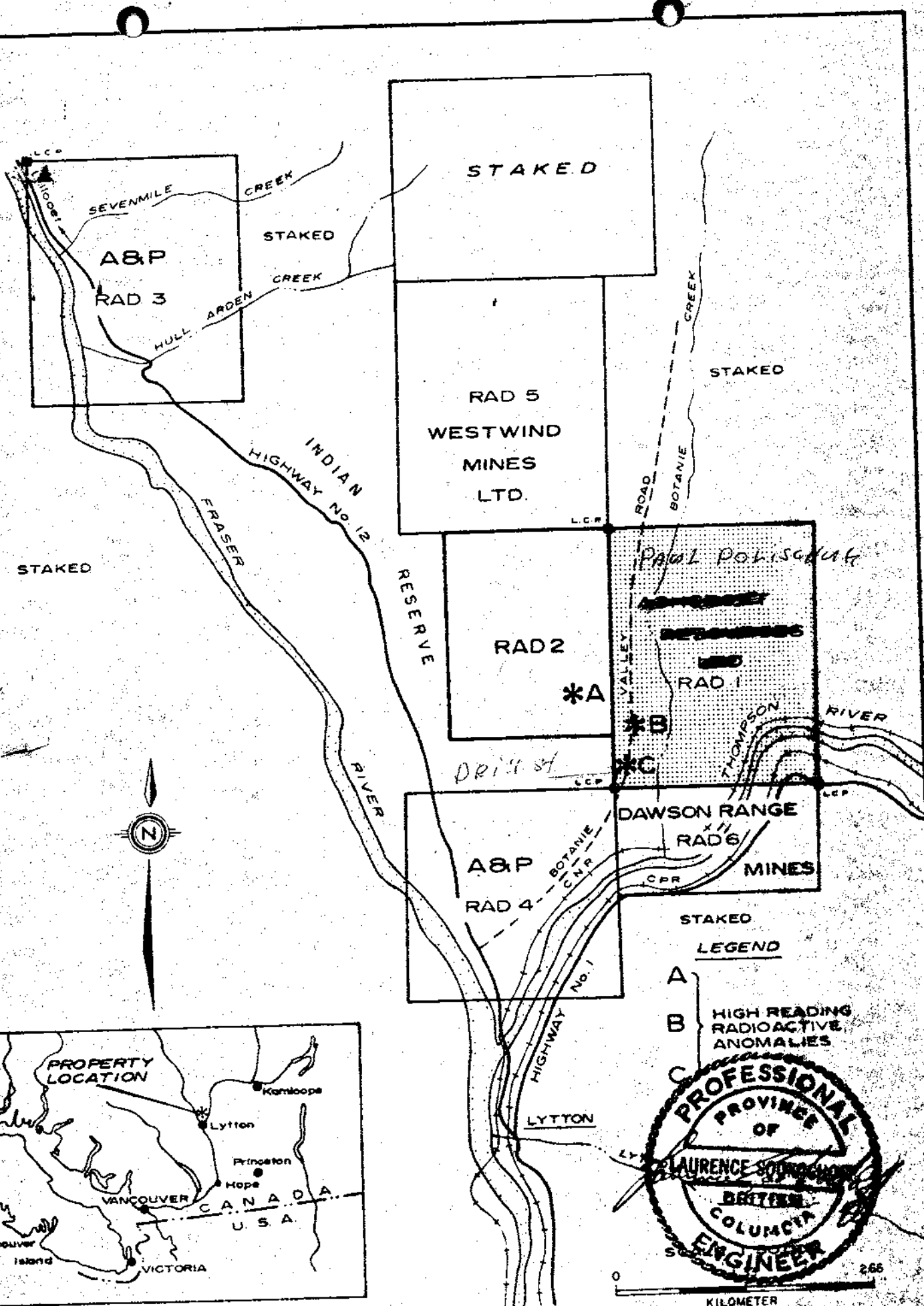

STAKED

STAKED

STAKED

STAKED

RAD 5  
WESTWIND  
MINES  
LTD.

RAD 2

\*A

*PAUL POLISCHUK*

RAD 1

\*B

*DRIFT ST*

\*C

DAWSON RANGE

A&P  
RAD 4

RAD 6  
MINES

STAKED  
LEGEND

- A
- B HIGH READING RADIOACTIVE ANOMALIES
- C

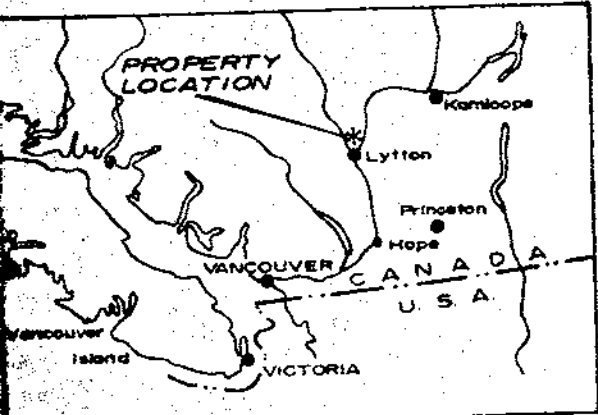

NOTE: Drawn from staking map and claim map 921/41E claim location approx.

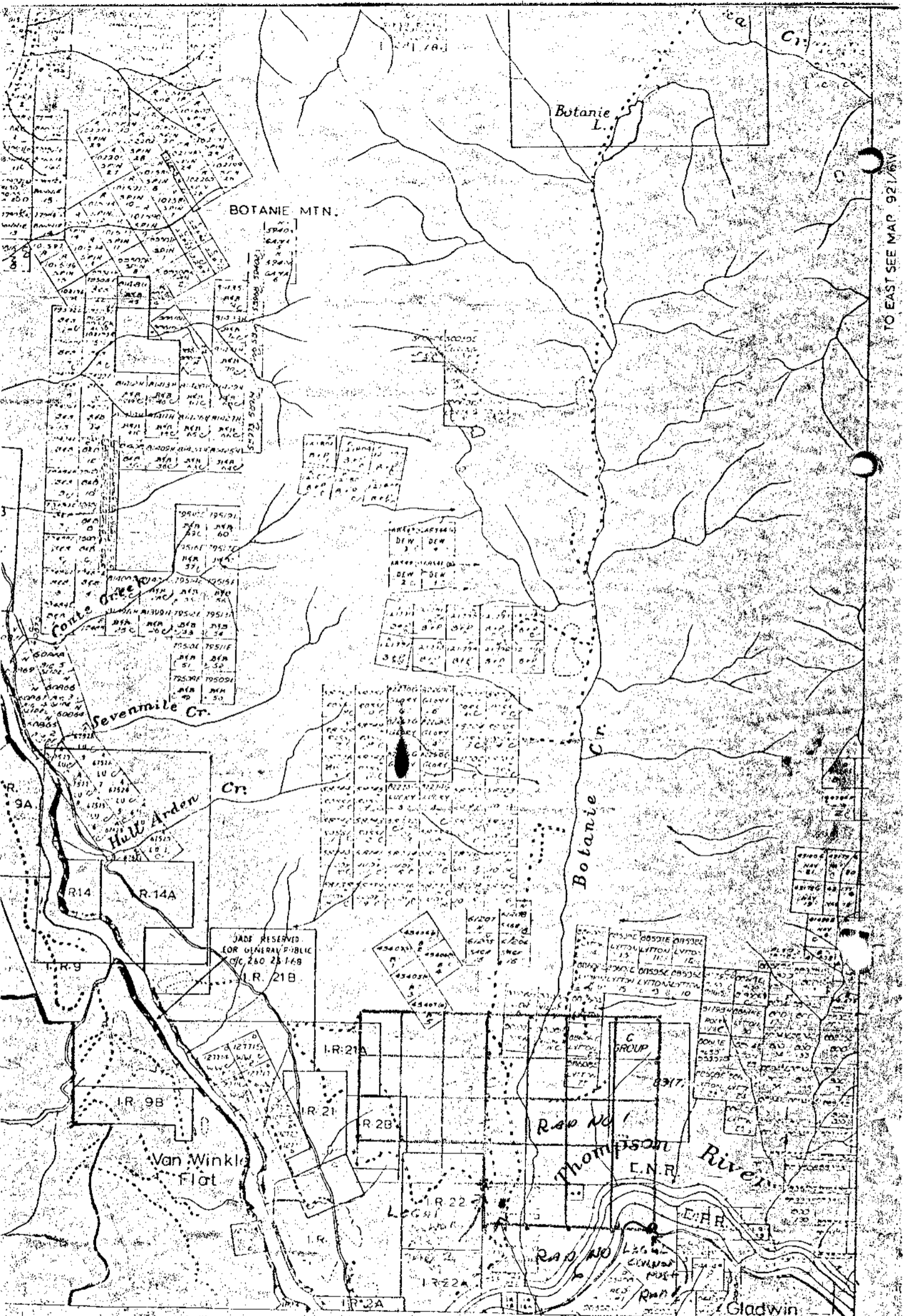

TO EAST SEE MAP 921/4V

TO SOUTH SEE MAP 921/4E

Drill Stations

121° 30'

**MINES AND PETROLEUM RESOURCES  
VICTORIA, B.C.**

**MINERAL CLAIM MAP 921/5E(M)**

This map is prepared to serve as a guide to the positions of located mineral claims and Flacer Mining Leases only. Unsurveyed claims and leases are plotted from locators' sketches and are not guaranteed. Letters C & indicate claims Crown Granted. Symbol C indicates claim has forfeited.

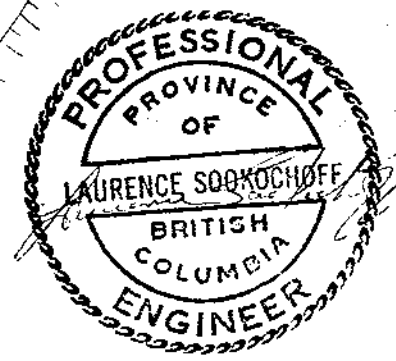
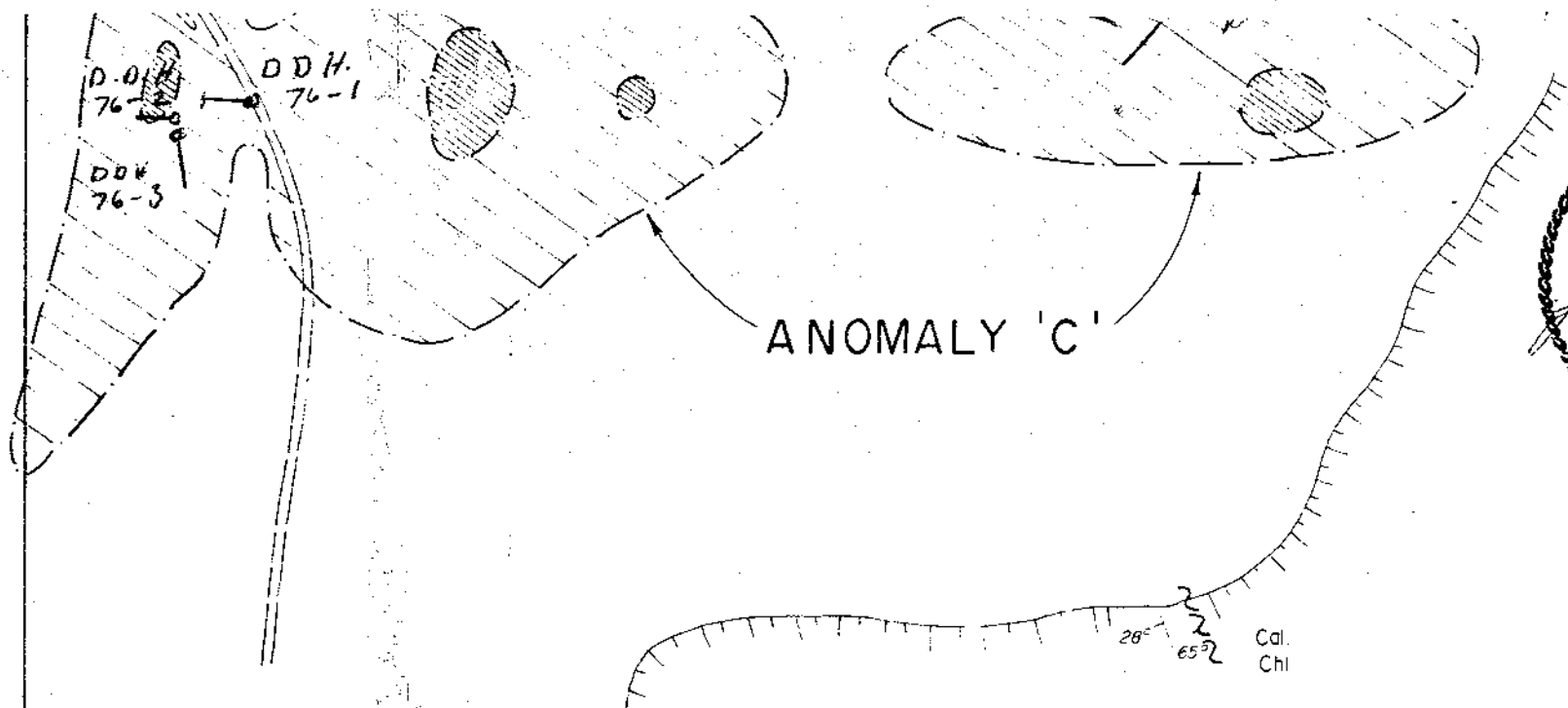

ASHC

RAD

G

30.5

L. Sookchoff

RAD No. 1 M.C  
 Location of D.D.H. No. 76-1 - 76-3  
 SCALE IN METERS



Property Rad No. 1 M.C.

# DIAMOND DRILL SAMPLING RECORD

DIP TESTS

Hole No. 76-1

Started June 19th. 1976

Bearing 270° Dip at Collar -80° Hor. Comp. Ver. Comp.

Sheet No. 921/5E.

Finished June 29th, 1976

Location L75S-75E. Elevation Lat. Dept. 148'

Logged by Paul Polischuk

Purpose of Hole Testing radioactive anomaly

Distance			DESCRIPTION	Sample No.	From	To	L	Analysis	PROGRESSIVE TOTALS			
From	To	Core%							FEET & PER CENT			
0	17		casing									
17	34	50%	grey conglomerate badly fractured.									
34	35		dark Fine grain rock resembles shale?									
35	101	60	grey conglomerate.									
101	112	60	dark brown shale									
112	135	80	grey conglomerate									
135	145		dark brown shale									
145	148	80	grey conglomerate end of hole.									
			<p><i>Paul Polischuk</i></p> <p><i>I have completed Geology "29" COURSE AND HAVE 30 YEARS EXPERIENCE IN MINING &amp; EXPLORATION</i></p> <p><i>THE CORE IS STORED IN LILLOOET, BC</i></p>									

# DIAMOND DRILL SAMPLING RECORD

Property Rad no. 1 M.C.  
 Started July 10th, 1976  
 Finished July 12 th, 1976  
 Logged by Paul Polischuk

Bearing 160° Dip at Collar ..... Hor. Comp. .... Ver. Comp. ....  
 Location L75S-25E Elevation ..... Lat. .... Dept. 35'  
 Purpose of Hole Testing radioactive anomaly

DIP TESTS

Hole No. 76-2  
 Sheet No. 921/5E

Distance			DESCRIPTION	Sample No.	From	To	L	Analysis	PROGRESSIVE TOTALS	
From	To	Core%							FEET & PER CENT	
0	22'		casing							
22	34	10%	Reddish altered limestone ( radioactive ) hole caved at 35'							

