

6220

PROSPECTING REPORT ON  
THE GREEN MINERAL CLAIM  
CONSISTING OF 10 UNITS  
SITUATED ON BIRCH ISLAND  
IN THE KAMLOOPS MINING  
DIVISION.

REPORT BY A. MITCHELL

*A. Mitchell*

MINERAL TEST PASSED  
IN KAMLOOPS 1974

MINERAL RESOURCES BRANCH  
ASSESSMENT REPORT  
NO. \_\_\_\_\_

Cost of work done on the Green Mineral  
Claim, Birch Island.

June 1976 to January 1977

Prospecting for 18 days at \$40. per day..\$720:00  
Four Wheel Drive at \$20. per day..... 360:00  
Camp Supplies..... 182:00

Total \$1,262.00

The above costs to be applied as assesment  
work for one year on the Green mineral  
claim consisting of 10 units.

Record number 299.

Work paid for by.... Copper Lake Explorations Ltd NPL  
3204 West Broadway  
Vancouver, B.C.

A preliminary report on the Green mineral claim record number 299, consisting of 10 units, located at Birch Island B.C.

#### Introduction.

The Green claim is situated between Butler and Baker creeks, and is near the continental Rexspar uranium claims which, as has been recently Announced, is going into production.

The claim is well located in relation to a sufficient supply of water and timber and the property is easily accessible the topography lends itself to low cost mining.

#### Geology.

Where observed along the Banks of Butler creek the rocks were composed of Volcanics & Schists, in placed by trachyte, oxidized on the surface to Hematite and Limonite.

Prospecting June 1976 to Jan 1977

18 days were spent traversing the claim the main purpose was in prospecting for uranium.

A scintillometer C.A.E. model 963 was used, counts ranged approx from 100 to 150 counts per second. Which is not considered of economic importance.

Recommendations.

Geological mapping to correlate the strata with the favorable host rock of the rexspar formation.

Several cuts should be made with either a backhoe or a caterpillar tractor.

Liason with the owner of the surface of the land, for example an agreement to rent his equipment to do the above mentioned work.

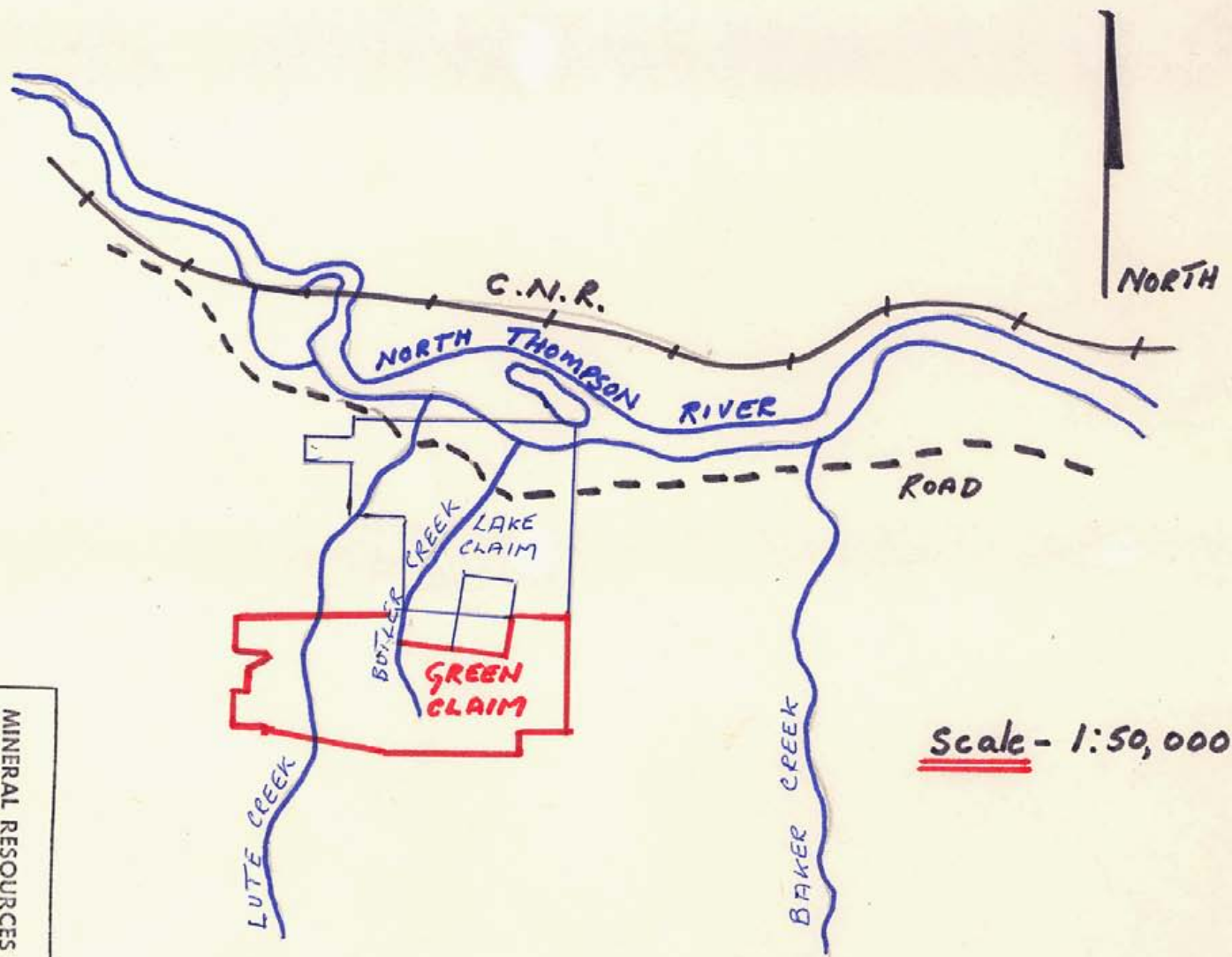

Scale - 1:50,000

MINERAL RESOURCES BRANCH  
ASSESSMENT REPORT  
NO. 6220

INDEX MAP      GREEN CLAIM

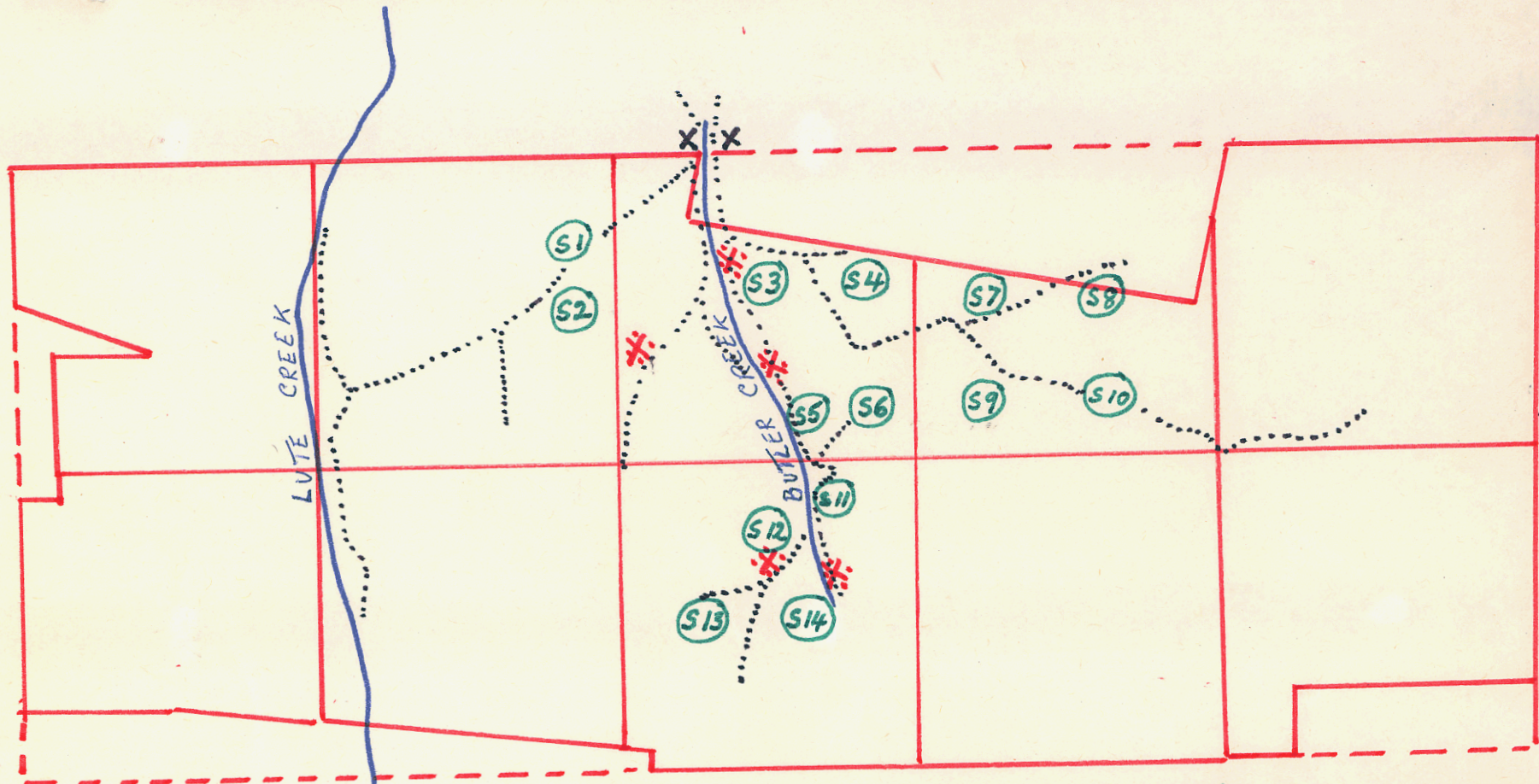

Scale = 500 meters - 2"  
 X = enter claim  
 ..... = area prospected  
 \* = outcrops

WORK MAP      GREEN CLAIM

MINERAL RESOURCES BRANCH  
 ASSESSMENT REPORT  
 NO. 6220

Scintellometer		results		
S1	= 100 c.p.s.	S8	= 100	c.p.s.
S2	= 100 "	S9	= 150	"
S3	= 100 "	S10	= 100	"
S4	= 150 "	S11	= 150	"
S5	= 100 "	S12	= 100	"
S6	= 100 "	S13	= 100	"
S7	= 100 "	S14	= 150	"