

6252

PROSPECTING REPORT
ON THE LAKE MINERAL
CLAIM, CONSISTING OF
12 UNITS.

SITUATED AT BIRCH
ISLAND IN THE KAMLOOPS
MINING DIVISION.

REPORT BY A. MITCHELL.

MINERAL RESOURCES BRANCH
ASSESSMENT REPORT

NO. _____

Cost of work done on the LAKE
Mineral claim, Birch Island, B.C.
July 1976 to April 1977

Prospecting for 21 days at \$40. per day...	\$840:00
Four wheel drive at \$20. per day.....	420:00
Camp supplies including travel.....	193:00

TOTAL	\$ 1453:00

The above costs to be applied as assesment
work for one year on the LAKE mineral claim
Record number 375

Work paid for by .. Copper lake Explorations LTD NPL
3204 West Broadway
Vancouver, B.C.

LOCATION

The Lake claim consisting of 12 units is located at Birch Island in the Kamloops mining division and traverses both Butler and Lute creeks.

Access was gained from the Birch Island road which runs on the south side of the North Thompson River.

The units run three north and four west.

INTRODUCTION

The prospecting trip was undertaken as a preliminary investigation of the property.

As this was the first phase random sampling was undertaken.

PROSPECTING

The prospecting done covered most of the LAKE claim, including both sides of Butler creek and the East side of Lute Creek. In some areas travel was slow due to the very heavy undergrowth which was caused by the wet season.

Several outcroppings were noted and samples taken.

The rocks were mainly Volcanics and Mica schists. Some of the schists carried finely disseminated pyrite, and some of the schists and volcanics were oxidized on the surface to hematite and limonite.

Please see work map for full details.

Report by A. Mitchell
Passed mineral identification
test in Kamloops²

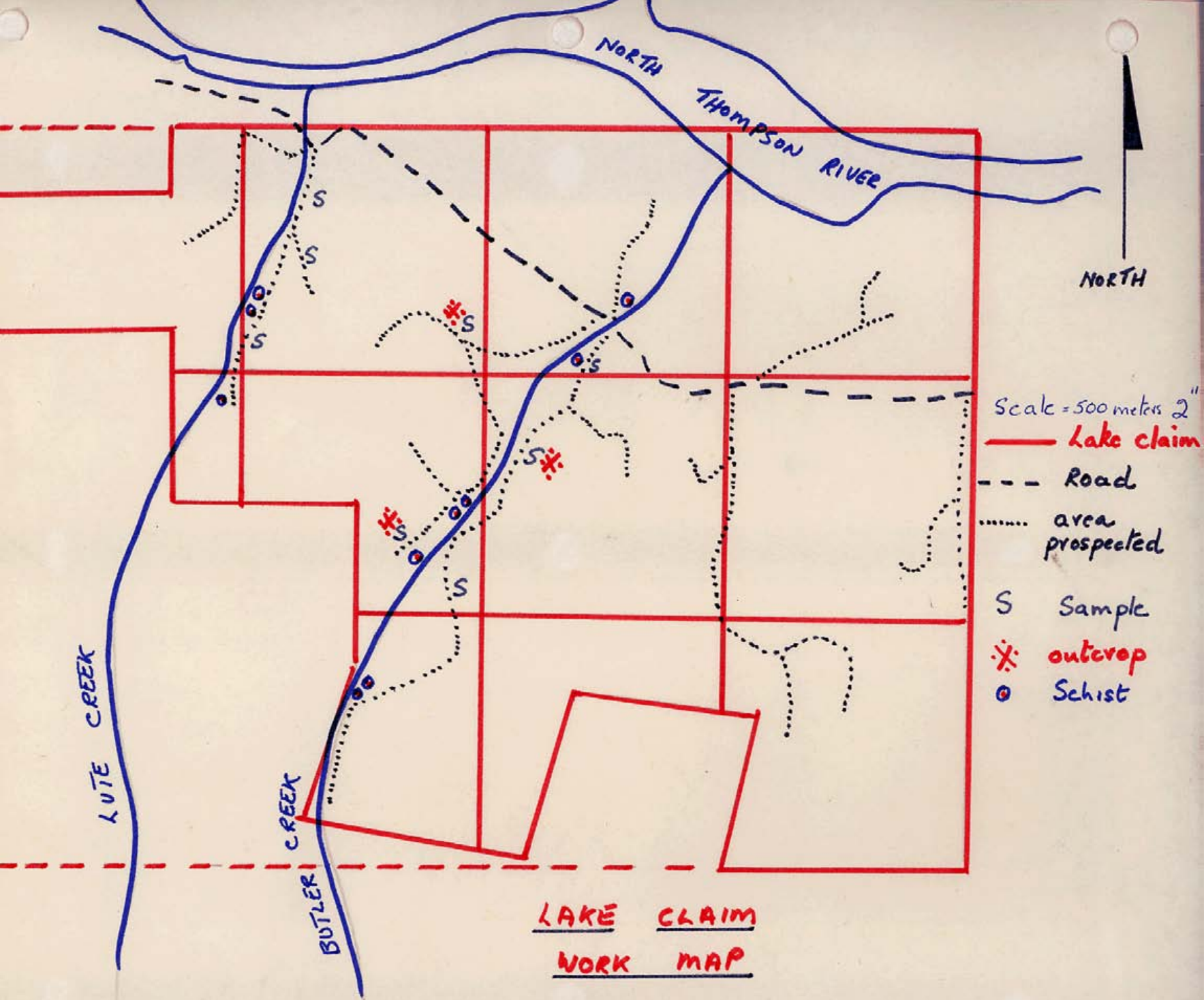

LAKE CLAIM
WORK MAP

- Scale = 500 meters 2"
- Lake claim
 - - - Road
 - area prospected
 - S Sample
 - X* outcrop
 - O Schist

#6252

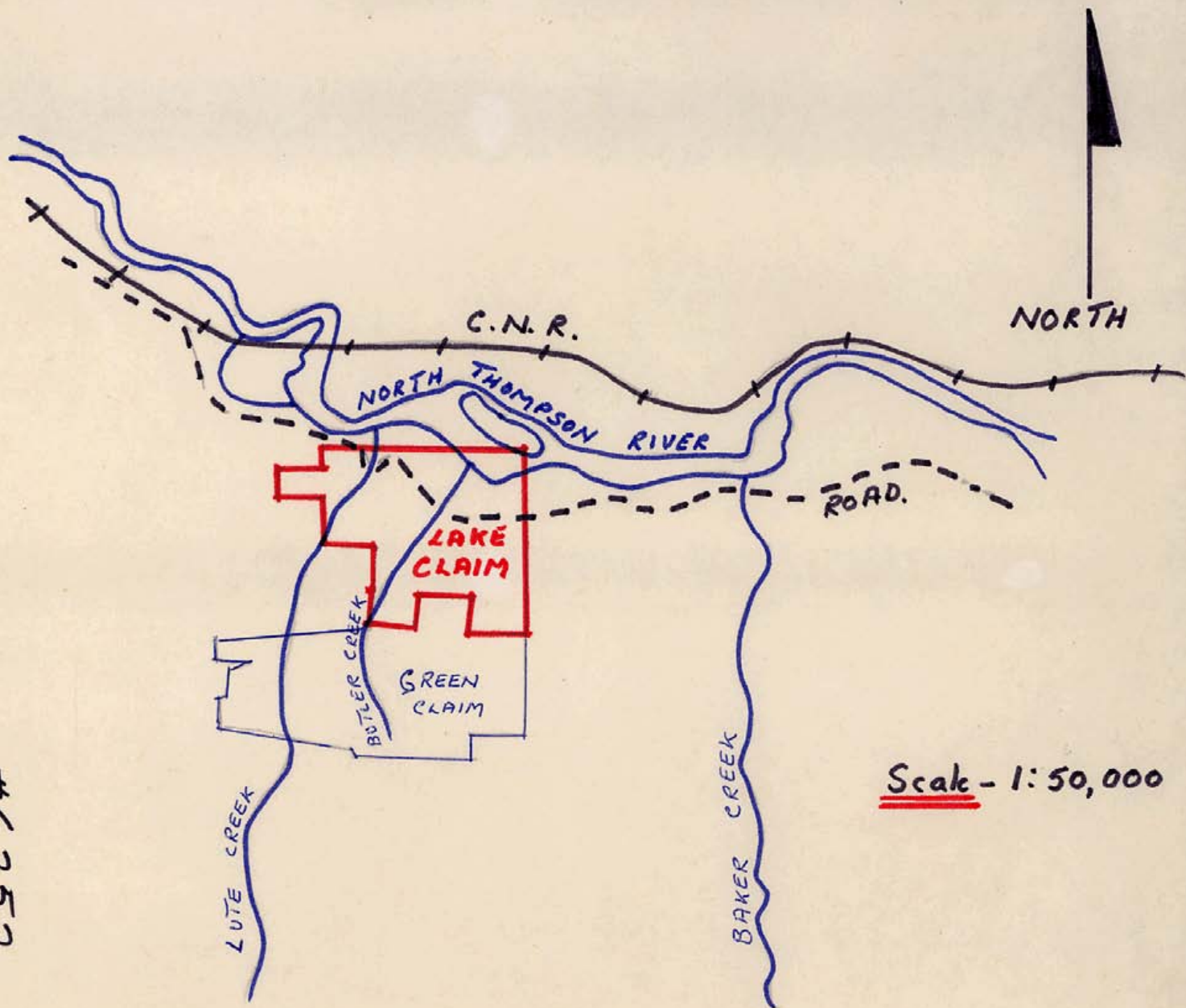

INDEX MAP

LAKE CLAIM