

We Robert Beaupre, 4361 Shelbourne Street, Victoria, 1977 Free Miner's License 155486 (B.C. Government Prospecting Course passed March 18, 1976) and Alex Low c/- 4361 Shelbourne Street, Victoria, 1977 Free Miner's License 93142 did singly and jointly attend to staking and prospecting the following Mining Properties:

Blaze # 1	Recorded June 21, 1976	Receipt # 113616E
Blaze # 2	Recorded July 12, 1976	Receipt # 113636E

Victoria Mining Division

We did prospect the above by trenching (surface drilling and blasting for samples and rock types) observing and geo chemical testing. More than 10 metres of blasting was done. Hours put in were:

Between	June	21 to 30	57 hours
	July	1 to 19	31 hours
	August	8 to 28	24 hours
	September	6 to 18	20 hours
	October	2 to 24	15 hours
	November	6 to 20	17 hours
	Total		164 hours at \$10.00 per hour \$1640.00

Cost of transportation being use of a Chevelle Blazer and A Dune Buggy, Gas, Oil, Repairs	\$ 795.54
Atlas Copco Drill rentals and powder	\$ 95.98
Camp Equipment/ Food	\$ 315.19
Cost Assays / Geo Chemical Reports	\$1147.46
Costs Maps for reports and Assessment Report	
* See sketch attached	
TOTAL	\$2994.17

The Field Work was done in Metamorphic Rocks, a Garnet, Biotite, Quartz, Feldspar, Schist which would appear to be in contact with Gneiss. Some small Diorite veins were noted and severe folding and faulting was observed. One Quartz vein had some free Gold but did not appear to continue when a depth of one metre was blasted out. See detailed minerals noted from Assays and Spectrographs Reports attached. One float sample showed good Silver reading and appeared to be of local origin.

Gold was read as being above background levels at several locations and may correspond to the type of deposits described from some Australian deposits, as indicated by the sedimentary rock formation observed in the area.



 Robert C. Beaupre



 Alex Low

6298

MINERAL RESOURCES BRANCH
 ASSESSMENT REPORT
 NO. _____

Surface
samples
for geo/chem

* Surface chip
samples, samples
from ~~the~~ surface
blasting in vein
outcrop in exposed
quartz etc, float
samples.

AIR PHOTO
MAP

20CKAIN

6298

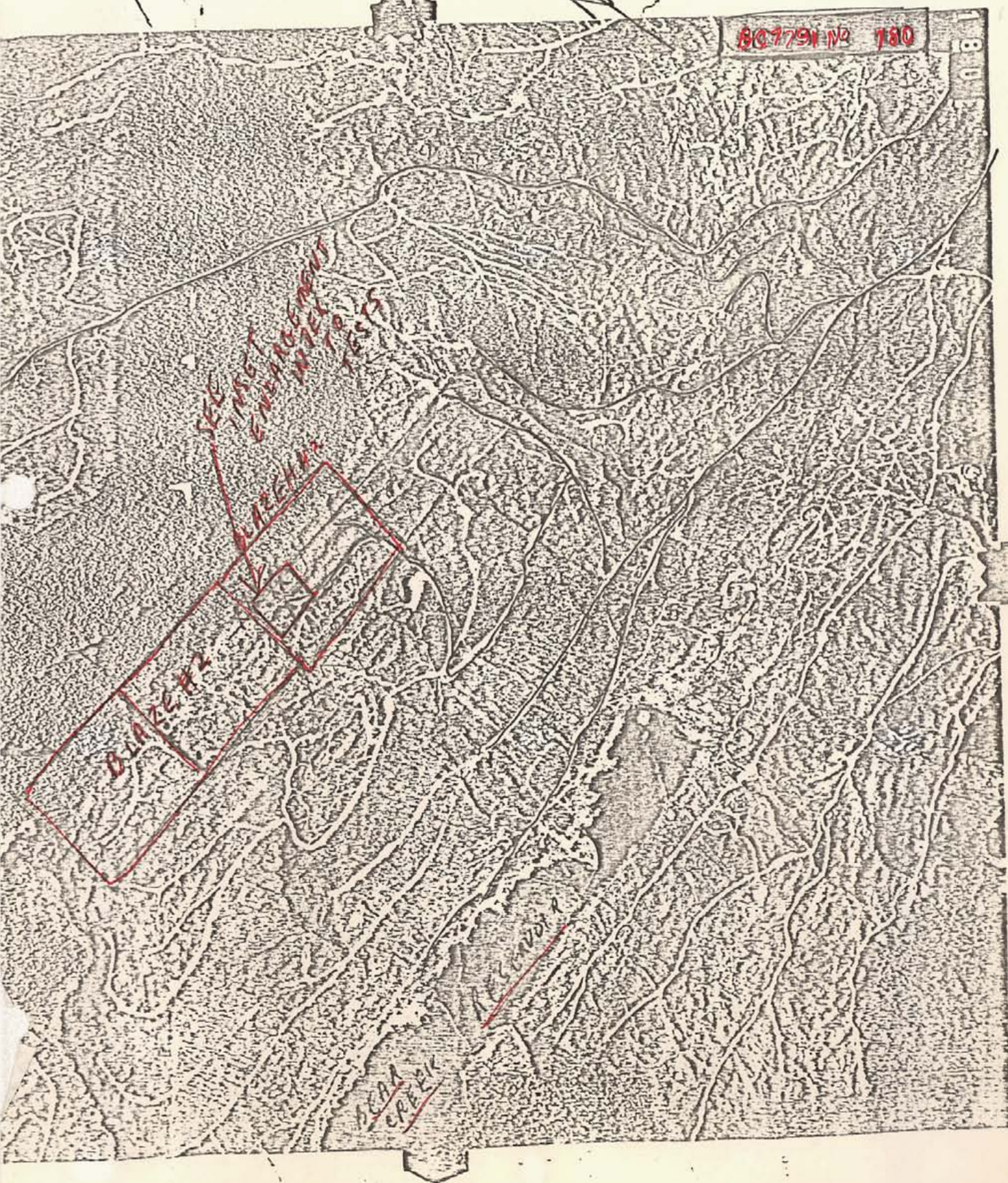

6298

1/2 307, 16. APR. 60
SUBJ. TO CONDITIONS

Jordan
Meadows

SURVEY
MTN.

River

Beech
Creek

West

VALENTINE
MTN.

BLA #2 #1
LCP

PML
264
LCP

RES. MIN. & PLACER
1/2 1105, 5 APR. 68
RELEASE REQUIRED

Bear Creek Reservoir

Beech
River

Division
Reservoir

Bear Cr.

MINING DIVISION

TO SOUTH SEE MAP 92 B/5W

MIN & PLACER
1/2 16 FEB. 60
RELEASE REQUIRED

1/2 1105
1/2 1106
1/2 1107
1/2 1108
1/2 1109
1/2 1110
1/2 1111
1/2 1112
1/2 1113
1/2 1114
1/2 1115
1/2 1116
1/2 1117
1/2 1118
1/2 1119
1/2 1120



DEPARTMENT OF MINES AND PETROLEUM RESOURCES

MINERAL RESOURCES BRANCH
INSPECTION AND ENGINEERING DIVISION

SITE PLAN

SEE/INSET/MAP
ATTACHED

TRACED OVER
BC AIR PHOTO 7791/180 LINE
SEPT 75 FLIGHT
Scale 20 chains = 1 inch

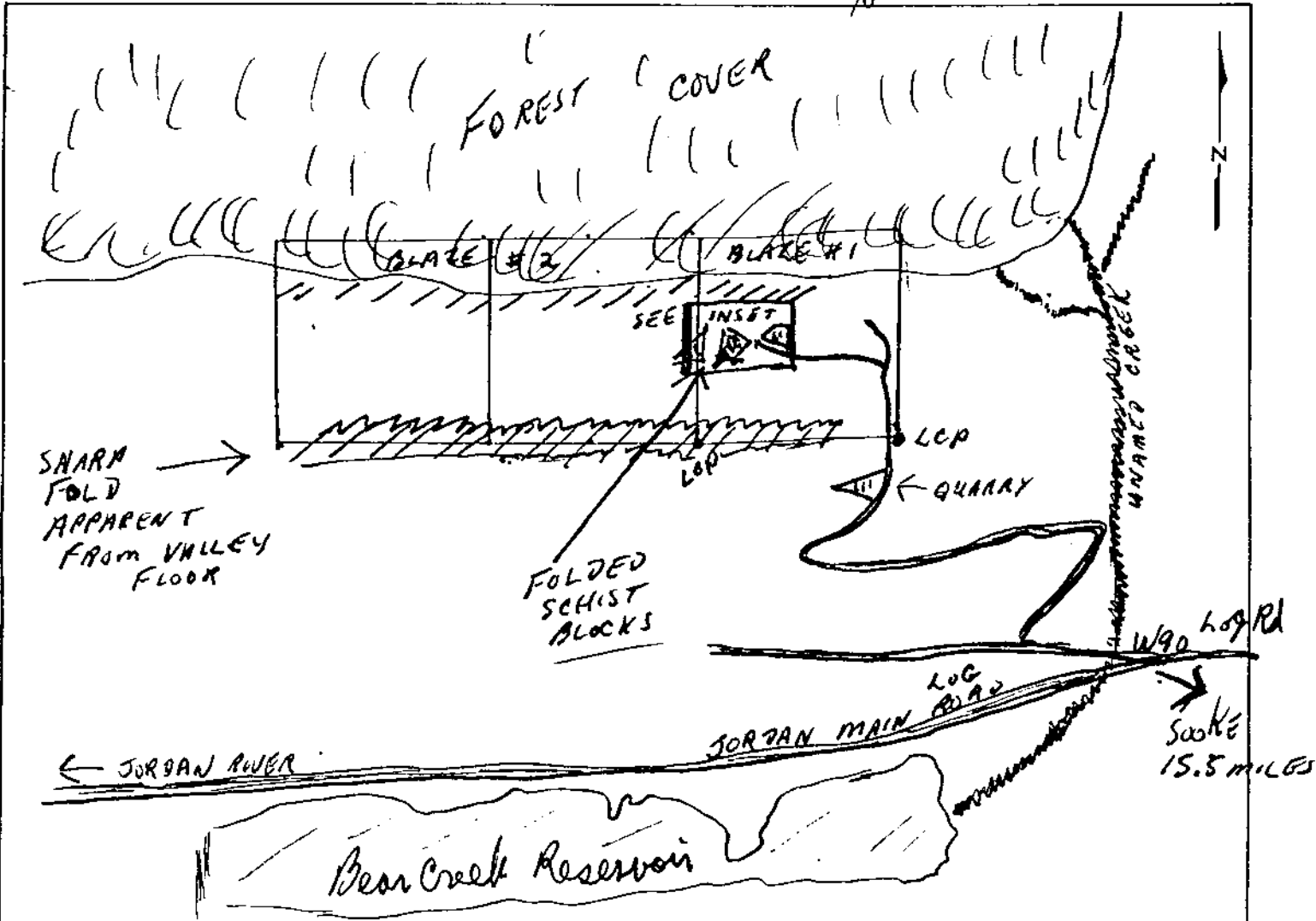

INDICATE:

Claim boundaries, permanent watercourses, access road and distance to nearest town, proposed roads, test pits, trenches, ground slope at trenches, drill sites, and camp sites.

LOCATION MAP
Show nearest town and access road.

↑
SEE MAPS
SUBMITTED
OF LOGGING
ROADS

Name of property	BLAKE #1 & 2
Claim No.	GROUPED 1977
Owner	_____
Date	_____
File No.	_____



DEPARTMENT OF MINES AND PETROLEUM RESOURCES

MINERAL RESOURCES BRANCH

INSPECTION AND ENGINEERING DIVISION

INSET
CORE PLAN

SCALE 4" = 2 1/2 CHAINS APPROX

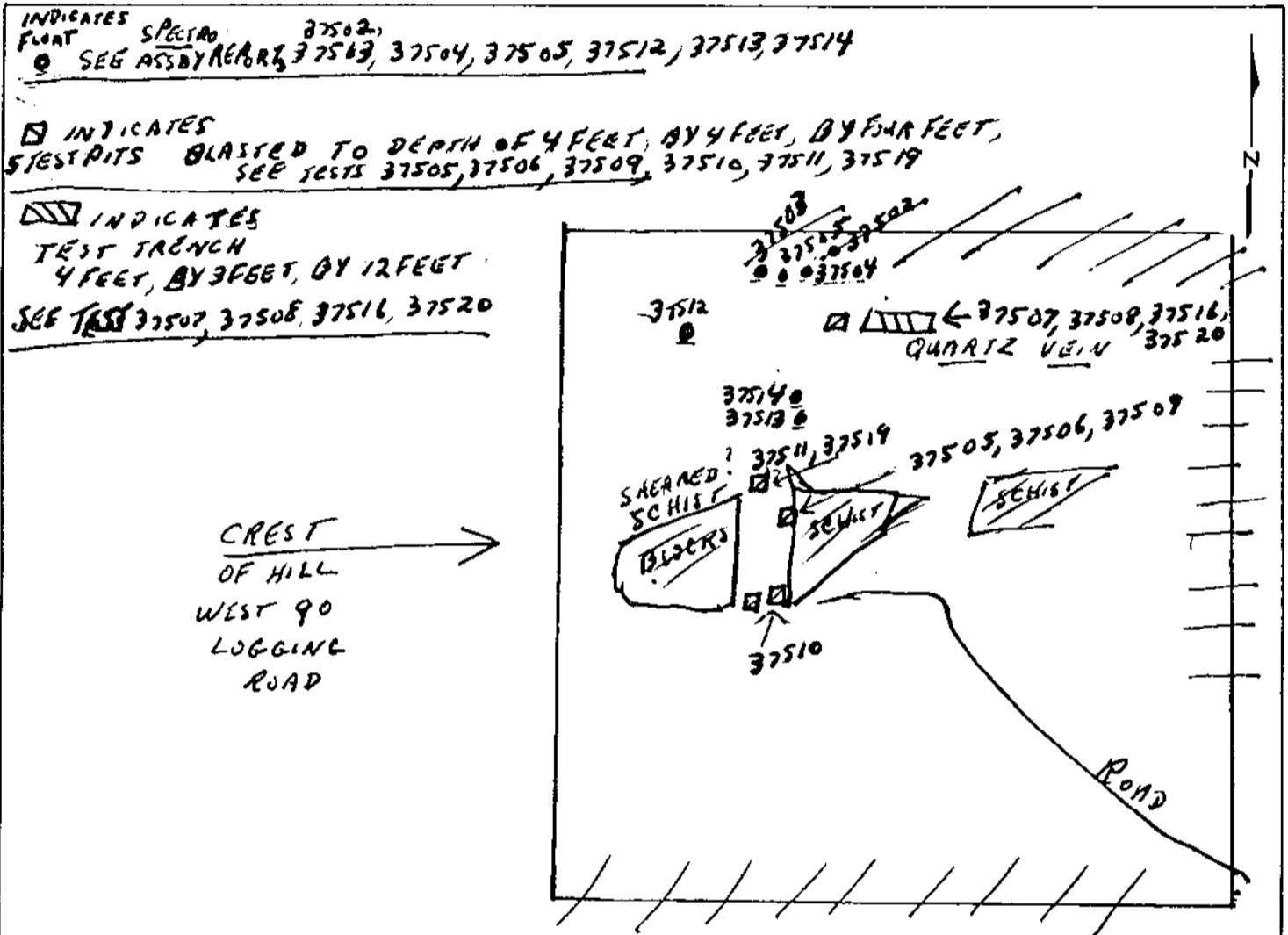

INDICATE:

Claim boundaries, permanent watercourses, access road and distance to nearest town, proposed roads, test pits, trenches, ground slopes, trenches, drill sites, and camp sites.

LOCATION MAP

Show nearest town and access road.

Name of property BLAZE GROUP 1977

Claim No. _____

Owner _____

Date _____

File No. _____

INDEX
TO TERMS

Blow #1

Field Sheet

○ denotes
holes to
be drilled or chips samples
from surface veins

17A ←
18A

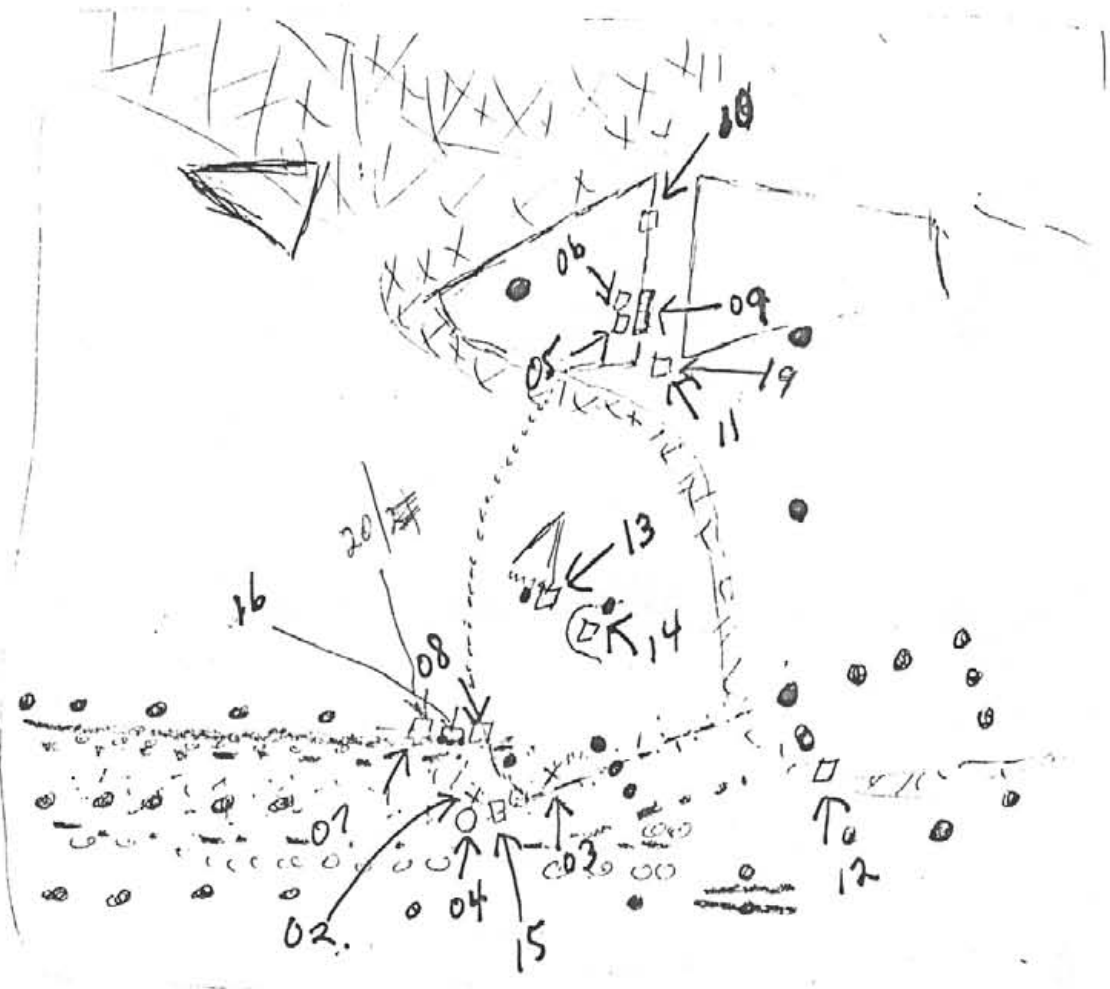

- Quartz-pegged
- - - - - Quartz muscovite
- Quartz core missing

6298



INVOICE

Tel. (604) 985-0648

Telex 043-52597

CHEMEX LABS LTD. 212 BROOKSBANK AVENUE, NORTH VANCOUVER, B.C. CANADA V7J 2C1

Mr. R. Beaupre

DATE Nov. 19/76

P. O. Box 1537

INVOICE NO. 18883

Victoria, B. C.

CERTIFICATE NO. 32103

ATTN. _____

ITEM	DESCRIPTION	SUB-TOTAL	TOTAL
1	Assayed for Ag & Au	\$8.00	
			\$8.00

pd NOV/22/76

TERMS—NET 30 DAYS

76-040

1½% Per Month (18%) Per Annum Charged on Overdue Accounts



INVOICE

Tel. (604) 985-0648

Telex 043-52597

CHEMEX LABS LTD. 212 BROOKSBANK AVENUE, NORTH VANCOUVER, B.C. CANADA V7J 2C1

R. Beaupre

DATE Sept. 20/76

P. O. Box 1537

INVOICE NO. 18283

Victoria, B. C.

CERTIFICATE NO. 31773

ATTN. _____

ITEM	DESCRIPTION	SUB-TOTAL	TOTAL
1	Assayed for Ag & Au	\$8.00	
			\$8.00

TERMS—NET 30 DAYS

76-040

1½% Per Month (18%) Per Annum Charged on Overdue Accounts



INVOICE

CHEMEX LABS LTD. 212 BROOKSBANK AVE., NORTH VANCOUVER, B.C. V7J 2C1 TELEPHONE (604) 985-0648

Robert Beaupre

DATE Aug. 31/76

c/o Victro Registry Services
P. O. Box 1537
Victoria, B. C.

INVOICE NO. 17993

CERTIFICATE NO. 31664

V8W 2X7

ATTN:

ITEM	DESCRIPTION	SUB-TOTAL	TOTAL
4	Assayed for Ag & Au @ \$8.00	\$32.00	
			\$32.00

Paid cash 2/9/76

TERMS — NET 30 DAYS

1½% Per Month (18%) Per Annum Charged on Overdue Accounts.

75-040



CHEMEX LABS LTD. 212 BROOKSBANK AVE., NORTH VANCOUVER, B.C. V7J 2C1 TELEPHONE (604) 985-0648

R. Beaupre

DATE August 2/76

c/o Victro Registry Services

INVOICE NO. 17514

Box 1537

CERTIFICATE NO. SP1107

Victoria, B.C.

ATTN:

ITEM	DESCRIPTION	SUB-TOTAL	TOTAL
2	Thirty Element Semiquantitative Spectrographic Analyses @ \$20.00		\$40.00

TERMS — NET 30 DAYS

1½% Per Month (18%) Per Annum Charged on Overdue Accounts.

75-040

CANADIAN IMPERIAL BANK OF COMMERCE

DOUGLAS AND VIEW
VICTORIA, B.C.

PAY TO THE
ORDER OF

Chemex LABS LTD

June 11 1976
\$ *60⁰⁰/₁₀₀*

TELEPHONE (604) 985-0648

Sixty dollars

R. C. BEAUPRE

xy
100 DOLLARS

DATE June 9/76

PERSONAL CHEQUING
ACCOUNT

RC INV 16866

R. C. Beaupre

CHEQUE NO. 16866

BRANCH NO. SP 1065

⑆00090⑆0101⑆ 06⑆65932⑆

ITEM	DESCRIPTION	SUB-TOTAL	TOTAL
3	Thirty Element Semiquantitative Spectrograph Analyses @ \$20.00	\$60.00	
			\$60.00

TERMS — NET 30 DAYS

1½% Per Month (18%) Per Annum Charged on Overdue Accounts.

75-040



INVOICE

CHEMEX LABS LTD. 212 BROOKSBANK AVE., NORTH VANCOUVER, B.C. V7J 2C1 TELEPHONE (604) 985-0648

R. Beaupre

DATE July 27/76

c/o Victro Registry Services,

INVOICE NO. 17413

P.O. 1537

CERTIFICATE NO. 31488

Victoria, B.C.

ATTN:

ITEM	DESCRIPTION	SUB-TOTAL	TOTAL
4	Assayed for Ag & Au (F.A.) @ \$8.00		\$32.00

TERMS — NET 30 DAYS

1½% Per Month (18%) Per Annum Charged on Overdue Accounts.

75-040



CHEMEX LABS LTD. 212 BROOKSBANK AVE., NORTH VANCOUVER, B.C. V7J 2C1 TELEPHONE (604) 985-0648

R. Beaupre

DATE July 28/76

c/o Victro Registry Services

INVOICE NO. 17456

P. O. 1537

CERTIFICATE NO. 37772

Victoria, B. C.

ATTN:

ITEM	DESCRIPTION	SUB-TOTAL	TOTAL
2	Analyzed for Au @ \$3.00	\$6.00	
2	Prepared (rock) @ \$1.25	2.50	
			\$8.50

Handwritten note: Paid \$8.50 July 29/76

TERMS — NET 30 DAYS

1½% Per Month (18%) Per Annum Charged on Overdue Accounts.

75-040



INVOICE

Tel. (604) 985-0648
Telex 043-52597

CHEMEX LABS LTD. 212 BROOKSBANK AVENUE, NORTH VANCOUVER, B.C. CANADA V7J 2C1

R. Beaupre

Box 1537

Victoria, B. C.

DATE Oct. 20/76

INVOICE NO. 18617

CERTIFICATE NO. 31870, 38861
& SP 0501

ATTN. _____

ITEM	DESCRIPTION	SUB-TOTAL	TOTAL
1	Assayed for Au	\$5.00	
1	Analyzed for Zn	1.25	
1	Prepared (rock)	1.25	
1	20 element semiquantitative analysis	15.00	
			\$22.50

CANADIAN IMPERIAL  BANK OF COMMERCE
DOUGLAS AND VIEW
VICTORIA, B.C.

PAY TO THE
ORDER OF

CHEMEX LABS LTD

OCT 27 1976

\$ 22⁵⁰/₁₀₀

Twenty two dollars

R. C. BEAUPRE

100 DOLLARS

PERSONAL CHEQUING
ACCOUNT

[Signature]

⑆00090⑆010⑆ 06⑆5932⑆



INVOICE

Tel. (604) 985-0648
Telex 043-52597

CHEMEX LABS LTD. 212 BROOKSBANK AVENUE, NORTH VANCOUVER, B.C. CANADA V7J 2C1

R. Beaupre
P. O. 1537
Victoria, B. C.

DATE Nov. 8/76
INVOICE NO. 18786
CERTIFICATE NO. 31910
ATTN. _____

ITEM	DESCRIPTION	SUB-TOTAL	TOTAL
1	Assayed for Ag & Au	\$8.00	

CANADIAN IMPERIAL  BANK OF COMMERCE
DOUGLAS AND VIEW
VICTORIA, B.C.

\$8.00

PAY TO THE ORDER OF

Chemex LABS LTD

NOVEMBER 10 19 76

\$ 8⁰⁰/₁₀₀

Eight dollars

XY
100 DOLLARS

R. C. BEAUPRE

PERSONAL CHEQUING ACCOUNT

⑆00090⑆010⑆ 06⑆65932⑆

TERMS—NET 30 DAYS

76.040

1½% Per Month (18%) Per Annum Charged on Overdue Accounts



INVOICE

CHEMEX LABS LTD. 212 BROOKSBANK AVE., NORTH VANCOUVER, B.C. V7J 2C1 TELEPHONE (604) 985-0648

R. Beaupre

DATE June 18/76

c/o Victro Registry Services

INVOICE NO. 16957

P.O. 1537

CERTIFICATE NO. SP 1073

Victoria, B.C.

ATTN: _____

ITEM	DESCRIPTION	SUB-TOTAL	TOTAL
1	Thirty Element Semiquantitative Spectrograph Analysis @ \$20.00	\$20.00	
1	Additional Element (Au) @\$2.00	2.00	
			\$22.00

PA 21/6/76

TERMS — NET 30 DAYS

1½% Per Month (18%) Per Annum Charged on Overdue Accounts.

75-040



INVOICE

Tel. (604) 985-0648

Telex 043-52597

CHEMEX LABS LTD. 212 BROOKSBANK AVENUE, NORTH VANCOUVER, B.C. CANADA V7J 2C1

R. BeaupreDATE Oct. 26/76P. O. Box 1537INVOICE NO. 18664Victoria, B. C.CERTIFICATE NO. 38865

ATTN. _____

ITEM	DESCRIPTION	SUB-TOTAL	TOTAL
1	Analyzed for Pb, Zn, Ni, As, Ag, Au, Mn, Sb, Cr & Fe Prepared (rock)	\$14.40	\$15.65
1		1.25	

TERMS—NET 30 DAYS

76-040

1½% Per Month (18%) Per Annum Charged on Overdue Accounts



CHEMEX LABS LTD. 212 BROOKSBANK AVE., NORTH VANCOUVER, B.C. V7J 2C1 TELEPHONE (604) 985-0648

Victro Registry ServicesDATE April 13/76Box 1537INVOICE NO. 16406Victoria, B. C.CERTIFICATE NO. SP 1036ATTN: Robert C. Beaupre

ITEM	DESCRIPTION	SUB-TOTAL	TOTAL
1	20 element semiquantitative analyses	\$15.00	\$15.00

TERMS—NET 30 DAYS

75-040

1½% Per Month (18%) Per Annum Charged on Overdue Accounts.



CHEMEX LABS LTD.

212 BROOKSBANK AVE.
 NORTH VANCOUVER, B.C.
 CANADA V7J 2C1
 TELEPHONE: 985-0648
 AREA CODE: 604
 TELEX: 043-52597

• ANALYTICAL CHEMISTS • GEOCHEMISTS • REGISTERED ASSAYERS

CERTIFICATE OF ANALYSIS

TO: Mr. R. Beaupre
 Box 1537
 Victoria, B.C.

ATTN:

Foot of Hill

CERTIFICATE NO. SP 0501
 INVOICE NO. 18617
 RECEIVED Oct. 19/76
 ANALYSED Oct. 20/76

SAMPLE NO. :	Lower Concentration Limit (PPM)	37517A
Antimony	50	bcl
Arsenic	50	50
Barium	5	-
Beryllium	5	bcl
Bismuth	5	-
Boron	20	bcl
Cadmium	20	bcl
Calcium	0.05%	-
Chromium	10	bcl
Cobalt	10	bcl
Copper	1	10
Gallium	2	bcl
Germanium	20	-
Iron	0.05%	-
Lead	5	bcl
Magnesium	0.02%	-
Manganese	5	30
Molybdenum	10	bcl
Nickel	5	bcl
Niobium	50	-
Silver	1	bcl
Strontium	20	-
Tantalum	200	-
Tellurium	200	-
Thorium	100	bcl
Tin	10	bcl
Titanium	5	10
Vanadium	10	bcl
Zinc	50	bcl
Zirconium	20	bcl

SEMI QUANTITATIVE SPECTROGRAPHIC ANALYSES

>5000 ppm = > 5000 ppm 50 ppm = 25-100 ppm
 5000 ppm = 2500-10000 ppm 20 ppm = 10-50 ppm
 2000 ppm = 1000-4000 ppm 10 ppm = 5-20 ppm
 1000 ppm = 500-2000 ppm 5 ppm = 2-10 ppm

500 ppm = 250-1000 ppm 2 ppm = 1-4 ppm
 200 ppm = 100-400 ppm 1 ppm = 0.5-2 ppm
 100 ppm = 50-200 ppm bcl = below concentration limit

Ranges for Iron, Calcium & Magnesium are reported in %



MEMBER
 CANADIAN TESTING
 ASSOCIATION

CERTIFIED BY:

[Signature]



STATEMENT

Tel. (604) 985-0648

CHEMEX LABS LTD. 212 BROOKSBANK AVE., NORTH VANCOUVER, B.C. CANADA V7J 2C1

Mr. R. Beaupre,

DATE July 31, 1976

C/O Victro Registry Services,

ATTN.....

P.O. 1537,

Victoria, B.C.

DATE	REF.	CHARGES	CREDITS	BALANCE
June	Bal.fwd.			\$ Nil
July 27	Inv. #17413	\$32.00		
28	17456	8.50		\$40.50

INTEREST WILL BE CHARGED ON OVERDUE ACCOUNTS



CHEMEX LABS LTD.

212 BROOKSBANK AVE.
 NORTH VANCOUVER, B.C.
 CANADA V7J 2C1
 TELEPHONE: 985-0648
 AREA CODE: 604
 TELEX: 043-52597

• ANALYTICAL CHEMISTS • GEOCHEMISTS • REGISTERED ASSAYERS

CERTIFICATE OF ANALYSIS

TO: Robert Beaupre
 c/o Victro Registry Services Ltd.
 P.O. Box 1537
 Victoria, B.C.

ATTN:

CERTIFICATE NO. SP 1065
 INVOICE NO. 16866
 RECEIVED June 2/76
 ANALYSED June 8/76

SAMPLE NO. :	Lower Concentration Limit (PPM)	37502 s/stm	37503 s/stm	37504 FLOAT
Antimony	50	bcl	bcl	200
Arsenic	50	50	50	> 10,000
Barium	5	100	700	20
Beryllium	5	bcl	bcl	bcl
Bismuth	5	bcl	bcl	10
Boron	20	20	20	bcl
Cadmium	20	bcl	bcl	bcl
Calcium	0.05%	5%	2%	0.2%
Chromium	10	300	200	10
Cobalt	10	30	bcl	20
Copper	1	20	10	100
Gallium	2	30	20	bcl
Germanium	20	bcl	bcl	bcl
Iron	0.05%	10%	2%	20%
Lead	5	10	20	300
Magnesium	0.02%	2%	1.5%	0.02%
Manganese	5	1000	500	50
Molybdenum	10	20	bcl	50
Nickel	5	100	10	50
Niobium	50	bcl	bcl	bcl
Silver	1	bcl	bcl	5000
Strontium	20	100	200	5
Tantalum	200	bcl	bcl	bcl
Tellurium	200	bcl	bcl	bcl
Thorium	100	bcl	bcl	bcl
Tin	10	bcl	bcl	bcl
Titanium	5	7000	1000	200
Vanadium	10	150	70	bcl
Zinc	50	100	100	> 10,000
Zirconium	20	70	70	20

SEMI QUANTITATIVE SPECTROGRAPHIC ANALYSES

>5000 ppm = > 5000 ppm 50 ppm = 25-100 ppm
 5000 ppm = 2500-10000 ppm 20 ppm = 10-50 ppm
 2000 ppm = 1000-4000 ppm 10 ppm = 5-20 ppm
 1000 ppm = 500-2000 ppm 5 ppm = 2-10 ppm

500 ppm = 250-1000 ppm 2 ppm = 1-4 ppm
 200 ppm = 100-400 ppm 1 ppm = 0.5-2 ppm
 100 ppm = 50-200 ppm bcl = below concentration limit
 Ranges for Iron, Calcium & Magnesium are reported in %



MEMBER
 CANADIAN TESTING
 ASSOCIATION

CERTIFIED BY:



CHEMEX LABS LTD.

212 BROOKSBANK AVE.
 NORTH VANCOUVER, B.C.
 CANADA V7J 2C1
 TELEPHONE: 985-0648
 AREA CODE: 604
 TELEX: 043-52597

• ANALYTICAL CHEMISTS • GEOCHEMISTS • REGISTERED ASSAYERS

CERTIFICATE OF ANALYSIS

TO: R. Beaupre
 c/o Victro Registry Services
 P.O. 1537
 ATTN: Victoria, B.C.

CERTIFICATE NO. SP 1073
 INVOICE NO. 16957
 RECEIVED June 15/76
 ANALYSED June 17/76

SAMPLE NO.	Lower Concentration Limit (PPM)	37505 <i>Steel out temp. in summit.</i>
Antimony	50	bcl
Arsenic	50	bcl
Barium	5	200
Beryllium	5	bcl
Bismuth	5	bcl
Boron	20	100
Cadmium	20	bcl
Calcium	0.05%	3%
Chromium	10	2000
Cobalt	10	15
Copper	1	20
Gallium	2	20
Germanium	20	bcl
Iron	0.05%	2%
Lead	5	20
Magnesium	0.02%	1%
Manganese	5	500
Molybdenum	10	bcl
Nickel	5	15
Niobium	50	bcl
Silver	1	bcl
Strontium	20	200
Tantalum	200	200
Tellurium	200	bcl
Thorium	100	bcl
Tin	10	70
Titanium	5	1000
Vanadium	10	150
Zinc	50	50
Zirconium	20	50

Gold

SEMI QUANTITATIVE SPECTROGRAPHIC ANALYSES
 < 20
 >5000 ppm => 5000 ppm 50 ppm = 25-100 ppm
 5000 ppm = 2500-10000 ppm 20 ppm = 10-50 ppm
 2000 ppm = 1000-4000 ppm 10 ppm = 5-20 ppm
 1000 ppm = 500-2000 ppm 5 ppm = 2-10 ppm

500 ppm = 250-1000 ppm 2 ppm = 1-4 ppm
 200 ppm = 100-400 ppm 1 ppm = 0.5-2 ppm
 100 ppm = 50-200 ppm bcl = below concentration limit

Ranges for Iron, Calcium & Magnesium are reported in %



MEMBER

CERTIFIED BY: *[Signature]*



CHEMEX LABS LTD.

212 BROOKSBANK AVE.
 NORTH VANCOUVER, B.C.
 CANADA V7J 2C1
 TELEPHONE: 985-0648
 AREA CODE: 604
 TELEX: 043-52597

• ANALYTICAL CHEMISTS • GEOCHEMISTS • REGISTERED ASSAYERS

CERTIFICATE OF ANALYSIS

TO: R. Beaupre
 c/o Victro Registry Services
 Box 1537
 Victoria, B.C.

CERTIFICATE NO. SP1107
 INVOICE NO. 17514
 RECEIVED July 22/76
 ANALYSED July 28/76

ATTN:

SAMPLE NO. :	Lower Concentration Limit (PPM)	37508	37511
Antimony	50	bcl	bcl
Arsenic	50	bcl	bcl
Barium	5	700	500
Beryllium	5	bcl	5
Bismuth	5	bcl	bcl
Boron	20	50	bcl
Cadmium	20	bcl	50
Calcium	0.05%	2%	1%
Chromium	10	500	100
Cobalt	10	bcl	bcl
Copper	1	30	100
Gallium	2	20	bcl
Germanium	20	bcl	bcl
Iron	0.05%	3%	10%
Lead	5	200	100
Magnesium	0.02%	1.5%	1%
Manganese	5	500	>10,000
Molybdenum	10	bcl	bcl
Nickel	5	10	50
Niobium	50	bcl	bcl
Silver	1	bcl	2
Strontium	20	100	50
Tantalum	200	200	bcl
Tellurium	200	bcl	bcl
Thorium	100	bcl	bcl
Tin	10	30	20
Titanium	5	1000	700
Vanadium	10	100	70
Zinc	50	100	100
Zirconium	20	100	100

SEMI QUANTITATIVE SPECTROGRAPHIC ANALYSES

>5000 ppm => 5000 ppm 50 ppm = 25-100 ppm
 5000 ppm = 2500-10000 ppm 20 ppm = 10-50 ppm
 2000 ppm = 1000-4000 ppm 10 ppm = 5-20 ppm
 1000 ppm = 500-2000 ppm 5 ppm = 2-10 ppm

500 ppm = 250-1000 ppm 2 ppm = 1-4 ppm
 200 ppm = 100-400 ppm 1 ppm = 0.5-2 ppm
 100 ppm = 50-200 ppm bcl = below concentration limit
 Ranges for Iron, Calcium & Magnesium are reported in %



MEMBER
 CANADIAN TESTING
 ASSOCIATION

CERTIFIED BY: 

