

6490

DRILLING REPORT

ON

M.C. NEXT #1 & NEXT #2

"GOLDSTREAM RIVER AREA"
REVELSTOKE MINING DIVISION, B. C.

- FOR -

MR. S. J. O. MCCLAY

BY

A. L. DE BRISKE, GEOLOGIST

MINERAL RESOURCES BRANCH
ASSESSMENT REPORT

NO. _____

TABLE OF CONTENTS

INTRODUCTION	PAGE 1
LOCATION AND ACCESS	PAGE 1
DRILL LOG	PAGE 1
RESULTS	PAGE 2
COST STATEMENT	PAGE 3
CERTIFICATION	PAGE 4

INTRODUCTION

The Next #1 and Next #2 claims referred to on this report comprise a group of 22 units lying south of Goldstream River in the Big Bend area of British Columbia.

The claims be immediately South of claims presently held by Noranda Corporation Ltd. on which a significant Copper-Zinc orebody has been outlined. The owner, Mr. S. J. O. McClay, in conjunction with Abaca Resources Ltd. (N.P.L.) have conducted gridding, geological, magnetometer and geochemical surveys, with encouraging results. Based on the results, a B.Q. size diamond drill hole was recommended at which time the writer was employed to log the core.

LOCATION AND ACCESS

The property is located some 80 kilometers north of Revelstoke, B. C. on the South side of Goldstream River. The drilling area of the claim is approximately latitude 51° 38'N and longitude 118° 32'W.

Access is by travelling on the paved Highway 23 for 80 kilometers North of Revelstoke, B. C. and approximately 10 kilometers East on good 2 wheel drive logging road.

DRILL LOG
DDH #1-76

Date hole commenced - October 23, 1976
Date hole stopped - October 31, 1976
Contractor Azemuth South (180°) - Herb Allen Drilling Ltd.
Merritt, B. C.
Inclination of hole - -60 degrees
Core diameter - 1 7/16" (B.Q. Wireline)
Elevation of hole - 900 meters (approximately)
Core location - Drill site

<u>Footage</u>	<u>Rock Type & Remarks</u>
0-12	Overburden
12-237	Calcareous Phyllite Thickly laminated micaceous bands (fine grained chlorite/ coarse grained biotite) with accompanying graphite and pyrahotite which are separated by recrystallized calcite layers up to 1MM in thickness. Occasional quartzose rich lenses (up to 5 CM) 50% of section composed of dark grey to black micaceous bands; 50% composed of light grey.
237-487	Calcareous Phyllite Calcareous and quartzose lenses are separated by micaceous layers (Biotite coarse grained; chlorite fine grained) with graphite and pyrahotite.
487 -	Hole stopped.

RESULTS

A total of 487 feet of B Q core was drilled in one hole which did not contain sufficient mineralization to warrant assaying.

COST STATEMENT OCTOBER 22, 1976 - NOVEMBER 1, 1976

Diamond Drilling - 487 feet @ \$11.00	\$ 4,872.00
Caterpillar Tractor	1,165.50
Field Supervision	1,200.00
A. A. De Briske, Geologist	1,000.00
Room and Board 3x11 days @ \$20.00/day	660.00
Diamond Drill Helper	1,200.00
Transportation	500.00
	<u>\$14,597.50</u>

CERTIFICATION

I, ~~Edward~~^{LEONARD} Arthur De Briske, of Trail, B. C. do hereby certify that

1. I am a mining exploration geologist residing at 625 Dickens Street, Trail, B. C.
2. I am a graduate of the University Of British Columbia, (1964) B.Sc. (Major -Geology).
3. I have practised my profession since 1964.
4. Information contained in the Report is based on work carried out by me, or at my direction, between the period of October 21, 1976 to November 2, 1976.

A. L. De Briske, B. Sc.
Geologist

October 26, 1977
Vancouver, B. C.

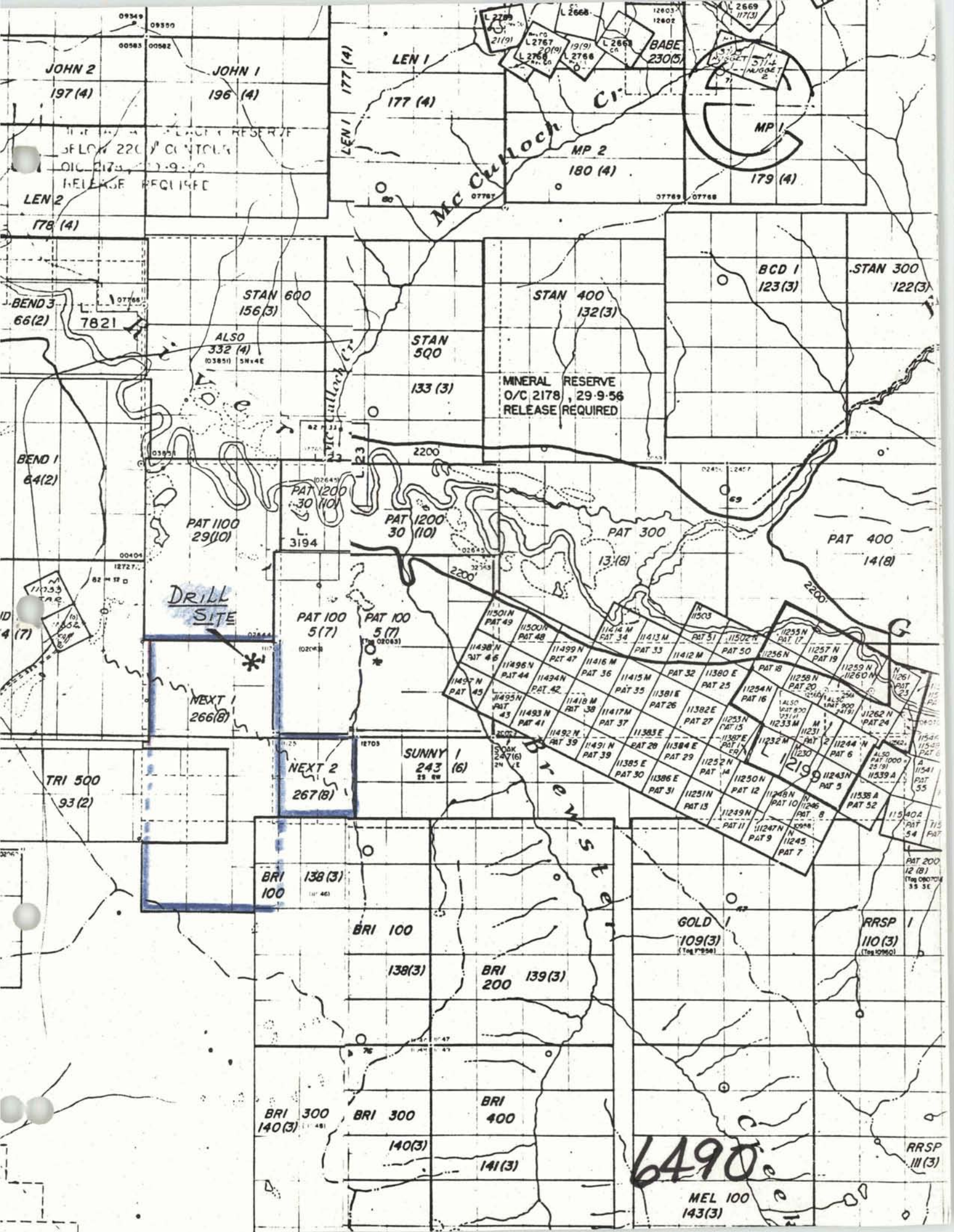

JOHN 2
197 (4)

JOHN 1
196 (4)

LEN 1
177 (4)

LEN 2
178 (4)

STAN 600
156 (3)

STAN 400
132 (3)

BCD 1
123 (3)

STAN 300
122 (3)

BEND 3
66 (2)

BEND 1
64 (2)

4 (7)

DRILL SITE

PAT 1100
29 (10)

PAT 1200
30 (10)

STAN 500
133 (3)

MINERAL RESERVE
O/C 2178, 29-9-56
RELEASE REQUIRED

PAT 300
13 (8)

PAT 400
14 (8)

PAT 100
5 (7)

PAT 100
5 (7)

NEXT 1
266 (8)

NEXT 2
267 (8)

SUNNY 1
243 (6)

TRI 500
93 (2)

BRI 100
138 (3)

BRI 100
138 (3)

BRI 200
139 (3)

GOLD 1
109 (3)

RRSP 1
110 (3)

BRI 300
140 (3)

BRI 300
140 (3)

BRI 400
141 (3)

GOLD 1
109 (3)

RRSP 1
110 (3)

6490

MEL 100
143 (3)

RRSP
111 (3)

85
15

M.C PAT 100

M.C NEXT #2 |

DRILL TRENCH
DWH 1-76

DRILL SITE 80

L.C.P
NEXT #2

1

POST
1W

M.C PAT 1100

SCALE 1-1250



MR SJO McCLAY
NEXT GROUP
REVELSTOKE MD
DRILL SITE

685-1205
Brian Mcclay

MINERAL RESOURCES BRANCH
ASSESSMENT REPORT
NO. **6490**

LOGGING
ROAD