

78-#18-#6645

DIAMOND DRILL LOGS
on the
SPAR GROUP 1
ADAMS LAKE PLATEAU
KAMLOOPS MINING DIVISION

51° 03' N 119° 33' W
NTS 82 M/4E

<u>NAME</u>	<u>RECORD NO</u>	<u>EXPIRY DATE</u>
Spar 1	127210	Nov. 5/79
Spar 2	127211	Nov. 5/79
K	607	Oct. 28/77
VK	608	Oct. 21/77
WILLI	609	Oct. 21/77

on behalf of

PAMEX MINING LTD.

by

G. GUTRATH

ATLED EXPLORATION MANAGEMENT LTD.

January, 1978

MINERAL RESOURCES BRANCH
ASSESSMENT REPORT
6645
NO. _____

INTRODUCTION

The drill core was logged by G. Gutrath, P. Eng. in November, 1976. A total of 8 holes were drilled but only DDH1 through 5 totalling 475' were logged by the writer.

A Smit 300 using BQ wireline equipment was used to drill the holes. The overall cost of the drilling was approximately 25/00/foot.

The core is stored on the property.

PISIMA
MTN.

LOCATION OF
DRILLING

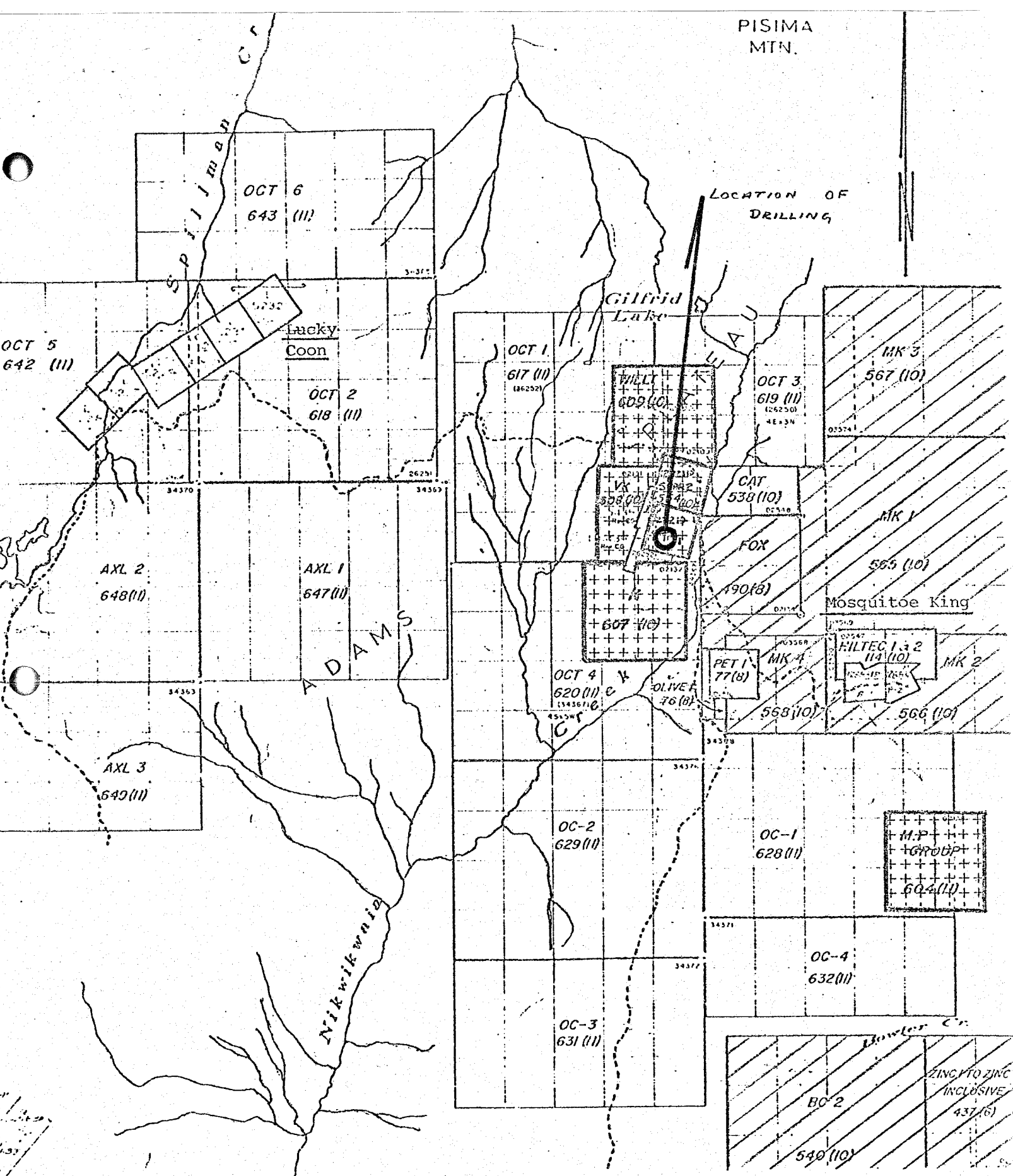

CLAIM MAP

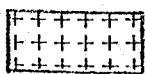

Pamex Mines Ltd.

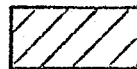

Craigmont Mines Ltd.

(optioned or located claims)

Scale 1:50,000

RESULTS

In October/November, 1966, the Spar claim group was optioned to Hesca Resources Ltd. who carried out a BQ wireline drill program in the adit area on the Spar 1 claim. Hesca drilled 8 vertical holes to a maximum depth of 150 feet within a radius of 100 feet of the adit zone in an attempt to determine the extent of the sulphide mineralized zone.

DDH 76-1, drilled to test the central core of the adit zone, intersected 16 feet of massive sulphide mineralization that assayed 18.88% lead, 8.5% zinc, 0.23% copper, 11.12oz./ton silver and ^{788 g/t} .023% gold. DDH 76-2 was drilled 40 feet to the southwest of 76-1 and intersected 6.5 feet of massive sulphide mineralization assaying 12.0% lead, 4.10% zinc, 0.18% copper, 6.92oz./ton silver and 0.014oz/t. gold. From these two holes it can be seen that the massive sulphides thin rapidly from 16 feet to 6.5 feet along the southwest plunge of the zone. No drilling was done to the southwest of DDH 76-2 to see if the zone completely pinches out or possibly thickens. DDH 76-3 to 76-5 were drilled to the north and northwest of the adit zone and did not intersect any mineralization of economic interest. DDH 76-7 was drilled 40 feet to the south of DDH 76-2 and did not intersect any significant sulphide sections. DDH 76-8 was not completed because of winter conditions that resulted in the termination of the drill program.

Respectfully submitted,

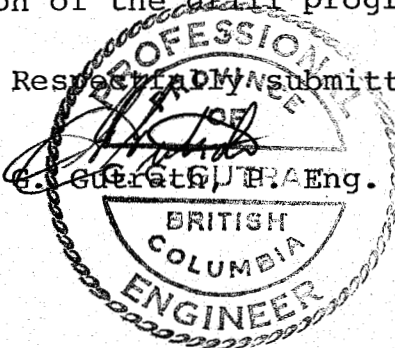

ENGINEER'S CERTIFICATE

I, GORDON C. GUTRATH, of 3636 Lakedale Avenue in the Municipality of Burnaby, in the Province of British Columbia, DO HEREBY CERTIFY:-

1. THAT I am a consulting geologist with a business address of 1024-355 Burrard Street, VANCOUVER, B.C. V6C 2G8
2. THAT I am a graduate of the University of British Columbia where I obtained my B. Sc., in geological science in 1960.
3. THAT I am a Registered Professional Engineer in the Geological Section of the Association of Professional Engineers in the Province of British Columbia.
4. THAT I have practised my profession as a geologist for the past eighteen years and
5. THAT I have no interest in the property with which this report is concerned, nor do I expect to receive any such interest, nor do I have any interest in Pamex Mining Ltd.

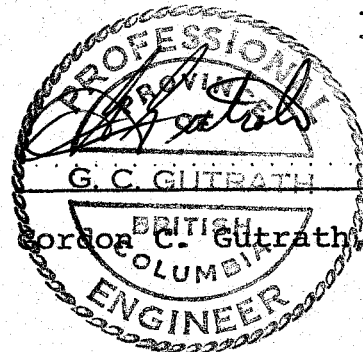

DATED at the City of Vancouver, Province of British Columbia, this 2nd day of February, 1978.

08
25°

BB

A

07

Edge of Trench

140

03

06

B

50

26°

15

06?

Edge of Dump

SCALE 1" = 40'

PAMEX MINES LTD.

DDH with logs attached.

Ground

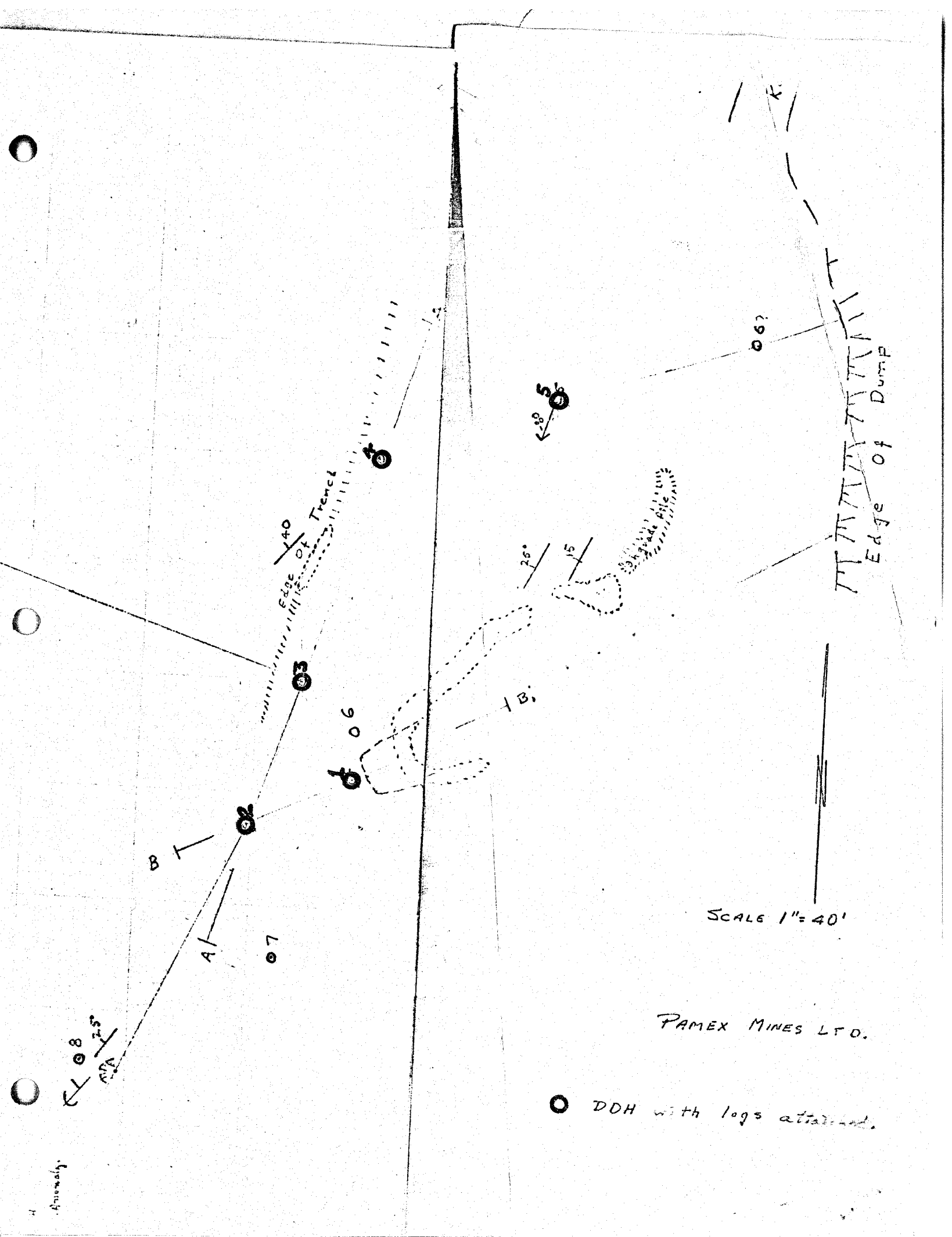

DIAMOND DRILL LOG

COLLAR:---

LAT. _____
 DEP. _____
 ELEVATION _____
 AZIMUTH _____

DIP TEST		
FOOTAGE	ANGLE	
	READING	CORRECTED

PROPERTY *PAMEX-SPAR*
 HOLE NO. *76-4*
 COMMENCED _____
 FINISHED _____
 PURPOSE OF HOLE _____
 LOGGED BY: *GG Nov. 76*

Page 1

N.M.P.

FOOTAGE	DESCRIPTION	CORE SAMPLES						
		SAMPLE NO.	FROM	TO	WIDTH	ASSAY	WIDTH X ASSAY	SAMPLE NO.
0 - 2'	Overburden							
2 - 9'	Quartz chlorite schist, light and dark banding, very siliceous from 2'-6'. Then more limy more light bands than next section, cubic pyrite, some pyrrhotite, some open space filling, weakly oxidized, foliation @ 60° to 70° only minor galena and zinc							
9' - 31'	limy argillaceous quartz chlorite schist. coarse cubic pyrite, blebs of pyrrhotite, minor galena and sphalerite, crenulated, drag folded, banding starting @ 27' to 30'							
31 - 38.5	Quartz chlorite schist with short dark sections @ 60° to 70° to core, similar to 2'-9'							
38.5 - 40'	Silicified zone, epidote - possible silicified, fault zone cutting core @ 30°, minor sulphides							
40' - 95'	limy argillaceous chlorite-quartz schist. Very uniform banding. Fine to coarse banding minor crenulation, minor sulphides, 81' patch of pyrrhotite-pyrite parallel banding, to 95' ground 3' of core @ 92', non-fault							

DIAMOND DRILL LOG

COLLAR:—

LAT. _____
 DEP. _____
 ELEVATION _____
 AZIMUTH _____

DIP TEST		
FOOTAGE	ANGLE	
	READING	CORRECTED

PROPERTY *PAMEX-5 PAR*
 HOLE NO. *76-5*
 COMMENCED _____
 FINISHED _____
 PURPOSE OF HOLE _____
 LOGGED BY: *G.G. Nov/76*

Page 1

N.M.P.

FOOTAGE	DESCRIPTION	CORE SAMPLES						
		SAMPLE NO.	FROM	TO	WIDTH	ASSAY	WIDTH X ASSAY	SAMPLE NO.
0-2'	Overburden							
2-3'	Very siliceous - Quartz vein (?) epidote patches, irregular veinlets and patches of pyrophyllite, pyrite.							
3'-6.5'	Chlorite - Quartz schist; 30% quartz bands, 60% $\frac{1}{4}$ " wide, dark greenish black chloritic bands, consistent banding at 60° to 80° Disseminated sulphides, fine to medium grained							
6.5'-33'	Quartz chlorite schist - Quartz 60-70%, dark chlorite bands 30-40%, consistent banding @ 60°-80° to core. Appears to be pervasive silicification, banding in same direction in undisturbed, feathery. Irregular patches of quartz mixed with sulphides, patches, blebs, bands & diss. 5-10% light green chlorite some epidote, Pyrophyllite - pyrite veinlets cut banding.							
33'-51.5'	Silicified Chlorite quartz schist. Very similar to 6.5'-33' but lighter coloured, greenish grey 4.5 to 4.7 - greywacke, less altered, darker, banding @ 60° - 80° to core							

PAMEX MINES LTD.

SPAR CLAIM GROUP

SAMPLE ASSAYS

	<u>Sample No.</u>	<u>Sample Interval</u>	<u>Width</u>
DDH 76-61	1962A	7' - 18'	11'
	1963	18'-28'	10'
	1964	28'-34'	6'
	1965	34'-38'	4'
	1966	38'-53'	15'
	1967	53'-57.5'	4.5'
	DDH 76-2	1968	30'-38'
1969		38'-46'	8'
1970		46'-52.5'	6.5'
1971		52.5'-60'	7.5'
1972		60'-70'	10'
1973		70'-80'	10'
1974		80'-90'	10'
DDH 76-3	1976	31'-41'	10'
	1977	41'-46'	5'
	1978	74'-84'	10'
	1979	84'-94'	10'
DDH 76-4	1980	2'-12'	10'

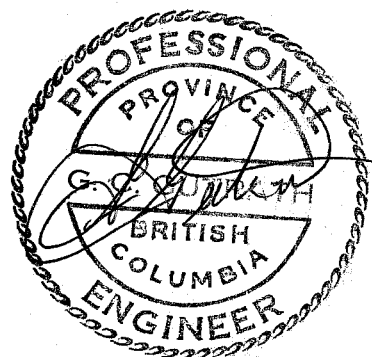

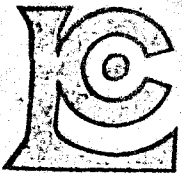

CHEMEX LABS LTD.

212 DOOKSBANK AVE.
 NORTH VANCOUVER, B.C.
 CANADA V7J 2C1
 TELEPHONE: 985-0648
 AREA CODE: 604
 TELEX: 043-52597

• ANALYTICAL CHEMISTS • GEOCHEMISTS • REGISTERED ASSAYERS

CERTIFICATE OF ASSAY

TO: Hesca Resources
 705 - 900 W. Hastings
 Vancouver, B. C.

CERTIFICATE NO. 31913

INVOICE NO. 18805

RECEIVED Nov. 4/76

ATTN:

ANALYSED Nov. 8/76

SAMPLE NO.	% Copper	% Lead	% Zinc	Oz/Ton Silver	Oz/Ton Gold
✓ 1962	0.04	0.37	0.50	0.14	<0.003
✓ 1963 18-28(10)	0.16 1.6	13.1 = 131.0	7.44 = 74.4	6.90 = 69.0	0.018 = 0.18
✓ 1964 28-34(6)	0.34 2.04	28.5 = 171.0	10.3 = 60.8	18.12 = 108.72	0.032 = 0.192
✓ 1965 34-38(4)	0.09 2.64	1.68 302.0	2.70 136.2	1.08 77.72	0.003 0.372
✓ 1976	0.06 (0.23)	0.70 (18.88)	0.77 (8.5)	(11.12)	(0.023)
✓ 1977	0.08	1.31	2.53		
✓ 1978	0.02	0.39	0.73	0.18	<0.003
✓ 1979	0.05	1.25	1.04	0.51	<0.003
✓ 1980	< 0.01	0.01	0.02		

Spar 1-2



MEMBER
 CANADIAN TESTING
 ASSOCIATION

REGISTERED ASSAYER, PROVINCE OF BRITISH COLUMBIA



CHEMEX LABS LTD.

212 BROOKSBANK AVE.
 NORTH VANCOUVER, B.C.
 CANADA V7J 2C1
 TELEPHONE: 985-0648
 AREA CODE: 604
 TELEX: 043-52597

• ANALYTICAL CHEMISTS • GEOCHEMISTS • REGISTERED ASSAYERS

CERTIFICATE OF ASSAY

TO: Hesca Res.
 705 - 900 W. Hastings
 Vancouver, B.C.

CERTIFICATE NO. 31900

INVOICE NO. 18748

RECEIVED Nov. 1/76

ANALYSED Nov. 3/76

ATTN: *Plateau* cc: W. Gutrath

SAMPLE NO. :	% Copper	% Lead	% Zinc	Oz/Ton Silver	Oz/Ton Gold
✓ 1966A	0.03	0.45	0.32	0.24	0.003
✓ 1967	0.06	0.32	0.92	0.20	0.007
✓ 1968	0.03	0.77	0.73	0.24	0.003
✓ 1969	0.03	0.02	0.02	0.01	< 0.003
✓ 1970	0.18	12.0	4.10	6.92	0.014
✓ 1971	0.07	0.49	1.18	0.35	0.010
✓ 1972	0.04	0.47	0.69	0.18	0.003
✓ 1973	0.01	0.09	0.20	0.04	< 0.003
✓ 1974 A	0.01	0.10	0.05	0.06	0.012



MEMBER
 CANADIAN TESTING
 ASSOCIATION

[Signature]
 REGISTERED ASSAYER, PROVINCE OF BRITISH COLUMBIA